

**NORTH EDGE OF WB SHOULDER**

| Location               | Station    | Offset | Theoretical Grade Elevations |
|------------------------|------------|--------|------------------------------|
| W. END W. APPR. PAV'T. | 1191+72.50 | -45.50 | 476.59                       |
| AA                     | 1191+82.50 | -45.50 | 476.89                       |
| AB                     | 1191+92.50 | -45.50 | 477.18                       |
| E. END W. APPR. PAV'T. | 1192+02.50 | -45.50 | 477.48                       |

**NORTH EDGE OF WB PAVEMENT**

| Location               | Station    | Offset | Theoretical Grade Elevations |
|------------------------|------------|--------|------------------------------|
| W. END W. APPR. PAV'T. | 1191+72.50 | -41.50 | 476.68                       |
| AA                     | 1191+82.50 | -41.50 | 476.97                       |
| AB                     | 1191+92.50 | -41.50 | 477.27                       |
| E. END W. APPR. PAV'T. | 1192+02.50 | -41.50 | 477.56                       |

**CHANGE IN CROSS SLOPE (WB1) & ROADWAY CROWN**

| Location               | Station    | Offset | Theoretical Grade Elevations |
|------------------------|------------|--------|------------------------------|
| W. END W. APPR. PAV'T. | 1191+72.50 | -29.50 | 476.86                       |
| AA                     | 1191+82.50 | -29.50 | 477.16                       |
| AB                     | 1191+92.50 | -29.50 | 477.45                       |
| E. END W. APPR. PAV'T. | 1192+02.50 | -29.50 | 477.75                       |

**CHANGE IN CROSS SLOPE (WB2)**

| Location               | Station    | Offset | Theoretical Grade Elevations |
|------------------------|------------|--------|------------------------------|
| W. END W. APPR. PAV'T. | 1191+72.50 | -17.50 | 476.68                       |
| AA                     | 1191+82.50 | -17.50 | 476.97                       |
| AB                     | 1191+92.50 | -17.50 | 477.27                       |
| E. END W. APPR. PAV'T. | 1192+02.50 | -17.50 | 477.56                       |

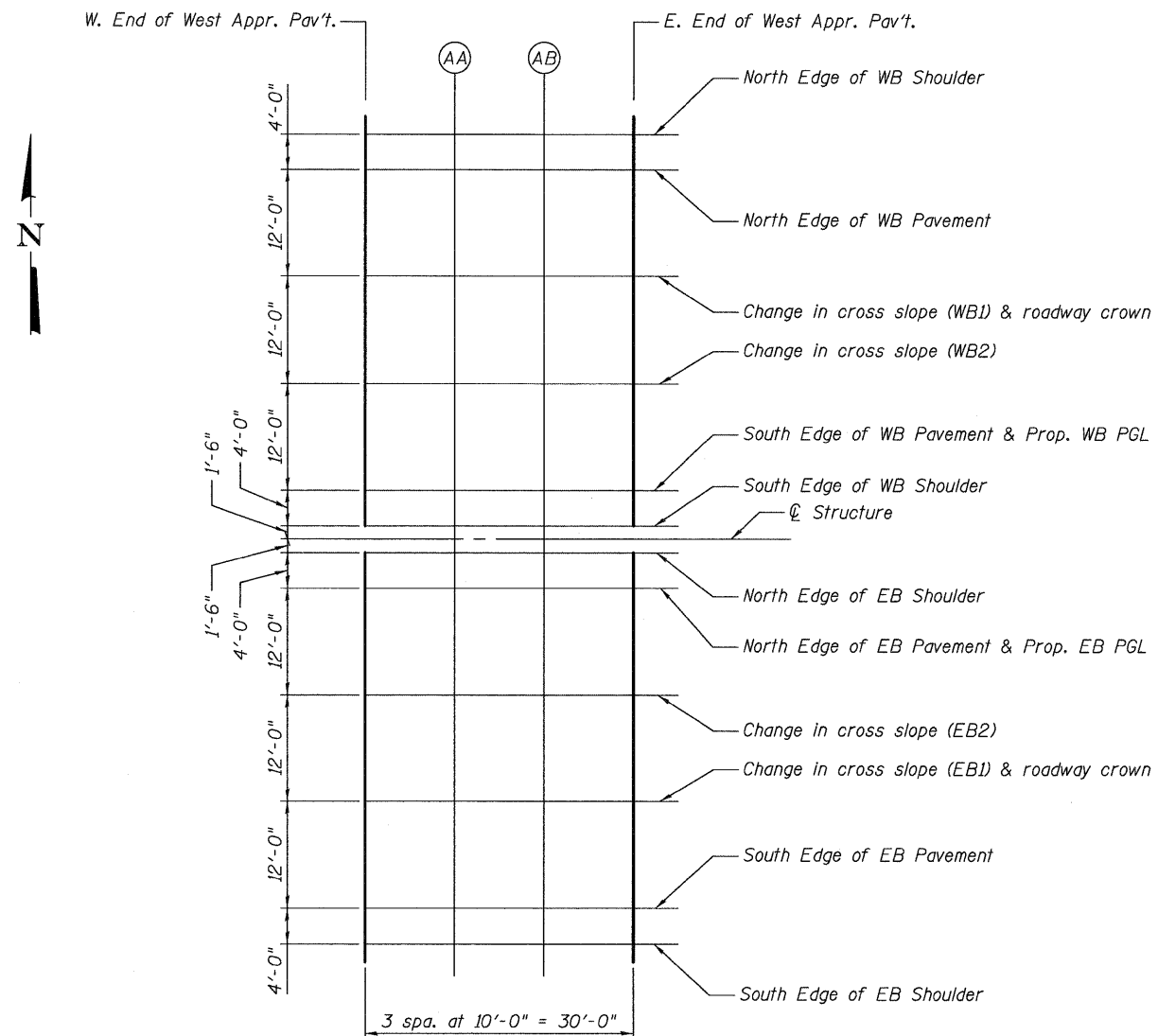

**PLAN**

**SOUTH EDGE OF WB PAVEMENT & PROP. WB PGL**

| Location               | Station    | Offset | Theoretical Grade Elevations |
|------------------------|------------|--------|------------------------------|
| W. END W. APPR. PAV'T. | 1191+72.50 | -5.50  | 476.43                       |
| AA                     | 1191+82.50 | -5.50  | 476.72                       |
| AB                     | 1191+92.50 | -5.50  | 477.02                       |
| E. END W. APPR. PAV'T. | 1192+02.50 | -5.50  | 477.31                       |

**SOUTH EDGE OF WB SHOULDER**

| Location               | Station    | Offset | Theoretical Grade Elevations |
|------------------------|------------|--------|------------------------------|
| W. END W. APPR. PAV'T. | 1191+72.50 | -1.50  | 476.34                       |
| AA                     | 1191+82.50 | -1.50  | 476.64                       |
| AB                     | 1191+92.50 | -1.50  | 476.93                       |
| E. END W. APPR. PAV'T. | 1192+02.50 | -1.50  | 477.23                       |

**NORTH EDGE OF EB SHOULDER**

| Location               | Station    | Offset | Theoretical Grade Elevations |
|------------------------|------------|--------|------------------------------|
| W. END W. APPR. PAV'T. | 1191+72.50 | 1.50   | 476.34                       |
| AA                     | 1191+82.50 | 1.50   | 476.64                       |
| AB                     | 1191+92.50 | 1.50   | 476.93                       |
| E. END W. APPR. PAV'T. | 1192+02.50 | 1.50   | 477.23                       |

**NORTH EDGE OF EB PAVEMENT & PROP. EB PGL**

| Location               | Station    | Offset | Theoretical Grade Elevations |
|------------------------|------------|--------|------------------------------|
| W. END W. APPR. PAV'T. | 1191+72.50 | 5.50   | 476.43                       |
| AA                     | 1191+82.50 | 5.50   | 476.72                       |
| AB                     | 1191+92.50 | 5.50   | 477.02                       |
| E. END W. APPR. PAV'T. | 1192+02.50 | 5.50   | 477.31                       |

**CHANGE IN CROSS SLOPE (EB2)**

| Location               | Station    | Offset | Theoretical Grade Elevations |
|------------------------|------------|--------|------------------------------|
| W. END W. APPR. PAV'T. | 1191+72.50 | 17.50  | 476.68                       |
| AA                     | 1191+82.50 | 17.50  | 476.97                       |
| AB                     | 1191+92.50 | 17.50  | 477.27                       |
| E. END W. APPR. PAV'T. | 1192+02.50 | 17.50  | 477.56                       |

**CHANGE IN CROSS SLOPE (EB1) & ROADWAY CROWN**

| Location               | Station    | Offset | Theoretical Grade Elevations |
|------------------------|------------|--------|------------------------------|
| W. END W. APPR. PAV'T. | 1191+72.50 | 29.50  | 476.86                       |
| AA                     | 1191+82.50 | 29.50  | 477.16                       |
| AB                     | 1191+92.50 | 29.50  | 477.45                       |
| E. END W. APPR. PAV'T. | 1192+02.50 | 29.50  | 477.75                       |

**SOUTH EDGE OF EB PAVEMENT**

| Location               | Station    | Offset | Theoretical Grade Elevations |
|------------------------|------------|--------|------------------------------|
| W. END W. APPR. PAV'T. | 1191+72.50 | 41.50  | 476.68                       |
| AA                     | 1191+82.50 | 41.50  | 476.97                       |
| AB                     | 1191+92.50 | 41.50  | 477.27                       |
| E. END W. APPR. PAV'T. | 1192+02.50 | 41.50  | 477.56                       |

**SOUTH EDGE OF EB SHOULDER**

| Location               | Station    | Offset | Theoretical Grade Elevations |
|------------------------|------------|--------|------------------------------|
| W. END W. APPR. PAV'T. | 1191+72.50 | 45.50  | 476.59                       |
| AA                     | 1191+82.50 | 45.50  | 476.89                       |
| AB                     | 1191+92.50 | 45.50  | 477.18                       |
| E. END W. APPR. PAV'T. | 1192+02.50 | 45.50  | 477.48                       |

c:\pwworking\homa\d0549104\0600345-76A91-026-TSE.dgn  
jmgus  
3/15/2011 2:13:45 PM



|                                       |                |           |
|---------------------------------------|----------------|-----------|
| USER NAME = jmgus                     | DESIGNED - BWC | REVISED - |
| FILE NAME = 0600345-76A91-026-TSE.DGN | CHECKED - LGP  | REVISED - |
| PLOT SCALE = NONE                     | DRAWN - JM     | REVISED - |
| PLOT DATE = 3/18/2011                 | CHECKED - BSK  | REVISED - |

**STATE OF ILLINOIS  
DEPARTMENT OF TRANSPORTATION**

**TOP OF WEST APPROACH SLAB ELEVATIONS  
STRUCTURE NO. 060-0345**

BRIDGE SHEET NO. 26 OF 133 SHEETS

| F.A.I. RTE.               | SECTION | COUNTY  | TOTAL SHEETS | SHEET NO. |
|---------------------------|---------|---------|--------------|-----------|
| 270                       | 60-1B-1 | MADISON | 712          | 405       |
| <b>CONTRACT NO. 76A91</b> |         |         |              |           |
| ILLINOIS FED. AID PROJECT |         |         |              |           |