

TOP PLAN

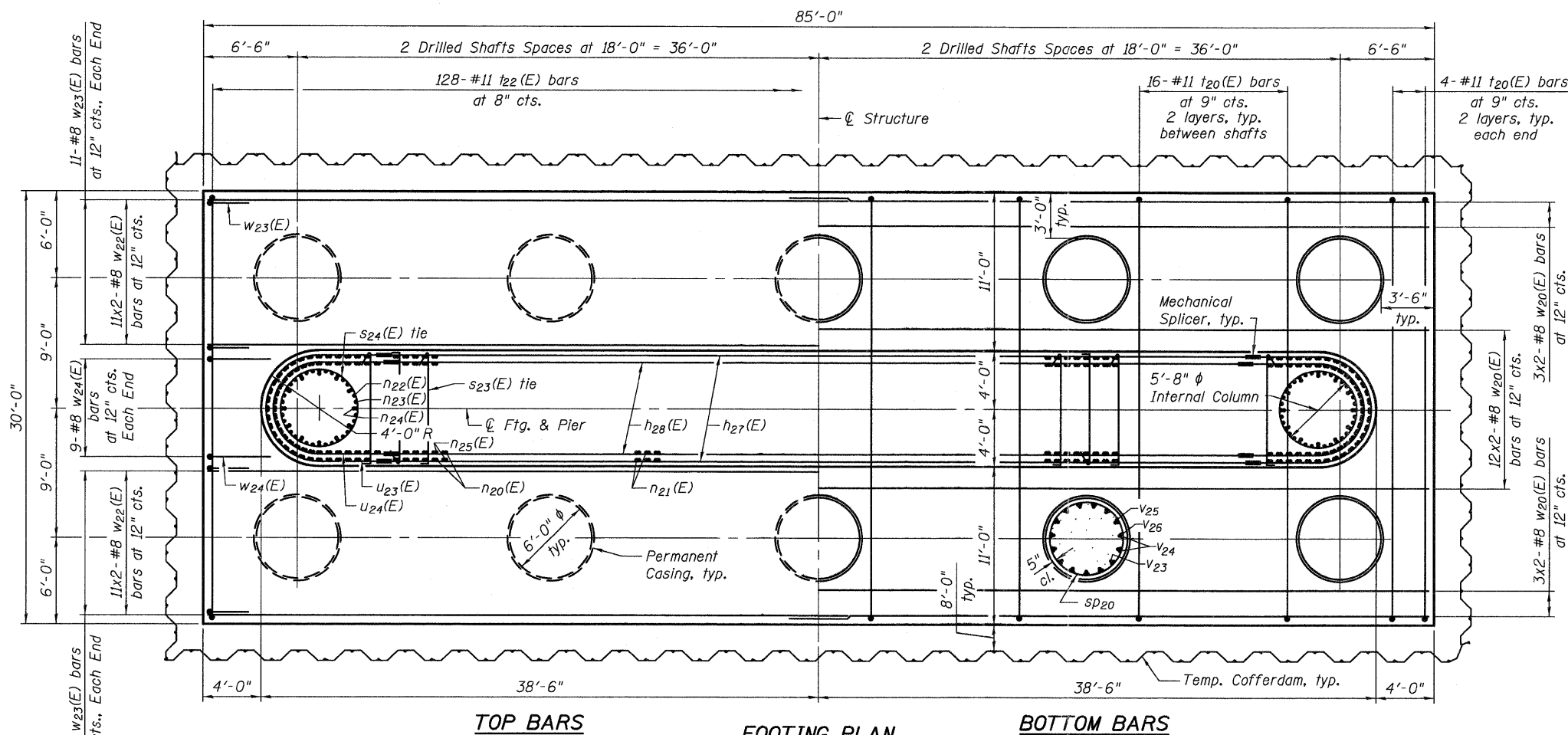

TOP BARS

FOOTING PLAN

BOTTOM BARS

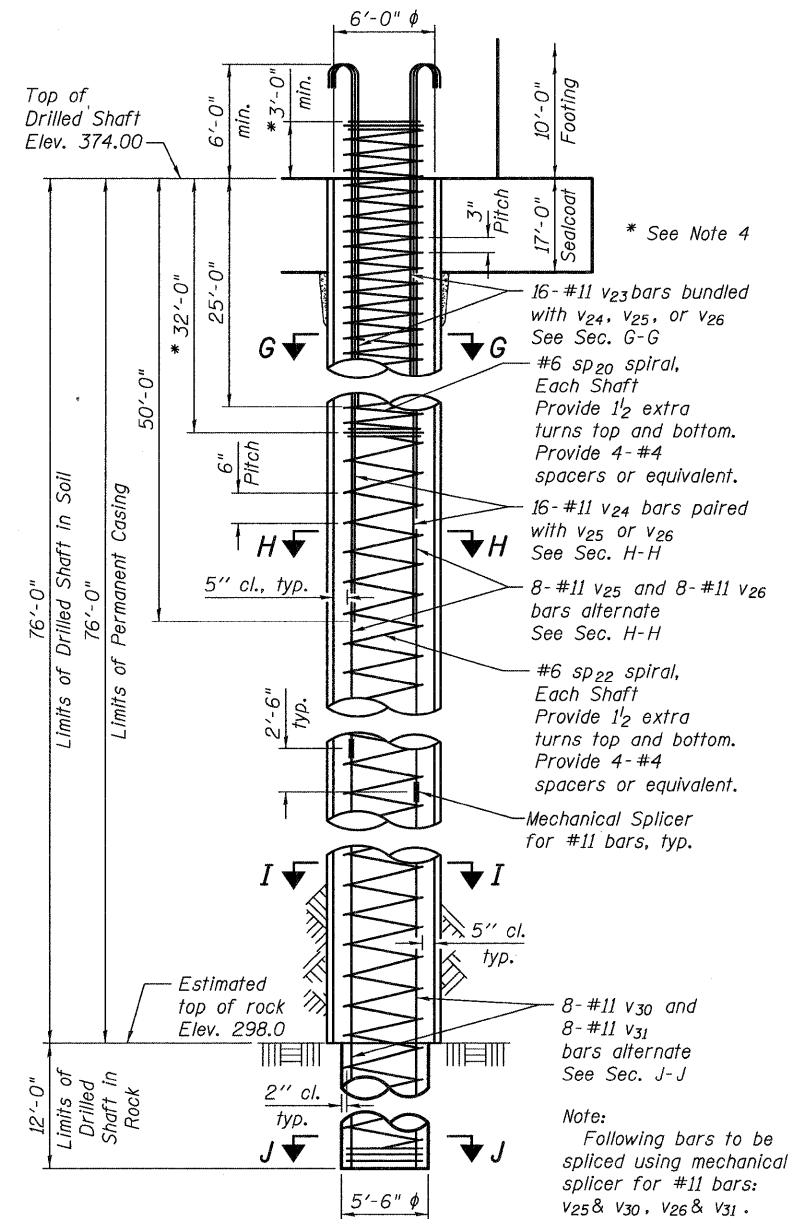

DRILLED SHAFT DETAIL

NOTES:

1. The quantities and reinforcement detailing are based on the elevations shown and may change based on the actual top of rock encountered and final top of shaft elevations.
2. When splicing of spiral reinforcement is necessary, the spirals shall be provided with 1/2 extra turns at the ends to be spliced. These additional turns shall either be welded together according to AWS D1.4, or shall both terminate with a 135° standard hook.
3. The Contractor is responsible for determining the Permanent Casing thickness and the actual tip elevation used per article 5.16.06(d) of the Standard Specifications.
4. Lapping of spiral reinforcement is not permitted within this designated area. Where splicing is necessary, fully-welded or full-mechanical splices are allowed.
5. The Permanent Casing should be advanced into the rock a sufficient distance as needed to achieve an adequate seal for the excavation of the Drilled Shaft in Rock.

c:\pwworking\king\oma\d0549104\0600345-76A91-096-PRD.dgn
jmgus

3/15/2011
2:49:37 PM



USER NAME = jmgus
FILE NAME = 0600345-76A91-096-PRD.DGN
PLOT SCALE = NONE
PLOT DATE = 3/18/2011

DESIGNED - MG
CHECKED - PJM
DRAWN - JM
CHECKED - BSK

REVISED -
REVISED -
REVISED -
REVISED -

STATE OF ILLINOIS
DEPARTMENT OF TRANSPORTATION

PIER 3 - PLANS
STRUCTURE NO. 060-0345

BRIDGE SHEET NO. 96 OF 133 SHEETS

F.A.I. RTE.	SECTION	COUNTY	TOTAL SHEETS	SHEET NO.
270	60-1B-1	MADISON	712	475
				CONTRACT NO. 76A91

ILLINOIS FED. AID PROJECT