

DATE	
BY	
FINAL SURVEY	SURVEYED
NOTE BOOK	PLOTTED
NO.	TEMPLATE
	AREAS CHECKED

DATE	
BY	
ORIGINAL SURVEY	SURVEYED
NOTE BOOK	PLOTTED
NO.	TEMPLATE
	AREAS CHECKED

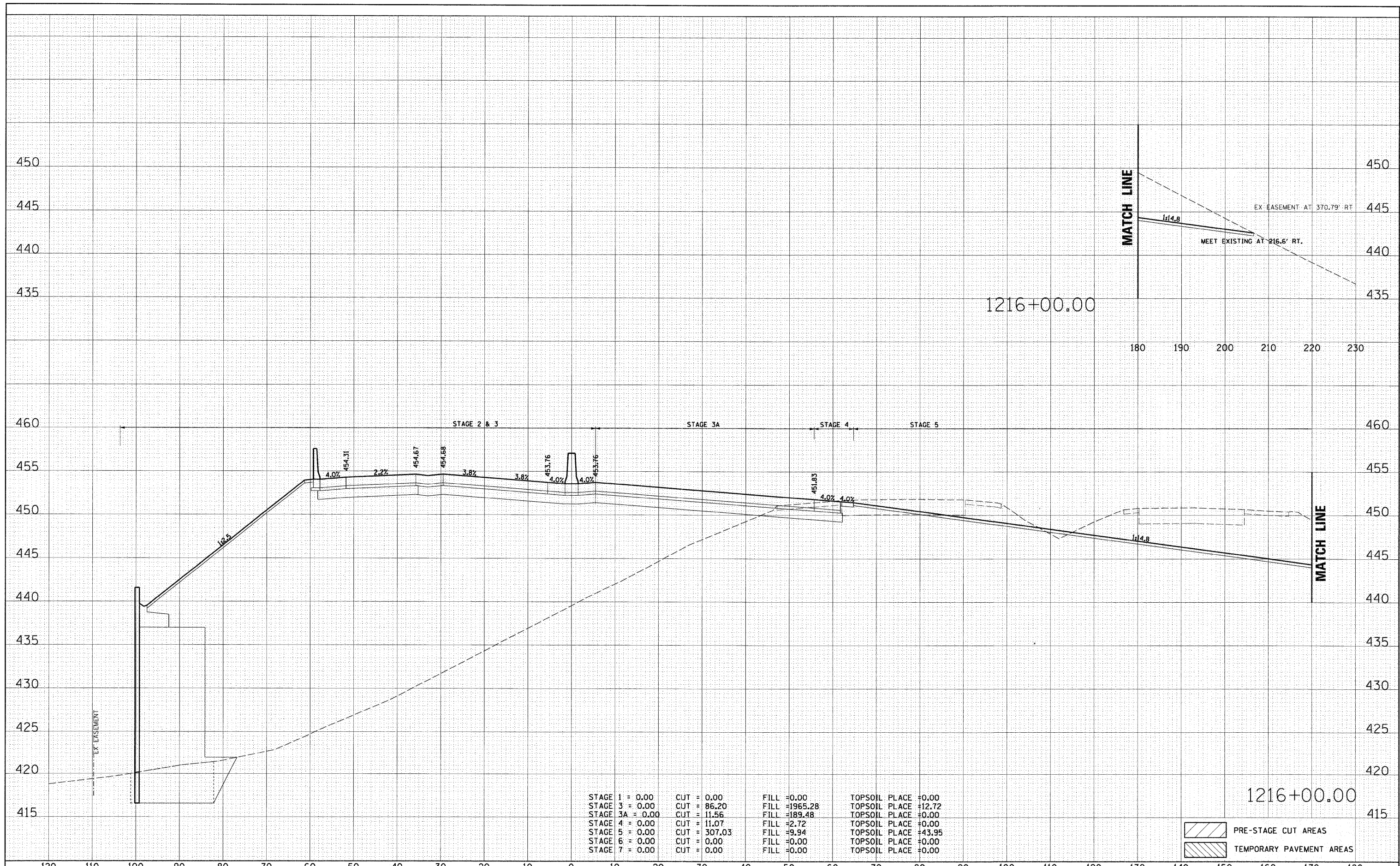

FILE NAME = D:\76091\sh-t-xa-270.dgn

USER NAME = malopez  
 DESIGNED SJM  
 DRAWN BAH  
 CHECKED -  
 PLOT DATE = 3/17/2011

REVISIED -  
 REVISIED -  
 REVISIED -  
 REVISIED -

**STATE OF ILLINOIS  
 DEPARTMENT OF TRANSPORTATION**

**CROSS SECTIONS  
 INTERSTATE I-270**

SCALE: SHEET NO. OF SHEETS STA. 1216+00.00 TO STA. 1216+00.00

F.A.I. RTE.	SECTION	COUNTY	TOTAL SHEETS	SHEET NO.
270	60-1B-1	MADISON	712	591
			CONTRACT NO. 76A91	
ILLINOIS FED. AID PROJECT				