

**EARTHWORK SCHEDULE**

ALIGNMENT	STATION	TO	STATION	EARTH EXCAVATION (SPECIAL) CU YD		
I-70	190+92.60	TO	191+00.00	160		
	191+00.00	TO	191+50.00	1,801		
	191+50.00	TO	192+00.00	1,895		
	192+00.00	TO	192+29.00	1,057		
	192+29.00	TO	192+60.97	889		
	BRIDGE OMISSION					
	193+49.36	TO	193+87.33	1,093		
	193+87.33	TO	194+00.00	484		
	194+00.00	TO	194+15.00	634		
	194+15.00	TO	194+50.00	1,521		
194+50.00	TO	194+75.00	1,092			
194+75.00	TO	195+00.00	1,105			
195+00.00	TO	195+50.00	2,227			
195+50.00	TO	196+00.00	2,248			
196+00.00	TO	196+35.36	1,605			
70E55N	50+25.76	TO	50+50.00	1,105		
	50+50.00	TO	51+00.00	2,343		
	51+00.00	TO	51+50.00	2,430		
	51+50.00	TO	51+65.34	756		
	51+65.34	TO	52+00.00	1,650		
	52+00.00	TO	52+34.14	1,753		
			52+34.14	TO	53+06.36	1,442
<b>TOTALS</b>				29,290		
<b>ROUNDED TOTALS</b>				29,290		

**NOTE:**  
THE EARTH EXCAVATION (SPECIAL) TOTALS IS ROUNDED TO THE NEAREST 5 CU YD.

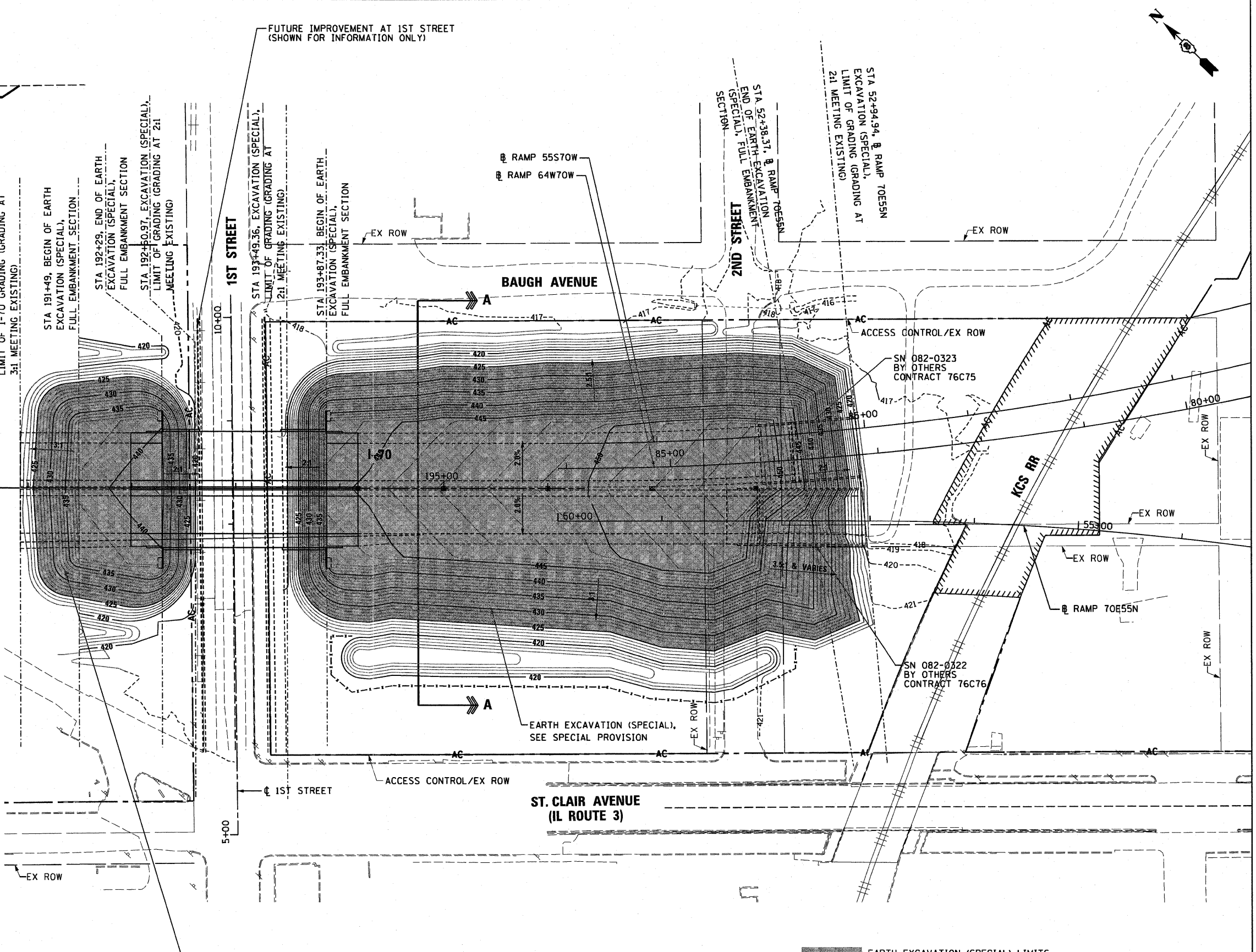

**EARTH EXCAVATION (SPECIAL) LIMITS, ALSO SEE SPECIAL PROVISION**

