

DATE	
BY	
DESIGNED	
CHECKED	
PLOTTED	
TEMPLATE	
AREAS	
CHECKED	
NO.	

DATE	
BY	
DESIGNED	
CHECKED	
PLOTTED	
TEMPLATE	
AREAS	
CHECKED	
NO.	

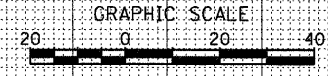
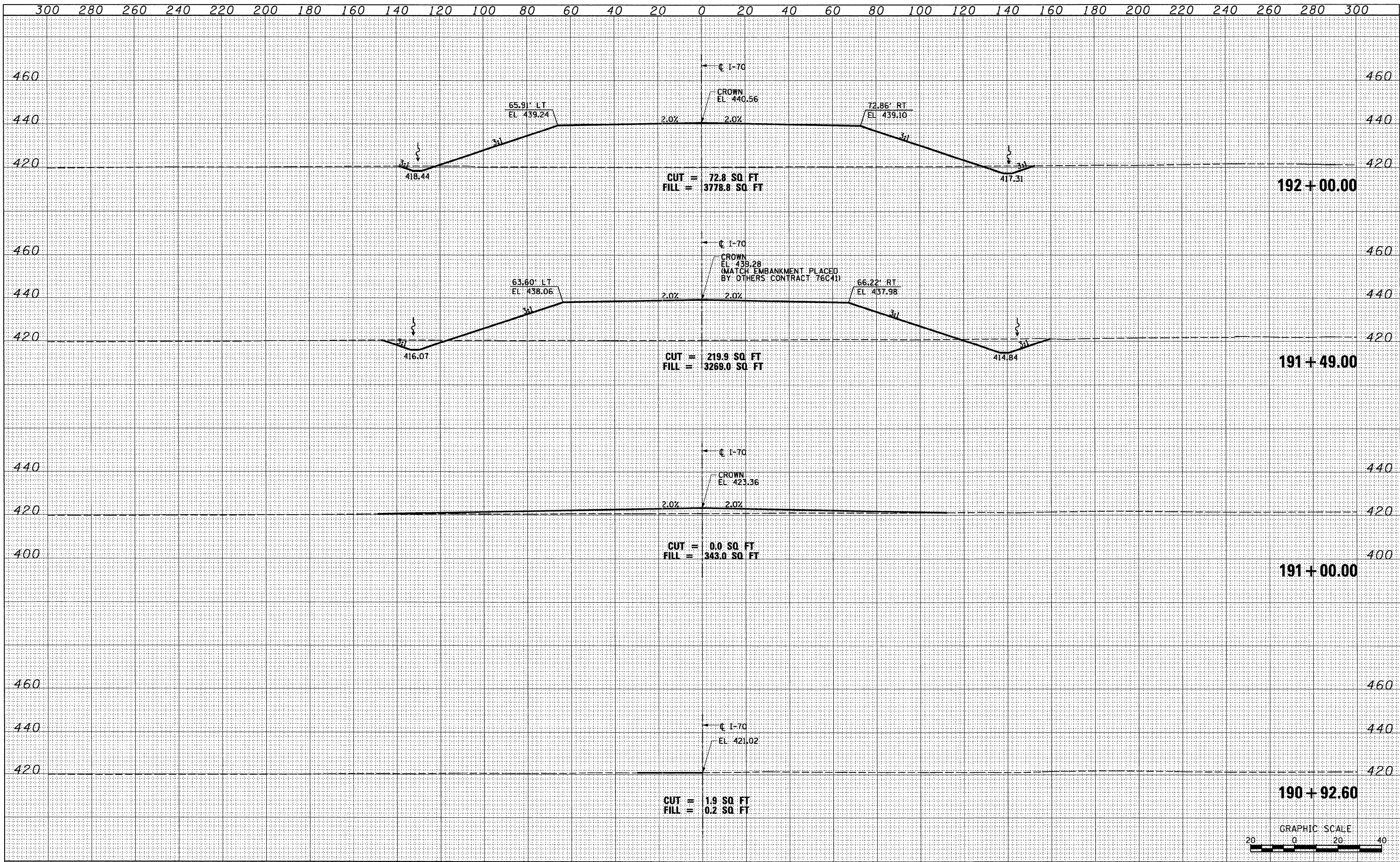

FILE NAME = P:\P60046609\1000_Geopak\76C50\XS-Sheets\08TR	USER NAME = pimserno	DESIGNED OP	REVISED -	STATE OF ILLINOIS DEPARTMENT OF TRANSPORTATION	CROSS SECTIONS - PROPOSED I-70		F.A.P. RTE.	SECTION	COUNTY	TOTAL SHEETS	SHEET NO.
	-76C50-sht.XS_170.dgn	DRAWN OP	REVISED -		SCALE: H: 20 V: 20	SHEET NO. 1 OF 5 SHEETS	998	82-1-2HB	ST. CLAIR	72	64
	PLOT SCALE = 40.0000' / in.	CHECKED DBM	REVISED -		STA. 190+92.60 TO STA. 191+49.00	FED. ROAD DIST. NO. ILLINOIS FED. AID PROJECT		CONTRACT NO. 76C50			
	PLOT DATE = #DATE#	DATE 2-12-10	REVISED -								