

F.A.P. RTE.	SECTION	COUNTY	TOTAL SHEETS	SHEET NO.
327	14, 15RS-1	CLINTON	21	1
		ILLINOIS	CONTRACT NO. 76E10	

STATE OF ILLINOIS  
DEPARTMENT OF TRANSPORTATION  
DIVISION OF HIGHWAYS

**PROPOSED  
HIGHWAY PLANS**

FAP ROUTE 327 (US 50)  
SECTION 14-15RS-1  
PROJECT NHF-0327(051)  
RESURFACING, 3P  
CLINTON COUNTY

C-98-098-10

INDEX OF SHEETS

1. COVER SHEET, PROJECT LIMITS, ADT
2. GENERAL NOTES, STANDARDS, COMMITMENTS
3. SUMMARY OF QUANTITIES
4. LOCATION MAP
- 5.-6. SCHEDULES
7. TYPICAL SECTION
- 8.-12. PLAN VIEW SHEETS
- 13.-17. PAVEMENT MARKING SHEETS
- 18.-21. DETAIL SHEETS

D-98-076-10

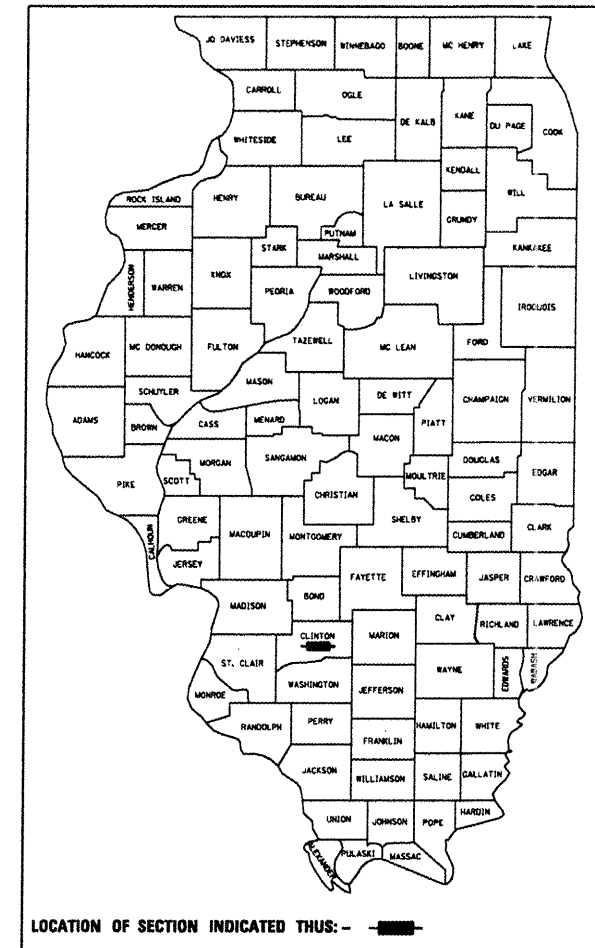

BEGIN PROJECT:  
STA. 3214 + 42.17  
LAT: 38.622729  
LONG: -89.481843

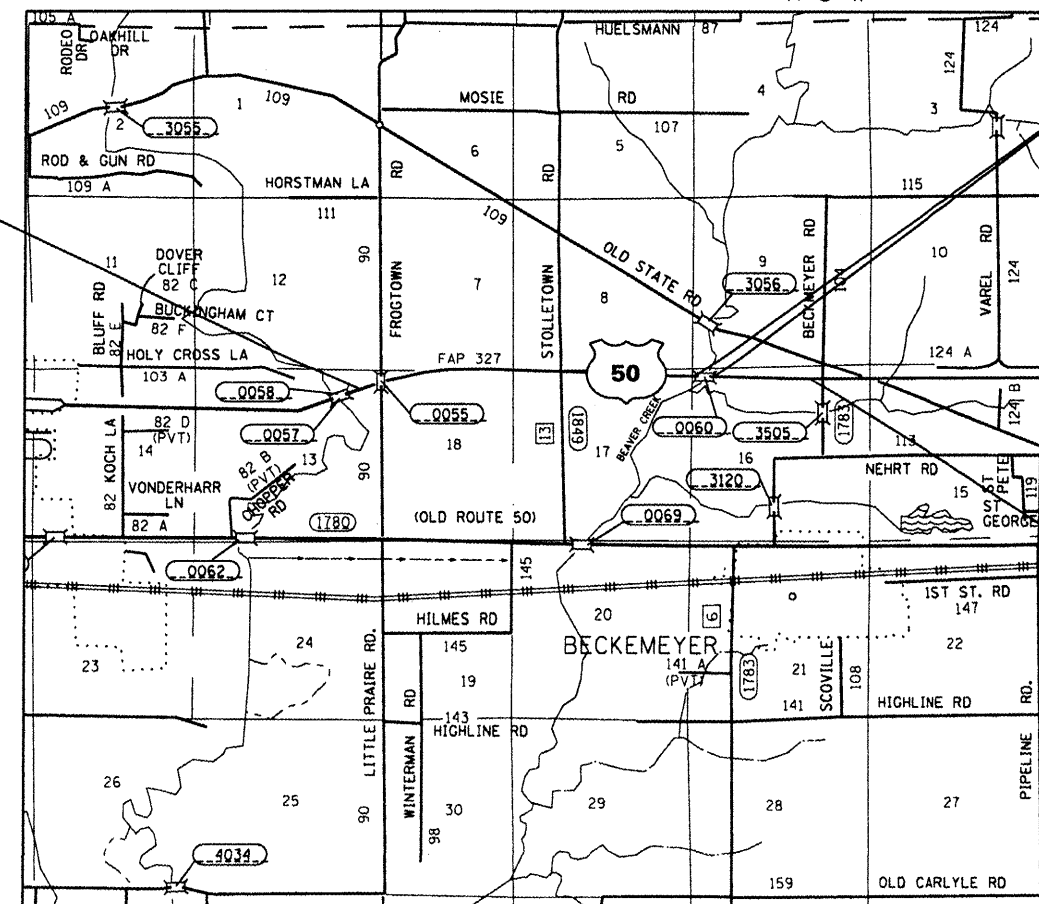

BRIDGE OMISSION:  
STA. 3315 + 89 TO  
STA. 3320 + 35  
446 FT



END PROJECT:  
STA 3341 + 38.42  
LAT: 38.623589  
LONG: -89.437185

TRAFFIC DATA:  
2009 = 5300  
2010 = 5400  
2030 = 6600  
SU = 4.2%  
MU = 10.4%

NOT TO SCALE

GROSS LENGTH = 12,696.25 FT. = 2.4 MILE  
NET LENGTH = 12,250.25 FT. = 2.3 MILE

FUNCTIONAL CLASSIFICATION:  
OTHER PRINCIPAL ARTERIAL

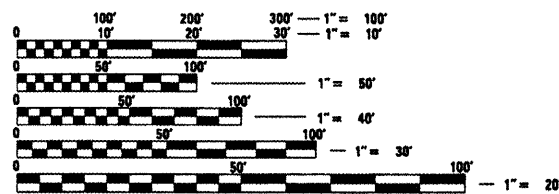

FULL SIZE PLANS HAVE BEEN PREPARED USING STANDARD ENGINEERING SCALES. REDUCED SIZED PLANS WILL NOT CONFORM TO STANDARD SCALES. IN MAKING MEASUREMENTS ON REDUCED PLANS, THE ABOVE SCALES MAY BE USED.

J.U.L.I.E.  
JOINT UTILITY LOCATION INFORMATION FOR EXCAVATION  
1-800-892-0123  
OR 811

PROJECT ENGINEER: PATTI LEBEAU (618)346-3179  
PROJECT MANAGER: CHERYL KEPLAR (618)346-3186

CONTRACT NO. 76E10

STATE OF ILLINOIS  
DEPARTMENT OF TRANSPORTATION  
DIVISION OF HIGHWAYS

SUBMITTED *March 23, 2011*  
*Mary C. Jamie*  
DEPUTY DIRECTOR OF HIGHWAYS, REGION 5 ENGINEER

*May 13, 2011*  
*Scott E. Stitt, P.E.*  
ENGINEER OF DESIGN AND ENVIRONMENT

*May 13, 2011*  
*Christine M. Reed, P.E.*  
DIRECTOR OF HIGHWAYS, CHIEF ENGINEER

PRINTED BY THE AUTHORITY  
OF THE STATE OF ILLINOIS

GENERAL NOTES

1. THE STANDARDS AND REVISION NUMBERS LISTED SHALL APPLY TO THIS PROJECT.

2. ILLINOIS STATE LAW REQUIRES A 48-HOUR NOTICE BE GIVEN TO ALL UTILITIES BEFORE DIGGING. FIELD MARKING OF FACILITIES MAY BE OBTAINED BY CONTACTING J.U.L.I.E. OR FOR NON-MEMBERS, THE UTILITY COMPANY DIRECTLY. AGENCIES KNOWN TO HAVE FACILITIES WITHIN THE PROJECT AREA ARE AS FOLLOWS:

- |  |                |
|--|----------------|
| •AT&T ILLINOIS - COMMUNICATIONS                      | AERIAL, BURIED |
| •CARLYLE NORTH WATER COMPANY - WATER                 | BURIED         |
| •CLINTON COUNTY ELECTRIC COOPERATIVE INC. - ELECTRIC | AERIAL, BURIED |
| •KINDER MORGAN - GAS                                 | BURIED         |

MEMBERS OF J.U.L.I.E. (800) 892-0123 ARE INDICATED BY •. NON-J.U.L.I.E. MEMBERS MUST BE NOTIFIED INDIVIDUALLY.

3. THE CONTRACTOR SHALL VERIFY ALL DIMENSIONS AND CONDITIONS IN THE FIELD PRIOR TO CONSTRUCTION AND ORDERING OF MATERIALS.

4. SHORT TERM PAVEMENT MARKING SHALL BE APPLIED TO THE MILLED, PRIMED, BINDER COURSE AND FINAL SURFACE COURSE. ONLY THE REMOVAL OF THE FINAL SURFACE APPLICATION WILL BE PAID FOR (WORK ZONE PAVEMENT MARKING REMOVAL - SQ. FT). AN AMOUNT OF TEMPORARY PAVEMENT MARKING WHICH EQUALS THE AMOUNT OF PERMANENT PAVEMENT MARKING HAS ALSO BEEN ADDED TO THE PLANS.

5. THE FOLLOWING SUPERPAVE MIXTURE REQUIREMENTS ARE APPLICABLE FOR THIS PROJECT:

MIXTURE USE	SURFACE	BINDER	PATCHING	SHOULDER >2.25"	SHOULDER <2.25"	INCIDENTAL SURF.
AC/PG	PG 64-22	PG 64-22	PG 64-22	PG 64-22	PG 64-22	PG 64-22
RAP % (MAX)	SEE SPEC.	SEE SPEC.	SEE SPEC.	SEE CONTRACT RAP	SEE CONTRACT RAP	SEE SPEC.
DESIGN AIR VOIDS	4.0% @ Ndes=90	4.0% @ Ndes=90	4.0% @ Ndes=90	SPECIAL PROVISION		**4.0% @ Ndes=90
MIX COMPOSITION				**2.0% @ Ndes=30	**2.0% @ Ndes=30	
(GRADATION MIXTURE)	IL 12.5/9.5	IL 19.0	IL 19.0	NMAS 3/4"	NMAS 1/2"	
FRICTION AGG	MIXTURE "D"	MIXTURE "B"	MIXTURE "B"			MIXTURE "D"

\*\*TOP LIFT SHOULDERS - DESIGN THIS MIX AT 2.0% VOIDS AND ADD ASPHALT TO REDUCE VOIDS TO 1.5%

PLAN QUANTITIES FOR HMA (HOT MIX ASPHALT) CONCRETE SURFACE COURSE ITEMS ARE CALCULATED USING A UNIT WEIGHT OF 112 LB/SQ YD/IN.

6. THE THICKNESS OF THE HMA MIXTURE SHOWN ON THE PLANS IS THE NOMINAL THICKNESS. DEVIATIONS FROM THE NOMINAL THICKNESS WILL BE PERMITTED WHEN SUCH DEVIATIONS OCCUR DUE TO IRREGULARITIES IN THE EXISTING SURFACE OR BASE ON WHICH THE HMA MIXTURE IS PLACED.

7. 'ROAD CONSTRUCTION AHEAD' SIGNS SHALL BE PLACED AT EACH END OF THE PROJECT PLUS THE INTERSECTING SIDEROADS, AND WILL BE CONSIDERED INCLUDED IN THE TRAFFIC CONTROL PAY ITEMS. ALL CONSTRUCTION SIGNS SHALL BE FLUORESCENT ORANGE AND 48" X 48".

8. ANY EXCAVATION OR DROP-OFF MORE THAN 3" AT EDGE OF PAVEMENT SHALL BE PROTECTED WITH EXTENDED LEG BARRICADES AND APPROPRIATE LIGHTING.

9. NO OVERNIGHT LANE CLOSURES WILL BE ALLOWED.

10. ALL TEMPORARY PAVEMENT MARKING SHALL BE PLACED IN SUCH A MANNER SO AS NOT TO INTERFERE WITH THE PLACEMENT OF PERMANENT PAVEMENT MARKINGS.

11. THE PAVEMENT MARKING SHOWN IN THE PLANS IS APPROXIMATE. THE LOCATION OF THE PROPOSED PAVEMENT MARKINGS SHOULD MATCH EXISTING FIELD CONDITIONS.

12. ALL LARGE CRACK LINES AND JOINTS IN THE EXISTING PAVEMENT ADJACENT TO THE NEW PATCHES HAVE SAW CUTS TO SCORE THE NEW PATCHES IN THE SAME AREA OF THE CRACK OR JOINT.

13. THE STRIP REFLECTIVE CRACK CONTROL IS TO BE PLACED ON CONCRETE PRIOR TO LEVEL BINDER PERPINDICULAR TO TRAFFIC LANE AT THE INTERSECTION OF STOLLETOWN RD. FROM STATION 3262+00 TO STATION 3283+00, AT THE SEAM OF THE TAPER AND 10 FOOT PAVEMENT AREA SEALED WITH CRACK CONTROL DUE TO EDGE SPALLING. THIS LOCATION IS TO BE CLEAN FREE OF LOOSE DEBRIS FROM ALL FLANGE/CRACK/JOINTS AND FILLED WITH HOT MIX OR SOME TYPE OF SPECIAL MIX.

COMMITMENTS

NO COMMITMENTS

STANDARDS

- 420001-07
- 442101-07
- 630001-09
- 631033-04
- 635006-03
- 635011-02
- 642001-01
- 701011-02
- 701201-04
- 701301-04
- 701306-03
- 701311-03
- 701901-01
- 780001-02
- 781001-03

FILE NAME =	USER NAME = *USER*	DESIGNED - ---	REVISED - ---	<b>STATE OF ILLINOIS DEPARTMENT OF TRANSPORTATION</b>	<b>GENERAL NOTES, COMMITMENTS &amp; STANDARDS</b>	F.A.P. RTE.	SECTION	COUNTY	TOTAL SHEETS	SHEET NO.	
*FILE#*		DRAWN - ---	REVISED - ---			327	19-1585-1	CLINTON	21	2	
	PLOT SCALE = *SCALE*	CHECKED - ---	REVISED - ---			CONTRACT NO. 76E1Q					
	PLOT DATE = *DATE*	DATE - ---	REVISED - ---			FED. ROAD DIST. NO. ILLINOIS FED. AID PROJECT					

# SUMMARY OF QUANTITIES

SUMMARY OF QUANTITIES			TOTAL QUANTITIES	CONSTRUCTION TYPE CODE			SUMMARY OF QUANTITIES			TOTAL QUANTITIES	CONSTRUCTION TYPE CODE		
CODE NO	ITEM	UNIT		0005 80%_EED 20%_STATE	-----	-----	CODE NO	ITEM	UNIT		0005 80%_EED 20%_STATE	-----	-----
20201200	REMOVAL AND DISPOSAL OF UNSUITABLE MATERIAL	CU YD	1.8	1.8		70100450	TRAFFIC CONTROL AND PROTECTION, STANDARD 701201	L SUM	1				
40600200	BITUMINOUS MATERIALS (PRIME COAT)	TON	13.2	13.2		70100460	TRAFFIC CONTROL AND PROTECTION, STANDARD 701306	L SUM	1				
40600300	AGGREGATE (PRIME COAT)	TON	64	64		70300100	SHORT TERM PAVEMENT MARKING	FOOT	27684	27684			
40600895	CONSTRUCTING TEST STRIP	EACH	1	1		70300210	TEMPORARY PAVEMENT MARKING LETTERS AND SYMBOLS	SO FT	62.4	62.4			
40600985	PORTLAND CEMENT CONCRETE SURFACE REMOVAL - BUTT JOINT	SQ YD	3000	3000		70300220	TEMPORARY PAVEMENT MARKING - LINE 4"	FOOT	36021	36021			
40600990	TEMPORARY RAMP	SQ YD	150	150		70300260	TEMPORARY PAVEMENT MARKING - LINE 12"	FOOT	351	351			
40603090	HOT-MIX ASPHALT BINDER COURSE, IL-19.0, N90	TON	5329	5329		70300280	TEMPORARY PAVEMENT MARKING- LINE 24"	FOOT	46	46			
40603345	HOT-MIX ASPHALT SURFACE COURSE, MIX "D", N90	TON	3553	3553		70301000	WORK ZONE PAVEMENT MARKING REMOVAL	SO FT	3076	3076			
40800020	BITUMINOUS MATERIALS (PRIME COAT)	TON	1	1		*78000100	THERMOPLASTIC PAVEMENT MARKING - LETTERS AND SYMBOLS	SO FT	62.4	62.4			
40800030	AGGREGATE (PRIME COAT)	TON	3	3		*78000200	THERMOPLASTIC PAVEMENT MARKING - LINE 4"	FOOT	36021	36021			
40800050	INCIDENTAL HOT-MIX ASPHALT SURFACING	TON	67	67		*78000600	THERMOPLASTIC PAVEMENT MARKING - LINE 12"	FOOT	351	351			
44004250	PAVED SHOULDER REMOVAL	SQ YD	5.3	5.3		*78000650	THERMOPLASTIC PAVEMENT MARKING - LINE 24"	FOOT	46	46			
44201000	CLASS B PATCHES, TYPE IV, 12 INCH	SQ YD	149	149		*78100100	RAISED REFLECTIVE PAVEMENT MARKER	EACH	240	240			
44201294	CLASS B PATCH - EXPANSION JOINT	FOOT	170	170		*78200410	GUARDRAIL MARKERS, TYPE A	EACH	16	16			
44201296	DEFORMED BARS - EXPANSION JOINT	EACH	110	110		*78201000	TERMINAL MARKER - DIRECT APPLIED	EACH	4	4			
44201297	DOWEL BARS 1"	EACH	25	25		78300200	RAISED REFLECTIVE PAVEMENT MARKER REMOVAL	EACH	240	240			
44213200	SAW CUTS	FOOT	849	849		X4421021	CLASS B PATCHES, TYPE IV, 12 INCH, SPECIAL	SQ YD	138	138			
44213202	TIE BARS 1"	EACH	410	410		20076600	TRAINEES	HOUR	500	500			
44300200	STRIP REFLECTIVE CRACK CONTROL TREATMENT	FOOT	2100	2100									
48102100	AGGREGATE WEDGE SHOULDER, TYPE B	TON	353	353									
48203100	HOT-MIX ASPHALT SHOULDERS	TON	4708	4708									
48300300	PORTLAND CEMENT CONCRETE SHOULDERS 8"	SQ YD	5.3	5.3									
50300225	CONCRETE STRUCTURES	CU YD	1.4	1.4									
50800205	REINFORCEMENT BARS, EPOXY COATED	POUND	291	291									
60100080	FRENCH DRAINS	CU YD	1.8	1.8									
60100085	GEOTECHNICAL FABRIC FOR FRENCH DRAINS	SQ YD	5.3	5.3									
*63000001	STEEL PLATE BEAM GUARD RAIL, TYPE A, 6 FOOT POSTS	FOOT	1104	1104									
*63100089	TRAFFIC BARRIER TERMINAL, TYPE 6B	EACH	4	4									
*63100167	TRAFFIC BARRIER TERMINAL, TYPE 1 (SPECIAL) TANGENT	EACH	4	4									
63200310	GUARDRAIL REMOVAL	FOOT	1100	1100									
64200105	SHOULDER RUMBLE STRIPS	FOOT	25216	25216									
67000400	ENGINEER'S FIELD OFFICE, TYPE A	CAL MO	4	4									
67100100	MOBILIZATION	L SUM	1	1									

\*SPECIALTY ITEM ■ 0042

FILE NAME =	USER NAME = #USER#	DESIGNED - ---	REVISED - ---	<b>STATE OF ILLINOIS DEPARTMENT OF TRANSPORTATION</b>	<b>SUMMARY OF QUANTITIES</b>	F.A.P. RTE. 327	SECTION 14, 15B5-1	COUNTY CLINTON	TOTAL SHEETS 21	SHEET NO. 3	
#FILE#	PLOT SCALE = #SCALE#	CHECKED - ---	REVISED - ---	SCALE: _____	SHEET NO. ___ OF ___ SHEETS	STA. _____	TO STA. _____	CONTRACT NO. 76E10			
	PLOT DATE = #DATE#	DATE - -----	REVISED - ---	FED. ROAD DIST. NO. _____		ILLINOIS FED. AID PROJECT					

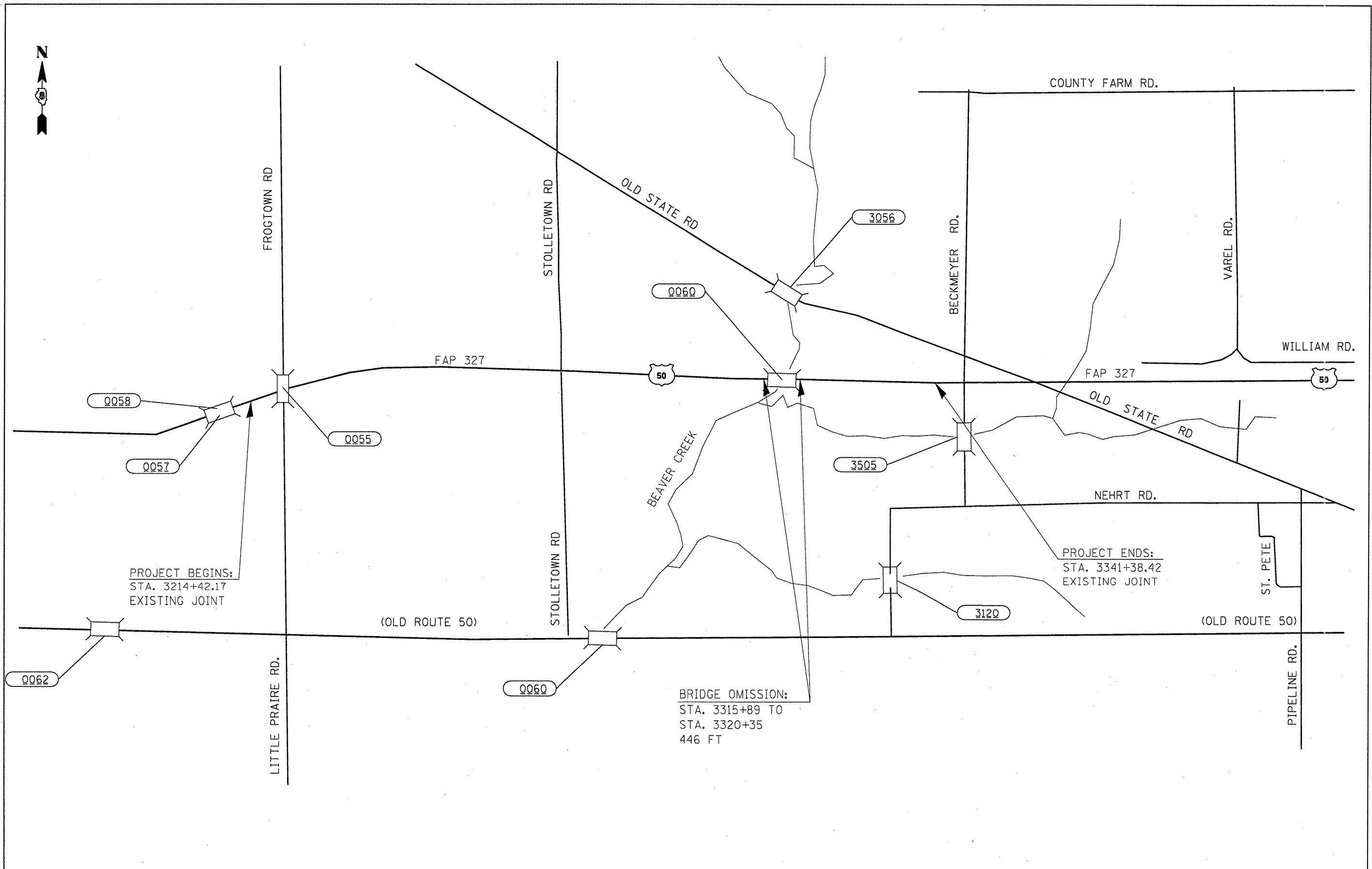

FILE NAME =	USER NAME = #USER#	DESIGNED - ---	REVISED - ---
#FILE#		DRAWN - ---	REVISED - ---
	PLOT SCALE = #SCALE#	CHECKED - ---	REVISED - ---
	PLOT DATE = #DATE#	DATE - ---	REVISED - ---

**STATE OF ILLINOIS  
DEPARTMENT OF TRANSPORTATION**

**LOCATION MAP**

SCALE: \_\_\_\_\_ SHEET NO. \_\_\_ OF \_\_\_ SHEETS STA. \_\_\_\_\_ TO STA. \_\_\_\_\_

F.A.P. RTE.	SECTION	COUNTY	TOTAL SHEETS	SHEET NO.
327	19..1585-1	CLINION	-21-	4
FED. ROAD DIST. NO. _____ ILLINOIS FED. AID PROJECT			CONTRACT NO. 76E1Q	

PAVEMENT MARKINGS SCHEDULE													
STATION	TO	STATION	LENGTH	LINE 24"	LINE 12"	LETTER AND SYMBOLS/TURN ARROWS	4"			RAISED REFLECTIVE PAVEMENT MARKERS			
							YELLOW		WHITE	TWO-WAY AMBER	ONE-WAY AMBER	ONE-WAY CRYSTAL	REMOVAL
							LANE LINE	SKIP-DASH CENTERLINE	EDGE LINE				
							(FT)	(FT)	(FT)				
3262+70.00	TO	3269+72.00	702		167.6								
3274+20.00	TO	3281+51.00	731		182.8								
3214+42.17	TO	3341+38.42	12696					25393					
3270+17.30	TO	3271+71.30	154					154					
3272+58.40	TO	3273+84.40	126					126					
3262+70.00	TO	3269+72.00	702				2808						
3269+72.00	TO	3271+72.00	200				400						
3272+58.00	TO	3274+20.00	162				324						
3274+20.00	TO	3281+51.00	731				2924						
3214+42.00	TO	3262+70.00	4828						60			60	
3269+69.00	TO	3271+71.00	202						5			5	
3272+58.00	TO	3274+20.00	162						5			5	
3281+51.00	TO	3341+38.00	5987						75			75	
3262+70.00	TO	3269+72.00	702							35		35	
3274+20.00	TO	3281+51.00	1031							52		52	
3270+17.00	TO	3271+71.00	154								4	4	
3272+58.00	TO	3273+84.00	126								4	4	
		3270+42.06				15.6							
		3271+32.50				15.6							
		3272+83.50				15.6							
		3273+54.28				15.6							
		NO PASSING											
3257+93.00	TO	3262+70.00	477				477						
3281+84.00	TO	3287+53.00	569				569						
3214+42.00	TO	3262+70.00	4828					1207					
3281+51.00	TO	3341+38.00	5987					1497					
		STOLLETOWN RD.											
19+57.00	TO	21+00.00	143					143					
		19+57.00		23									
		19+44.00		23									
		SUB TOTAL:		46	351	62.4	7502	2704	25816	145	87	8	
		TOTAL:		46	351	62.4		36021			240		240

FILE NAME *	USER NAME = #USER#	DESIGNED - ---	REVISED - ---	<b>STATE OF ILLINOIS DEPARTMENT OF TRANSPORTATION</b>	<b>SCHEDULES</b>	F.A.P. RTE.	SECTION	COUNTY	TOTAL SHEETS	SHEET NO.	
#FILE#		DRAWN - ---	REVISED - ---			327	14.1985-1	CLINION	21	9	
	PLOT SCALE = #SCALE#	CHECKED - ---	REVISED - ---			SCALE: _____ SHEET NO. ___ OF ___ SHEETS STA. _____ TO STA. _____		CONTRACT NO. 76E10			
	PLOT DATE = #DATE#	DATE - -----	REVISED - ---			FED. ROAD DIST. NO.   ILLINOIS FED. AID PROJECT					

RESURFACING SCHEDULE										
STA.	TO	STA.	WIDTH	LENGTH	HMA SURF CRSE	HMA BINDER	BITUMINOUS	AGGREGATE	HMA	AGGREGATE
					MIX D, N90	COURSE, IL 19.0, N90	MATERIAL (PRIME COAT)	(PRIME COAT)	SHOULDERS	WEDGE SHOULDER
					TON	TON	TON	TON	TON	TON
3214+42	TO	3261+00	24	4658	1043.4	1565	3.9	18.6		
3261+00	TO	3284+00	57	2300	1223.6	1836	4.6	21.9		
3284+00	TO	3341+38	24	5738	1285.3	1928	4.8	23.0		
3214+42	TO	3271+78	8	5736					2142	
3272+66	TO	3341+38	8	6872					2566	
3214+42	TO	3271+78	2	5736						161
3272+66	TO	3341+38	2	6872						192
TOTAL:					3553	5329	13.2	64	4708	353

PATCHING SCHEDULE										
STA	TO	STA	LENGTH	DOWEL BARS	TIE BARS	DEFORMED BARS	CLASS B PATCH	CLASS B PATCH,	SAW CUTS	STRIP REFLECTIVE
			FOOT	EACH	EACH	EXPANSION JOINT	EXPANSION JOINT	TYPE IV, 12"	FOOT	FOOT
3273+78	TO	3275+12	134	18	266	72	89	149	288	
3280+07	TO	3282+83	276	7	550	81	81	138	561	
3262+00	TO	3283+00	2100							2100
TOTAL:				25	816	153	170	287	849	2100

SIDEROAD/BUTT JOINT SCHEDULE							
SIDEROAD/STA.	L/R	WIDTH	INCIDENTAL HMA	(40800020) BIT.	(40800030)	TEMPORARY	P.C.C. BUTT
		(FOOT)	(TON)	MAT. PRIME COAT	AGG. PRIME COAT	RAMPS	JOINTS
3214+42.17		40	13.1	0.15	0.67	22.2	444.4
STOLLETOWN RD.	L	25	5.1	0.15	0.13	13.9	277.8
STOLLETOWN RD.	R	85	9.1	0.15	0.17	47.2	944.4
3315+14.54		40	13.1	0.15	0.67	22.2	444.4
3321+26.85		40	13.1	0.15	0.67	22.2	444.4
3341+38.42		40	13.1	0.15	0.67	22.2	444.4
TOTAL:			67	1	3	150	3000

PATCHING SCHEDULE											
STA	TO	STA.	LENGTH	DOWEL BARS	TIE BARS	DEFORMED BARS	CLASS B PATCH	CLASS B PATCH,	CLASS B PATCH,	SAW CUTS	STRIP REFLECTIVE
			FOOT	EACH	EACH	EXPANSION JOINT	EXPANSION JOINT	TYPE IV, 12"	TYPE IV, 12" SPECIAL	FOOT	FOOT
3273+78	TO	3275+12	134	18	134	56	89	149		288	
3280+07	TO	3282+83	276	7	276	54	81	138		561	
3262+00	TO	3283+00	2100								2100
TOTAL:				25	410	110	170	149	138	849	2100

GUARDRAIL SCHEDULE									
STA.	TO	STA.	SIDE	STEEL PLATE	TRAFFIC BARRIER	GUARDRAIL	TERMINAL	GUARDRAIL	TRAFFIC BARRIER
				BEAM GUARDRAIL, TYPE A, 6 FOOT POSTS	TERMINAL, TYPE I, (SPECIAL) TANGENT		MARKERS, DIRECT APPLIED		REMOVAL
				(FOOT)	(EACH)	(EACH)	(EACH)	(FOOT)	(EACH)
3312+90	TO	3316+15	R	240		4		325	1
3313+90	TO	3316+15	L	144		4		225	1
3320+27	TO	3323+27	L	216		4		300	1
3320+27	TO	3322+77	R	168		4		250	1
3312+90			R		1		1		
3313+90			L		1		1		
3323+27			L		1		1		
3322+77			R		1		1		
TOTAL:				768	4	16	4	1100	4

FILE NAME =	USER NAME = #USER#	DESIGNED - ---	REVISED - ---
#FILE#		DRAWN - ---	REVISED - ---
	PLOT SCALE = #SCALE#	CHECKED - ---	REVISED - ---
	PLOT DATE = #DATE#	DATE - -----	REVISED - ---

STATE OF ILLINOIS  
DEPARTMENT OF TRANSPORTATION

SCHEDULES

SCALE: -----	SHEET NO. ___ OF ___ SHEETS	STA. _____ TO STA. _____	F.A.P. RTE. 327	SECTION 14-1585-1	COUNTY CLINTON	TOTAL SHEETS 21	SHEET NO. 6
			FED. ROAD DIST. NO. _____ ILLINOIS FED. AID PROJECT				
			CONTRACT NO. 76E1Q				

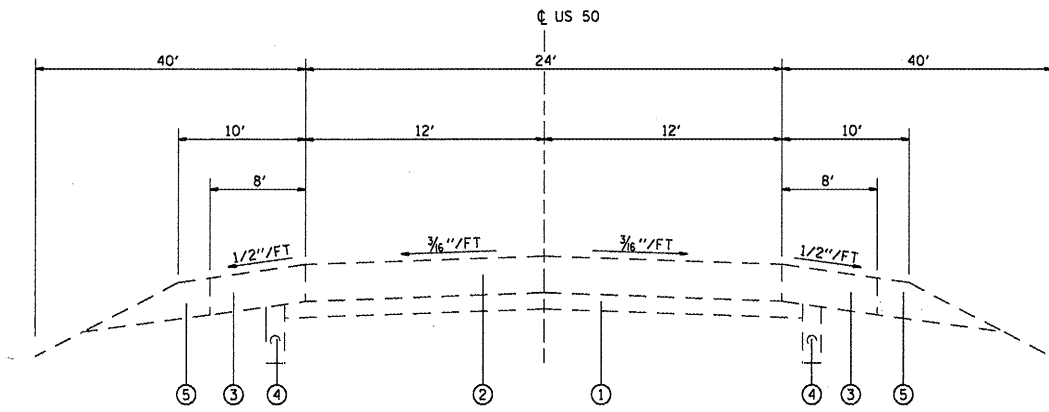

**EXISTING TYPICAL SECTION**  
 STA. 3214+42.17 TO STA. 3230+56.57  
 STA. 3249+22.72 TO STA. 3262+00.17  
 STA. 3283+00.15 TO STA. 3341+38.42

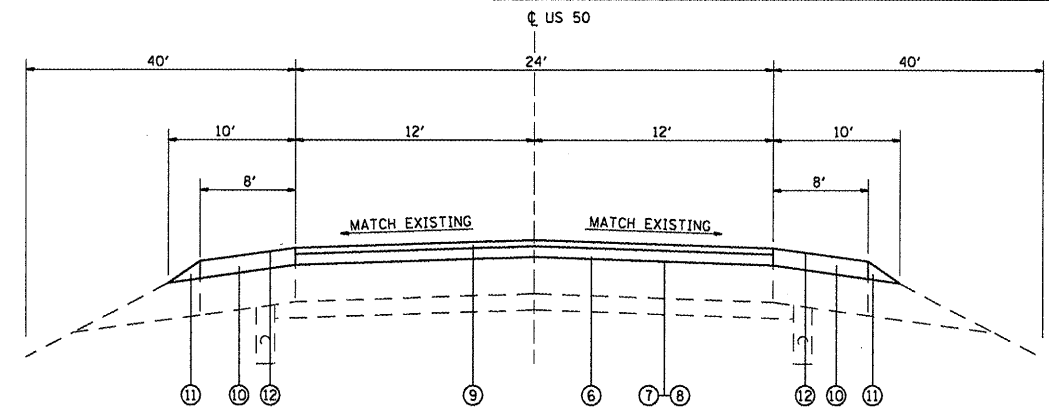

**PROPOSED TYPICAL SECTION**  
 STA. 3214+42.17 TO STA. 3230+56.57  
 STA. 3249+22.72 TO STA. 3262+00.17  
 STA. 3283+00.15 TO STA. 3341+38.42

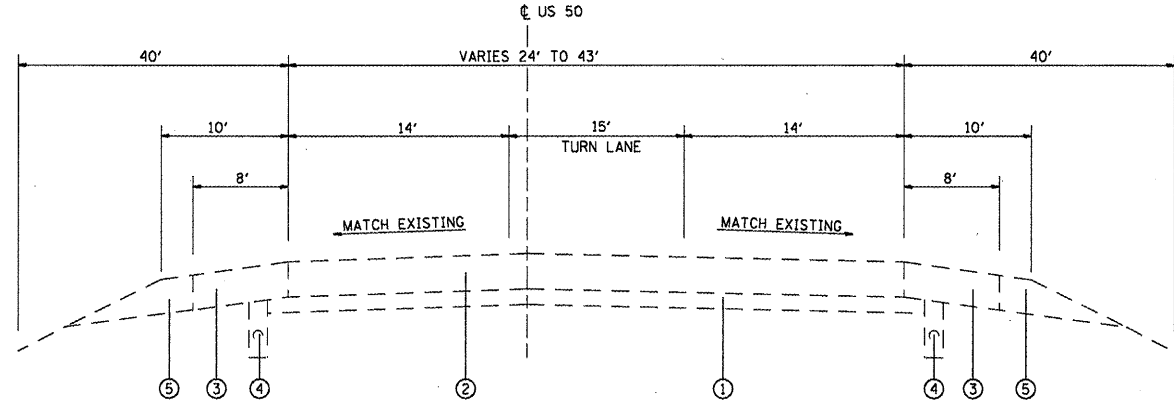

**EXISTING TYPICAL SECTION**  
 STA. 3262+00.17 TO STA. 3283+00.15

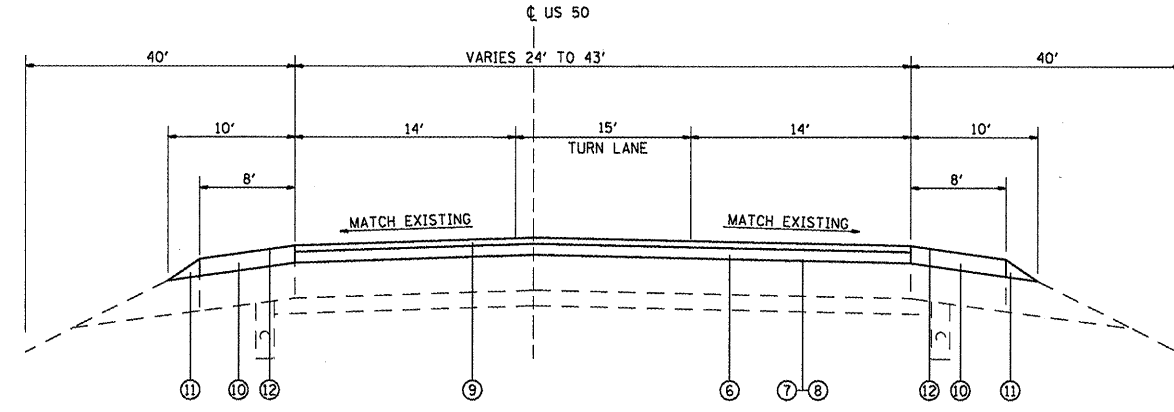

**PROPOSED TYPICAL SECTION**  
 STA. 3262+00.17 TO STA. 3283+00.15

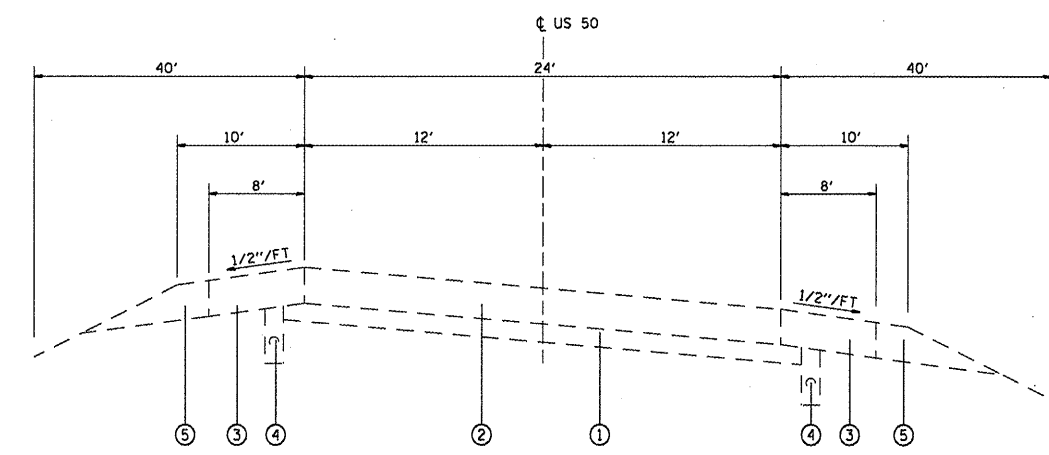

**EXISTING SUPERELEVATED SECTION**  
 STA. 3230+56.57 TO STA. 3249+22.72

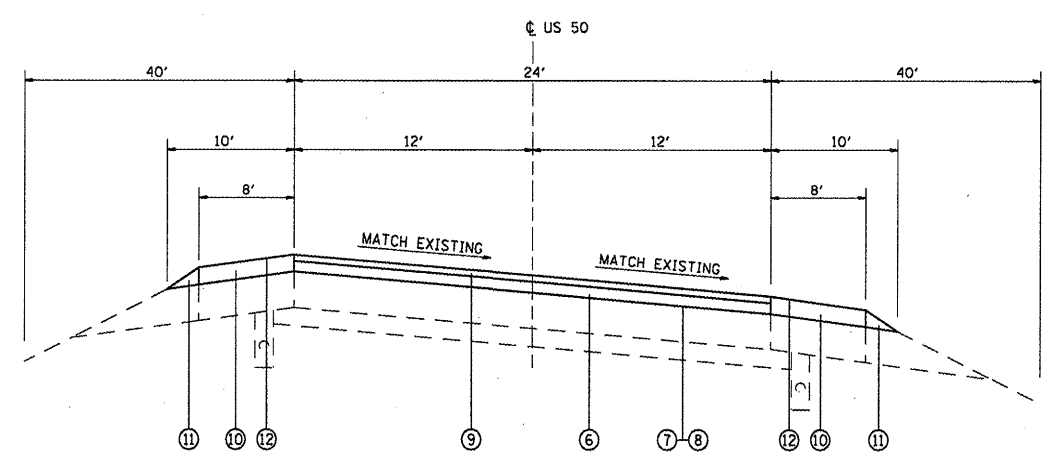

**PROPOSED SUPERELEVATED SECTION**  
 STA. 3230+56.57 TO STA. 3249+22.72

**LEGEND**

- ① EXISTING STABILIZED SUB-BASE 4"
- ② EXISTING PORTLAND CEMENT PAVEMENT 8"
- ③ EXISTING BITUMINOUS SHOULDERS 8"
- ④ EXISTING PIPE DRAINS, 4"
- ⑤ EXISTING AGGREGATE SHOULDERS, TYPE B
- ⑥ PROPOSED HMA BINDER COURSE, IL 19.0, N90, 2 1/4"
- ⑦ PROPOSED AGGREGATE PRIME COAT
- ⑧ PROPOSED BITUMINOUS PRIME COAT
- ⑨ PROPOSED HMA SURFACE COURSE, MIX "D", N90, 1 1/2"
- ⑩ PROPOSED HMA SHOULDER, 3 3/4"
- ⑪ PROPOSED AGGREGATE SHOULDER WEDGE
- ⑫ PROPOSED SHOULDER RUMBLE STRIP

FILE NAME =	USER NAME = #USER#	DESIGNED -	REVISIONS -
#FILE#		DRAWN -	REVISIONS -
	PLOT SCALE = #SCALE#	CHECKED -	REVISIONS -
	PLOT DATE = #DATE#	DATE -	REVISIONS -

**STATE OF ILLINOIS  
 DEPARTMENT OF TRANSPORTATION**

<b>TYPICAL SECTION</b>	
SCALE: _____	SHEET NO. ___ OF ___ SHEETS
STA. _____ TO STA. _____	

F.A.P. RTE.	SECTION	COUNTY	TOTAL SHEETS	SHEET NO.
327	14..1585:1	CLINTON	21	7
FED. ROAD DIST. NO. _____ (ILLINOIS) FED. AID PROJECT			CONTRACT NO. 76E1Q	



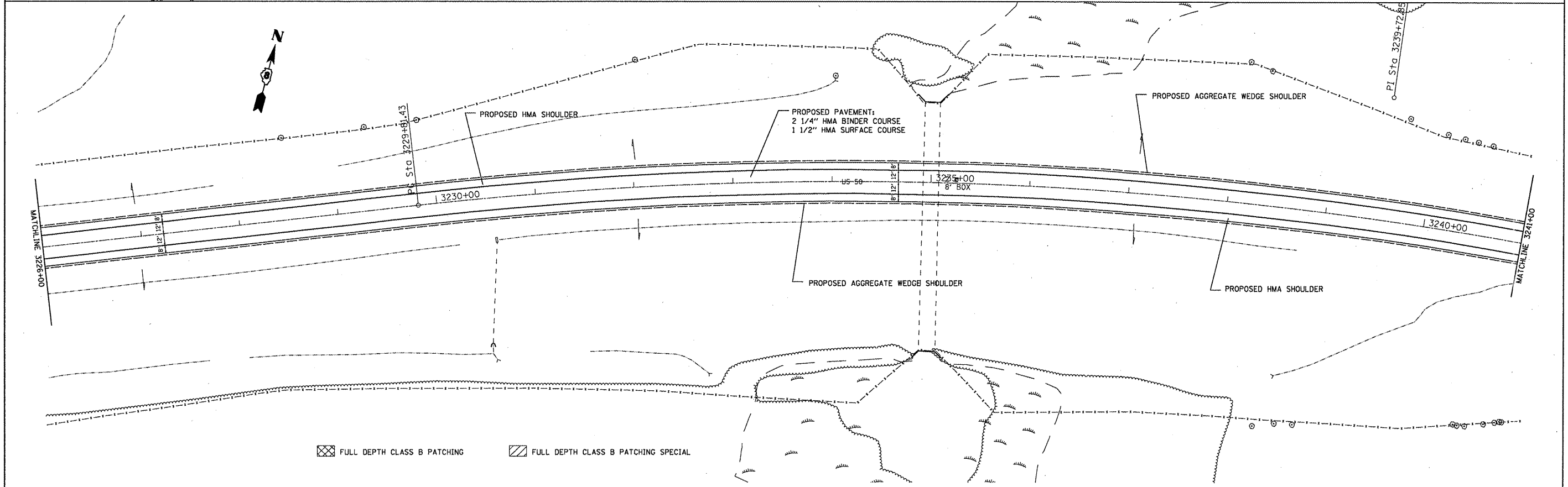
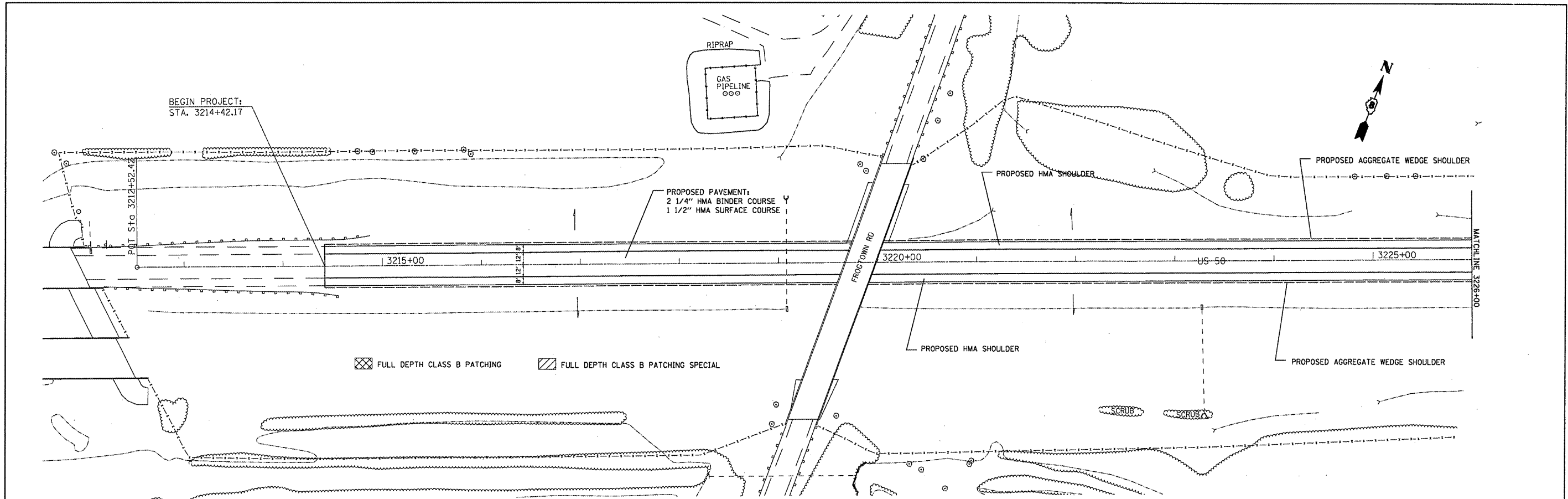

FILE NAME =	USER NAME = #USER#	DESIGNED - ---	REVISED - ---	<b>STATE OF ILLINOIS DEPARTMENT OF TRANSPORTATION</b>	<b>PLAN VIEW</b>	F.A.P. RTE.	SECTION	COUNTY	TOTAL SHEETS	SHEET NO.
#FILE#		DRAWN - ---	REVISED - ---			-327	14-1585-1	CLINTON	21	8
		CHECKED - ---	REVISED - ---			SCALE: 20		SHEET NO. 1 OF 5 SHEETS		STA. 3212+50 TO STA. 3241+00
		PLOT DATE = #DATE#	DATE - ---			FED. ROAD DIST. NO. - ILLINOIS FED. AID PROJECT				



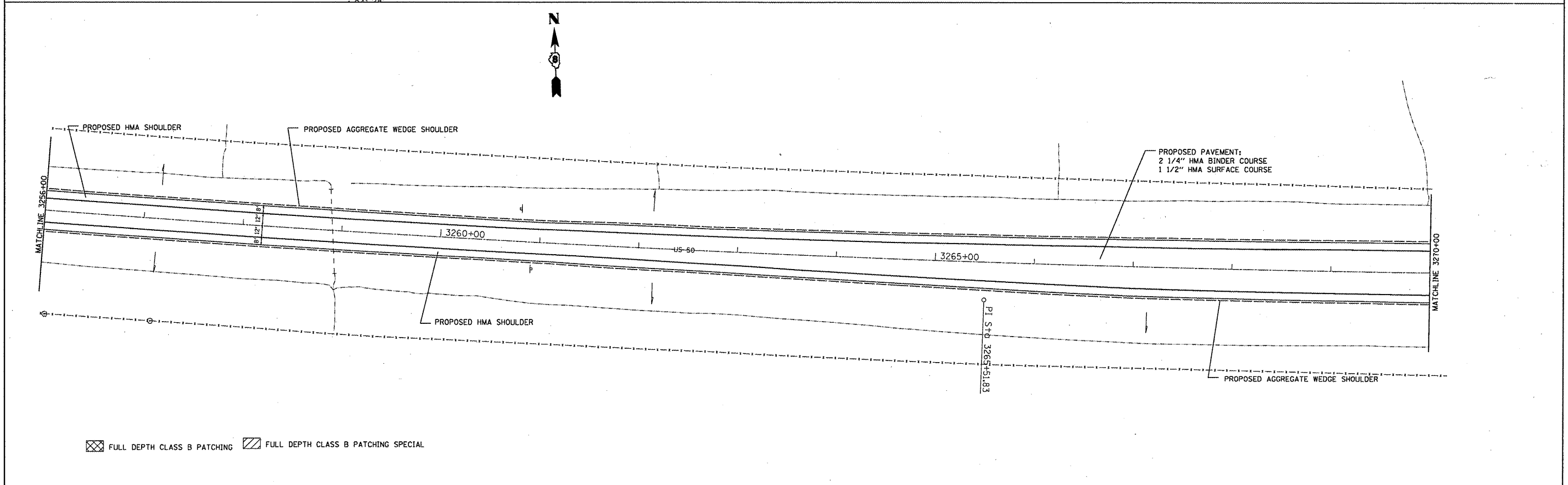
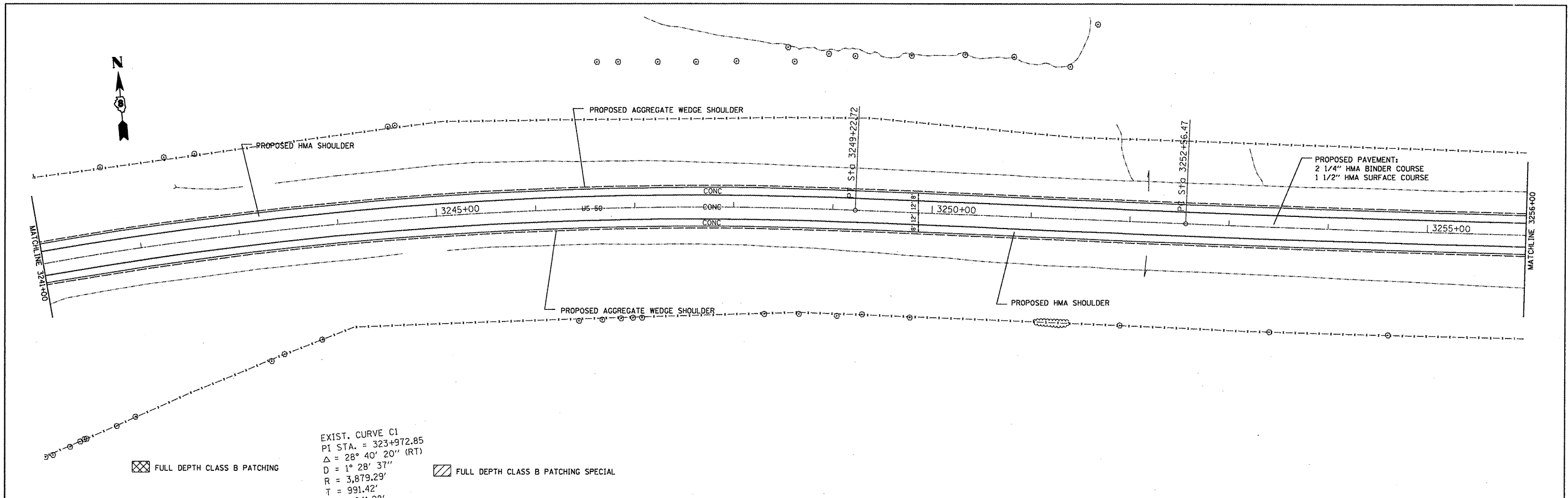

FILE NAME =	USER NAME = *USER*	DESIGNED -	REVISD -
#FILE#		DRAWN -	REVISD -
	PLOT SCALE = *SCALE*	CHECKED -	REVISD -
	PLOT DATE = *DATE*	DATE -	REVISD -

**STATE OF ILLINOIS  
 DEPARTMENT OF TRANSPORTATION**

**PLAN VIEW**

SCALE: 20' = 1" SHEET NO. 2 OF 5 SHEETS STA. 3241+00 TO STA. 3270+00

F.A.P. RTE.	SECTION	COUNTY	TOTAL SHEETS	SHEET NO.
327	14-1585-1	CLINTON	21	9
CONTRACT NO. 76E10				
FED. ROAD DIST. NO. ILLINOIS FED. AID PROJECT				

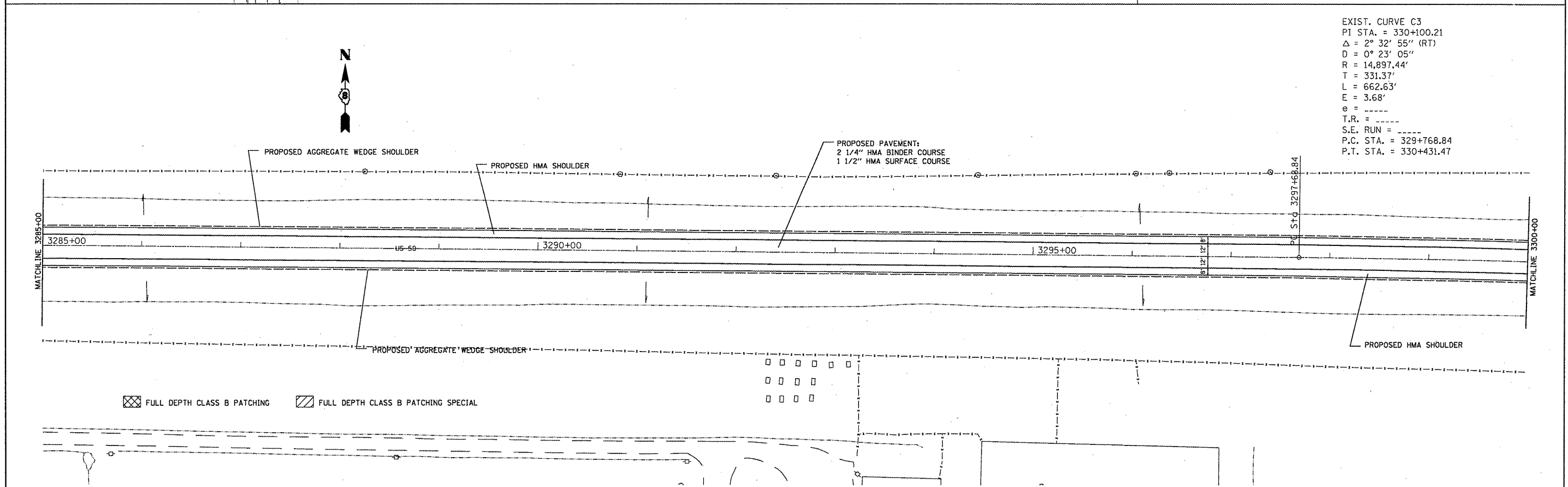
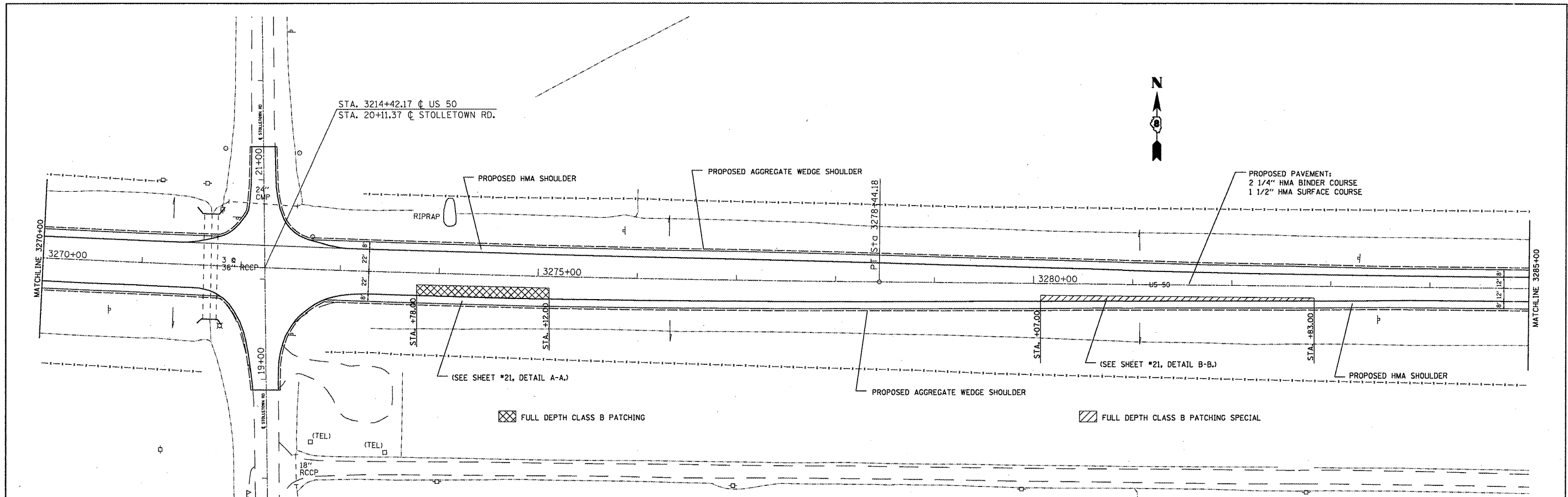

EXIST. CURVE C3  
 PI STA. = 330+100.21  
 $\Delta$  = 2° 32' 55" (RT)  
 D = 0° 23' 05"  
 R = 14,897.44'  
 T = 331.37'  
 L = 662.63'  
 E = 3.68'  
 e = -----  
 T.R. = -----  
 S.E. RUN = -----  
 P.C. STA. = 329+768.84  
 P.T. STA. = 330+431.47

FILE NAME =	USER NAME = #USER#	DESIGNED -	REVISED -
#FILE#		DRAWN -	REVISED -
	PLOT SCALE = #SCALE#	CHECKED -	REVISED -
	PLOT DATE = #DATE#	DATE -	REVISED -

**STATE OF ILLINOIS  
 DEPARTMENT OF TRANSPORTATION**

**PLAN VIEW**

SCALE: 20' = 1" SHEET NO. 3 OF 5 SHEETS STA. 3270+00 TO STA. <3300+00>

F.A.P. RTE.	SECTION	COUNTY	TOTAL SHEETS	SHEET NO.
327	14-158S-1	CLINTON	21	10
FED. ROAD DIST. NO. ILLINOIS FED. AID PROJECT			CONTRACT NO. 76E10	

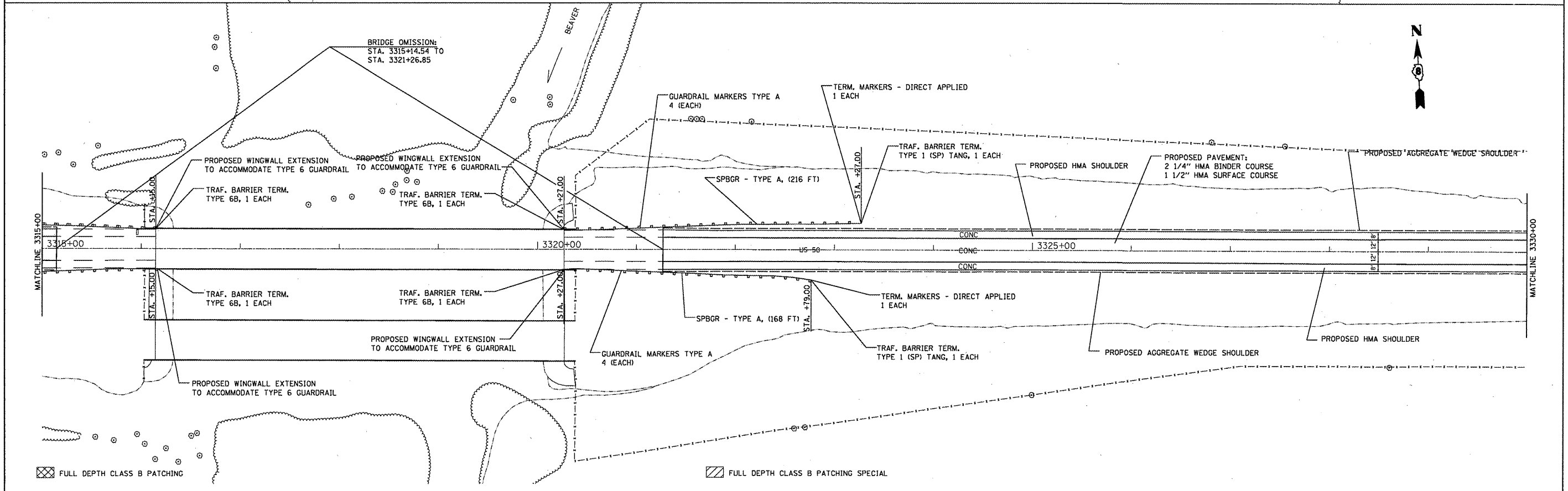
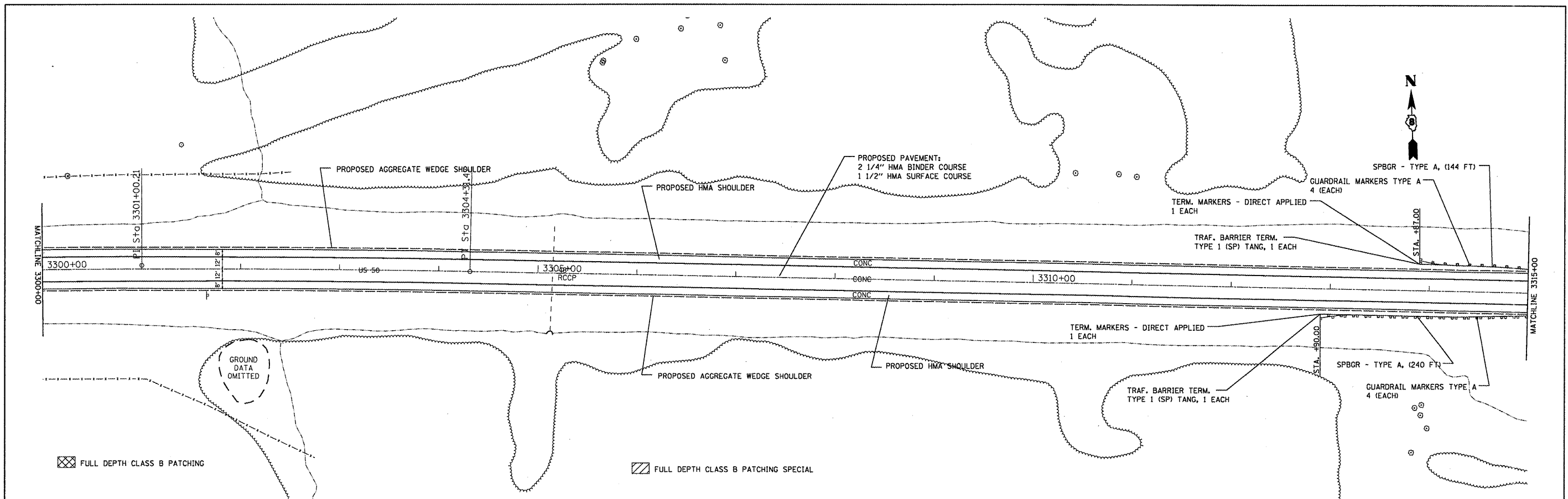

FILE NAME =	USER NAME = #USER#	DESIGNED -	REVISED -	<b>STATE OF ILLINOIS DEPARTMENT OF TRANSPORTATION</b>	<b>PLAN VIEW</b>			F.A.P. RTE.	SECTION	COUNTY	TOTAL SHEET NO.
#FILE#		DRAWN -	REVISED -		SCALE: 20	SHEET NO. 4 OF 5 SHEETS	STA. 3300+00 TO STA. 3330+00	327	14, 1585-1	CLINION	21 11
		CHECKED -	REVISED -								
		DATE	REVISED					FED. ROAD DIST. NO.	ILLINOIS	FED. AID PROJECT	

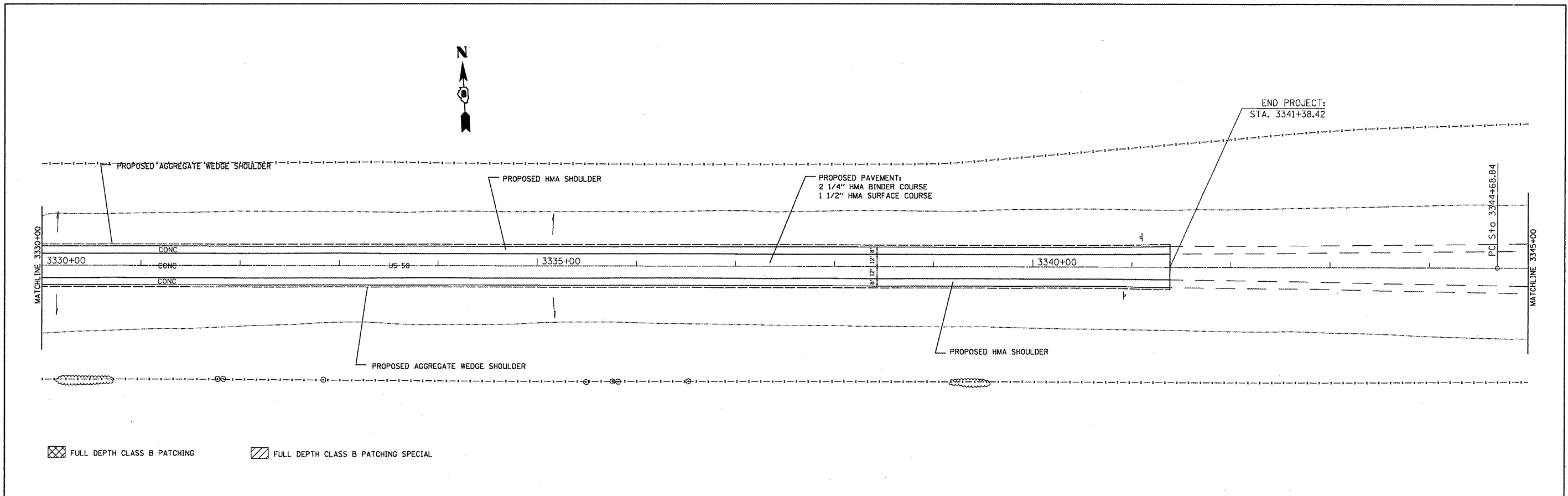

FULL DEPTH CLASS B PATCHING
  FULL DEPTH CLASS B PATCHING SPECIAL

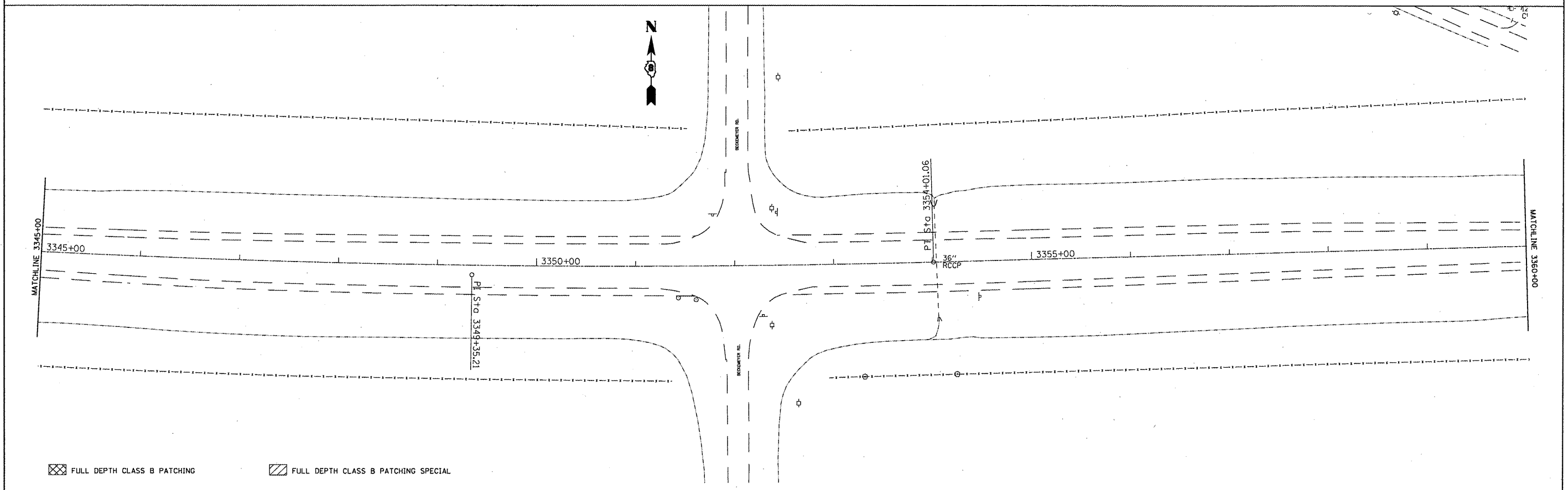

FULL DEPTH CLASS B PATCHING
  FULL DEPTH CLASS B PATCHING SPECIAL

FILE NAME = #FILEL#	USER NAME = #USER#	DESIGNED - ---	REVISED - ---	<b>STATE OF ILLINOIS DEPARTMENT OF TRANSPORTATION</b>	<b>PLAN VIEW</b>	F.A.P. RTE.	SECTION	COUNTY	TOTAL SHEETS	SHEET NO.
	PLOT SCALE = #SCALE#	CHECKED - ---	REVISED - ---			-327	14-1585-1	CLINTON	21	12
	PLOT DATE = #DATE#	DATE - ---	REVISED - ---			CONTRACT NO. 76E10		FED. ROAD DIST. NO. ILLINOIS FED. AID PROJECT		

SCALE: 20' = 1" SHEET NO. 5 OF 5 SHEETS STA. 3330±00 TO STA. 3360±00

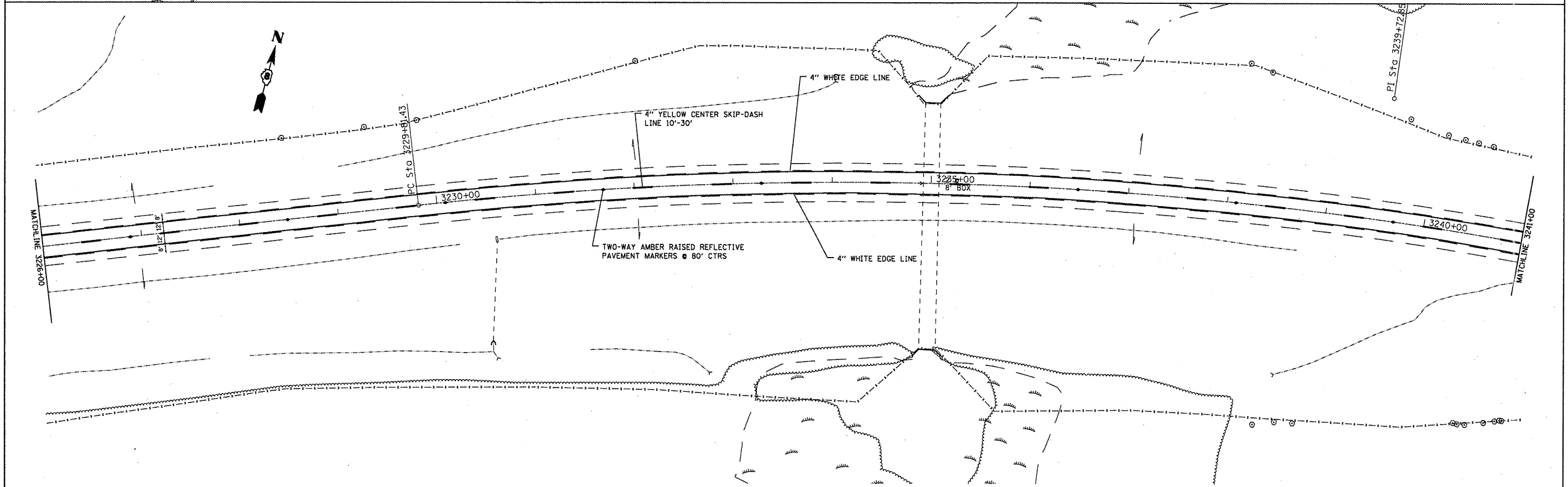
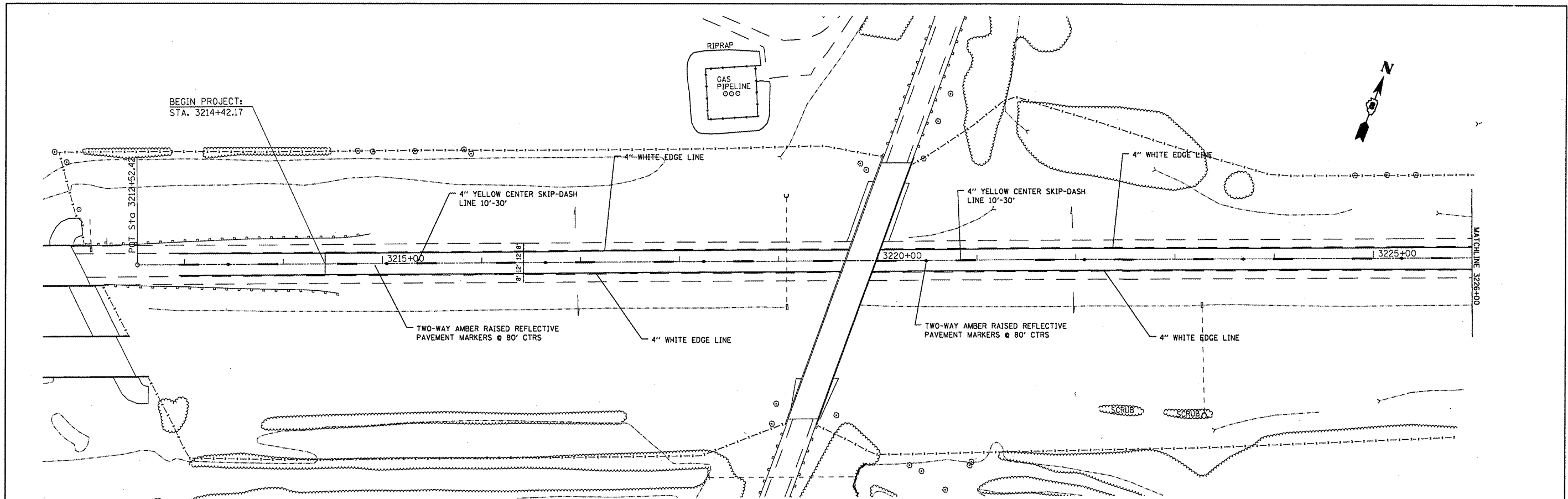

FILE NAME =  
#FILE#

USER NAME = #USER#  
PLOT SCALE = #SCALE#  
PLOT DATE = #DATE#

DESIGNED - ---  
DRAWN - ---  
CHECKED - ---  
DATE - ---

REVISED - ---  
REVISED - ---  
REVISED - ---  
REVISED - ---

**STATE OF ILLINOIS  
DEPARTMENT OF TRANSPORTATION**

**PAVEMENT MARKING**

SCALE: \_\_\_\_\_ SHEET NO. \_\_\_ OF \_\_\_ SHEETS STA. \_\_\_\_\_ TO STA. \_\_\_\_\_

F.A.P. RTE.	SECTION	COUNTY	TOTAL SHEETS	SHEET NO.
327	14.15BS-1	CLINTON	21	13
FED. ROAD DIST. NO. _____ ILLINOIS FED. AID PROJECT			CONTRACT NO. 16E1Q	

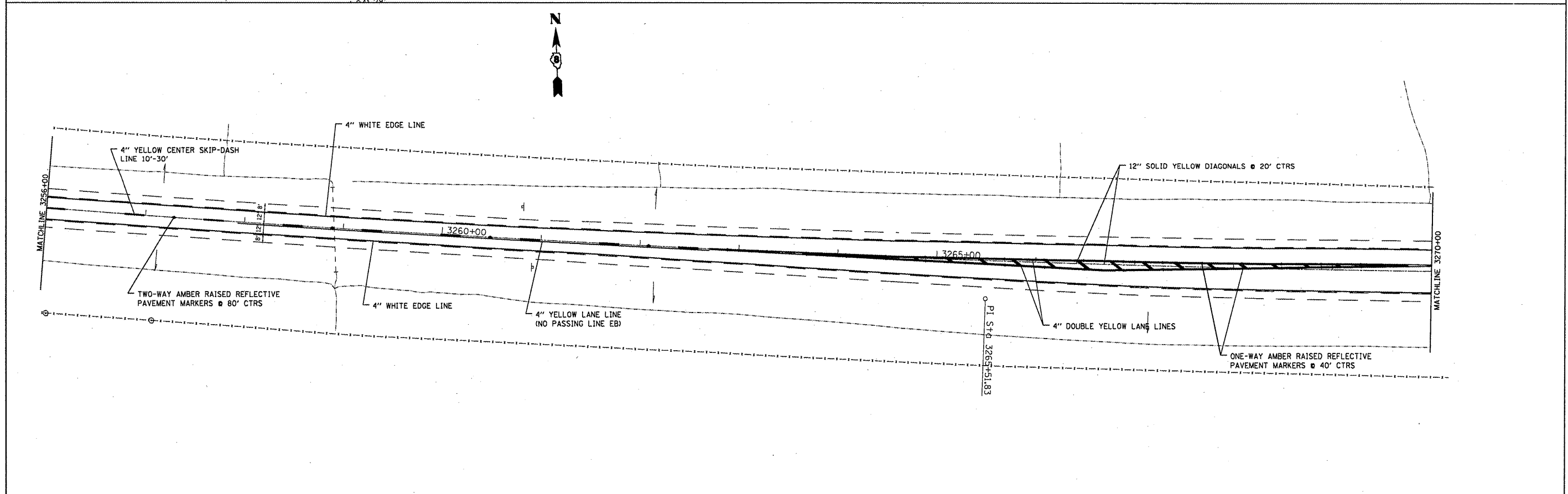
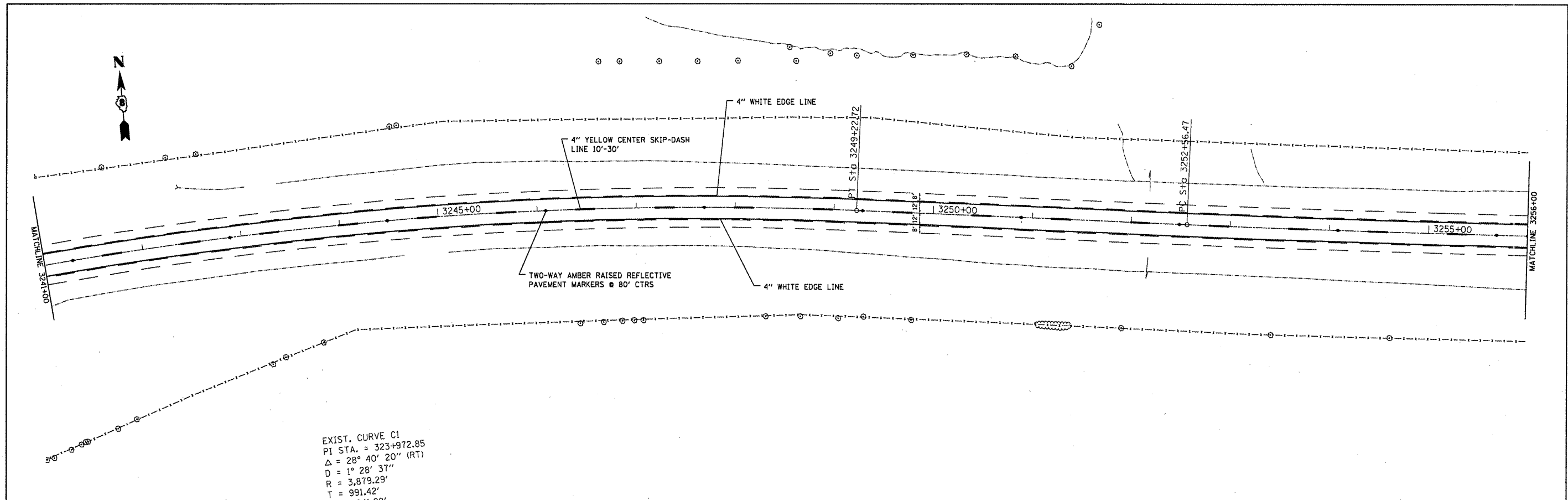

FILE NAME =	USER NAME = #USER#	DESIGNED -	REVISED -	<b>STATE OF ILLINOIS DEPARTMENT OF TRANSPORTATION</b>	<b>PAVEMENT MARKING</b>	F.A.P. RTE.	SECTION	COUNTY	TOTAL SHEETS	SHEET NO.	
#FILE#		DRAWN -	REVISED -			327	14J585-1	CLINTON	21	14	
	PLOT SCALE = #SCALE#	CHECKED -	REVISED -			CONTRACT NO. 16E10					
	PLOT DATE = #DATE#	DATE -	REVISED -			FED. ROAD DIST. NO. ILLINOIS FED. AID PROJECT					
					SCALE: _____	SHEET NO. ____ OF ____ SHEETS		STA. _____ TO STA. _____			

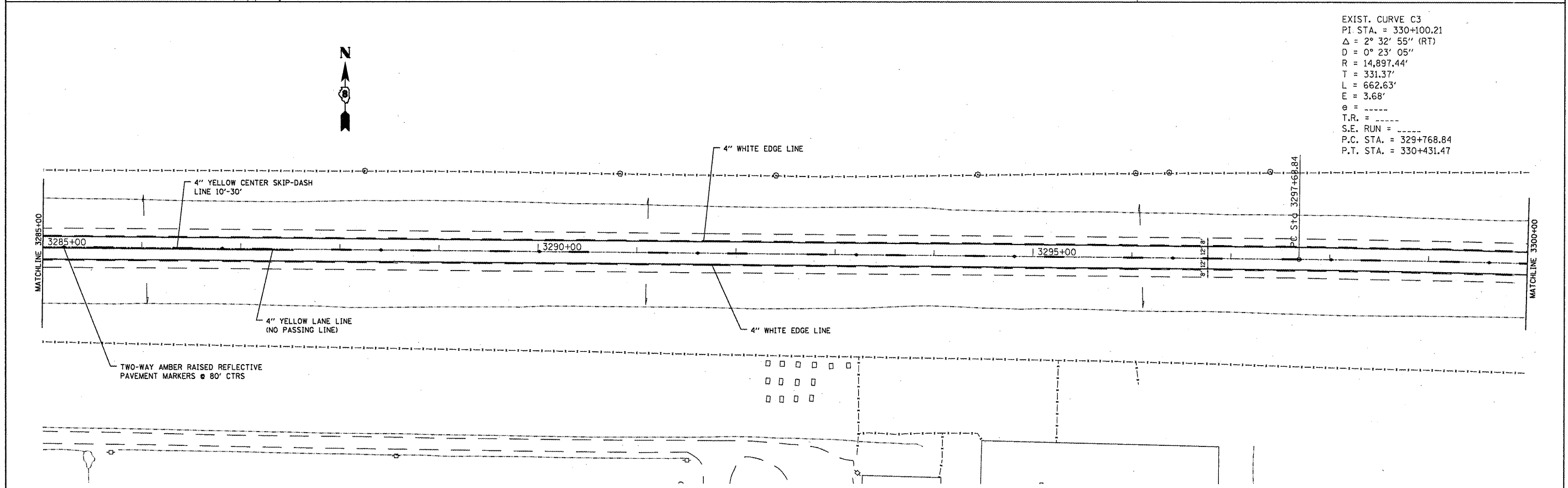
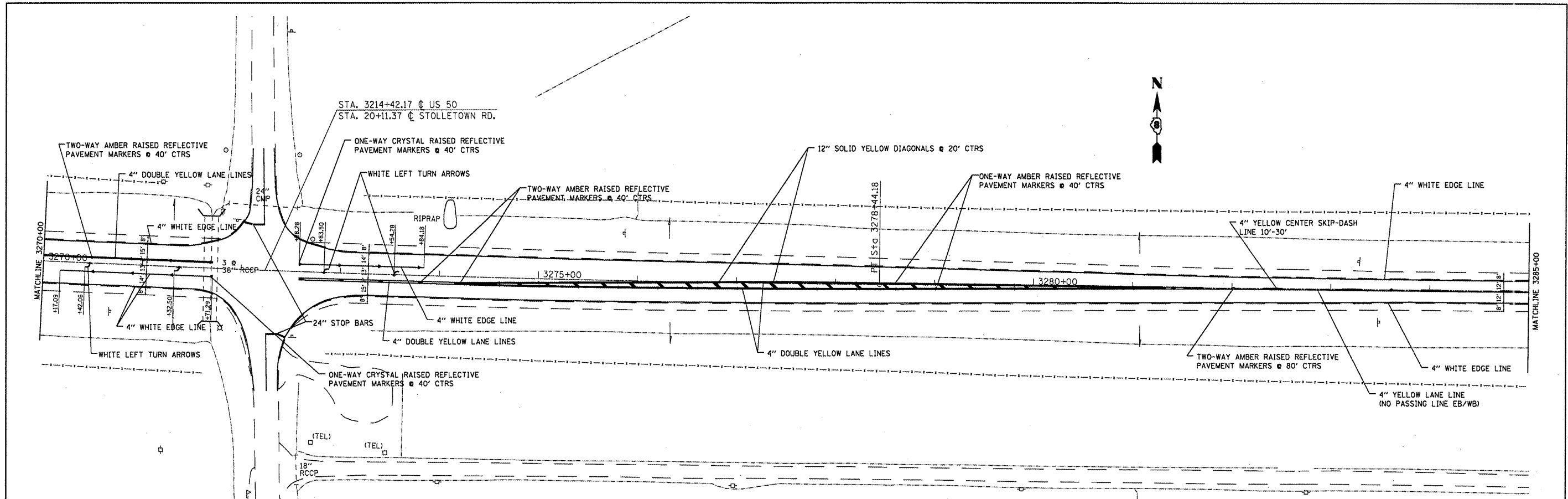

EXIST. CURVE C3  
 PI STA. = 330+100.21  
 $\Delta = 2^\circ 32' 55''$  (RT)  
 $D = 0^\circ 23' 05''$   
 $R = 14,897.44'$   
 $T = 331.37'$   
 $L = 662.63'$   
 $E = 3.68'$   
 $e =$   
 $T.R. =$   
 $S.E. RUN =$   
 $P.C. STA. = 329+768.84$   
 $P.T. STA. = 330+431.47$

FILE NAME =	USER NAME = #USER#	DESIGNED -	REVISED -
#FILE#		DRAWN -	REVISED -
	PLOT SCALE = #SCALE#	CHECKED -	REVISED -
	PLOT DATE = #DATE#	DATE -	REVISED -

**STATE OF ILLINOIS  
 DEPARTMENT OF TRANSPORTATION**

**PAVEMENT MARKING**

SCALE: \_\_\_\_\_ SHEET NO. \_\_\_\_ OF \_\_\_\_ SHEETS STA. \_\_\_\_\_ TO STA. \_\_\_\_\_

F.A.P. RTE.	SECTION	COUNTY	TOTAL SHEETS	SHEET NO.
327	14,198S:1	CLINTON	21	15
CONTRACT NO. 76E10				
FED. ROAD DIST. NO.   ILLINOIS FED. AID PROJECT				



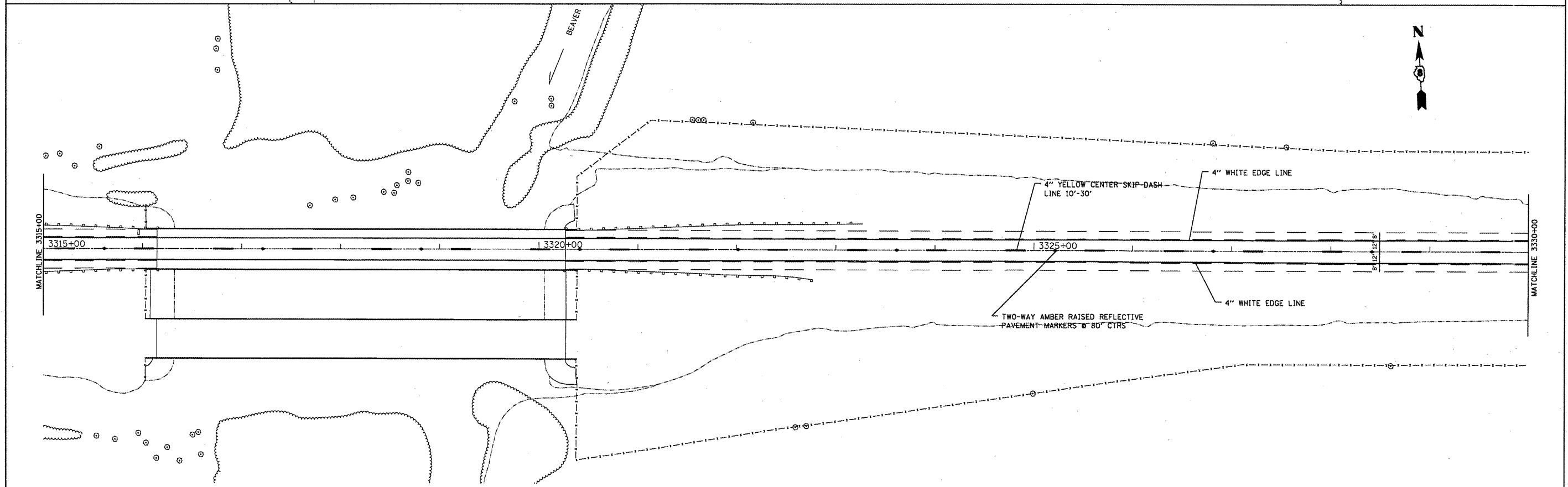
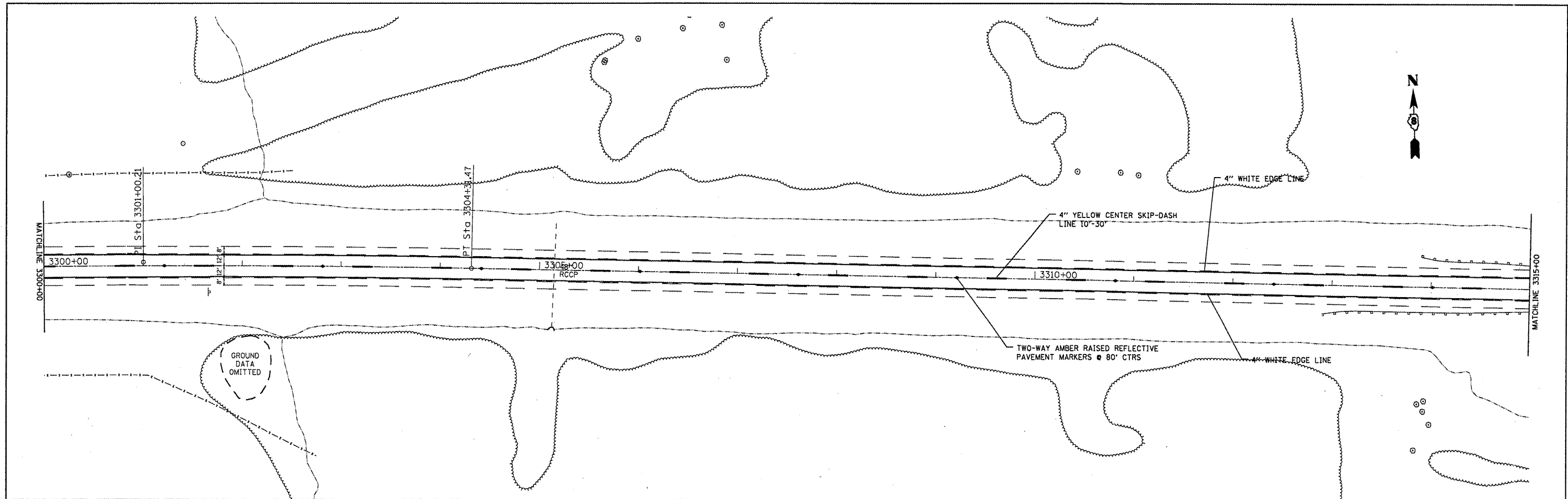

FILE NAME =	USER NAME = #USER#	DESIGNED -	REVISED -
#FILE#		DRAWN -	REVISED -
	PLOT SCALE = #SCALE#	CHECKED -	REVISED -
	PLOT DATE = #DATE#	DATE -	REVISED -

**STATE OF ILLINOIS  
DEPARTMENT OF TRANSPORTATION**

**PAVEMENT MARKING**

SCALE: \_\_\_\_\_ SHEET NO. \_\_\_ OF \_\_\_ SHEETS STA. \_\_\_\_\_ TO STA. \_\_\_\_\_

F.A.P. RTE.	SECTION	COUNTY	TOTAL SHEETS	SHEET NO.
327	14,158S-1	CLINTON	21	16
FED. ROAD DIST. NO. _____ ILLINOIS FED. AID PROJECT				
CONTRACT NO. 76E1Q				

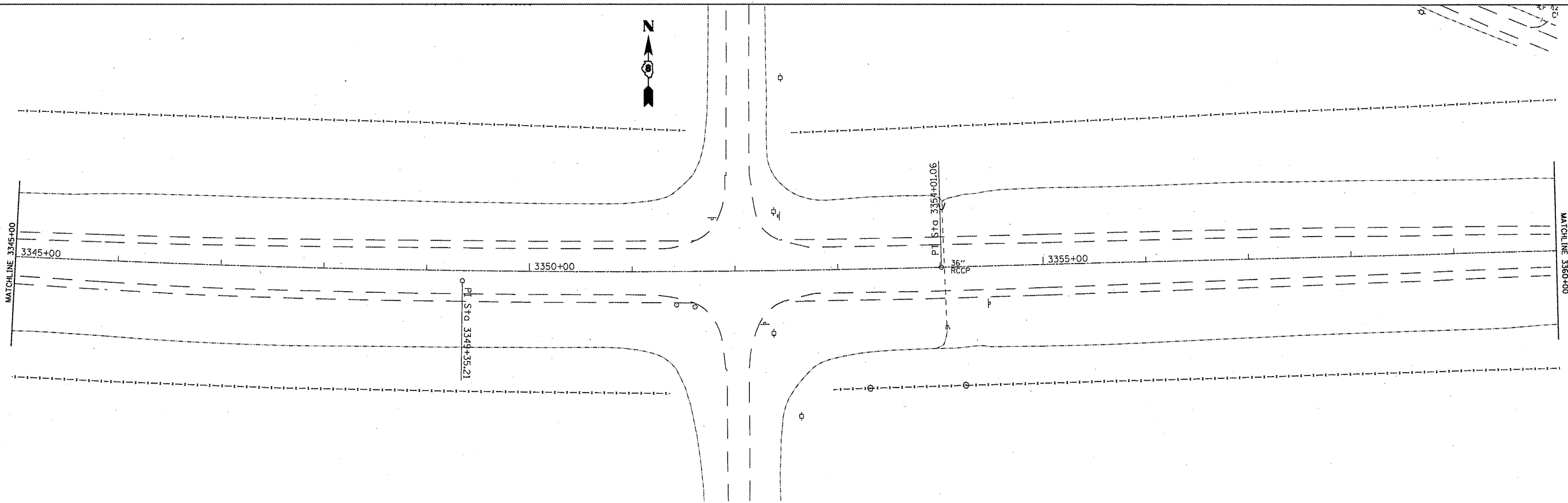
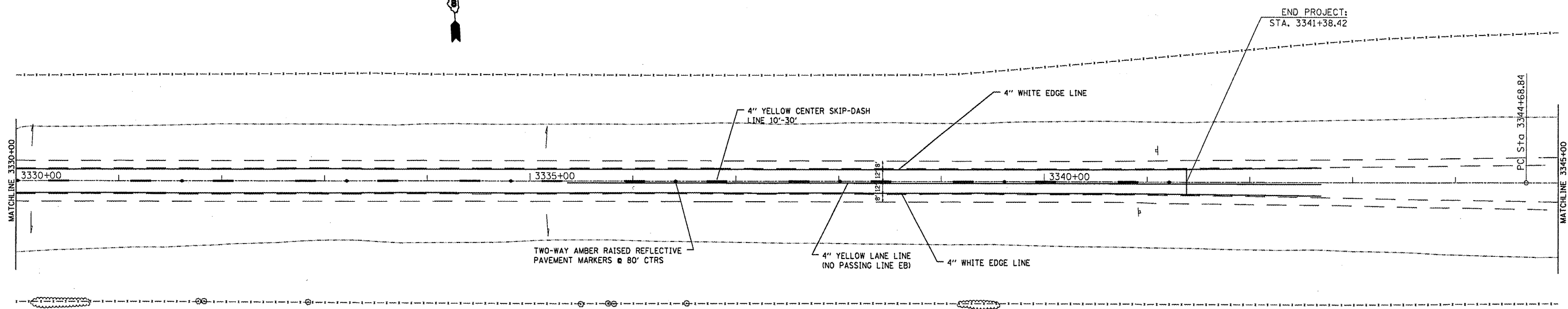

FILE NAME = #FILE#	USER NAME = #USER#	DESIGNED - ___	REVISED - ___
		DRAWN - ___	REVISED - ___
	PLOT SCALE = #SCALE#	CHECKED - ___	REVISED - ___
	PLOT DATE = #DATE#	DATE - _____	REVISED - ___

**STATE OF ILLINOIS  
DEPARTMENT OF TRANSPORTATION**

<b>PAVEMENT MARKING</b>	
SCALE: _____	SHEET NO. ___ OF ___ SHEETS STA. _____ TO STA. _____

F.A.P. RTE. 327	SECTION 14,1585-1	COUNTY CLINTON	TOTAL SHEETS 21	SHEET NO. 17
FED. ROAD DIST. NO. ILLINOIS FED. AID PROJECT			CONTRACT NO. 76E10	

L	A	B
< 150	25'	-
≥ 150	50'	-
≥ 200	50'	≤ 50'

• TO BE DETERMINED BY GEOMETRICS AND SHOWN IN PLANS

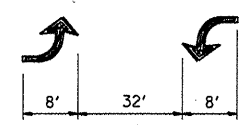
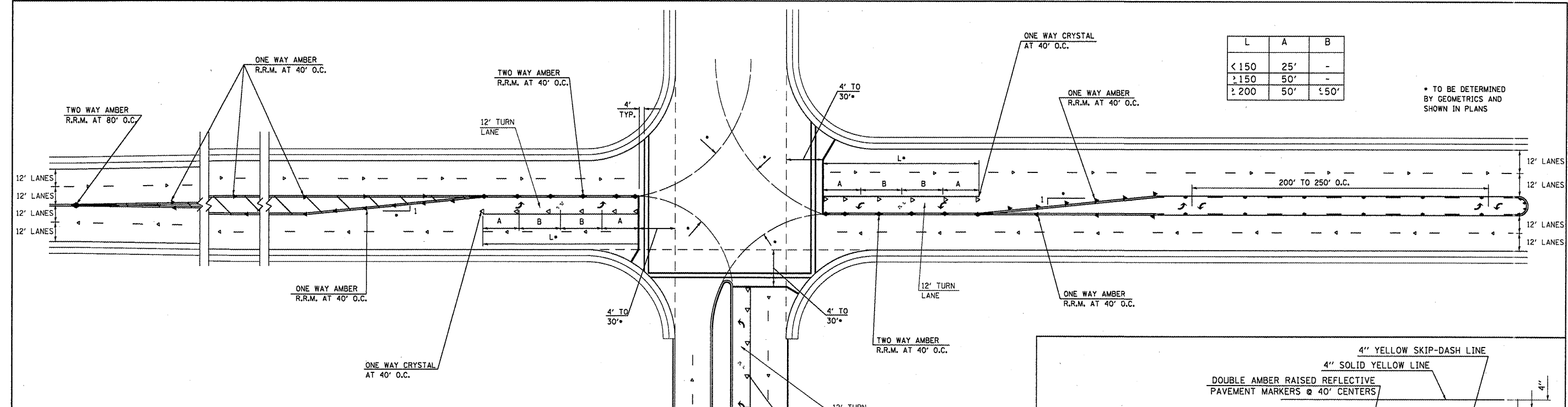

BI-DIRECTIONAL TURN ARROW @ 200' O. C.

SPEED	CHANNELIZATION & GORES	OBJECTS	CONTINUOUS
< 30 MPH	15'	10'	50'
30-45 MPH	20'	15'	75'
> 45 MPH	30'	20'	150'

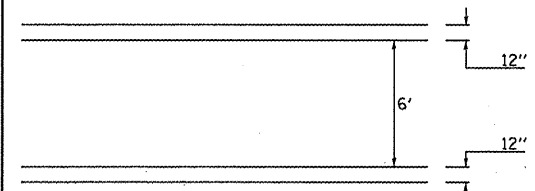

TYPICAL APPLICATION FOR PEDESTRIAN CROSSWALK

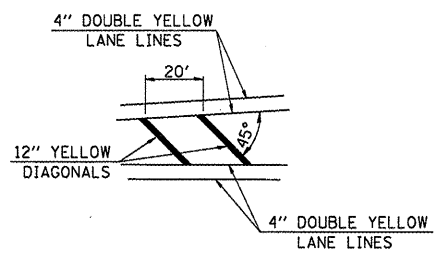

TYPICAL APPLICATION FOR MEDIAN STRIPING

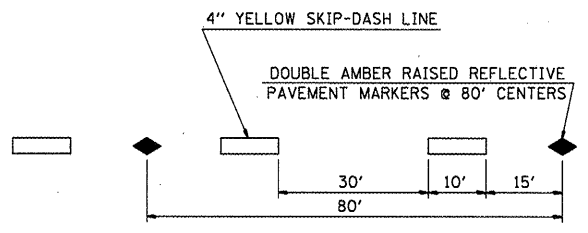

TYPICAL APPLICATION FOR YELLOW SKIP-DASH LINES WITH RAISED REFLECTIVE PAVEMENT MARKERS

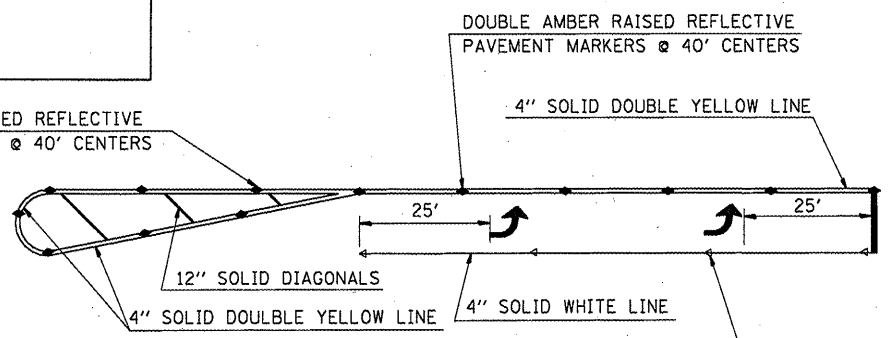

TYPICAL APPLICATION FOR LEFT TURN LANE WITH RAISED REFLECTIVE PAVEMENT MARKERS

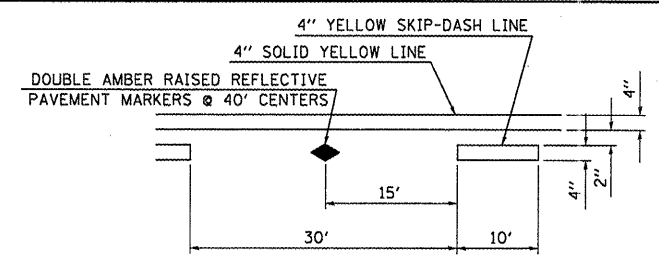

TYPICAL APPLICATION FOR BI-DIRECTIONAL TURN LANE WITH RAISED REFLECTIVE PAVEMENT MARKERS

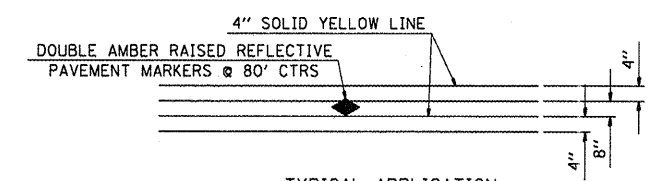

TYPICAL APPLICATION FOR DOUBLE YELLOW LANE LINES WITH RAISED REFLECTIVE PAVEMENT MARKERS

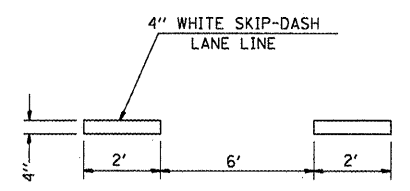

TYPICAL APPLICATION FOR WHITE SKIP-DASH AUX LANE LINES

FILE NAME =	USER NAME = #USER#	DESIGNED -	REVISED -
#FILE#		DRAWN -	REVISED -
	PLOT SCALE = #SCALE#	CHECKED -	REVISED -
	PLOT DATE = #DATE#	DATE -	REVISED -

STATE OF ILLINOIS  
DEPARTMENT OF TRANSPORTATION

PAVEMENT MARKING

SCALE: \_\_\_\_\_ SHEET NO. \_\_\_\_\_ OF \_\_\_\_\_ SHEETS STA. \_\_\_\_\_ TO STA. \_\_\_\_\_

F.A.P. RTE.	SECTION	COUNTY	TOTAL SHEETS	SHEET NO.
327	14.1585-1	CLINTON	21	18
FED. ROAD DIST. NO. _____ ILLINOIS FED. AID PROJECT			CONTRACT NO. 76E10	

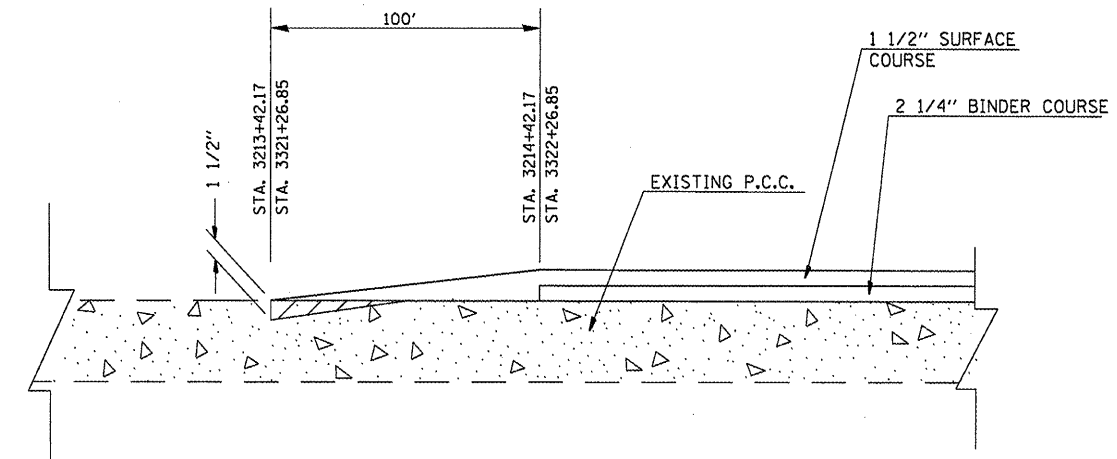
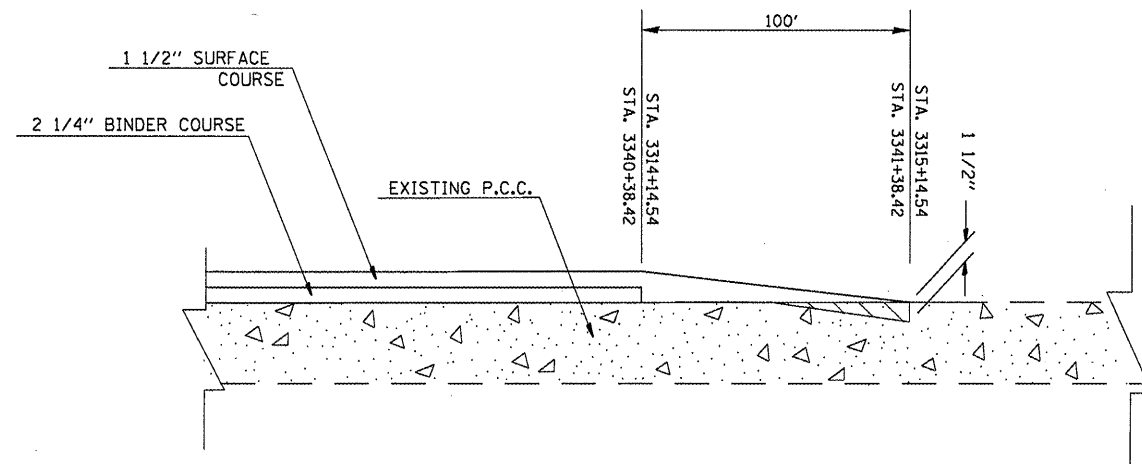

**BRIDGE OMISSION &  
BUTT JOINT DETAIL**

S.N. 014-0060 BEGIN/END PROJECT  
 STA. 3315+14.54 STA. 3214+42.17  
 STA. 3321+26.85 STA. 3321+26.85

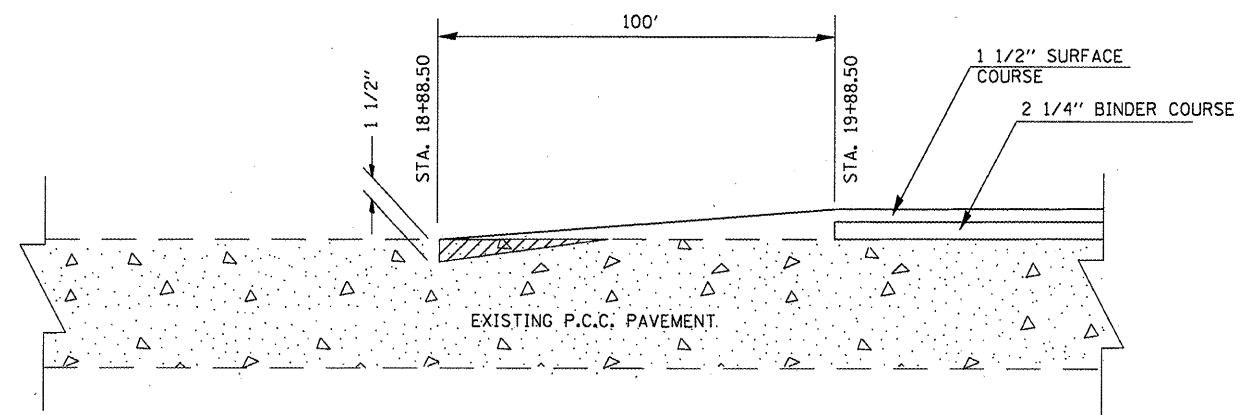
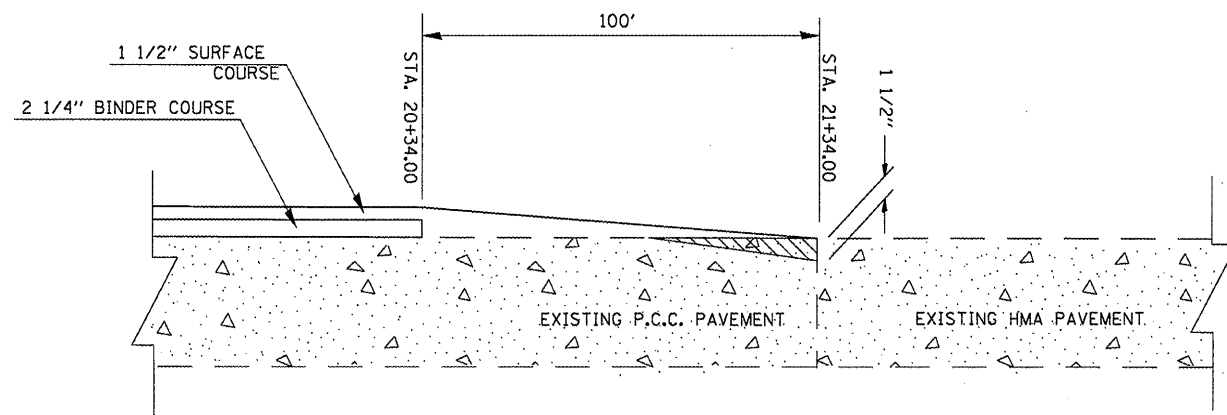

**SIDEROAD  
BUTT JOINT DETAIL**

NORTH/SOUTH STOLLETOWN RD.  
 STA. 18+88.5  
 STA. 18+88.5

FILE NAME =	USER NAME = *USER*	DESIGNED -	REVISED -	<b>STATE OF ILLINOIS DEPARTMENT OF TRANSPORTATION</b>	<b>DETAIL SHEET</b>	F.A.P. RTE.	SECTION	COUNTY	TOTAL SHEETS	SHEET NO.	
*FILEL*	DRAWN -	REVISED -	REVISED -			327	19-1585-1	CLINION	21	19	
	PLOT SCALE = *SCALE*	CHECKED -	REVISED -			CONTRACT NO. 76E10					
	PLOT DATE = *DATE*	DATE -	REVISED -			FED. ROAD DIST. NO. ILLINOIS FED. AID PROJECT					
SCALE: _____ SHEET NO. ___ OF ___ SHEETS STA. _____ TO STA. _____											

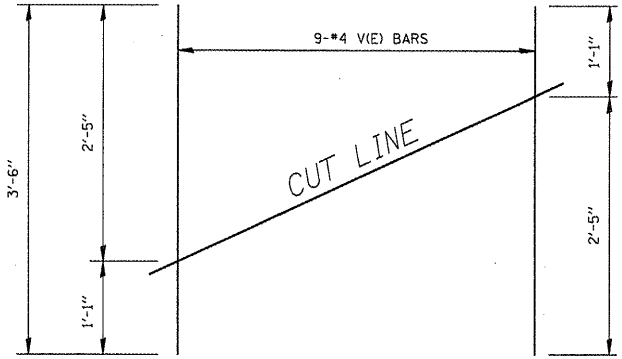
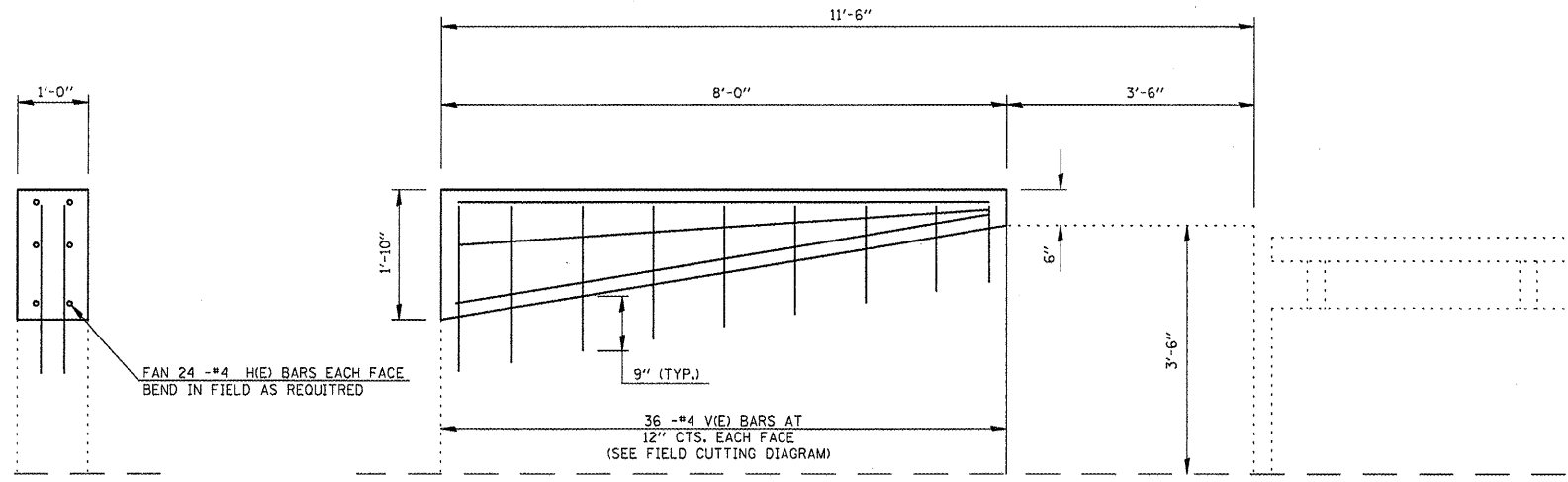

S.N. 014-0060

NOTE: THE ADDITION OF CEMENT TO THESE BRIDGE PARAPETS IS TO PROPERLY ATTACH THE GUARDRAIL TO THE PARAPET AFTER RAISING THE EXISTING ROADWAY WITH THE 2 1/2" RESURFACING.

FIELD CUTTING DIAGRAM

ORDER VIE) FULL LENGTH. CUT AS SHOWN AND USE REMAINDER OF BARS IN OPPOSITE FACE.

**BILL OF MATERIAL**

Bar	No.	Size	Length	Shape
h(E)	24	#4	7'-8"	
v(E)	36	#4	3'-6"	
Concrete Structures	Cu. Yd.	1.4		
Reinforcement Bars, Epoxy Coated	Pound	210		

FILE NAME =	USER NAME = #USER#	DESIGNED -	REVISED -	<b>STATE OF ILLINOIS DEPARTMENT OF TRANSPORTATION</b>	<b>BRIDGE WINGWALL DETAIL SHEET</b>	F.A.P. RTE.	SECTION	COUNTY	TOTAL SHEETS	SHEET NO.
#FILE#	PLDT SCALE = #SCALE#	DRAWN -	REVISED -			327	14.158S-1	CLINTON	21	20
	PLDT DATE = #DATE#	CHECKED -	REVISED -			CONTRACT NO. 16E1Q				
		DATE -	REVISED -	SCALE: _____	SHEET NO. _ OF _ SHEETS	STA. _____ TO STA. _____		FED. ROAD DIST. NO.   ILLINOIS FED. AID PROJECT		

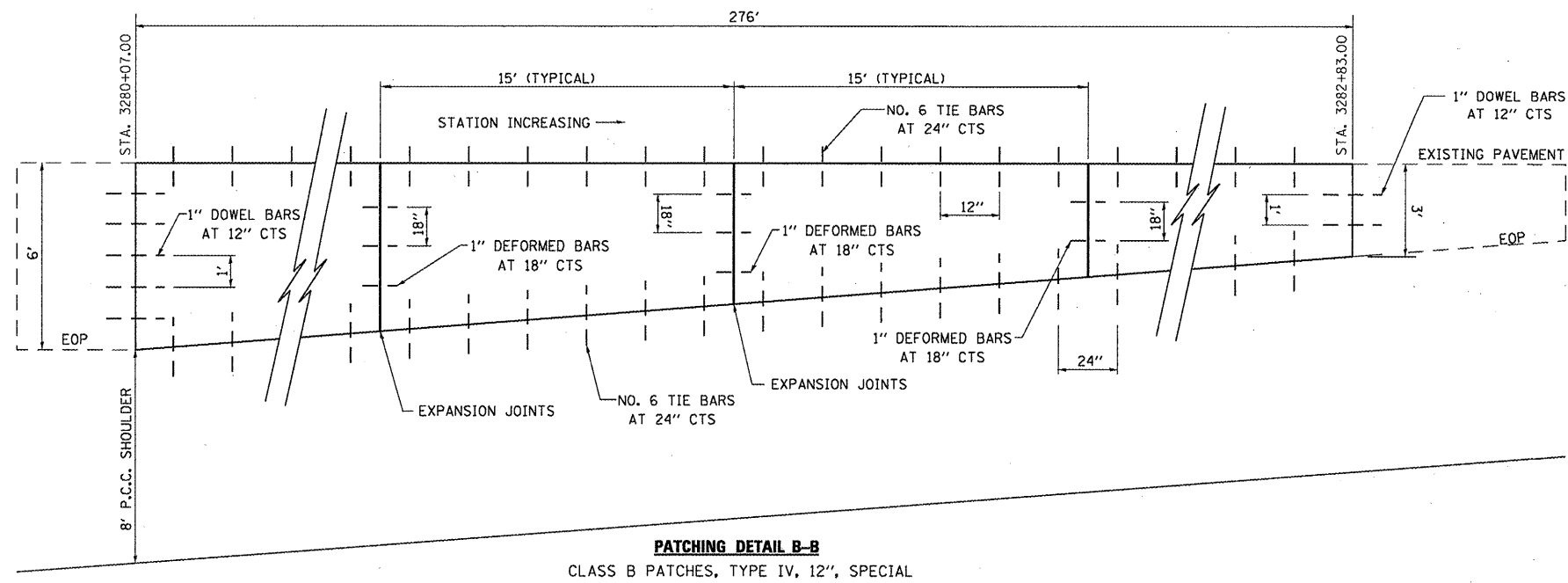
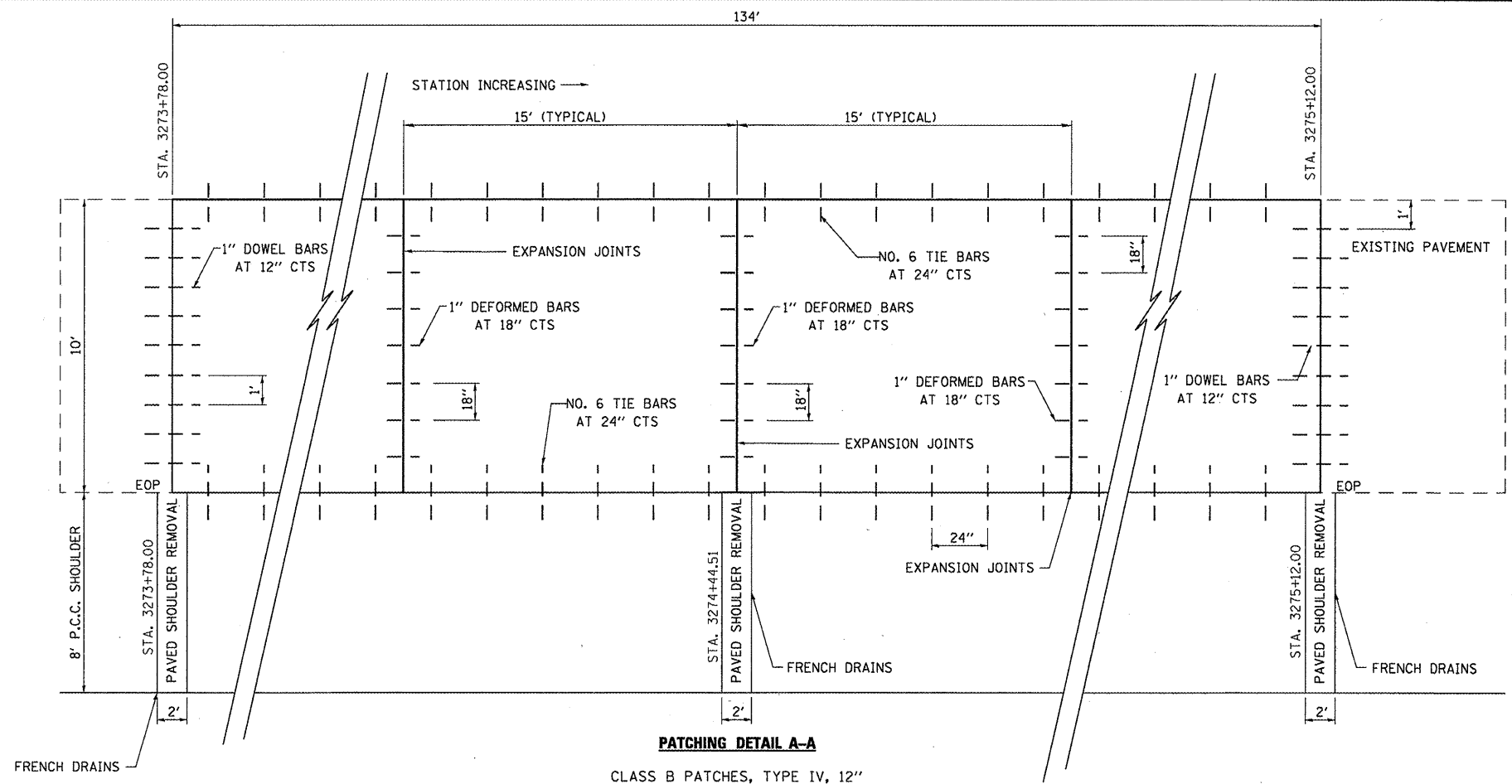

NOTE: SEE HIGHWAY STANDARD FOR THINGS NOT SHOWN.

FILE NAME =	USER NAME = #USER#	DESIGNED -	REVISED -	<b>STATE OF ILLINOIS DEPARTMENT OF TRANSPORTATION</b>	<b>DETAIL SHEET</b>	F.A.P. RTE.	SECTION	COUNTY	TOTAL SHEETS	SHEET NO.
#FILE#		DRAWN -	REVISED -			327	14-1585-1	CLINION	21	21
		CHECKED -	REVISED -			CONTRACT NO. 76E10				
		PLOT SCALE = #SCALE#		SCALE: _____ SHEET NO. ____ OF ____ SHEETS STA. _____ TO STA. _____		FED. ROAD DIST. NO. ILLINOIS FED. AID PROJECT				
		PLOT DATE = #DATE#								