

STATE OF ILLINOIS  
 DEPARTMENT OF TRANSPORTATION  
 DIVISION OF HIGHWAYS  
**PROPOSED  
 HIGHWAY PLANS**

| F.A.P. RTE. | SECTION | COUNTY   | TOTAL SHEETS       | SHEET NO. |
|-------------|---------|----------|--------------------|-----------|
| 312         | 122-J   | RANDOLPH | 93                 | 1         |
|             |         | ILLINOIS | CONTRACT NO. 76E33 |           |

**INDEX OF SHEETS**

- 1 COVER SHEET, INDEX OF SHEETS
- 2 GENERAL NOTES, HIGHWAY STANDARDS, ADT, COMMITMENTS
- 3 SUMMARY OF QUANTITIES
- 4 TYPICAL SECTIONS
- 5 - 7 SCHEDULE OF QUANTITIES
- 8 LOCATION MAP
- 9 - 20 PLAN SHEETS
- 21 - 93 CROSS SECTIONS

FAP RTE 312 (IL 3)  
 SECTION 122-J  
 PROJECT HSIP-0312(040)  
 GUARDRAIL - HSIP  
 RANDOLPH COUNTY

C-98-012-11

D-98-013-11

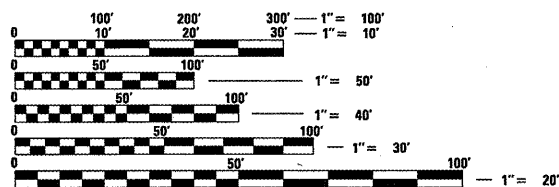
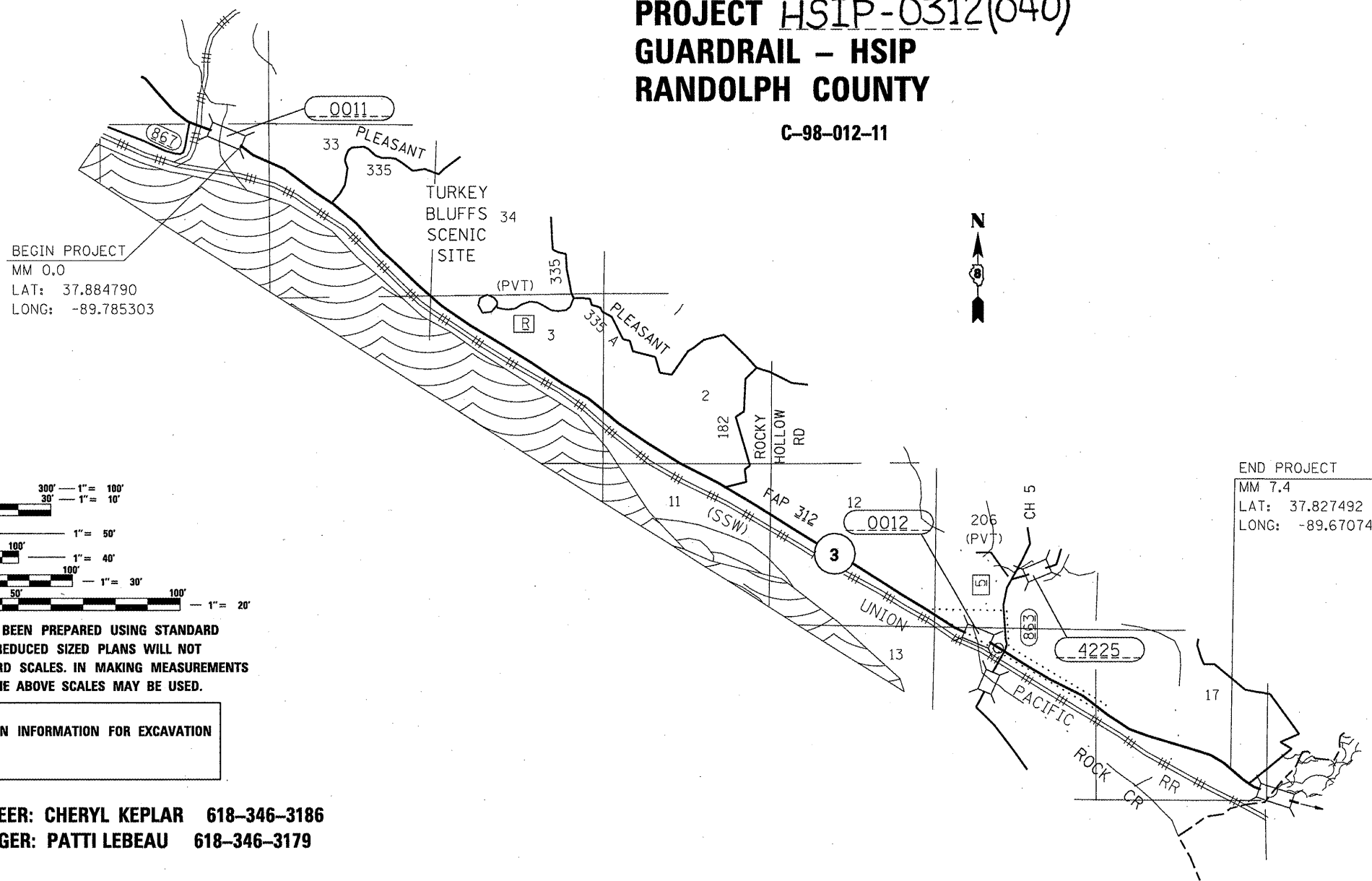
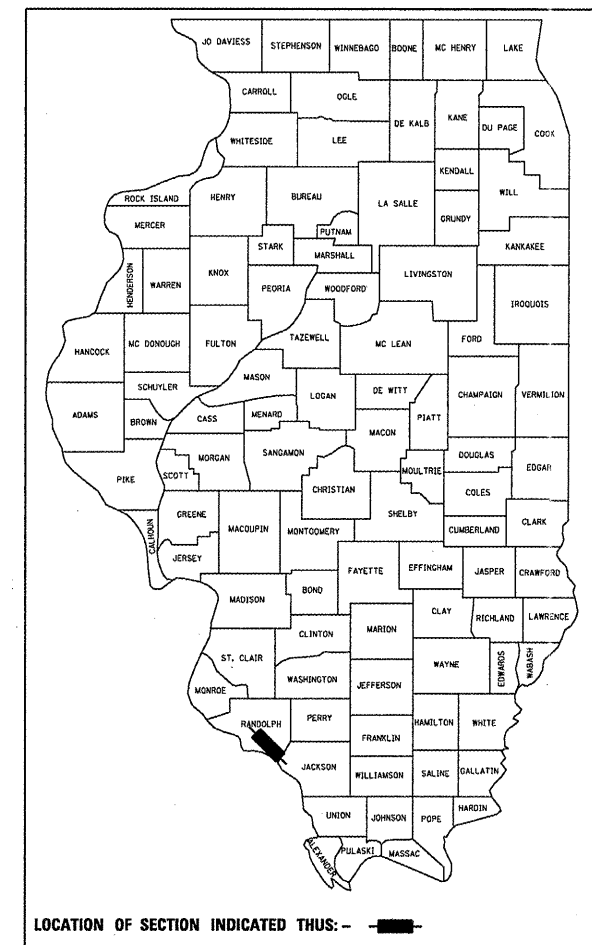

FULL SIZE PLANS HAVE BEEN PREPARED USING STANDARD ENGINEERING SCALES. REDUCED SIZED PLANS WILL NOT CONFORM TO STANDARD SCALES. IN MAKING MEASUREMENTS ON REDUCED PLANS, THE ABOVE SCALES MAY BE USED.

J.U.L.I.E.  
 JOINT UTILITY LOCATION INFORMATION FOR EXCAVATION  
 1-800-892-0123  
 OR 811

PROJECT ENGINEER: CHERYL KEPLAR 618-346-3186  
 PROJECT MANAGER: PATTI LEBEAU 618-346-3179

CONTRACT NO. 76E33

STATE OF ILLINOIS  
 DEPARTMENT OF TRANSPORTATION  
 DIVISION OF HIGHWAYS

SUBMITTED March 24 20 11  
Mary C. Jamie  
 DEPUTY DIRECTOR OF HIGHWAYS, REGION 5 ENGINEER

May 13 20 11  
Scott E. Stitt P.E.  
 acting ENGINEER OF DESIGN AND ENVIRONMENT

May 13 20 11  
Christine M. Reed  
 DIRECTOR OF HIGHWAYS, CHIEF ENGINEER

**PRINTED BY THE AUTHORITY  
 OF THE STATE OF ILLINOIS**