

FOR INDEX OF SHEETS, SEE SHEET NO. 3

US 51

ADT (2010)

8,800

PV = 8,275

SU = 250

MU = 275

IL 149

ADT (2009)

3,250

PV = 2,925

SU = 175

MU = 150

STANDARDS

701306-03

701311-03

701901-01

SEE SOQ SHEET FOR STATION EQUATIONS

TOWNSHIP

MAKANDA

FRANKFORT

CAVE

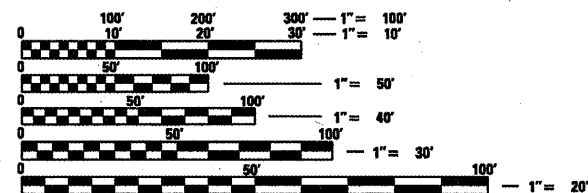

FULL SIZE PLANS HAVE BEEN PREPARED USING STANDARD ENGINEERING SCALES. REDUCED SIZED PLANS WILL NOT CONFORM TO STANDARD SCALES. IN MAKING MEASUREMENTS ON REDUCED PLANS, THE ABOVE SCALES MAY BE USED.

J.U.L.I.E.
JOINT UTILITY LOCATION INFORMATION FOR EXCAVATION
1-800-892-0123
OR 811

PROJECT ENGINEER ALEC LENZINI (618)549-2171
PROJECT MANAGER CHARLES STEIN (618)351-5210

CONTRACT NO. 78224

STATE OF ILLINOIS
DEPARTMENT OF TRANSPORTATION

DIVISION OF HIGHWAYS

PROPOSED
HIGHWAY PLANS

FAP 322 (US 51) & FAP 873 (IL 149)

SECTION (9-3,10-3,107)I-1

PROJECT HSIP-000S(852)

RUMBLE STRIP

JACKSON & FRANKLIN COUNTY

C-99-003-11

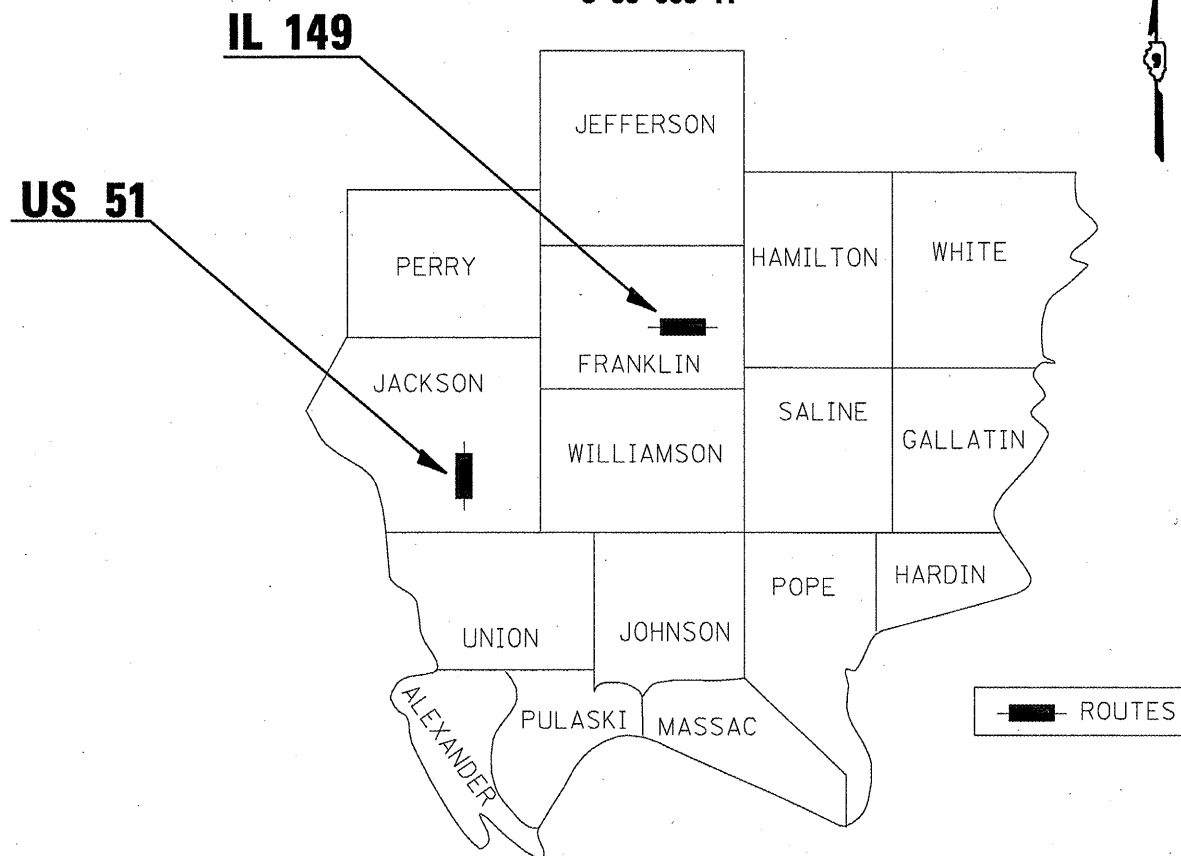

US 51
GROSS LENGTH = 2,667 M = 8750 FT = 1.657 MILE
BEGIN STA 8+283 (METRIC) = STA 0+00 (ENGLISH)
END STA 10+950 (METRIC) = STA 87+50 (ENGLISH)

IL 149
GROSS LENGTH 40,588 FT = 7.7 MILE
BEGIN STA 832+32 (ENGLISH) = STA 1238+20 (ENGLISH)

F.A.P. RTE.	SECTION	COUNTY	TOTAL SHEETS	SHEET NO.
•	(9-3,10-3,107)I-1	•	10	1
FED. ROAD DIST. NO.	ILLINOIS	CONTRACT NO. 78224		
*FAP 322/873, JACKSON AND FRANKLIN COUNTY				

D-99-001-11

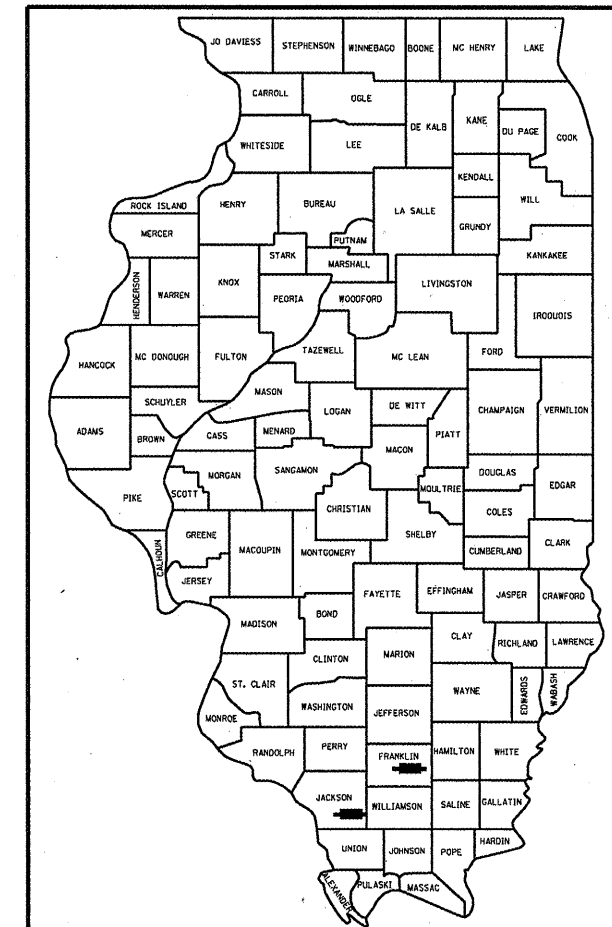

LOCATION OF SECTION INDICATED THUS: - [thick black line] -

STATE OF ILLINOIS
DEPARTMENT OF TRANSPORTATION
DIVISION OF HIGHWAYS

SUBMITTED March 25 20 11
Mary C. Lomax
DEPUTY DIRECTOR OF HIGHWAYS, REGION ENGINEER

May 13 20 11
Scott E. Stitt P.E. I.B.I.
acting ENGINEER OF DESIGN AND ENVIRONMENT

May 13 20 11
Christine M. Reader
DIRECTOR OF HIGHWAYS, CHIEF ENGINEER

PRINTED BY THE AUTHORITY
OF THE STATE OF ILLINOIS

Prepared By: Joe Zlanfievicz
DISTRICT STUDIES & PLANS ENGINEER

Examined By: James E. Emery
DISTRICT LAND ACQUISITION ENGINEER

Examined By: Carmie Nolan
DISTRICT PROGRAM DEVELOPMENT ENGINEER

Examined By: Kevin Kelly
DISTRICT OPERATIONS ENGINEER

Examined By: [Signature]
DISTRICT CONSTRUCTION ENGINEER

Examined By: Bruce A. Peble
DISTRICT MATERIALS ENGINEER

Approved By: Mary C. Romie
DEPUTY DIRECTOR OF HIGHWAYS, REGION ENGINEER

March 25 2011
DATE

FILE NAME =	USER NAME = LENZINIAD	DESIGNED - ---	REVISED - -----
ca:\pw_work\pwidot\lenziniad\0239191\7824-Design-rest.dgn		DRAWN - ---	REVISED - -----
	PLOT SCALE = 1/83.1218" / IN.	CHECKED - ---	REVISED - -----
	PLOT DATE = 3/1/2011	DATE - ---	REVISED - -----

**STATE OF ILLINOIS
DEPARTMENT OF TRANSPORTATION**

----- **SIGNATURE SHEET** -----

SCALE: _____ SHEET NO. 2 OF XX SHEETS STA. _____ TO STA. _____

F.A.P. RTE.	SECTION	COUNTY	TOTAL SHEETS	SHEET NO.
*	(9-3,10-3,107H-1)	*	10	2
FED. ROAD DIST. NO. _____ ILLINOIS FED. AID PROJECT			CONTRACT NO. 78224	

INDEX OF SHEETS

<u>SHEET NO</u>	<u>DESCRIPTION</u>
1	COVER SHEET
2	SIGNATURE SHEET
3	INDEX OF SHEETS
4	SUMMARY OF QUANTITIES & STATION EQUATIONS
5	TYPICAL SECTION
6	TYPICAL SECTION
7	CENTERLINE DETAIL
8	SHOULDER DETAIL
9	PLAN SHEET
10	PLAN SHEET

FILE NAME =	USER NAME = LENZINIAD	DESIGNED -	REVISED -	STATE OF ILLINOIS DEPARTMENT OF TRANSPORTATION	INDEX OF SHEETS			F.A.P. RTE.	SECTION	COUNTY	TOTAL SHEETS	SHEET NO.
c:\pw_work\pwidot\lenzinia\d0239191\7824-Design-rest.dgn	DRAWN -	REVISED -	REVISED -		-----			*	(9-3,10-3,107)-1	*	10	3
PLOT SCALE = 1/8" = 1'-0"	CHECKED -	REVISED -	REVISED -		SCALE: -----	SHEET NO. 3 OF XX SHEETS	STA. -----	CONTRACT NO. 78224				
PLOT DATE = 3/1/2011	DATE -	REVISED -	REVISED -		----- TO STA. -----			FED. ROAD DIST. NO. - ILLINOIS FED. AID PROJECT				

SUMMARY OF QUANTITIES 0021

Code Number	Item Description	Unit	Quantity		90% FED. 10% STATE
			Jackson	Franklin	Total
67100100	MOBILIZATION	L SUM	0.5	0.5	1.0
70100460	TRAFFIC CONTROL AND PROTECTION, STANDARD 701306	L SUM	0.5	0.5	1.0
X0325866	CENTER LINE - RUMBLE STRIP	FOOT	6,563.0		6,563.0
64200105	SHOULDER RUMBLE STRIPS	FOOT		81,176	81,176

STATION EQUATIONS FOR IL 149

838+88.7 BK = 838+85.52 AH
 846+66.6 BK = 846+26.10 AH
 859+37.90 BK = 859+40.50 AH
 932+34.69 BK = 932+33.25 AH
 1002+58.9 BK = 1002+59.87 AH
 1016+56.20 BK = 1016+58.91 AH
 1042+33.09 BK = 1042+34.23 AH
 1076+44.97 BK = 1076+47.32 AH
 1120+16.89 BK = 1120+17.96 AH
 1139+53.68 BK = 1139+52.85 AH
 1171+24.90 BK = 1171+30.57 AH
 1219+17.00 BK = 1219+11.58 AH

FILE NAME =	USER NAME = LENZINIAD	DESIGNED -	REVISED -	STATE OF ILLINOIS DEPARTMENT OF TRANSPORTATION	SUMMARY OF QUANTITIES	F.A.P. RTE.	SECTION	COUNTY	TOTAL SHEETS	SHEET NO.
c:\pwork\pwork\lenziniad\0239191\7824-Design-rest.dgn		DRAWN -	REVISED -			*	(9-3,10-3,1071)-1	*	10	4
PLOT SCALE = 1/8" = 1' IN.		CHECKED -	REVISED -							
PLOT DATE = 3/24/2011		DATE -	REVISED -		SCALE: _____ SHEET NO. 3 OF XX SHEETS STA. _____ TO STA. _____					
						CONTRACT NO. 78224				
						FED. ROAD DIST. NO. ILLINOIS FED. AID PROJECT				

TYPICAL SECTION
US 51 (FAP 322)
(NOT TO SCALE)

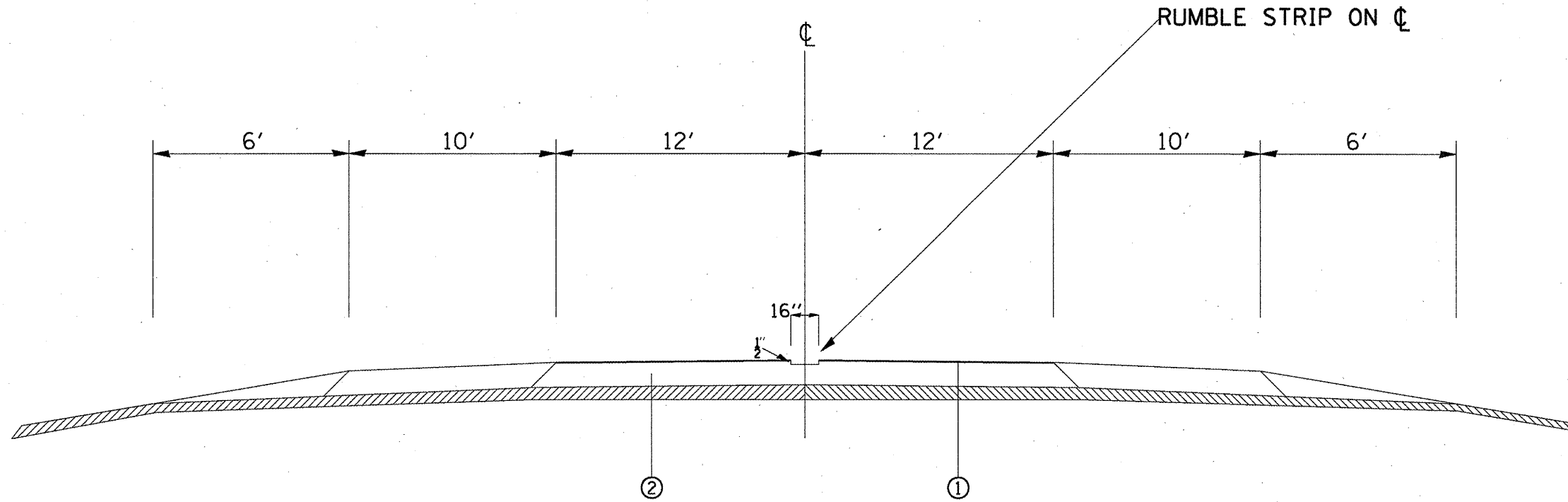

TO BE USED:
STA 8+283 TO STA 10+950 - METRIC
STA 0+00 TO STA 87+50 - ENGLISH

LEGEND

- ① BITUMINOUS CONCRETE SURFACE COURSE, SUPERPAVE, MIX "D", N90, 40MM OR 1-1/2"
- ② BITUMINOUS CONCRETE BINDER COURSE, SUPERPAVE, IL-19.0, N90, 320MM OR 1'-1/2"

FILE NAME =	USER NAME = LENZINIAD	DESIGNED -	REVISED -	STATE OF ILLINOIS DEPARTMENT OF TRANSPORTATION	TYPICAL SECTION NOT TO SCALE	F.A.P. RTE.	SECTION	COUNTY	TOTAL SHEETS	SHEET NO.
et:\pwork\pwork\lenziniad\0239191\7824-Design-rest.dgn	DRAWN -	REVISED -	.			(9-3,10-3,1071)-1	.	10	5	
PLOT SCALE = 1/32" = 1/8" / IN.	CHECKED -	REVISED -	CONTRACT NO. 78224							
PLOT DATE = 3/1/2011	DATE -	REVISED -	FED. ROAD DIST. NO. ILLINOIS FED. AID PROJECT							
						SCALE: _____	SHEET NO. 5 OF XX SHEETS	STA. _____ TO STA. _____		

TYPICAL SECTION
 US 149 (FAP 873)
 (NOT TO SCALE)

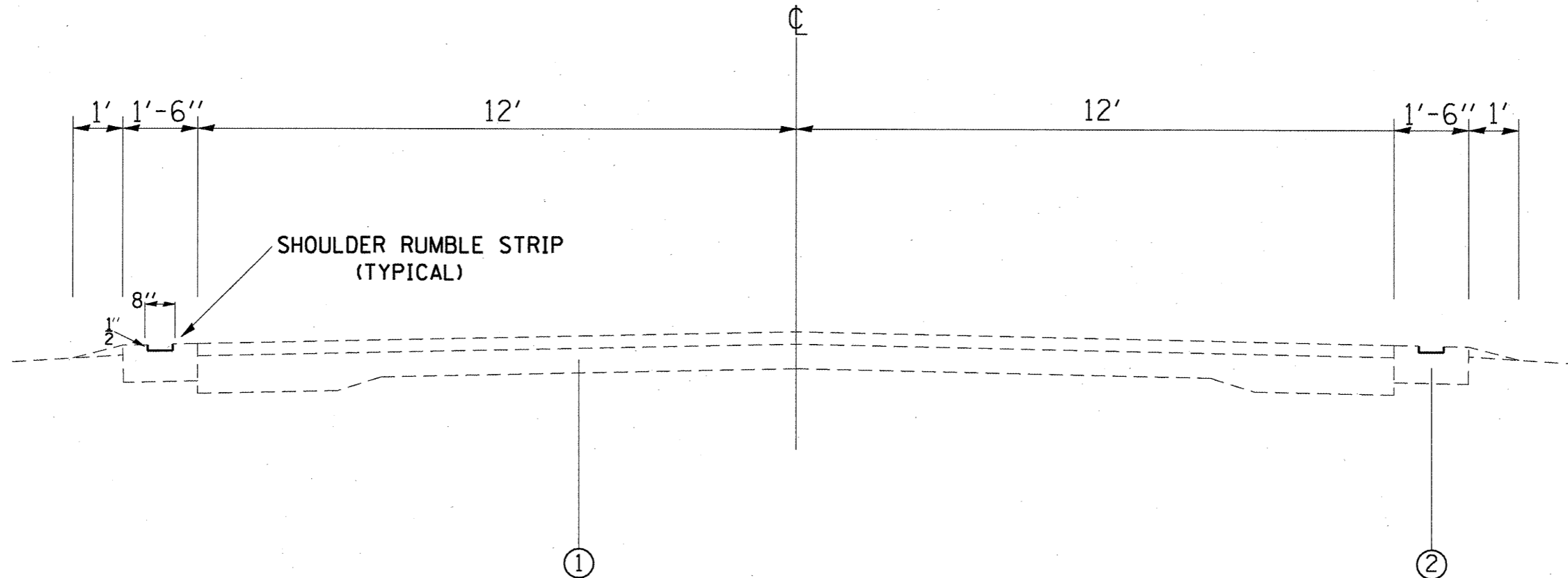

TO BE USED:
 STA 832+32 TO STA 1238+20

LEGEND

- ① EXISTING HMA SURFACED CONCRETE PAVEMENT
- ② EXISTING 8" HMA SHOULDER

FILE NAME =	USER NAME = LENZINIAD	DESIGNED -	REVISD -	STATE OF ILLINOIS DEPARTMENT OF TRANSPORTATION	TYPICAL SECTION		F.A.P. RTE.	SECTION	COUNTY	TOTAL SHEETS	SHEET NO.
o:\pwork\pwork\lenziniad\8239191\782	4-Design-rest.dgn	DRAWN -	REVISD -		NOT TO SCALE		*	(9-3,10-3,107)I-1	*	10	6
	PLOT SCALE = 1/8" = 1' / IN.	CHECKED -	REVISD -		SCALE: _____	SHEET NO. 5 OF XX SHEETS	STA. _____ TO STA. _____	CONTRACT NO. 78224			
	PLOT DATE = 3/8/2011	DATE -	REVISD -		FED. ROAD DIST. NO. - ILLINOIS FED. AID PROJECT						

CENTERLINE RUMBLE STRIP DETAIL

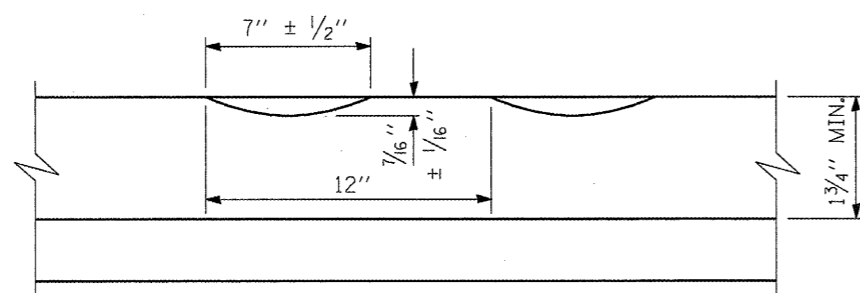

SECTION A-A

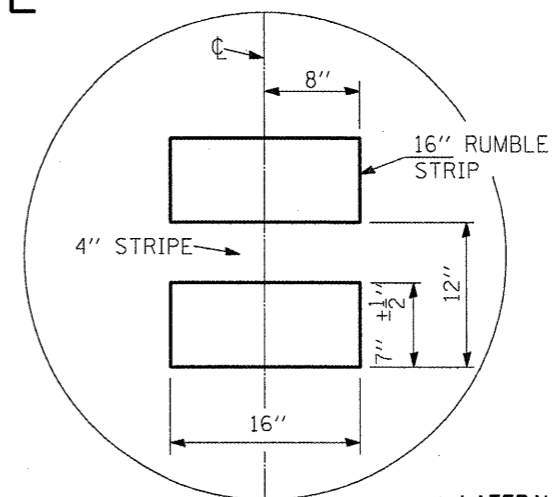

* LATERAL DEVIATION SHALL NOT EXCEED ONE INCH IN 100 FEET.

DETAIL B

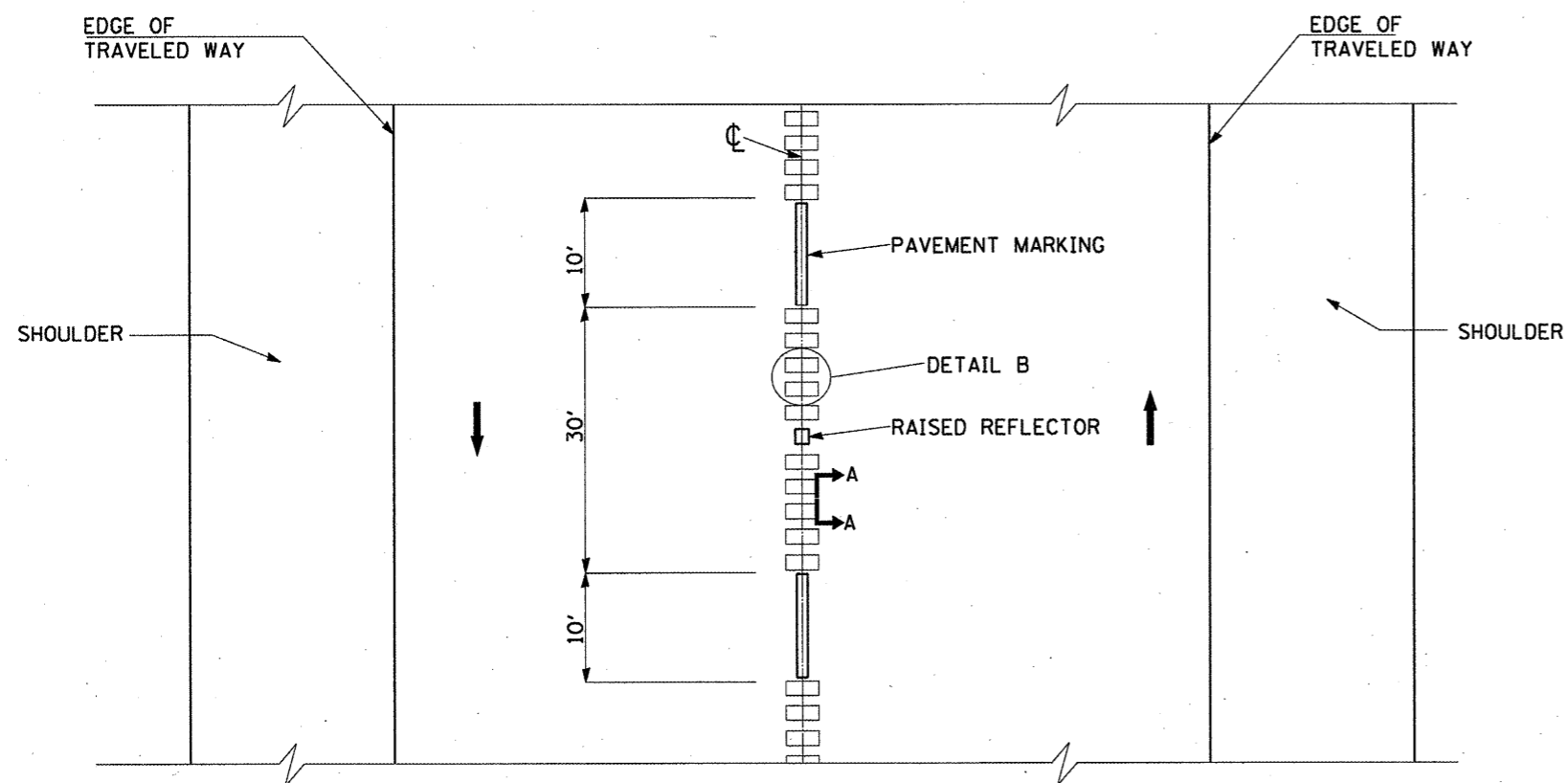

TWO-WAY ROAD

GENERAL NOTES

SEE STANDARD 780001 FOR SKIP DASH STRIPING.

RUMBLE STRIPS SHALL NOT BE PLACED ON BRIDGES.

ALL RUMBLE STRIPS SHALL BE MILLED.

CENTERLINE RUMBLE STRIPS SHALL BE CONTINUOUS THROUGH CONNECTIONS OF SIDEROADS WITH NO LEFT TURN LANES.

DISCONTINUE CENTERLINE RUMBLE STRIPS THROUGH THE LIMITS OF ALL LEFT TURN LANES, INCLUDING ANY LANE TAPER SECTIONS.

ADJUST SPACING OF RUMBLE STRIPS TO FALL BETWEEN RAISED REFLECTIVE PAVEMENT MARKERS AND EXISTING SKIP DASH PAVEMENT MARKERS.

SEE STANDARD 701306 FOR TRAFFIC CONTROL.

FILE NAME =	USER NAME = LENZINIAD	DESIGNED -	REVISED -	STATE OF ILLINOIS DEPARTMENT OF TRANSPORTATION	CENTERLINE RUMBLE STRIP DETAIL		F.A.P. RTE.	SECTION	COUNTY	TOTAL SHEETS	SHEET NO.
et:\pw_work\p1dot\lenzimed\0239191\7824-Design-rest.dgn	4-Design-rest.dgn	DRAWN -	REVISED -		NOT TO SCALE		*	(9-3.10-3.1071-1)	*	10	7
PLOT SCALE = 1/8" = 1' / IN.		CHECKED -	REVISED -		SCALE: _____	SHEET NO. 5 OF XX SHEETS	STA. _____	TO STA. _____	CONTRACT NO. 78224		
PLOT DATE = 3/24/2011		DATE -	REVISED -		FED. ROAD DIST. NO. ILLINOIS FED. AID PROJECT						

SHOULDER RUMBLE STRIP DETAIL

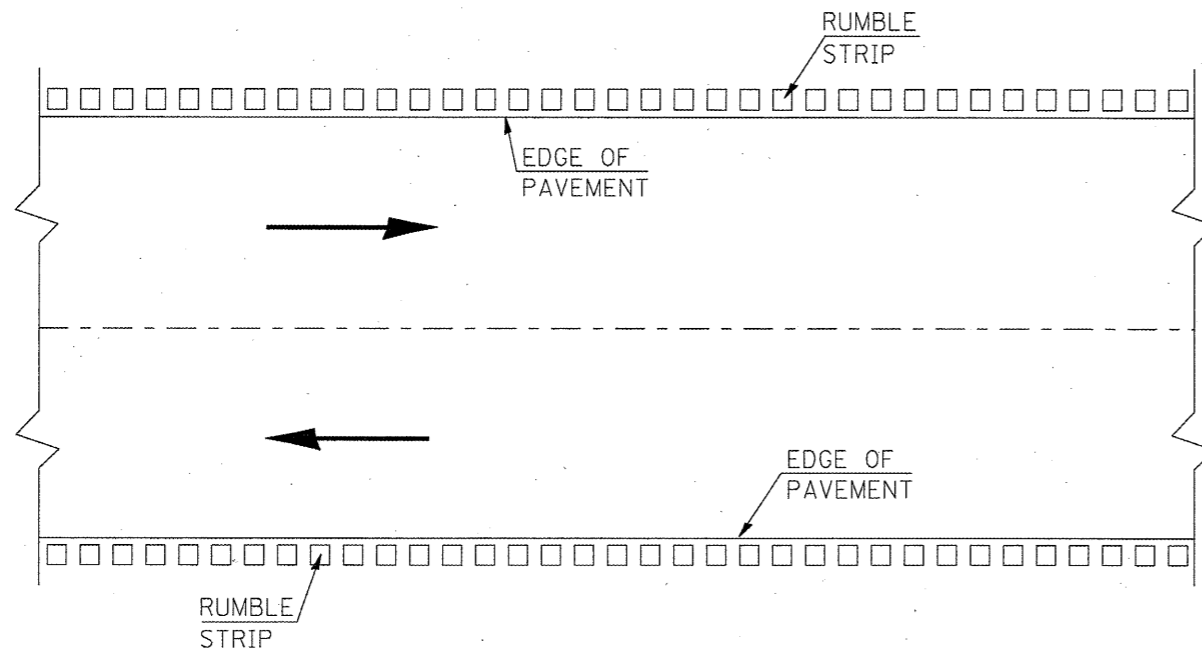

PLAN VIEW

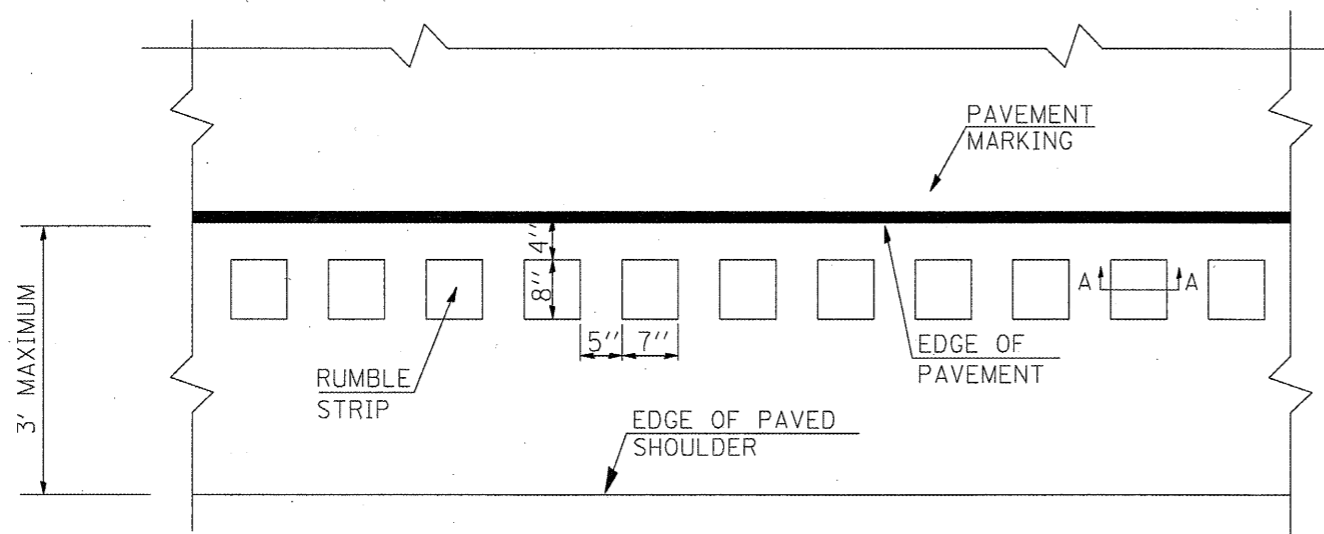

PLAN FOR RUMBLE STRIP

GENERAL NOTES

OMIT SHOULDER RUMBLE STRIPS ACROSS STRUCTURES AND SIDE ROADS.

ON PORTLAND CEMENT CONCRETE SHOULDERS, NO SHOULDER RUMBLE STRIP SHALL BE LOCATED CLOSER THAN 7" TO A TRANSVERSE JOINT.

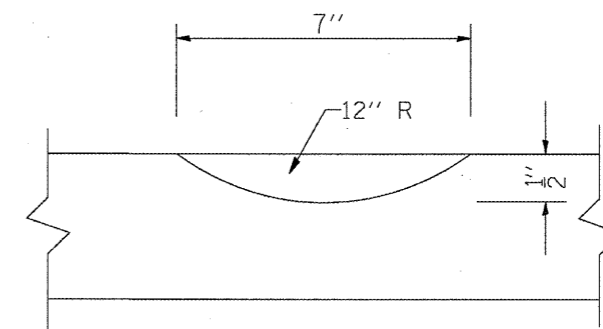

SECTION A-A

FILE NAME =	USER NAME = LENZINIAD	DESIGNED -	REVISED -	STATE OF ILLINOIS DEPARTMENT OF TRANSPORTATION	SHOULDER RUMBLE STRIP DETAIL NOT TO SCALE	F.A.P. RTE.	SECTION	COUNTY	TOTAL SHEETS	SHEET NO.
o:\pwork\pwork\lenziniad\08239191\7824-Design-rest.dgn	DRAWN -	REVISED -	(9-3,10-3,107)-1				10	8		
PLOT SCALE = 1/8" = 1' IN.	CHECKED -	REVISED -	CONTRACT NO. 78224							
PLOT DATE = 3/8/2011	DATE -	REVISED -	FED. ROAD DIST. NO. ILLINOIS FED. AID PROJECT							
				SCALE: _____ SHEET NO. 5 OF XX SHEETS STA. _____ TO STA. _____		FAP 322/873, JACKSON AND FRANKLIN COUNTY				

PLAN VIEW US 51 (FAP 322)

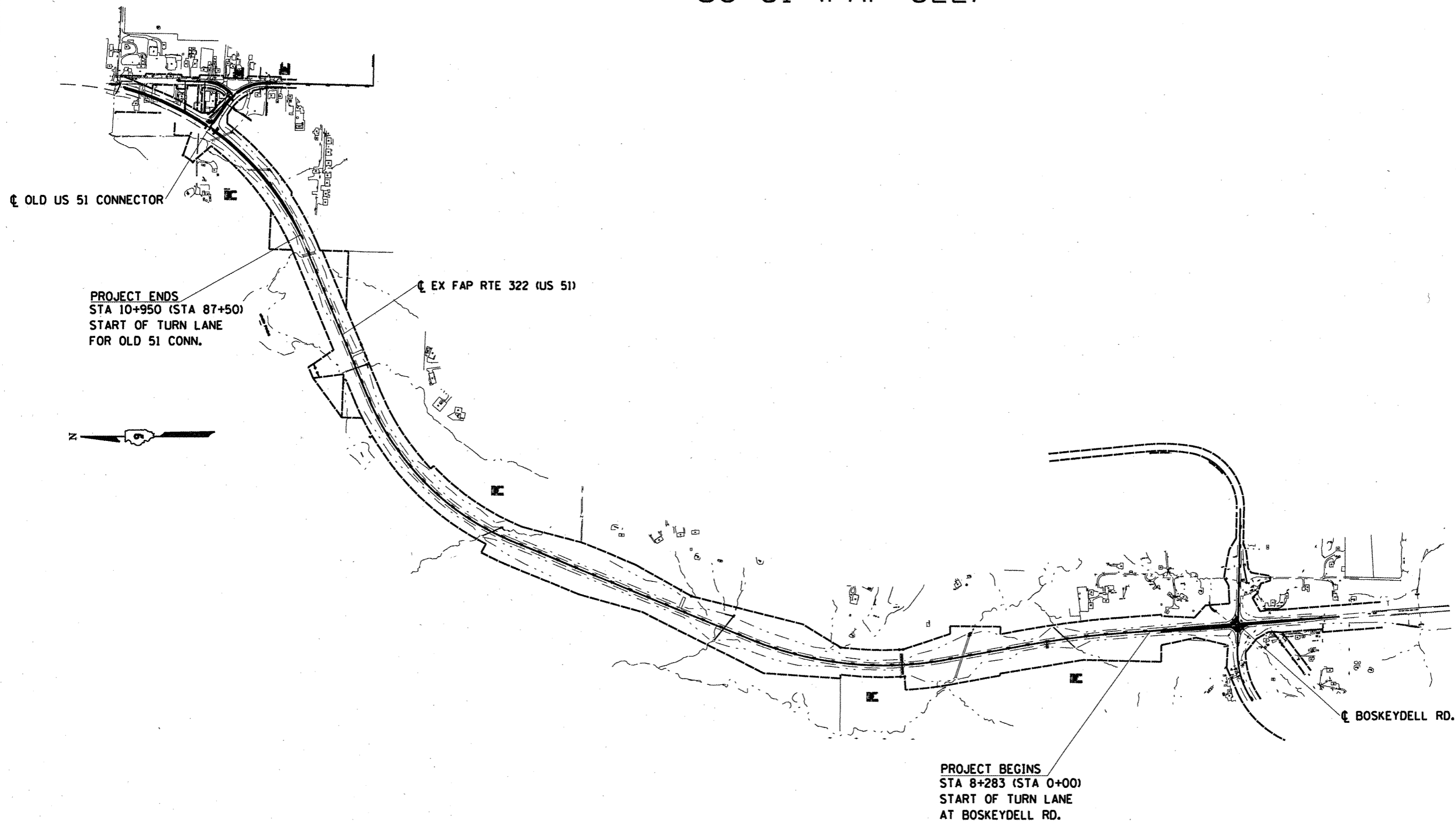

FILE NAME =	USER NAME = LENZINIAD	DESIGNED -	REVISED -	STATE OF ILLINOIS DEPARTMENT OF TRANSPORTATION	PLAN SHEET	F.A.P. RTE.	SECTION	COUNTY	TOTAL SHEETS	SHEET NO.
ca:\priv_work\pwsdot\lenziniad\023191\78224-Design-rest.dgn		DRAWN -	REVISED -			.	(9-3.10-3.1071)-1	.	10	9
PLOT SCALE = 1/8" = 1' / IN.		CHECKED -	REVISED -							
PLOT DATE = 3/8/2011		DATE -	REVISED -		SCALE: SHEET NO. 5 OF XX SHEETS STA. TO STA.					CONTRACT NO. 78224
						FED. ROAD DIST. NO. - ILLINOIS FED. AID PROJECT				

PLAN VIEW US 149 (FAP 873)

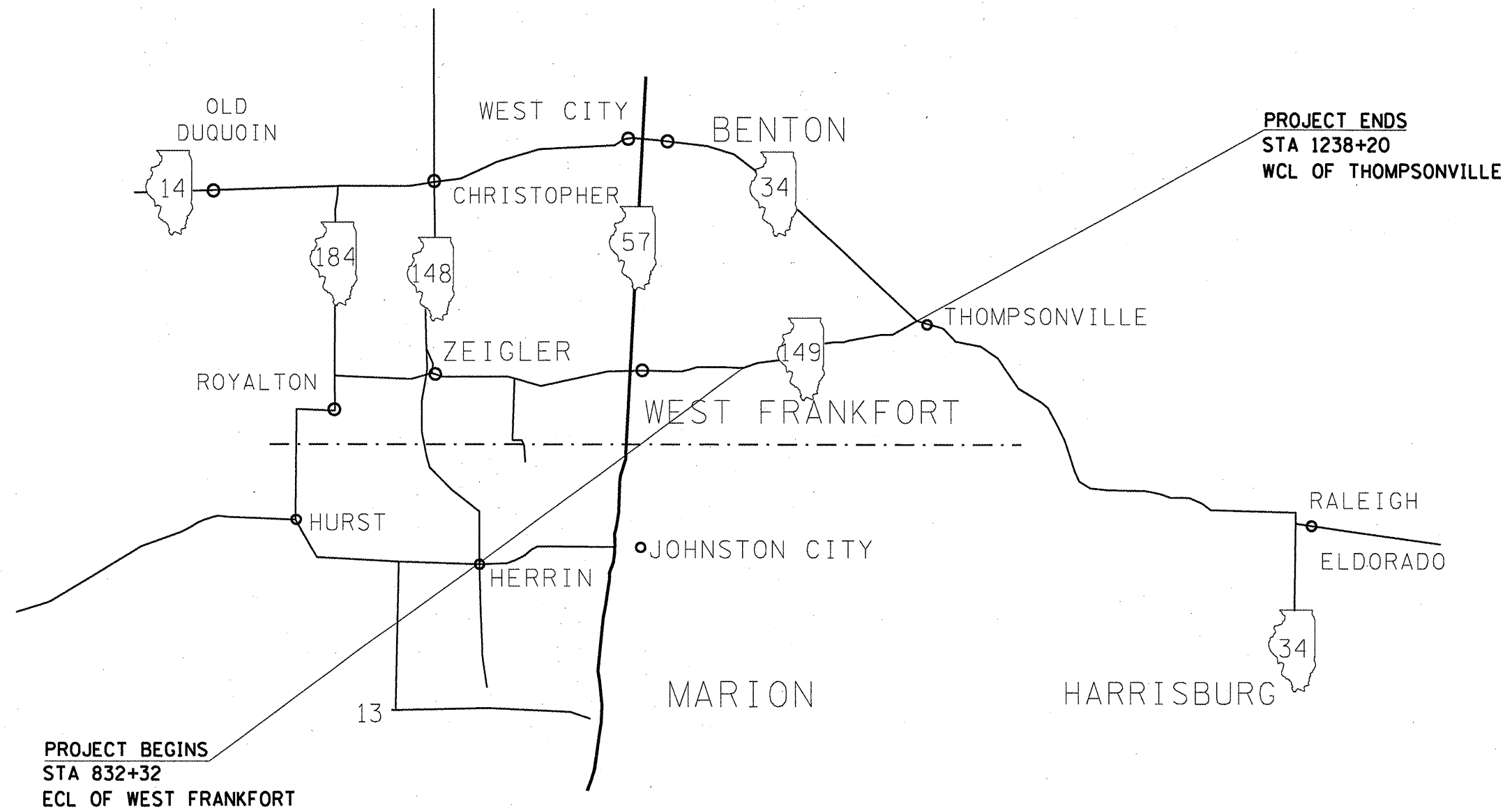

PROJECT BEGINS
STA 832+32
ECL OF WEST FRANKFORT

PROJECT ENDS
STA 1238+20
WCL OF THOMPSONVILLE

FILE NAME =	USER NAME = LENZINIAD	DESIGNED -	REVISED -
ci:\pwork\pwork\lenziniad\08239191\7824-Design-rest.dgn		---	-----
PLOT SCALE = 103.1218 / / IN.		DRAWN -	REVISED -
PLOT DATE = 3/3/2011		---	-----
		CHECKED -	REVISED -
		---	-----
		DATE -	REVISED -
		-----	-----

**STATE OF ILLINOIS
DEPARTMENT OF TRANSPORTATION**

----- PLAN SHEET -----	
SCALE:	SHEET NO. 5 OF XX SHEETS
STA.	TO STA.

F.A.P. RTE.	SECTION	COUNTY	TOTAL SHEETS	SHEET NO.
•	(9-3.10-3.107)1-1	•	10	10
CONTRACT NO. 78224				
FED. ROAD DIST. NO. ILLINOIS FED. AID PROJECT				