

Bench Mark: CB-1, BM Elev. 100.00 (assumed), chiseled 'C' in southwest wingwall of existing SN 053-3041
 Existing Structure: SN 053-3041 built in 1924 as the Camelin Bridge in the Long Point Township at Station 10+00.00. The existing structure is a single span RC thru Girder supported by closed abutments which is 47.3' back to back of abutments and 24.1' face to face of existing concrete parapets. Traffic will be detoured during construction.

ROUTE NO.	SECTION	COUNTY	TOTAL SHEETS	SHEET NO.
FAS 267	*	LIVINGSTON	25	8
FED. ROAD DIST. NO.		ILLINOIS	FED. AID PROJECT	
		Contract #87450	*06-00169-01-BR	

No Salvage

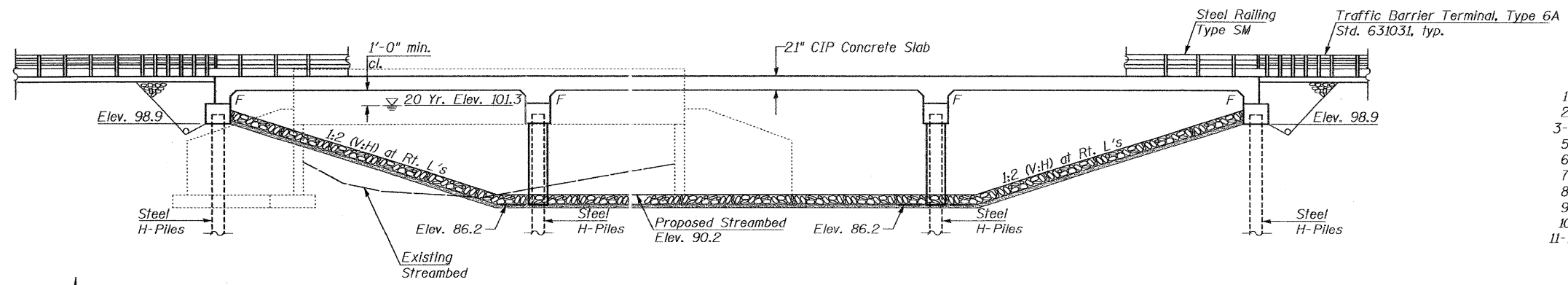

INDEX OF SHEETS

- 1 General Data
- 2 General Data
- 3-4 Top of Slab Elevations
- 5 Superstructure
- 6 Superstructure Details
- 7 Steel Railing, Type SM
- 8 Abutments
- 9 Piers
- 10 HP Pile Details
- 11-12 Boring Logs

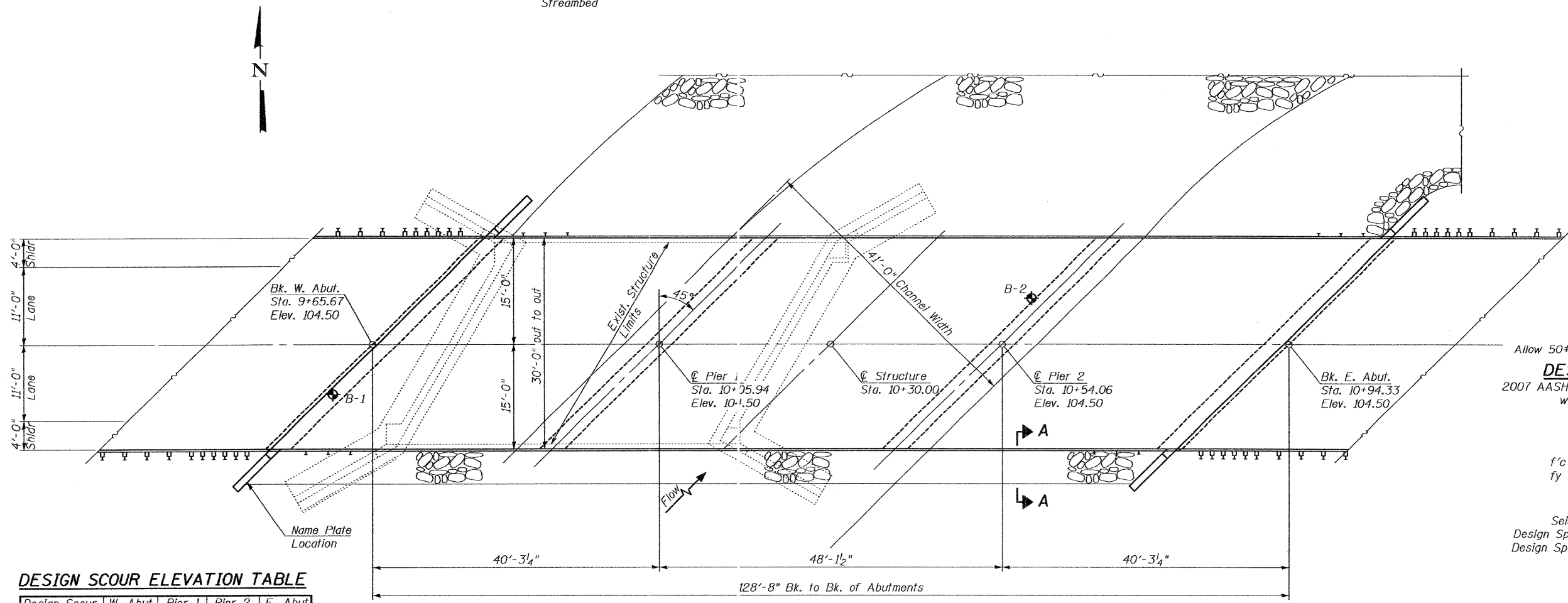

DESIGN SCOUR ELEVATION TABLE

Design Scour Elevation (ft)	W. Abut.	Pier 1	Pier 2	E. Abut.
	98.9	86.02	86.02	98.9

LOADING HL-93
 Allow 50# / sq. ft. for future wearing surface.

DESIGN SPECIFICATIONS
 2007 AASHTO LRFD Bridge Design Specifications with 2008 and 2009 Interims

DESIGN STRESSES

FIELD UNITS

f'c = 3,500 psi
 fy = 60,000 psi (Reinforcement)

SEISMIC DATA

Seismic Performance Zone (SPZ) = 1
 Design Spectral Acceleration at 1.0 sec. (SD1) = 0.078 g
 Design Spectral Acceleration at 0.2 sec. (SD5) = 0.14 g
 Soil Site Class = C

See Sheet 2 of 12 for Section A-A and Section B-B

PLAN

WATERWAY INFORMATION

Drainage Area = 17.0 Sq. Mi. Low Grade Elev. 100.3 @ Sta. 13+00

Flood	Freq. Yr.	Q C.F.S.	Opening Sq. Ft.		H.W.E.		Head - Ft.		Headwater El.	
			Exist.	Prop.	Exist.	Prop.	Exist.	Prop.	Exist.	Prop.
Design	20	2335	269	669	101.34	0.57	0.62	101.91	101.96	
Base	100	3744	269	786	102.46	0.26	0.96	102.72	103.42	
Overtopping										
Max. Calc.	500	5060	269	786	103.31	0.24	0.93	103.55	104.24	

Max. Rec. H.W.E. = 102.3 ft.

R. 3 E. 3rd. P.M.

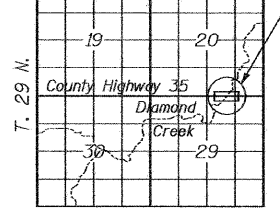

LOCATION SKETCH

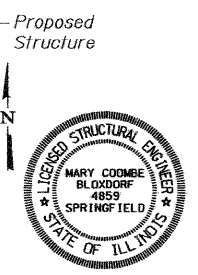

Mary Coombe Bloxdorf
 ILLINOIS STRUCTURAL NO. 4859
 EXPIRES 11/30/10
 DATE: 3/30/11

SHEET TITLE
 GENERAL PLAN & ELEVATION

PROJECT	C.H. 35 OVER DIAMOND CREEK	PROJECT NO.	06079
	FAS RTE. 267 SEC. 06-00169-01-BR	DATE	3/29/11
	LIVINGSTON COUNTY	DESIGN BY	CME/MCB
	STATION 10+30.00	DRAWN BY	TFG/CFC
	STRUCTURE NUMBER 053-3456	CHECKED BY	CME/MCB
		DRAWING NO.	
		1 OF 12 SHTS	

PLOT DATE = 3/29/2011
 FILE NAME = BRIDGE-RT-267-01-general-plan.dgn
 PLOT SCALE = 81000000 1" = 100'
 USER NAME = CFC

DIAMOND CREEK
 BUILT 201 BY
 LIVINGSTON COUNTY
 SEC. 06-00169-01-BR
 F.A.S. RTE. 267 STA. 10+30.00
 STR. NO. 053-3456 LOADING HL93

NAME PLATE
 See Std. 515001

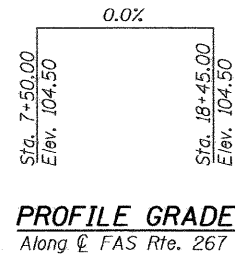

PROFILE GRADE
 Along & FAS Rte. 267