

ROUTE NO.	SECTION	COUNTY	TOTAL SHEETS	SHEET NO.
F.A.S. 267	06-00169 01-BR	LIVINGSTON	25	20
FED. ROAD DIST. NO. 7		ILLINOIS	FED. AID PROJECT	

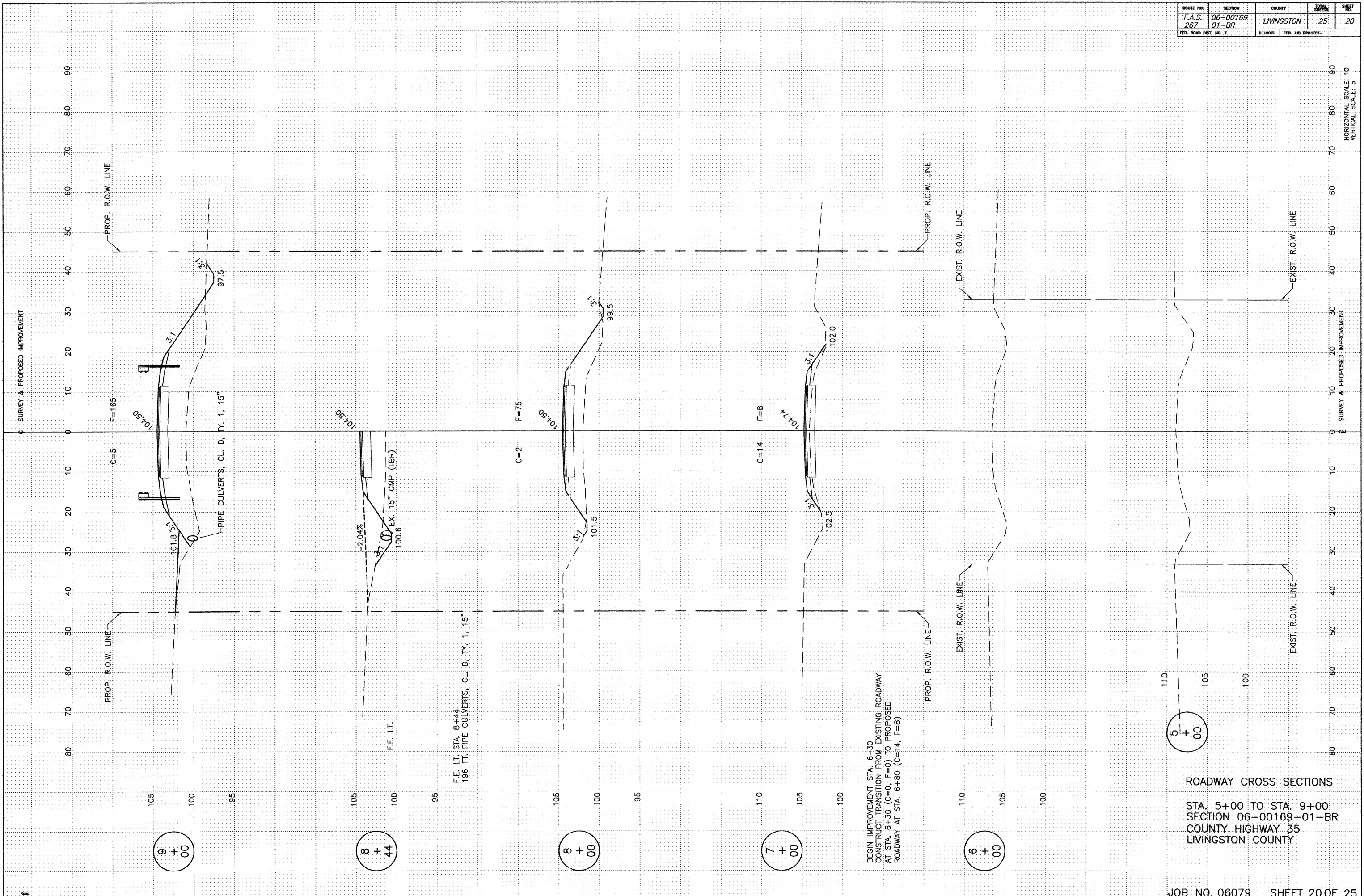

ROADWAY CROSS SECTIONS  
 STA. 5+00 TO STA. 9+00  
 SECTION 06-00169-01-BR  
 COUNTY HIGHWAY 35  
 LIVINGSTON COUNTY