

ROUTE NO.	SECTION	COUNTY	TOTAL SHEETS	SHEET NO.
F.A.S. 267	06-00169-01-BR	LIVINGSTON	25	24
FED. ROAD DIST. NO. 7		KILGORE'S FED. AID PROJECT-		

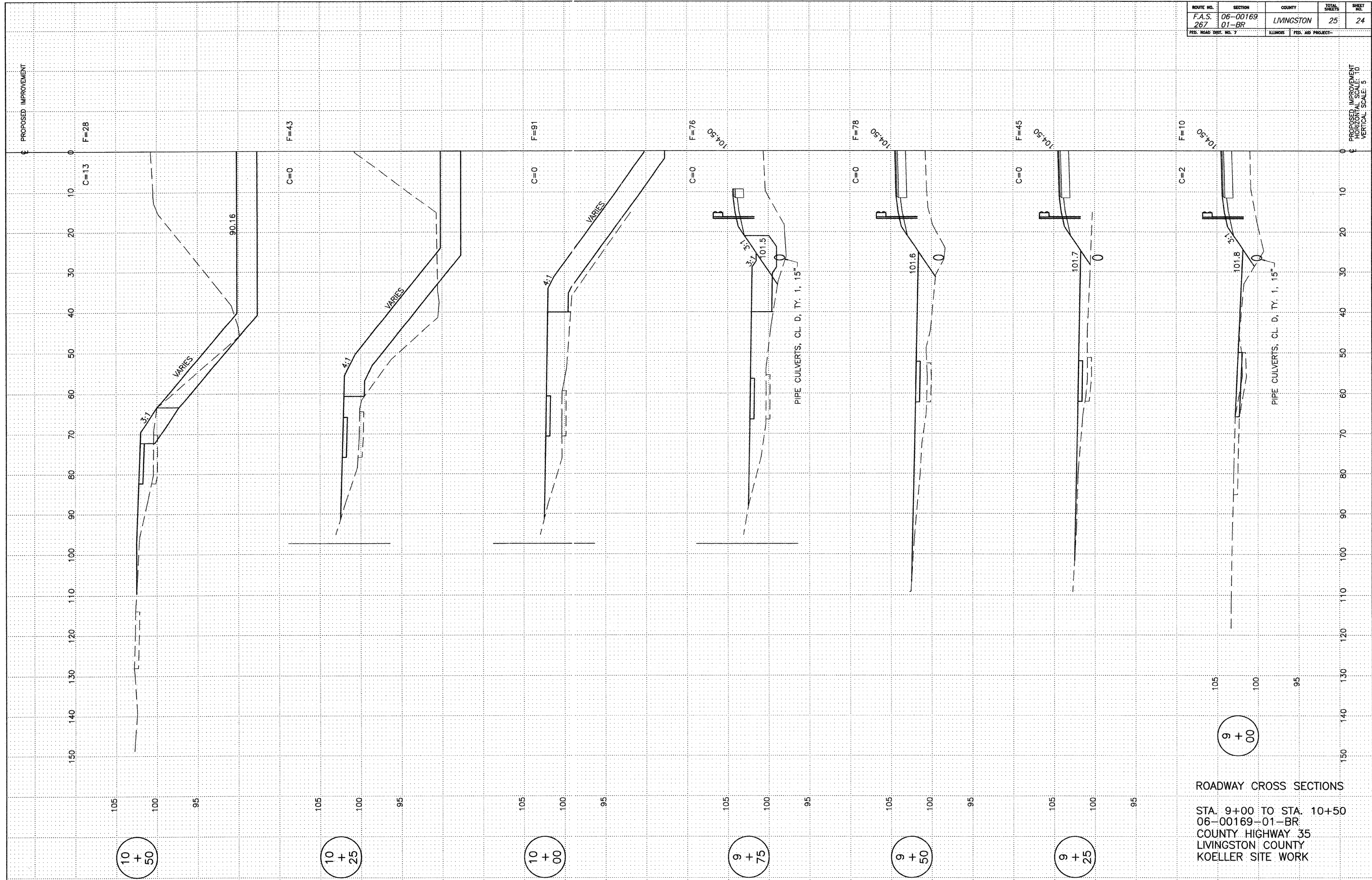

ROADWAY CROSS SECTIONS
 STA. 9+00 TO STA. 10+50
 06-00169-01-BR
 COUNTY HIGHWAY 35
 LIVINGSTON COUNTY
 KOELLER SITE WORK