

STORM STRUCTURES							
LABEL	STATION	OFFSET (FT)	TYPE	FRAME	ELEVATION	RIM/EP	INVERT
S-1	116+14	18.0 LT	DRAINAGE STRUCTURE SPECIAL	TY 24 F&G	907.42	EP	903.90 12"W
S-2	117+34	53.0 LT	PRC FLARED END SECTION				903.75 12"E
S-3	118+00	18.0 LT	MANHOLE, TYPE A, 5' DIA.	TY 24 F&G	910.81	EP	904.00 12"W
S-4	118+00	38.0 LT	PRC FLARED END SECTION				903.75 12"E

PIPES					
NO.		DIA. (IN)	LENGTH (LF)	SLOPE	TBF (CY)
P-1	STORM SEWERS, CLASS A, TYPE 1	12	20	0.75%	2
P-2	STORM SEWERS, CLASS A, TYPE 1	12	35	0.71%	5

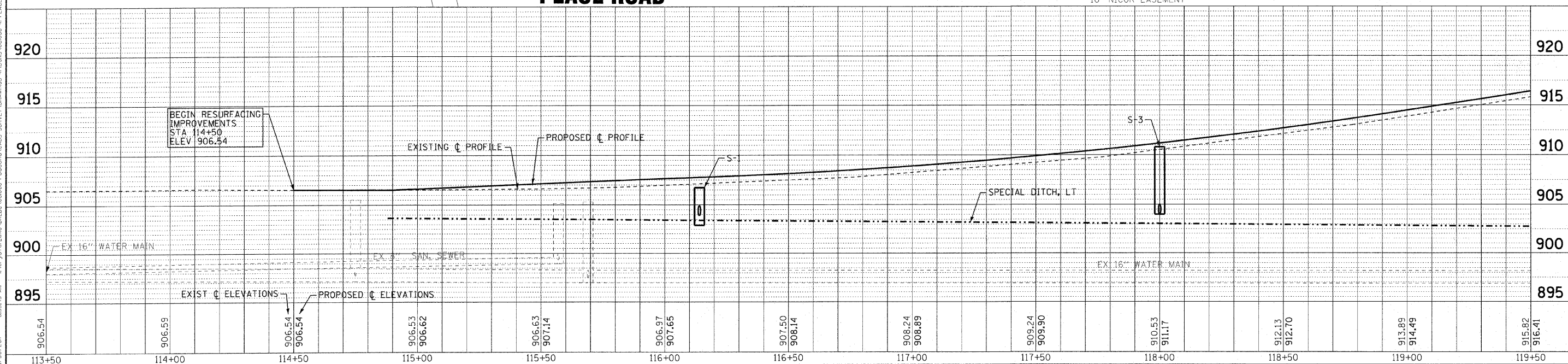

	DESIGNED -	DJS	REVISED -	
	DRAWN -	UKB	REVISED -	
	CHECKED -	RWL	REVISED -	
	DATE -	04-01-2011	REVISED -	

**CITY OF DEKALB, ILLINOIS
PEACE ROAD
IMPROVEMENTS**

**DRAINAGE AND UTILITY
PEACE ROAD**

SCALE: H: 1"=20' V: 1"=5' STA. 113+50 TO STA. 119+50

F.A.U. RTE. 5369	SECTION 06-00172-01-WR	COUNTY DeKalb	TOTAL SHEETS 33	SHEET NO. 18
FED. ROAD DIST. NO. 3 ILLINOIS			CONTRACT NO. 87488	
FED. AID PROJECT W-5017045				

DESIGNED BY: WOOTEN CONSULTING ENGINEERS, INC. 1000 N. WOODSTOCK AVENUE, SUITE 100, DEKALB, IL 62521
 LICENSE NO. 08-00121 - EXPIRES 4/30/2011
 DATE: 3/20/2011 8:55:43 AM
 PROJECT: PEACE ROAD IMPROVEMENTS - SURVEY, DRAWINGS - 4' UNITS, 08/06/08 - 4' PEACE - DU - PP - 050

MATCH LINE STA. 119+50 - SEE SHEET NO. 19