

1. ALL ADJUSTMENT OF EXISTING UTILITY VALVES, MANHOLES, ETC., NOT OWNED BY THE CITY OF JACKSONVILLE, WILL BE COORDINATED BY THE CONTRACTOR WITH THE INDIVIDUAL UTILITY.

PLAN	SURVEYED	DATE
NO.	PLOTTED	BY
	CHECKED	
	RT. OF WAY CHECKED	
	CADD FILE NAME	

PROFILE	SURVEYED	DATE
NO.	PLOTTED	BY
	CHECKED	
	STRUCTURE NOTATIONS CHKD	

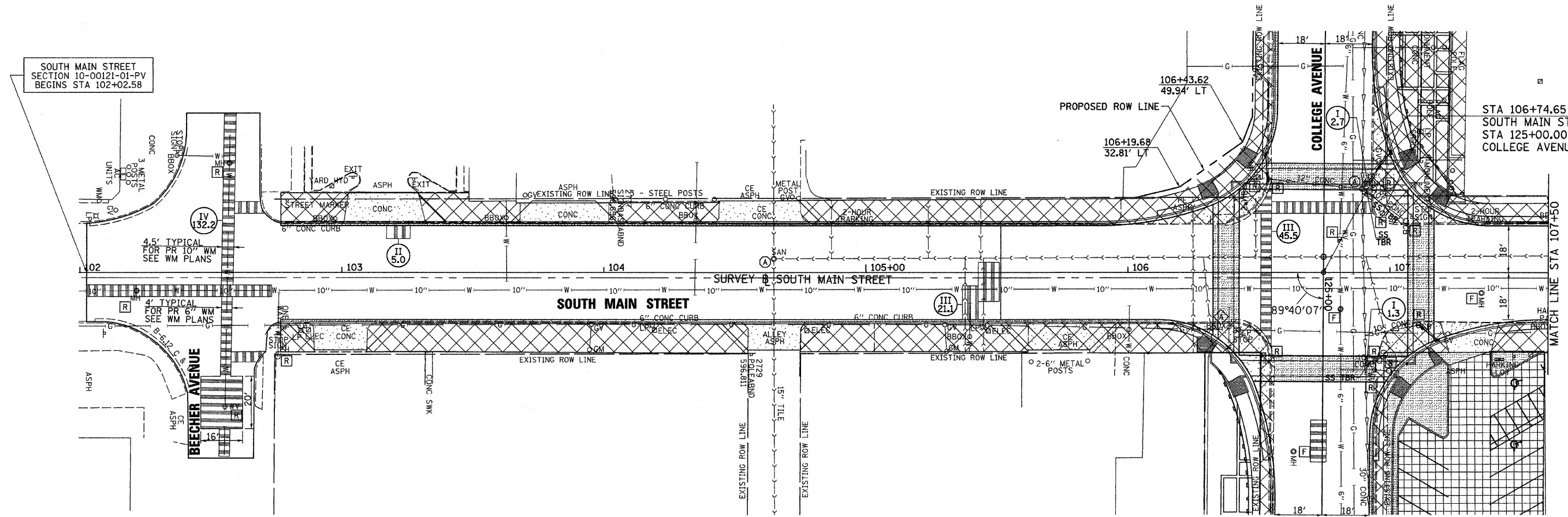

LEGEND

(A)	FRAME AND LID TO BE ADJUSTED	[Hatched Box]	PAVEMENT REMOVAL
(A)	DOMESTIC SERVICE BOX TO BE ADJUSTED	[Horizontal Lines Box]	PAVEMENT PATCHING
(A)	WATER VALVE TO BE ADJUSTED	[Vertical Lines Box]	HOT-MIX ASPHALT SURFACE REMOVAL
(R)	STRUCTURE TO BE REMOVED	[Diagonal Lines Box]	CURB & GUTTER, SIDEWALK, ETC. TO BE REMOVED
(F)	STRUCTURE TO BE FILLED	[Dotted Box]	DRIVEWAY PAVEMENT REMOVAL
(AB)	STRUCTURE TO BE ABANDONED		
(ADJ)	STRUCTURE TO BE ADJUSTED		

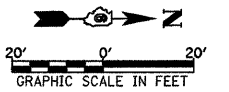

FILE NAME = v:\transportation\2893\SMADR001.dgn	USER NAME = jolson	DESIGNED - JRB	REVISED -	STATE OF ILLINOIS DEPARTMENT OF TRANSPORTATION	CITY OF JACKSONVILLE DOWNTOWN STREETS CONSTRUCTION SOUTH MAIN STREET REMOVAL SHEET			F.A. RTE.	SECTION	COUNTY	TOTAL SHEETS	SHEET NO.
	PLOT SCALE = 28.0000' / IN.	DRAWN - JMO	REVISED -					N/A	10-00121-01-PV	MORGAN	77	18
	PLOT DATE = 2/23/2011	CHECKED - JRB	REVISED -					SCALE: 1" = 20'			SHEET NO. OF SHEETS	
						FED. ROAD DIST. NO.		ILLINOIS FED. AID PROJECT				