

- NOTES**
1. ALL LETTERS AND SYMBOLS SHALL BE LARGE SIZE (8 FT. LONG)
 2. THERMOPLASTIC PAVEMENT MARKING IS ABBREVIATED AS T.P.P.M.
 3. RAISED REFLECTIVE PAVEMENT MARKER IS ABBREVIATED AS R.R.P.M.
 4. SEE PLAN AND PROFILE SHEETS FOR SIGN REMOVAL.

NO.	REVISIONS

SMS Sheppard, Morgan & Schwaab, Inc.
 CONSULTING ENGINEERS AND LAND SURVEYORS
 215 Market Street, P.O. Box E, Alton, IL 62002, 618432-2755. E-mail: smss@smssinc.com
 95 Central Industrial Drive, Suite 1, Granite City, IL 62040, 61847-2700. E-mail: smss@smssinc.com
 DESIGN FIRM # 184-000892

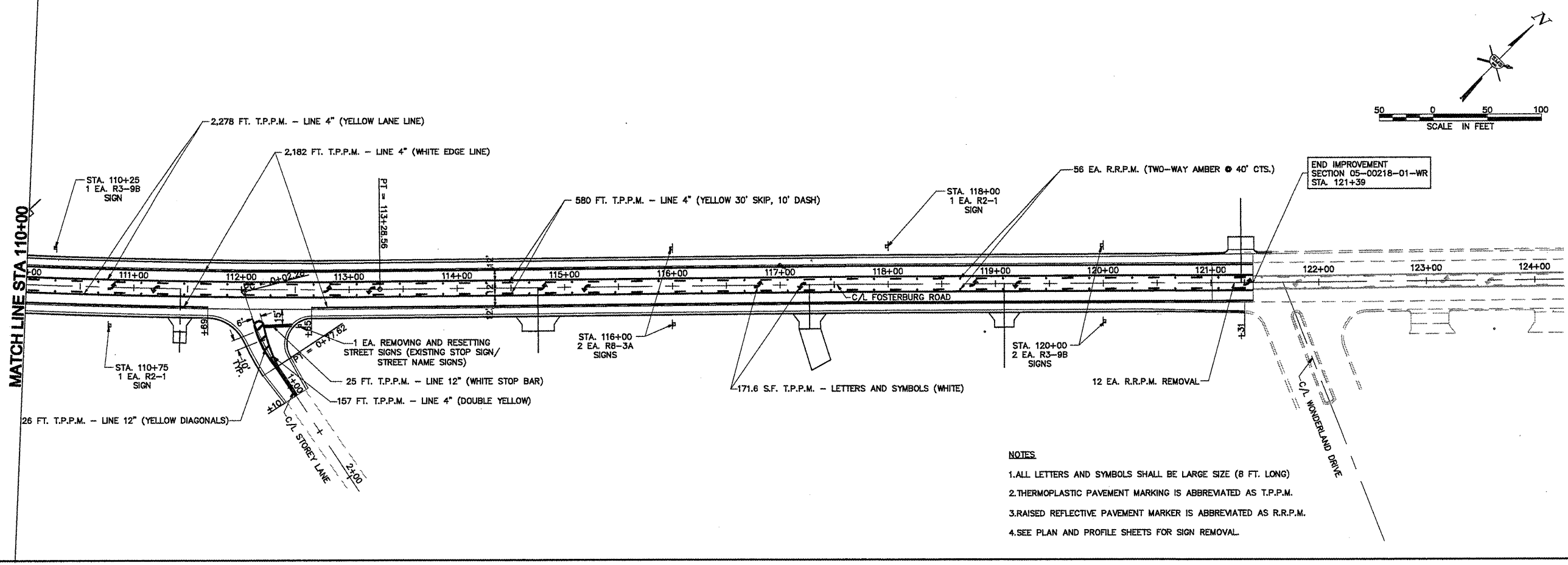

- NOTES**
1. ALL LETTERS AND SYMBOLS SHALL BE LARGE SIZE (8 FT. LONG)
 2. THERMOPLASTIC PAVEMENT MARKING IS ABBREVIATED AS T.P.P.M.
 3. RAISED REFLECTIVE PAVEMENT MARKER IS ABBREVIATED AS R.R.P.M.
 4. SEE PLAN AND PROFILE SHEETS FOR SIGN REMOVAL.

CITY OF ALTON, ILLINOIS
SECTION 05-00218-01-WR
FOSTERBURG ROAD - PHASE 2
PAVEMENT MARKING & SIGNING PLAN

DWG. NO.	FBR_PHS_PVMT_MARKING.dwg
DATE	JAN 2011
SCALE	1" = 50' H. 1" = 5' V.
SHEET	22 OF 55

X:\00-Local\Projects\ALTON\FOSTERBURG ROAD PHASE 2\0500218-01-WR\PHS_PVMT_MARKING.dwg, 07/02/2011 11:17:38 AM, gpm, 1.50