

F.A.U. RTE.	SECTION	COUNTY	TOTAL SHEETS	SHEET NO.
9266	06-00062-06-PV	ST. CLAIR	80	46
FHWA REG. NO. 7 ILLINOIS		PROJECT NO. RS-0163(035)		
FEDERAL AID PROJECT		CONTRACT NO. 97457		

TRAFFIC SIGNAL PLANS

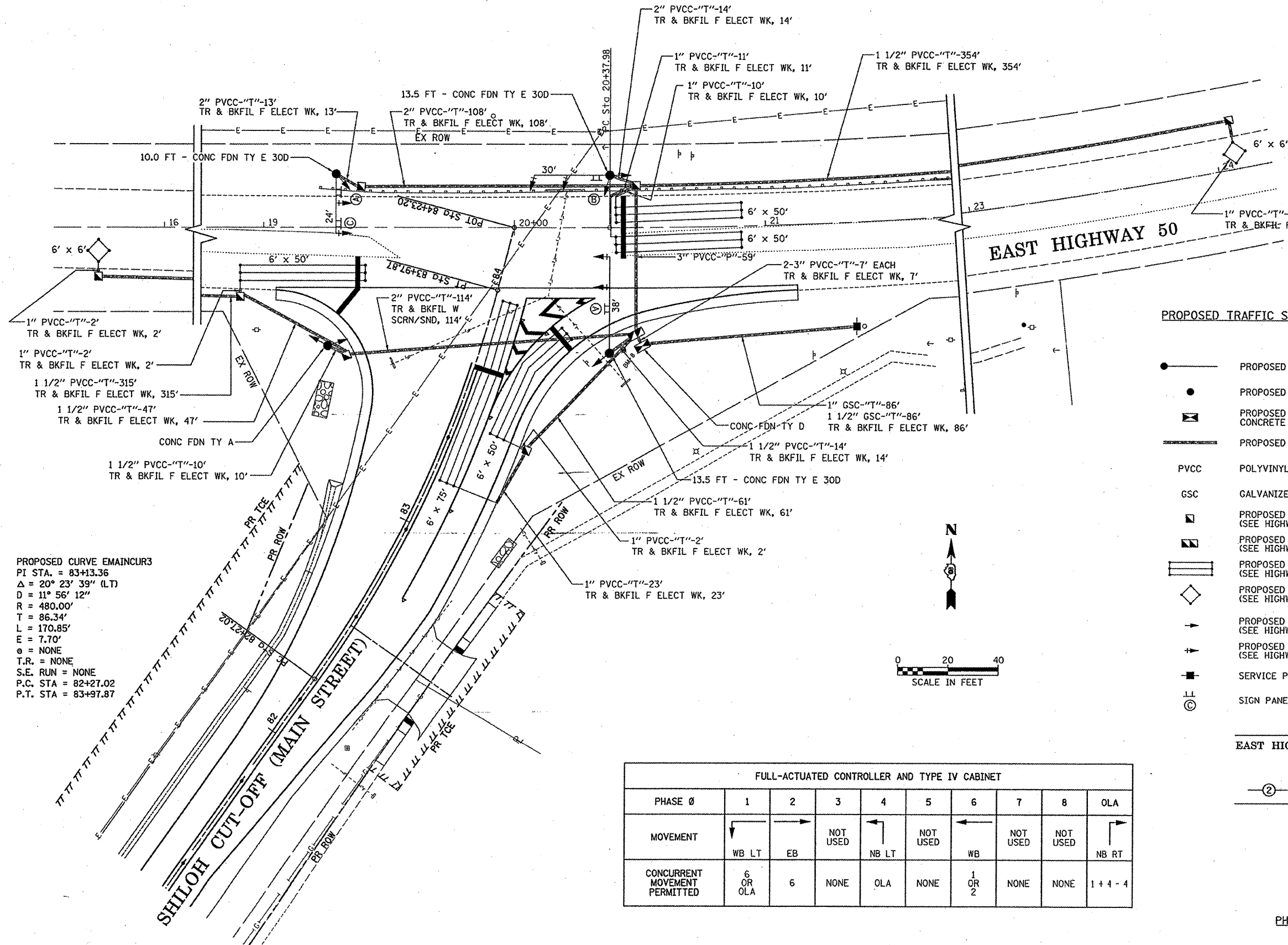

PROPOSED CURVE EMAINCUR3
 PI STA. = 83+13.36
 $\Delta = 20^\circ 23' 39''$ (LT)
 $D = 11^\circ 56' 12''$
 $R = 480.00'$
 $T = 86.34'$
 $L = 170.85'$
 $E = 7.70'$
 $\phi = \text{NONE}$
 T.R. = NONE
 S.E. RUN = NONE
 P.C. STA = 82+27.02
 P.T. STA = 83+97.87

- PROPOSED TRAFFIC SIGNALS LEGEND**
- PROPOSED STEEL MAST ARM
 - PROPOSED ALUMINUM SIGNAL POST
 - ⊞ PROPOSED CONTROLLER WITH CONCRETE FOUNDATION, TYPE D
 - PROPOSED CONDUIT: "T" TRENCH, "P" PUSHED, SIZE SPECIFIED
 - PVCC POLYVINYL CHLORIDE CONDUIT
 - GSC GALVANIZED STEEL CONDUIT
 - ◻ PROPOSED HANDHOLE (SEE HIGHWAY STANDARD 814001)
 - ◻ PROPOSED DOUBLE HANDHOLE (SEE HIGHWAY STANDARD 814006)
 - ▭ PROPOSED DETECTOR LOOP LARGE (SEE HIGHWAY STANDARDS 886001 & 886006)
 - ◊ PROPOSED DETECTOR LOOP SMALL (SEE HIGHWAY STANDARDS 886001 & 886006)
 - ↑ PROPOSED SIGNAL HEAD (SEE HIGHWAY STANDARD 880006)
 - ↑ PROPOSED SIGNAL HEAD WITH BACKPLATE (SEE HIGHWAY STANDARD 880006)
 - ⊞ SERVICE POLE (SEE HIGHWAY STANDARD 805001)
 - ⊙ SIGN PANEL (SEE SHEET 45 FOR SIGN IDENTIFICATION)

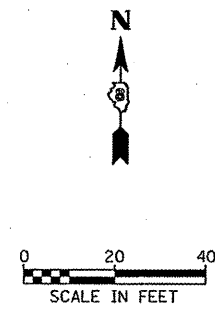

FULL-ACTUATED CONTROLLER AND TYPE IV CABINET

PHASE Ø	1	2	3	4	5	6	7	8	OLA
MOVEMENT	↙ WB LT	→ EB	NOT USED	↖ NB LT	NOT USED	← WB	NOT USED	NOT USED	↗ NB RT
CONCURRENT MOVEMENT PERMITTED	6 OR OLA	6	NONE	OLA	NONE	1 OR 2	NONE	NONE	1 + 4 - 4

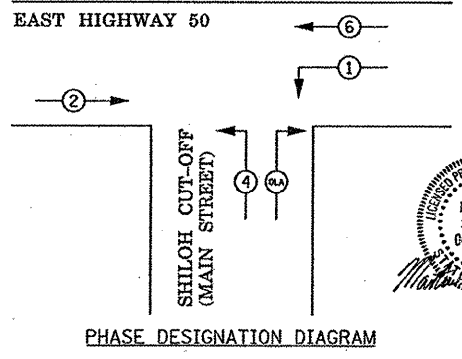

MARTIN N. SOLOMON
 062-054412
 7/20/2011
 Exp 11/30/2011