

PLAN
 SURVEYED BY _____
 PLOTTED BY _____
 NOTE BOOK NO. _____
 CHECKED BY _____
 REV. OF WAY CHECKED _____

PROFILE
 SURVEYED BY _____
 PLOTTED BY _____
 NOTE BOOK NO. _____
 CHECKED BY _____
 STRUCTURE NOTATIONS SHOWN

ROUTE NO.	SECTION	COUNTY	TOTAL SHEETS	SHEET
T.R. 212 HAHN ROAD	10-10117-00-BR	CLINTON	16	16

CONTRACT NO. 97464

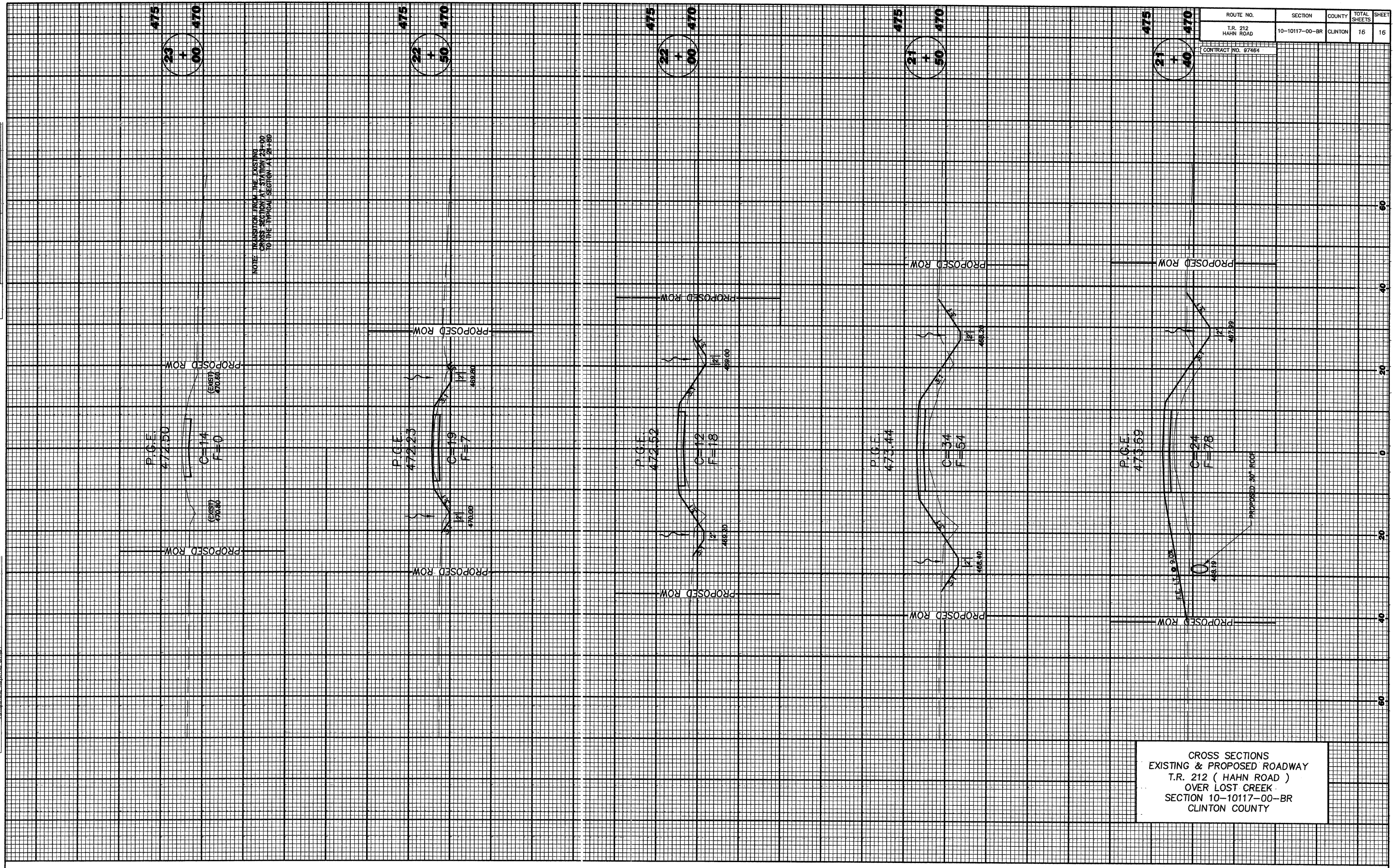

NOTE: TRANSITION FROM THE EXISTING CROSS SECTION AT STATION 23+00 TO THE TYPICAL SECTION AT 24+80

CROSS SECTIONS
 EXISTING & PROPOSED ROADWAY
 T.R. 212 (HAHN ROAD)
 OVER LOST CREEK
 SECTION 10-10117-00-BR
 CLINTON COUNTY