

STAGING NOTES

1. CHANGEABLE MESSAGE SIGNS REQUIRED FOR:
IL 14 AT US 51 AND I-57
IL 148 AT IL 154 AND AT ZEIGLER
2. IL 148 SOUTH CLOSED TO ALL TRAFFIC.
3. SEE TYPICAL SECTION FOR ROADWAY STAGING DIMENSIONS.
4. SEE SPECIAL PROVISIONS FOR CLOSING REQUIREMENTS.

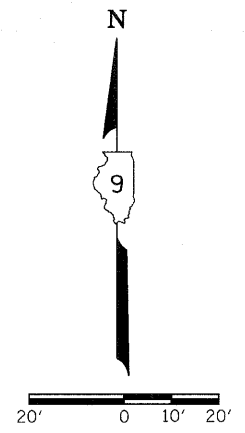
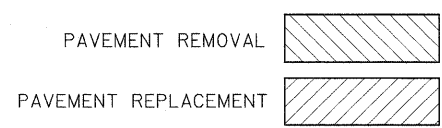
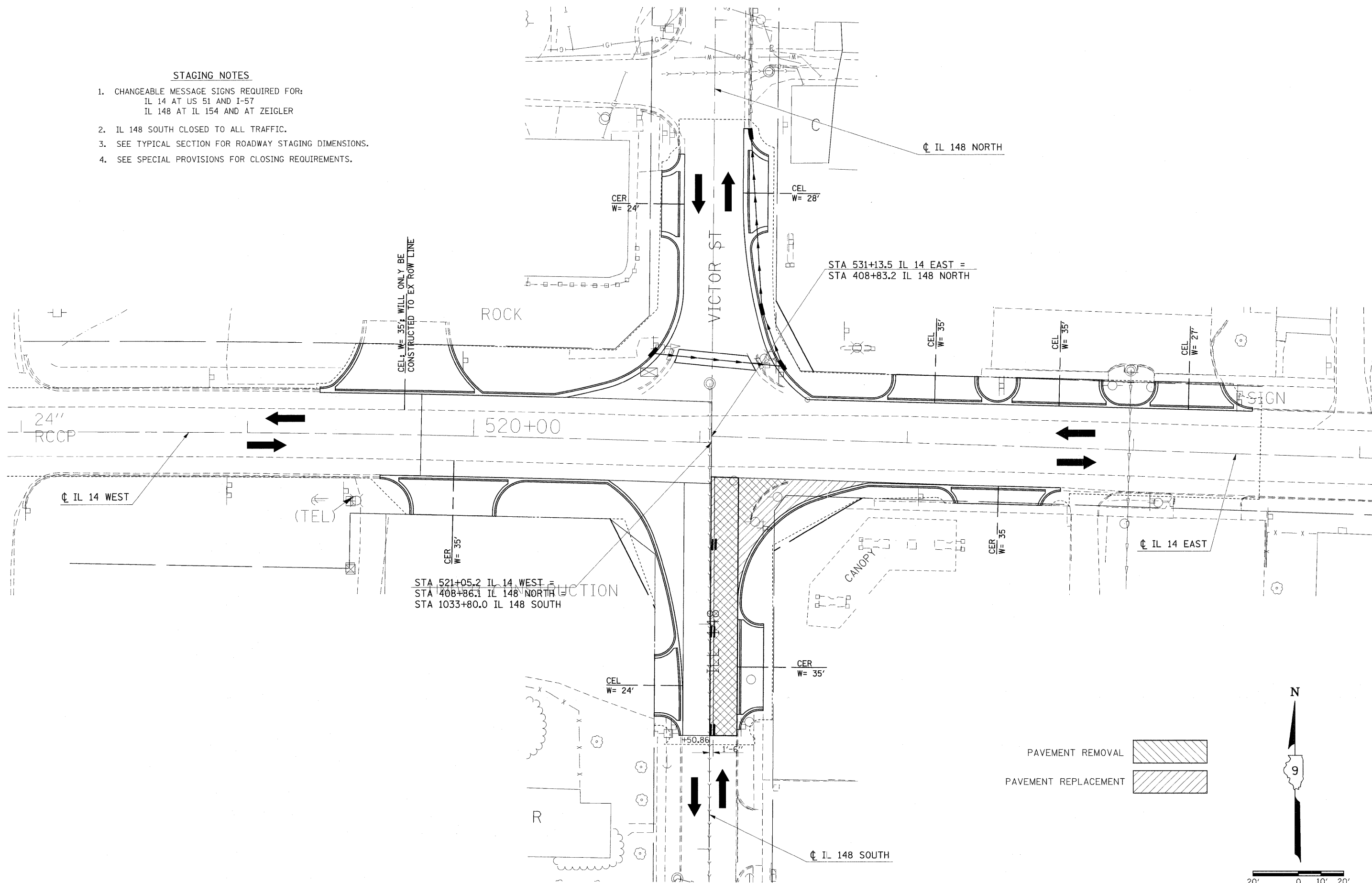

FILE NAME =	USER NAME = #USER#	DESIGNED -	REVISED -	STATE OF ILLINOIS DEPARTMENT OF TRANSPORTATION	STAGE 4: IL 14 /IL 148 INTERSECTION			F.A.P. RTE.	SECTION	COUNTY	TOTAL SHEETS	SHEET NO.			
#FILE#		DRAWN -	REVISED -		SCALE: 20	SHEET NO.	OF	SHEETS	STA.	TO STA.	869	(1-1,1,3,6)R-1,RS-3(1,3,6)B-2	*	299	63
	PLOT SCALE = #SCALE#	CHECKED -	REVISED -								* PERRY & FRANKLIN COUNTY CONTRACT NO. 98797				
	PLOT DATE = #DATE#	DATE -	REVISED -								ILLINOIS FED. AID PROJECT				