

STAGING NOTES

1. CHANGEABLE MESSAGE SIGN REQUIRED AT I-57 INTERCHANGE.
2. IL 148 SOUTHBOUND TURNING MOVEMENT CLOSED TO IL 14 WESTBOUND TRAFFIC.
3. CHANGEABLE MESSAGE SIGN REQUIRED AT ZIEGLER.
4. IL 14 EASTBOUND TURNING MOVEMENT CLOSED TO IL 148 NORTHBOUND TRAFFIC.
5. SEE TYPICAL SECTION FOR ROADWAY STAGING DIMENSIONS.

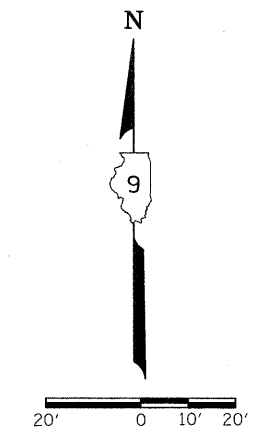
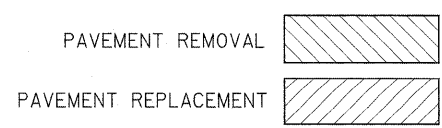
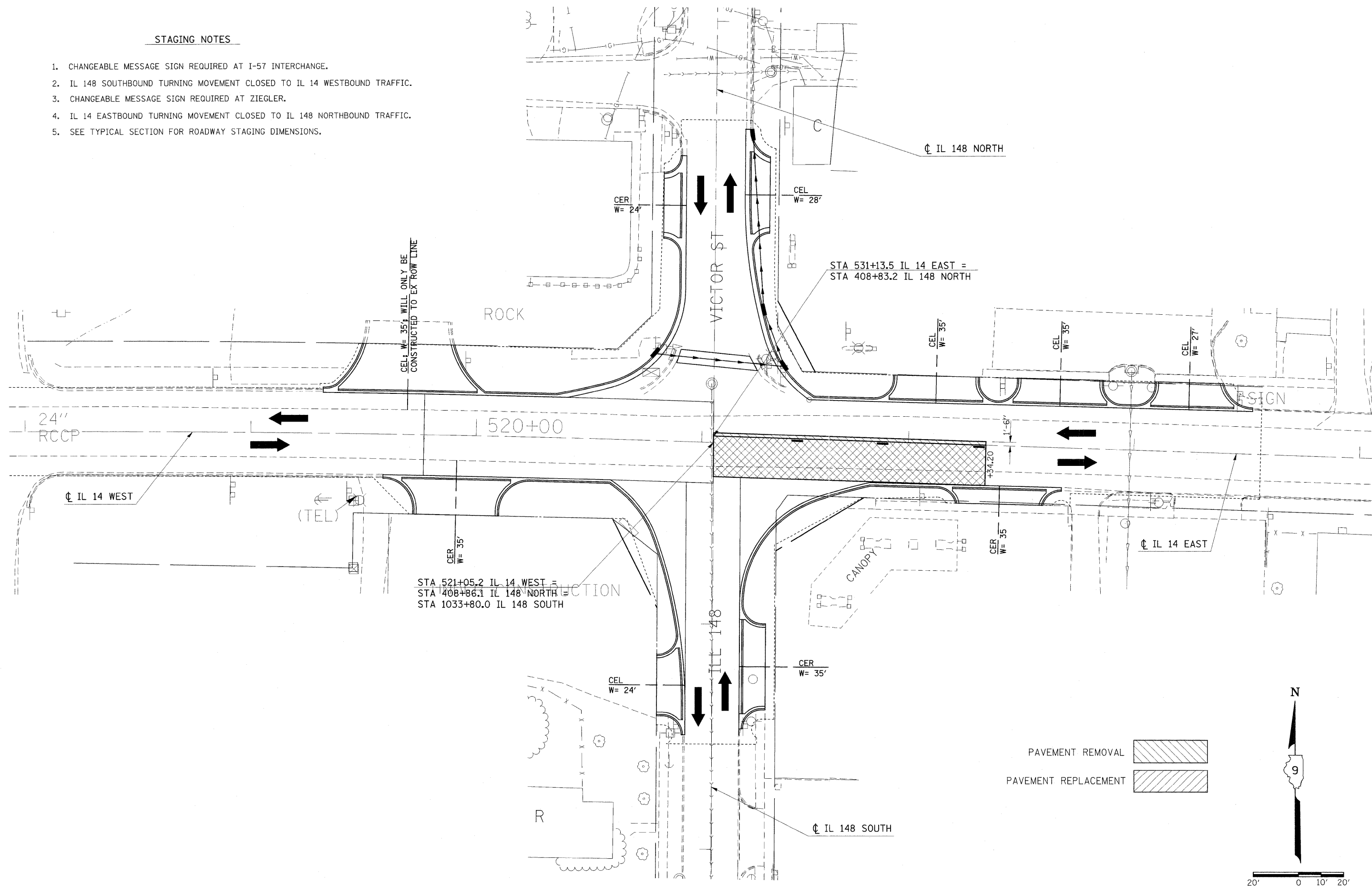

FILE NAME =	USER NAME = #USER#	DESIGNED -	REVISED -	STATE OF ILLINOIS DEPARTMENT OF TRANSPORTATION	STAGE 5: IL 14 /IL 148 INTERSECTION			F.A.P. RTE.	SECTION	COUNTY	TOTAL SHEETS	SHEET NO.
#FILE#		DRAWN -	REVISED -					869	(1-1,3,6)R-1,RS-3,(1,3,6)B-2	*	299	64
	PLOT SCALE = #SCALE#	CHECKED -	REVISED -					* PERRY & FRANKLIN COUNTY		CONTRACT NO. 98797		
	PLOT DATE = #DATE#	DATE -	REVISED -					ILLINOIS FED. AID PROJECT				
				SCALE: 20	SHEET NO.	OF	SHEETS	STA.	TO STA.			