

INDEX OF SHEETS

SHEET NO.	DESCRIPTION
1	TITLE SHEET & SUMMARY OF QUANTITIES
2	PLAN & PROFILE, TYPICAL SECTIONS, GENERAL NOTES & STONE RIPRAP DITCH DESIGN
3-4	ROADWAY CROSS SECTIONS
5-13	BRIDGE DESIGN

THE FOLLOWING STANDARDS ARE A PART OF THESE PLANS AND ARE INCLUDED IN THE PROPOSAL:

000001-06	STANDARD SYMBOLS, ABBREVIATIONS & PATTERNS
280001-05	TEMPORARY EROSION CONTROL SYSTEMS
701901-01	TRAFFIC CONTROL DEVICES
B.L.R. 21-8	TYPICAL APPLICATION OF TRAFFIC CONTROL DEVICES FOR CONSTRUCTION ON RURAL LOCAL HIGHWAYS
B.L.R. 22-6	TYPICAL APPLICATION OF TRAFFIC CONTROL DEVICES FOR CONSTRUCTION ON RURAL LOCAL HIGHWAYS (TWO-LANE TWO-WAY RURAL TRAFFIC) (ROAD CLOSED TO THRU TRAFFIC)

SUMMARY OF QUANTITIES

CODE NO.	ITEM	UNIT	QUANTITY
20100500	TREE REMOVAL, ACRES	ACRE	0.20
20200100	EARTH EXCAVATION	CU YD	175.00
20300100	CHANNEL EXCAVATION	CU YD	440.00
20400800	FURNISHED EXCAVATION	CU YD	1077.00
28000305	TEMPORARY DITCH CHECKS	FOOT	14.00
28000400	PERIMETER EROSION BARRIER	FOOT	50.00
28100807	STONE DUMPED RIPRAP, CLASS A4	TON	350.00
40200800	AGGREGATE SURFACE COURSE, TYPE B	TON	390.00
50100100	REMOVAL OF EXISTING STRUCTURES	EACH	1.00
50300225	CONCRETE STRUCTURES	CU YD	23.80
50300280	CONCRETE ENGASEMENT	CU YD	2.80
50400405	PRECAST PRESTRESSED CONCRETE DECK BEAMS (21" DEPTH)	SQ FT	1320.00
50800105	REINFORCEMENT BARS	POUND	2530.00
Δ 50900205	STEEL RAILING, TYPE S1	FOOT	106.00
51201400	FURNISHING STEEL PILES 10X42	FOOT	490.00
51202305	DRIVING PILES	FOOT	490.00
51203400	TEST PILE STEEL HP10X42	EACH	1.00
51500100	NAME PLATES	EACH	1.00
67100100	MOBILIZATION	L SUM	1.00
*X2501000	SEEDING, CLASS 2 (SPECIAL)	ACRE	0.50
*Z0068900	STONE LINED DITCH	TON	169.00

Δ SPECIALTY ITEMS

DESIGN DESIGNATION:
DESIGN SPEED: 30 MPH.
HIGHWAY CLASS - LOCAL ROAD
EXISTING STRUCTURE NO.: 097-3043
PROPOSED STRUCTURE NO.: 097-3273
CURRENT A.D.T. = 80
CONTRACT NO. 99441



STATE OF ILLINOIS

DEPARTMENT OF TRANSPORTATION

PLANS FOR PROPOSED FEDERAL AID - H.B.P. PROJECT

T.R. 28A WHITE COUNTY SECTION 07-08137-00-BR

PROJECT NO. BROS-193(38) JOB NO. C-99-546-07

CONTRACT # 99441 BEAR CREEK TRIBUTARY

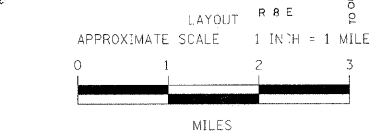
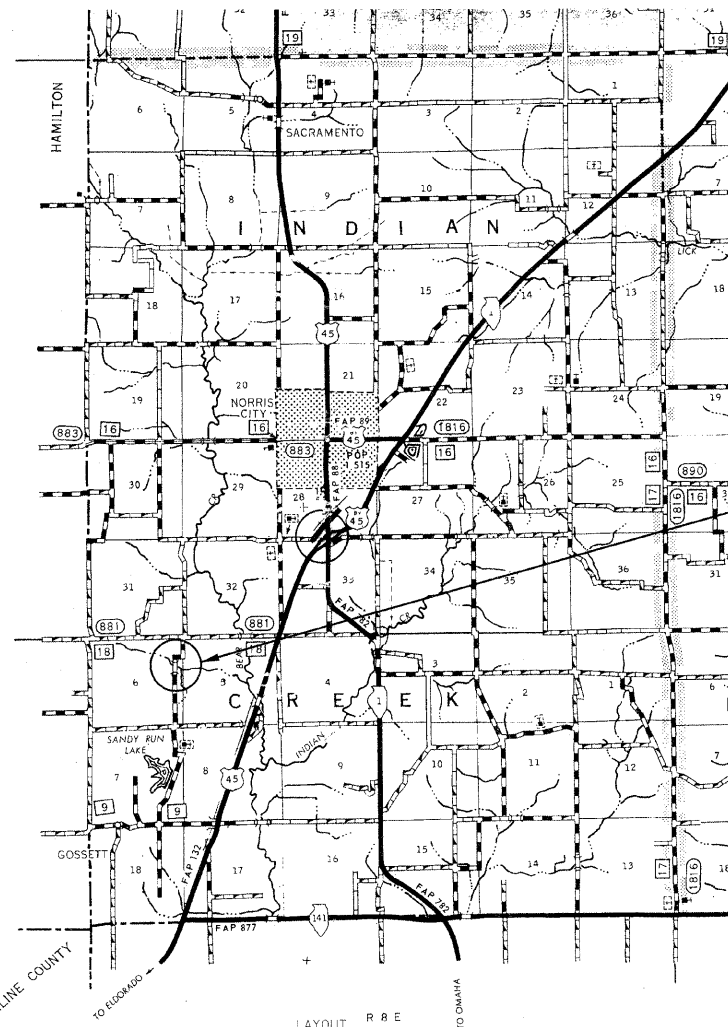

GROSS LENGTH	650.00 FT	0.123 MILES
OMISSIONS	0.00 FT	0.000 MILES
NET LENGTH	650.00 FT	0.123 MILES

PLAN	1" = 50'	
PROFILE	1" = 50'	
PROFILE VERT.	1" = 5'	
CROSS SECTION	1" = 5'	

SECTION 07-08137-00-BR BEGINS STATION 1+50

STATION 5+00, STRUCTURE NO. 097-3273
A 55' LONG SINGLE SPAN PRECAST PRESTRESSED CONCRETE DECK BEAM BRIDGE (21" DEPTH), 24' ROADWAY, 0.00% GRADE, 20° LT. FWD. SKEW.

SECTION 07-08137-00-BR ENDS STATION 8+00

STATE OF ILLINOIS
DEPARTMENT OF TRANSPORTATION

APPROVED 2/14/2011
Susan A. Ray
COUNTY ENGINEER

PASSED 3/25/2011
Dennis W. Hill
ENGINEER OF LOCAL ROADS AND STREETS

RELEASING FOR BID
BASED ON LIMITED REVIEW: 3/28/11
Mary C. Lamie
MARY C. LAMIE, P.E.
DEPUTY DIRECTOR OF HIGHWAYS
REGION FIVE ENGINEER

TR	SECTION	COUNTY	TOTAL SHEETS	SHEET NO.
28A	07-08137-00-BR	WHITE	13	1

FED. ROAD DIST. NO. 9 ILLINOIS FFD. AID PROJECT
PROJECT# BROS-193(038) CONTRACT# 99441
JOB # C-99-546-07 BEAR CREEK TRIBUTARY
LEC JOB # H091L007WH

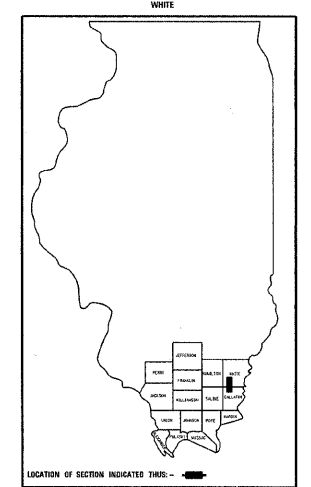

PROFESSIONAL DESIGN FIRM
LAND SURVEY & PROFESSIONAL ENGINEERING CORPORATION
184-000887
(62-032435)(35-002769)



AARON M. MEFFORD
NAME
Aaron Mefford
SIGNATURE
DATE
2-15-11
11-30-11 EXPIRES

TOWNSHIP ROUTE 28A
OVER BEAR CREEK TRIBUTARY
WHITE COUNTY, ILLINOIS

SHEET TITLE:
TITLE SHEET

SCALE:	VARS
BY: AMM	
DATE: 2/11	
REV:	

1 OF 13 SHEETS
SHEET NO. 1