

HORIZONTAL CONTROL TABLE (1927 DATUM)

POINT	NORTHING	EASTING	DESCRIPTION	STATION/OFFSET
1	1982835.4489	619546.9945	RUNWAY 12/30 AND TAXIWAY E1	STA. 376+70.70 @ RUNWAY 12/30 AND STA. 0+00.00 @ TAXIWAY E1
2	1983047.7711	619668.5039	TAXIWAY E1 AND TAXIWAY ECHO	STA. 2+40.00 @ TAXIWAY E1 AND STA. 176+70.70 @ TAXIWAY E
3	1983296.6194	618668.0646	RUNWAY 12/30 AND TAXIWAY ALPHA	STA. 386+63.27 @ RUNWAY 12/30 AND STA. 35+25.55 @ TAXIWAY A
4	1983421.8225	618945.9924	TAXIWAY ECHO AND TAXIWAY ALPHA	STA. 184+75.26 @ TAXIWAY E AND STA. 38+30.38 @ TAXIWAY A
5	1983780.9848	617744.9280	RUNWAY 12/30 AND TAXIWAY BRAVO	STA. 397+05.76 @ RUNWAY 12/30 AND STA. 1201+70.23 @ TAXIWAY B
6	1983914.4149	618007.1782	TAXIWAY ECHO AND TAXIWAY BRAVO	STA. 193+55.46 @ TAXIWAY E AND STA. 1204+64.47 @ TAXIWAY B
7	1984051.1239	617246.6232	TAXIWAY ECHO AND RUNWAY 6/24	STA. 198+28.70 @ TAXIWAY E AND STA. 035+80.53 @ RUNWAY 6/24
8	1983012.4046	618501.9413	100' RADIUS TO EDGE OF PAVEMENT	STA. 1+65.00, 75' LT. @ TAXIWAY E1
9	1983316.4512	618917.7425	50' RADIUS TO EDGE OF PAVEMENT	STA. 183+20.76, 75' LT. @ TAXIWAY E
10	1983337.9614	618944.3993	50' RADIUS TO EDGE OF PAVEMENT	STA. 184+37.70, 75' LT. @ TAXIWAY E
11	1983251.4751	618455.1209	125' RADIUS TO EDGE OF PAVEMENT	STA. 386+03.91, 182.5' LT. @ RUNWAY 12/30
12	1983207.0251	619450.0811	20' RADIUS TO EDGE OF PAVEMENT	STA. 179+29.08, 44' RT. @ TAXIWAY E
13	1983117.6631	619606.3908	20' RADIUS TO EDGE OF PAVEMENT	STA. 177+49.15, 39.34' RT. @ TAXIWAY E
14	1983124.7472	619610.1077	20' RADIUS TO EDGE OF PAVEMENT	STA. 179+29.08, 45.5' RT. @ TAXIWAY E
15	1983208.3478	619450.7760	35' RADIUS TO EDGE OF PAVEMENT	STA. 0+97.50, 77.5' RT. @ TAXIWAY E1
16	1982885.7778	619660.9222	NOAA BRASS DISC	STA. 181+80.42, @ TAXIWAY ECHO
17	1983284.7900	619207.0450	IRON PIN	STA. 188+58.08, 119.36' RT. @ TAXIWAY ECHO
BM#21	1983705.8500	618661.5780		STA. 372+69.94, 71.40' RT. @ RUNWAY 12/30
BM#19	1982713.3210	619353.4790		CHISEL "X"

VERTICAL CONTROL TABLE (1929 DATUM)

BM #	ELEVATION	LOCATION	DESCRIPTION
22	639.09	STA. 181+80.42, @ TAXIWAY ECHO	NOAA BRASS DISC
861	639.98	STA. 188+58.08, 119.36' RT. @ TAXIWAY ECHO	IRON PIN
79	639.87	STA. 372+69.94, 71.40' RT. @ RUNWAY 12/30	CHISEL "X"

LEGEND

- NEW 5" BITUMINOUS OVERLAY
- NEW BITUMINOUS ENTRANCE ROAD
- BITUMINOUS PAVEMENT TO BE REMOVED
- NEW 10" P.C.C. PAVEMENT
- BITUMINOUS PAVED SHOULDER
- P.C.C. PAVEMENT TO BE REMOVED
- NEW 2" BITUMINOUS OVERLAY (ADDITIVE ALTERNATE #1)
- NEW EDGE LIGHT
- NEW ELECTRIC CIRCUIT
- NEW GUIDANCE SIGN
- NEW ELECTRICAL DUCT
- NEW STORM SEWER
- NEW STORM INLET/ MANHOLE/SLOPEBOX
- EXISTING BENCHMARK
- EXISTING BUILDING
- EXISTING AIRFIELD FENCE
- AIRPORT PROPERTY LINE
- NEW BENCHMARK TO BE INSTALLED BY CONTRACTOR

NOTES

1. SUBTRACT 0.24 FEET FROM GRADES SHOWN IN PLANS (1929 DATUM) TO OBTAIN 1988 NAVD.
2. FIRM PANEL # 17031C-0207J DATED 08/19/08

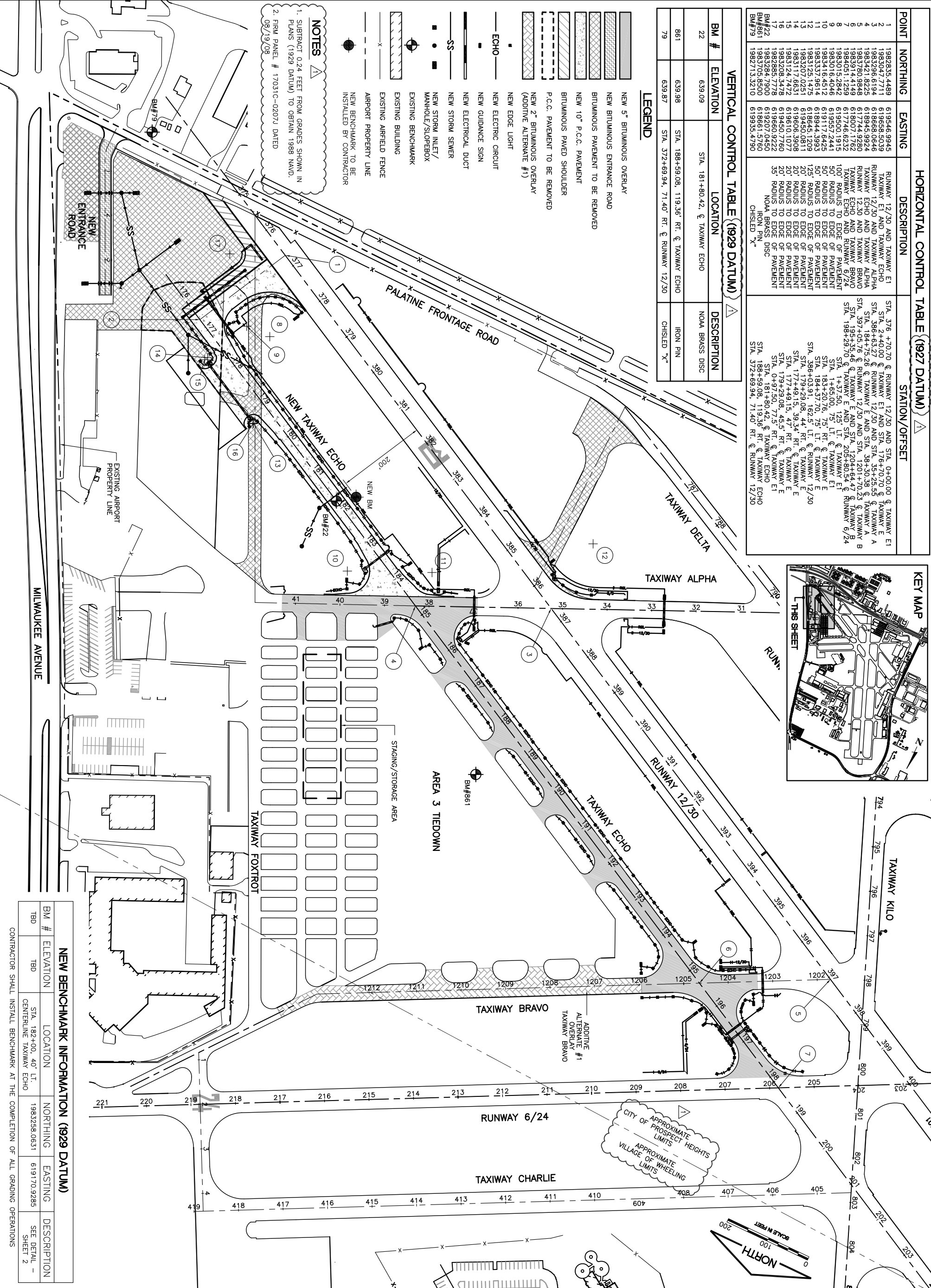
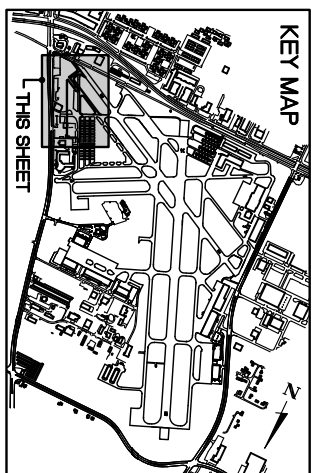

NEW BENCHMARK INFORMATION (1929 DATUM)

BM #	ELEVATION	LOCATION	NORTHING	EASTING	DESCRIPTION
TBD	TBD	STA. 182+00, 40' LT. CENTRELINE TAXIWAY ECHO	1983258.0631	619170.9285	SEE DETAIL - SHEET 2

CONTRACTOR SHALL INSTALL BENCHMARK AT THE COMPLETION OF ALL GRADING OPERATIONS

0 1 2
THIS BAR IS EQUAL TO 2" AT FULL SCALE (34X22).

NUMBER	BY	DATE
1	MLK	03/31/10

**CHICAGO EXECUTIVE AIRPORT
WHEELING/PROSPECT HEIGHTS, ILLINOIS
CONSTRUCT PARTIAL PARALLEL TAXIWAY ECHO AND
PARTIAL OVERLAY OF TAXIWAY ECHO**

SITE PLAN/PROJECT CONTROL PLAN

© Copyright CMT, Inc.

CMT
CRAWFORD, MURPHY & TILLY, INC.
CONSULTING ENGINEERS
License No. 184-000613

DESIGN BY:	MLK
DRAWN BY:	JRO
CHECKED BY:	MLK
APPROVED BY:	DLP
DATE:	04/22/11
JOB No.:	08290-08
ILLINOIS PROJECT:	PWK-3244
A.P.P. PROJECT:	3-17-0018-B-32
SHEET	3 OF 49 SHEETS

K:\Chicago\cmap\0829008 Iry E:\low\Sheets\1\low