

F.A.U. RTE.	SECTION	COUNTY	TOTAL SHEETS	SHEET NO.
3778	2021-143-1	COOK	10	1
FED. ROAD DIST. NO. 1		ILLINOIS	CONTRACT NO. 62P59	

FOR INDEX OF SHEETS, SEE SHEET NO. 2

**PROJECT LOCATED IN:
CITY OF MARKHAM,
BREMEN TOWNSHIP**

STATE OF ILLINOIS
DEPARTMENT OF TRANSPORTATION
PROPOSED
HIGHWAY PLANS
F.A.U. ROUTE: 3778 (CRAWFORD AVE/PULASKI RD.)
I-57 MAINTENANCE YARD
SECTION: 2021-143-1
PARKING LOT IMPROVEMENT
C-91-015-22
COOK COUNTY

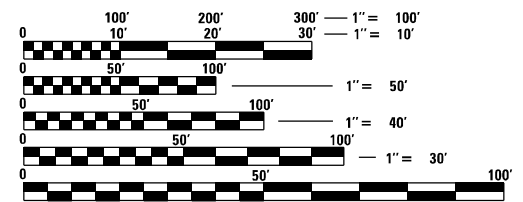

FULL SIZE PLANS HAVE BEEN PREPARED USING STANDARD ENGINEERING SCALES. REDUCED SIZED PLANS WILL NOT CONFORM TO STANDARD SCALES. IN MAKING MEASUREMENTS ON REDUCED PLANS, THE ABOVE SCALES MAY BE USED.

J.U.L.I.E.
JOINT UTILITY LOCATION INFORMATION FOR EXCAVATION
1-800-892-0123
OR 811

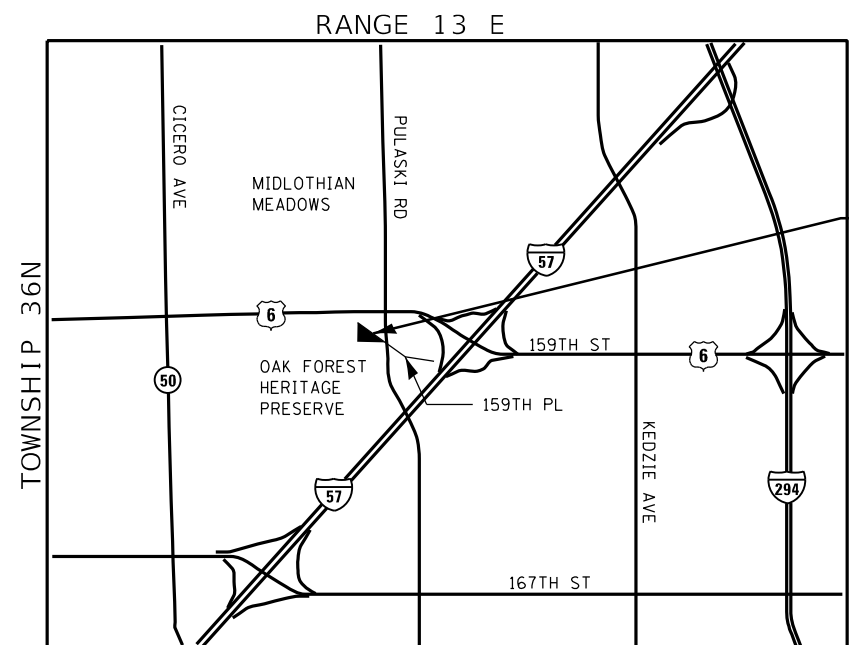

**I-57 MAINTENANCE YARD
PARKING LOT
(16010 S CRAWFORD AVE,
MARKHAM)**

**LOCATION MAP
NOT TO SCALE**

PROJECT ENGINEER: DAN WILGREEN, P.E. (847)705-4240
PROJECT MANAGER: FAWAD AQUEEL, P.E. (847)705-4247

CONTRACT NO. 62P59

MILLENNIA PROFESSIONAL SERVICES
THOMAS V. NGO, P.E.
062-058379
DATE: 03/18/2022
SIGNATURE AND SEAL APPLIES
TO DRWG NO 1 TO 29, 103-110

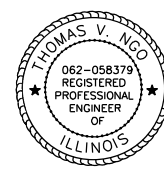

STATE OF ILLINOIS
DEPARTMENT OF TRANSPORTATION

SUBMITTED MARCH 21, 2022
Jose Rios
REGIONAL ENGINEER

May 13, 2022 [Signature]
ENGINEER OF DESIGN AND ENVIRONMENT

May 13, 2022 [Signature]
DIRECTOR OF HIGHWAYS PROJECT IMPLEMENTATION

**PRINTED BY THE AUTHORITY
OF THE STATE OF ILLINOIS**

INDEX OF SHEETS

- 1 COVER SHEET
- 2 INDEX OF SHEETS, STATE STANDARDS, & GENERAL NOTES
- 3-5 SUMMARY OF QUANTITIES
- 6 TYPICAL SECTION AND HMA MIXTURE TABLE
- 7 EXISTING SITE AND REMOVAL PLAN
- 8 PROPOSED SITE AND PAVEMENT MARKING PLAN
- 9 PROPOSED GRADING AND DRAINAGE PLAN
- 10 DISTRICT ONE TYPICAL PAVEMENT MARKINGS (TC-13)

LIST OF HIGHWAY STANDARDS

- 000001-08 STANDARD SYMBOLS, ABBREVIATIONS, AND PATTERNS
- 442201-03 CLASS C AND D PATCHES
- 602001-02 CATCH BASIN TYPE A
- 602011-02 CATCH BASIN TYPE C
- 604001-05 FRAME AND LIDS TYPE 1
- 701006-05 OFF-RD OPERATIONS, 2L, 2W, 15' (4.5m) TO 24" (600mm) FROM PAVEMENT EDGE

COMMITMENTS

GENERAL NOTES

1. BEFORE STARTING ANY EXCAVATION, THE CONTRACTOR SHALL CALL "J.U.L.I.E." AT 800-892-0123 FOR FIELD LOCATIONS OF BURIED ELECTRIC, TELEPHONE AND GAS UTILITIES. 48 HOUR NOTIFICATION IS REQUIRED.
2. THE CONTRACTOR SHALL COORDINATE CONSTRUCTION ACTIVITIES WITH THE I-57 TEAM SECTION TECHNICIAN CHARLES MCLENDON AT 708-388-9611 OR 9612.
3. THE CONTRACTOR WILL NOT BE ALLOWED TO SET UP A YARD OR FIELD OFFICE ON STATE PROPERTY WITHOUT WRITTEN PERMISSION FROM THE DEPARTMENT.
4. BEFORE BEGINNING ANY WORK, THE CONTRACTOR SHALL RETAIN AND RECORD FOR FUTURE REFERENCES, ALL EXISTING PAVEMENT MARKING LINES AND RAISED REFLECTIVE PAVEMENT MARKERS IN ORDER THAT THESE LOCATIONS CAN BE RE-ESTABLISHED FOR STRIPING. EXACT LOCATIONS OF ALL STRIPING SHALL BE AS DIRECTED BY THE ENGINEER.
5. IT SHALL BE THE CONTRACTOR'S RESPONSIBILITY TO VERIFY ALL DIMENSIONS AND CONDITIONS EXISTING IN THE FIELD PRIOR TO CONSTRUCTION AND ORDERING OF MATERIALS.
6. THE CONTRACTOR SHALL BE REQUIRED TO PROVIDE ACCESS TO ABUTTING PROPERTY AT ALL TIMES DURING THE CONSTRUCTION OF THIS PROJECT.
7. DO NOT SCALE PLANS FOR CONSTRUCTION DIMENSIONS.
8. EXISTING BROKEN FRAMES AND LIDS SHALL BE REMOVED AND DISPOSED OF BY THE CONTRACTOR AND SHALL BE REPLACED AS DIRECTED BY THE ENGINEER. REPLACEMENT FRAMES AND LIDS WILL BE PAID FOR ACCORDING TO ARTICLE 109.04 OF THE STANDARD SPECIFICATIONS UNLESS A SEPARATE PAY ITEM HAS BEEN PROVIDED.
9. CONTRACTOR IS TO PERFORM THEIR OPERATIONS DURING THE I-57 MAINTENANCE YARD OPERATING HOURS, UNLESS APPROVED BY THE TEAM SECTION TECHNICIAN.

FILE NAME = \$FILE\$
 PLOT SCALE = \$SCALE\$
 USER NAME = \$USER\$



USER NAME = \$USERS	DESIGNED - TN	REVISED -
	DRAWN - JP	REVISED -
PLOT SCALE = \$SCALE\$	CHECKED - MK	REVISED -
PLOT DATE = \$DATES	DATE -	REVISED -

**STATE OF ILLINOIS
 DEPARTMENT OF TRANSPORTATION**

I-57 MAINTENANCE YARD			
INDEX OF SHEETS, STATE STANDARDS, & GENERAL NOTES			
SCALE: N/A	SHEET NO. 1 OF 1 SHEETS	STA. N/A	TO STA. N/A

F.A.U. RTE.	SECTION	COUNTY	TOTAL SHEETS	SHEET NO.
3778	2021-143-I	COOK	10	2
FED. ROAD DIST. NO. 1 ILLINOIS FED. AID PROJECT			CONTRACT NO. 62P59	

\$FILE\$

PAYCODE	ITEM DESCRIPTION	UNIT	TOTAL QUANTITIES	CONST. TYPE CODE	
				URBAN	
				100% STATE	
20200100	EARTH EXCAVATION	CU YD	2345	2345	
20800150	TRENCH BACKFILL	CU YD	4.1	4.1	
28000510	INLET FILTERS	EACH	9	9	
31101400	SUBBASE GRANULAR MATERIAL, TYPE B 6"	SQ YD	10460	10460	
40600275	BITUMINOUS MATERIALS (PRIME COAT)	POUND	23535	23535	
40600290	BITUMINOUS MATERIALS (TACK COAT)	POUND	2355	2355	
40601005	HOT-MIX ASPHALT REPLACEMENT OVER PATCHES	TON	25	25	
40603085	HOT-MIX ASPHALT BINDER COURSE, IL-19.0, N70	TON	1757	1757	
40604062	HOT-MIX ASPHALT SURFACE COURSE, IL-9.5, MIX "D", N70	TON	879	879	
42000300	PORTLAND CEMENT CONCRETE PAVEMENT 8"	SQ YD	171	171	
42001300	PROTECTIVE COAT	SQ YD	171	171	
44000100	PAVEMENT REMOVAL	SQ YD	10629	10629	
44002218	HOT-MIX ASPHALT REMOVAL OVER PATCHES, 4 1/2"	SQ YD	100	100	
44201765	CLASS D PATCHES, TYPE II, 10 INCH	SQ YD	50	50	
44201769	CLASS D PATCHES, TYPE III, 10 INCH	SQ YD	50	50	
55100300	STORM SEWER REMOVAL 8"	FOOT	15	15	
55100400	STORM SEWER REMOVAL 10"	FOOT	30	30	

• SPECIALTY ITEM

FILE NAME = \$FILE\$
PLOT SCALE = \$SCALE\$
USER NAME = \$USER\$



USER NAME = \$USERS
DESIGNED - TN
DRAWN - JP
PLOT SCALE = \$SCALE\$
PLOT DATE = \$DATES

DESIGNED - TN
DRAWN - JP
CHECKED - MK
DATE -

REVISED -
REVISED -
REVISED -
REVISED -

STATE OF ILLINOIS
DEPARTMENT OF TRANSPORTATION

I-57 MAINTENANCE YARD
SCHEDULE OF QUANTITIES

SCALE: N/A

SHEET NO. 1 OF 3 SHEETS

STA. TO STA.

F.A.J.
RTE.
3778

SECTION
2021-143-I

COUNTY
COOK
TOTAL SHEETS
10
SHEET NO.
3
CONTRACT NO. 62P59

FED. ROAD DIST. NO. 1 ILLINOIS FED. AID PROJECT

PAYCODE	ITEM DESCRIPTION	UNIT	TOTAL QUANTITIES	CONST. TYPE CODE	
				URBAN	
				100% STATE	
60200105	CATCH BASINS, TYPE A, 4'-DIAMETER, TYPE 1 FRAME, OPEN LID	EACH	1	1	
60206905	CATCH BASINS, TYPE C, TYPE 1 FRAME, OPEN LID	EACH	1	1	
60250200	CATCH BASINS TO BE ADJUSTED	EACH	1	1	
60250400	CATCH BASINS TO BE ADJUSTED WITH NEW TYPE 1 FRAME, OPEN LID	EACH	1	1	
60500050	REMOVING CATCH BASINS	EACH	2	2	
• 66900200	NON-SPECIAL WASTE DISPOSAL	CU YD	1335	1335	
• 66900530	SOIL DISPOSAL ANALYSIS	EACH	2	2	
• 66901001	REGULATED SUBSTANCES PRE-CONSTRUCTION PLAN	L SUM	1	1	
• 66901003	REGULATED SUBSTANCES FINAL CONSTRUCTION REPORT	L SUM	1	1	
• 66901006	REGULATED SUBSTANCES MONITORING	CAL DA	8	8	
67100100	MOBILIZATION	L SUM	1	1	
• 78000200	THERMOPLASTIC PAVEMENT MARKING - LINE 4"	FOOT	990	990	
550A0040	STORM SEWERS, CLASS A, TYPE 1 10"	FOOT	30	30	
X5537700	STORM SEWERS TO BE CLEANED 10"	FOOT	100	100	
X5537800	STORM SEWERS TO BE CLEANED 12"	FOOT	350	350	
X5538000	STORM SEWERS TO BE CLEANED 18"	FOOT	200	200	
X5538200	STORM SEWERS TO BE CLEANED 24"	FOOT	100	100	

• SPECIALTY ITEM

FILE NAME = P:\2019\ME\19003_Ver_Ver_PHI\1\037_Maintenance Yard Parking Lot\01-CA00\62P59_1-57_Yard\02-Shs\03-0162P59-sh1-S00.dgn
 PLOT SCALE = 2.0000' / 1" = 200
 USER NAME = tngo



USER NAME = tngo
 PLOT SCALE = 2.0000' / 1" = 200
 PLOT DATE = 3/31/2022

DESIGNED - TN
 DRAWN - JP
 CHECKED - MK
 DATE -
 REVISED -
 REVISED -
 REVISED -
 REVISED -

STATE OF ILLINOIS
 DEPARTMENT OF TRANSPORTATION

I-57 MAINTENANCE YARD
 SCHEDULE OF QUANTITIES

SCALE: N/A

SHEET NO. 2 OF 3 SHEETS STA. TO STA.

F.A.U. RTE.	SECTION	COUNTY	TOTAL SHEETS	SHEET NO.
377B	2021-143-I	COOK	10	4
FED. ROAD DIST. NO. 1 [ILLINOIS] FED. AID PROJECT			CONTRACT NO. 62P59	

P:\2019\ME\19003_Ver_Ver_PHI\1\037_Maintenance Yard Parking Lot\01-CA00\62P59_1-57_Yard\02-Shs\03-0162P59-sh1-S00.dgn

REV-SEP

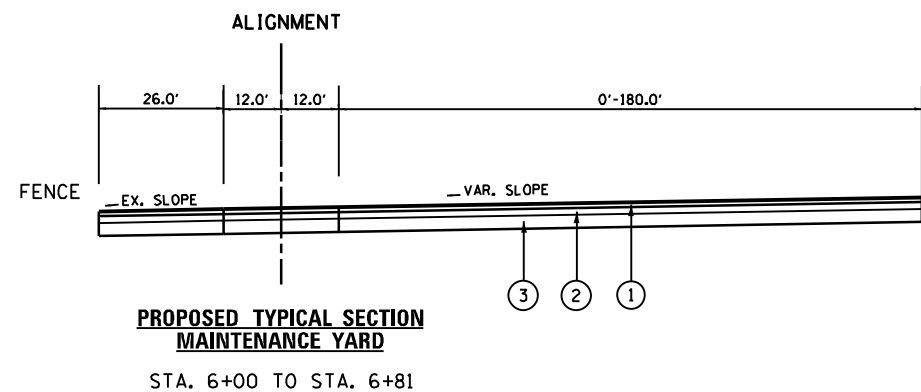
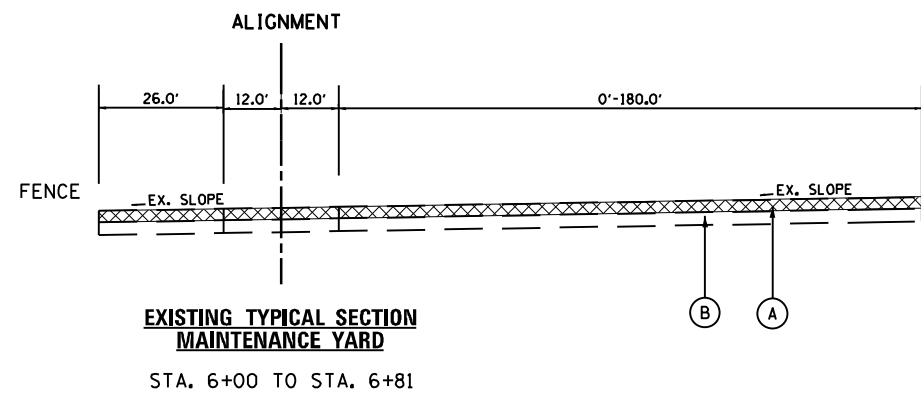
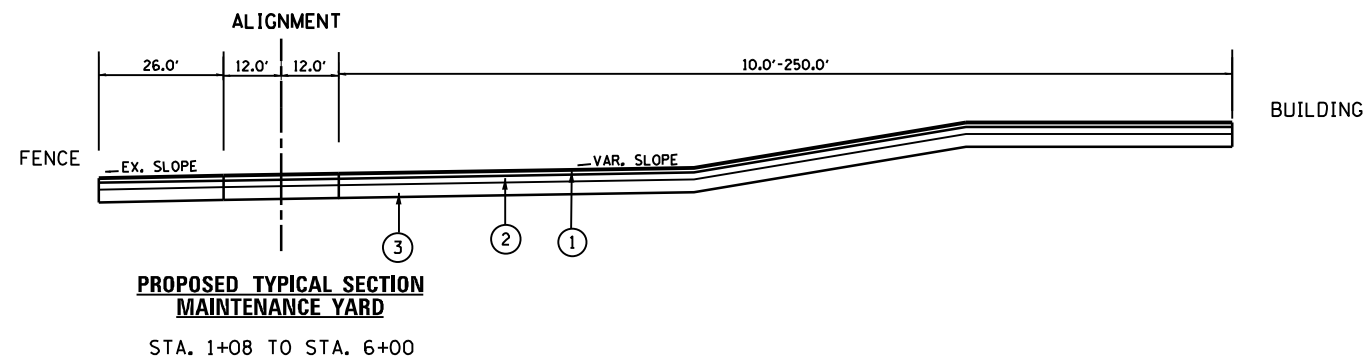
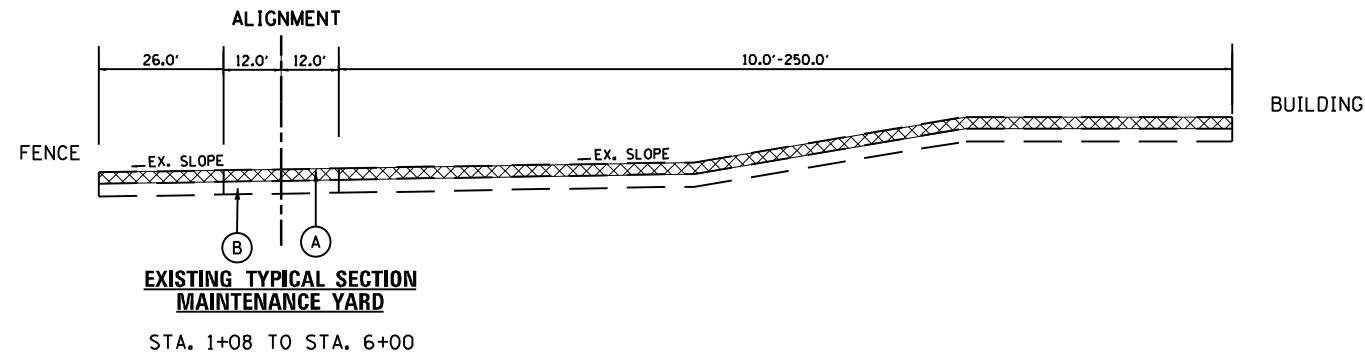

- EXISTING LEGEND**
- ⊗ REMOVAL
 - Ⓐ HMA SURFACE REMOVAL 4 1/2"
 - Ⓑ EXISTING SUB-BASE

- PROPOSED LEGEND**
- ① HMA SURFACE COURSE, MIX "D", IL-9.5, N70, 1 1/2"
 - ② HMA BINDER COURSE, IL-19.0, N70, 3"
 - ③ SUBBASE GRANULAR MATERIAL, TYPE B 6"

HOT MIX ASPHALT MIXTURE REQUIREMENTS		
MIXTURE TYPE	AIR VOID @ N _{DES.}	QMP TYPE
PAVEMENT RECONSTRUCTION		
HOT-MIX ASPHALT SURFACE COURSE, MIX "D", IL-9.5, N70, 1 1/2"	4% @ 70 GYR	QC/QA
HOT-MIX ASPHALT BINDER COURSE, IL-19.0, N70, 3"	4% @ 70 GYR	QC/QA
PATCHING		
CLASS D PATCHES (HMA IL-19 mm)	4% @ 70 GYR	QC/QA
HMA REPLACEMENT OVER PATCHES (HMA BINDER IL-19 mm)	4% @ 70 GYR	QC/QA
QUALITY CONTROL FOR PERFORMANCE (QCP); PAY FOR PERFORMANCE (PFP) QMP DESIGNATION: QUALITY CONTROL / QUALITY ASSURANCE (QC/QA);		

MIXTURE NOTES:

- THE UNIT WEIGHT USED TO CALCULATE ALL HOT-MIX ASPHALT SURFACE MIXTURES IS 112 LBS/SQ YD/IN
- THE "AC TYPE" FOR POLYMERIZED HMA MIXES SHALL BE "SBS/SBR PG 76-22" AND FOR NON-POLYMERIZED HMA THE "AC TYPE" SHALL BE "PG 64-22" UNLESS MODIFIED BY RECLAIMED MATERIALS SPECIFICATIONS.

FILE NAME = \$FILE\$
 PLOT SCALE = \$SCALE\$
 USER NAME = \$USER\$



USER NAME = \$USERS\$	DESIGNED - FN	REVISED -
DRAWN - dP	CHECKED - MK	REVISED -
PLOT SCALE = \$SCALE\$	DATE - *	REVISED -
PLOT DATE = \$DATES\$		

STATE OF ILLINOIS
DEPARTMENT OF TRANSPORTATION

I-57 MAINTENANCE YARD
TYPICAL SECTIONS AND HMA MIXTURE TABLE

SCALE: •	SHEET NO. • OF • SHEETS	STA. • TO STA. •	F.A.U. RTE. 3778	SECTION 2021-143-I	COUNTY COOK	TOTAL SHEETS 10	SHEET NO. 6
			CONTRACT NO. 62P59				
FED. ROAD DIST. NO. 1 ILLINOIS FED. AID PROJECT							

\$FILE\$

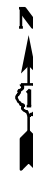

CONTROL POINT #	NORTHING	EASTING	ELEVATION	DESCRIPTION
CP#1	1798225.066	1152645.033	631.675	SET NAIL
CP#2	1798031.719	1152612.543	633.845	SET REBAR
CP#3	1798371.679	1152336.994	634.524	SET NAIL
CP#4	1798114.015	1152295.265	637.575	SET NAIL
CP#5	1798427.181	1152159.368	636.62	SET NAIL
CP#6	1798636.164	1152140.288	626.833	SET NAIL
BM#1			636.993	CUT SQUARE IN STEP
BM#2			633.126	CUT SQUARE IN CONC
BM#3			627.587	CUT SQUARE IN BACK OF CURB

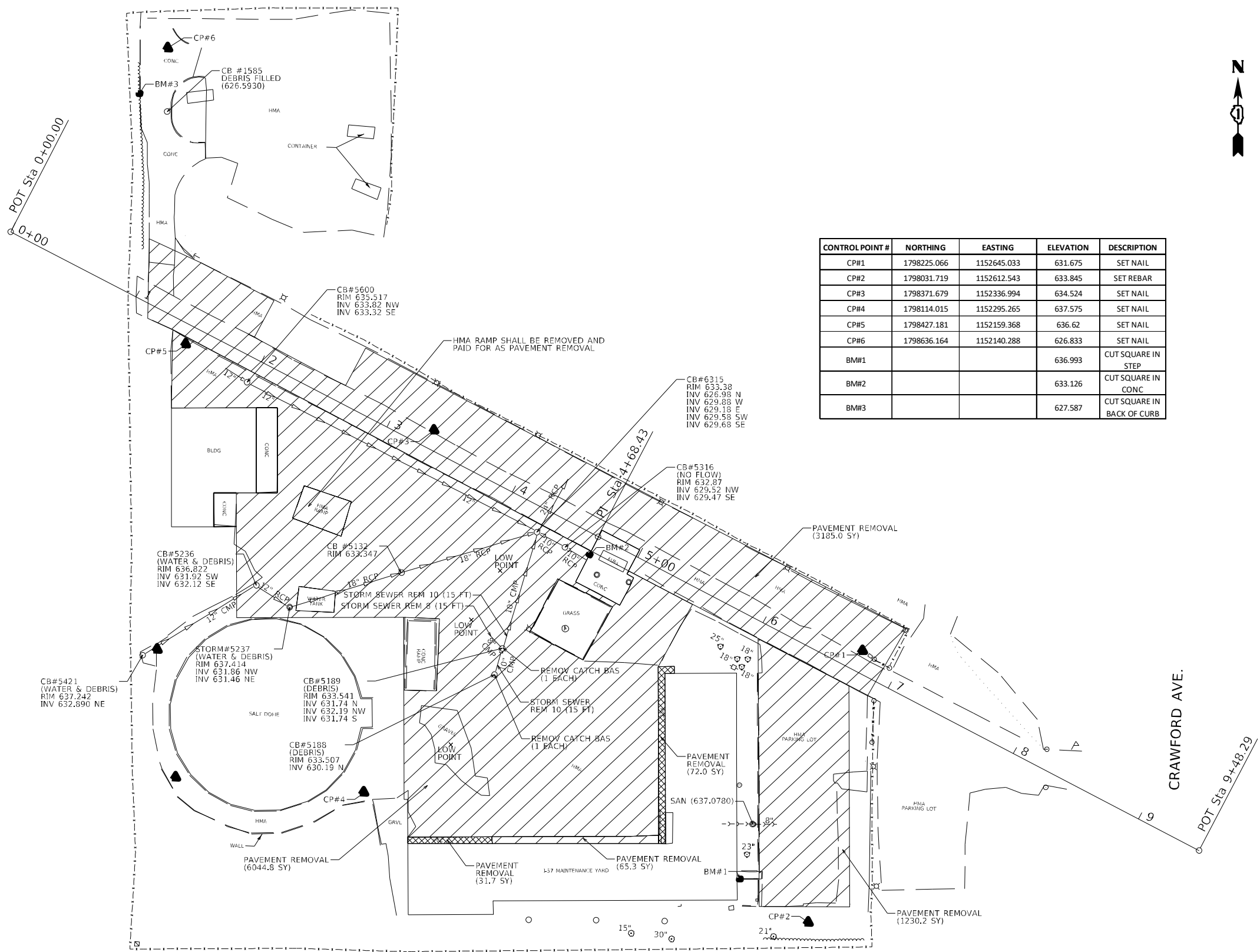

LEGEND

	PAVEMENT REMOVAL (HMA)
	PAVEMENT REMOVAL (PCC)

FILE NAME = \$FILE\$
 PLOT SCALE = \$SCALE\$
 USER NAME = \$USER\$



USER NAME = \$USERS	DESIGNED - TN	REVISED -
	DRAWN - JP	REVISED -
PLOT SCALE = \$SCALE\$	CHECKED - MK	REVISED -
PLOT DATE = \$DATES	DATE -	REVISED -

STATE OF ILLINOIS
DEPARTMENT OF TRANSPORTATION

I-57 MAINTENANCE YARD EXISTING SITE AND REMOVAL PLAN			
SCALE: 1"=40'	SHEET NO. OF	SHEETS	STA. TO STA.

F.A.U. RTE.	SECTION	COUNTY	TOTAL SHEETS	SHEET NO.
3778	2021-143-I	COOK	10	7
CONTRACT NO. 62P59				
FED. ROAD DIST. NO. 1 ILLINOIS FED. AID PROJECT				

\$FILE\$



LEGEND



PROPOSED HMA SURFACE COURSE, MIX "D", IL-9.5, N70, 1 1/2"
PROPOSED HMA BINDER COURSE, IL-19.0, N70, 3"
SUBBASE GRANULAR MATERIAL, TYPE B 6"



PCC PAVEMENT 8"

PROPOSED HMA SURFACE COURSE, MIX "D", IL-9.5, N70, 1 1/2"
PROPOSED HMA BINDER COURSE, IL-19.0, N70, 3"
SUBBASE GRANULAR MATERIAL, TYPE B 6"

PROPOSED HMA SURFACE COURSE, MIX "D", IL-9.5, N70, 1 1/2"
PROPOSED HMA BINDER COURSE, IL-19.0, N70, 3"
SUBBASE GRANULAR MATERIAL, TYPE B 6"

PROPOSED HMA SURFACE COURSE, MIX "D", IL-9.5, N70, 1 1/2"
PROPOSED HMA BINDER COURSE, IL-19.0, N70, 3"
SUBBASE GRANULAR MATERIAL, TYPE B 6"

PROP PCC PAVEMENT 8"
(171.0 SQ YD)

PROP. THERMOPLASTIC PAVEMENT MARKING
4" WHITE SOLID LINE (TYP)

CRAWFORD AVE.

FILE NAME = P:\2019\ME19003_Vari-Plan-Plan\037_Maintenance_Yard_Parking_Lot\01-CADD\62P59_1-57_Yard\02-Shts\08-0162P59_sht-Fr_Site & Pmnt_Mk.dgn
PLOT SCALE = 50.0000' / 1" =
USER NAME = JUSEPHNE#



USER NAME	= SUSERS
PLOT SCALE	= 50.0000' / 1" =
PLOT DATE	= 3/23/2022

DESIGNED	- TN
DRAWN	- JP
CHECKED	- MK
DATE	-

REVISED	-
REVISED	-
REVISED	-
REVISED	-

**STATE OF ILLINOIS
DEPARTMENT OF TRANSPORTATION**

**I-57 MAINTENANCE YARD
PROPOSED SITE AND PAVEMENT MARKING PALN**

SCALE: 1"=25' SHEET NO. OF SHEETS STA. TO STA.

F.A.U. RTE.	SECTION	COUNTY	TOTAL SHEETS	SHEET NO.
3778	2021-143-I	COOK	10	8
FED. ROAD DIST. No. 1 ILLINOIS FED. AID PROJECT			CONTRACT NO. 62P59	

P:\2019\ME19003_Vari-Plan-Plan\037_Maintenance_Yard_Parking_Lot\01-CADD\62P59_1-57_Yard\02-Shts\08-0162P59_sht-Fr_Site & Pmnt_Mk.dgn

MATCHLINE (SEE TOP RIGHT)

P-1
30 LF - 10" STORM SEW
CL A TY-1 @ 1.4 % TO ST-2

ST-1
STA 4+11.90.1' RT
CB TY C, TY 1 FRAME, OPEN LID
RIM = 633.32
INV = 631.32 (E)

ST-2
STA 4+37.2, 84.7' RT
4" DIA, CB TY A TY 1 FRAME, OPEN LID
RIM = 633.30
INV = 630.90 (W)
INV = 630.84 (N)

ST-3
STA 4+25.3, 17.0' RT
CB ADJ NEW TY 1 FRAME, OPEN LID
RIM = 632.95
INV = 626.98 (N)
INV = 629.88 (W)
INV = 629.18 (E)
INV = 629.58 (SW)
INV = 629.68 (SE)

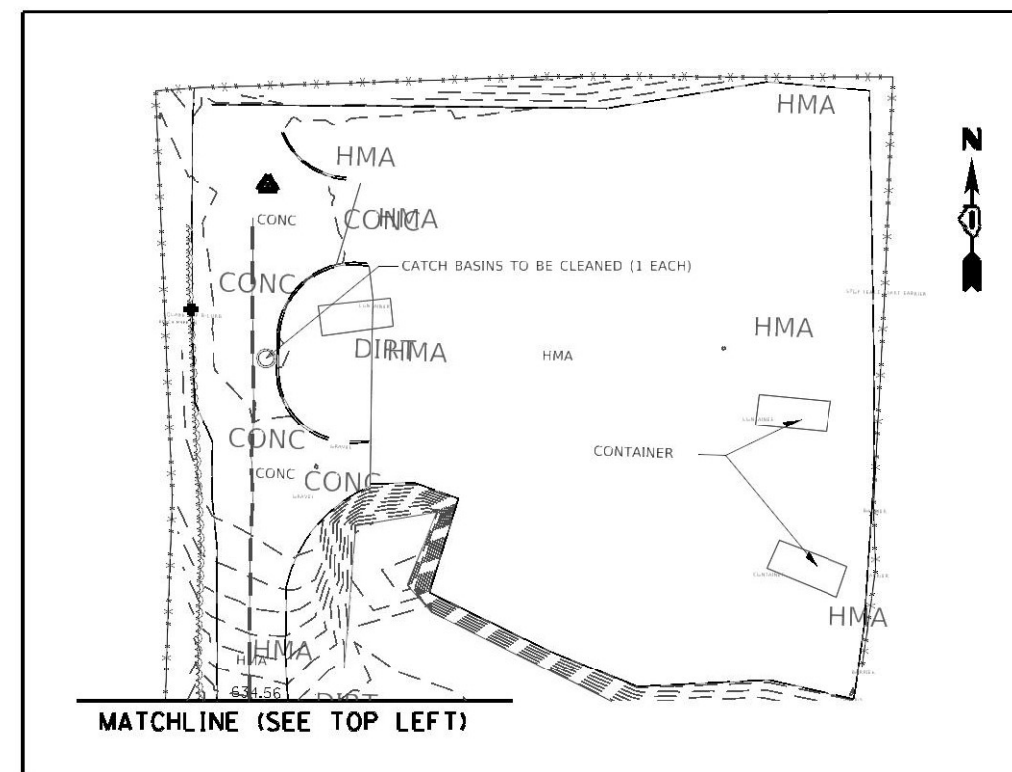

FILE NAME = P:\2019\ME19003_Var\PHIL\037_Maintenance Yard Parking Lot\01-CADD\62P59_I-57_Yard\02-Shts\09-D062P59-sht-Grading & Drainage.dgn
 PLOT SCALE = 50.0000' / 1" = 50.0000'
 USER NAME = mkoehler

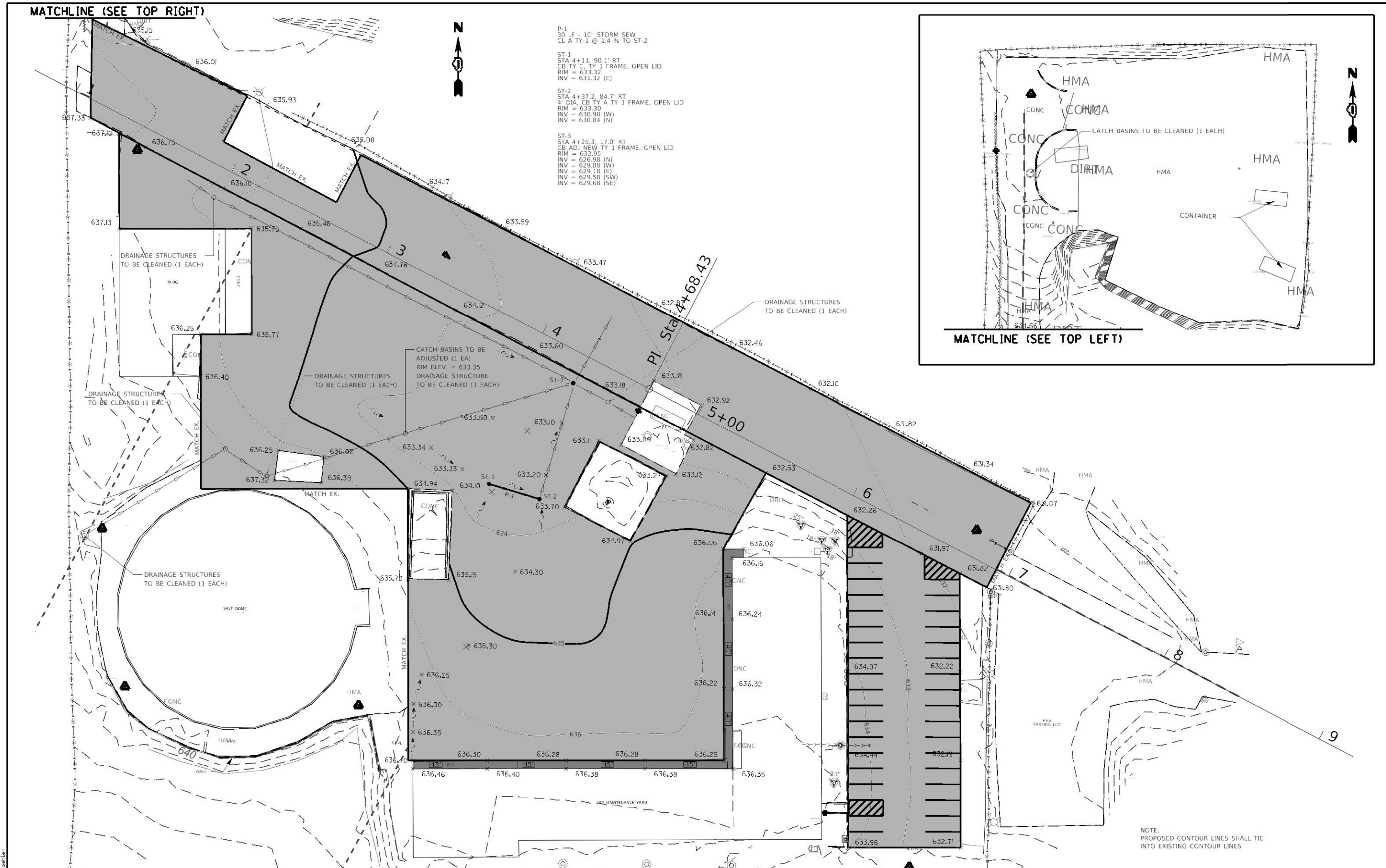

NOTE:
PROPOSED CONTOUR LINES SHALL TIE
INTO EXISTING CONTOUR LINES



USER NAME = mkoehler	DESIGNED - TN	REVISED -
PLOT SCALE = 50.0000' / 1"	DRAWN - JP	REVISED -
PLOT DATE = 3/23/2022	CHECKED - MK	REVISED -
	DATE -	REVISED -

**STATE OF ILLINOIS
DEPARTMENT OF TRANSPORTATION**

**I-57 MAINTENANCE YARD
PROPOSED GRADING AND DRAINAGE PLAN**

SCALE: 1"=25' SHEET NO. OF SHEETS STA. TO STA.

F.A.U. RTE. 3778	SECTION 2021-143-I	COUNTY COOK	TOTAL SHEETS 10	SHEET NO. 8
FED. ROAD DIST. No. 1 ILLINOIS FED. AID PROJECT				
CONTRACT NO. 62P59				

P:\2019\ME19003_Var\PHIL\037_Maintenance Yard Parking Lot\01-CADD\62P59_I-57_Yard\02-Shts\09-D062P59-sht-Grading & Drainage.dgn

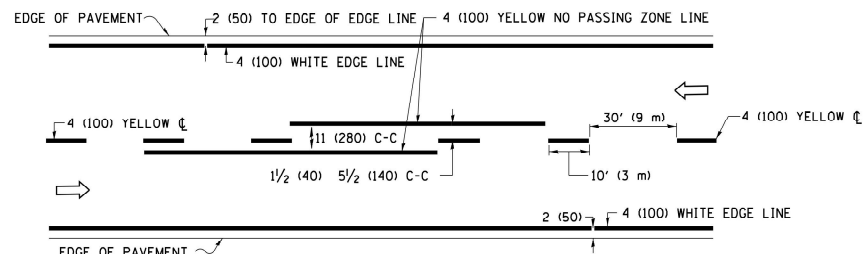

2-LANE ROADWAY

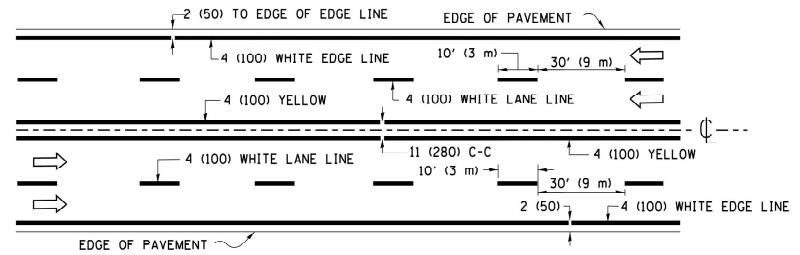

MULTI-LANE UNDIVIDED

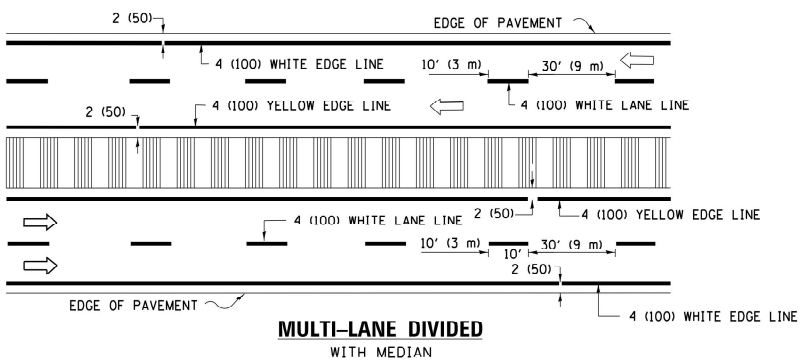

MULTI-LANE DIVIDED WITH MEDIAN

TYPICAL LANE AND EDGE LINE MARKING

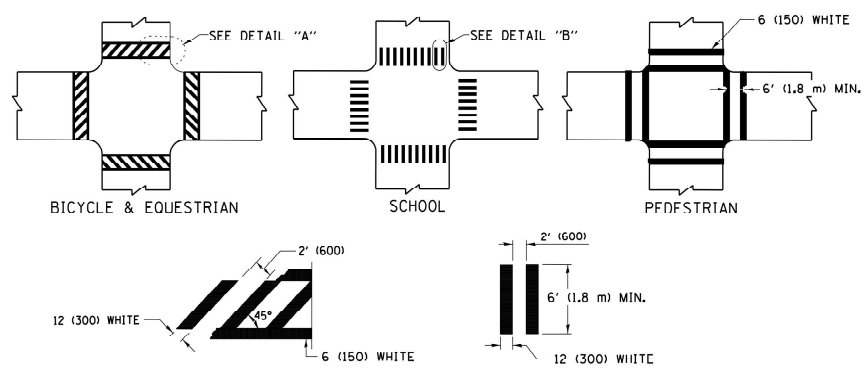

TYPICAL CROSSWALK MARKING

* MARKINGS SHALL BE INSTALLED PARALLEL TO THE CENTERLINE OF THE ROAD WHICH IT CROSSES

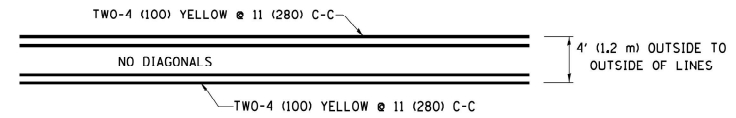

4' (1.2 m) WIDE MEDIANS ONLY

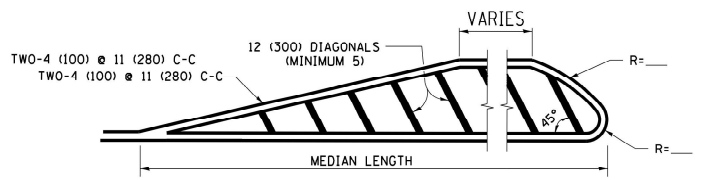

MEDIANS OVER 4' (1.2 m) WIDE

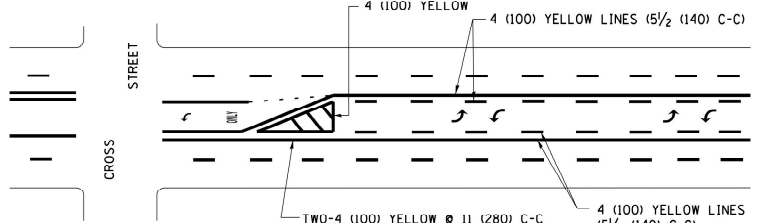

MEDIAN WITH TWO-WAY LEFT TURN LANE TYPICAL PAINTED MEDIAN MARKING

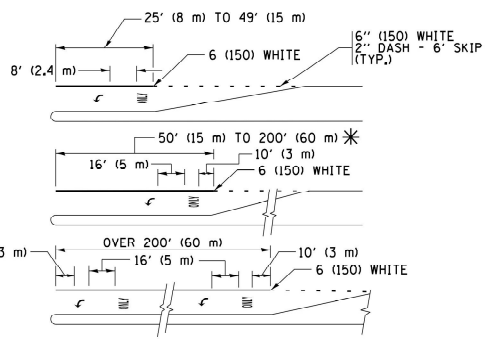

TYPICAL LEFT (OR RIGHT) TURN LANE TYPICAL TURN LANE MARKING

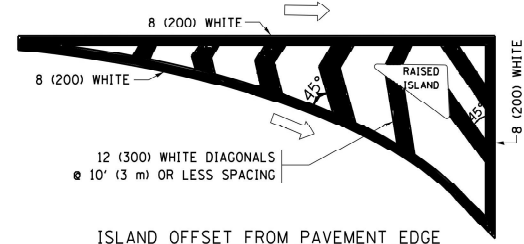

ISLAND OFFSET FROM PAVEMENT EDGE

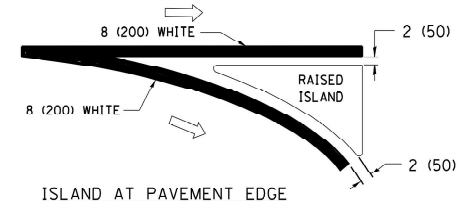

ISLAND AT PAVEMENT EDGE TYPICAL ISLAND MARKING

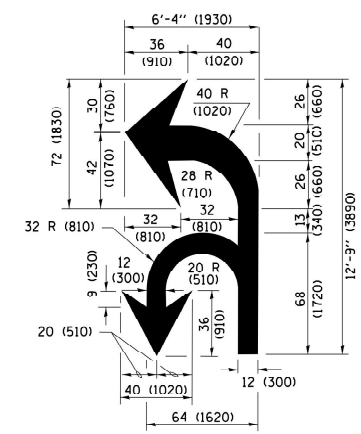

COMBINATION LEFT AND U-TURN

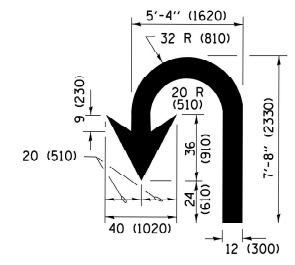

U-TURN

LANE REDUCTION TRANSITION

* LANE REDUCTION ARROWS REQUIRED AT SPEEDS OF 45 MPH OR GREATER OR WHEN SPECIFIED IN PLANS.

D(FT)	SPEED LIMIT
345	30
425	35
500	40
580	45
665	50
750	55

TYPE OF MARKING	WIDTH OF LINE	PATTERN	COLOR	SPACING /REMARKS
CENTERLINE ON 2 LANE PAVEMENT	4 (100)	SKIP-DASH	YELLOW	10' (3 m) LINE WITH 30' (9 m) SPACE
CENTERLINE ON MULTI-LANE UNDIVIDED PAVEMENT	2 @ 4 (100)	SOLID	YELLOW	11 (280) C-C
NO PASSING ZONE LINES FOR ONE DIRECTION FOR BOTH DIRECTIONS	4 (100) 2 @ 4 (100)	SOLID SOLID	YELLOW YELLOW	5 1/2 (140) C-C FROM SKIP-DASH CENTERLINE 11 (280) C-C OMIT SKIP-DASH CENTERLINE BETWEEN
LANE LINES	4 (100) 5 (125) ON FREEWAYS	SKIP-DASH SKIP-DASH	WHITE WHITE	10' (3 m) LINE WITH 30' (9 m) SPACE
DOTTED LINES (EXTENSIONS OF CENTER, LANE OR TURN LANE MARKINGS)	SAME AS LINE BEING EXTENDED	SKIP-DASH	SAME AS LINE BEING EXTENDED	2' (600) LINE WITH 6' (1.8 m) SPACE
EDGE LINES	4 (100)	SOLID	YELLOW-LEFT WHITE-RIGHT	OUTLINE MEDIANS IN YELLOW
TURN LANE MARKINGS	6 (150) LINE, FULL SIZE LETTERS & SYMBOLS (8' (2.4m))	SOLID	WHITE	SEE TYPICAL TURN LANE MARKING DETAIL
TWO WAY LEFT TURN MARKING	2 @ 4 (100) EACH DIRECTION 8' (2.4m) LEFT ARROW	SKIP-DASH AND SOLID IN PAIRS	YELLOW WHITE	10' (3 m) LINE WITH 30' (9 m) SPACE FOR SKIP-DASH, 5 1/2 (140) C-C BETWEEN SOLID LINE AND SKIP-DASH LINE SEE TYPICAL TWO-WAY LEFT TURN MARKING DETAIL
CROSSWALK LINES (PEDESTRIAN) A. DIAGONALS (BIKE & EQUESTRIAN) B. LONGITUDINAL BARS (SCHOOL)	2 @ 6 (150) 12 (300) @ 45° 12 (300) @ 90°	SOLID SOLID SOLID	WHITE WHITE WHITE	NOT LESS THAN 6' (1.8 m) APART 2' (600) APART SEE TYPICAL CROSSWALK MARKING DETAILS.
STOP LINES	24 (600)	SOLID	WHITE	PLACE 4' (1.2 m) IN ADVANCE OF AND PARALLEL TO CROSSWALK, IF PRESENT, OTHERWISE, PLACE AT DESIRED STOPPING POINT, PARALLEL TO CROSSROAD CENTERLINE, WHERE POSSIBLE.
PAINTED MEDIANS	2 @ 4 (100) WITH 12 (300) DIAGONALS @ 45° NO DIAGONALS USED FOR 4' (1.2 m) WIDE MEDIANS	SOLID	YELLOW TWO WAY TRAFFIC WHITE ONE WAY TRAFFIC	11 (280) C-C FOR THE DOUBLE LINE SEE TYPICAL PAINTED MEDIAN MARKING.
GORE MARKING AND CHANNELIZING LINES	8 (200) WITH 12 (300) DIAGONALS @ 45°	SOLID	WHITE	DIAGONALS: 15' (4.5 m) C-C (LESS THAN 30MPH (50 km/h)) 20' (6 m) C-C 30MPH (50 km/h) TO 45MPH (70 km/h) 30' (9 m) C-C (OVER 45MPH (70 km/h))
RAILROAD CROSSING	24 (600) TRANSVERSE LINES "RR" 15' 6" (1.8 m) LETTERS: 16 (400) LINE FOR "X"	SOLID	WHITE	SEE STATE STANDARD 780001 AREA OF: "R"=3.6 SQ. FT. (0.33 m²) EACH "X"=54.0 SQ. FT. (5.0 m²)
SHOULDER DIAGONALS (REQUIRED FOR SHOULDERS ≥ 8')	12 (300) @ 45°	SOLID	WHITE - RIGHT YELLOW - LEFT	50' (15 m) C-C (LESS THAN 30MPH (50 km/h)) 75' (25 m) C-C (30 MPH (50 km/h) TO 45MPH (70 km/h)) 150' (45 m) C-C (OVER 45MPH (70 km/h))
U TURN ARROW	SEE DETAIL	SOLID	WHITE	16.3 SF
2 ARROW COMBINATION LEFT AND U TURN	SEE DETAIL	SOLID	WHITE	30.4 SF

FOR FURTHER DETAILS ON PAVEMENT MARKING REFER TO STANDARD SPECIFICATIONS FOR ROAD AND BRIDGE CONSTRUCTION AND STATE STANDARD 780001.

All dimensions are in inches (millimeters) unless otherwise shown.

FILE NAME =	USER NAME = footemj	DESIGNED = EVERS	REVISED = C. JUCIUS 09-09-09
pw\1\084EBID\INTEG\11nois.gov\PIW001\Documents\DOT Offices\District 1\Projects\Dist	DRAWN = CADData\CADsheets\tc13.dgn	CHECKED =	REVISED = C. JUCIUS 07-01-13
Default	PLOT SCALE = 50.000' / in.	DATE = 03-19-90	REVISED = C. JUCIUS 12-21-15
	PLOT DATE = 4/13/2016		REVISED = C. JUCIUS 04-12-16

STATE OF ILLINOIS DEPARTMENT OF TRANSPORTATION

DISTRICT ONE			
TYPICAL PAVEMENT MARKINGS			
SCALE: NONE	SHEET 1	OF 1 SHEETS	STA. TO STA.

F.A.P. RTE.	SECTION	COUNTY	TOTAL SHEETS	SHEET NO.
3778	2021-143-1	COOK	10	10
TC-13		CONTRACT NO. 62P59		
ILLINOIS FED. AID PROJECT				