

STATE OF ILLINOIS
DEPARTMENT OF TRANSPORTATION

F.A.P. RTE.	SECTION	COUNTY	TOTAL SHEETS	SHEET NO.
IL 185	D7 PATCHING 2022-8	FAYETTE	5	1
		ILLINOIS	CONTRACT NO. 74B15	

FOR INDEX OF SHEETS, SEE SHEET NO. 2

PROPOSED
HIGHWAY PLANS

FAP ROUTE 750 (IL 185)
SECTION D7 PATCHING 2022-8
PAVEMENT PATCHING
FAYETTE COUNTY

C-97-056-22

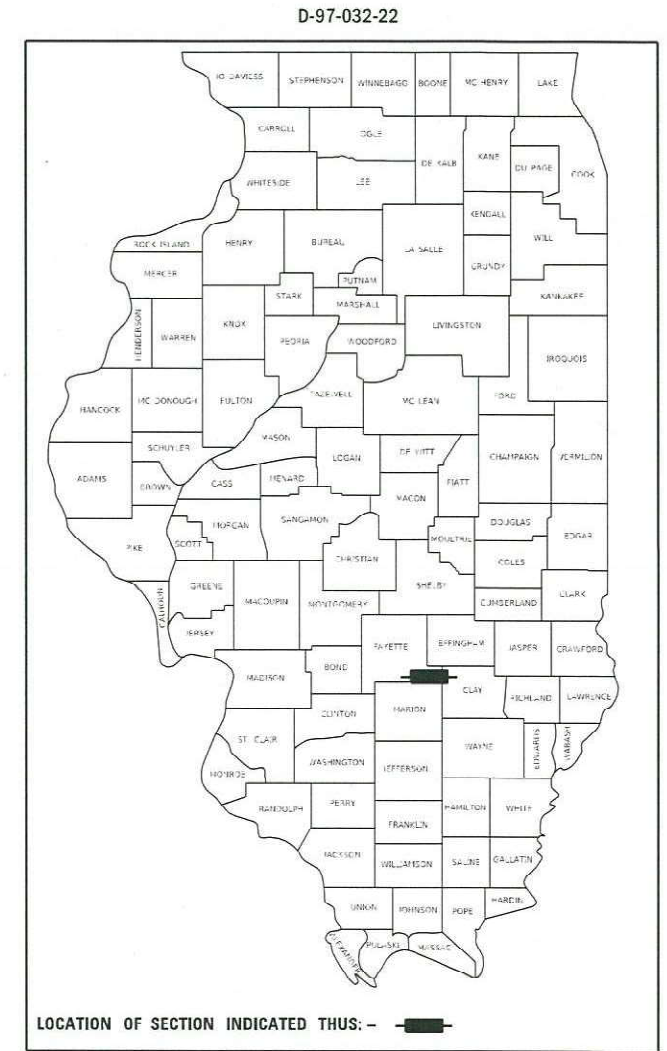

PROJECT
LOCATION

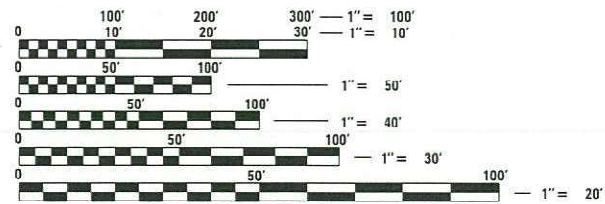
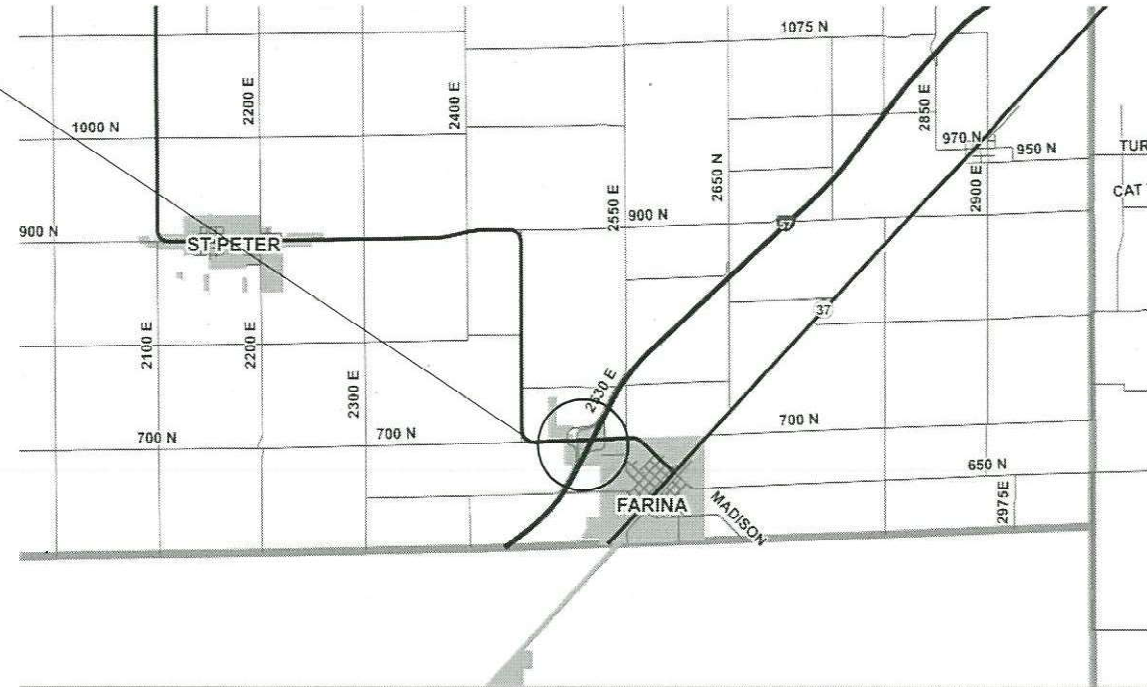

FULL SIZE PLANS HAVE BEEN PREPARED USING STANDARD ENGINEERING SCALES. REDUCED SIZED PLANS WILL NOT CONFORM TO STANDARD SCALES. IN MAKING MEASUREMENTS ON REDUCED PLANS, THE ABOVE SCALES MAY BE USED.

J.U.L.I.E.
JOINT UTILITY LOCATION INFORMATION FOR EXCAVATORS
1-800-892-0123
OR 811

PROJECT ENGINEER : MARK DAUGHERTY
PROJECT MANAGER : RYAN WEI

GROSS LENGTH = 3,000 FT. = 0.5 MILE
NET LENGTH = 3,000 FT. = 0.5 MILE

CONTRACT NO. 74B15

STATE OF ILLINOIS
DEPARTMENT OF TRANSPORTATION

SUBMITTED April 7 20 22
Jeffrey P. Mysiolek
REGIONAL ENGINEER

May 13, 2022 [Signature]
ENGINEER OF DESIGN AND ENVIRONMENT

May 13, 2022 [Signature]
DIRECTOR OF HIGHWAYS PROJECT IMPLEMENTATION

PRINTED BY THE AUTHORITY
OF THE STATE OF ILLINOIS

INDEX OF SHEETS

<u>SHEET NO.</u>	<u>ITEM</u>
1	COVER SHEET
2	INDEX OF SHEETS, GENERAL NOTES,
3	SUMMARY OF QUANTITIES
4	SCHEDULE OF QUANTITIES
5	PLAN SHEETS

THE FOLLOWING STANDARDS ARE A PART OF THESE PLANS AND ARE INCLUDED AFTER SHEET NO. 5 :

<u>STD. NO.</u>	<u>DESCRIPTION</u>
000001-08	STANDARD SYMBOLS, ABBREVIATIONS AND PATTERNS
001001-02	AREAS OF REINFORCEMENT BARS
001006	DECIMAL OF AN INCH AND OF A FOOT
420001-10	PAVEMENT JOINTS
420701-03	PAVEMENT WELDED WIRE REINFORCEMENT
442201-03	CLASS C AND D PATCHES
701001-02	OFF-ROAD OPERATIONS, 2L, 2W, MORE THAN 15' (4.5M) AWAY
701006-05	OFF-ROAD OPERATIONS, 2L, 2W, 15' TO 24" FROM PAVEMENT EDGE
701456-05	RAMP CLOSURE FREEWAY/EXPRESSWAY
701501-06	URBAN LANE CLOSURE, 2L, 2W, UNDIVIDED
701901-08	TRAFFIC CONTROL DEVICES
780001-05	TYPICAL PAVEMENT MARKINGS

GENERAL NOTES

THIS PROJECT IS LOCATED ON IL 185 IN THE CITY OF FARINA IN FAYETTE COUNTY. THE PROJECT IS LOCATED ON IL 185 BETWEEN JOHN DEERE RD, AND CARLTON AVE, AND THE ON/OFF RAMPS OF THE I-57 INTERCHANGE. THE WORK INCLUDED IN SECTION D7 PATCHING 2022-8 CONSISTS OF CLASS C PAVEMENT PATCHING W/PAVEMENT FABRIC, TRAFFIC CONTROL, AND ANY OTHER WORK NECESSARY TO COMPLETE THIS SECTION.

CLASS C PATCHING SHALL INCLUDE WELDED WIRE REINFORCEMENT ON THIS CONTRACT FOR THE TYPE III AND IV PATCHES. THE WIRE SHALL BE INSTALLED 3.5 INCHES +/- 1 IN. BELOW THE FINISHED PATCH SURFACE ELEVATION.

THE ACTUAL LOCATIONS OF PAVEMENT PATCHING AND FINAL QUANTITIES SHALL BE DETERMINED BY THE ENGINEER IN THE FIELD.

MODEL: Default
 FILE: M:\MS-PAV\ldot-cw-bentley.com\PROJECTS\DOT Offices\District 7\Projects\74B15\CADD\data\CAD\sheet\74B15-sht-index.dgn

USER NAME = steffenmk	DESIGNED -	REVISED -
	DRAWN -	REVISED -
PLOT SCALE = 100.0000 ' / in.	CHECKED -	REVISED -
PLOT DATE = 4/8/2022	DATE -	REVISED -

**STATE OF ILLINOIS
DEPARTMENT OF TRANSPORTATION**

INDEX OF SHEETS & GENERAL NOTES

SCALE: SHEET OF SHEETS STA. TO STA.

F.A.P. RTE.	SECTION	COUNTY	TOTAL SHEETS	SHEET NO.
750	D7 PATCHING 2022-8	FAYETTE	5	2
			CONTRACT NO. 74B15	
ILLINOIS FED. AID PROJECT				

SUMMARY OF QUANTITIES			TOTAL QUANTITIES	CONSTRUCTION TYPE CODE		
CODE NO	ITEM	UNIT		0006		
44200050	WELDED WIRE REINFORCEMENT	SO YD	1800	1800		
44201381	CLASS C PATCHES, TYPE III, 12 INCH	SO YD	39	39		
44201383	CLASS C PATCHES, TYPE IV, 12 INCH	SO YD	1761	1761		
67100100	MOBILIZATION	L SUM	1	1		
70100825	TRAFFIC CONTROL AND PROTECTION, STANDARD 701456	L SUM	1	1		
70102620	TRAFFIC CONTROL AND PROTECTION, STANDARD 701501	L SUM	1	1		
70107025	CHANGEABLE MESSAGE SIGN	CAL DA	28	28		

MODEL: Default
FILE NAME: p:\bullet-aw-beadley.com\P\1\DOT Documents\DOT Office\Dir\dir: 7\Project\74B15\CADD\DATA\CAD\Sheet\74B15-PL-500.dgn

USER NAME = steffenmk	DESIGNED -	REVISED -
	DRAWN -	REVISED -
PLOT SCALE = 100,0000' / in.	CHECKED -	REVISED -
PLOT DATE = 4/8/2022	DATE -	REVISED -

**STATE OF ILLINOIS
DEPARTMENT OF TRANSPORTATION**

SUMMARY OF QUANTITIES					
SCALE:	SHEET	OF	SHEETS	STA.	TO STA.

F.A.P. RTE.	SECTION	COUNTY	TOTAL SHEETS	SHEET NO.
750	D7 PATCHING 2022-8	FAYETTE	5	3
CONTRACT NO. 74B15			ILLINOIS FED. AID PROJECT	

MODEL: Default
 FILE NAME: p:\ultra-cw-bead\p\p\DOT\Documents\DOT Office\Dir\dir_7\Project\74B15\CADD\DATA\CAD\Sheet\74B15-SP-SCSched.xls

CLASS C PATCHING SCHEDULE								
Patch Number	Lane	Station	Length ft	Width ft	Plan Depth in	#44201381 Type 3 sy	#44201383 Type 4 sy	#44200050 Pavt Fab sy
1	EB	994+35	11.0	16.0	12.0	19.6		19.6
2	EB	994+45	11.0	16.0	12.0	19.6		19.6
3	EB	994+55	20.0	16.0	12.0		35.6	35.6
4	EB	1008+85	80.0	16.0	12.0		142.2	142.2
5	EB	1011+90	250.0	16.0	12.0		444.4	444.4
6	EBSHld	1013+60	80.0	10.0	12.0		88.9	88.9
7	EB	1017+05	105.0	14.0	12.0		163.3	163.3
8	EBSHld	1017+05	105.0	10.0	12.0		116.7	116.7
9	WBSHld	1019+25	65.0	8.0	12.0		57.8	57.8
10	WBSHld	1017+05	105.0	14.0	12.0		163.3	163.3
11	WB	1007+35	75.0	16.0	12.0		133.3	133.3
12	WB	995+30	20.0	16.0	12.0		35.6	35.6
13	WB	995+10	90.0	16.0	12.0		160.0	160.0
14	WBLTL	995+30	20.0	18.0	12.0		40.0	40.0
15	WBLTL	995+10	90.0	18.0	12.0		180.0	180.0
TOTALS :						39.2	1761.1	1800.3

USER NAME = stefenmk	DESIGNED -	REVISED -
	DRAWN -	REVISED -
PLOT SCALE = 100,0000 ' / in.	CHECKED -	REVISED -
PLOT DATE = 4/8/2022	DATE -	REVISED -

**STATE OF ILLINOIS
 DEPARTMENT OF TRANSPORTATION**

SCHEDULE OF QUANTITIES

SCALE: SHEET OF SHEETS STA. TO STA.

F.A.P. RTE.	SECTION	COUNTY	TOTAL SHEETS	SHEET NO.
750	D7 PATCHING 2022-8	FAYETTE	5	4
CONTRACT NO. 74B15				
ILLINOIS		FED. AID PROJECT		



PROJECT BEGINS
JOHN DEERE RD.

PROJECT ENDS
CARLTON AVE.

MODEL: Default
 FILE: \\mifs-pw-bentley.com\PW\DOT\Documents\DOT Offices\District 2\Projects\74B15\CADD\DATA\CAD\Sheets\74B15-Plan_Sht.dgn

USER NAME = steffnmk	DESIGNED -	REVISED -
	DRAWN -	REVISED -
PLOT SCALE = 100,0000' / in.	CHECKED -	REVISED -
PLOT DATE = 4/8/2022	DATE -	REVISED -

**STATE OF ILLINOIS
DEPARTMENT OF TRANSPORTATION**

PLAN SHEET

SCALE: SHEET OF SHEETS STA. TO STA.

F.A.P. RTE.	SECTION	COUNTY	TOTAL SHEETS	SHEET NO.
750	D7 PATCHING 2022-8	FAYETTE	5	5
CONTRACT NO. 74B15				
ILLINOIS FED. AID PROJECT				