

STATE OF ILLINOIS
DEPARTMENT OF TRANSPORTATION

F.A.P. RTE.	SECTION	COUNTY	TOTAL SHEETS	SHEET NO.
311	(2,3)RS-3&SW	KENDALL	21	1
		ILLINOIS	CONTRACT NO. 66J71	

INDEX OF SHEETS

- 1 COVER SHEET
- 2 GENERAL NOTES
- 3-6 SUMMARY OF QUANTITIES
- 7-9 TYPICAL SECTIONS
- 10-14 SCHEDULES
- 15-16 ADA DETAILS
- 17 LAYOUT MAP
- 18-21 DETAILS

LIST OF ILLINOIS DOT HIGHWAY STANDARDS

- 000001-08 STANDARD SYMBOLS, ABBREVIATIONS AND PATTERNS
- 406201-01 MAILBOX TURNOUT
- 424001-11 PERPENDICULAR CURB RAMPS FOR SIDEWALKS
- 424006-05 DIAGONAL CURB RAMPS FOR SIDEWALKS
- 424011-04 CORNER PARALLEL CURB RAMPS FOR SIDEWALKS
- 424021-06 DEPRESSED CORNER FOR SIDEWALKS
- 424026-03 ENTRANCE / ALLEY PEDESTRIAN CROSSINGS
- 630001-12 STEEL PLATE BEAM GUARDRAIL
- 701006-05 OFF-ROAD OPERATIONS 2L, 2W, 15' TO 24" FROM PAVEMENT EDGE
- 701011-04 OFF-ROAD MOVING OPERATIONS 2L, 2W, DAY ONLY
- 701301-04 LANE CLOSURE, 2L, 2W, SHORT TIME OPERATIONS
- 701306-04 LANE CLOSURE, 2L, 2W, SLOW MOVING OPERATIONS DAY ONLY, FOR SPEEDS ≥ 45 MPH
- 701311-03 LANE CLOSURE, 2L, 2W, MOVING OPERATIONS - DAY ONLY
- 701501-06 URBAN LANE CLOSURE, 2L, 2W, UNDIVIDED
- 701801-06 SIDEWALK, CORNER OR CROSSWALK CLOSURE
- 701901-08 TRAFFIC CONTROL DEVICES
- 780001-05 TYPICAL PAVEMENT MARKINGS
- 781001-04 TYPICAL APPLICATIONS RAISED REFLECTIVE PAVEMENT MARKERS
- 782006-01 GUARDRAIL AND BARRIER WALL REFLECTOR MOUNTING DETAILS

**PROPOSED
HIGHWAY PLANS**

**F.A.P. ROUTE 311 (IL 71)
SECTION (2,3)RS-3&SW
PROJECT COVD-UYDF(211)
3P MILLING & RESURFACING
KENDALL COUNTY**

C-93-048-19

**OMISSION
STA. 1268+77 TO STA. 1289+72**

**END PROJECT
STA. 1409+76
0.2 MI W OF IL 47
IN YORKVILLE**

**BRIDGE OMISSION
STA. 873+60 TO STA. 875+30**

**BEGIN PROJECT
STA. 869+15
LASALLE CO. LINE**

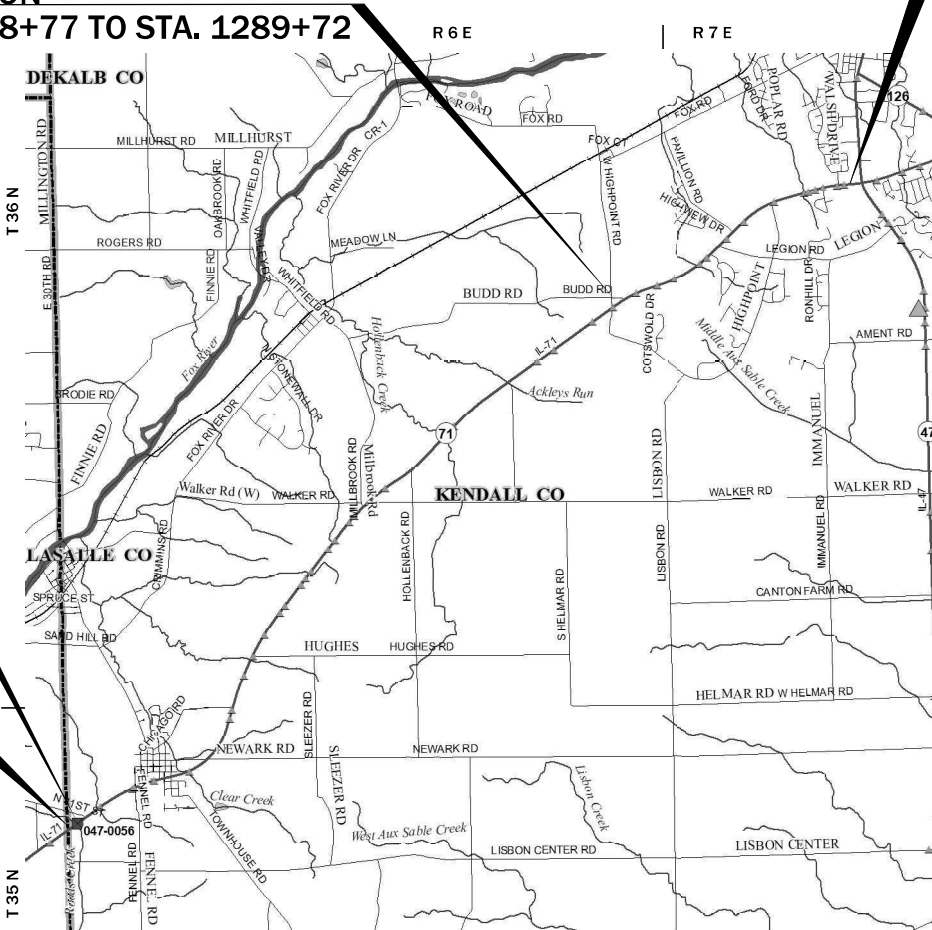

**FUNCTIONAL CLASSIFICATION:
OTHER PRIMARY ARTERIAL**
2019 ADT = 6250
P.V. = 89.00% S.U. = 5.25% M.U. = 5.75%

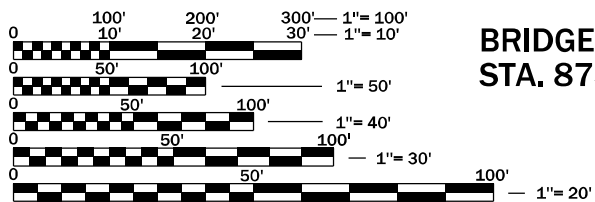

FULL SIZE PLANS HAVE BEEN PREPARED USING STANDARD ENGINEERING SCALES. REDUCED SIZED PLANS WILL NOT CONFORM TO STANDARD SCALES. IN MAKING MEASUREMENTS ON REDUCED PLANS, THE ABOVE SCALES MAY BE USED.

J.U.L.I.E.
JOINT UTILITY LOCATION INFORMATION FOR EXCAVATION
1-800-892-0123
OR 811

**PROJECT ENGINEER BRAD DUNCAN, P.E.
SQUAD LEADER DARCY CARPENTER
DISTRICT 3 NO. (815) 434-6131
CONTRACT NO. 66J71**

GROSS LENGTH = 54067.2 FT. = 10.24 MILE
NET LENGTH = 51963 FT. = 9.84 MILE

STATE OF ILLINOIS
DEPARTMENT OF TRANSPORTATION

SUBMITTED February 08, 2022

David Alford
REGIONAL ENGINEER

May 13, 2022 *Scott A. Etk*
ENGINEER OF DESIGN AND ENVIRONMENT

May 13, 2022 *Stephen M. Smith*
DIRECTOR OF HIGHWAYS PROJECT IMPLEMENTATION

**PRINTED BY THE AUTHORITY
OF THE STATE OF ILLINOIS**

GENERAL NOTES

THE HMA SURFACE OF ALL MAILBOX TURNOUTS, PRIVATE ENTRANCES, COMMERCIAL ENTRANCES, AND SIDE ROADS SHALL BE MADE NEATLY, IN A WORKMANLIKE MANNER, AND SHALL ACCURATELY CONFORM TO THE SHAPES AND DIMENSIONS SHOWN ON THE PLAN DETAILS. IF REQUIRED BY THE ENGINEER, THE CONTRACTOR SHALL SAW CUT THE HMA SURFACE TO CONFORM TO THE SHAPES AND DIMENSIONS SHOWN ON THE PLAN DETAILS. THIS WORK WILL BE INCLUDED IN THE COST OF THE HMA SURFACE.

EXCEPT AS NOTED ON THE PLANS, PAVEMENT GRADES SHOWN ARE AT THE TOP OF PAVEMENT SURFACES.

THE ENGINEER WILL BE THE SOLE JUDGE CONCERNING CURING TIME FOR THE VARIOUS HMA LIFTS.

ON EXISTING PAVEMENT WHICH MAY BE SUPERELEVATED, THE NEW HMA PAVEMENT SHALL BE BUILT WITH THE SAME SUPERELEVATION UNLESS NEW SUPERELEVATION RATES ARE GIVEN ON THE PLANS.

ALL ELEVATIONS REFERRING TO U.S.G.S. MEAN SEA LEVEL DATUM.

THE FOLLOWING RATES OF APPLICATION HAVE BEEN USED IN CALCULATING PLAN QUANTITIES:

GRANULAR MATERIALS	2.05	TONS / CU YD
HMA RESURFACING	112	LBS / SQ YD / IN
SHORT TERM PAVEMENT MARKING	10	FT /100 FT OF APPLICATION
MIX FOR CRACKS, JTS & FLGWYS	0.0003	TONS / SQ YD
LEVEL BINDER (HAND METHOD)	0.0005	TONS / SQ YD
SUPPLEMENTAL WATERING	3	GAL / SQ YD / APPLICATION
CALCIUM CHLORIDE	2	LB / SQ YD / APPLICATION
AGGREGATE DITCH CHECKS	5	TONS AGGREGATE

THE CONTRACTOR SHALL CONTACT JULIE AT LEAST 48 HOURS PRIOR TO EXCAVATION TO DETERMINE WHICH UTILITES ARE IN THE AREA.

HMA MIXTURE REQUIREMENT TABLE					
LOCATIONS:	ENTIRE PROJECT	ENTIRE PROJECT	ENTIRE PROJECT	ENTIRE PROJECT	ENTIRE PROJECT
MIXTURE USE(S):	HMA BINDER COURSE	HMA SURFACE COURSE	HMA SHOULDER BOTTOM LIFT(S)	HMA SHOULDER TOP LIFT	INCIDENTAL HMA
BINDER GRADE (PG):	PG 64-22	PG 64-22	PG 64-22	PG 64-22	PG 64-22
DESIGN AIR VOIDS:	4.0% @ N70	4.0% @ N70	4.0% @ N50	4.0% @ N50	4.0% @ N50
MIXTURE COMPOSITION: (MIXTURE GRADATION)	IL-19.0	IL-9.5	IL-19.0	IL-9.5	IL-9.5
FRICTION AGGREGATE:		MIXTURE D			
MIXTURE WEIGHT:	112.0 LB/SY/IN	112.0 LB/SY/IN	112.0 LB/SY/IN	112.0 LB/SY/IN	112.0 LB/SY/IN
QUALITY MANAGEMENT PROGRAM:	QCP	QCP	QC/QA	QC/QA	QC/QA
SUBLOT SIZE:	1000 TONS	1000 TONS	N/A	N/A	N/A
DENSITY TEST METHOD:	CORES	CORES	CORES/NUCLEAR	CORES/NUCLEAR	SATISFACTION OF ENGINEER
MATERIAL TRANSFER DEVICE (REQUIRED):	YES	YES	NO	NO	NO

66J71-IL 71: LASALLE CO LINE TO 0.2 MI W OF IL 47

STATE OF ILLINOIS
DEPARTMENT OF TRANSPORTATION
DISTRICT THREE
AS BUILT INFORMATION

STATE OF ILLINOIS
DEPARTMENT OF TRANSPORTATION
DISTRICT THREE

SUPERVISING CONSTRUCTION FIELD ENGINEER

PREPARED BY: _____
DISTRICT STUDIES & PLANS ENGINEER

RESIDENT ENGINEER / TECHNICIAN

DATE: _____

START & END DATES
OF CONSTRUCTION:

EXAMINED BY: _____
DISTRICT CONSTRUCTION ENGINEER

INSPECTORS:

DISTRICT MATERIALS ENGINEER

DISTRICT OPERATIONS ENGINEER

FILE NAME =	USER NAME = youslfm	DESIGNED - _____	REVISED - _____	STATE OF ILLINOIS DEPARTMENT OF TRANSPORTATION	GENERAL NOTES	F.A.P. RTE.	SECTION	COUNTY	TOTAL SHEETS	SHEET NO.
pw:\idot-pw\berkeley.com\PWIDOT\Documents\IDOT Office\District 3\Projects\0366J71\CADData\CADsheets\0366J71-1.dwg	DRAWN - _____	REVISED - _____	311			(2,3)RS-3&SW	KENDALL	21	2	
PLOT SCALE = 100,0000' / in.	CHECKED - _____	REVISED - _____	CONTRACT NO. 66J71							
Default	PLOT DATE = 2/9/2022	DATE - _____	REVISED - _____			SCALE: _____	SHEET _ OF _ SHEETS	STA. _____ TO STA. _____	ILLINOIS	FED. AID PROJECT

CODE NO.	ITEM	UNIT	TOTAL QUANTITY	CONSTR. CODE	
				URBAN	100% FED INFO-COVID-SUPP ROADWAY 0005 RURAL
20400800	FURNISHED EXCAVATION	CU YD	19		19
25000210	SEEDING, CLASS 2A	ACRE	0.2		0.2
25000400	NITROGEN FERTILIZER NUTRIENT	POUND	18		18
25000500	PHOSPHORUS FERTILIZER NUTRIENT	POUND	18		18
25000600	POTASSIUM FERTILIZER NUTRIENT	POUND	18		18
25100630	EROSION CONTROL BLANKET	SQ YD	976		976
40600290	BITUMINOUS MATERIALS (TACK COAT)	POUND	17768		17768
40600370	LONGITUDINAL JOINT SEALANT	FOOT	155313		155313
40600400	MIXTURE FOR CRACKS, JOINTS, AND FLANGWAYS	TON	59		59
40600990	TEMPORARY RAMP	SQ YD	712		712
40603085	HOT-MIX ASPHALT BINDER COURSE, IL-19.0, N70	TON	18304		18304
40604062	HOT-MIX ASPHALT SURFACE COURSE, IL-9.5, MIX "D", N70	TON	12203		12203
40800050	INCIDENTAL HOT-MIX ASPHALT SURFACING	TON	731		731
42400100	PORTLAND CEMENT CONCRETE SIDEWALK 4 INCH	SQ FT	220		220

MODEL: Default
 FILE NAME: p:\project-aw-beadley.com\PIV\DOT\Documents\DOT Office\Dir\dir: 3\Project\036671\CA\Drawings\CAD\Sheets\036671-Sub-S00.dgn

USER NAME = youslfm	DESIGNED - _____	REVISED - _____	STATE OF ILLINOIS DEPARTMENT OF TRANSPORTATION	SUMMARY OF QUANTITIES		F.A.P. RTE.	SECTION	COUNTY	TOTAL SHEETS	SHEET NO.
PLOT SCALE = 100,0000' / in.	CHECKED - _____	REVISED - _____				311	(2,3)RS-3&5W	KENDALL	21	3
PLOT DATE = 2/9/2022	DATE - _____	REVISED - _____		SCALE: _____ SHEET ____ OF ____ SHEETS STA. _____ TO STA. _____		ILLINOIS FED. AID PROJECT		CONTRACT NO. 66J71		

CODE NO.	ITEM	UNIT	TOTAL QUANTITY	CONSTR. CODE	
				URBAN	100% FED INFO-COVID-SUPP ROADWAY
				0005	RURAL
* 42400800	DETECTABLE WARNINGS	SQ FT	16		16
44000164	HOT-MIX ASPHALT SURFACE REMOVAL, 3 3/4"	SQ YD	197723		197723
44000500	COMBINATION CURB AND GUTTER REMOVAL	FOOT	33		33
44000600	SIDEWALK REMOVAL	SQ FT	118		118
48203100	HOT-MIX ASPHALT SHOULDERS	TON	11015		11015
60605000	COMBINATION CONCRETE CURB AND GUTTER, TYPE B-6.24	FOOT	33		33
* 63000001	STEEL PLATE BEAM GUARDRAIL, TYPE A, 6 FOOT POSTS	FOOT	737.5		737.5
* 63100167	TRAFFIC BARRIER TERMINAL, TYPE 1 (SPECIAL) TANGENT	EACH	16		16
63200310	GUARDRAIL REMOVAL	FOOT	900		900
64200108	SHOULDER RUMBLE STRIPS, 8 INCH	FOOT	106620		106620
67000400	ENGINEER'S FIELD OFFICE, TYPE A	CAL MO	4		4
67100100	MOBILIZATION	L SUM	1		1
70100460	TRAFFIC CONTROL AND PROTECTION, STANDARD 701306	L SUM	1		1
70300100	SHORT TERM PAVEMENT MARKING	FOOT	15612		15612

*= SPECIALTY ITEM

MODEL: Default
 FILE: \\nas01-01\public\sw_bentley.com\PROJECTS\DOT Offices\District 3\Projects\036671\CADD\Drawings\036671-01.dwg

USER NAME = carminaw	DESIGNED - _____	REVISED - _____	STATE OF ILLINOIS DEPARTMENT OF TRANSPORTATION	SUMMARY OF QUANTITIES			F.A.P. RTE.	SECTION	COUNTY	TOTAL SHEETS	SHEET NO.
PLOT SCALE = 100,0000' / in.	DRAWN - _____	REVISED - _____					311	(2,3)RS-3&5W	KENDALL	25	4
PLOT DATE = 2/9/2022	CHECKED - _____	REVISED - _____		SCALE: _____ SHEET ___ OF ___ SHEETS STA. _____ TO STA. _____			CONTRACT NO. 66J71				
	DATE - _____	REVISED - _____					ILLINOIS FED. AID PROJECT				

CODE NO.	ITEM	UNIT	TOTAL QUANTITY	CONSTR. CODE	
				URBAN	100% FED INFO-COVID-SUPP ROADWAY
				0005	RURAL
70300150	SHORT TERM PAVEMENT MARKING REMOVAL	SQ FT	5204		5204
* 72501000	TERMINAL MARKER - DIRECT APPLIED	EACH	16		16
* 78000100	THERMOPLASTIC PAVEMENT MARKING - LETTERS AND SYMBOLS	SQ FT	203		203
* 78000200	THERMOPLASTIC PAVEMENT MARKING - LINE 4"	FOOT	15474		15474
* 78000400	THERMOPLASTIC PAVEMENT MARKING - LINE 6"	FOOT	435		435
* 78000500	THERMOPLASTIC PAVEMENT MARKING - LINE 8"	FOOT	1187		1187
* 78000600	THERMOPLASTIC PAVEMENT MARKING - LINE 12"	FOOT	492		492
* 78000650	THERMOPLASTIC PAVEMENT MARKING - LINE 24"	FOOT	106		106
* 78001110	PAINT PAVEMENT MARKING - LINE 4"	FOOT	247502		247502
* 78001130	PAINT PAVEMENT MARKING - LINE 6"	FOOT	20720		20720
* 78011000	GROOVING FOR RECESSED PAVEMENT MARKING, LETTERS AND SYMBOLS	SQ FT	203		203
* 78011025	GROOVING FOR RECESSED PAVEMENT MARKING 5"	FOOT	15474		15474
* 78011035	GROOVING FOR RECESSED PAVEMENT MARKING 7"	FOOT	435		435
* 78011045	GROOVING FOR RECESSED PAVEMENT MARKING 9"	FOOT	1187		1187

*= SPECIALTY ITEM

MODEL: Default
 FILE NAME: p:\blider-cw-bentley.com\PROJECTS\DOT Offices\District 3\Projects\036671\CADD\Drawings\036671-01.rvt

USER NAME = carminaw	DESIGNED - _____	REVISED - _____	STATE OF ILLINOIS DEPARTMENT OF TRANSPORTATION	SUMMARY OF QUANTITIES		F.A.P. RTE.	SECTION	COUNTY	TOTAL SHEETS	SHEET NO.
PLOT SCALE = 100,0000' / in.	CHECKED - _____	REVISED - _____				311	(2,3)RS-3&5W	KENDALL	25	5
PLOT DATE = 2/9/2022	DATE - _____	REVISED - _____		SCALE: _____ SHEET ____ OF ____ SHEETS STA. _____ TO STA. _____		ILLINOIS FED. AID PROJECT		CONTRACT NO. 66J71		

CODE NO.	ITEM	UNIT	TOTAL QUANTITY	CONSTR. CODE	
				URBAN	
				100% FED INFO-COVID-SUPP ROADWAY	
				0005	RURAL
* 78011065	GROOVING FOR RECESSED PAVEMENT MARKING 13"	FOOT	492	492	
* 78011125	GROOVING FOR RECESSED PAVEMENT MARKING 25"	FOOT	106	106	
* 78100100	RAISED REFLECTIVE PAVEMENT MARKER	EACH	634	634	
* 78200005	GUARDRAIL REFLECTORS, TYPE A	EACH	87	87	
78300200	RAISED REFLECTIVE PAVEMENT MARKER REMOVAL	EACH	634	634	
X0327809	LINEAR DELINEATOR PANELS, 4 INCH	EACH	58	58	
X4401198	HOT-MIX ASPHALT SURFACE REMOVAL, VARIABLE DEPTH	SQ YD	6531	6531	
Ø Z0076600	TRAINEES	HOUR	1,000	1,000	
Z0030850	TEMPORARY INFORMATION SIGNING	SQ FT	42	42	
Ø Z0076604	TRAINEES - TRAINING PROGRAM GRADUATE	HOUR	1,000	1,000	
Z0034105	MATERIAL TRANSFER DEVICE	TON	30507	30507	

*= SPECIALTY ITEM Ø 0042

MODEL: Default
 FILE NAME: p:\blider-cw\benlley.com\PHWDOT\Documents\DOT Offices\District 3\Projects\036671\CADD\Drawings\Sheet\036671-Phas.dgn

USER NAME = carminaw	DESIGNED - _____	REVISED - _____	STATE OF ILLINOIS DEPARTMENT OF TRANSPORTATION	SUMMARY OF QUANTITIES			F.A.P. RTE.	SECTION	COUNTY	TOTAL SHEETS	SHEET NO.
PLOT SCALE = 100.0000' / in.	DRAWN - _____	REVISED - _____					311	(2,3)RS-3&5W	KENDALL	25	6
PLOT DATE = 2/9/2022	CHECKED - _____	REVISED - _____		SCALE: _____ SHEET ___ OF ___ SHEETS STA. _____ TO STA. _____			CONTRACT NO. 66J71				
DATE - _____	REVISED - _____	REVISED - _____					ILLINOIS FED. AID PROJECT				

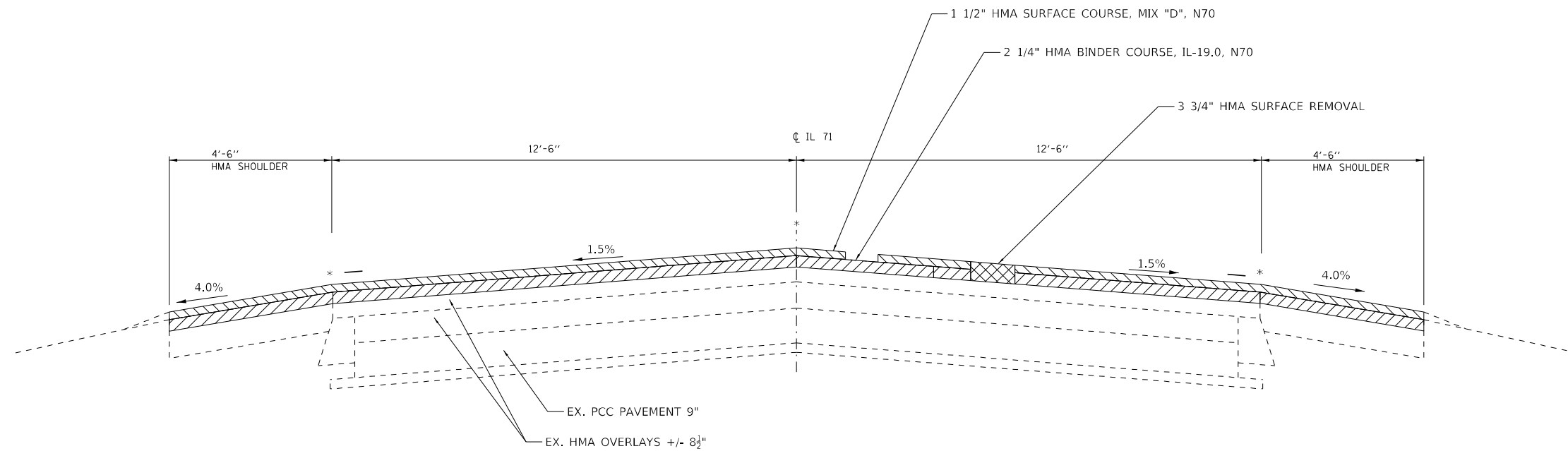

PROPOSED TYPICAL SECTION 1

- STA 869+15 TO STA 873+60
- STA 873+60 TO STA 875+30 (BRIDGE OMISSION)
- STA 875+30 TO STA 910+43
- STA 921+30 TO STA 925+34
- STA 931+15 TO STA 1104+34
- STA 1109+68 TO STA 1268+77
- STA 1268+77 TO STA 1289+72 (OMISSION)
- STA 1289+72 TO STA 1329+87
- STA 1331+82 TO STA 1347+82
- STA 1350+86 TO STA 1409+76

* LONGITUDINAL JOINT SEALANT IS TO BE PLACED UNDER THE HMA SURFACE

MODEL: Default
 FILE NAME: p:\project\paw_bentley.com\p\illinois\documents\DOT_offices\dir\dir_3\project\366671\CAD\data\CADsheets\366671-366671-366671.dgn

USER NAME = yousifm	DESIGNED -	REVISED -
	DRAWN -	REVISED -
PLOT SCALE = 100,0000 ' / in.	CHECKED -	REVISED -
PLOT DATE = 2/7/2022	DATE -	REVISED -

**STATE OF ILLINOIS
DEPARTMENT OF TRANSPORTATION**

TYPICAL SECTIONS	
SCALE:	SHEET 1 OF 3 SHEETS STA. TO STA.

F.A.P. RTE.	SECTION	COUNTY	TOTAL SHEETS	SHEET NO.
311	(2,3)RS-3&5W	KENDALL	21	7
CONTRACT NO. 66J71				
ILLINOIS FED. AID PROJECT				

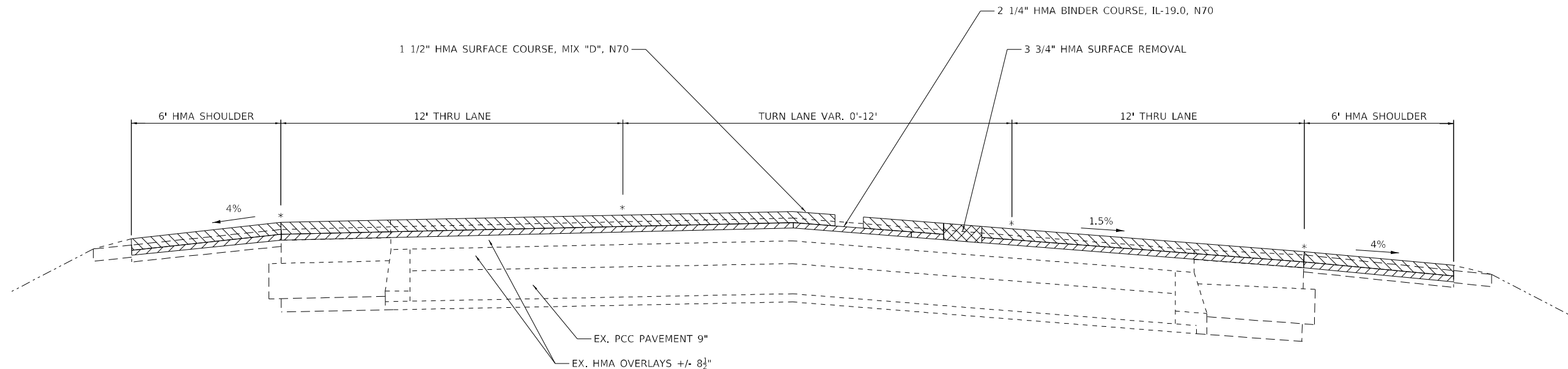

PROPOSED TYPICAL SECTION 2

STA 910+43 TO STA 921+30

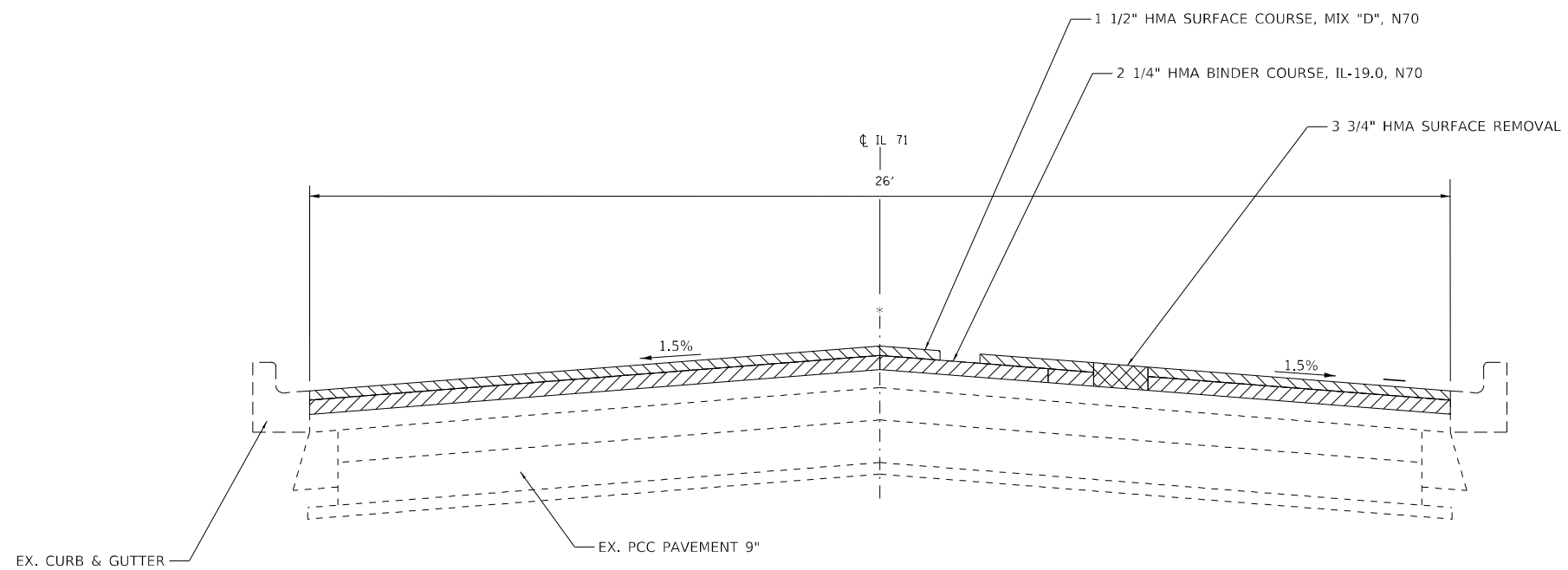

PROPOSED TYPICAL SECTION 3

STA 925+34 TO STA 931+15

* LONGITUDINAL JOINT SEALANT IS TO BE PLACED UNDER THE HMA SURFACE

MODEL: Default
 FILE: \\na11c01.pva\ultra-cw-bea\pva.com\PIV\DOT\Documents\DOT Office\Dir\dr. 3\Project\036671\CA\Drawings\CAD\Sheets\036671-Sub\Typical.dgn

USER NAME = youslfm	DESIGNED -	REVISED -
	DRAWN -	REVISED -
PLOT SCALE = 100,0000' / in.	CHECKED -	REVISED -
PLOT DATE = 2/7/2022	DATE -	REVISED -

**STATE OF ILLINOIS
DEPARTMENT OF TRANSPORTATION**

TYPICAL SECTIONS

SCALE: SHEET 2 OF 3 SHEETS STA. TO STA.

F.A.P. RTE.	SECTION	COUNTY	TOTAL SHEETS	SHEET NO.
311	(2,3)RS-3&5W	KENDALL	21	8
CONTRACT NO. 66J71				
ILLINOIS FED. AID PROJECT				

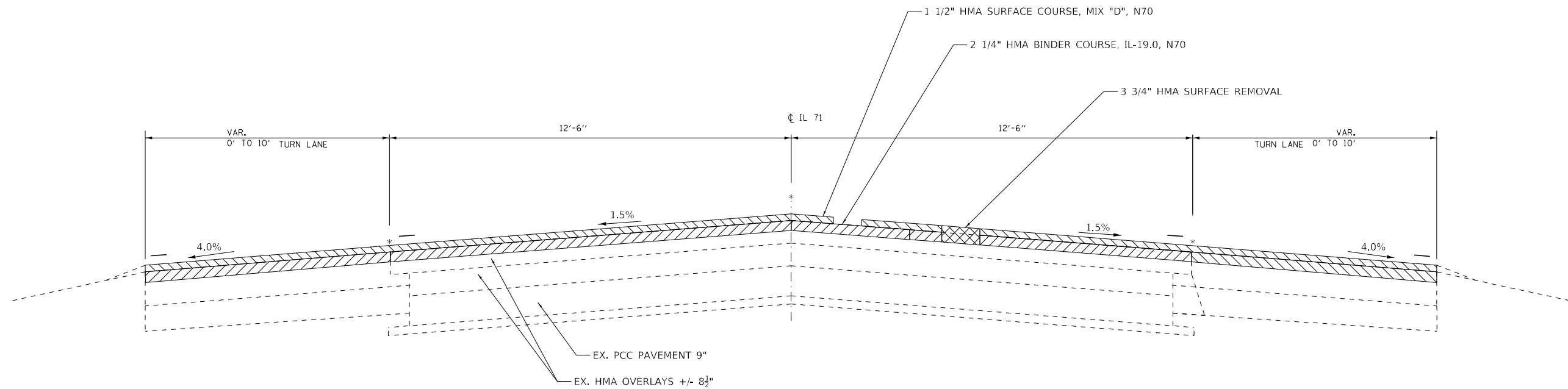

PROPOSED TYPICAL SECTION 4

STA 1104+34 TO STA 1109+68

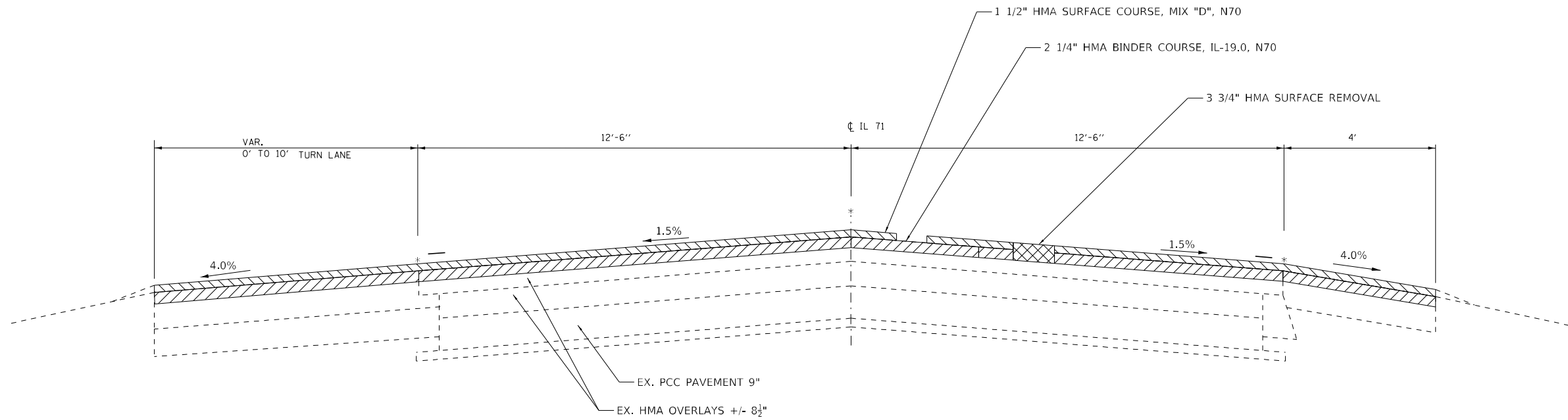

PROPOSED TYPICAL SECTION 5

STA 1329+87 TO STA 1331+82
 STA 1347+82 TO STA 1350+86

* LONGITUDINAL JOINT SEALANT IS TO BE PLACED UNDER THE HMA SURFACE

MODEL: Default
 FILE: \\na11c01.pva\ultra-caw-bee\caw.com\PIV\DOT\Documents\1\DOT Office\Dir\rdt_3\Project\1036671\CA\Drawings\CAD\Sheets\1036671-Sub\Typical.dgn

USER NAME = youslfm	DESIGNED -	REVISED -
	DRAWN -	REVISED -
PLOT SCALE = 100,0000 ' / in.	CHECKED -	REVISED -
PLOT DATE = 2/7/2022	DATE -	REVISED -

**STATE OF ILLINOIS
 DEPARTMENT OF TRANSPORTATION**

TYPICAL SECTIONS			
SCALE:	SHEET 3	OF 3 SHEETS	STA. TO STA.

F.A.P. RTE.	SECTION	COUNTY	TOTAL SHEETS	SHEET NO.
311	(2,3)RS-3&5W	KENDALL	21	9
CONTRACT NO. 66J71				
ILLINOIS FED. AID PROJECT				

MAINLINE SCHEDULE

STA. TO STA.	LENGTH	MAINLINE WIDTH	SHLD WIDTH	HMA SURFACE REMOVAL	HMA SURF.CSE MIX.D IL-9.5,N70 1 1/2"	BINDER COURSE IL-19.0 N70 2 1/4"	HMA SHLD IL-9.5 N50 TOP LIFT	HMA SHLD IL-19.5 N50 BOTTOM LIFT	MATERIAL TRANSFER DEVICE	MIX FOR JTS, CRACKS & FLGWYS	BIT. MAT'L (TACK COAT)	LONG JOINT SEAL		TEMP RAMP	SHLD RUMBLE STRIP LT/RT 8"		
												MAINLINE	SHLD				
		FOOT	FOOT	FOOT	SQ YD	TONS	TONS	TON	TON	TON	TONS	POUND	FOOT	FOOT	SQ YD	FOOT	
869+15	873+60	445	25	9	1681	103.8	156	37.4	56.1	259.6	0.5	126	445	890	34.7	890.0	
873+60	875+30	170	BRIDGE OMISSION													69.4	
875+30	910+43	3513	25	9	13271	819.7	1230	295.1	442.6	2049.3	4.0	995	3513	7026		7026.0	
910+43	921+30	1087	36	12	5797	365.2	548	121.7	182.6	913.1	1.7	435	2174	2174		2174.0	
921+30	925+34	404	25	9	1526	94.3	141	33.9	50.9	235.7	0.5	114	404	808		808.0	
925+34	931+15	581	26		1678	141.0	211			352.5	0.5	126	581				
931+15	1104+34	17319	25	9	65427	4041.1	6062	1454.8	2182.2	10102.8	19.6	4907	17319	34638		34638.0	
1104+34	1109+68	534	25	20	2670	124.6	187	99.7	149.5	311.5	0.8	200	534	1068		1068.0	
1109+68	1268+77	15909	25	9	60101	3712.1	5568	1336.4	2004.5	9280.3	18.0	4508	15909	31818		31818.0	
1268+77	1289+72	2095	OMISSION													69.4	4190.0
1289+72	1329+87	4015	25	9	15168	936.8	1405	337.3	505.9	2342.1	4.6	1138	4015	8030		8030.0	
1329+87	1331+82	195	25	13	823	45.5	68	23.7	35.5	113.8	0.2	62	195	390		390.0	
1331+82	1347+82	1600	25	9	6044	373.3	560	134.4	201.6	933.3	1.8	453	1600	3200		3200.0	
1347+82	1350+86	304	25	13	1284	70.9	106	36.9	55.3	177.3	0.4	96	304	608		608.0	
1350+86	1409+76	5890	25	9	22251	1374.3	2062	494.8	742.1	3435.8	6.7	1669	5890	11780	34.7	11780.0	
TOTALS					197723	12203	18304	4406	6609	30507	59	14829	52883	102430	208	106620	

SIDEROADS

NAME	STA.	MATERIAL	SIDE LT/RT	WIDTH FRONT	WIDTH BACK	VARIABLE	INCIDENTAL	BIT	FURNISH EX	SEEDING CL 2A	NITROGEN FERTILIZER NUTRIENT	PHOSPORUS FERTILIZER NUTRIENT	POTASSIUM FERTILIZER NUTRIENT	EROSION CONTROL BLANKET	TEMP RAMP
						DEPTH SURF REM	HMA SURF IL-9.5 N50	MATL (TACK COAT)							
N41ST RD	879+34	HMA	LT	126	48	290.0	32.5	130.5	1.3	0.02	2.0	2.0	2.0	106.7	10.7
OTTAWA RD	909+88	HMA	LT	84	22	176.7	19.8	79.5	1.3	0.01	0.9	0.9	0.9	48.9	4.9
OTTAWA RD	909+88	HMA	RT	62	18	133.3	14.9	60.0	1.3	0.01	1.1	1.1	1.1	60.0	4.0
JOHNSON ST	917+03	HMA	LT	156	50	343.3	38.5	154.5							11.1
VAN BUREN	923+24	HMA	LT	36	12	80.0	9.0	36.0							2.7
UNION RD	925+42	HMA	RT	74	24	163.3	18.3	73.5							5.3
UNION RD	925+62	HMA	LT	72	24	160.0	17.9	72.0							5.3
EAST ST	930+70	HMA	LT	78	24	170.0	19.0	76.5							5.3
EAST ST	930+70	HMA	RT	78	24	170.0	19.0	76.5							5.3
MAIN ST	950+24	HMA	LT	112	38	250.0	28.0	112.5	2.8	0.02	1.6	1.6	1.6	84.4	8.4
MAIN ST	950+24	HMA	RT	140	64	340.0	38.1	153.0	2.3	0.03	2.6	2.6	2.6	142.2	14.2
CHICAGO RD	980+86	HMA	LT	106	24	216.7	24.3	97.5	1.3	0.01	1.0	1.0	1.0	53.3	5.3
HUGHES RD	1009+38	HMA	RT	116	38	256.7	28.7	115.5	1.3	0.02	1.6	1.6	1.6	84.4	8.4
MILLBROOK RD	1104+94	HMA	LT	115	45	266.7	29.9	120.0	1.3	0.02	1.9	1.9	1.9	100.0	10.0
WALKER RD	1109+17	HMA	RT	92	33	208.3	23.3	93.8	1.1	0.02	1.4	1.4	1.4	73.3	7.3
HOLLENBACK RD	1138+21	HMA	RT	74	22	160.0	17.9	72.0	1.3	0.01	0.9	0.9	0.9	48.9	4.9
SLEEPY HOLLOW RD	1205+28	HMA	RT	98	28	210.0	23.5	94.5	1.1	0.01	1.2	1.2	1.2	62.2	6.2
TIMBER CREEK RD	1331+58	HMA	RT	52	33	141.7	15.9	63.8							7.3
LEGION RD	1337+79	HMA	RT	92	30	203.3	22.8	91.5							6.7
PAVILLION RD	1347+82	HMA	LT	91	28	198.3	22.2	89.3	1.1	0.01	1.2	1.2	1.2	62.2	6.2
HIGHPOINT RD	1373+17	HMA	RT	92	22	190.0	21.3	85.5	1.1	0.01	0.9	0.9	0.9	48.9	4.9
TOTALS						4328.3	484.8	1947.8	18.6	0.20	18.1	18.1	18.1	975.6	144.7

MODEL: Default
 FILE: Mainline_schedule.dwg
 PROJECT: D:\Projects\DOT Office\Drawings\Projects\316671\CA000\316671\CA000\316671.dwg

USER NAME = yousifm	DESIGNED - AC	REVISED - _____
	DRAWN - AC	REVISED - _____
PLOT SCALE = 100,0000' / in.	CHECKED - MY	REVISED - _____
PLOT DATE = 2/9/2022	DATE - 1/14/2022	REVISED - _____

**STATE OF ILLINOIS
DEPARTMENT OF TRANSPORTATION**

SCHEDULES

SCALE: _____ SHEET 1 OF 1 SHEETS STA. _____ TO STA. _____

F.A.I. RTE.	SECTION	COUNTY	TOTAL SHEETS	SHEET NO.
311	(2,3)RS-365W	KENDALL	21	10
CONTRACT NO. 66J71				
ILLINOIS FED. AID PROJECT				

ENTRANCES SCHEDULE - IL 71 KENDALL COUNTY

NAME	STA.	SIDE	WIDTH	WIDTH	VARIABLE	INCIDENTAL	BIT	TEMP
			FRONT	BACK	DEPTH	HMA SURF	MATL	
		LT/RT	FOOT	FOOT	SQ YD	TON	POUND	SQ YD
PE	877+84	RT	35	25	33.3	3.7	15.0	5.6
PE	880+04	RT	30	20	27.8	3.1	12.5	4.4
PE	882+34	RT	30	20	27.8	3.1	12.5	4.4
PE	885+34	LT	35	25	33.3	3.7	15.0	5.6
PE	886+59	LT	25	15	22.2	2.5	10.0	3.3
PE	886+84	RT	35	25	33.3	3.7	15.0	5.6
PE	892+84	RT	35	25	33.3	3.7	15.0	5.6
CE	903+73	RT	75	45	66.7	7.5	30.0	10.0
PE	921+99	LT	35	25	33.3	3.7	15.0	5.6
CE	943+49	RT	65	45	61.1	6.8	27.5	10.0
CE	917+99	RT	75	50	69.4	7.8	31.3	11.1
PE	1010+13	LT	45	35	44.4	5.0	20.0	7.8
PE	1011+63	RT	30	20	27.8	3.1	12.5	4.4
PE	1044+88	LT	35	25	33.3	3.7	15.0	5.6
PE	1046+38	LT	35	25	33.3	3.7	15.0	5.6
PE	1054+13	RT	35	25	33.3	3.7	15.0	5.6
PE	1056+63	LT	40	30	38.9	4.4	17.5	6.7
PE	1056+88	RT	30	20	27.8	3.1	12.5	4.4
CE, CE	1065+88	LT	155	125	155.6	17.4	70.0	27.8
PE	1085+94	RT	40	30	38.9	4.4	17.5	6.7
PE	1095+69	RT	30	20	27.8	3.1	12.5	4.4
PE	1097+44	RT	35	25	33.3	3.7	15.0	5.6
PE	1113+92	LT	30	20	27.8	3.1	12.5	4.4
PE	1135+71	LT	65	40	58.3	6.5	26.3	8.9
PE	1166+46	LT	30	20	27.8	3.1	12.5	4.4
PE	1168+96	RT	55	35	50.0	5.6	22.5	7.8
PE	1183+03	LT	35	25	33.3	3.7	15.0	5.6
FIELD ENT	1213+53	LT	35	25	33.3	3.7	15.0	5.6
FIELD ENT	1239+03	RT	55	45	55.6	6.2	25.0	10.0
SUBTOTALS					1222.2	136.9	550.0	202.2

ENTRANCES SCHEDULE CONTINUED - IL 71 KENDALL COUNTY

NAME	STA.	SIDE	WIDTH	WIDTH	VARIABLE	INCIDENTAL	BIT	TEMP
			FRONT	BACK	DEPTH	HMA SURF	MATL	
		LT/RT	FOOT	FOOT	SQ YD	TON	POUND	SQ YD
PE	1242+28	LT	35	25	33.3	3.7	15.0	5.6
PE	1265+63	LT	30	20	27.8	3.1	12.5	4.4
PE	1268+28	LT	30	20	27.8	3.1	12.5	4.4
PE	1287+12	RT	45	35	44.4	5.0	20.0	7.8
PE	1302+21	RT	35	20	30.6	3.4	13.8	4.4
PE	1304+58	LT	40	20	33.3	3.7	15.0	4.4
PE	1318+33	RT	30	20	27.8	3.1	12.5	4.4
PE	1326+93	LT	45	25	38.9	4.4	17.5	5.6
PE	1330+08	LT	25	15	22.2	2.5	10.0	3.3
PE	1332+43	LT	40	20	33.3	3.7	15.0	4.4
PE	1336+29	LT	50	35	47.2	5.3	21.3	7.8
PE	1339+29	LT	30	20	27.8	3.1	12.5	4.4
PE	1340+19	LT	25	15	22.2	2.5	10.0	3.3
PE	1340+29	RT	25	15	22.2	2.5	10.0	3.3
PE	1341+79	LT	40	30	38.9	4.4	17.5	6.7
PE	1342+29	LT	55	45	55.6	6.2	25.0	10.0
PE	1352+82	LT	45	30	41.7	4.7	18.8	6.7
PE	1354+07	LT	40	25	36.1	4.0	16.3	5.6
PE	1369+17	LT	30	20	27.8	3.1	12.5	4.4
PE	1370+17	LT	35	25	33.3	3.7	15.0	5.6
CE	1385+92	RT	25	15	22.2	2.5	10.0	3.3
CE	1385+92	LT	60	40	55.6	6.2	25.0	8.9
CE	1388+92	LT	65	50	63.9	7.2	28.8	11.1
PE	1390+52	LT	30	20	27.8	3.1	12.5	4.4
PE	1394+17	LT	30	20	27.8	3.1	12.5	4.4
PE	1397+67	LT	40	25	36.1	4.0	16.3	5.6
PE	1400+52	LT	30	20	27.8	3.1	12.5	4.4
CE	1400+67	RT	50	35	47.2	5.3	21.3	7.8
SUBTOTALS					980.6	109.8	441.3	156.7
TOTALS					2202.8	246.7	991.3	358.9

MODEL: Default
 FILE: \\MAILSrv\pub\ultra-cw-bead\p\71\DOT\Documents\DOT\Entrances\IL71\Entrances.dgn

USER NAME = yousifm	DESIGNED - AC	REVISED - _____
	DRAWN - AC	REVISED - _____
PLOT SCALE = 100,0000' / in.	CHECKED - MY	REVISED - _____
PLOT DATE = 2/7/2022	DATE - 1/14/2022	REVISED - _____

**STATE OF ILLINOIS
DEPARTMENT OF TRANSPORTATION**

SCHEDULES

SCALE: _____ SHEET 1 OF 1 SHEETS STA. _____ TO STA. _____

F.A.I. RTE.	SECTION	COUNTY	TOTAL SHEETS	SHEET NO.
311	(2,3)RS-365W	KENDALL	21	11
CONTRACT NO. 66J71				
ILLINOIS FED. AID PROJECT				

THERMOPLASTIC PAVEMENT MARKING SCHEDULE

STA TO STA	LOCATION	LENGTH	THERMOPLASTIC										GROOVING FOR RCSD PVT MRKG					
			4"	4"	6"	6"	8"	12"	12"	24"	LTRS &	5"	7"	9"	13"	25"	LTRS &	
			WH	YW	WH	YW	WH	WH	YW	WH	SYM	FOOT	FOOT	FOOT	FOOT	FOOT	SYM	
			FOOT	FOOT	FOOT	FOOT	FOOT	FOOT	FOOT	FOOT	SQ FT	FOOT	FOOT	FOOT	FOOT	FOOT	SQ FT	
869+15 - 909+88	LASALLE CO TO OTTAWA RD	4073																
909+88 - 917+03	OTTAWA RD TO JOHNSON ST	715	1423	2040				234			143	46.8	3463		234	143	46.8	
* 917+03 - 950+24	JOHNSON ST TO MAIN ST	3321	6203	5808	75	360			183	166			12011	435		349		
950+24 - 980+86	MAIN ST TO CHICAGO RD	3062									58						58	
980+86 - 1009+38	CHICAGO RD TO HUGHES RD	2852																
1009+38 - 1104+94	HUGHES RD TO MILLBROOK RD	9556																
1104+94 - 1138+21	MILLBROOK RD TO HOLLENBACK RD	3327						604			24	93.6			604		24 93.6	
1138+21 - 1205+28	HOLLENBACK RD TO SLEEPY HOLLOW RD	6707																
1205+28 - 1268+77	SLEEPY HOLLOW RD TO HIGH POINT RD	6349																
1268+77 - 1289+72	OMISSION (NEW PAVEMENT)	2095																
1289+72 - 1347+82	HIGH POINT RD TO PAVILLION RD	5810						144			24	31.2			144		24 31.2	
1347+82 - 1409+76	PAVILLION RD TO WALSH DR	6194						205				31.2			205		31.2	
SUBTOTALS			7626	7848	75	360		1187	183	309	106	202.8	15474	435	1187	492	106 202.8	
TOTALS			15474		435			1187	492		106	202.8	15474	435	1187	492	106 202.8	

NOTE: ALL TURN LANES SHOULD INCLUDE 8" WHITE SKIP DASHES AS PER THE PAVEMENT MARKING TYPICAL SECTIONS

NOTE: EDGE LINE SKIPS TO BE INSTALLED AT MAIN ST INTERSECTION

*NOTE: NEW EDGE LINE ON THE SOUTH SIDE OF IL 71 BETWEEN UNION ST AND EAST ST IN NEWARK

NOTE: NEW STOP BARS AT MAIN ST, WALKER RD, MILLBROOK RD, TIMBER CREEK RD, & PAVILLION RD

RAISED REFLECTIVE PAVEMENT MARKER SCHEDULE

LOCATION	2 WAY AMBER	1 WAY CRYSTAL	1 WAY AMBER	REMOVAL
	EACH	EACH	EACH	EACH
KENDALL COUNTY		TURN LNS		
869+15 - 1268+77	495	20	40	555
OMISSION: 1268+77 - 1289+72	OMISSION			
1289+72 - 1409+76	75	4		79
SUBTOTAL	570	24	40	634
TOTAL	634			634

PAINT PAVEMENT MARKING SCHEDULE - IL 71 KENDALL COUNTY

STA TO STA	LOCATION	LENGTH	PAINT		
			4"	4"	6"
			WHITE	YELLOW	YELLOW
			FOOT	FOOT	FOOT
869+15 - 909+88	LASALLE CO TO OTTAWA RD	4073	16132		2040
909+88 - 917+03	OTTAWA RD TO JOHNSON ST	715			
917+03 - 950+24	JOHNSON ST TO MAIN ST	3321			
950+24 - 980+86	MAIN ST TO CHICAGO RD	3062	11980	12248	
980+86 - 1009+38	CHICAGO RD TO HUGHES RD	2852	11276	14376	1320
1009+38 - 1104+94	HUGHES RD TO MILLBROOK RD	9556	38128	6262	4780
1104+94 - 1138+21	MILLBROOK RD TO HOLLENBACK RD	3327	13238		1680
1138+21 - 1205+28	HOLLENBACK RD TO SLEEPY HOLLOW RD	6707	26684	6898	2980
1205+28 - 1268+77	SLEEPY HOLLOW RD TO HIGH POINT RD	6349	25396	3780	3180
1268+77 - 1289+72	OMISSION (NEW PAVEMENT)	2095			
1289+72 - 1347+82	HIGH POINT RD TO PAVILLION RD	5810	22998	11240	1640
1347+82 - 1409+76	PAVILLION RD TO WALSH DR	6194	24286	2580	3100
SUBTOTALS			190118	57384	20720
TOTALS			247502 20720		

NOTE: 2 APPLICATIONS OF PAINT HAVE BEEN CALCULATED FOR THIS

SHORT-TERM PAVEMENT MARKING SCHEDULE

LOCATION	SHORT TERM PVMT MARK	SHORT TERM PVMT MARK REMOVAL
	FOOT	SQ FT
KENDALL COUNTY		
869+15 - 1268+77	12000	4000
OMISSION: 1268+77 - 1289+72	OMISSION	
1289+72 - 1409+76	3612	1204
TOTAL	15612	5204

MODEL: Default
 FILE NAME: p:\bldg-cw-bentley.com\PROJECTS\DOT OFFICES\District 3\Projects\036671\CAD\Drawings\CAD\Sheet\036671-Plan.dgn

USER NAME = carminaw	DESIGNED - AC	REVISED - _____
	DRAWN - AC	REVISED - _____
PLOT SCALE = 100,0000' / in.	CHECKED - MY	REVISED - _____
PLOT DATE = 2/9/2022	DATE - 1/14/2022	REVISED - _____

**STATE OF ILLINOIS
DEPARTMENT OF TRANSPORTATION**

SCALE: _____		SHEET 1 OF 1 SHEETS	STA. _____ TO STA. _____
--------------	--	---------------------	--------------------------

F.A.I. RTE.	SECTION	COUNTY	TOTAL SHEETS	SHEET NO.
311	(2,3)RS-365W	KENDALL	21	12
CONTRACT NO. 66J71			ILLINOIS FED. AID PROJECT	

GUARDRAIL SCHEDULE - IL 71 KENDALL COUNTY

LOCATION	QUAD	EXISTING LENGTH GR	LENGTH OF NEED	SPBGR TYP A 6' POST	TRAF BAR TERM TYP 1 (SPL) TAN	GUARDRAIL REFLECTORS TYPE A	TERM MARK DA	GUARDRAIL REMOVAL	LINEAR DELINEATOR PANELS 4"
		FOOT	FOOT	FOOT	EACH	EACH	EACH	FOOT	EACH
STA 873+78	EB	275/287.5	NO WORK			7			6
	WB	312.5/250	NO WORK			7			6
STA 907+96	EB	125	NO WORK			2			1
	WB	125	NO WORK			2			1
STA 957+99	EB	137.5	112.5	112.5	2	2	2	137.5	1
	WB	137.5	112.5	112.5	2	2	2	137.5	1
STA 979+26	EB	137.5	NO WORK			2			1
	WB	125	NO WORK			2			1
STA 997+81	EB	125	NO WORK			2			1
	WB	137.5	NO WORK			2			1
STA 1040+71	EB	612.5	NO WORK			8			7
	WB	600	NO WORK			8			7
STA 1054+71	WB	250	NO WORK			3			2
STA 1061+56	EB	300	NO WORK			4			3
	WB	225	NO WORK			3			2
STA 1097+99	EB	87.5	75	75	2	2	2	87.5	1
	WB	125	100	100	2	2	2	125	1
STA 1118+73	EB	262.5	NO WORK			3			2
	WB	262.5	NO WORK			3			2
STA 1224+00	EB	125	NO WORK			2			1
	WB	125	NO WORK			2			1
STA 1286+23	EB	100	75	75	2	2	2	100	1
	WB	87.5	75	75	2	2	2	87.5	1
STA 1323+98	EB	212.5	NO WORK			3			2
	WB	125	NO WORK			2			1
STA 1329+04	EB	100	87.5	87.5	2	2	2	100	1
	WB	125	100	100	2	2	2	125	1
STA 1355+82	EB	125	NO WORK			2			1
	WB	125	NO WORK			2			1
TOTALS				737.5	16.0	87.0	16.0	900.0	58.0

MODEL: Default
 FILE: \\blmfc-pw-bentley.com\FW\DOT\Documents\DOT Office\Dir\dir: 3\Project\036671\CAD\Drawings\CAD\Sheets\036671-Plans.dgn

USER NAME = yousifm	DESIGNED - AC	REVISED - _____
	DRAWN - AC	REVISED - _____
PLOT SCALE = 100,0000' / in.	CHECKED - MY	REVISED - _____
PLOT DATE = 2/7/2022	DATE - 1/14/2022	REVISED - _____

**STATE OF ILLINOIS
DEPARTMENT OF TRANSPORTATION**

SCHEDULES	
SCALE: _____	SHEET 1 OF 1 SHEETS STA. _____ TO STA. _____

F.A.I. RTE.	SECTION	COUNTY	TOTAL SHEETS	SHEET NO.
311	(2,3)RS-3&5W	KENDALL	21	13
			CONTRACT NO. 66J71	
ILLINOIS FED. AID PROJECT				

SIDEWALK SCHEDULE FOR NEW RAMP INSTALLATION							
LOCATION	QUAD	SIDEWALK REMOVAL	PCC SIDEWALK 4"	CCC&G REMOVAL	CC&G	EARTH EX *	DETECTABLE WARNINGS
		SQ FT	SQ FT	FOOT	FOOT	CU YD	SQ FT
EAST ST	NW	58.9	115.6	11.3	11.3	2.1	8
EAST ST	SW	59	104	21.4	21.4	1.9	8
TOTAL		118	220	33	33	4	16

*NOTE: THESE ITEMS SHALL BE INCLUDED IN THE COST OF THE SIDEWALK PAY ITEMS, AS OUTLINED IN THE SPECIAL PROVISIONS UNDER "RESTORATION OF WORK AREAS"

MONUMENT NUMBER	DESCRIPTION	EXISTING MONUMENT TYPE	PROPOSED MONUMENT TYPE	MONUMENT RECORD TO BE RECORDED	RESPONSIBILITY
N/A	NO PERMANENT SURVEY MARKERS OR OTHER MARKERS WERE FOUND WHICH NEED TO BE RESET ON THIS JOB.	N/A	N/A	N/A	N/A

ONLY THE ORIGINAL SCOPE OF THIS JOB HAS BEEN SEARCHED FOR MONUMENTS. R.E. MUST INFORM PLATS AND PLANS TO SEARCH FOR ADDITIONAL MONUMENTS PRIOR TO MILLING IF ADDENDUMS HAVE BEEN ADDED TO THIS JOB.

NO KNOWN LAND SURVEY OR CENTERLINE CONTROL MONUMENTS ARE ON THE ROAD SURFACE THAT WILL BE DISTURBED BY THE RESURFACING.

UNKNOWN MONUMENTS MAY EXIST. IF AN UNLISTED MONUMENT IS FOUND, R.E. IS REQUIRED TO PROTECT THE MONUMENT FROM DAMAGE UNTIL A PLATS AND PLANS LAND SURVEYOR CAN DOCUMENT THE MONUMENT. PLATS AND PLANS WILL RESET SUCH MONUMENTS IN KIND FOLLOWING CONSTRUCTION.

NO MONUMENT RECORDS ARE REQUIRED FOR THIS JOB.

MODEL: Default
 FILE: \\mfc-pw-bentley.com\PW\DOT\Documents\DOT Office\Dir\dr: 3\Project\036671\CAD\Drawn\CAD\Sheets\036671-14.ras.dgn

USER NAME = youslfm	DESIGNED - AC	REVISED - _____
	DRAWN - AC	REVISED - _____
PLOT SCALE = 100,0000' / in.	CHECKED - MY	REVISED - _____
PLOT DATE = 2/7/2022	DATE - 1/14/2022	REVISED - _____

**STATE OF ILLINOIS
DEPARTMENT OF TRANSPORTATION**

SCHEDULES

SCALE: _____ SHEET 1 OF 1 SHEETS STA. _____ TO STA. _____

F.A.I. RTE.	SECTION	COUNTY	TOTAL SHEETS	SHEET NO.
311	(2,3)RS-3&5W	KENDALL	21	14
			CONTRACT NO. 66J71	
			ILLINOIS FED. AID PROJECT	

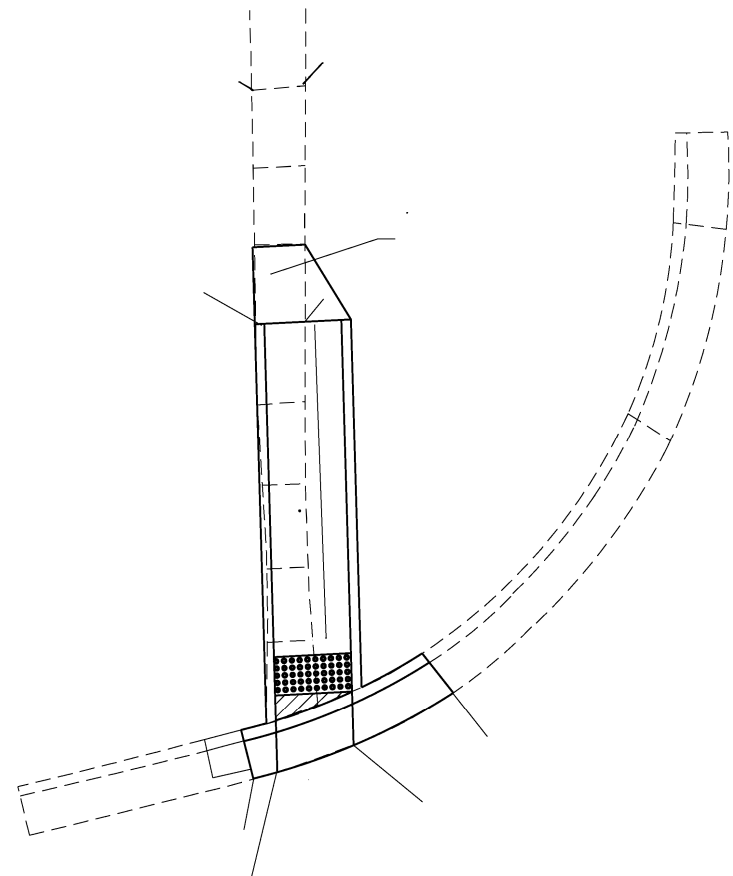

SIDEWALK 4" = 115.6 SQ FT

CCC & G = 11.3 FT

DETECTABLE WARNING =
8.0 SQ FT

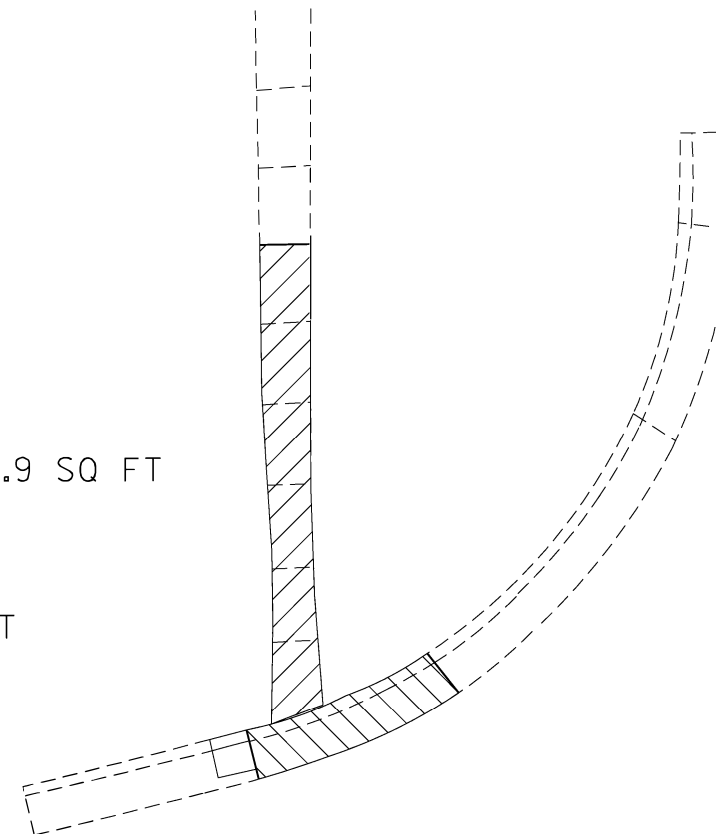

SIDEWALK REM = 58.9 SQ FT

CURB REM = 11.3 FT

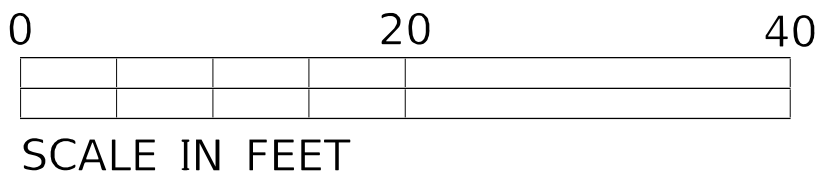

NOTES:

1. SEE HIGHWAY STANDARDS 424001 - 424031 FOR MAX SLOPES AND ADDITIONAL REQUIREMENTS.
2. SEE HIGHWAY STANDARD 606001 FOR CURB AND GUTTER REQUIREMENTS NEXT TO ADA RAMPS.
3. ALL CROSS-SLOPES IN THE DIRECTION OF TRAVEL ARE AN ABSOLUTE MAXIMUM OF 2% LAYOUT SHOULD BE AT 1.5% TO ALLOW FOR ERROR WHILE REMAINING WITH THE MAXIMUM SLOPE.
4. SIDEWALK CURBS ARE SHOW ONLY AS REQUIRED BY FIELD CONDITIONS AND MAY BE OMITTED IF FOUND TO BE UNNECESSARY.
5. PEDESTRIAN PUSH BUTTON SIGN PAY ITEM TO BE INCIDENTAL TO THE PDESTRIAN PUSH BUTTON PAY ITEM.

MODEL: Default
 FILE: M:\MSA_Plan\1000-cw_bentley.com\PROJECTS\DOT_Offices\District_3\Projects\36671\CAD\Drawings\CAD\Sheets\36671-Plans.dgn

USER NAME = yousifm	DESIGNED - _____	REVISED - _____
PLOT SCALE = 100.0000' / in.	DRAWN - _____	REVISED - _____
PLOT DATE = 2/7/2022	CHECKED - _____	REVISED - _____
	DATE - _____	REVISED - _____

**STATE OF ILLINOIS
DEPARTMENT OF TRANSPORTATION**

**ADA DETAILS
EAST STREET NW**

SCALE: _____ SHEET ____ OF ____ SHEETS STA. _____ TO STA. _____

F.A.P. RTE.	SECTION	COUNTY	TOTAL SHEETS	SHEET NO.
311	(2,3)RS-3&5W	KENDALL	21	15
			CONTRACT NO. 66J71	
ILLINOIS FED. AID PROJECT				

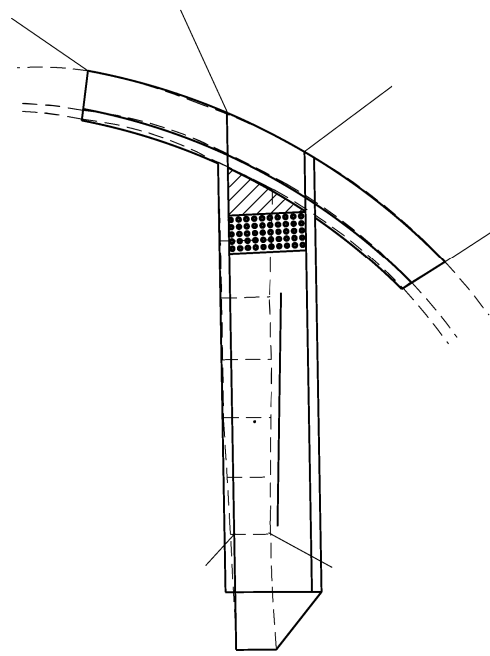

SIDEWALK REM = 59.0 SQ FT

CURB REM = 21.4 FT

SIDEWALK 4" = 104.0 SQ FT

CCC & G = 21.4 FT

DETECTABLE WARNING =
8.0 SQ FT

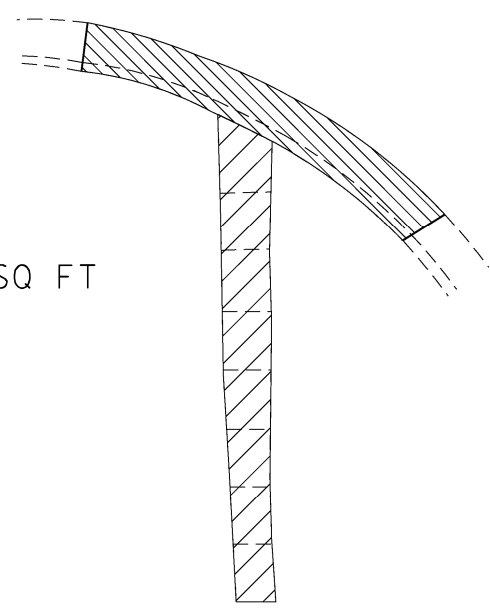

-
-
-
-
-
-

0 20 40

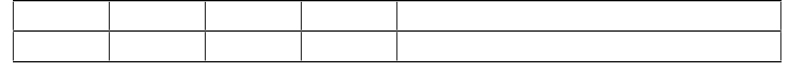

SCALE IN FEET

NOTES:

1. SEE HIGHWAY STANDARDS 424001 - 424031 FOR MAX SLOPES AND ADDITIONAL REQUIREMENTS.
2. SEE HIGHWAY STANDARD 606001 FOR CURB AND GUTTER REQUIREMENTS NEXT TO ADA RAMPS.
3. ALL CROSS-SLOPES IN THE DIRECTION OF TRAVEL ARE AN ABSOLUTE MAXIMUM OF 2% LAYOUT SHOULD BE AT 1.5% TO ALLOW FOR ERROR WHILE REMAINING WITH THE MAXIMUM SLOPE.
4. SIDEWALK CURBS ARE SHOW ONLY AS REQUIRED BY FIELD CONDITIONS AND MAY BE OMITTED IF FOUND TO BE UNNECESSARY.
5. PEDESTRIAN PUSH BUTTON SIGN PAY ITEM TO BE INCIDENTAL TO THE PDESTRIAN PUSH BUTTON PAY ITEM.

MODEL: Default
FILE: Main15: p:\ulidect-sw_bentley.com\p\id\DOT\Documents\DOT_Offices\District_3\Project\3D36671\CADD\Draw\CAD\Sheets\3D36671-Plans.dgn

USER NAME = yousifm	DESIGNED - _____	REVISED - _____
DRAWN - _____	DRAWN - _____	REVISED - _____
PLOT SCALE = 100.0000' / in.	CHECKED - _____	REVISED - _____
PLOT DATE = 2/7/2022	DATE - _____	REVISED - _____

**STATE OF ILLINOIS
DEPARTMENT OF TRANSPORTATION**

**ADA DETAILS
EAST STREET SW**

SCALE: _____ SHEET ____ OF ____ SHEETS STA. _____ TO STA. _____

F.A.P. RTE.	SECTION	COUNTY	TOTAL SHEETS	SHEET NO.
311	(2,3)RS-3&5W	KENDALL	21	16
			CONTRACT NO. 66J71	
ILLINOIS FED. AID PROJECT				

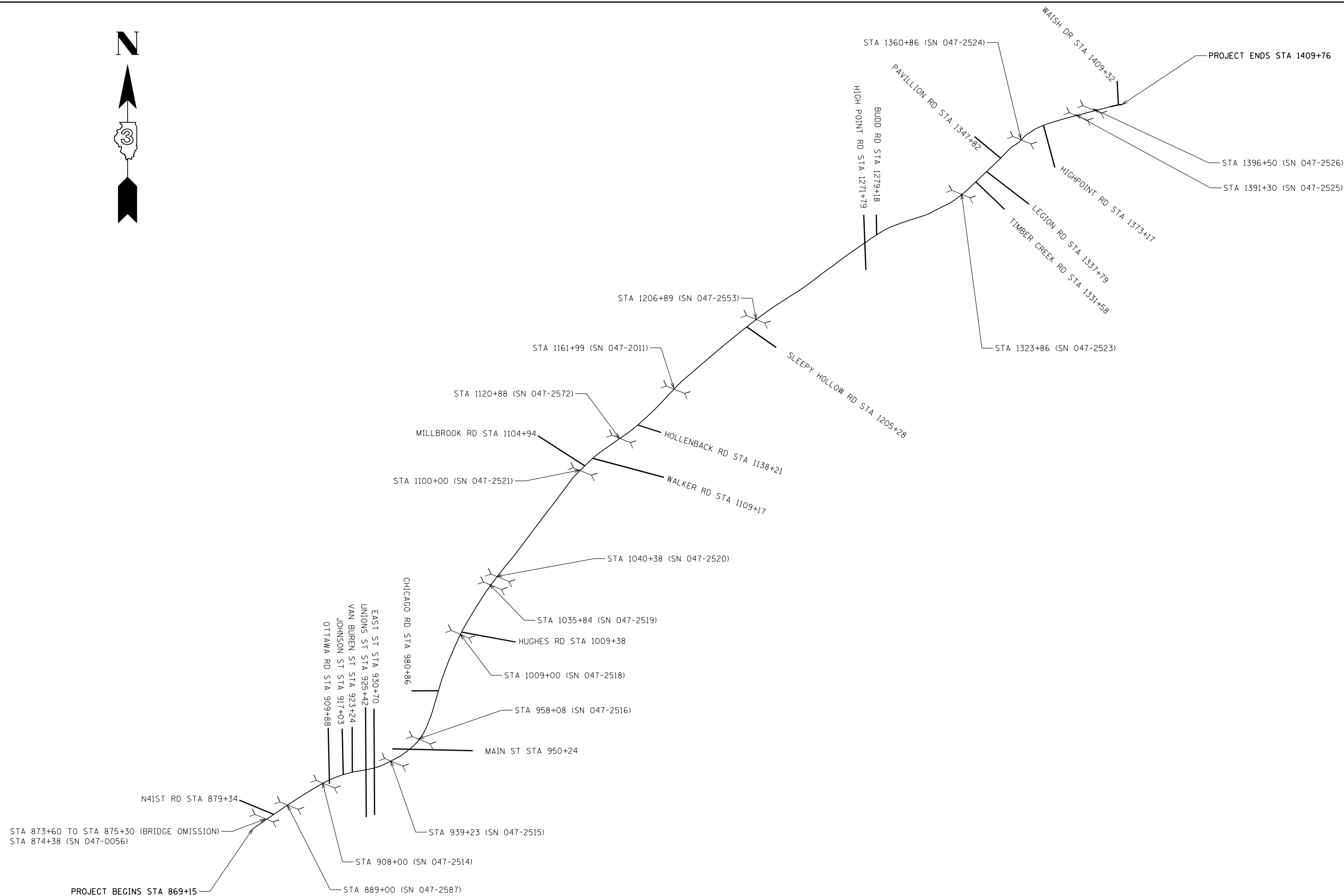

FILE NAME =	USER NAME = youslfm	DESIGNED -	REVISED -
pw:\illdot\pw.bentley.com\PWIDOT\Documents\IDOT Office\District 3\Projects\I366J71\CADData\CADsheets\I366J71-1.dwg		DRAWN -	REVISED -
Default	PLOT SCALE = 100,0000' / in.	CHECKED -	REVISED -
	PLOT DATE = 2/7/2022	DATE -	REVISED -

**STATE OF ILLINOIS
DEPARTMENT OF TRANSPORTATION**

LOCATION MAP

SCALE: _____ SHEET _ OF _ SHEETS STA. _____ TO STA. _____

F.A.P. RTE.	SECTION	COUNTY	TOTAL SHEETS	SHEET NO.
311	(2,3)RS-3,SW	KENDALL	21	17
CONTRACT NO. 66J71				
ILLINOIS FED. AID PROJECT				

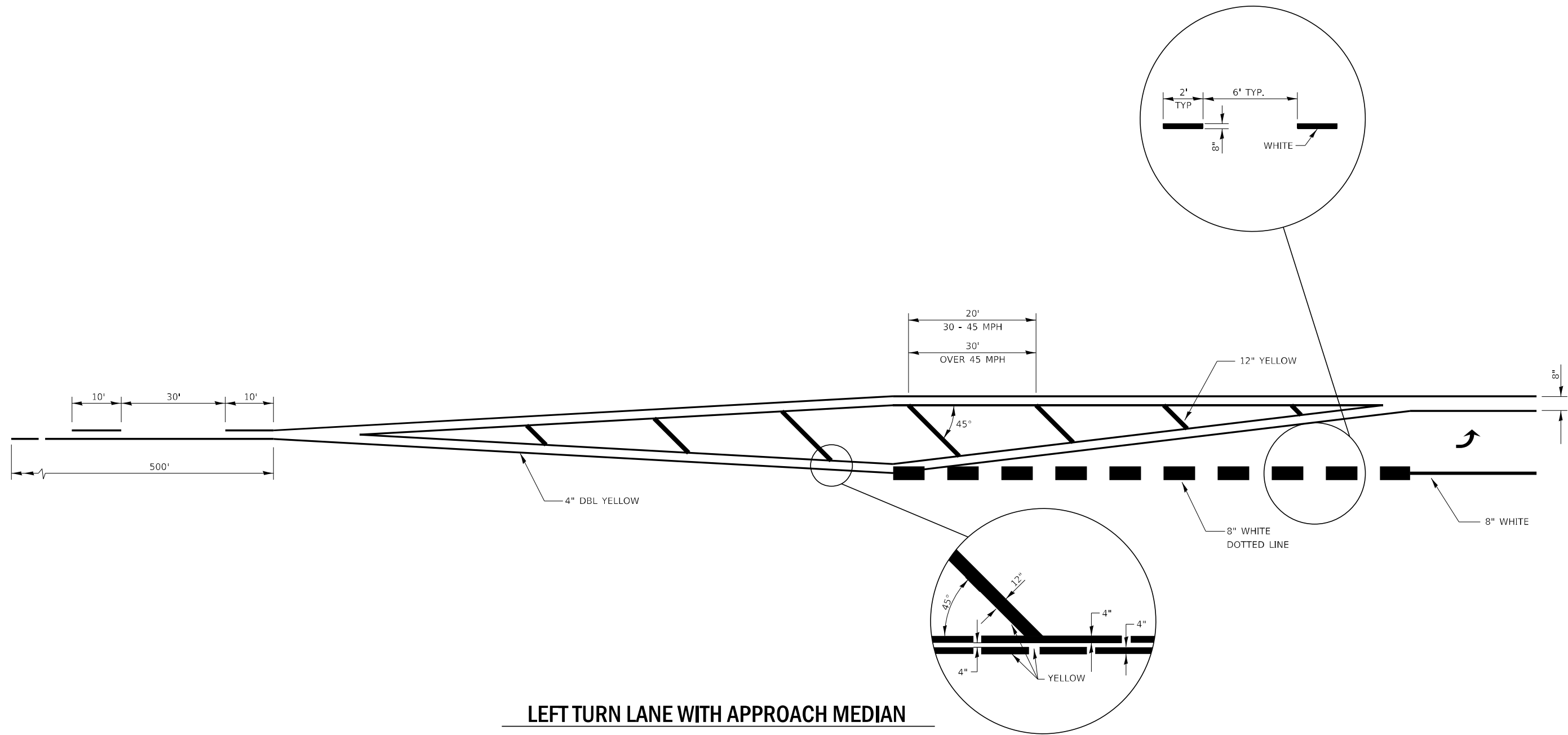

LEFT TURN LANE WITH APPROACH MEDIAN

FILE NAME =	USER NAME = youslfm	DESIGNED - _____	REVISED - _____
pw:\ildot-pw\berkeley.com\PWIDOT\Documents\IDOT Office\District 3\Projects\I366J71\CADData\CADsheets\I366J71-311-1-DRAWN		DRAWN - _____	REVISED - _____
Default	PLOT SCALE = 100,0000' / in.	CHECKED - _____	REVISED - _____
	PLOT DATE = 2/7/2022	DATE - _____	REVISED - _____

**STATE OF ILLINOIS
DEPARTMENT OF TRANSPORTATION**

DETAILS	
SCALE: _____	SHEET _____ OF _____ SHEETS
STA. _____	TO STA. _____

F.A.P. RTE.	SECTION	COUNTY	TOTAL SHEETS	SHEET NO.
311	(2,3)RS-3,SW	KENDALL	21	18
CONTRACT NO. 66J71				
ILLINOIS FED. AID PROJECT				

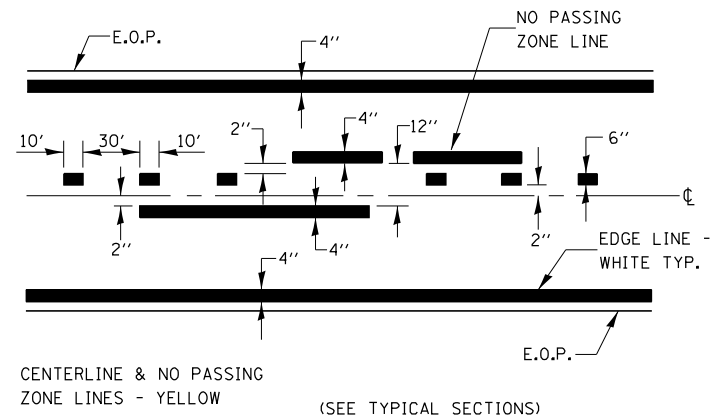

PAVEMENT MARKING

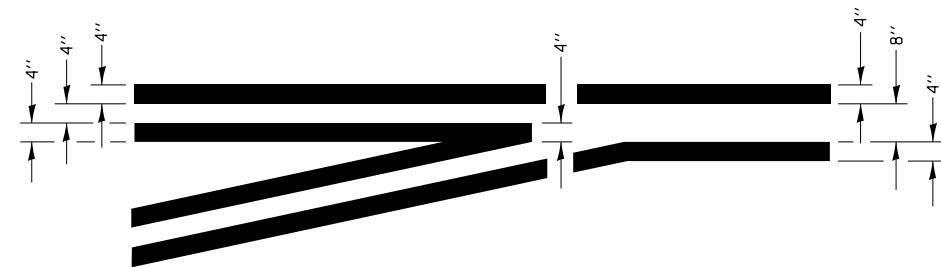

**TYPICAL APPLICATION
LEFT TURN LANES**

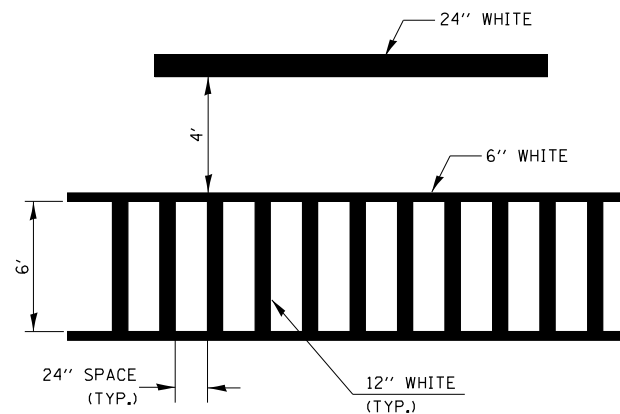

**TYPICAL SPACING DETAIL FOR
CROSSWALKS AND STOP BARS**

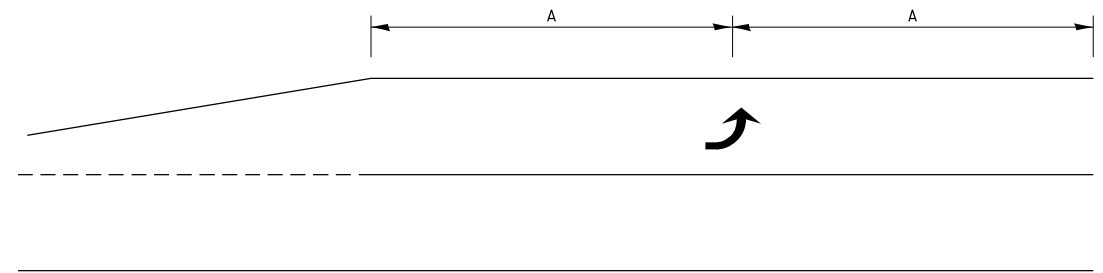

99' AND UNDER

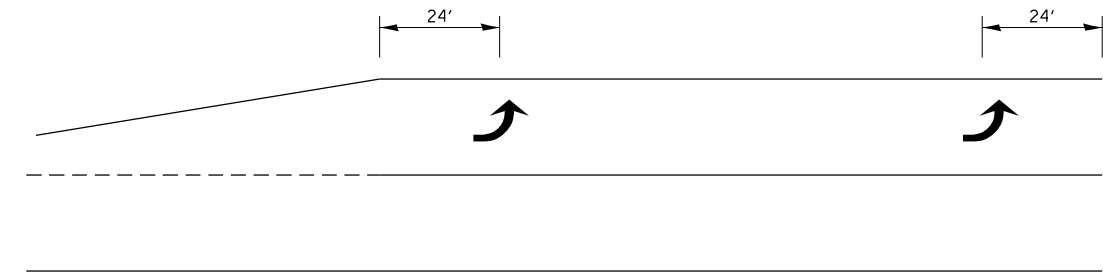

100' TO 149'



150' AND LONGER

**TYPICAL PLACEMENT OF ARROWS
IN TURN LANES**

FILE NAME =	USER NAME = youslfm	DESIGNED -	REVISED -
pw:\illdot-pw\benley.com\PWIDOT\Documents\IDOT Office\District 3\Projects\D366J71\CADData\CADsheets\D366J71-1.dwg		DRAWN -	REVISED -
Default	PLOT SCALE = 100,0000' / in.	CHECKED -	REVISED -
	PLOT DATE = 2/7/2022	DATE -	REVISED -

**STATE OF ILLINOIS
DEPARTMENT OF TRANSPORTATION**

DETAILS			
SCALE: _____	SHEET _____	OF _____	SHEETS
STA. _____	TO STA. _____		

F.A.P. RTE.	SECTION	COUNTY	TOTAL SHEETS	SHEET NO.
311	(2,3)RS-3,SW	KENDALL	21	19
CONTRACT NO. 66J71			ILLINOIS FED. AID PROJECT	

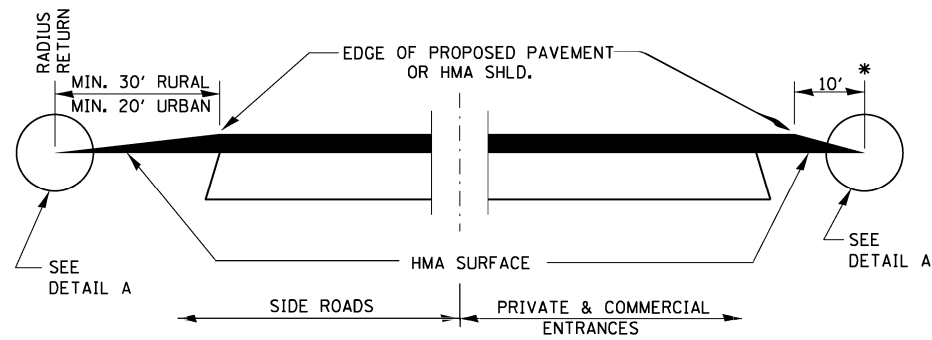

SECTION A-A
DETAILS AT ENTRANCES & SIDE ROADS

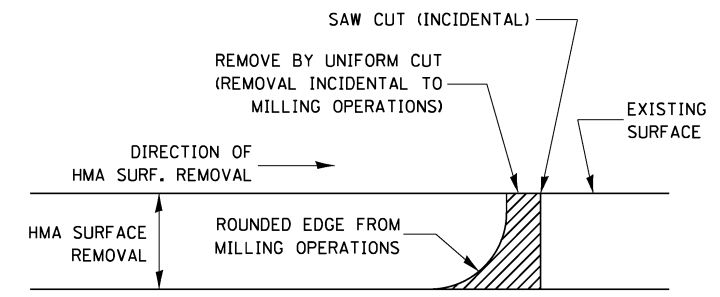

NOTE:
WHEN MILLING OPERATIONS PRODUCE A ROUNDED EDGE, THEN A SAW CUT SHALL BE USED TO MANUFACTURE A PERPENDICULAR EDGE AS SHOWN IN THE DETAIL. THE ENGINEER SHALL BE THE SOLE JUDGE CONCERNING THE USE OF THIS DETAIL.

HMA DETAIL AT BUTT JOINTS

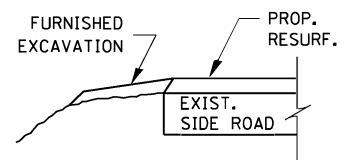

SECTION B-B

THE COST OF REMOVAL AT EXISTING HMA OR P.C.C. LOCATIONS SHALL BE PAID FOR PER SQ. YD. BY THE APPROPRIATE PAY ITEM. REMOVAL AT THE EXISTING AGG. LOCATIONS SHALL BE INCIDENTAL TO THE HMA. A-3 LOCATIONS SHALL BE FEATHER TAPERED.

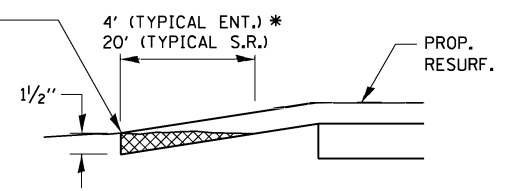

DETAIL A

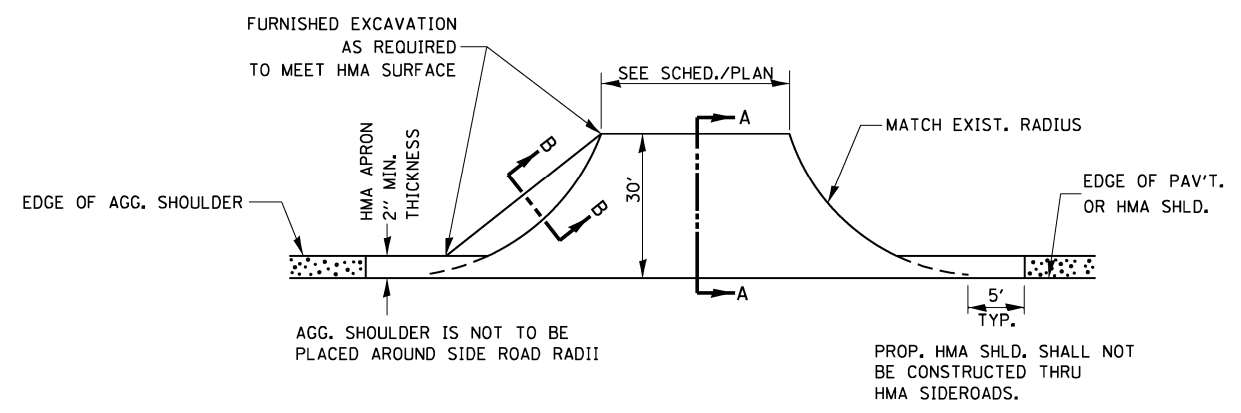

PLAN AT SIDE ROADS

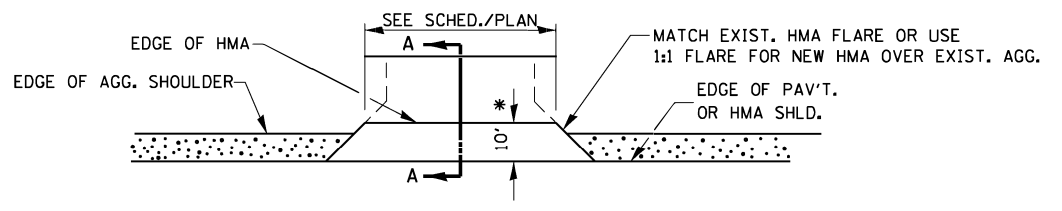

PLAN AT PRIVATE & COMMERCIAL ENTRANCES
(DO NOT RESURFACE FIELD ENTRANCES)

* PROPOSED HMA RESURFACING AT PUBLIC EDUCATIONAL FACILITY ENTRANCES SHALL BE EXTENDED TO THE RIGHT-OF-WAY LIMITS.

FILE NAME =	USER NAME = youslfm	DESIGNED -	REVISED -
pw:\idot-pw.bentley.com\PWIDOT\Documents\IDOT Office\District 3\Projects\D366J71\CADData\CAD\Sheets\D366J71-1.dwg		DRAWN -	REVISED -
Default	PLOT SCALE = 100.0000' / in.	CHECKED -	REVISED -
	PLOT DATE = 2/7/2022	DATE -	REVISED -

STATE OF ILLINOIS
DEPARTMENT OF TRANSPORTATION

DETAILS	
SCALE: _____	SHEET ____ OF ____ SHEETS STA. _____ TO STA. _____

F.A.P. RTE.	SECTION	COUNTY	TOTAL SHEETS	SHEET NO.
311	(2,3)RS-3,SW	KENDALL	21	20
CONTRACT NO. 66J71				
ILLINOIS FED. AID PROJECT				

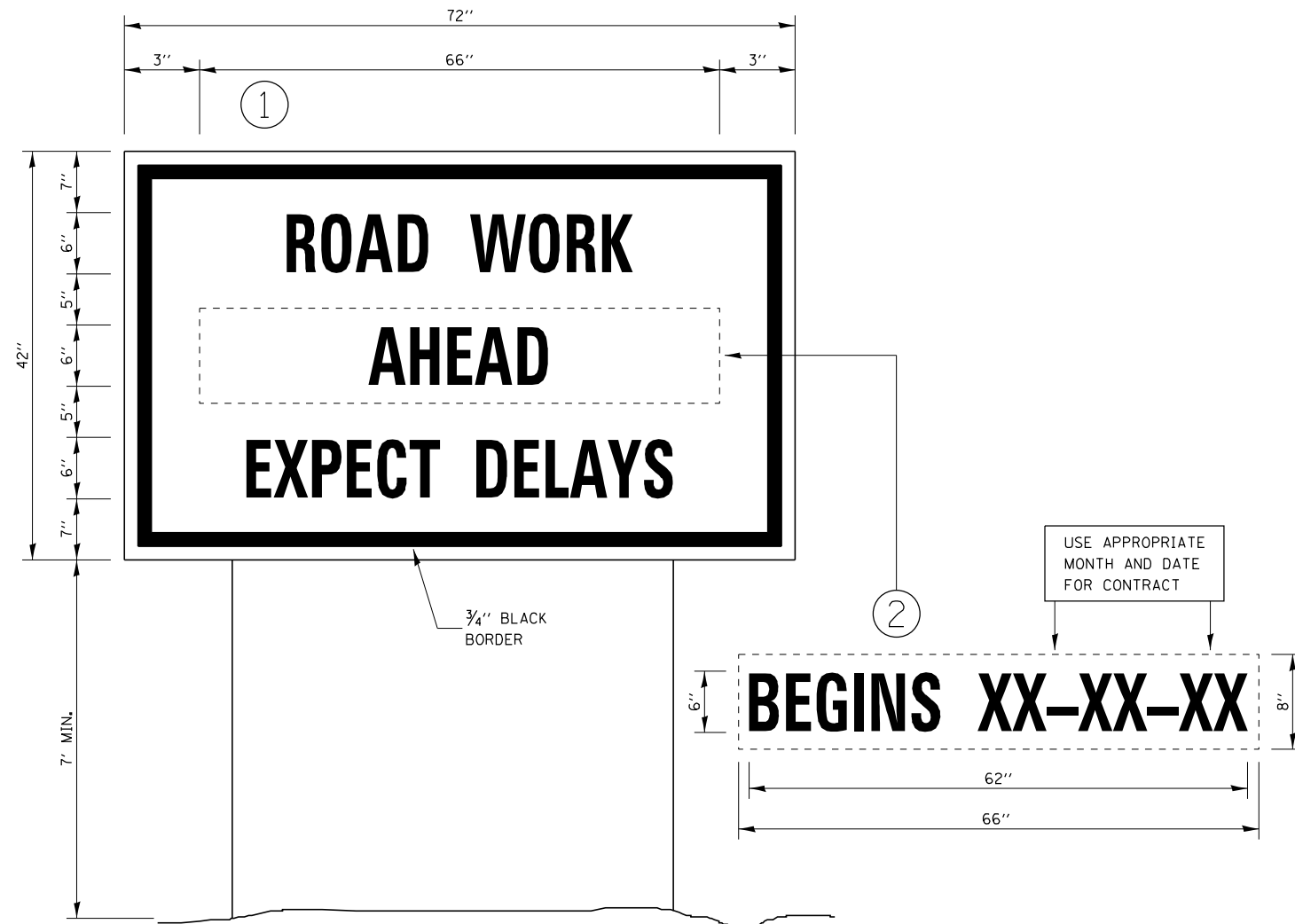

TEMPORARY INFORMATION SIGNING

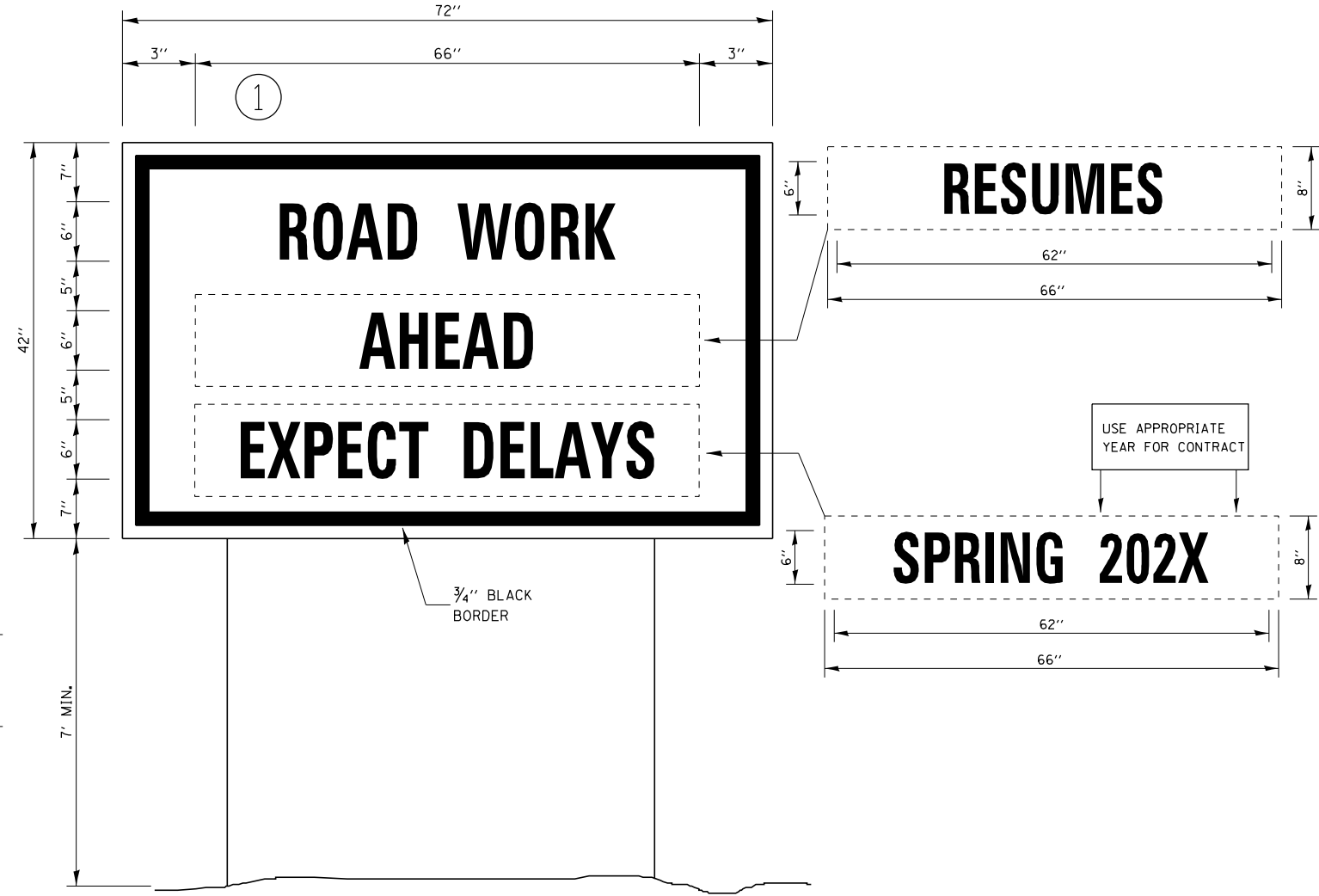

WINTER SHUT DOWN SIGNING

NOTES:

1. USE 6" D BLACK LETTERING ON FLOURESENT ORANGE BACKGROUND.
2. ERECT SIGNS AT LOCATIONS IN ADVANCE OF THE "ROAD CONSTRUCTION AHEAD" SIGNS AS DIRECTED BY THE ENGINEER.
3. ERECT SIGN ① WITH INSTALLED PANEL ② A MINIMUM OF ONE WEEK PRIOR TO THE START OF THE LANE CLOSURE.
4. REMOVE PANEL ② ON THAT DATE.
5. SEE SPECIAL PROVISION "TEMPORARY INFORMATION SIGNING" FOR ADDITIONAL INFORMATION.
6. WILL BE PAID FOR PER SQ FT AS "TEMPORARY INFORMATION SIGNING". EACH SIGN = 21 SQ FT AND THE DATE PANEL ② WILL NOT BE MEASURED SEPARATELY FOR PAYMENT.

FILE NAME =	USER NAME = youslfm	DESIGNED -	REVISED -	STATE OF ILLINOIS DEPARTMENT OF TRANSPORTATION	DETAILS		F.A.P. RTE.	SECTION	COUNTY	TOTAL SHEETS	SHEET NO.
pw:\idot\pw\benley.com\PWIDOT\Documents\IDOT Office\District 3\Projects\D366J71\CADData\CADsheets\D366J71-1-1-2022.dwg		DRAWN -	REVISED -		311	(2,3)RS-3,SW	KENDALL	21	21	CONTRACT NO. 66J71	
Default	PLOT SCALE = 100,0000 / in.	CHECKED -	REVISED -		SCALE: _____	SHEET _ OF _ SHEETS	STA. _____	TO STA. _____	ILLINOIS FED. AID PROJECT		
	PLOT DATE = 2/7/2022	DATE -	REVISED -								