

| COUNTY | ROUTE | SECTION | SHT. NO. |
|--------|----------|----------------|----------|
| ADAMS | FAS 1598 | 16-00017-05-FP | 1 |

COVER SHEET
TOTAL NO. SHEETS - 17

INDEX OF SHEETS 06-17-2022 LETTING ITEM 125

| SHEET NO. | SHEET |
|-----------|--|
| 1 | TITLE SHEET |
| 2 | SUMMARY OF QUANTITIES SCHEDULE OF QUANTITIES |
| 3 | TYPICAL SECTIONS |
| 4 | GENERAL NOTES TRAFFIC CONTROL AND PROTECTION HMA MIXTURE REQUIREMENTS APPLICATION RATES |
| 5-6 | PLAN SHEET - RESURFACING |
| 7-8 | HMA SURFACE REMOVAL |
| 9-10 | PAVEMENT MARKINGS |
| 11 | HMA ENTRANCE RESURFACING |
| 12 | HMA MAILBOX TURNOUTS |
| 13-14 | BUTT JOINT - FEATHER EDGE DETAILS |
| 15-17 | CROSS SECTIONS - ROADWAY |

STANDARDS

- STANDARD 442201-03
- STANDARD 701011-04
- STANDARD 701201-05
- STANDARD 701301-04
- STANDARD 701306-04
- STANDARD 701311-03
- STANDARD 701901-08
- STANDARD 780001-05

THE PROPOSED IMPROVEMENT CONSISTS OF HMA SURFACE REMOVAL, HMA BINDER AND HMA SURFACE COURSE, PLACEMENT OF AGGREGATE SHOULDERS, INCIDENTAL SURFACING AND PAVEMENT MARKINGS.

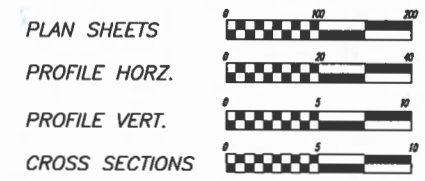

FULL SIZE PLANS HAVE BEEN PREPARED USING STANDARD ENGINEERING SCALES, REDUCED SIZED PLANS WILL NOT CONFORM TO STANDARD SCALES, IN MAKING MEASUREMENTS ON REDUCED PLANS, THE ABOVE SCALES MAY BE USED.

UTILITIES:

- J.U.L.I.E. 1-800-892-0123
- ABS WATER COOP CLAYTON, IL
- ADAMS ELECTRIC COOP CAMP POINT, IL
- ADAMS TELEPHONE COOP GOLDEN, IL

STATE OF ILLINOIS
DEPARTMENT OF TRANSPORTATION
DIVISION OF HIGHWAYS
PLANS FOR PROPOSED
SURFACE TRANSPORTATION / RURAL PROGRAM FUNDS
ADAMS COUNTY SEC. 16-00017-05-FP
FAS ROUTE 1598 (CO HWY 11)
PROJECT NO. VA5R(542)
JOB NO. C-96-053-21

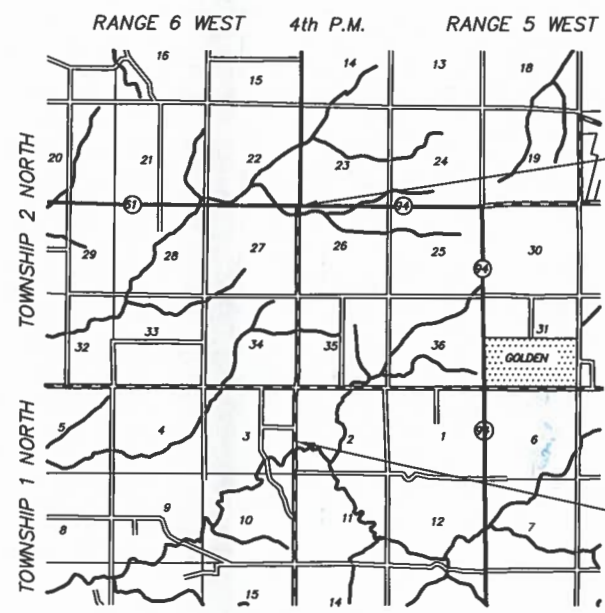
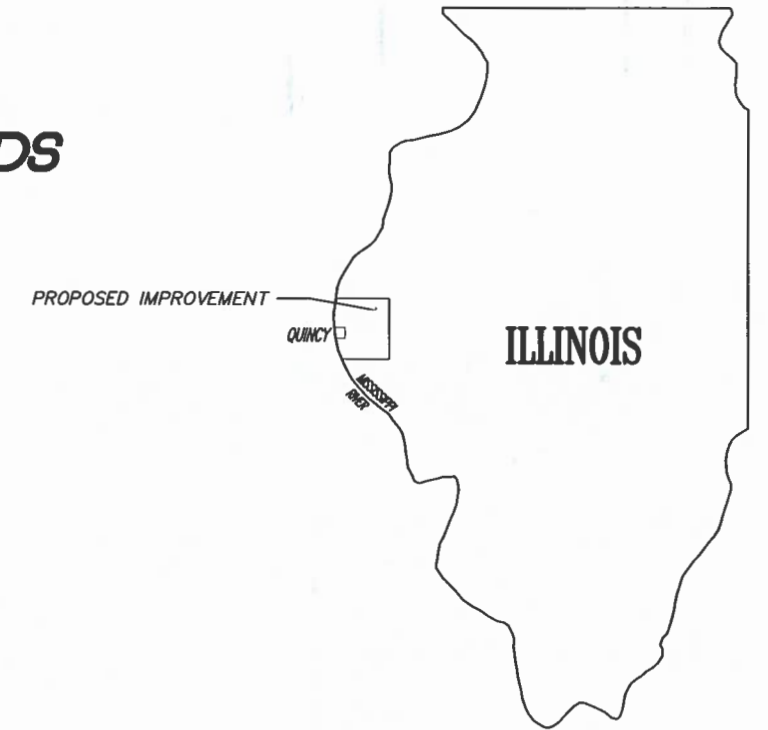

LOCATION MAP



DESIGN DESIGNATION: MAJOR COLLECTOR
ADT: 500 (2021)
DESIGN SPEED - 50 M.P.H.

SUMMARY OF LENGTH:

GROSS LENGTH:
 FAS 1598 - STA. 212+00 TO STA. 350+34 = 13,834 FT.
 FAS 1602 - STA. 164+10 TO STA. 164+80.9 = 70.9 FT.

NET LENGTH TO BE IMPROVED = 13,904.9 FT. = 2.634 MILES

THESE PLANS WERE PREPARED BY ME OR A FULL TIME MEMBER OF MY STAFF WORKING UNDER MY PERSONAL SUPERVISION.

SUBMITTED BY James R. Frankenhoff DATE 3/2/22
 COUNTY ENGINEER
 LICENSE NO. 062-044792
 LIC. EXPIRES 11/30/2023



APPROVED March 2, 2022
James R. Frankenhoff COUNTY ENGINEER

PASSED March 16, 2022
Eric Cole DISTRICT ENGINEER OF LOCAL ROADS AND STREETS

RELEASING FOR BID BASED ON LIMITED REVIEW March 16, 2022
Abby H. Meyer REGION FOUR ENGINEER

STATE OF ILLINOIS
DEPARTMENT OF TRANSPORTATION

PREPARED BY
 ADAMS COUNTY HIGHWAY DEPARTMENT
 101 NORTH 54th STREET, QUINCY, ILLINOIS

PAVEMENT SCHEDULE

| LOCATION / STA. - STA. | BITUMINOUS MATERIALS (TACK COAT) | HOT-MIX ASPHALT BINDER COURSE, IL9.5FG, N50 | POLYMERIZED HOT-MIX ASPHALT SURFACE COURSE, MIX "C", N50 | AGGREGATE SHOULDERS, TYPE B | CLASS D PATCHES, TYPE IV, 6 INCH |
|------------------------|----------------------------------|---|--|-----------------------------|----------------------------------|
| | POUND | TON | TON | TON | SQ YD |
| STA. 212+00 - 350+34 | 20,010 | 2,290 | 2,860 | 1,450 | 68 |
| CH 17 INTERSECTION | 190 | 15 | 30 | 25 | |
| TOTAL | 22,200 | 2,305 | 2,890 | 1,475 | 68 |

HMA SURFACE REMOVAL

| LOCATION / STA. - STA. | HOT-MIX ASPHALT SURFACE REMOVAL - BUTT JOINT | HOT-MIX ASPHALT SURFACE REMOVAL - 1 3/4" | TEMPORARY RAMP |
|---------------------------|--|--|----------------|
| | SQ. YD. | SQ. YD. | SQ. YD. |
| STA. 212+00 - STA. 212+10 | 154 | | 14 |
| STA. 212+10 - STA. 350+34 | 173 | 32,728 | 110 |
| CH 17 INTERSECTION | 23 | 182 | 49 |
| TOTAL | 350 | 32,910 | 173 |

LONGITUDINAL JOINT SEALANT (FOOT)

| STA. - OFFSET | LENGTH |
|---------------------------------|---------------|
| STA. 212+00 - 350+34 CENTERLINE | 13,834 |
| STA. 243+54 - 244+74 EOP RT | 120 |
| TOTAL | 13,954 |

SUMMARY OF QUANTITIES

| CODE NO. | ITEM | UNIT | TOTAL QUANTITY | SPECIAL PROVISION |
|------------|--|-------|----------------|-------------------|
| 35101400 | AGGREGATE BASE COURSE, TYPE B | TON | 15 | |
| 35800100 | PREPARATION OF BASE | SQ YD | 4 | * |
| 40600290 | BITUMINOUS MATERIALS (TACK COAT) | POUND | 22,200 | |
| 40600370 | LONGITUDINAL JOINT SEALANT | FOOT | 13,954 | |
| 40600982 | HOT-MIX ASPHALT SURFACE REMOVAL - BUTT JOINT | SQ YD | 350 | * |
| 40600990 | TEMPORARY RAMP | SQ YD | 173 | |
| 40602965 | HOT-MIX ASPHALT BINDER COURSE, IL9.5 FG, N50 | TON | 2,305 | * |
| 40604150 | POLYMERIZED HOT-MIX ASPHALT SURFACE COURSE, IL-9.5, MIX "C", N50 | TON | 2,890 | * |
| 40800029 | BITUMINOUS MATERIAL (TACK COAT) | POUND | 84 | |
| 40800050 | INCIDENTAL HOT-MIX ASPHALT SURFACING | TON | 17 | * |
| 44000156 | HOT-MIX ASPHALT SURFACE REMOVAL, 1 3/4" | SQ YD | 32,910 | * |
| 44201723 | CLASS D PATCHES, TYPE IV, 6 INCH | SQ YD | 68 | |
| 48101200 | AGGREGATE SHOULDERS, TYPE B | TON | 1,475 | * |
| 67100100 | MOBILIZATION | L SUM | 1 | |
| 70300100 | SHORT TERM PAVEMENT MARKING | FOOT | 1,384 | |
| 70300150 | SHORT TERM PAVEMENT MARKING REMOVAL | SQ FT | 462 | |
| Δ 78001110 | PAINT PAVEMENT MARKING - LINE 4" | FOOT | 13,088 | |
| Δ 78001140 | PAINT PAVEMENT MARKING - LINE 8" | FOOT | 86 | |
| Δ 78001150 | PAINT PAVEMENT MARKING - LINE 12" | FOOT | 51 | |
| Δ 78001180 | PAINT PAVEMENT MARKING - LINE 24" | FOOT | 50 | |
| X7010216 | TRAFFIC CONTROL AND PROTECTION, (SPECIAL) | L SUM | 1 | * |
| # 20076600 | TRAINEES | Hour | 500 | |
| # 20076604 | TRAINEES TRAINING PROGRAM GRADUATE | Hour | 500 | |

Δ SPECIALTY ITEMS # 0042

TYPICAL CROSS SECTIONS

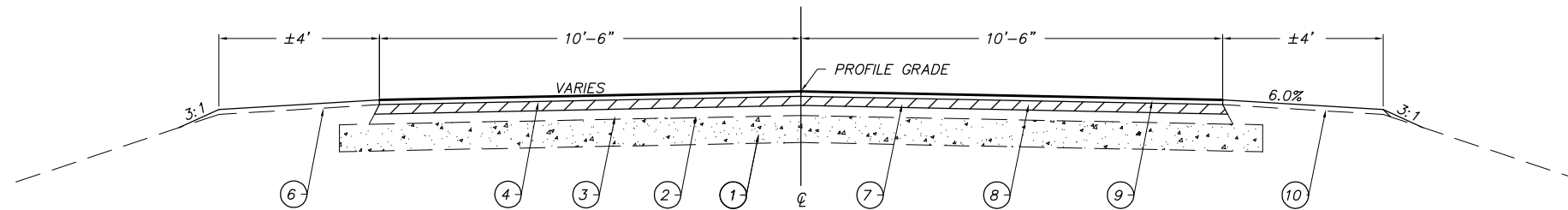

PROPOSED TYPICAL SECTION
STATION 212+00 TO STATION 231+54

EXISTING MATERIALS:

1. ± 10 " AGGREGATE BASE COURSE, TYPE B
2. $1\frac{1}{2}$ " HMA BINDER COURSE
3. 1" HMA SURFACE COURSE, MIX "C", CLASS 1
4. $1\frac{1}{2}$ " POLY HMA SURFACE COURSE, MIX "C", CLASS 1, TYPE 2
6. AGGREGATE SHOULDER WEDGE

PROPOSED MATERIALS:

7. HOT-MIX ASPHALT SURFACE REMOVAL, $1\frac{3}{4}$ "
8. $1\frac{1}{4}$ " HOT-MIX ASPHALT BINDER COURSE, IL-9.5FG, N50
9. $1\frac{1}{2}$ " POLYMERIZED HOT-MIX ASPHALT SURFACE COURSE, IL-9.5, MIX "C", N50
10. AGGREGATE SHOULDERS, TYPE B

EXISTING CONSTRUCTION SECTIONS:

- SEC. 17G
- SEC. 83-00017-03-RS
- SEC. 95-00148-FPL2

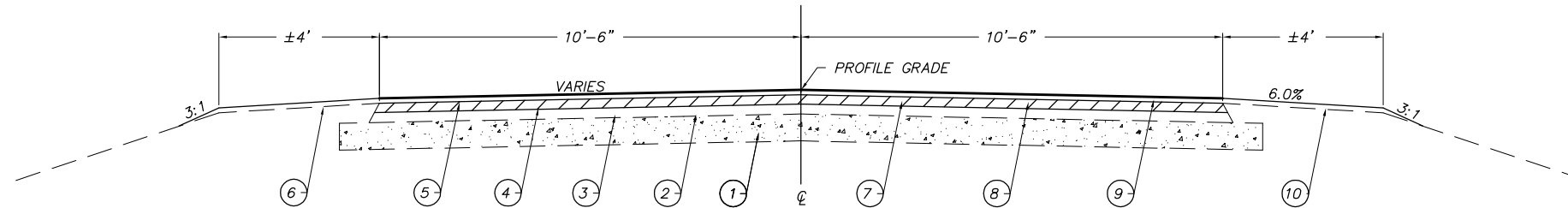

PROPOSED TYPICAL SECTION
STATION 231+54 TO STATION 236+74.9
STATION 251+42.5 TO STATION 350+34

EXISTING MATERIALS:

1. ± 10 " AGGREGATE BASE COURSE, TYPE B
2. $1\frac{1}{2}$ " HMA BINDER COURSE
3. 1" HMA SURFACE COURSE, MIX "C", CLASS 1
4. $1\frac{1}{2}$ " HMA SURFACE COURSE, MIX "C", CLASS 1, TYPE 3
5. $1\frac{3}{4}$ " POLY HMA SURFACE COURSE, SUPERPAVE, MIX "C", N50
6. AGGREGATE SHOULDER WEDGE

PROPOSED MATERIALS:

7. HOT-MIX ASPHALT SURFACE REMOVAL, $1\frac{3}{4}$ "
8. $1\frac{1}{4}$ " HOT-MIX ASPHALT BINDER COURSE, IL-9.5FG, N50
9. $1\frac{1}{2}$ " POLYMERIZED HOT-MIX ASPHALT SURFACE COURSE, IL-9.5, MIX "C", N50
10. AGGREGATE SHOULDERS, TYPE B

EXISTING CONSTRUCTION SECTIONS:

- SEC. 17G
- SEC. 83-00017-03-RS
- SEC. 91-00017-04-RS
- SEC. 04-00000-02-GM

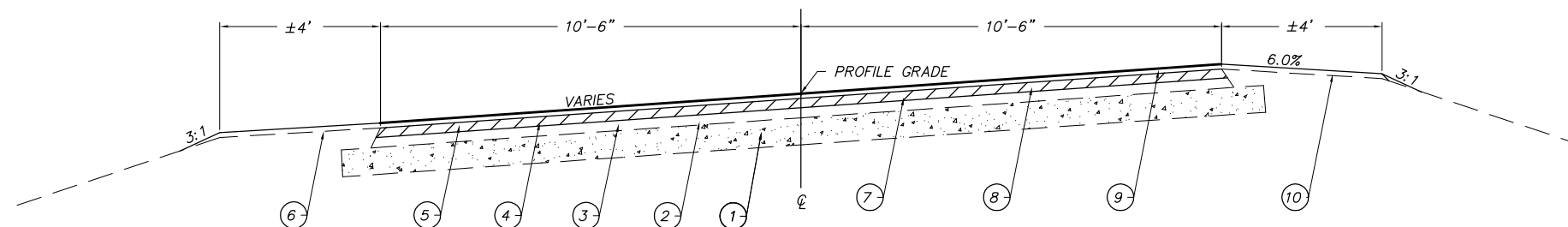

PROPOSED TYPICAL SECTION
STATION 236+74.9 TO STATION 251+42.5

EXISTING MATERIALS:

1. ± 10 " AGGREGATE BASE COURSE, TYPE B
2. $1\frac{1}{2}$ " HMA BINDER COURSE
3. 1" HMA SURFACE COURSE, MIX "C", CLASS 1
4. $1\frac{1}{2}$ " HMA SURFACE COURSE, MIX "C", CLASS 1, TYPE 3
5. $1\frac{3}{4}$ " POLY HMA SURFACE COURSE, SUPERPAVE, MIX "C", N50
6. AGGREGATE SHOULDER WEDGE

PROPOSED MATERIALS:

7. HOT-MIX ASPHALT SURFACE REMOVAL, $1\frac{3}{4}$ "
8. $1\frac{1}{4}$ " HOT-MIX ASPHALT BINDER COURSE, IL-9.5FG, N50
9. $1\frac{1}{2}$ " POLYMERIZED HOT-MIX ASPHALT SURFACE COURSE, IL-9.5, MIX "C", N50
10. AGGREGATE SHOULDERS, TYPE B

NORMAL CROWN DOES NOT APPLY IN AREAS OF SUPER-ELEVATION OR SUPER-ELEVATION TRANSITION AS LISTED WITH THE CURVE DATA INFORMATION CONTAINED IN THESE PLANS.

| | | | | | | | | | |
|------------------|----------------|-----------|--|--|--------------------|---------------------|----------------------------|--------------|-----------|
| USER NAME = | DESIGNED - JRF | REVISED - | ADAMS COUNTY HIGHWAY DEPARTMENT | TYPICAL SECTIONS FAS ROUTE 1598 (CO HWY 11) | COUNTY | ROUTE | SECTION | TOTAL SHEETS | SHEET NO. |
| PLOT SCALE = 1:2 | DRAWN - AJM | REVISED - | | | ADAMS | FAS 1598 | 16-00017-05-FP | 17 | 3 |
| PLOT DATE = | CHECKED - | REVISED - | | | CONTRACT NO. 93788 | | | | |
| | DATE - | REVISED - | | | SCALE | SHEET 1 OF 1 SHEETS | STA. 212+00 TO STA. 350+34 | | |

GENERAL NOTES

- WHERE SECTION OR SUB-SECTION STONES, PROPERTY PINS, USGS BENCH MARK MONUMENTS, AND U.S. ARMY CORPS OF ENGINEERS SURVEY MARKERS ARE ENCOUNTERED, THE ENGINEER SHALL BE NOTIFIED BEFORE SUCH STONES AND MONUMENTS ARE REMOVED. THE CONTRACTOR SHALL PROTECT AND CAREFULLY PRESERVE ALL PROPERTY MARKS UNTIL AN OWNER, AN AUTHORIZED SURVEYOR OR THEIR REPRESENTATIVE HAS WITNESSED OR OTHERWISE REFERENCED THE PROPERTY MARKS LOCATION.
- ALL PRIVATELY OWNED UTILITIES, UNLESS OTHERWISE SPECIFIED, WILL BE MOVED BY THEIR RESPECTIVE OWNERS WHERE REQUIRED. THE FOLLOWING UTILITY COMPANIES MAY HAVE FACILITIES WITHIN THE LIMITS OF CONSTRUCTION:

| | | |
|---------------------|----------------------|-----------|
| ADAMS ELECTRIC COOP | ADAMS TELEPHONE COOP | ABS WATER |
|---------------------|----------------------|-----------|
- THE NOMINAL THICKNESS FOR BINDER COURSE AND THE HOT-MIX ASPHALT MATERIALS IS SHOWN ON THE TYPICAL SECTIONS, STANDARDS, SCHEDULES OR SPECIAL DETAILS. THE CONSTRUCTED THICKNESS OF THE ABOVE ITEMS SHALL NOT BE LESS THAN 90% OF THE NOMINAL THICKNESS AT ANY LOCATION.
- THE UTILITY LOCATIONS, IF MARKED ON THE PLANS, ARE FOR REFERENCE ONLY, AND ARE SHOWN FOR CONTRACTOR INFORMATIONAL USE ONLY, AND ARE NOT TO BE REFERENCED FOR CONSTRUCTION PURPOSES. THE IMPLIED PRESENCE OR ABSENCE OF UTILITIES IS NOT TO BE CONSTRUCTED BY THE OWNER, ENGINEER, CONTRACTOR, OR SUBCONTRACTORS TO BE AN ACCURATE AND COMPLETE REPRESENTATION OF UTILITIES THAT MAY OR MAY NOT EXIST ON THE CONSTRUCTION SITE.
- THE CONTRACTOR SHALL BE RESPONSIBLE FOR DETERMINING THE LOCATION AND ELEVATION OF ALL EXISTING UTILITIES AND TO NOTIFY ALL UTILITY COMPANIES PRIOR TO THE BEGINNING OF CONSTRUCTION. THE REROUTING, DISCONNECTION, PROTECTION, ETC. OF ANY UTILITIES MUST BE COORDINATED BETWEEN THE CONTRACTOR, UTILITY AND OWNER. SITE SAFETY, INCLUDING THE AVOIDANCE OF HAZARDS ASSOCIATED WITH BURIED AND ABOVE GROUND UTILITIES REMAINS THE SOLE RESPONSIBILITY OF THE CONTRACTOR. THIS WILL BE CONSIDERED INCIDENTAL TO THE CONTRACT.
- ALL DISTURBED AREAS WITHIN THE RIGHT-OF-WAY SHALL BE SEEDED BY OTHERS.
- ANY EXISTING ROAD SIGNS THAT INTERFERE WITH CONSTRUCTION WILL BE REMOVED OR RELOCATED AS DIRECTED BY THE ENGINEER. AFTER THE CONSTRUCTION IS COMPLETED, THE CONTRACTOR WILL REPLACE THE SIGNS AS DIRECTED BY THE ENGINEER. THIS WORK WILL NOT BE PAID FOR SEPERATELY BUT SHALL BE INCLUDED IN THE CONTRACT AND NO ADDITIONAL COMPENSATION WILL BE ALLOWED.

APPLICATION RATES

| | |
|----------------------------------|----------------|
| BITUMINOUS MATERIALS (TACK COAT) | |
| ON EXISTING PAVEMENT | 0.05 LB/SQ FT |
| BETWEEN HMA LIFTS | 0.025 LB/SQ FT |
| | |
| AGGREGATE SHOULDERS, TYPE B | 1.8 TON/CU YD |

HOT-MIX ASPHALT MIXTURE REQUIREMENTS

| LOCATION(S): | CO HWY 11 & 17 | CO HWY 11 | CO HWY 11 | SIDE ROADS/ENTRANCES |
|--------------------|----------------------|----------------------|----------------------|----------------------|
| MIXTURE USE(S): | HMA SURF CSE | HMA BINDER CSE | PATCHING | INCIDENTAL HMA SURF |
| AC/PG: | SBS PG64-28 | PG64-22 | PG64-22 | PG64-22 |
| DESIGN AIR VOIDS | 4.0% @ N design = 50 | 4.0% @ N design = 50 | 4.0% @ N design = 50 | 4.0% @ N design = 50 |
| MIXTURE COMPOSTION | IL 9.5 | IL 9.5FG | IL 19.0 | IL 9.5 |
| FRICTION AGGREGATE | MIX "C" | N/A | N/A | N/A |
| QUALITY MANAGEMENT | QC/QA | QC/QA | QC/QA | QC/QA |
| SUBLOT SIZE | 1,000 TONS | 1,000 TONS | N/A | N/A |

NOTE: HOT-MIX ASPHALT QUANTITIES CALCULATED @ 112#/SQ.YD./IN.

TRAFFIC CONTROL AND PROTECTION

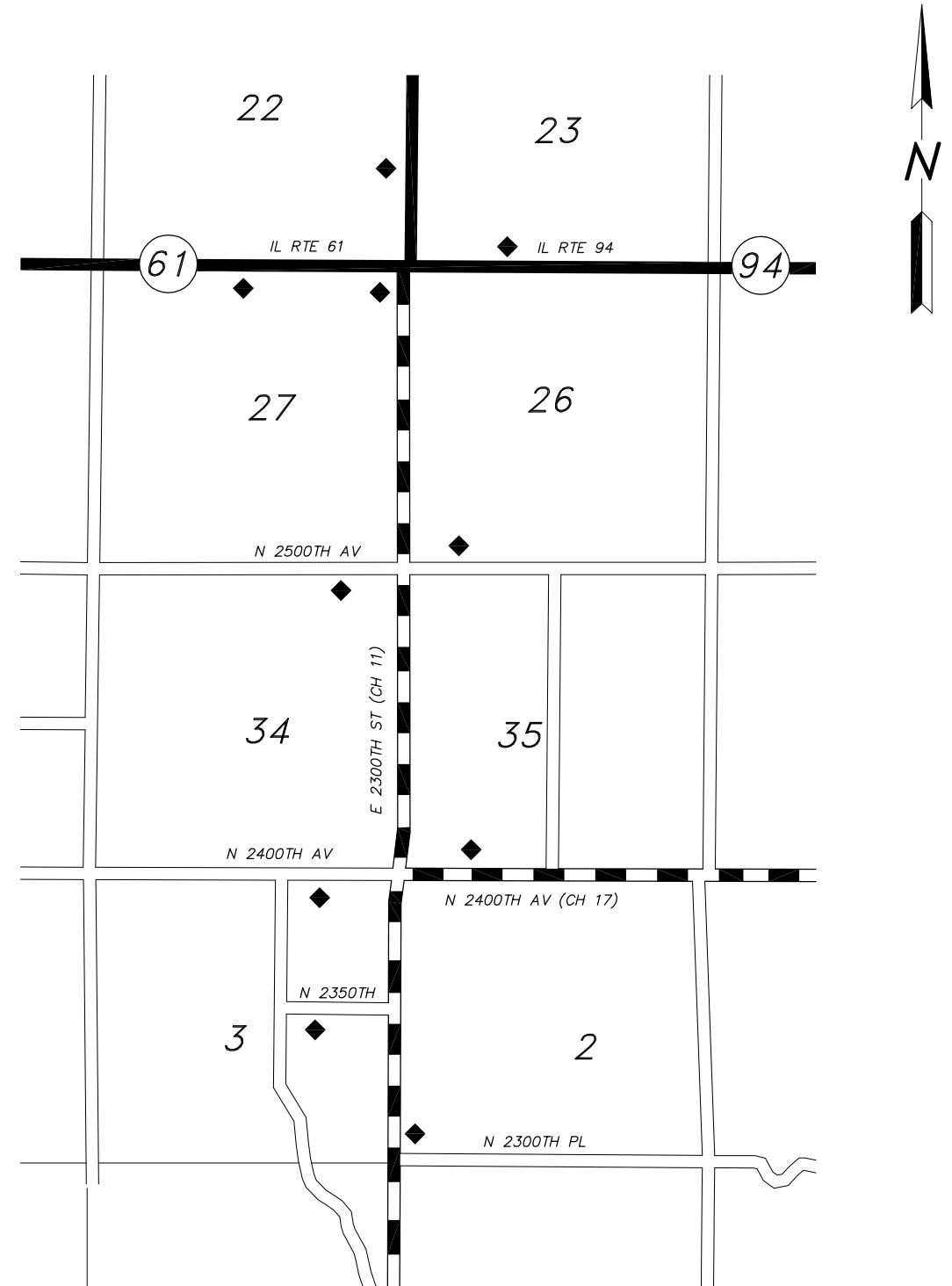

◆ ROAD CONSTRUCTION AHEAD

SEE SPECIAL PROVISIONS FOR APPLICATION OF:
"NO PASSING ZONES NOT STRIPPED NEXT ____ MILES"

| | | |
|------------------|----------------|-----------|
| USER NAME = | DESIGNED - JRF | REVISED - |
| PLOT SCALE = 1:2 | DRAWN - AJM | REVISED - |
| PLOT DATE = | CHECKED - | REVISED - |
| | DATE - | REVISED - |

**ADAMS COUNTY
HIGHWAY DEPARTMENT**

| | |
|--|----------------------|
| GENERAL NOTES HMA MIXTURE REQUIREMENTS | |
| APPLICATION RATES TRAFFIC CONTROL AND PROTECTION | |
| FAS ROUTE 1598 (CO HWY 11) | |
| SCALE | STA. --- TO STA. --- |
| SHEET 1 OF 1 SHEETS | |

| | | | | |
|--------------------|----------|----------------|--------------|-----------|
| COUNTY | ROUTE | SECTION | TOTAL SHEETS | SHEET NO. |
| ADAMS | FAS 1598 | 16-00017-05-FP | 17 | 4 |
| CONTRACT NO. 93788 | | | | |

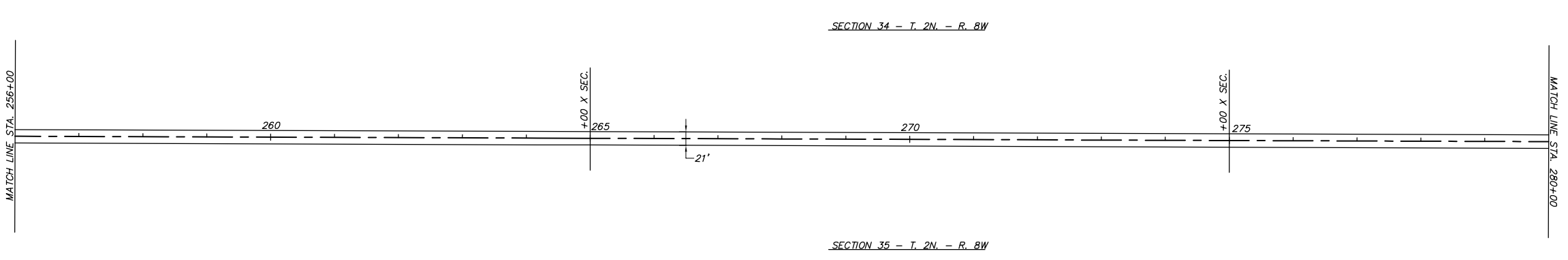
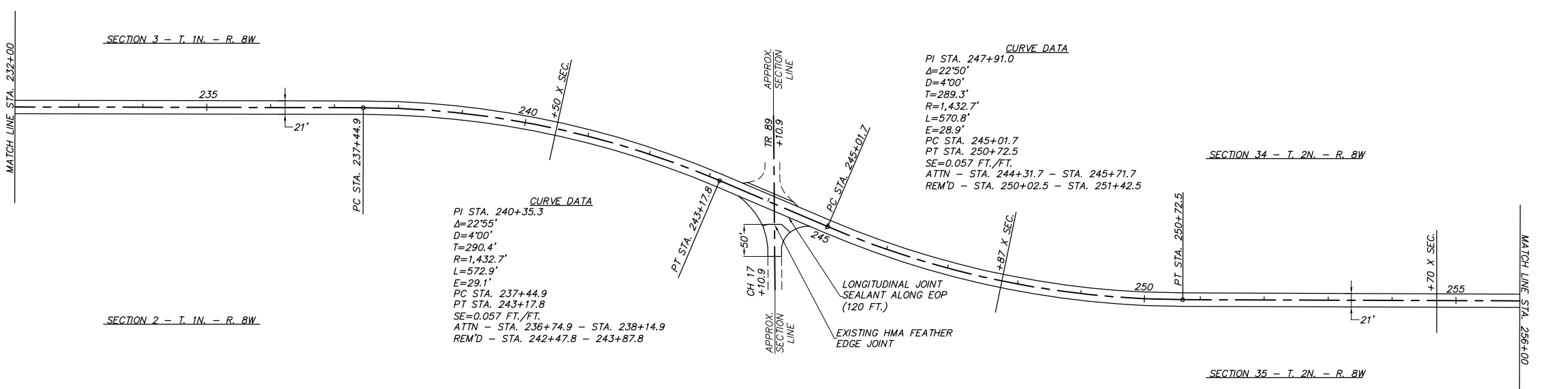
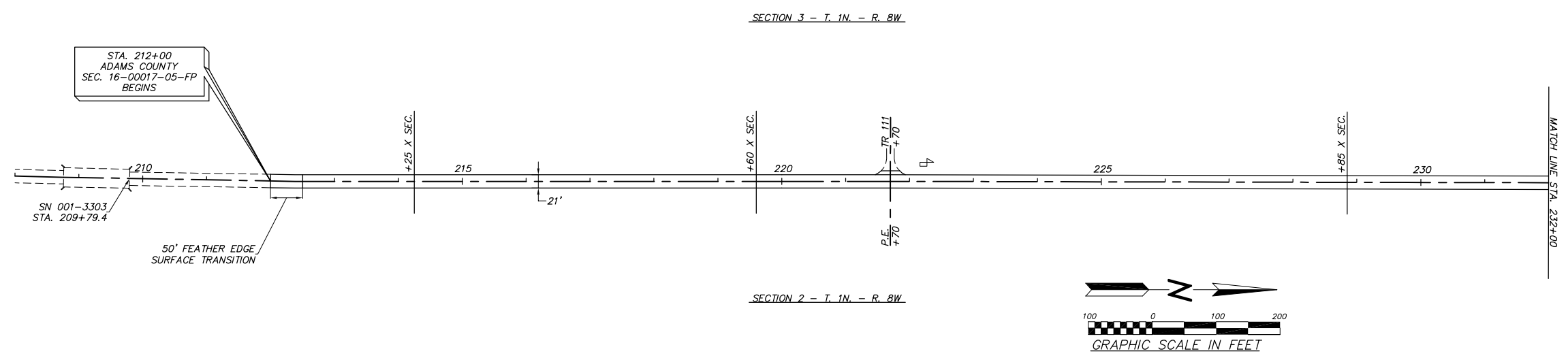

| | | |
|--------------------|----------------|-----------|
| USER NAME = | DESIGNED - JRF | REVISED - |
| PLOT SCALE = 1:100 | DRAWN - AJM | REVISED - |
| PLOT DATE = | CHECKED - | REVISED - |
| | DATE - | REVISED - |

**ADAMS COUNTY
HIGHWAY DEPARTMENT**

**PLAN
FAS ROUTE 1598 (CO HWY 11)**

SCALE 1"=100' SHEET 1 OF 2 SHEETS STA. 208+00 TO STA. 280+00

| | | | | |
|--------------------|----------|----------------|--------------|-----------|
| COUNTY | ROUTE | SECTION | TOTAL SHEETS | SHEET NO. |
| ADAMS | FAS 1598 | 16-00017-05-FP | 17 | 5 |
| CONTRACT NO. 93788 | | | | |

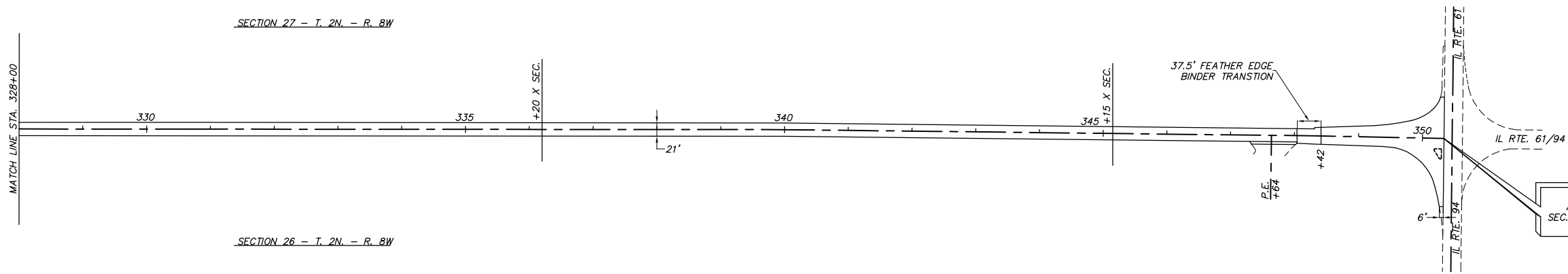
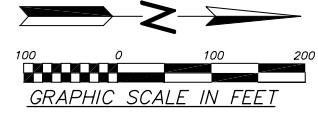
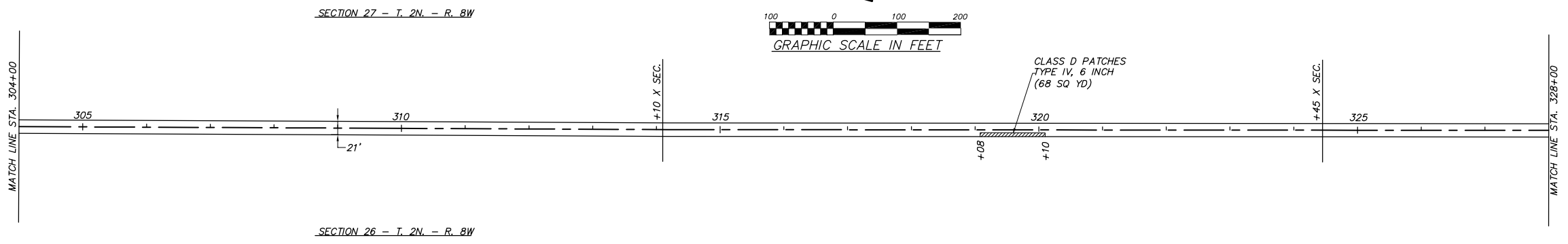
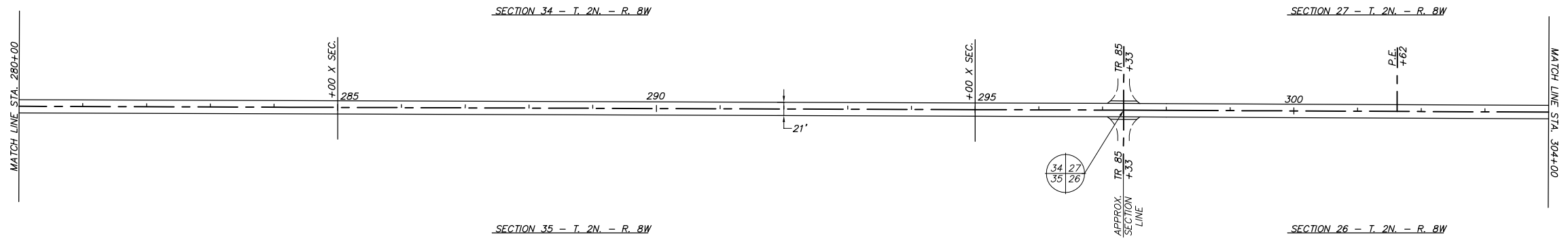

| | | |
|--------------------|----------------|-----------|
| USER NAME = | DESIGNED - JRF | REVISED - |
| PLOT SCALE = 1:100 | DRAWN - AJM | REVISED - |
| PLOT DATE = | CHECKED - | REVISED - |
| | DATE - | REVISED - |

**ADAMS COUNTY
HIGHWAY DEPARTMENT**

**PLAN
FAS ROUTE 1598 (CO HWY 11)**

SCALE 1"=100' SHEET 2 OF 2 SHEETS STA. 280+00 TO STA. 350+34

| COUNTY | ROUTE | SECTION | TOTAL SHEETS | SHEET NO. |
|--------------------|----------|----------------|--------------|-----------|
| ADAMS | FAS 1598 | 16-00017-05-FP | 17 | 6 |
| CONTRACT NO. 93788 | | | | |

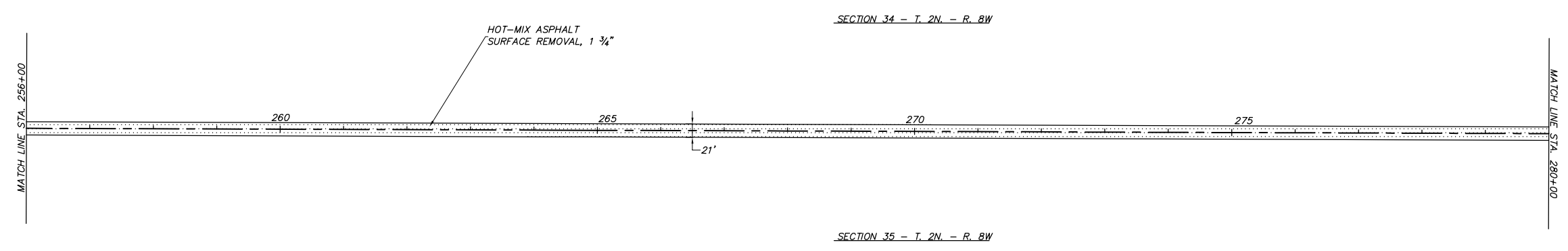
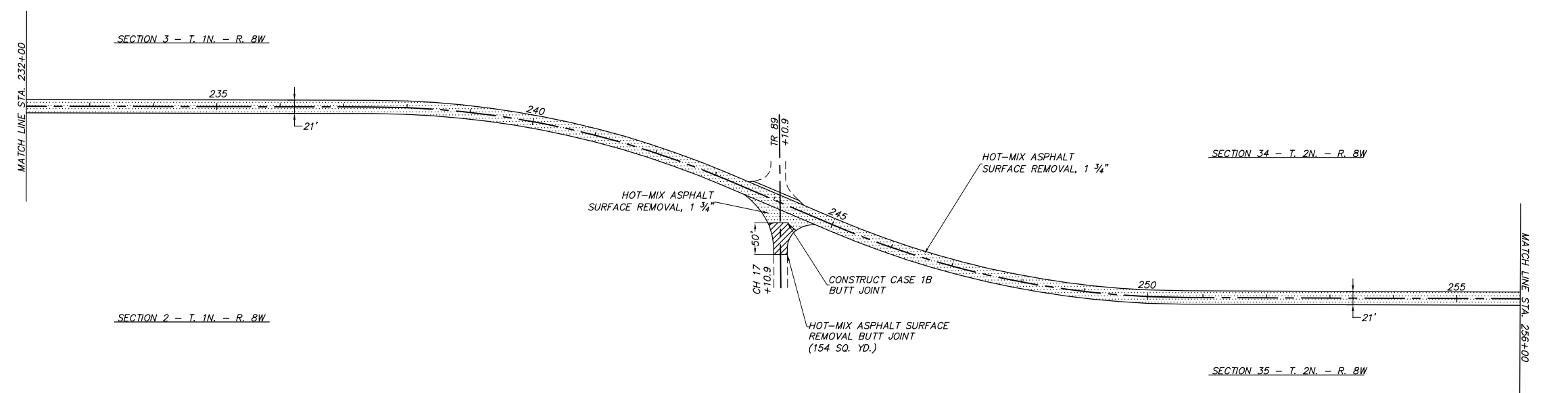
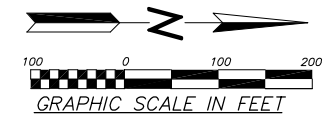
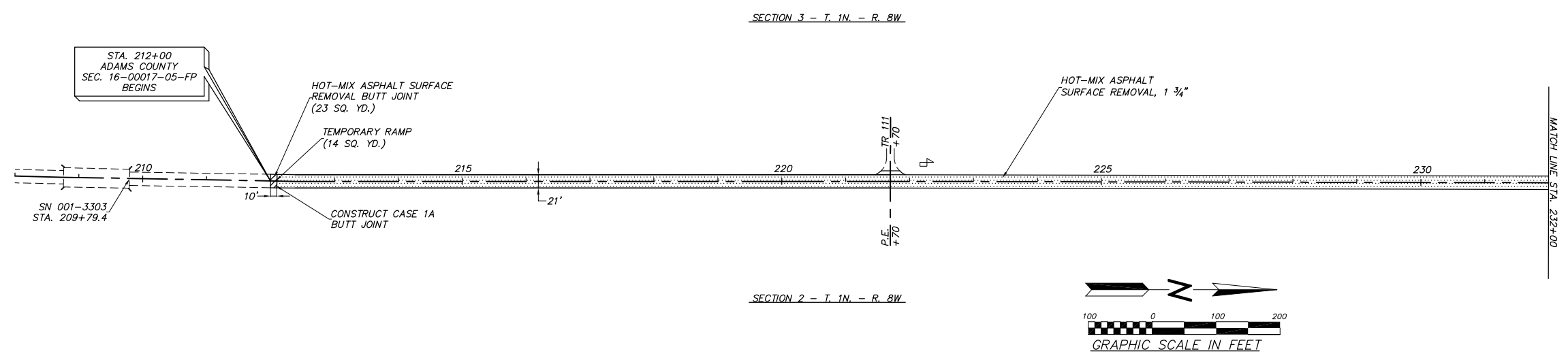

| | | | | | | | | | |
|--------------------|----------------|-----------|--|--|---------------|----------|---------------------|----------------------------|--------------------|
| USER NAME = | DESIGNED - JRF | REVISED - | ADAMS COUNTY HIGHWAY DEPARTMENT | HMA SURFACE REMOVAL PLAN FAS ROUTE 1598 (CO HWY 11) | COUNTY | ROUTE | SECTION | TOTAL SHEETS | SHEET NO. |
| PLOT SCALE = 1:100 | DRAWN - AJM | REVISED - | | | ADAMS | FAS 1598 | 16-00017-05-FP | 17 | 7 |
| PLOT DATE = | CHECKED - | REVISED - | | | SCALE 1"=100' | | SHEET 1 OF 2 SHEETS | STA. 208+00 TO STA. 280+00 | CONTRACT NO. 93788 |
| | DATE - | REVISED - | | | | | | | |

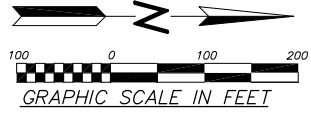
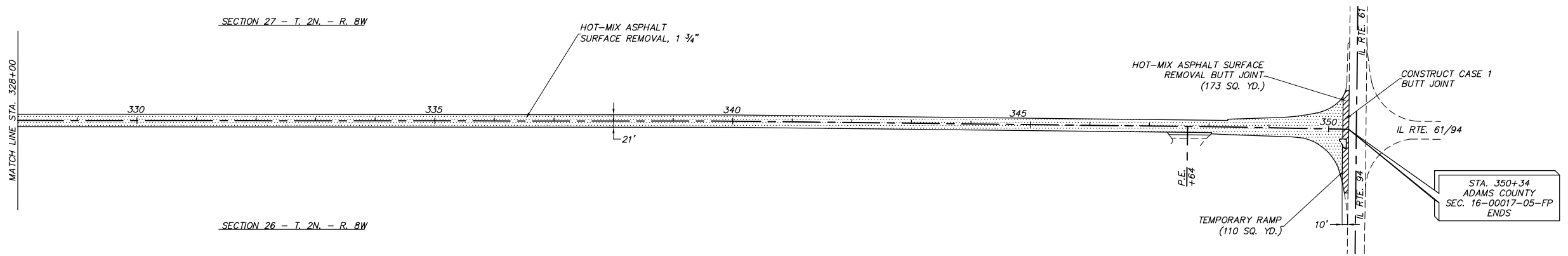
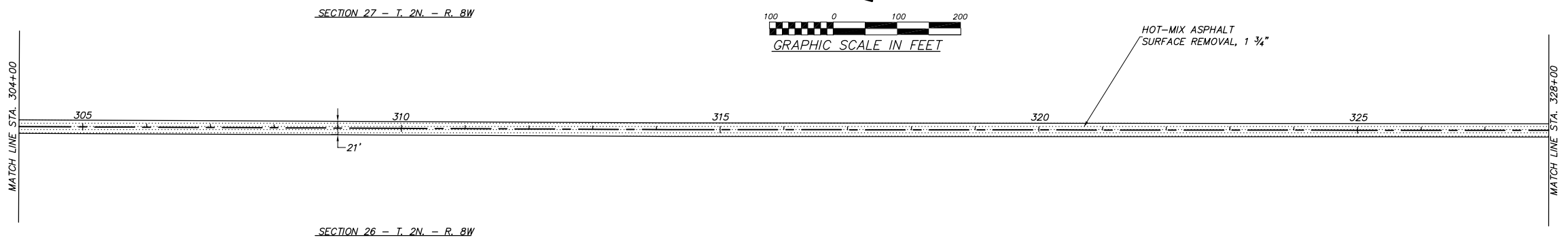
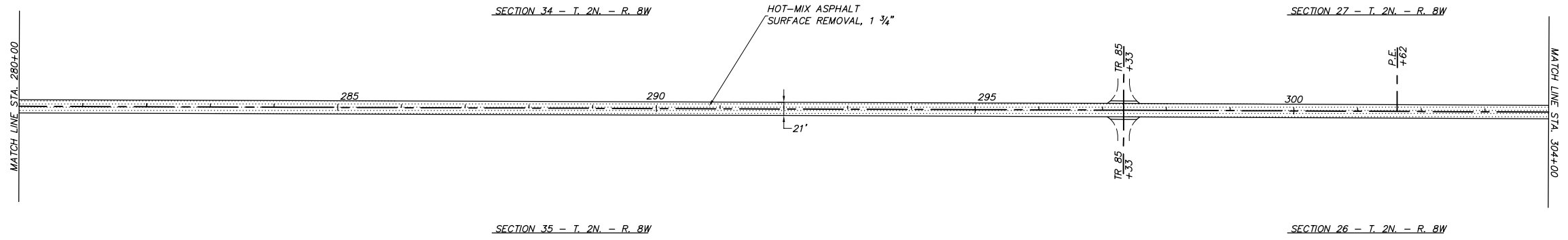

| | | |
|--------------------|----------------|-----------|
| USER NAME = | DESIGNED - JRF | REVISED - |
| PLOT SCALE = 1:100 | DRAWN - AJM | REVISED - |
| PLOT DATE = | CHECKED - | REVISED - |
| | DATE - | REVISED - |

**ADAMS COUNTY
HIGHWAY DEPARTMENT**

**HMA SURFACE REMOVAL PLAN
FAS ROUTE 1598 (CO HWY 11)**

SCALE 1"=100' SHEET 2 OF 2 SHEETS STA. 280+00 TO STA. 350+34

| COUNTY | ROUTE | SECTION | TOTAL SHEETS | SHEET NO. |
|--------------------|----------|----------------|--------------|-----------|
| ADAMS | FAS 1598 | 16-00017-05-FP | 17 | 8 |
| CONTRACT NO. 93788 | | | | |

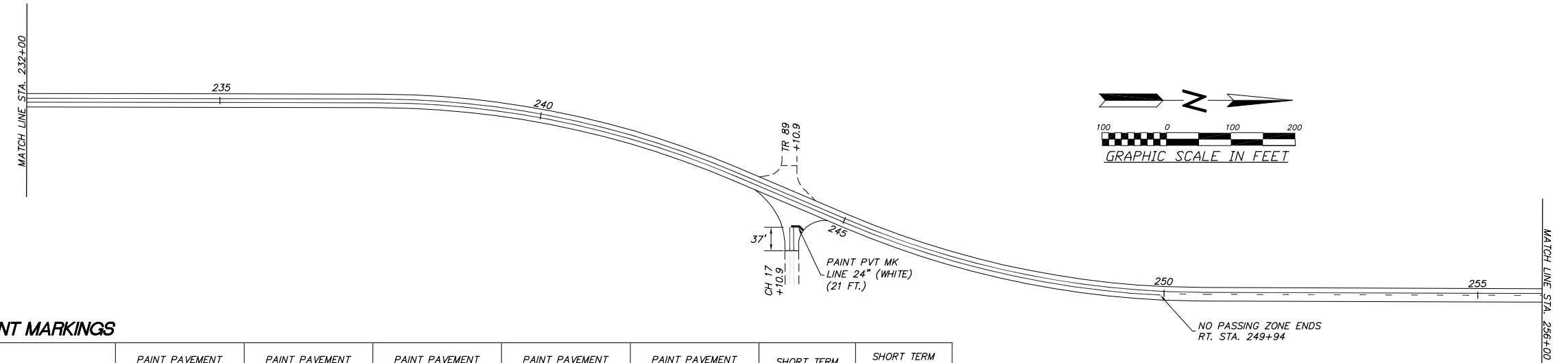
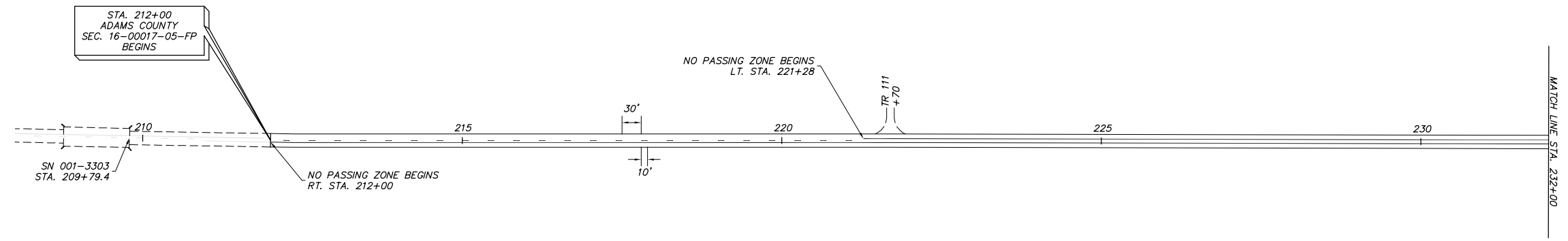

PAVEMENT MARKINGS

| LOCATION / STA. - STA. | PAINT PAVEMENT MARKING - LINE 4" (YELLOW) | PAINT PAVEMENT MARKING - LINE 4" (WHITE) | PAINT PAVEMENT MARKING - LINE 8" (WHITE) | PAINT PAVEMENT MARKING - LINE 12" (WHITE) | PAINT PAVEMENT MARKING - LINE 24" (WHITE) | SHORT TERM PAVEMENT MARKING | SHORT TERM PAVEMENT MARKING REMOVAL |
|---------------------------|---|--|--|---|---|-----------------------------|-------------------------------------|
| | FOOT | FOOT | FOOT | FOOT | FOOT | FOOT | SQ FT |
| STA. 212+00 - STA. 350+22 | 12,520 | 494 | 86 | 51 | 29 | 1,384 | 462 |
| CH 17 INTERSECTION | 74 | | | | 21 | | |
| TOTAL | 12,594 | 494 | 86 | 51 | 50 | 1,384 | 462 |

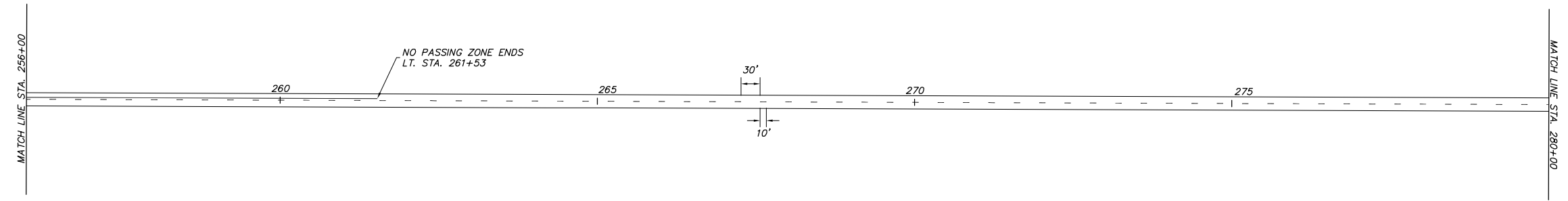

| | | |
|--------------------|----------------|-----------|
| USER NAME = | DESIGNED - JRF | REVISED - |
| PLOT SCALE = 1:100 | DRAWN - AJM | REVISED - |
| PLOT DATE = | CHECKED - | REVISED - |
| | DATE - | REVISED - |

**ADAMS COUNTY
HIGHWAY DEPARTMENT**

**PAVEMENT MARKINGS
FAS ROUTE 1598 (CO HWY 11)**

SCALE 1"=100' SHEET 1 OF 2 SHEETS STA. 208+00 TO STA. 280+00

| COUNTY | ROUTE | SECTION | TOTAL SHEETS | SHEET NO. |
|--------------------|----------|----------------|--------------|-----------|
| ADAMS | FAS 1598 | 16-00017-05-FP | 17 | 9 |
| CONTRACT NO. 93788 | | | | |

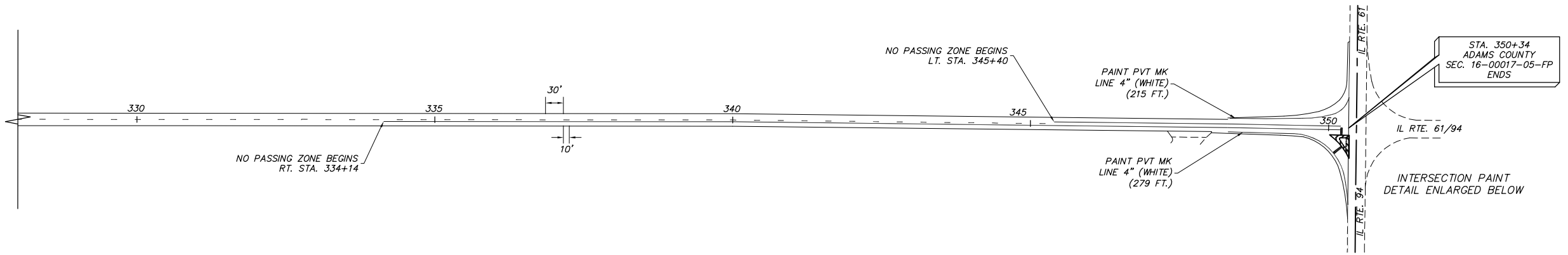
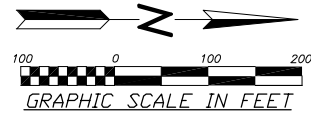
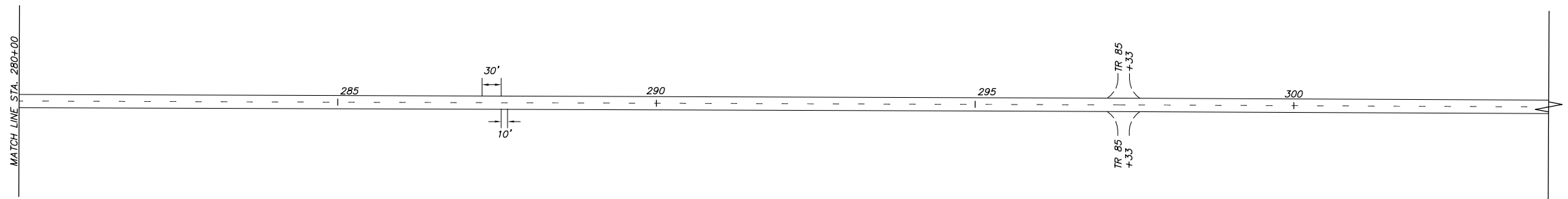

PAINT PVT MK LINE 12" (WHITE)

| | |
|-------|-------|
| 1 | 9.5' |
| 2 | 4.0' |
| 3 | 10.5' |
| 4 | 5.5' |
| 5 | 14.0' |
| 6 | 3.0' |
| 7 | 4.5' |
| TOTAL | 51.0' |

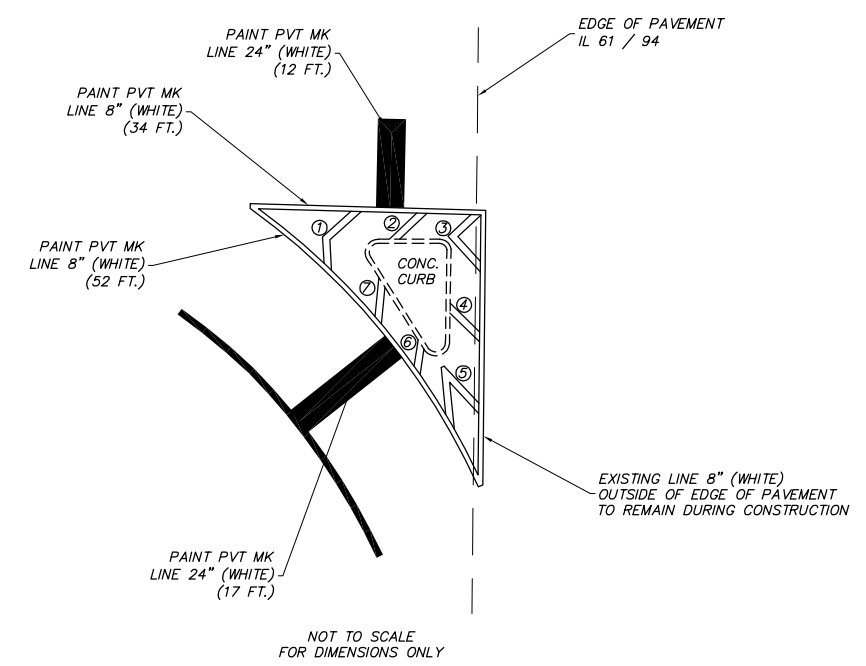

| | | |
|--------------------|----------------|-----------|
| USER NAME = | DESIGNED - JRF | REVISED - |
| PLOT SCALE = 1:100 | DRAWN - AJM | REVISED - |
| PLOT DATE = | CHECKED - | REVISED - |
| | DATE - | REVISED - |

**ADAMS COUNTY
HIGHWAY DEPARTMENT**

**PAVEMENT MARKINGS
FAS ROUTE 1598 (CO HWY 11)**

SCALE 1"=100' SHEET 2 OF 2 SHEETS STA. 280+00 TO STA. 350+34

| COUNTY | ROUTE | SECTION | TOTAL SHEETS | SHEET NO. |
|--------------------|----------|----------------|--------------|-----------|
| ADAMS | FAS 1598 | 16-00017-05-FP | 17 | 10 |
| CONTRACT NO. 93788 | | | | |

INTERSECTION DETAIL

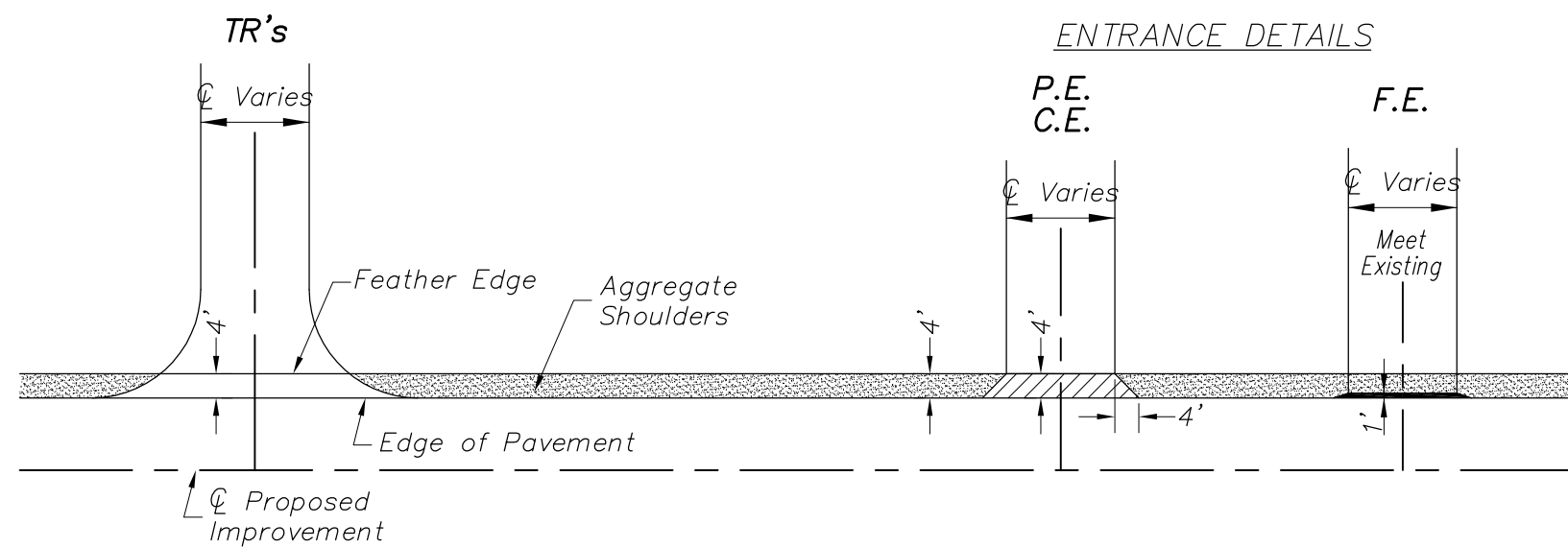

**INCIDENTAL PAVING SCHEDULE
 (ENTRANCES + SIDE ROADS)**

| TYPE / STA. | PREPARATION OF BASE | BITUMINOUS MATERIALS (TACK COAT) | INCIDENTAL HOT-MIX ASPHALT SURFACING |
|----------------------|---------------------|----------------------------------|--------------------------------------|
| | SQ YD | POUND | TON |
| P.E. RT. STA. 221+70 | | 8 | 2 |
| TR LT. STA. 221+70 | | 8 | 2 |
| TR LT. STA. 244+10.9 | | 18 | 3 |
| TR RT. STA. 297+33 | | 10 | 2 |
| TR LT. STA. 297+33 | | 12 | 2 |
| P.E. LT. STA. 301+62 | 4 | 4 | 1 |
| P.E. RT. STA. 347+64 | | 15 | 3 |
| TOTAL | 4 | 75 | 15 |

ALLOW 15 TON AGGREGATE BASE COURSE, TYPE B FOR USE WITH PREPARATION OF BASE AT VARIOUS LOCATIONS.

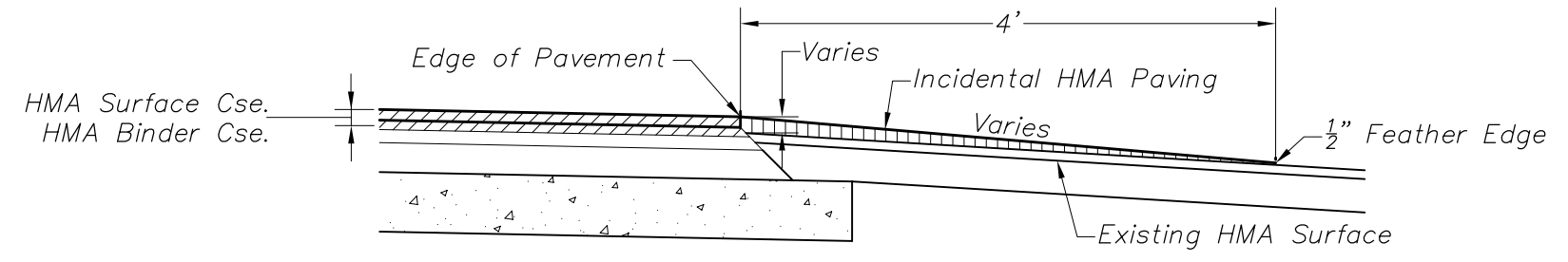

EXISTING HMA or PCC ENTRANCE

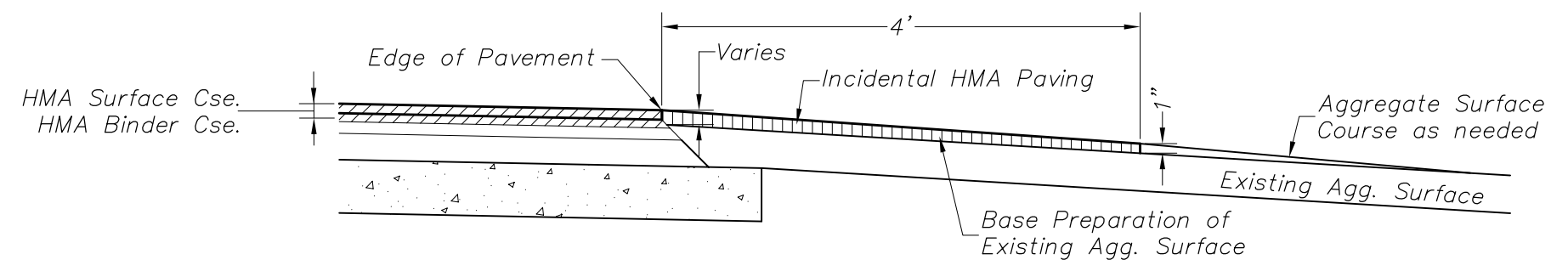

EXISTING AGGREGATE SURFACE ENTRANCE

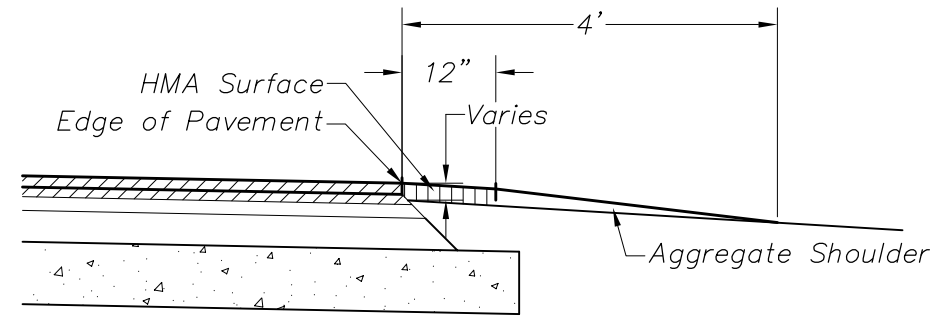

FIELD ENTRANCE

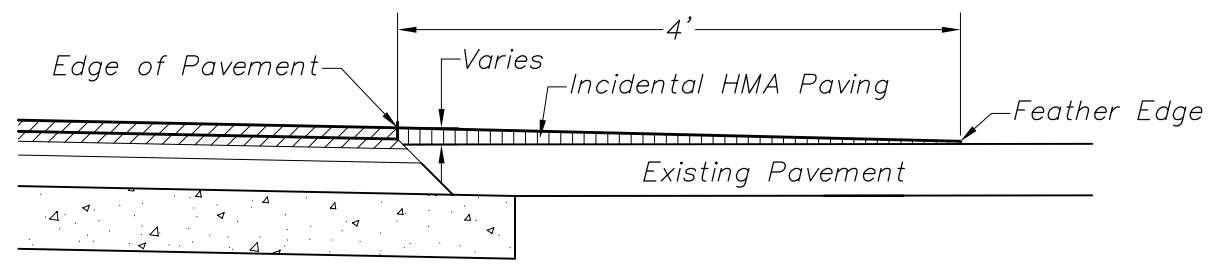

EXISTING SIDE ROADS

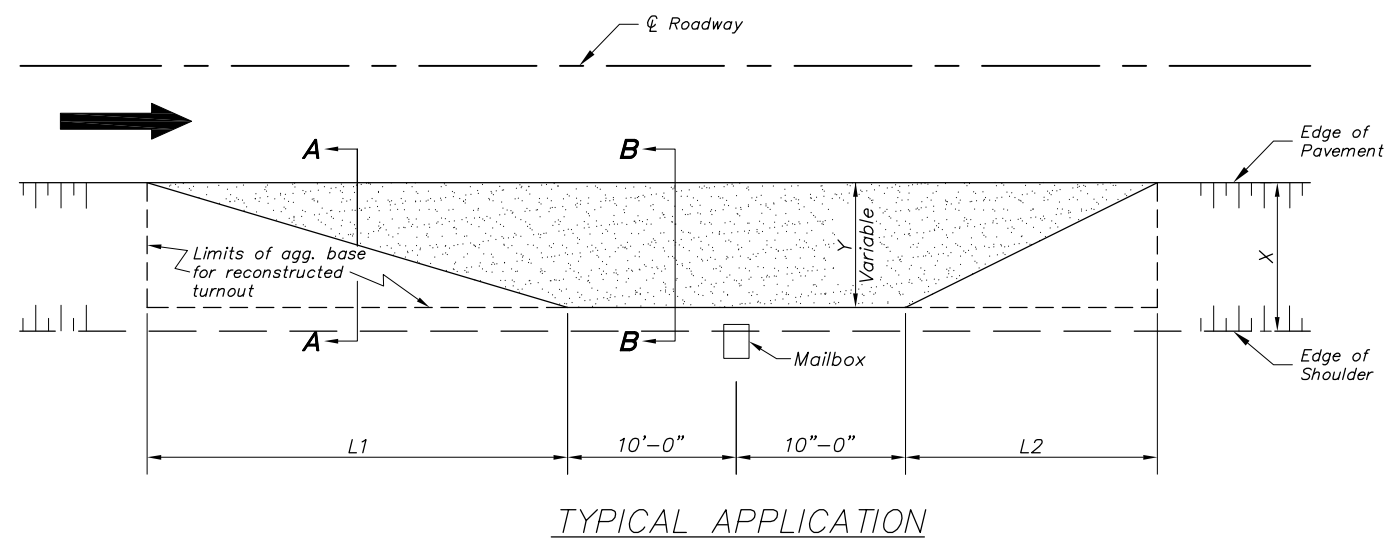

TYPICAL APPLICATION

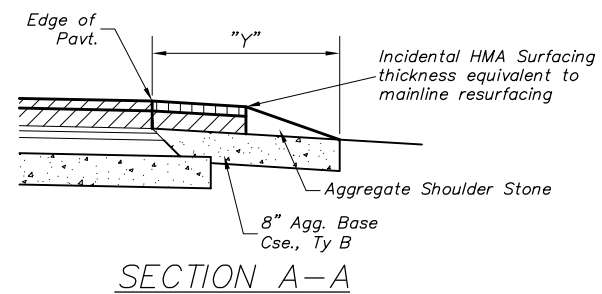

SECTION A-A

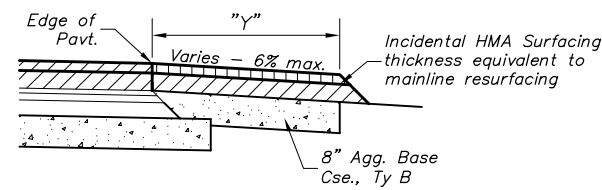

SECTION B-B

RECONSTRUCTED TURNOUTS

INCIDENTAL PAVING SCHEDULE (MAILBOX TURNOUT)

| LOCATION / STA. - STA. | BITUMINOUS MATERIALS (TACK COAT) | INCIDENTAL HOT-MIX ASPHALT SURFACING |
|------------------------|----------------------------------|--------------------------------------|
| | POUND | TON |
| L.T. STA. 222+27 | 2 | 9 |
| TOTAL | 2 | 9 |

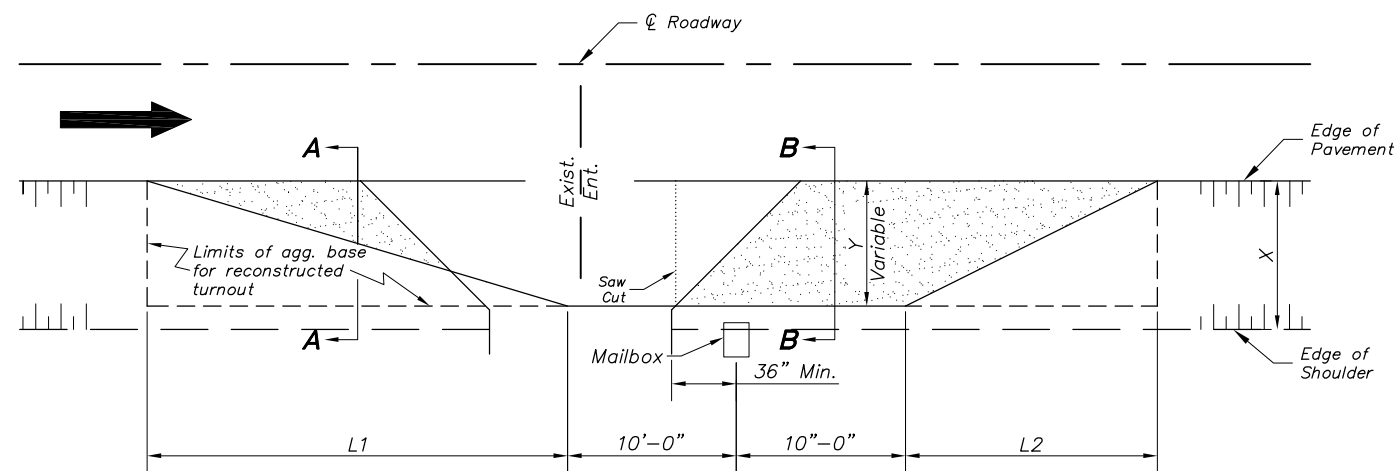

MAILBOX ON FARSIDE OF ENTRANCE

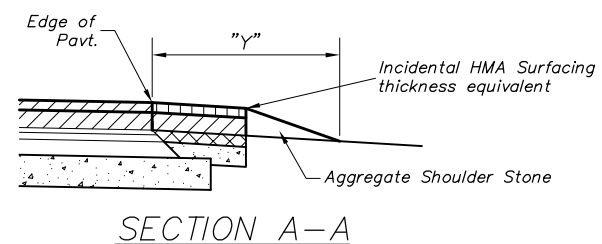

SECTION A-A

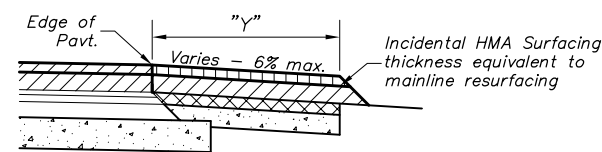

SECTION B-B

RESURFACED TURNOUTS

| DIMENSIONS - ft. | | | | | |
|-----------------------|----|----|----|----|----|
| Width of Shoulder (X) | 10 | 8 | 6 | 5 | 4 |
| Width of Turnout (Y) | 8 | 6 | 4 | 4 | 4 |
| L ₁ | 30 | 23 | 15 | 15 | 15 |
| L ₂ | 20 | 15 | 10 | 10 | 10 |

GENERAL NOTES:

The Engineer reserves the right to alter the placement of the mailbox turnout to match existing conditions and utilize the entrance as part of the taper.

Mailboxes shall be mounted such that the face of the mailbox is 6" to 12" and the post a minimum of 24" from the edge of the turnout surfacing.

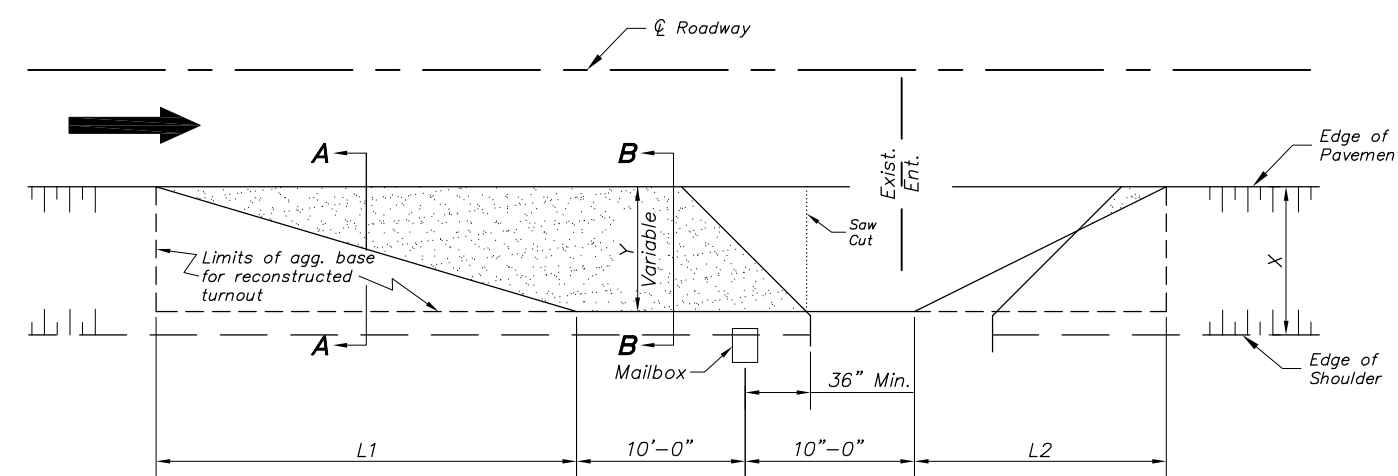

MAILBOX ON NEARSIDE OF ENTRANCE

| | | |
|------------------|----------------|-----------|
| USER NAME = | DESIGNED - JRF | REVISED - |
| PLOT SCALE = 1:1 | DRAWN - AJM | REVISED - |
| PLOT DATE = | CHECKED - | REVISED - |
| | DATE - | REVISED - |

ADAMS COUNTY
HIGHWAY DEPARTMENT

MAILBOX TURNOUTS

SCALE: NONE SHEET 1 OF 1 SHEETS

STA. -- TO STA. --

| COUNTY | ROUTE | SECTION | TOTAL SHEETS | SHEET NO. |
|--------------------|----------|---------------|--------------|-----------|
| ADAMS | FAS 1598 | 16-0017-05-FP | 17 | 12 |
| CONTRACT NO. 93788 | | | | |

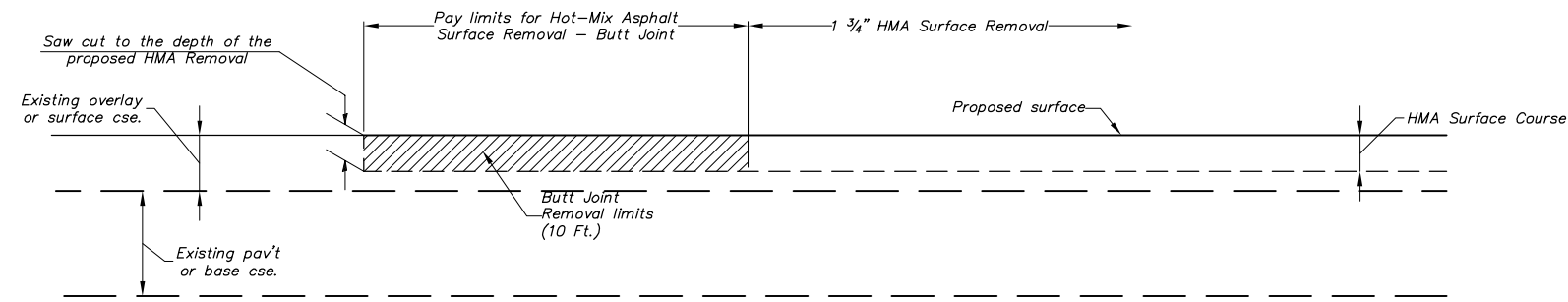

CASE 1: BUTT JOINT & SURFACE REMOVAL w/ SURFACE OVERLAY

General Notes

1. The work shall be done in accordance with Article 406.08 and the Special Provision for Butt Joints.
2. The pavement surface to be removed may be either HMA or P.C. concrete. The work shall be performed in accordance with Article 440.04 and the Special Provisions for Butt Joints.
3. The saw cut joints shall be primed just prior to the placing of HMA material. The work will be in accordance with the applicable portions of Article 406.05.

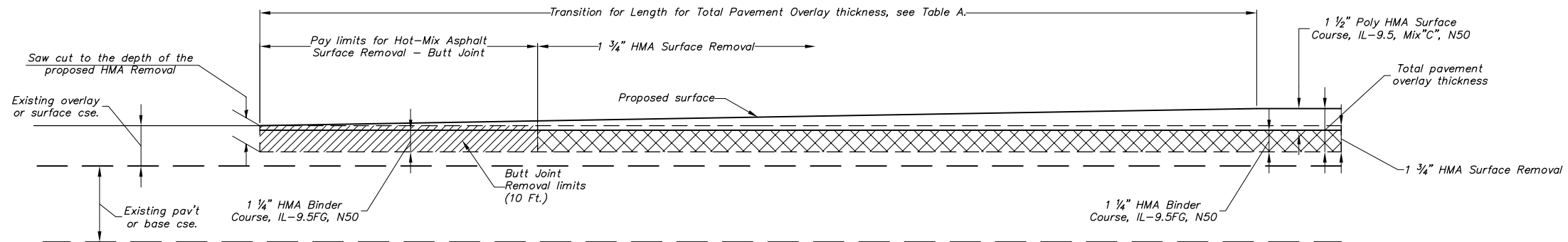

CASE 1A: BUTT JOINT & SURFACE REMOVAL w/ SURFACE & BINDER OVERLAY

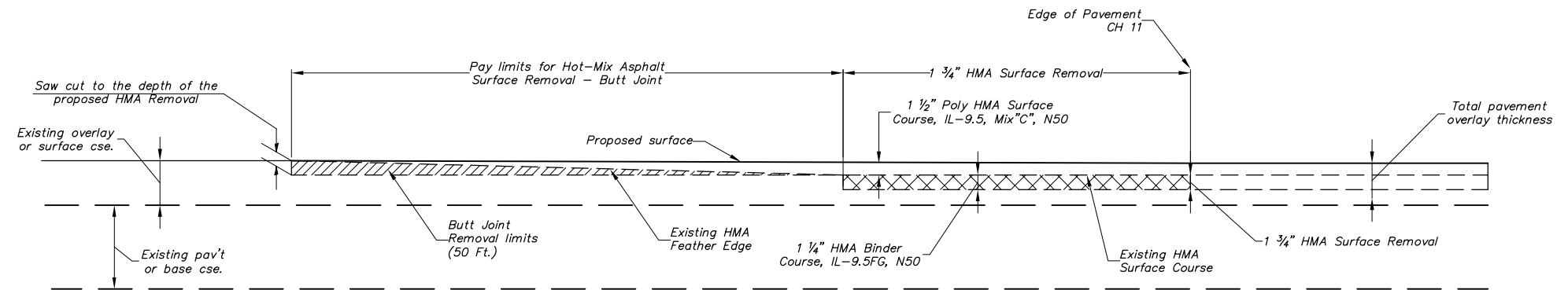

CASE 1B: BUTT JOINT & SURFACE REMOVAL w/ SURFACE & BINDER OVERLAY

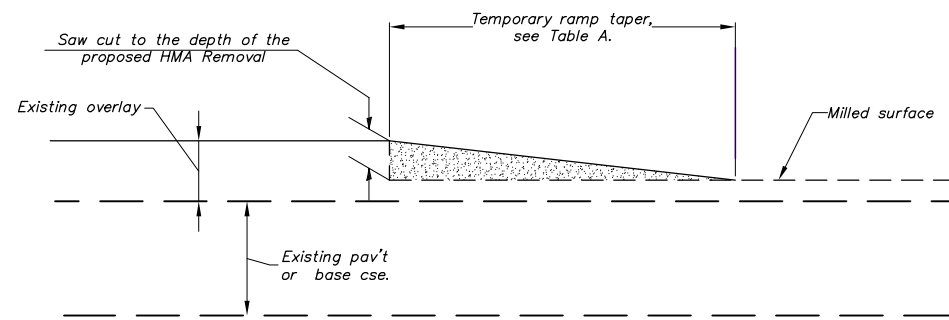

TEMPORARY RAMP DETAIL

TABLE A - TAPER RATES

| ELEMENT | POSTED SPEED < 45 MPH | POSTED SPEED ≥ 45 MPH |
|----------------|-------------------------|--|
| BUTT JOINT | 20' per 1" of DEPTH | 30' per 1" of DEPTH |
| FEATHEREDGE | 20' per 1" of THICKNESS | 30' per 1" of THICKNESS LESS 3/8" from TOTAL |
| TEMPORARY RAMP | 3' per 1" of HEIGHT | 4' per 1" of DEPTH |

Length of butt joint = Thickness of Surface Cse multiplied by the Taper Rate.
 Length of Pav't Transition = Total Pav't thickness multiplied by the Taper Rate.

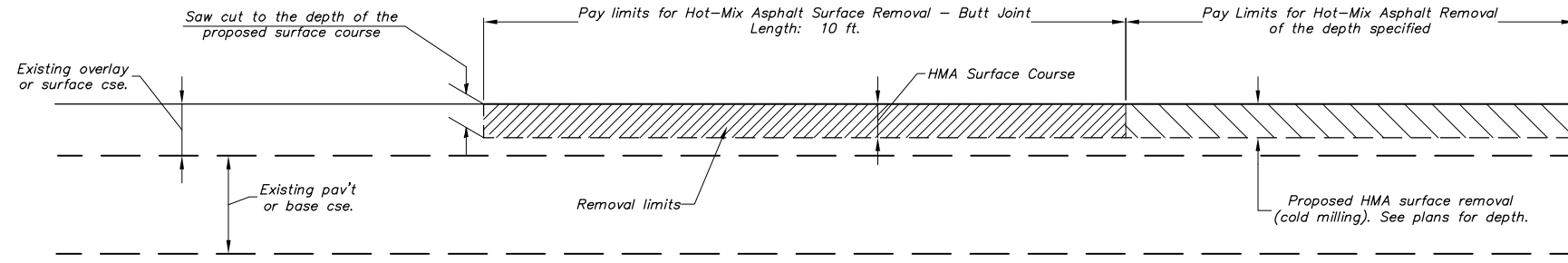

CASE 2: BUTT JOINT & SURFACE REMOVAL w/ RESURFACING

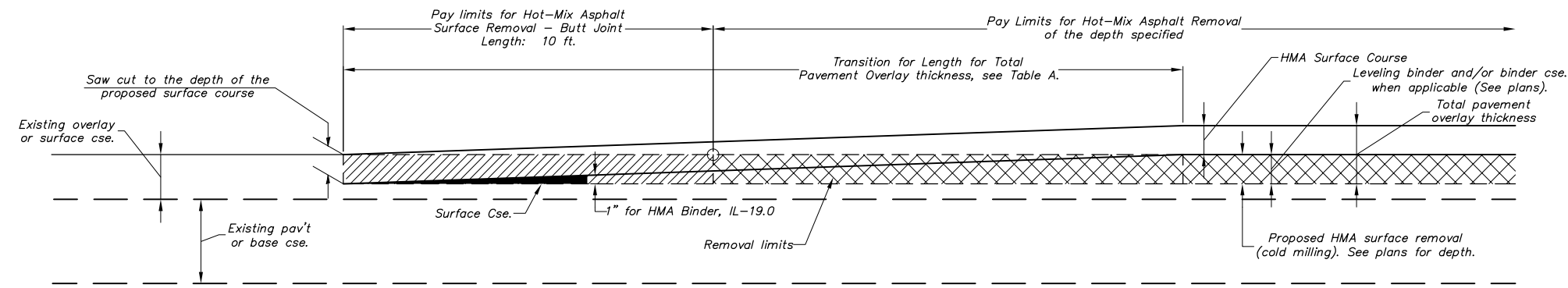

CASE 2A: BUTT JOINT & SURFACE REMOVAL w/ BINDER & RESURFACING

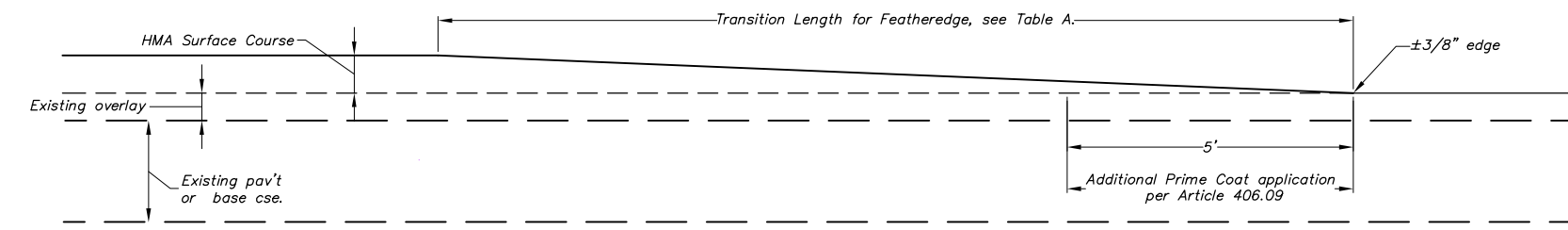

FEATHER EDGE APPROACH - SURFACE CSE

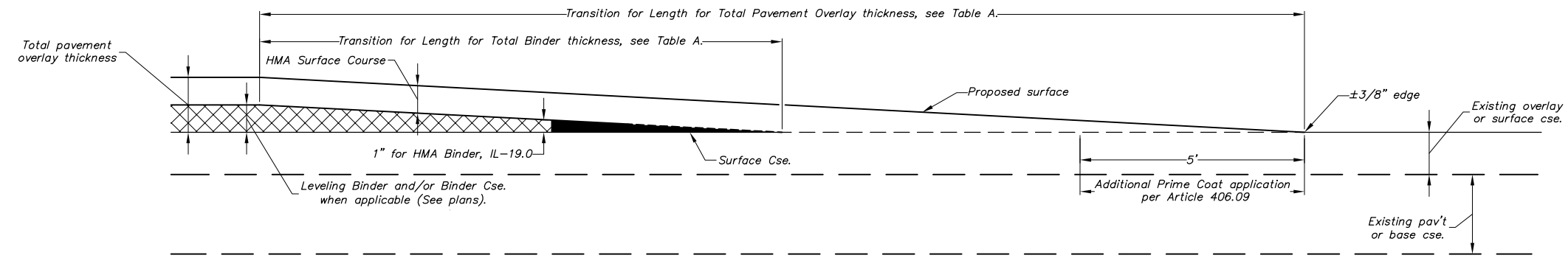

FEATHER EDGE APPROACH - SURFACE & BINDER CSE

| | | |
|-------------------|----------------|-----------|
| USER NAME = | DESIGNED - JRF | REVISED - |
| PLOT SCALE = 1:20 | DRAWN - JRF | REVISED - |
| PLOT DATE = | CHECKED - | REVISED - |
| | DATE - | REVISED - |

**ADAMS COUNTY
HIGHWAY DEPARTMENT**

| | | |
|---|---------------------|----------------------|
| BUTT JOINTS FEATHER EDGE TRANSITIONS | | |
| SCALE NONE | SHEET 2 OF 2 SHEETS | STA. --- TO STA. --- |

| | | | | |
|--------------------|----------|----------------|--------------|-----------|
| COUNTY | ROUTE | SECTION | TOTAL SHEETS | SHEET NO. |
| ADAMS | FAS 1598 | 16-00017-05-FP | 17 | 14 |
| CONTRACT NO. 93788 | | | | |

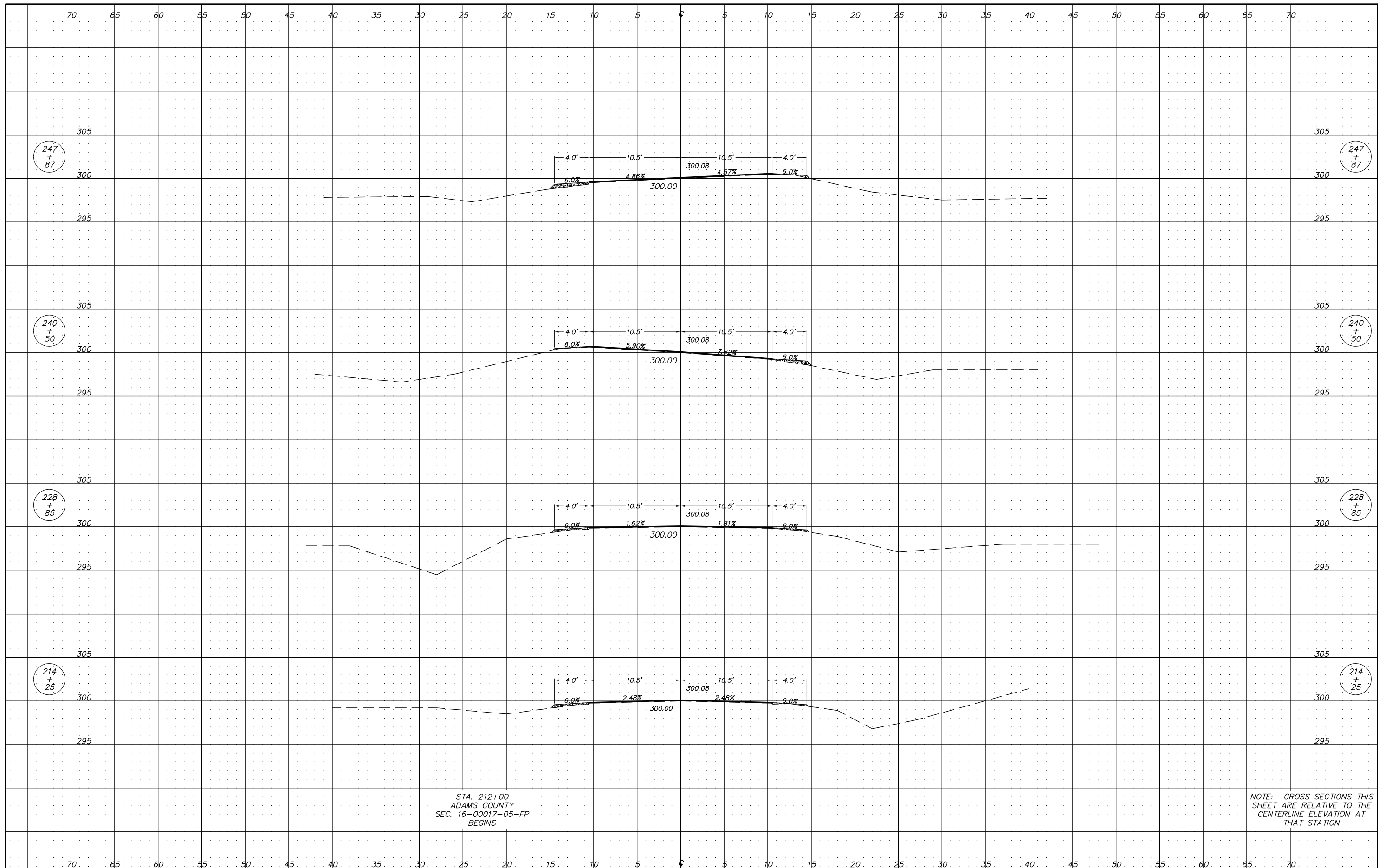

STA. 212+00
ADAMS COUNTY
SEC. 16-00017-05-FP
BEGINS

NOTE: CROSS SECTIONS THIS
SHEET ARE RELATIVE TO THE
CENTERLINE ELEVATION AT
THAT STATION

| | | | | | | | | | | | |
|------------------|----------------|-----------|--|--|---------------------|----------------------------|--------------------|----------|----------------|--------------|-----------|
| USER NAME = | DESIGNED - JRF | REVISED - | ADAMS COUNTY HIGHWAY DEPARTMENT | CROSS SECTIONS FAS ROUTE 1598 (CO HWY 11) | | | COUNTY | ROUTE | SECTION | TOTAL SHEETS | SHEET NO. |
| PLOT SCALE = 1:5 | DRAWN - AJM | REVISED - | | SCALE 1" = 5' | SHEET 1 OF 3 SHEETS | STA. 212+00 TO STA. 247+87 | ADAMS | FAS 1598 | 16-00017-05-FP | 17 | 15 |
| PLOT DATE = | CHECKED - | REVISED - | | | | | CONTRACT NO. 93788 | | | | |
| | DATE - | REVISED - | | | | | | | | | |

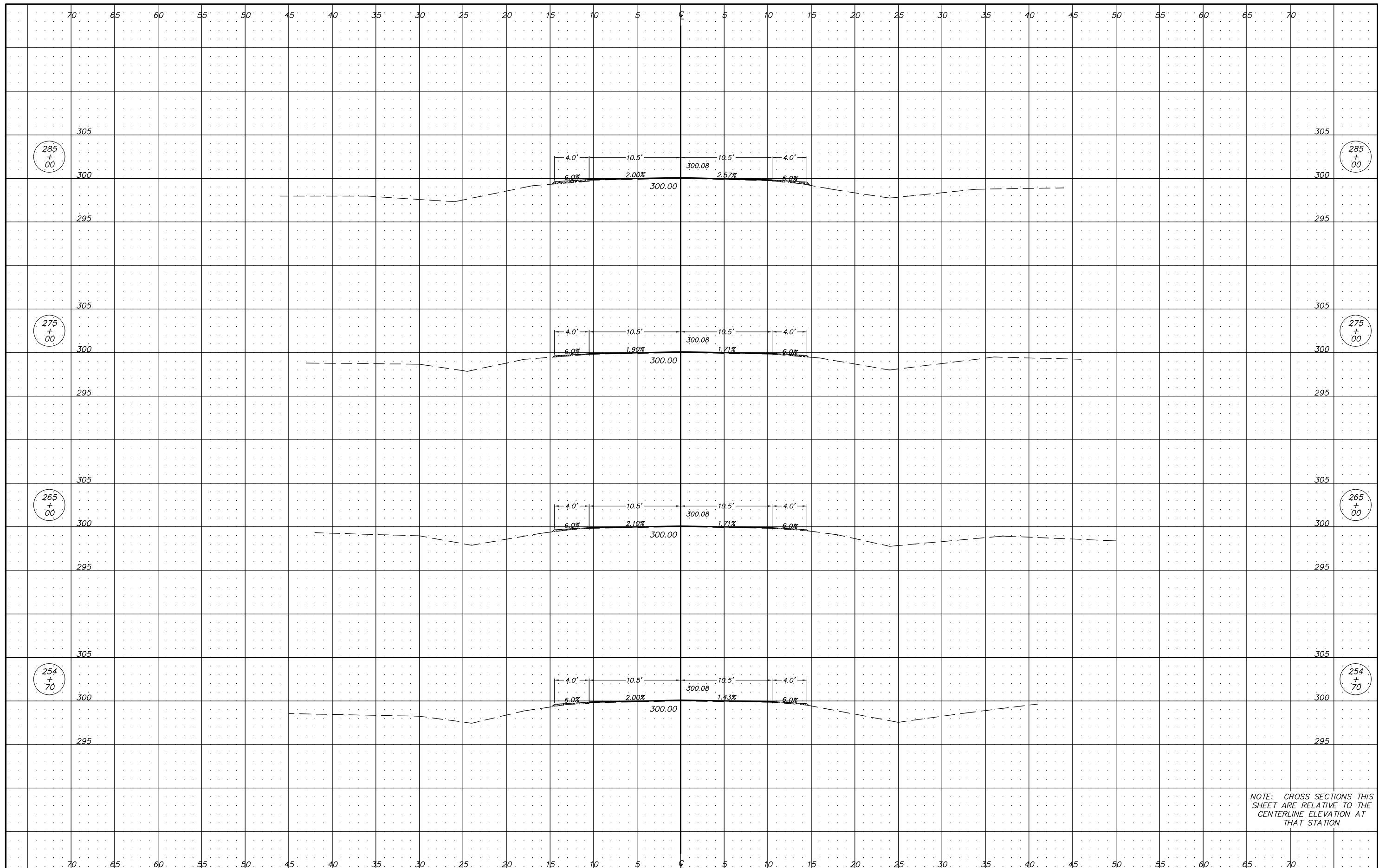

NOTE: CROSS SECTIONS THIS SHEET ARE RELATIVE TO THE CENTERLINE ELEVATION AT THAT STATION

| | | | | | | | | | | | |
|------------------|----------------|-----------|--|--|---------------------|----------------------------|--------------------|----------|----------------|--------------|-----------|
| USER NAME = | DESIGNED - JRF | REVISED - | ADAMS COUNTY HIGHWAY DEPARTMENT | CROSS SECTIONS FAS ROUTE 1598 (CO HWY 11) | | | COUNTY | ROUTE | SECTION | TOTAL SHEETS | SHEET NO. |
| PLOT SCALE = 1:5 | DRAWN - AJM | REVISED - | | SCALE 1" = 5' | SHEET 2 OF 3 SHEETS | STA. 254+70 TO STA. 285+00 | ADAMS | FAS 1598 | 16-00017-05-FP | 17 | 16 |
| PLOT DATE = | CHECKED - | REVISED - | | | | | CONTRACT NO. 93788 | | | | |
| | DATE - | REVISED - | | | | | | | | | |

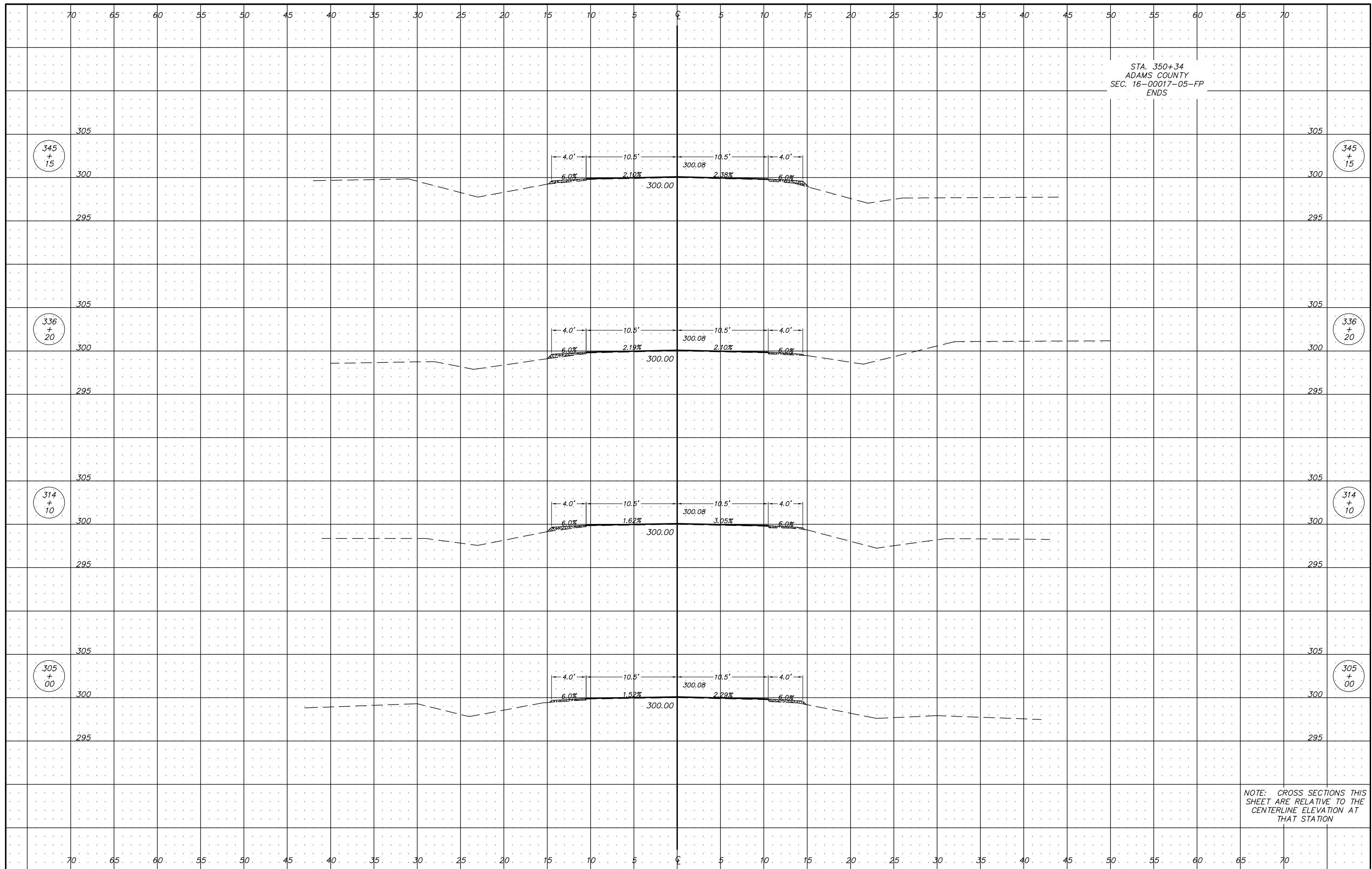

STA. 350+34
ADAMS COUNTY
SEC. 16-00017-05-FP
ENDS

NOTE: CROSS SECTIONS THIS SHEET ARE RELATIVE TO THE CENTERLINE ELEVATION AT THAT STATION

| | | | | | | | | | | |
|------------------|----------------|-----------|--|--|----------|---------------------|----------------------------|---------|--------------------|-----------|
| USER NAME = | DESIGNED - JRF | REVISED - | ADAMS COUNTY HIGHWAY DEPARTMENT | CROSS SECTIONS FAS ROUTE 1598 (CO HWY 11) | | COUNTY | ROUTE | SECTION | TOTAL SHEETS | SHEET NO. |
| PLOT SCALE = 1:5 | DRAWN - AJM | REVISED - | | ADAMS | FAS 1598 | 16-00017-05-FP | 17 | 17 | | |
| PLOT DATE = | CHECKED - | REVISED - | | SCALE 1" = 5' | | SHEET 3 OF 3 SHEETS | STA. 305+00 TO STA. 350+34 | | CONTRACT NO. 93788 | |
| | DATE - | REVISED - | | | | | | | | |