

SEE SHEET 73 FOR
ADDITIONAL INFORMATION
FOR WB I-290
IMPROVEMENT

END IMPROVEMENT
INTERIM RAMP SW
STA 1309+63.65



SCALE: 1"=50'

DATE	
BY	
PROJECT NO.	
PROPOSED	
ALIGNED	
FILE NAME	
NO.	
PLAN	
NO.	

DATE	
BY	
PROJECT NO.	
PROPOSED	
ALIGNED	
FILE NAME	
NO.	
PROFILE	
NO.	

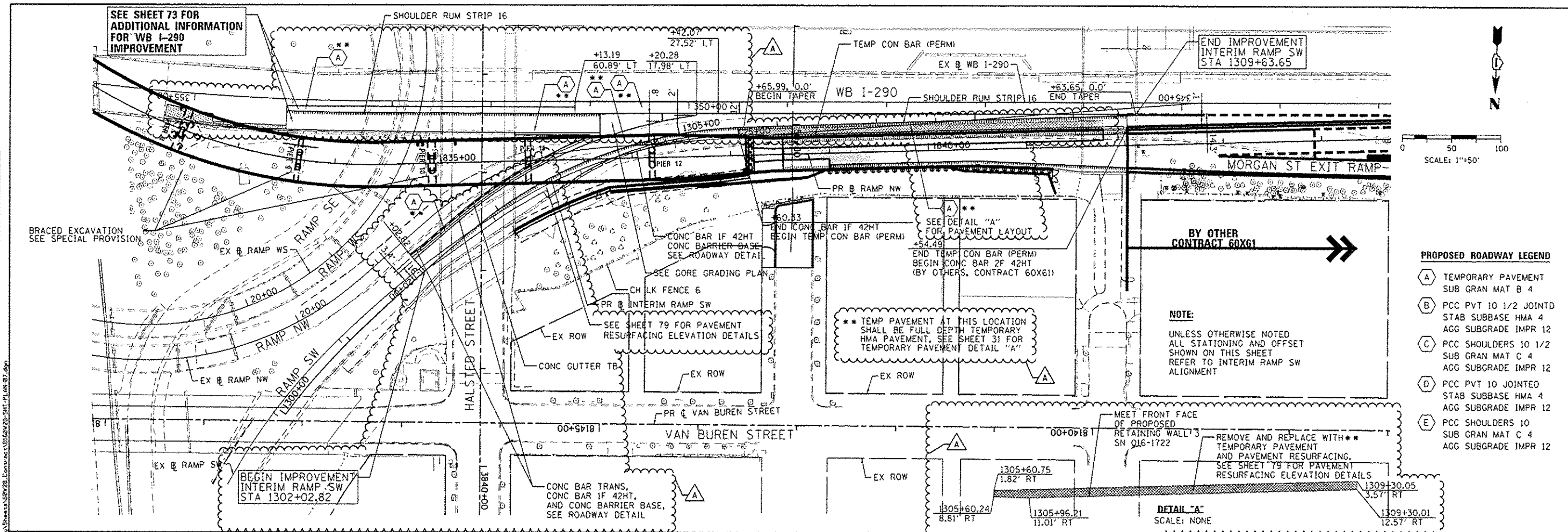

- PROPOSED ROADWAY LEGEND**
- (A) TEMPORARY PAVEMENT
SUB GRAN MAT B 4
 - (B) PCC PVT 10 1/2 JOINTD
STAB SUBBASE HMA 4
AGG SUBGRADE IMPR 12
 - (C) PCC SHOULDERS 10 1/2
SUB GRAN MAT C 4
AGG SUBGRADE IMPR 12
 - (D) PCC PVT 10 JOINTED
STAB SUBBASE HMA 4
AGG SUBGRADE IMPR 12
 - (E) PCC SHOULDERS 10
SUB GRAN MAT C 4
AGG SUBGRADE IMPR 12
- NOTE:**
UNLESS OTHERWISE NOTED
ALL STATIONING AND OFFSET
SHOWN ON THIS SHEET
REFER TO INTERIM RAMP SW
ALIGNMENT

**BY OTHER
CONTRACT 60X61** →

SEE DETAIL "A"
FOR PAVEMENT LAYOUT

END TEMP CON BAR (PERM)
BEGIN CONC BAR 2F 42HT
(BY OTHERS, CONTRACT 60X61)

TEMP PAVEMENT AT THIS LOCATION
SHALL BE FULL DEPTH TEMPORARY
HMA PAVEMENT, SEE SHEET 31 FOR
TEMPORARY PAVEMENT DETAIL "A"

REMOVE AND REPLACE WITH **
TEMPORARY PAVEMENT
AND PAVEMENT RESURFACING.
SEE SHEET 79 FOR PAVEMENT
RESURFACING ELEVATION DETAILS

DETAIL "A"
SCALE: NONE

EXISTING ELEVATIONS SHOWN FOR INFORMATION ONLY,
SEE SHEET 79 FOR ADDITIONAL INFORMATION
FOR INTERIM RAMP SW PAVEMENT RESURFACING

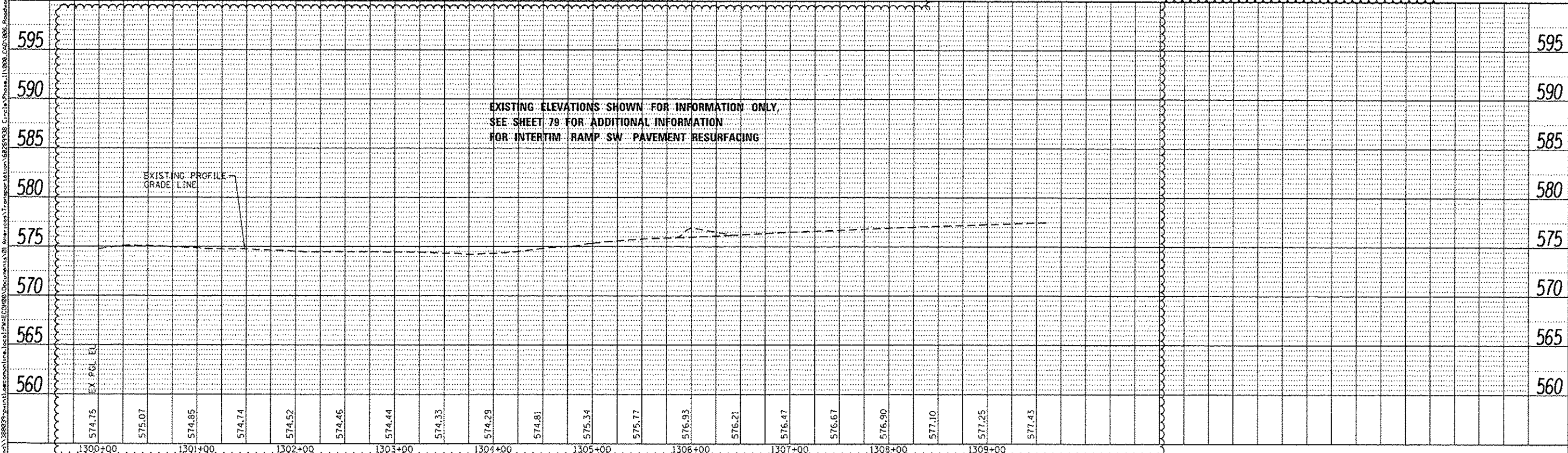

AECOM 303 EAST WACKER DRIVE, SUITE 1400 CHICAGO, IL 60601-3276 PHONE: (312) 713-1700 FAX: (312) 713-6900	DESIGNED - KAM DRAWN - NSA/OPS CHECKED - KCF DATE - 04/28/14	REVISED - REVISED - REVISED - REVISED -	STATE OF ILLINOIS DEPARTMENT OF TRANSPORTATION	PROPOSED PLAN AND PROFILE INTERIM RAMP SW TIE IN AT WB I-290	F.A.I. RTE. 90/94/290	SECTION 2013-010R	COUNTY COOK	TOTAL SHEETS 747	SHEET NO. 70	CONTRACT NO. 60W28	ILLINOIS FED. AID PROJECT
	USER NAME: j.pisano PLOT SCALE: 1/80,000 PLOT DATE: 5/26/2014	STA. 1300+87.42 TO STA. 1309+63.65	SCALE: 1"=50' SHEET 1 OF 1 SHEETS	STA. 1300+87.42 TO STA. 1309+63.65	ILLINOIS FED. AID PROJECT						