

LEGEND

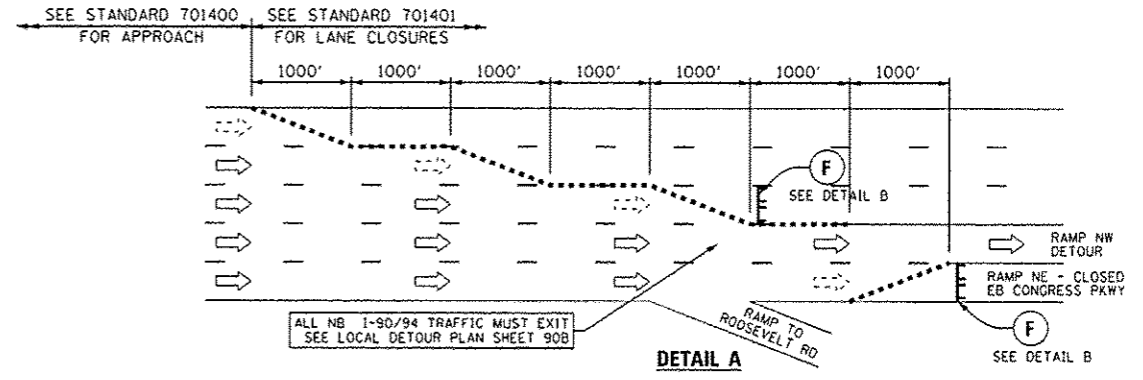

NB I-90/94 - 37TH ST TO CIRCLE INTERCHANGE CONT'D

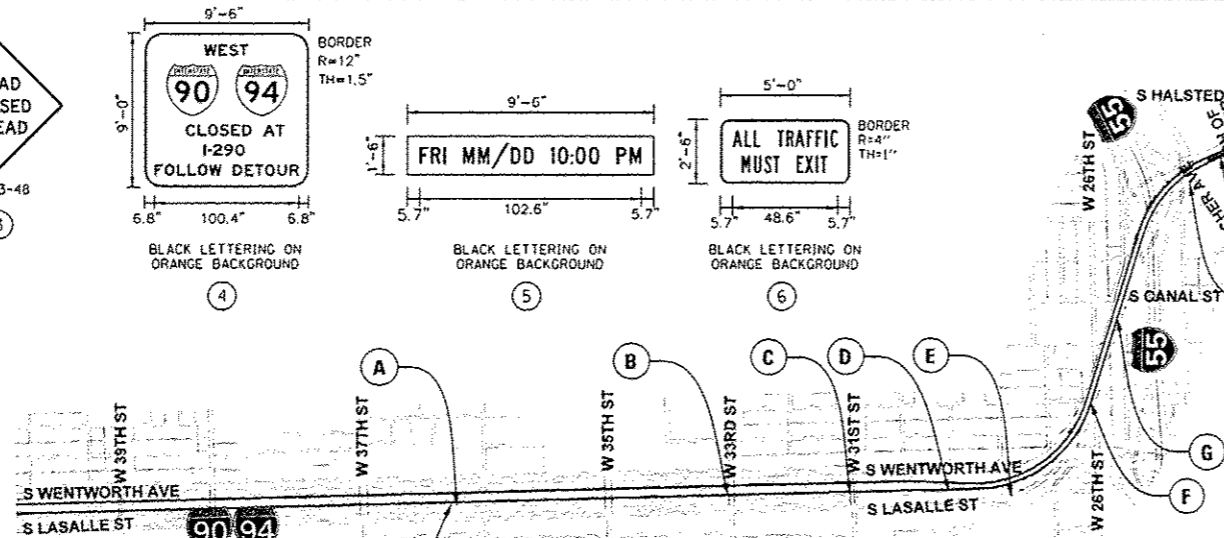
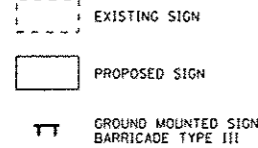
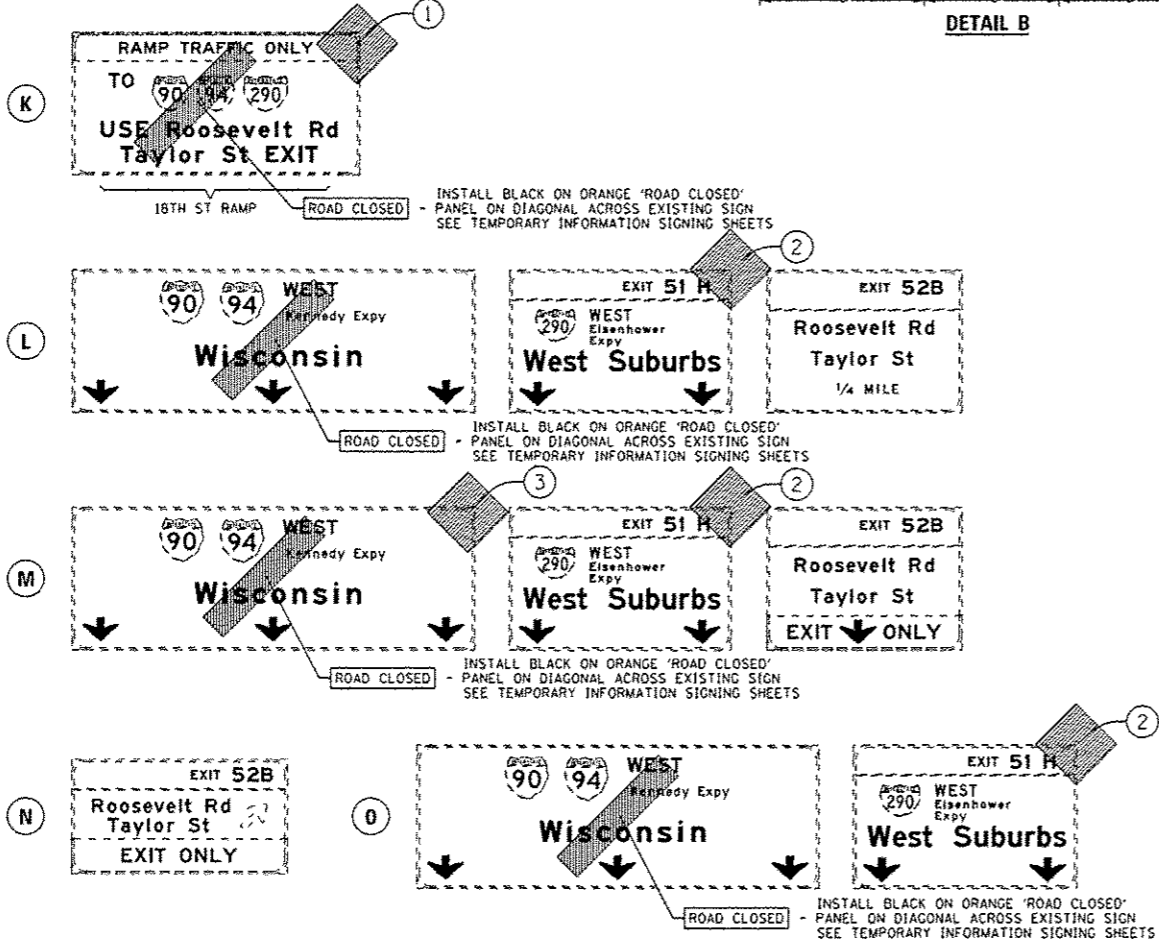

NB I-90/94 - 37TH ST TO CIRCLE INTERCHANGE CONT'D

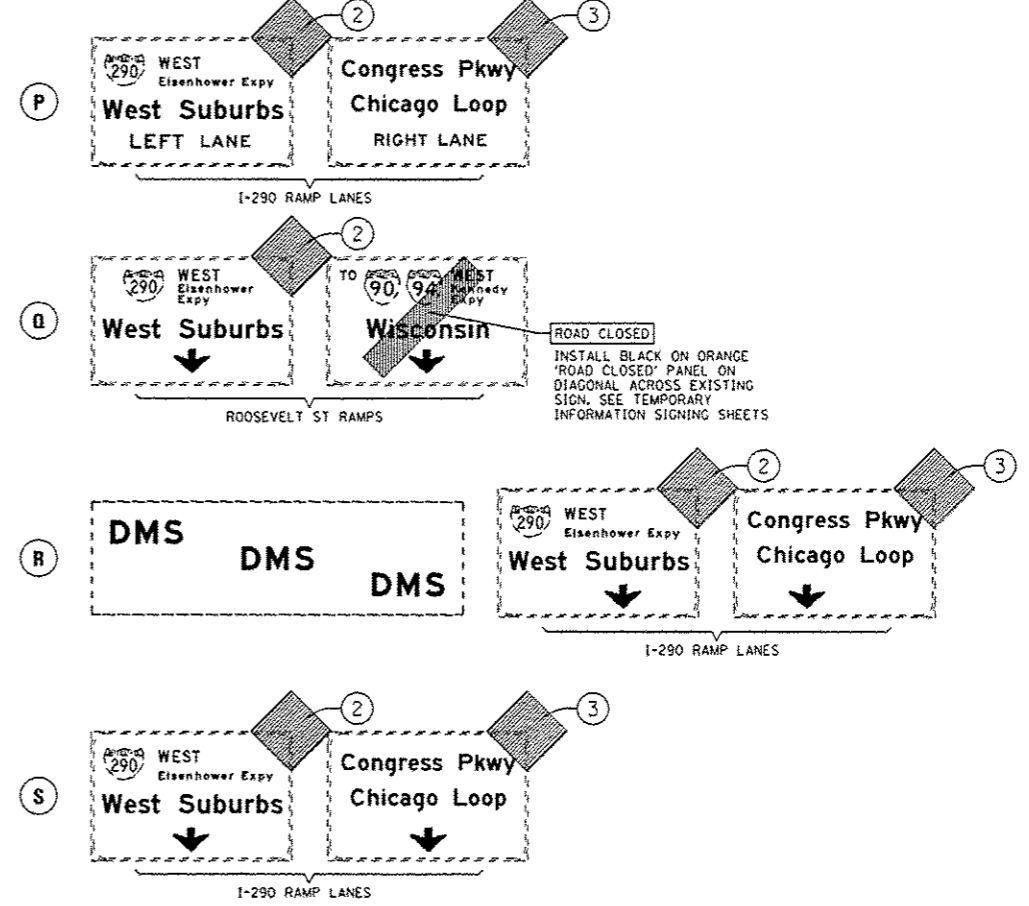

DESIGNED - OPS  
 DRAWN - PHP  
 CHECKED - KCF  
 DATE - 04/28/14

REVISED - 05/27/2014  
 REVISED -  
 REVISED -  
 REVISED -

STATE OF ILLINOIS  
 DEPARTMENT OF TRANSPORTATION

MAINLINE GIRDER ERECTION CLOSURES  
 TEMPORARY SIGNING PLAN - NB I-90/94

SCALE: 1" = 1000' SHEET 5 OF 8 SHEETS STA. TO STA.

|                           |           |        |              |           |
|---------------------------|-----------|--------|--------------|-----------|
| F.A.I. RTE.               | SECTION   | COUNTY | TOTAL SHEETS | SHEET NO. |
| 90/94/290                 | 2013-010R | COOK   | 747          | 988E      |
| CONTRACT NO. 60W28        |           |        |              |           |
| ILLINOIS FED. AID PROJECT |           |        |              |           |