

DETAIL "A"
CONCRETE BARRIER AT PIER 12
 N.T.S.

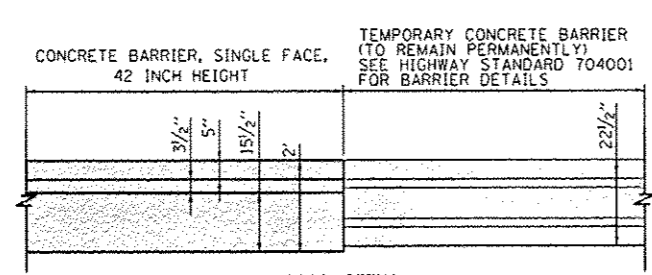

PLAN VIEW
 N.T.S.
 CONCRETE BARRIER, SINGLE FACE,
 42 INCH HEIGHT
 AT INTERIM RAMP SW AND WB I-290

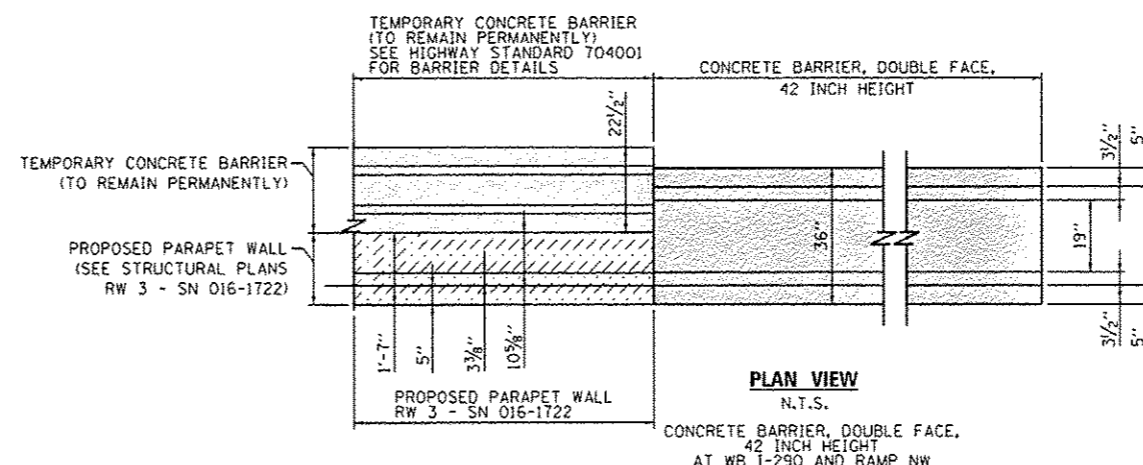

PLAN VIEW
 N.T.S.
 CONCRETE BARRIER, DOUBLE FACE,
 42 INCH HEIGHT
 AT WB I-290 AND RAMP NW

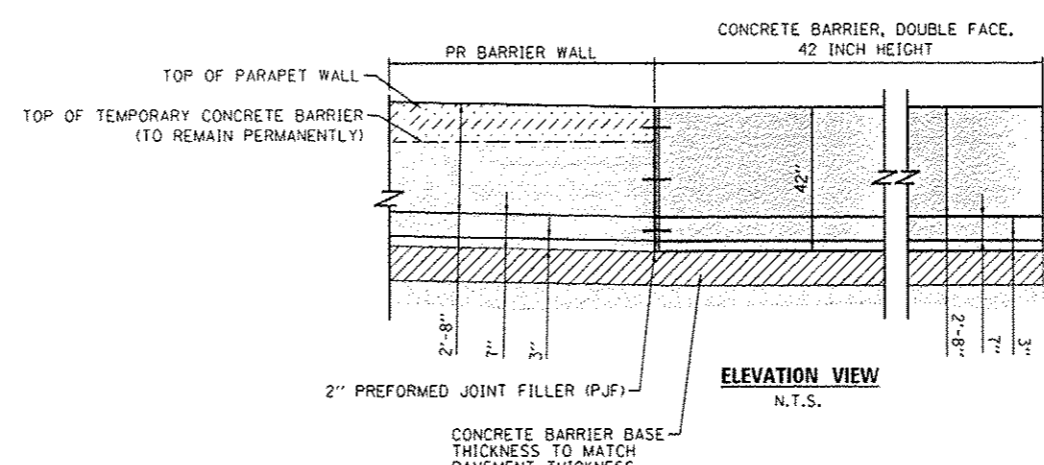

ELEVATION VIEW
 N.T.S.
 CONCRETE BARRIER BASE
 THICKNESS TO MATCH
 PAVEMENT THICKNESS

• FOR SECTIONS A-A, B-B, AND C-C SEE ROADWAY DETAILS - CONCRETE BARRIER AT PIER 12 AND TIE IN AT WB I-290 SHEET 644N.

- NOTES:**
1. EXPANSION JOINTS SHOWN ON THIS DRAWING SHALL BE PREFORMED JOINT MATERIAL (BITUMINOUS TYPE) FILLER AND SHALL MEET AASHTO DESIGNATION M-33.
 2. ALL WORK AND MATERIALS DETAILED HEREIN SHALL BE INCLUDED IN THE COST OF THE VARIOUS CONCRETE BARRIER PAY ITEMS UNLESS OTHERWISE NOTED.
 3. PREFORMED JOINT FILLER SHALL BE INCLUDED IN THE COST OF OF CONCRETE BARRIER OR CONCRETE BARRIER TRANSITION.
 4. JOINTS SHALL BE CONSTRUCTED AS SHOWN ON THE PLANS AND IN ACCORDANCE WITH ARTICLE 637.08 OF THE STANDARD SPECIFICATIONS
 5. TWO VERTICAL EPOXY COATED, NO. 8 TIE BARS, 10" LONG, SHALL BE PLACED STAGGERED FRONT TO BACK OF THE BARRIER WALL AT 48" CENTERS ALONG THE CONCRETE BARRIER TRANSITION. TIE BARS SHALL BE INCLUDED IN THE COST OF CONCRETE BARRIER TRANSITION.
 6. HORIZONTAL TIE BARS SHALL BE NO. 6 EPOXY COATED, 24" LONG, 24" C-C AND SHALL BE INCLUDED IN THE COST OF THE BARRIER BASE. HORIZONTAL TIE BARS ARE REQUIRED WHEN PAVEMENT IS PCC.
 7. EXPANSION JOINTS SHALL BE CONSTRUCTED IN BARRIER WALL AT MAXIMUM JOINT SPACING OF 90 FEET AND AS SHOWN ON THE PLANS.
 8. VERTICAL TIE BARS ARE REQUIRED WHEN CONCRETE BARRIER AND CONCRETE BARRIER BASE ARE NOT POURED MONOLITHICALLY.



D:\68428-shr-Detail-09A.dgn
 USER NAME: alirezah
 PLOT SCALE: 1/4" = 10'-0"
 PLOT DATE: 5/27/2014

DESIGNED - NSA/OPS
 DRAWN - NSA/OPS
 CHECKED - DBM
 DATE - 04/28/14

REVISED - 5/27/2014
 REVISED -
 REVISED -
 REVISED -

STATE OF ILLINOIS
 DEPARTMENT OF TRANSPORTATION

ROADWAY DETAILS - CONCRETE BARRIER AT PIER 12 AND
 TIE IN AT WB I-290
 SCALE: N.T.S. SHEET 1 OF 2 SHEETS STA. TO STA.

F.A.I. RTE. 90/94/290	SECTION 2013-010R	COUNTY COOK	TOTAL SHEETS 147	SHEET NO. 644M
CONTRACT NO. 60W28				ILLINOIS FED. AID PROJECT