

NOTES:

EXISTING UTILITIES SHOWN ARE FOR LATERAL REFERENCE ONLY. THE CONTRACTOR IS RESPONSIBLE FOR IDENTIFYING ALL EXISTING SEWERS AND UTILITIES PRIOR TO CONSTRUCTION. THE CONTRACTOR SHALL REFER TO THE UTILITY LOCATION PLANS FOR ADDITIONAL UTILITY INFORMATION.

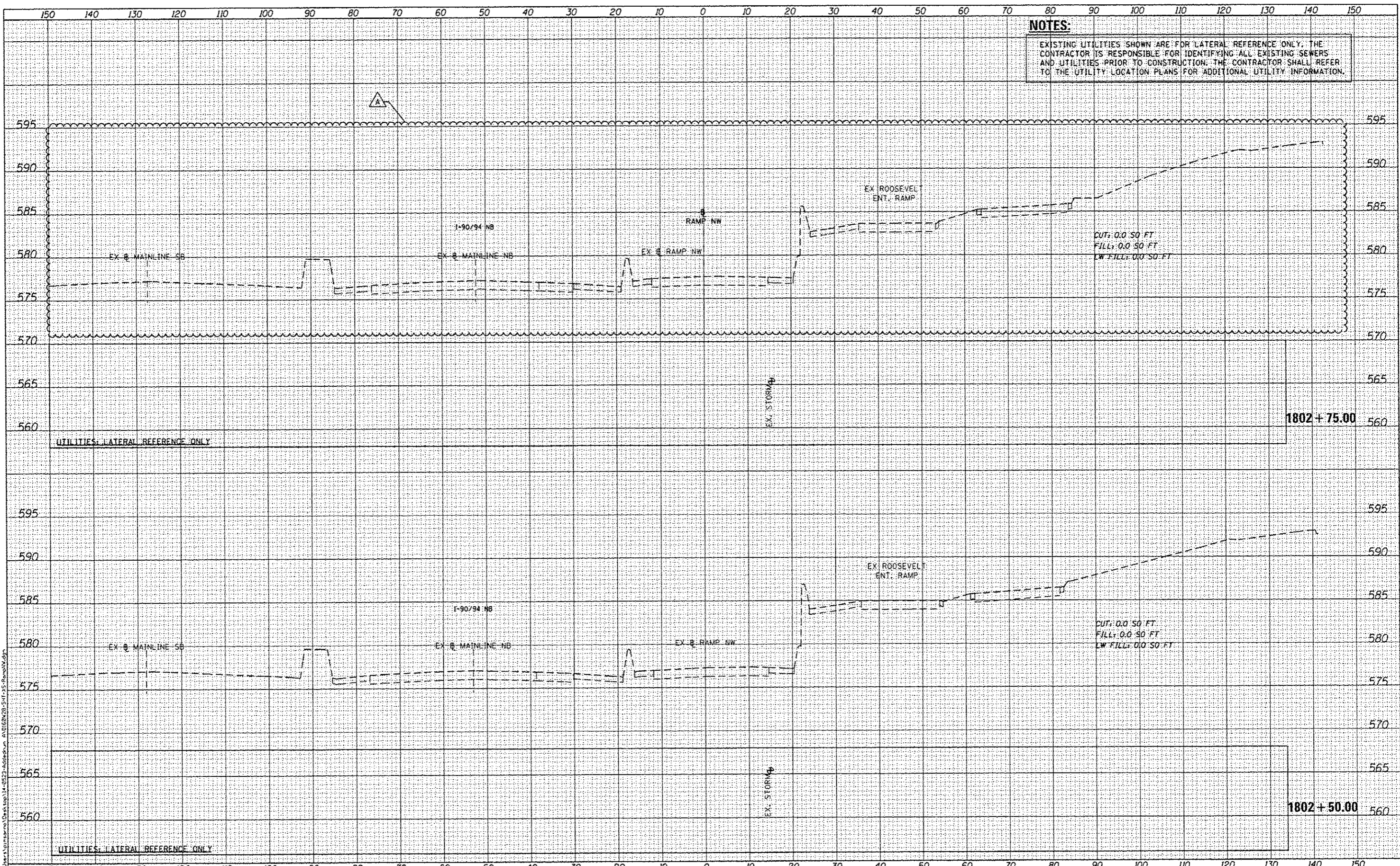

DATE	
BY	
REVISION	
NO.	
DATE	
BY	
REVISION	
NO.	

DATE	
BY	
REVISION	
NO.	
DATE	
BY	
REVISION	
NO.	



DESIGNED - KAM
 DRAWN - KAM
 CHECKED - KCF
 DATE - 04/28/14

REVISOR - [Symbol] 5/27/2014
 REVISION -
 REVISION -
 REVISION -

**STATE OF ILLINOIS
 DEPARTMENT OF TRANSPORTATION**

**CROSS SECTIONS
 RAMP NW**

SCALE: 1/5"=1'10" SHEET 01 OF 51 SHEETS STA. 1802+50.00 TO STA. 1802+75.00

F.A.I. RTE.	SECTION	COUNTY	TOTAL SHEETS	SHEET NO.
90/94/290	2013-010R	COOK	147	646
CONTRACT NO. 60W28			ILLINOIS FED. AID PROJECT	

FILE PATH: C:\Users\kajam\Documents\Drawings\14-0572-Subarea\A1018020-541-05-RampNW.dgn