

NOTES:

EXISTING UTILITIES SHOWN ARE FOR LATERAL REFERENCE ONLY. THE CONTRACTOR IS RESPONSIBLE FOR IDENTIFYING ALL EXISTING SEWERS AND UTILITIES PRIOR TO CONSTRUCTION. THE CONTRACTOR SHALL REFER TO THE UTILITY LOCATION PLANS FOR ADDITIONAL UTILITY INFORMATION.

SEE GRADING PLAN FOR ADDITIONAL INFIELD GRADING INFORMATION AROUND STRUCTURAL ELEMENTS.

DATE	
BY	
FINI	
SURVEY	
NOTE BOOK	
NO.	

DATE	
BY	
ORIGINAL	
SURVEY	
NOTE BOOK	
NO.	

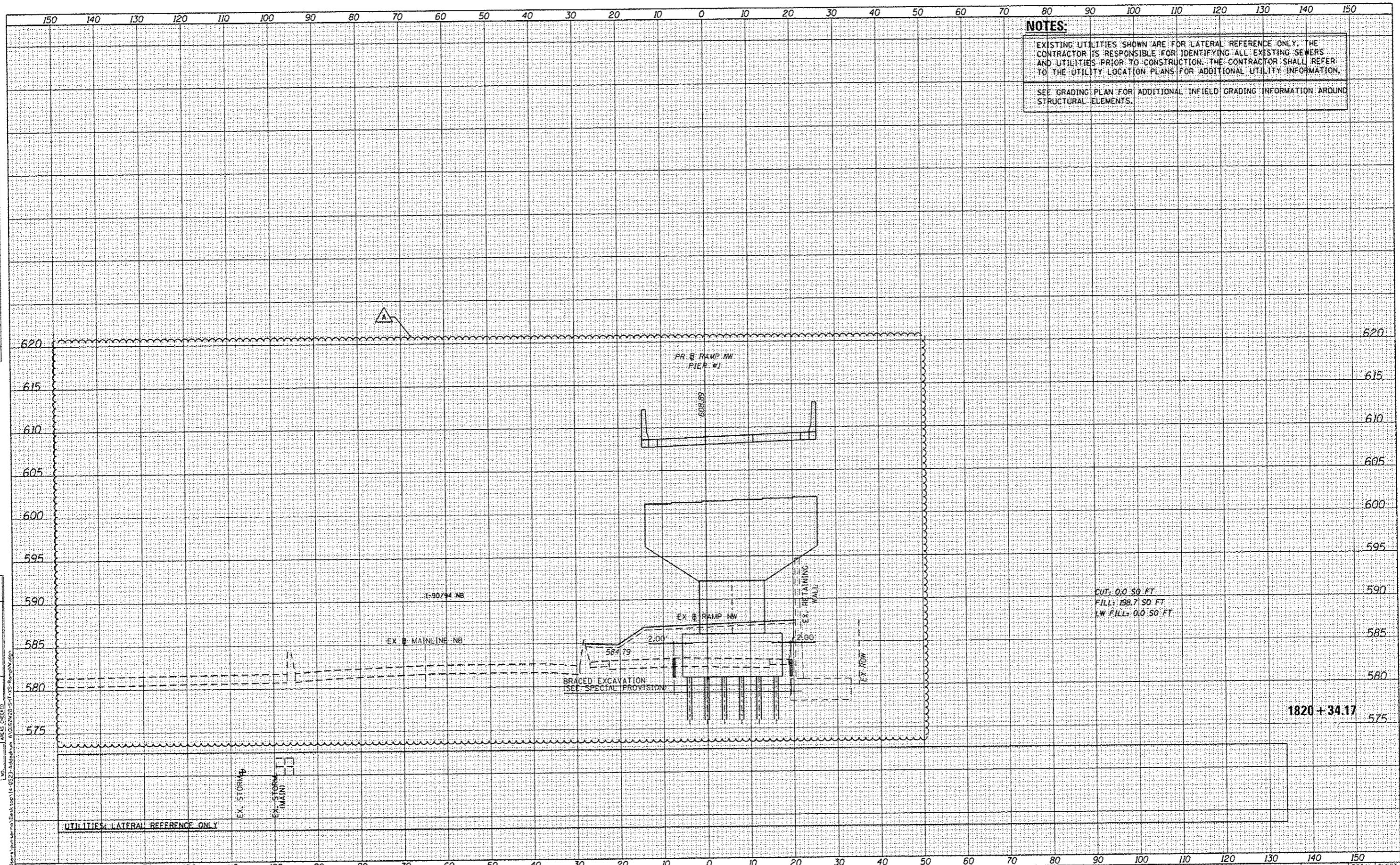

CUT: 0.0 SO FT
 FILL: 198.7 SO FT
 LW FILL: 0.0 SO FT

1820+34.17



DESIGNED - KAM	REVISED - 5/27/2014
DRAWN - KAM	REVISED -
CHECKED - KCF	REVISED -
DATE - 04/28/14	REVISED -

STATE OF ILLINOIS
 DEPARTMENT OF TRANSPORTATION

CROSS SECTIONS	
RAMP NW	
SCALE: 1:5V:1:0H	SHEET 23 OF 51 SHEETS
STA. 1820+34.17 TO STA. 1820+34.17	

F.A.I. RTE.	SECTION	COUNTY	TOTAL SHEETS	SHEET NO.
90/94/290	2013-010R	COOK	747	668
CONTRACT NO. 60W28			ILLINOIS FED. AID PROJECT	

FILE PATH: C:\Users\pmsorho\Desktop\14-0527-Addendum\04\1820W28-S41-XS-RampNW.dgn