

DATE	
BY	
APPROVED	
SURVEY	
PLotted	
NOTE BOOK	
NO.	

DATE	
BY	
APPROVED	
SURVEY	
PLotted	
NOTE BOOK	
NO.	

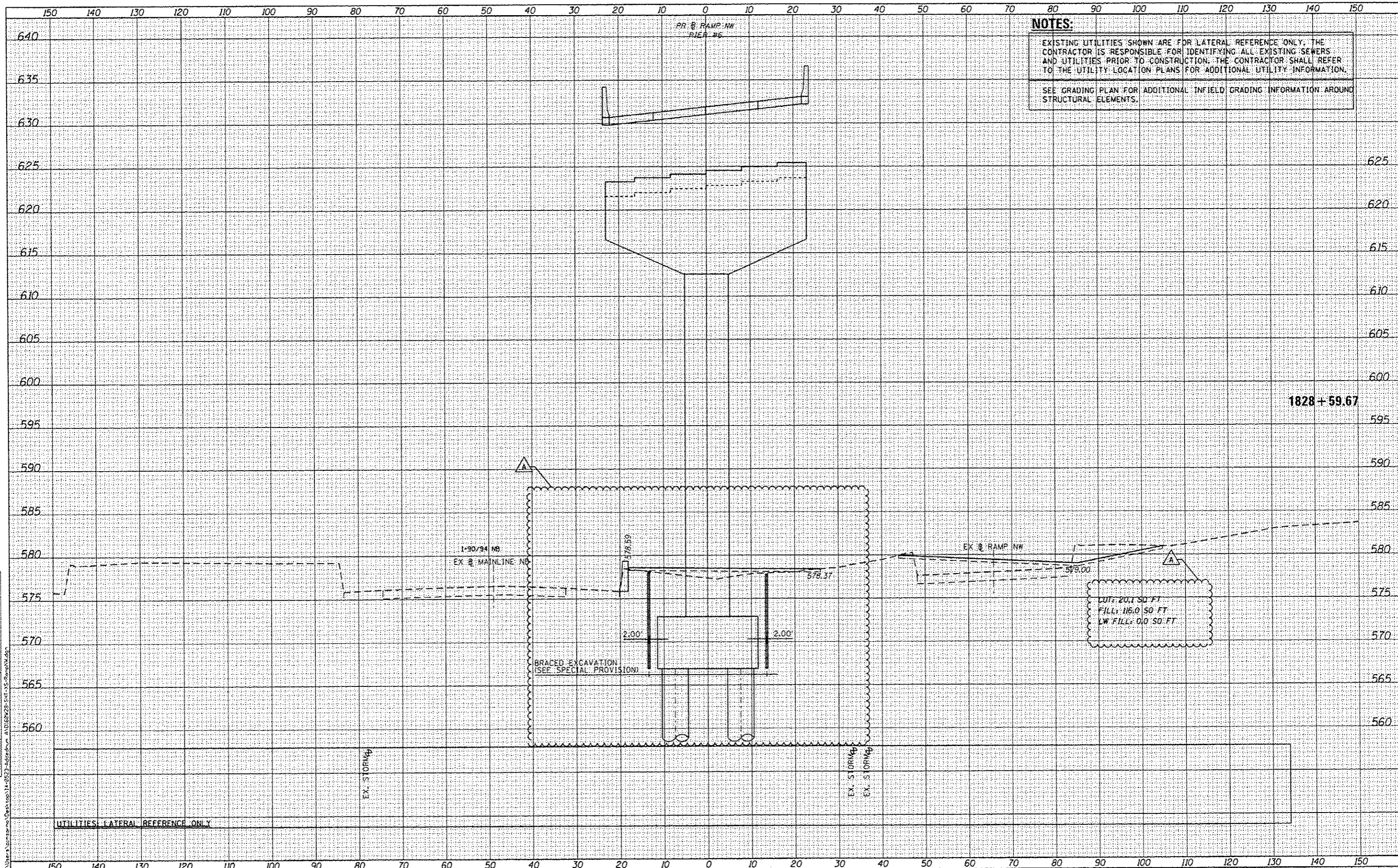

NOTES:
 EXISTING UTILITIES SHOWN ARE FOR LATERAL REFERENCE ONLY. THE CONTRACTOR IS RESPONSIBLE FOR IDENTIFYING ALL EXISTING SEWERS AND UTILITIES PRIOR TO CONSTRUCTION. THE CONTRACTOR SHALL REFER TO THE UTILITY LOCATION PLANS FOR ADDITIONAL UTILITY INFORMATION.
 SEE GRADING PLAN FOR ADDITIONAL INFIELD GRADING INFORMATION AROUND STRUCTURAL ELEMENTS.

FILE PATH: C:\Users\jamesr\OneDrive\Documents\1828+59.67\1828+59.67-RampNW.dwg
 A:\0168W28-SHT-XS-RampNW.dwg



0168W28-SHT-XS-RampNW.dwg
 USER NAME: jmsarno
 PLOT SCALE: 20.0000' / in.
 PLOT DATE: 5/23/2014

DESIGNED	- KAM	REVISED	- 5/27/2014
DRAWN	- KAM	REVISED	-
CHECKED	- KCF	REVISED	-
DATE	- 04/28/14	REVISED	-

STATE OF ILLINOIS
 DEPARTMENT OF TRANSPORTATION

CROSS SECTIONS
RAMP NW
 SCALE: 1:5V, 1:10H SHEET 29 OF 51 SHEETS STA. 1828+59.67 TO STA. 1828+59.67

F.A.I. RTE.	SECTION	COUNTY	TOTAL SHEETS	SHEET NO.
90/94/290	2013-010R	COOK	747	674
CONTRACT NO. 60W28			ILLINOIS FED. AID PROJECT	