

NOTES:

EXISTING UTILITIES SHOWN ARE FOR LATERAL REFERENCE ONLY. THE CONTRACTOR IS RESPONSIBLE FOR IDENTIFYING ALL EXISTING SEWERS AND UTILITIES PRIOR TO CONSTRUCTION. THE CONTRACTOR SHALL REFER TO THE UTILITY LOCATION PLANS FOR ADDITIONAL UTILITY INFORMATION.

DATE	
BY	
REVISIONS	
NO.	
DATE	
BY	
REVISIONS	
NO.	
DATE	
BY	
REVISIONS	
NO.	

DATE	
BY	
REVISIONS	
NO.	
DATE	
BY	
REVISIONS	
NO.	
DATE	
BY	
REVISIONS	
NO.	

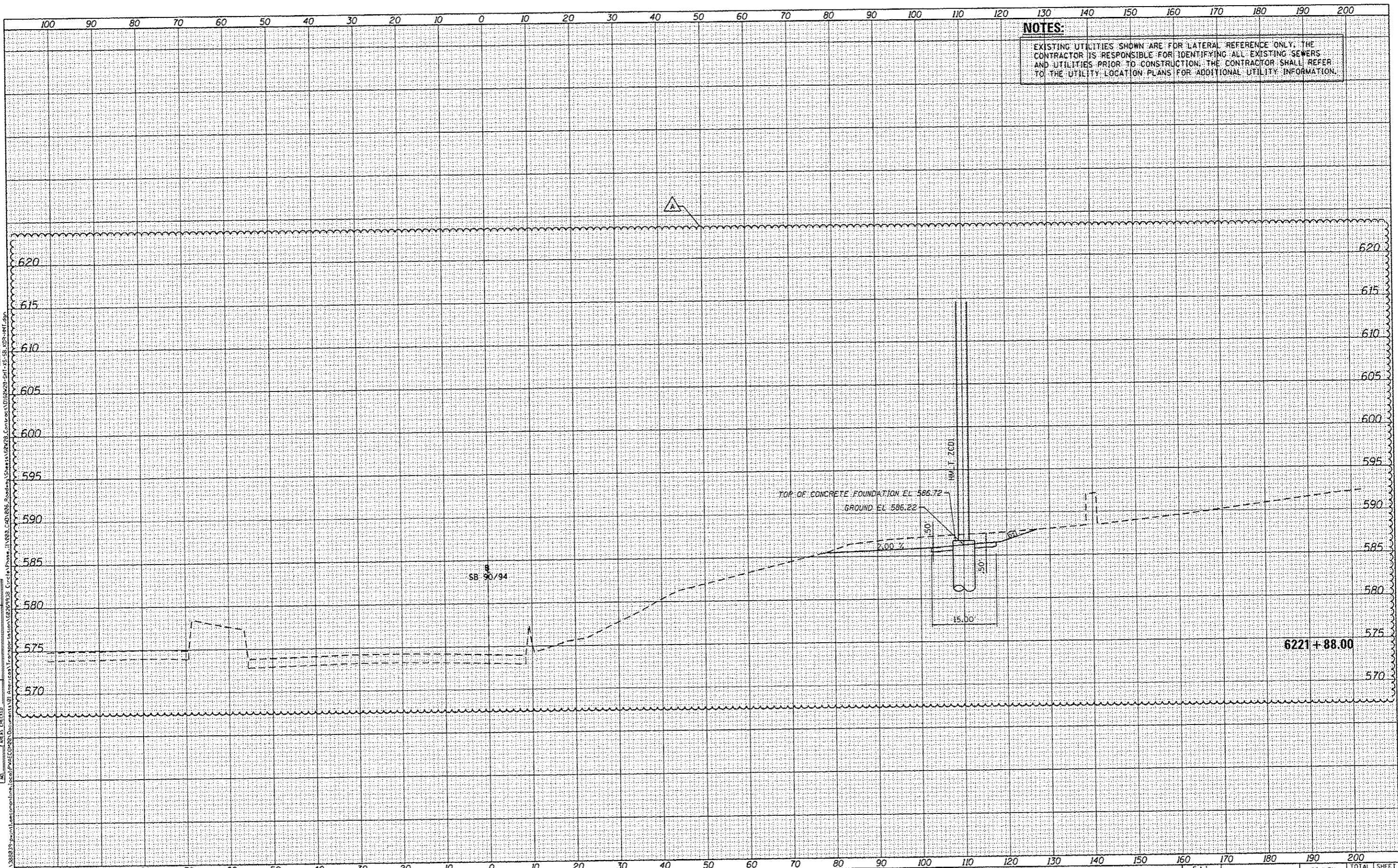

DESIGNED - NWM / AJP	REVISED - 5/27/2014
DRAWN - NWM / AJP	REVISED -
CHECKED - KAM	REVISED -
DATE - 04/28/14	REVISED -

**STATE OF ILLINOIS
DEPARTMENT OF TRANSPORTATION**

CROSS SECTIONS	
SB I-9094 HIGH MASS LIGHT TOWER	
SCALE: 1/5"=1'-0"	SHEET 1 OF 1 SHEETS
STA. 6221+88.00 TO STA. 6221+88.00	

F.A.I. RITE	SECTION	COUNTY	TOTAL SHEETS	SHEET NO.
90/94/290	2013-D10R	COOK	747	747
CONTRACT NO. 60W28				
ILLINOIS FED. AID PROJECT				