

**NOTES:**

EXISTING UTILITIES SHOWN ARE FOR LATERAL REFERENCE ONLY. THE CONTRACTOR IS RESPONSIBLE FOR IDENTIFYING ALL EXISTING SEWERS AND UTILITIES PRIOR TO CONSTRUCTION. THE CONTRACTOR SHALL REFER TO THE UTILITY LOCATION PLANS FOR ADDITIONAL UTILITY INFORMATION.

DATE	
BY	
DESIGNED	
DRAWN	
CHECKED	
DATE	
BY	
DESIGNED	
DRAWN	
CHECKED	
DATE	
BY	
DESIGNED	
DRAWN	
CHECKED	
DATE	
BY	
DESIGNED	
DRAWN	
CHECKED	
DATE	

DATE	
BY	
DESIGNED	
DRAWN	
CHECKED	
DATE	
BY	
DESIGNED	
DRAWN	
CHECKED	
DATE	
BY	
DESIGNED	
DRAWN	
CHECKED	
DATE	
BY	
DESIGNED	
DRAWN	
CHECKED	
DATE	

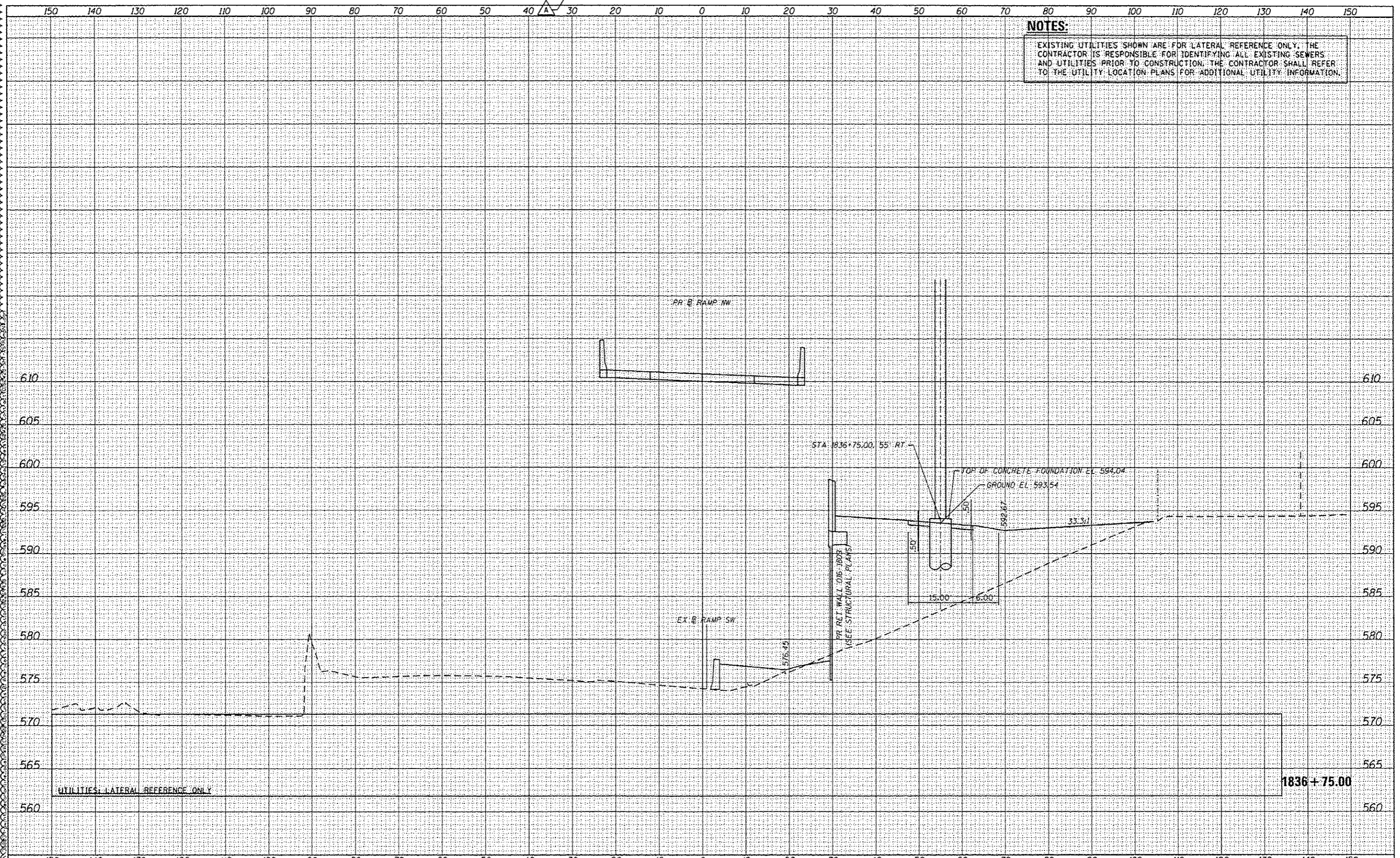

DIBBP28-5111-K5-flanctid.dgn  
 USER NAME = augeungh  
 PLOT SCALE = 10.0000" / 1"  
 PLOT DATE = 5/29/2014

DESIGNED - KAM	REVISED - 5/27/2014
DRAWN - KAM	REVISED -
CHECKED - KCF	REVISED -
DATE - 04/28/14	REVISED -

**STATE OF ILLINOIS  
 DEPARTMENT OF TRANSPORTATION**

**CROSS SECTIONS  
 RAMP NW HIGH MASS LIGHT TOWER**

SCALE: 1/8"=1'-0" SHEET 51A OF 51 SHEETS STA. 1836+75.00 TO STA. 1836+75.00

F.A.I. RTE. 90/94/290	SECTION 2013-010R	COUNTY COOK	TOTAL SHEETS 747	SHEET NO. 747A
CONTRACT NO. 60W28			ILLINOIS FED. AID PROJECT	