

FILE PATH = p:\388035-p\m\1\esc\com\1\m\1\AECD\000\Documents\01_Americas\Transportation\62629938_Circle\Phase_1\1000_CAD\005_Roadway\Sheets\60W28-sht-Drain-03

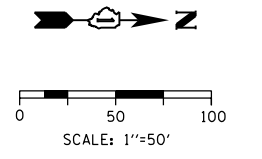

EXISTING

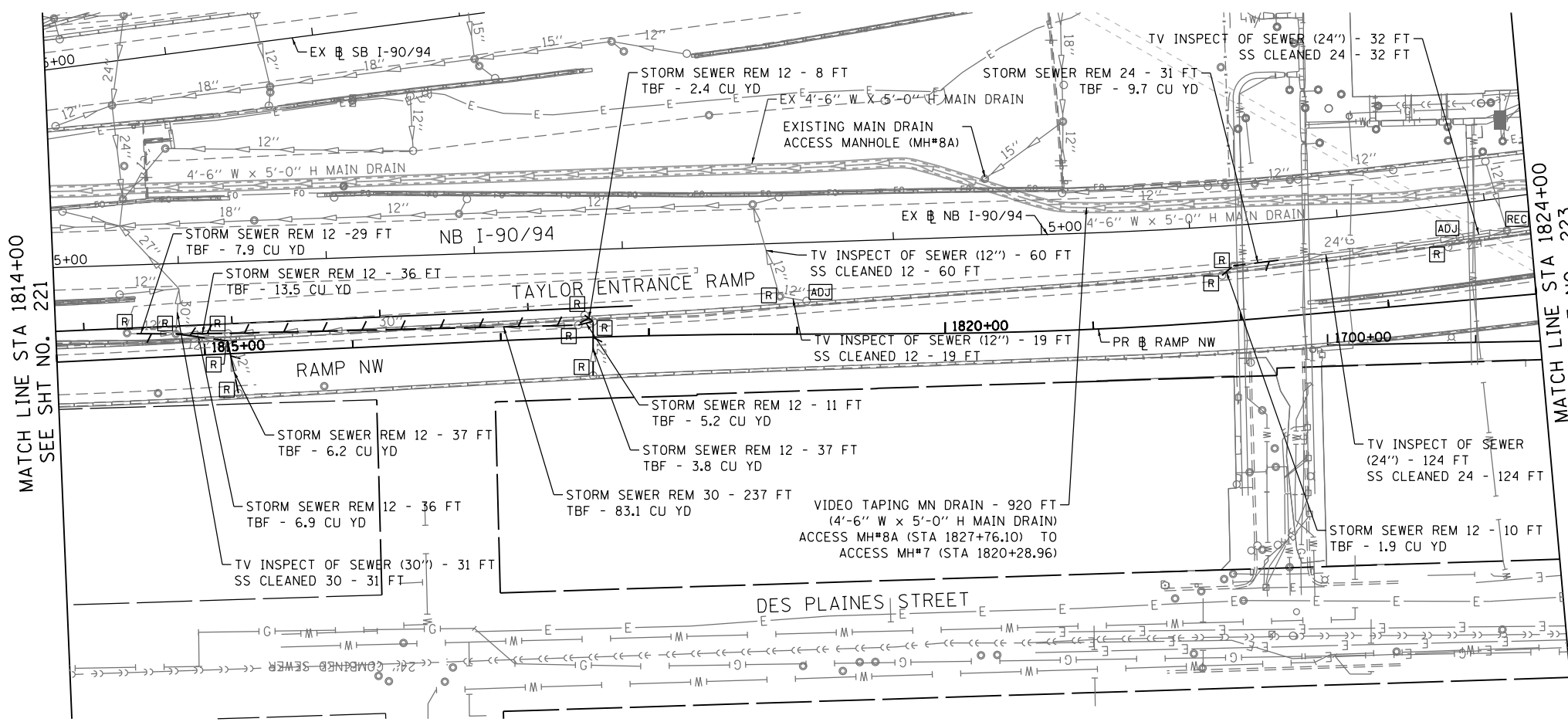
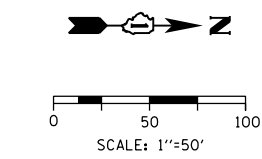
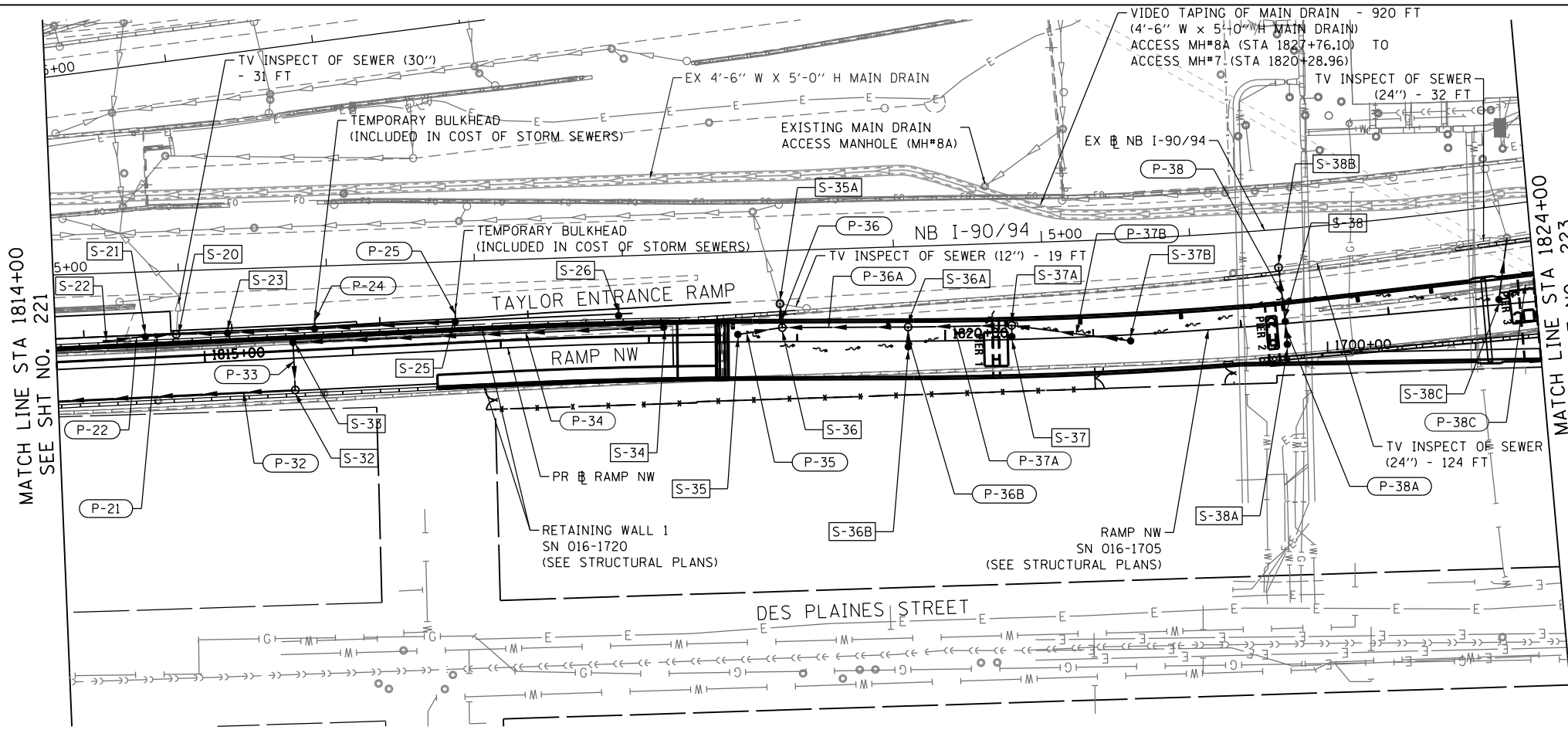

- NOTES**
1. SEE RAMP NW (SN 016-1705) STRUCTURAL PLANS FOR DRAINAGE SCUPPER LOCATIONS.
 2. SEE GRADING PLAN FOR LOW POINTS UNDER RAMP NW FLYOVER.

PROPOSED



D160W28-sht-Drain-03
 USER NAME = chiue
 PLOT SCALE = 100.0000' / in.
 PLOT DATE = 4/28/2014

DESIGNED -	DMS/ AFC	REVISED -	
DRAWN -	DMS/ AFC	REVISED -	
CHECKED -	E E Y	REVISED -	
DATE -	4/28/2014	REVISED -	

**STATE OF ILLINOIS
 DEPARTMENT OF TRANSPORTATION**

**DRAINAGE AND UTILITY PLAN
 RAMP NW**

SCALE: 1" = 50' SHEET 3 OF 6 SHEETS STA. 1814+00 TO STA. 1824+00

F.A.I. RTE.	SECTION	COUNTY	TOTAL SHEETS	SHEET NO.
90/94/290	2013-010R	COOK	747	222
CONTRACT NO. 60W28				
ILLINOIS FED. AID PROJECT				