

FOR INFORMATION ONLY

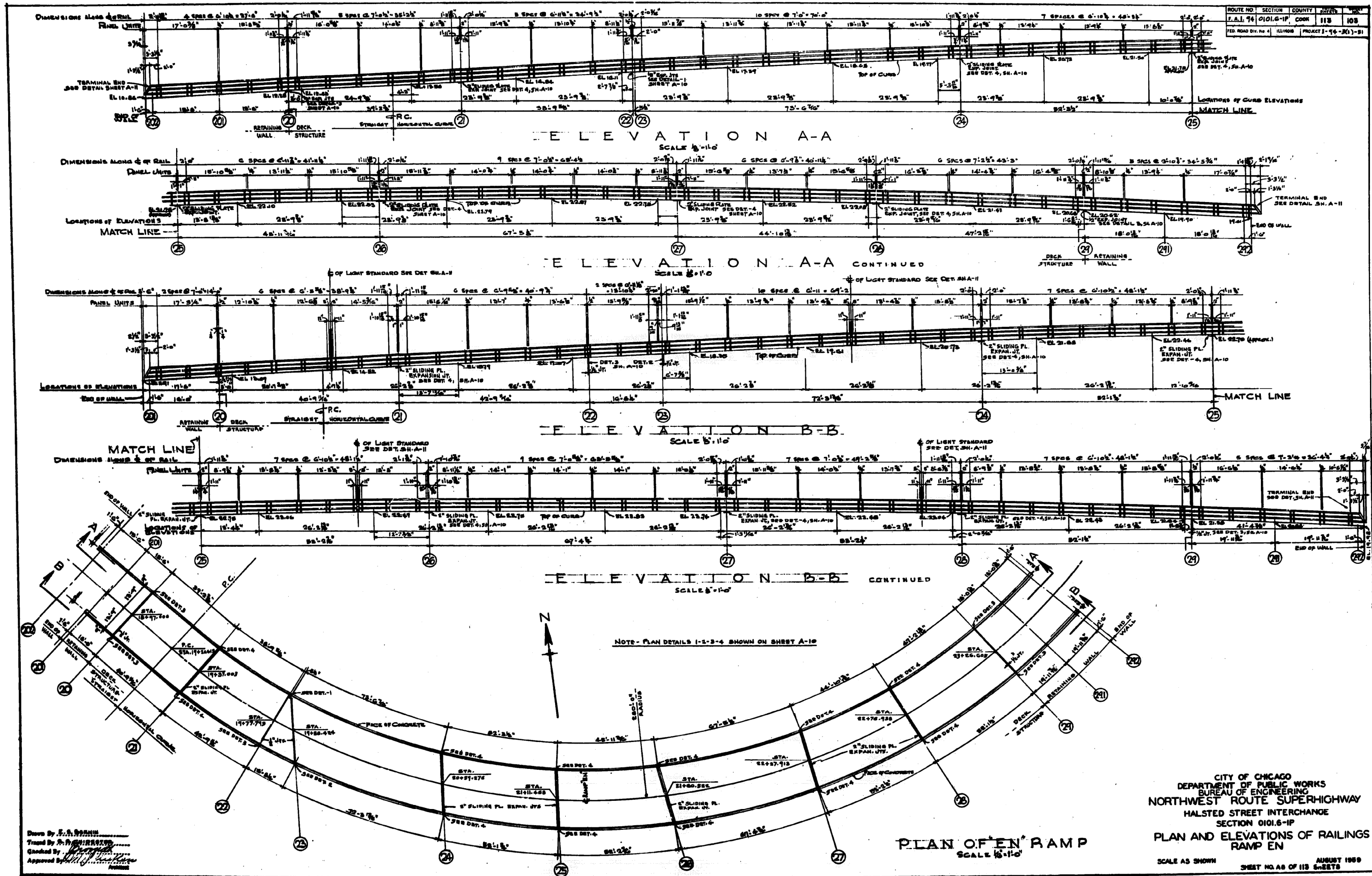

Drawn By: F.S. STERN
Traced By: J. J. HARRISON
Checked By: J. J. HARRISON
Approved By: J. J. HARRISON

CITY OF CHICAGO
DEPARTMENT OF PUBLIC WORKS
BUREAU OF ENGINEERING
NORTHWEST ROUTE SUPERHIGHWAY
HALSTED STREET INTERCHANGE
SECTION 0101.6-1P
PLAN AND ELEVATIONS OF RAILINGS
RAMP EN
SCALE AS SHOWN SHEET NO. 48 OF 118 SHEETS AUGUST 1989

FILE PATH = C:\Projects\14-0425 - 60W28 - 60W28 - 60W28 - sht-AS-BUILT-44.dgn



D160W28-sht-AS-BUILT-44.dgn
USER NAME = ayeungh
PLOT SCALE = 1.0000 / in.
PLOT DATE = 4/25/2014

DESIGNED -	REVISED -
DRAWN -	REVISED -
CHECKED -	REVISED -
DATE - 04/28/14	REVISED -

STATE OF ILLINOIS
DEPARTMENT OF TRANSPORTATION

EXISTING AS-BUILTS
SN 016-2449 & SN 016-2451

SCALE: NTS SHEET 44 OF 48 SHEETS STA. TO STA.

F.A.I. RTE.	SECTION	COUNTY	TOTAL SHEETS	SHEET NO.
90/94/290	2013-010R	COOK	747	514
CONTRACT NO. 60W28				
ILLINOIS FED. AID PROJECT				