

STATE OF ILLINOIS
DEPARTMENT OF TRANSPORTATION
DIVISION OF HIGHWAYS
PROPOSED
HIGHWAY PLANS

F.A.P. RTE.	SECTION	COUNTY	TOTAL SHEETS	SHEET NO.
587	17,18)RS-2	LASALLE	22	1
		ILLINOIS	CONTRACT NO. 66D54	

INDEX OF SHEETS

- 1 COVER SHEET
- 2 GENERAL NOTES AND COMMITMENTS
- 3-5 SUMMARY OF QUANTITIES
- 6 TYPICAL SECTIONS
- 7-9 SCHEDULES
- 10-17 PLAN SHEETS
- 18-22 DETAILS

LIST OF ILLINOIS DOT HIGHWAY STANDARDS

- 000001-07 STANDARD SYMBOLS, ABBREVIATIONS AND PATTERNS
- 001006 DECIMAL OF AN INCH AND OF A FOOT
- 406201-01 MAILBOX TURNOUT
- 667101-02 PERMANENT SURVEY MARKERS
- 701011-04 OFF-ROAD MOVING OPERATIONS 2L 2W, DAY ONLY
- 701301-04 LANE CLOSURE, 2L, 2W, SHORT TIME OPERATIONS
- 701306-04 LANE CLOSURE, 2L, 2W, SLOW MOVING OPERATIONS DAY ONLY, FOR SPEEDS ≥ 45 MPH
- 701311-03 LANE CLOSURE, 2L, 2W, MOVING OPERATIONS - DAY ONLY
- 701901-08 TRAFFIC CONTROL DEVICES
- 780001-05 TYPICAL PAVEMENT MARKINGS
- 781001-04 TYPICAL APPLICATIONS RAISED REFLECTIVE PAVEMENT MARKERS

FAP ROUTE 587 (US 34)
SECTION (17,18)RS-2
PROJECT STP G1QI(411)
3P MILLING AND RESURFACING
LASALLE COUNTY

C-93-061-14

RAILROAD OMISSION
STA. 578 + 98 TO 579 + 08

BEGIN IMPROVEMENT
STA. 577 + 05

BRIDGE
SN 050-0039

BRIDGE
SN 050-0040

END IMPROVEMENT
STA. 908 + 39

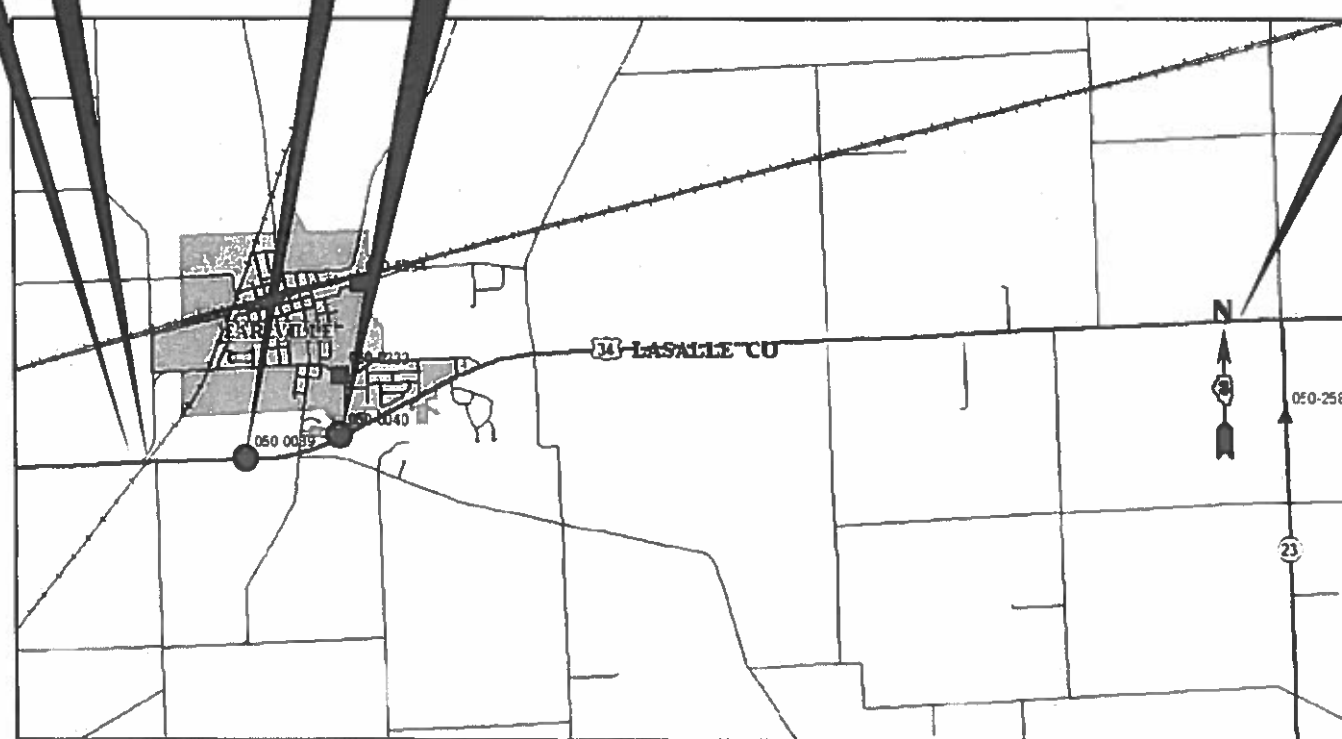

MICROFILMED _____
 REEL NUMBER _____
 AWARDED _____
 RESIDENT ENGINEER _____
 AS BUILT CHANGES WERE MADE
 ON THE FOLLOWING SHEETS _____

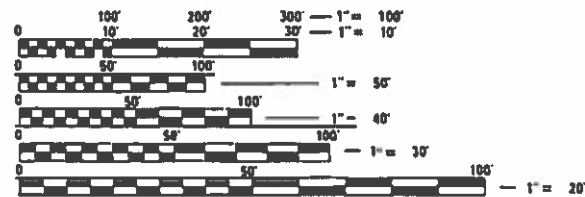

FULL SIZE PLANS HAVE BEEN PREPARED USING STANDARD ENGINEERING SCALES. REDUCED SIZED PLANS WILL NOT CONFORM TO STANDARD SCALES. IN MAKING MEASUREMENTS ON REDUCED PLANS, THE ABOVE SCALES MAY BE USED.

J.U.L.I.E.
 JOINT UTILITY LOCATION INFORMATION FOR EXCAVATION
 1-800-892-0123
 OR 811

PROJECT ENGINEER: BRAD DUNCAN, P.E.
UNIT CHIEF: LUIS CALDERON, P.E.
TOWNSHIPS: MERIDEN, EARL
CONTRACT NO. 66D54

GROSS LENGTH = 33,135 FT. = 6.28 MILES
 NET LENGTH = 33,045 FT. = 6.26 MILES



MINOR ARTERIAL (RURAL)
 2019 ADT=2600
 MU=4.8% SU=5.3% PV=89.9%

STATE OF ILLINOIS
 DEPARTMENT OF TRANSPORTATION
 DIVISION OF HIGHWAYS

SUBMITTED 05/24 2019
David P. Chaffin
 DEPUTY DIRECTOR OF HIGHWAYS, REGION ENGINEER

June 14 2019
E.A. Elk
 ENGINEER OF DESIGN AND ENVIRONMENT

June 10 2019
David P. Chaffin
 DIRECTOR OF HIGHWAYS PROJECT IMPLEMENTATION

PRINTED BY THE AUTHORITY
OF THE STATE OF ILLINOIS

GENERAL NOTES

THE THICKNESS OF HMA SHOWN ON THE PLANS IS THE NOMINAL THICKNESS. DEVIATIONS FROM THE NOMINAL THICKNESS WILL BE PERMITTED WHEN SUCH DEVIATIONS OCCUR DUE TO IRREGULARITIES IN THE EXISTING SURFACE OR BASE ON WHICH THE HMA IS PLACED.

THE HMA SURFACE OF ALL MAILBOX TURNOUTS, PRIVATE ENTRANCES, COMMERCIAL ENTRANCES, AND SIDE ROADS SHALL BE MADE NEATLY, IN A WORKMANLIKE MANNER, AND SHALL ACCURATELY CONFORM TO THE SHAPES AND DIMENSIONS SHOWN ON THE PLAN DETAILS. IF REQUIRED BY THE ENGINEER, THE CONTRACTOR SHALL SAW CUT THE HMA SURFACE TO CONFORM TO THE SHAPES AND DIMENSIONS SHOWN ON THE PLAN DETAILS. THIS WORK WILL BE INCLUDED IN THE COST OF THE HMA SURFACE.

EXCEPT AS NOTED ON THE PLANS, PAVEMENT GRADES SHOWN ARE AT THE TOP OF PAVEMENT SURFACES.

THE ENGINEER WILL BE THE SOLE JUDGE CONCERNING CURING TIME FOR THE VARIOUS HMA LIFTS.

FOR STABILIZATION, ALL TYPE III BARRICADES WILL REQUIRE A MINIMUM OF FOUR SAND BAGS PER BARRICADE.

SEEDING WILL NOT BE PERMITTED AT ANY TIME WHEN THE GROUND IS FROZEN, WET, OR IN AN UNTILLABLE CONDITION. LOCATIONS TO BE SEEDED WILL BE DETERMINED BY THE ENGINEER.

THE FINISHED EARTHWORK SHALL HAVE A VEGETATION SUSTAINING SOIL COVERING THE TOP FOUR INCHES (100 MILLIMETERS) IN AREAS TO BE SEEDED OR SODDED. THE VEGETATION SUSTAINING SOIL REQUIRED WILL NOT BE PAID FOR SEPARATELY BUT WILL BE INCLUDED IN THE COST OF FURNISHED EXCAVATION.

ALL EXCAVATED MATERIAL, WHICH INCLUDES DIGGING OR GRADING OF ANY SOIL OR FILL MATERIAL, WITH THE EXCEPTION OF AGGREGATE FILLS, MUST BE INCORPORATED WITHIN THE IDOT RIGHT OF WAY DUE TO ENVIRONMENTAL DOCUMENTATION REQUIREMENTS.

SHORT TERM PAVEMENT MARKING SHALL BE USED TO OUTLINE EXIT AND ENTRANCE RAMPS FOR THE PRIME COAT APPLICATION AND EACH RESURFACING LIFT.

ON EXISTING PAVEMENT WHICH MAY BE SUPERELEVATED, THE NEW HMA PAVEMENT SHALL BE BUILT WITH THE SAME SUPERELEVATION UNLESS NEW SUPERELEVATION RATES ARE GIVEN ON THE PLANS.

ALL ELEVATIONS REFERRING TO U.S.G.S. MEAN SEA LEVEL DATUM.

ANY REFERENCE TO A STANDARD IN THESE PLANS SHALL BE INTERPRETED TO MEAN THE EDITION AS INDICATED BY THE SUBNUMBER SHOWN IN THE LIST OF STANDARDS OR THE COPY INCLUDED IN THESE PLANS.

THE FOLLOWING RATES OF APPLICATION HAVE BEEN USED IN CALCULATING PLAN QUANTITIES:

GRANULAR MATERIALS	2.05	TONS / CU YD
HMA RESURFACING	112	LBS / SQ YD / IN
SHORT TERM PAVEMENT MARKING	10	FT /100 FT OF APPLICATION
MIX FOR CRACKS, JTS & FLGWYS	0.0003	TONS / SQ YD
LEVEL BINDER (HAND METHOD)	0.0005	TONS / SQ YD

THE CONTRACTOR SHALL CONTACT JULIE AT LEAST 48 HOURS PRIOR TO EXCAVATION TO DETERMINE WHICH UTILITIES ARE IN THE AREA.

COMMITMENTS

THE HMA SURFACE (PARTIAL) REMOVAL AND RESURFACING OPERATIONS OF STRUCTURES 050-0040 AND 050-0039 SHALL NOT DAMAGE THE EXISTING WATERPROOFING SYSTEM NOR ALTER THE EXISTING PROFILE. BEFORE OPERATIONS BEGIN, THE BRIDGE MAINTENANCE ENGINEER SHALL BE CONTACTED. DEPTH OF REMOVAL MAY BE ALTERED TO AVOID DAMAGING THE EXISTING WATERPROOFING SYSTEM IF FIELD CONDITIONS VARY OR IF BASED IN THE OPINION OF THE BRIDGE MAINTENANCE ENGINEER.

STATE OF ILLINOIS
DEPARTMENT OF TRANSPORTATION
DISTRICT THREE
AS BUILT INFORMATION

SUPERVISING CONSTRUCTION FIELD ENGINEER

RESIDENT ENGINEER / TECHNICIAN

START & END DATES
OF CONSTRUCTION:

INSPECTORS:

STATE OF ILLINOIS
DEPARTMENT OF TRANSPORTATION
DISTRICT THREE

PREPARED BY: Tom Beaud
DISTRICT STUDIES & PLANS ENGINEER

DATE: May 23, 2019

EXAMINED BY: Phyllis Vidya AH
DISTRICT CONSTRUCTION ENGINEER

Michael Short CR
DISTRICT MATERIALS ENGINEER

Tom Hufnagel JES
DISTRICT OPERATIONS ENGINEER

FILE NAME =	USER NAME = calderoni	DESIGNED -	REVISED -	STATE OF ILLINOIS DEPARTMENT OF TRANSPORTATION	GENERAL NOTES	F.A.P RTE.	SECTION	COUNTY	TOTAL SHEETS	SHEET NO.	
p:\planroom\dot\illinois.gov\PI1001\Docu	ents\1001\Offices\District 3\Projects\036605	ORIGIN	REVISED			587	(17,18)RS-2	LASALLE	22	2	
	PLOT SCALE = 100.0000' / in.	CHECKED -	REVISED -			CONTRACT NO. 66D54					
	PLOT DATE = 5/23/2019	DATE -	REVISED -			ILLINOIS FED. AID PROJECT					
						SCALE:	SHEET	OF	SHEETS	STA. TO STA.	

CONSTR. CODE
STP -RUR
80%FED- 20%STATE
ROADWAY
0005
RURAL

CODE NO.	ITEM	UNIT	TOTAL QUANTITY	
20400800	FURNISHED EXCAVATION	CU YD	40	40
40200800	AGGREGATE SURFACE COURSE, TYPE B	TON	115	115
40600290	BITUMINOUS MATERIALS (TACK COAT)	POUND	24729	24729
40600400	MIXTURE FOR CRACKS, JOINTS, AND FLANGEWAYS	TON	10	10
40600525	LEVELING BINDER (HAND METHOD), N50	TON	16	16
40600625	LEVELING BINDER (MACHINE METHOD), N50	TON	3554	3554
40600990	TEMPORARY RAMP	SQ YD	381	381
40603310	HOT-MIX ASPHALT SURFACE COURSE, MIX "C", N50	TON	3178	3178
40800050	INCIDENTAL HOT-MIX ASPHALT SURFACING	TON	516	516
44000155	HOT-MIX ASPHALT SURFACE REMOVAL, 1 1/2"	SQ YD	3656	3656
44000164	HOT-MIX ASPHALT SURFACE REMOVAL, 3 3/4"	SQ YD	31731	31731
48102100	AGGREGATE WEDGE SHOULDER, TYPE B	TON	2325	2325
* 66700205	PERMANENT SURVEY MARKERS, TYPE I	EACH	3	3
67100100	MOBILIZATION	L SUM	1	1

* SPECIALTY ITEM

FILE NAME =	USER NAME = calderoni	DESIGNED -	REVISED -
p:\planroom.dot.illinois.gov\PIDOT\Documents\IDOT Offices\District 3\Projects\0366054\0366054-shr-S00.dgn		DRAWN -	REVISED -
	PLOT SCALE = 100.0000' / in.	CHECKED -	REVISED -
	PLOT DATE = 5/24/2019	DATE -	REVISED -

**STATE OF ILLINOIS
DEPARTMENT OF TRANSPORTATION**

SUMMARY OF QUANTITIES

SCALE: SHEET NO. OF SHEETS STA. TO STA.

F.A.P. RTE.	SECTION	COUNTY	TOTAL SHEETS	SHEET NO.
587	(17,18)RS-2	LASALLE	22	3
ILLINOIS FED. AID PROJECT			CONTRACT NO. 66054	

CONSTR. CODE
STP -RUR
80%FED - 20%STATE
ROADWAY
0005
RURAL

CODE NO.	ITEM	UNIT	TOTAL QUANTITY	
70100460	TRAFFIC CONTROL AND PROTECTION, STANDARD 701306	L SUM	1	1
70300100	SHORT TERM PAVEMENT MARKING	FOOT	11093	11093
70300150	SHORT TERM PAVEMENT MARKING REMOVAL	SQ FT	2440	2440
70300210	TEMPORARY PAVEMENT MARKING LETTERS AND SYMBOLS	SQ FT	61	61
70300220	TEMPORARY PAVEMENT MARKING - LINE 4"	FOOT	71335	71335
70300240	TEMPORARY PAVEMENT MARKING - LINE 6"	FOOT	7936	7936
70300280	TEMPORARY PAVEMENT MARKING - LINE 24"	FOOT	298	298
* 78000100	THERMOPLASTIC PAVEMENT MARKING - LETTERS AND SYMBOLS	SQ FT	61	61
* 78000200	THERMOPLASTIC PAVEMENT MARKING - LINE 4"	FOOT	713	713
* 78000400	THERMOPLASTIC PAVEMENT MARKING - LINE 6"	FOOT	21	21
* 78000650	THERMOPLASTIC PAVEMENT MARKING - LINE 24"	FOOT	298	298
* 78001110	PAINT PAVEMENT MARKING - LINE 4"	FOOT	141444	141444
* 78001130	PAINT PAVEMENT MARKING - LINE 6"	FOOT	15830	15830
* 78100100	RAISED REFLECTIVE PAVEMENT MARKER	EACH	414	414

* SPECIALTY ITEM

FILE NAME =	USER NAME = calderoni	DESIGNED -	REVISED -
p:\planroom.dot.illinois.gov\PIDOT\Documents\IDOT Offices\District 3\Projects\0366054\Drawings\0366054-shr-S00.dgn		CHECKED -	REVISED -
		DATE -	REVISED -

**STATE OF ILLINOIS
DEPARTMENT OF TRANSPORTATION**

SUMMARY OF QUANTITIES

SCALE: SHEET NO. OF SHEETS STA. TO STA.

F.A.P. RTE.	SECTION	COUNTY	TOTAL SHEETS	SHEET NO.
587	(17,18)RS-2	LASALLE	22	4
ILLINOIS FED. AID PROJECT			CONTRACT NO. 66D54	

CODE NO.	ITEM	UNIT	TOTAL QUANTITY	CONSTR. CODE	
				STP - RUR	
				80%FED - 20%STATE	
				ROADWAY	
		0005		RURAL	
78300200	RAISED REFLECTIVE PAVEMENT MARKER REMOVAL	EACH	384	384	
X0327980	PAVEMENT MARKING REMOVAL - WATER BLASTING	SQ FT	28166	28166	
X4401198	HOT-MIX ASPHALT SURFACE REMOVAL, VARIABLE DEPTH	SQ YD	2490	2490	
Z0004556	HOT-MIX ASPHALT SURFACE REMOVAL (DECK)	SQ YD	1210	1210	
Z0030850	TEMPORARY INFORMATION SIGNING	SQ FT	42	42	
Z0033700	LONGITUDINAL JOINT SEALANT	FOOT	33031	33031	
∅ Z0076600	TRAINEES	HOUR	2000	2000	
Z0034105	MATERIAL TRANSFER DEVICE	TON	6664	6664	
∅ Z0076604	TRAINEES - TRAINING PROGRAM GRADUATE	HOUR	2000	2000	
Z0048665	RAILROAD PROTECTIVE LIABILITY INSURANCE	L SUM	1	1	

* SPECIALTY ITEM

∅ 0042

FILE NAME =	USER NAME = calderoni	DESIGNED -	REVISED -	STATE OF ILLINOIS DEPARTMENT OF TRANSPORTATION	SUMMARY OF QUANTITIES	F.A.P. RTE.	SECTION	COUNTY	TOTAL SHEETS	SHEET NO.
pw\planroom.dot.illinois.gov\PIDOT\Documents\DOT Offices\District 3\Projects\0366054\Drawings\0366054-shr-S00.dgn	DRAWN -	REVISED -	587			(17,18)RS-2	LASALLE	22	5	
PLOT SCALE = 100.0000' / in.	CHECKED -	REVISED -	CONTRACT NO. 66D54							
PLOT DATE = 5/24/2019	DATE -	REVISED -	ILLINOIS FED. AID PROJECT							
				SCALE:	SHEET NO. OF SHEETS	STA. TO STA.				

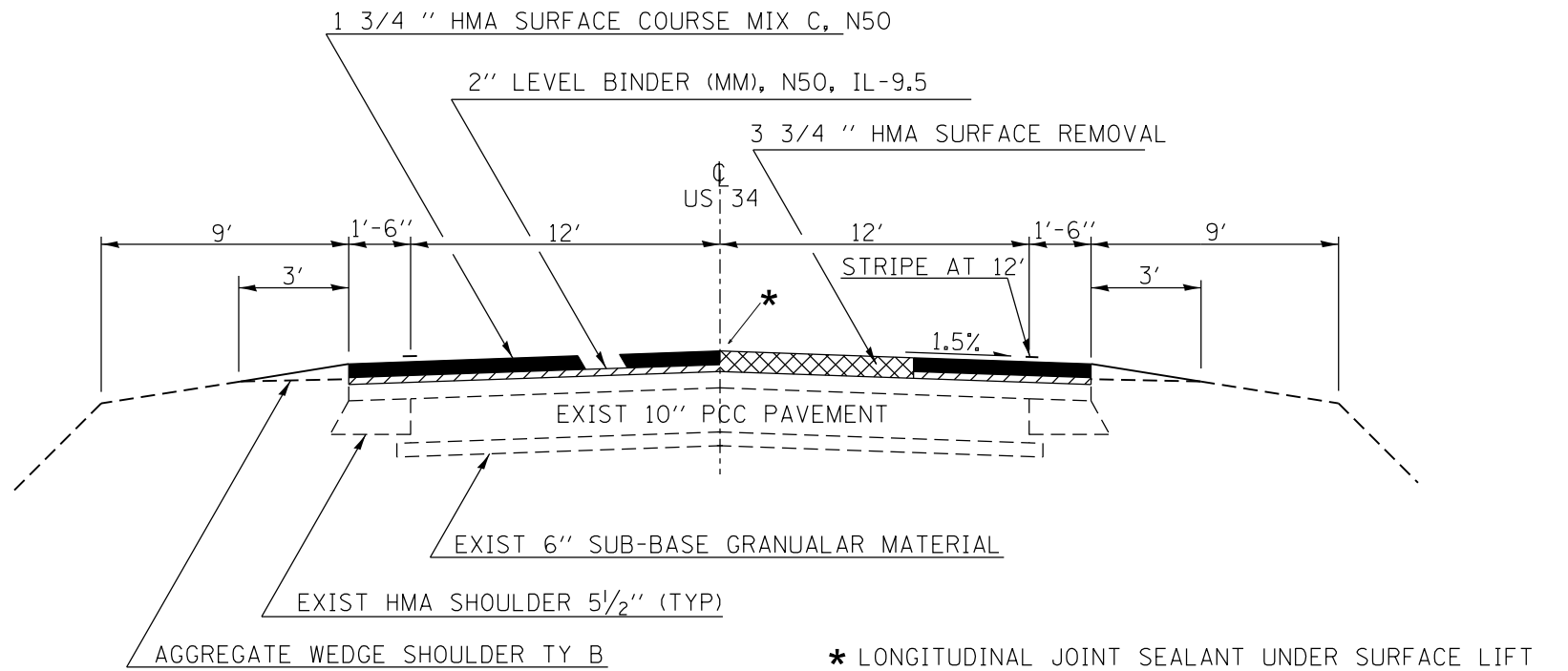

PROPOSED TYPICAL SECTION

STA. 577+05 - STA. 683+00
 STA. 683+00 - STA. 908+39.7

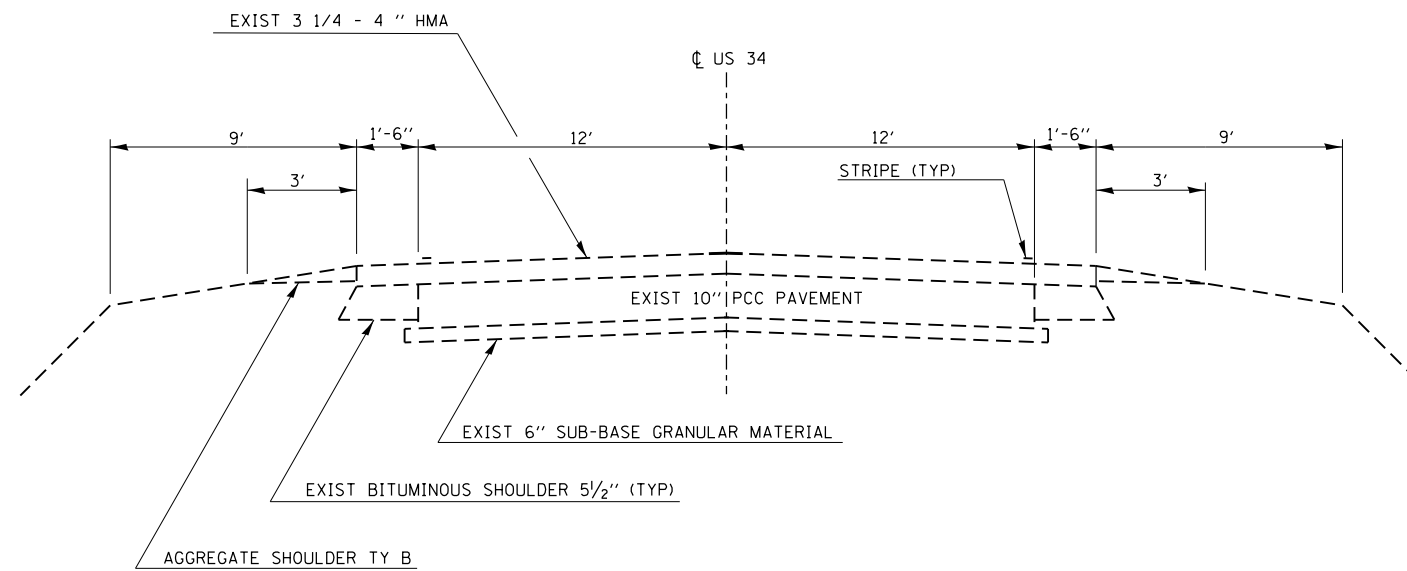

TYPICAL SECTION

STA. 577+05 TO 908+40

OMISSIONS

RAILROAD: STA. 578+98 TO STA. 579+08

HMA MIXTURE REQUIREMENT TABLE

LOCATION(S):	ENTIRE PROJECT	ENTIRE PROJECT
MIXTURE USE(S):	HMA LEVEL BINDER	HMA SURFACE
BINDER GRADE (PG):	PG 64-22	PG 64-22
DESIGN AIR VOIDS:	4.0% @ N50	4.0% @ N50
MIXTURE COMPOSITION: (MIXTURE GRADATION)	IL 9.5	IL 9.5
FRICTION AGGREGATE:	NA	MIXTURE C
MIXTURE WEIGHT:	112.0 LB/SY/IN	112.0 LB/SY/IN
QUALITY MANAGEMENT PROGRAM:	QCP	QCP
SUBLOT SIZE:	1000 TONS	1000 TONS
DENSITY TEST METHOD:	CORES	CORES
DENSITY TEST METHOD:	83BIT169L	

MAINLINE SCHEDULE

STA. TO STA.	LENGTH	WIDTH	HMA SURF REM 3 3/4" (MAINLINE)	HMA SURF CSE N50 MIX C 1.75"	LVL BIND N50 1L-9.5 2"	LONG JOINT SEAL (1 APP)	LEVEL BINDER (HM)	MIX JTS, CRACKS & FLGWYS	BIT MAT'L TACK COAT	AGG SHLD WEDGE SHLDR TY B	TEMP RAMP	
			FT	FT	SQ YD	TONS	TONS	FOOT	TONS	TON	POUND	TONS
577+05	578+98	193	27	579.0	56.7	64.8	193	0.29	0.17	390.8	13.7	23
RAILROAD OMISSION												
579+08	608+13	2905	27	8,715.0	854.1	976.1	2905	4.36	2.61	5,882.6	206.8	23
BRIDGE OMISSION 608+13 TO 610+07												
610+07	637+08	2701	27	8,103.0	794.1	907.5	2701	4.05	2.43	5,469.5	192.3	23
BRIDGE OMISSION 637+08 TO 639+71												
639+71	683+00	4329	27	12,987.0	1272.7	1454.5	4329	6.49	3.90	8,766.2	308.1	23
683+00	908+40	22540	27	1,347.0	132.0	150.9	22540	0.67	0.40	909.2	1604.4	23
TOTALS		32,668		31,731	3,110	3,554	32,668	16	10	21,418	2,325	113

* LONG JOINT SEAL UNDER CENTERLINE SURFACE LIFT

SIDEROAD SCHEDULE

STA	SIDE	LOCATION	MATERIAL	LENGTH	WIDTH	AREA	HMA SURF REM 1 1/2"	INC HMA SURF	TEMP RAMP	BIT MAT TACK CT	FURN EXCAV **	LANDSCAPING (FOR ESTIMATING)				
												EROS CNTRL BLANKET	SEED CL 2A	FERTILIZER		
														NITRO NUTR	PHOS NUTR	POT NUTR
FOOT	FOOT	SQ YD	SQ YD	TON	SQ YD	POUND	CU YD	SQ YD	ACRE	POUND	POUND	POUND				
577+93	LT	E 12TH RD	HMA	30	36	226.7	226.7	19.0	20.0	102.0	2.8	27	0.006	0.5	0.5	0.5
582+43	RT	E 12TH RD	HMA	30	54	303.3	303.3	25.5	30.0	136.5	2.2	21	0.004	0.4	0.4	0.4
624+30	LT	E 1251ST RD	HMA	85	25	566.7	566.7	47.6	13.9	255.0						
624+30	RT	E 1251ST RD	HMA	30	45	291.7	291.7	24.5	25.0	131.3	3.5	33	0.007	0.6	0.6	0.6
662+83	LT	GREENBRIAR RD	HMA	30	35	208.3	208.3	17.5	19.4	93.8	2.3	22	0.004	0.4	0.4	0.4
673+75	RT	E 1344TH RD	HMA	33	22	159.5	159.5	13.4	12.2	71.8	2.8	27	0.006	0.5	0.5	0.5
675+83	LT	RAVE ST	HMA	30	45	275.0	275.0	23.1	25.0	123.8						
683+00	LT	UNION ST/N 45TH RD	HMA	30	50	345.0	345.0	29.0	27.8	155.3	4.5	44	0.009	0.8	0.8	0.8
699+22	LT	E 14TH RD	HMA	30	30	196.7	196.7	16.5	16.7	88.5	2.8	27	0.006	0.5	0.5	0.5
699+32	RT	E 14TH RD	HMA	30	30	196.7	196.7	16.5	16.7	88.5	2.8	27	0.006	0.5	0.5	0.5
784+91	RT	E 1550TH RD	HMA	30	26	190.0	190.0	16.0	14.4	85.5	2.7	26	0.005	0.5	0.5	0.5
784+91	LT	E 1550TH RD	HMA	30	18	130.0	130.0	10.9	10.0	58.5	3.5	33	0.007	0.6	0.6	0.6
824+60	RT	E 1629TH RD	HMA	30	12	123.3	123.3	10.4	6.7	55.5	2.6	25	0.005	0.5	0.5	0.5
837+77	LT	E 1659TH RD	HMA	30	13	115.0	115.0	9.7	7.2	51.8	2.1	20	0.004	0.4	0.4	0.4
850+93	RT	E 1675TH RD	HMA	30	22	183.3	183.3	15.4	12.2	82.5	2.9	28	0.006	0.5	0.5	0.5
863+99	LT	E 17TH RD	HMA	30	20	145.0	145.0	12.2	11.1	65.3	2.4	23	0.005	0.4	0.4	0.4
TOTALS							3,656	307	268	1,645	40	382	0.08	7	7	7

** FURNISHED EXCAVATION AREAS TO BE SEEDED AND FERTILIZED AS DIRECTED BY THE RESIDENT. SEEDING, FERTILIZER AND EROSION CONTROL BLANKET ITEMS ARE INCLUDED IN THE COST OF FURNISHED EXCAVATION. REFER TO RESTORATION OF WORK AREA SPECIAL PROVISION.

US RTE. 34 LOCATION: E 12TH RD AT EARLVILLE TO IL 23 (S) LASALLE COUNTY

GPS NUMBER	DESCRIPTION	EXISTING MONUMENT TYPE	PROPOSED MONUMENT TYPE	MONUMENT RECORD TO BE RECORDED	RESPONSIBILITY
	E QUARTER CORNER SECTION 24, T36N, R2E, 3RD PM	BRASS DISK	TYPE 1	YES	1
	S QUARTER CORNER SECTION 15, T36N, R3E, 3RD PM	PK NAIL	TYPE 1	YES	1
	SW CORNER SECTION 13, T36N, R3E, 3RD PM *(LOCATED NORTH OF US RTE. 34 AT E 17TH RD. WILL REQUIRE INSPECTION TO DETERMINE LOCATION AND IF MONUMENT FALLS WITHIN CONSTRUCTION LIMITS)	UNKNOWN	*TYPE 1	YES	1

MISSING POINT NUMBERS WILL BE ASSIGNED. PRE CONSTRUCTION TIES ARE NOT REQUIRED.
 UNKNOWN MONUMENTS SET BY OTHERS MAY EXIST. IF FOUND, THE R.E. WILL DIRECT PLATS AND PLANS TO GPS ANY MONUMENT SUBJECT TO DESTRUCTION FROM THE RESURFACING WORK FOR THE PURPOSE OF RESETTING IT AFTER JOB COMPLETION.
 THE R.E. WILL DIRECT PLATS AND PLANS TO SEARCH FOR ADDITIONAL MONUMENTS IF THE CONSTRUCTION LIMITS ARE EXPANDED.
 UPON PAVING COMPLETION, THE R.E. WILL DIRECT PLATS AND PLANS TO STAKE THE LOCATIONS FOR TYPE 1 MONUMENT CORING.
 PLATS AND PLANS WILL PREPARE AND RECORD THE REQUIRED MONUMENT RECORDS.

RESPONSIBILITY:

- 1) RESIDENT TO RE-ESTABLISH MONUMENT (PAY ITEM REQUIRED. PERMANENT SURVEY MARKER, TYPE 1)
- 2) PLATS AND PLANS TO RE-ESTABLISH MONUMENT

ENTRANCE SCHEDULE											
STA	SIDE	TYPE	MATERIAL	LENGTH	WIDTH	AREA	HMA SURF REM VAR DEPTH	INC HMA SURF	BIT MAT TACK CT	AGG SURF CSE TY B	
				FOOT	FOOT	SQ YD	SQ YD	TON	POUND	TON	
580+65	LT	PE	HMA	10	12	13.3	13.3	1.1	6.0		
582+43	LT	PE	HMA	10	68	75.6	75.6	6.3	34.0		
588+50	RT	CE	HMA	10	24	26.7	26.7	2.2	12.0		
592+75	RT	CE	HMA	10	34	57.8	57.8	4.9	26.0		
604+50	RT	FE	AGG							5.0	
604+97	LT	FE	AGG							5.0	
614+35	LT	PE/MB	HMA	10	18	49.4	49.4	4.2	22.3		
647+45	LT	CE	HMA	10	36	55.0	55.0	4.6	24.8		
648+70	LT	CE	HMA	10	36	55.0	55.0	4.6	24.8		
648+70	RT	PE/MB	HMA	8	24	48.4	48.4	4.1	21.8		
650+80	RT	PE/MB	HMA	10	20	58.3	58.3	4.9	26.3		
659+18	RT	PE/MB	HMA	10	33	80.6	80.6	6.8	36.3		
660+90	LT	CE/MB	HMA	10	25	61.1	61.1	5.1	27.5		
661+50	LT	CE	CONC	NO WORK							
662+51	RT	CE	HMA	10	40	57.2	57.2	4.8	25.8		
666+24	RT	CE	HMA	10	50	75.6	75.6	6.3	34.0		
666+24	LT	CE	HMA	10	46	72.8	72.8	6.1	32.8		
667+76	LT	CE	HMA	10	33	49.4	49.4	4.2	22.3		
668+50	RT	CE / MBTO	HMA	10	48	102.2	102.2	8.6	46.0		
670+54	LT	CE	HMA	10	30	56.7	56.7	4.8	25.5		
671+08	RT	CE	HMA	10	46	72.8	72.8	6.1	32.8		
674+05	LT	CE	HMA	10	30	48.9	48.9	4.1	22.0		
674+29	RT	CE/MB	HMA	10	32	55.6	55.6	4.7	25.0		
675+09	RT	PE	HMA	10	38	42.2	42.2	3.5	19.0		
677+96	LT	PE	HMA	10	27	59.4	59.4	5.0	26.8		
679+78	RT	CE/MB	HMA	10	40	77.8	77.8	6.5	35.0		
680+50	LT	PE/MB	HMA	10	40	44.4	44.4	3.7	20.0		
694+93	LT	PE	HMA	10	12	38.9	38.9	3.3	17.5		
700+40	RT	PE	HMA	10	12	26.1	26.1	2.2	11.8		
704+77	LT	PE	AGG							5.0	
714+53	RT	CE	AGG							15.0	
715+60	LT	PE	HMA	10	24	32.2	32.2	2.7	14.5		
715+65	RT	PE/MB	HMA	10	16	66.1	66.1	5.6	29.8		
723+45	LT	PE	HMA	10	24	36.7	36.7	3.1	16.5		
724+07	RT	MBTO	HMA	6	64	42.7	42.7	3.6	19.2		
731+60	RT	MBTO	HMA	7	53	41.2	41.2	3.5	18.6		
731+60	LT	PE	HMA	10	17	25.0	25.0	2.1	11.3		
745+15	RT	FE	AGG							5.0	
746+60	LT	PE	HMA	10	26	42.8	42.8	3.6	19.3		
747+70	RT	MBTO	HMA	6	51	34.0	34.0	2.9	15.3		
755+40	RT	PE/MB	HMA	10	28	64.4	64.4	5.4	29.0		
760+60	RT	CE	HMA	10	29	61.1	61.1	5.1	27.5		
763+91	RT	PE/MB	HMA	10	26	59.4	59.4	5.0	26.8		
777+40	RT	MBTO	HMA	7	45	35.0	35.0	2.9	15.8		
777+45	LT	PE	HMA	10	7	19.4	19.4	1.6	8.8		
783+45	LT	PE	HMA	10	7	15.0	15.0	1.3	6.8		
787+90	RT	PE/MB	HMA	10	49	54.4	54.4	4.6	24.5		
788+25	RT	FE	AGG							15.0	
801+35	LT	FE	AGG							5.0	
802+54	RT	CE	HMA	10	35	58.3	58.3	4.9	26.3		
804+10	RT	CE	HMA	10	32	48.3	48.3	4.1	21.8		
817+78	RT	MBTO	HMA	10	25	56.1	56.1	4.7	25.3		
818+63	LT	PE	AGG	0	0					5.0	
819+85	LT	CE	HMA	10	16	40.0	40.0	3.4	18.0		
832+50	RT	PE/MB	HMA	10	59	65.6	65.6	5.5	29.5		
834+30	RT	FE	AGG							15.0	
843+25	LT	FE	AGG							5.0	
855+06	LT	PE	HMA	10	15	25.6	25.6	2.1	11.5		
870+63	RT	FE	AGG							5.0	
881+25	LT	PE/MB	HMA	10	58	64.4	64.4	5.4	29.0		
890+10	LT	FE	AGG	0	0					5.0	
890+10	RT	CE	HMA	10	22	41.1	41.1	3.5	18.5		
895+09	RT	PE	AGG	10						10.0	
895+36	LT	MBTO	AGG							10.0	
904+13	RT	FE	AGG							5.0	
TOTALS							2,490	209	1,121	115	

* NOTE: ALL STATIONS ARE APPROXIMATE.

MATCH LINE STA. 575 + 00

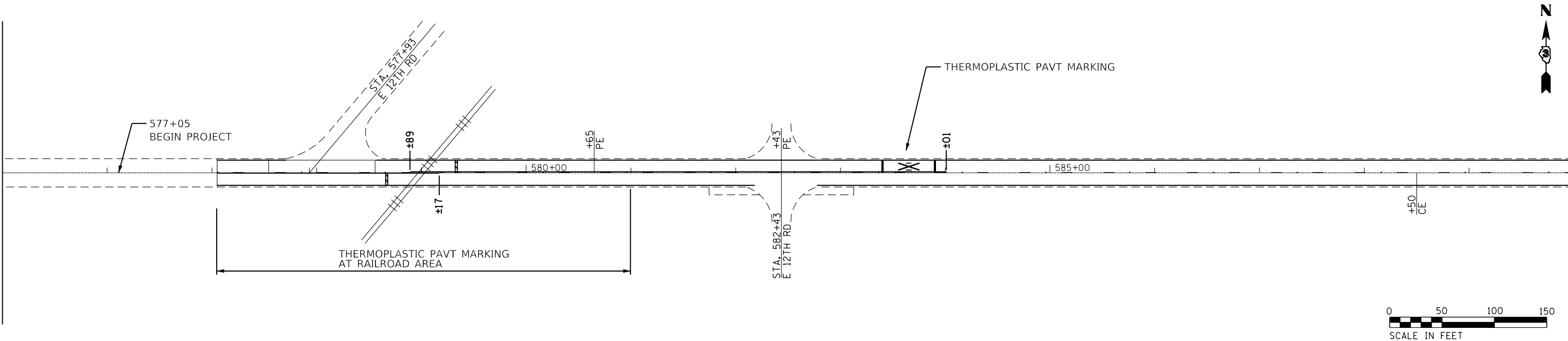

MATCH LINE STA. 590 + 00

MATCH LINE STA. 590 + 00

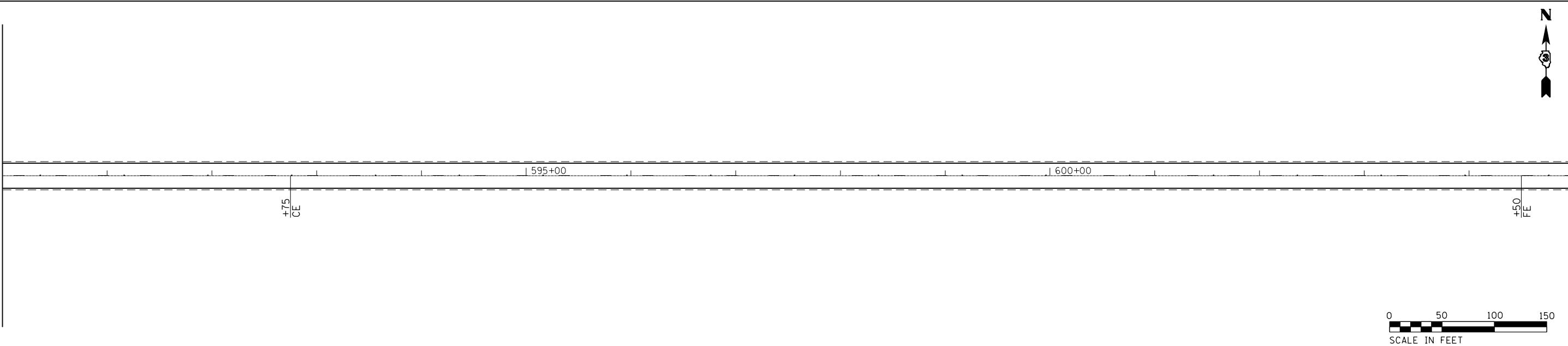

MATCH LINE STA. 605 + 00

MATCH LINE STA. 605 + 00

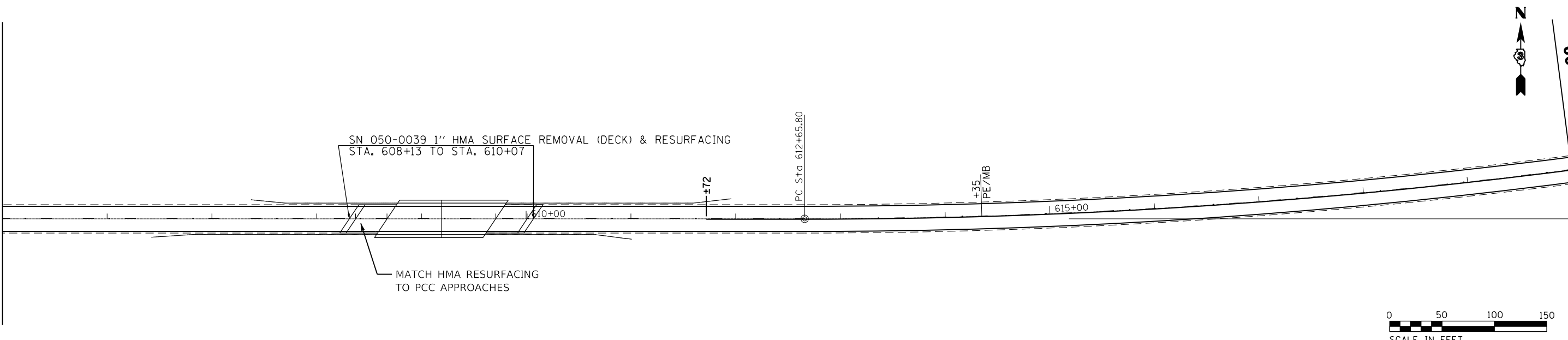

MATCH LINE STA. 620 + 00

FILE NAME =	USER NAME = calderon1	DESIGNED -	REVISED -
p:\planroom.dot\illinois.gov\PIDOT\Documents\IDOT Offices\District 3\Projects\0366054\0366054-sht-plan.dgn		DRAWN -	REVISED -
PLOT SCALE = 100.0000' / in.	CHECKED -	REVISED -	REVISED -
PLOT DATE = 5/24/2019	DATE -	REVISED -	REVISED -

STATE OF ILLINOIS
DEPARTMENT OF TRANSPORTATION

PLAN VIEWS

SCALE: 1=50 SHEET NO. 1 OF 8 SHEETS STA. 575+00 TO STA. 620+00

F.A.P. RTE.	SECTION	COUNTY	TOTAL SHEETS	SHEET NO.
587	(17,18)RS-2	LASALLE	22	10
CONTRACT NO. 66D54				
ILLINOIS FED. AID PROJECT				

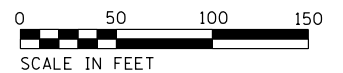
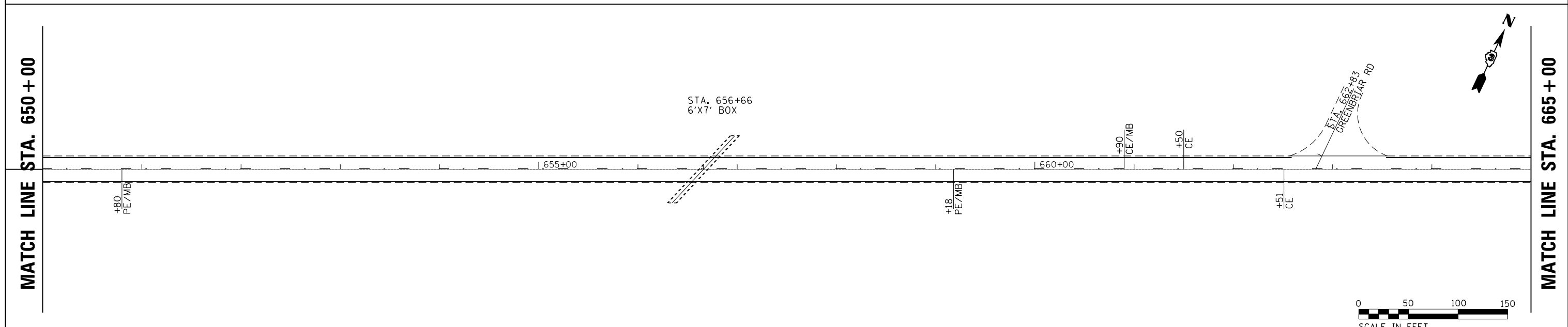
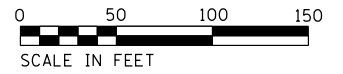
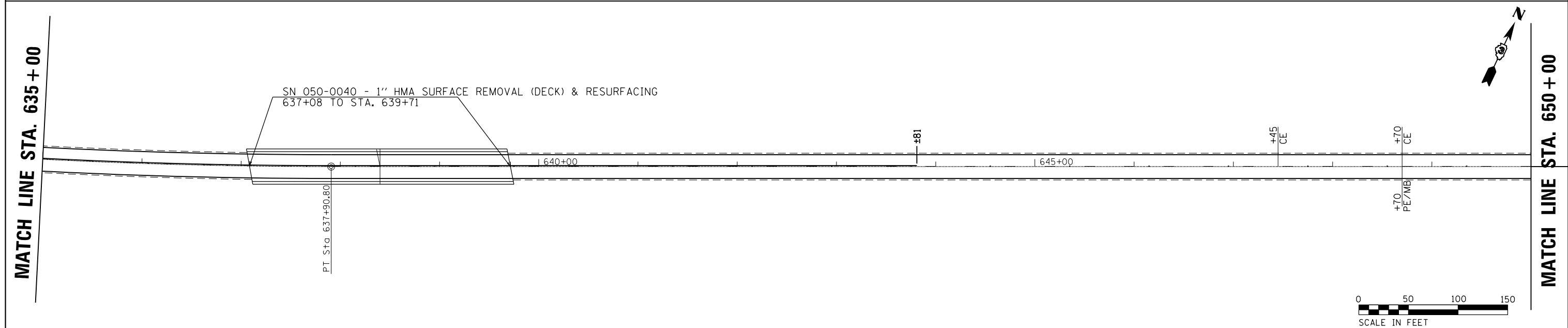
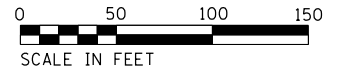
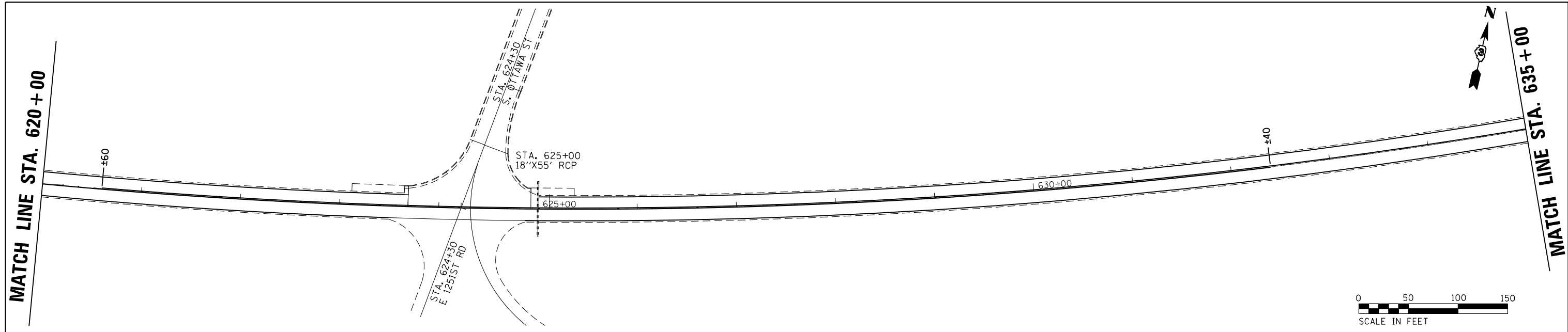

FILE NAME =	USER NAME = calderon1	DESIGNED -	REVISED -
p:\planroom.dot.illinois.gov\PIWIDOT\Documents\IDOT Offices\District 3\Projects\0366054\0366054-sht-plan.dgn		DRAWN -	REVISED -
	PLOT SCALE = 100.0000' / in.	CHECKED -	REVISED -
	PLOT DATE = 5/24/2019	DATE -	REVISED -

**STATE OF ILLINOIS
DEPARTMENT OF TRANSPORTATION**

PLAN VIEWS

SCALE: 1:50 SHEET 2 OF 8 SHEETS STA. 620+00 TO STA. 665+00

F.A.P. RTE.	SECTION	COUNTY	TOTAL SHEETS	SHEET NO.
587	(17,18)RS-2	LASALLE	22	11
CONTRACT NO. 66D54				
ILLINOIS FED. AID PROJECT				

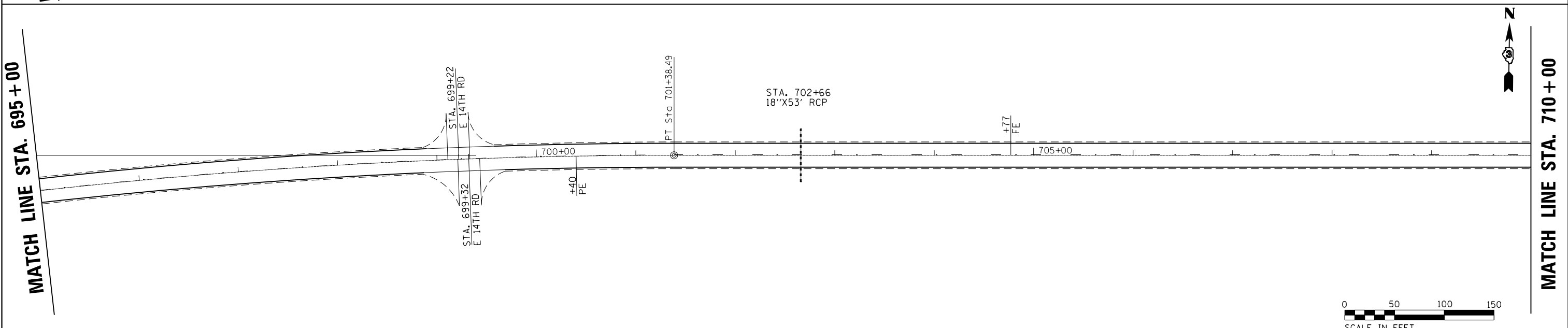
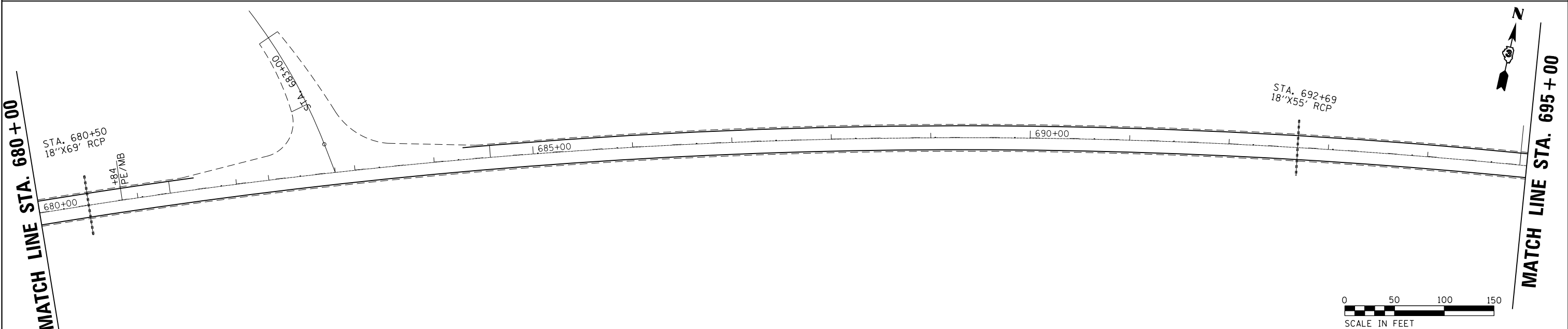
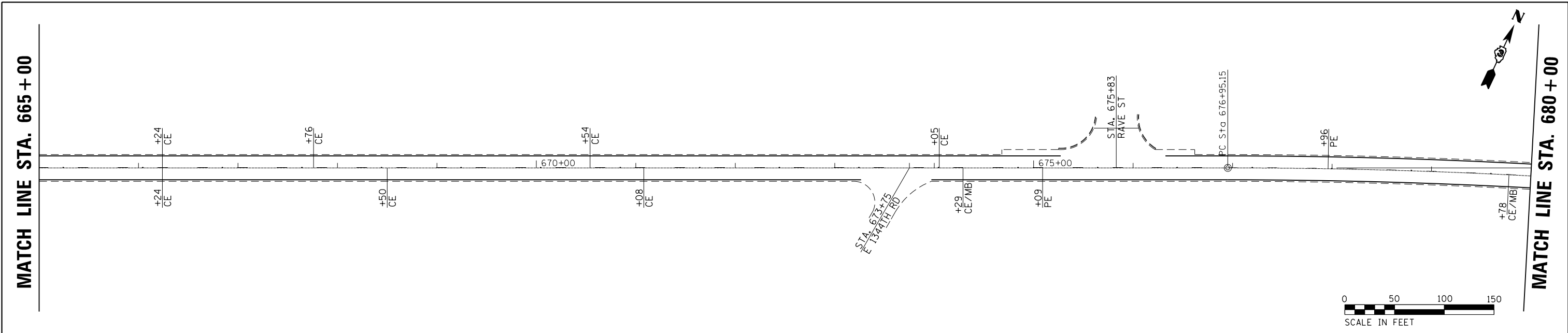

FILE NAME =	USER NAME = calderoni	DESIGNED -	REVISED -	STATE OF ILLINOIS DEPARTMENT OF TRANSPORTATION	PLAN VIEWS			F.A.P. RTE.	SECTION	COUNTY	TOTAL SHEETS	SHEET NO.
p:\planroom.dot.illinois.gov\PIDOT\Documents\IDOT Offices\District 3\Projects\0366D54\0366D54-sht-plan.dgn		CHECKED -	REVISED -		SCALE: 1:50	SHEET 3 OF 8 SHEETS	STA. 665+00 TO STA. 710+00	587	(17,18)RS-2	LASALLE	22	12
PLOT SCALE = 100.0000' / in.		DATE -	REVISED -					CONTRACT NO. 66D54				
PLOT DATE = 5/24/2019								ILLINOIS FED. AID PROJECT				

MATCH LINE STA. 710+00

STA. 711+66
18"X53' RCP

STA. 717+71
18"X58' RCP

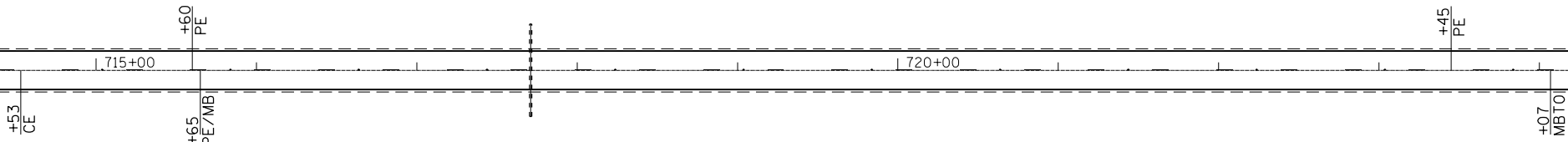

MATCH LINE STA. 725+00

MATCH LINE STA. 725+00

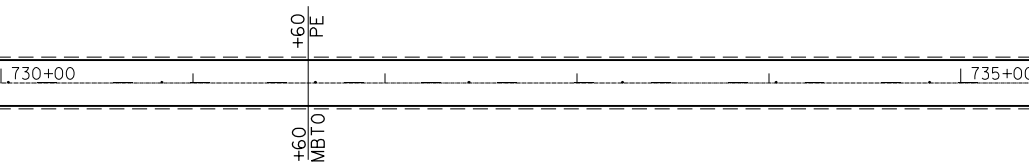

MATCH LINE STA. 740+00

MATCH LINE STA. 740+00

STA. 744+46
4'X6' BOX

STA. 753+58
24"X50' RCP

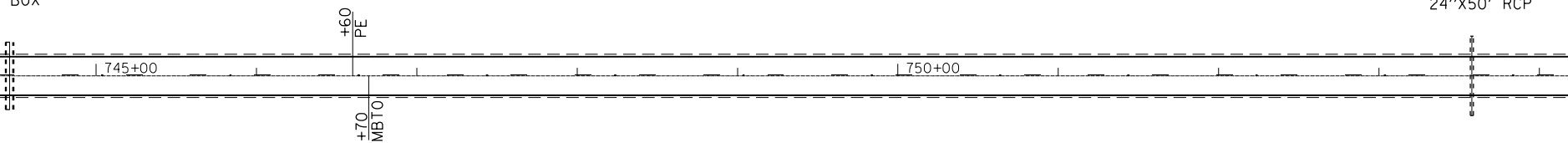

MATCH LINE STA. 755+00

FILE NAME =	USER NAME = calderon1	DESIGNED -	REVISED -
p:\planroom.dot\illinois.gov\PIDOT\Documents\IDOT Offices\District 3\Projects\0366054\0366054-sht-pln.dgn		DRAWN -	REVISED -
	PLOT SCALE = 100.0000' / in.	CHECKED -	REVISED -
	PLOT DATE = 5/24/2019	DATE -	REVISED -

**STATE OF ILLINOIS
DEPARTMENT OF TRANSPORTATION**

PLAN VIEWS

SCALE: 1:50 SHEET 4 OF 8 SHEETS STA. 710+00 TO STA. 755+00

F.A.P. RTE.	SECTION	COUNTY	TOTAL SHEETS	SHEET NO.
587	(17,18)RS-2	LASALLE	22	13
CONTRACT NO. 66D54				
ILLINOIS FED. AID PROJECT				

MATCH LINE STA. 755 + 00

MATCH LINE STA. 770 + 00

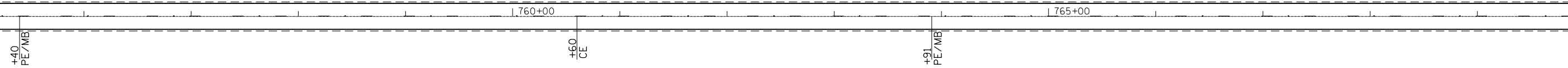

MATCH LINE STA. 770 + 00

MATCH LINE STA. 785 + 00

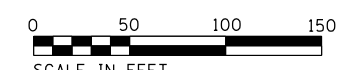
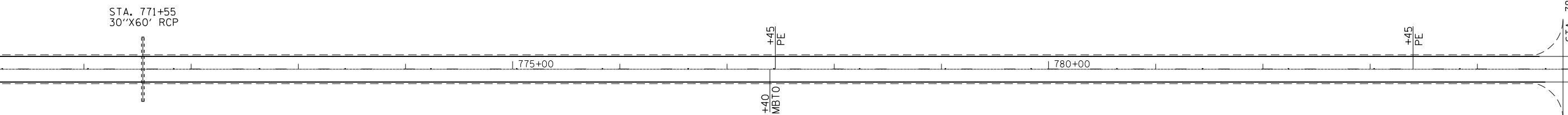

MATCH LINE STA. 785 + 00

MATCH LINE STA. 800 + 00

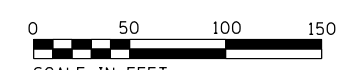
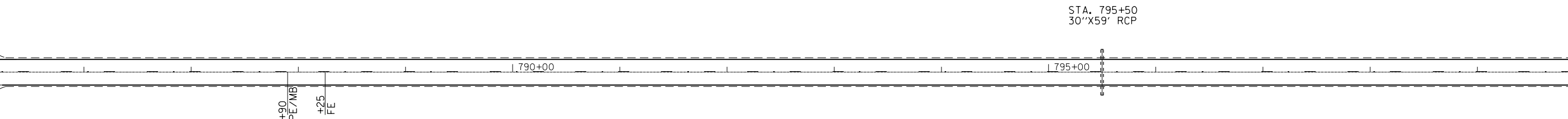

FILE NAME =	USER NAME = calderoni	DESIGNED -	REVISED -
p:\planroom.dot\illinois.gov\PIDOT\Documents\IDOT Offices\District 3\Projects\0366054\0366054-sht-plan.dgn		DRAWN	REVISED -
	PLOT SCALE = 100.0000' / in.	CHECKED -	REVISED -
	PLOT DATE = 5/24/2019	DATE -	REVISED -

**STATE OF ILLINOIS
DEPARTMENT OF TRANSPORTATION**

PLAN VIEWS

SCALE: 1:50 SHEET 5 OF 8 SHEETS STA. 755+00 TO STA. 800+00

F.A.P. RTE.	SECTION	COUNTY	TOTAL SHEETS	SHEET NO.
587	(17,18)RS-2	LASALLE	22	14
CONTRACT NO. 66D54				
ILLINOIS FED. AID PROJECT				

MATCH LINE STA. 800 + 00

MATCH LINE STA. 815 + 00

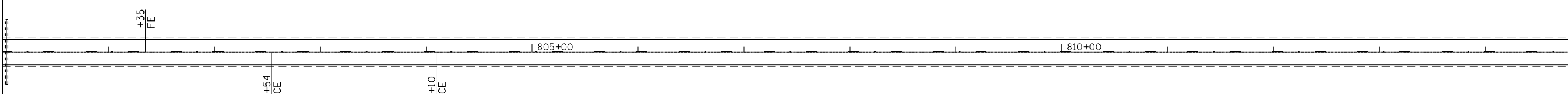

MATCH LINE STA. 815 + 00

MATCH LINE STA. 830 + 00

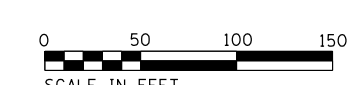
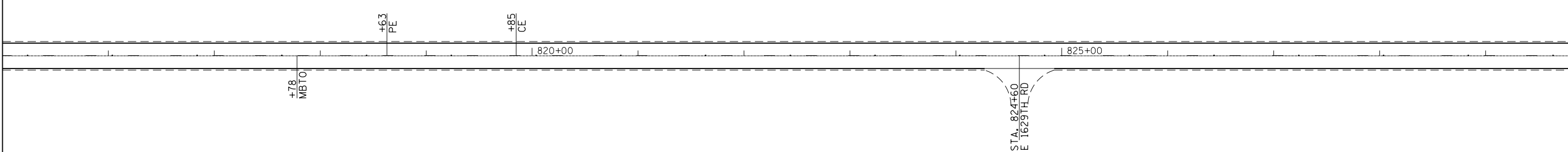

MATCH LINE STA. 830 + 00

MATCH LINE STA. 845 + 00

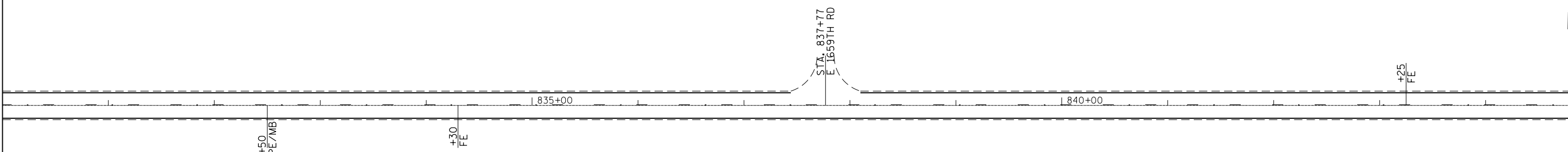

FILE NAME =	USER NAME = calderon1	DESIGNED -	REVISED -
p:\planroom\dot.illinois.gov\PWIDOT\Documents\IDOT Offices\District 3\Projects\0366D54\Drawings\0366D54-sht-plan.dgn		DRAWN -	REVISED -
	PLOT SCALE = 100.0000' / in.	CHECKED -	REVISED -
	PLOT DATE = 5/24/2019	DATE -	REVISED -

**STATE OF ILLINOIS
DEPARTMENT OF TRANSPORTATION**

PLAN VIEWS

SCALE: 1=50 SHEET 6 OF 8 SHEETS STA. 800+00 TO STA. 845+00

F.A.P. RTE.	SECTION	COUNTY	TOTAL SHEETS	SHEET NO.
587	(17,18)RS-2	LASALLE	22	15
CONTRACT NO. 66D54			ILLINOIS FED. AID PROJECT	

MATCH LINE STA. 845 + 00

MATCH LINE STA. 860 + 00

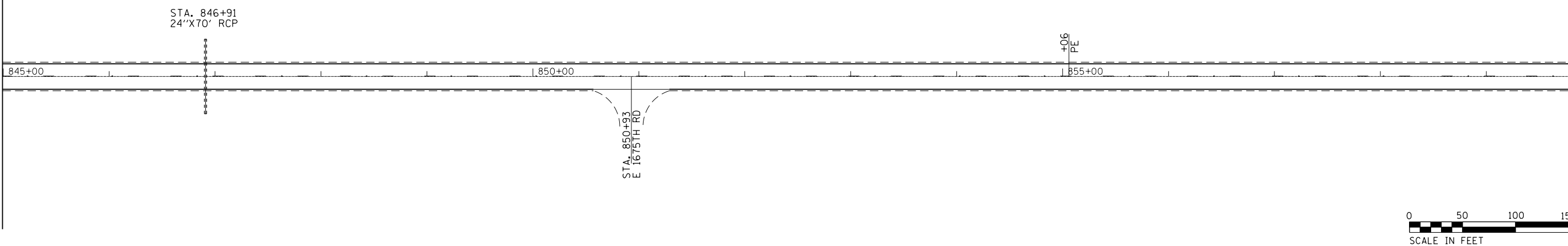

MATCH LINE STA. 860 + 00

MATCH LINE STA. 875 + 00

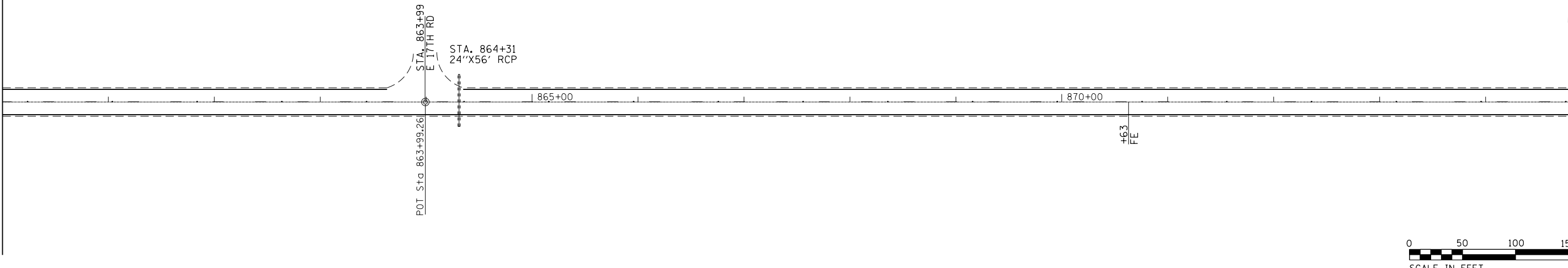

MATCH LINE STA. 875 + 00

MATCH LINE STA. 890 + 00

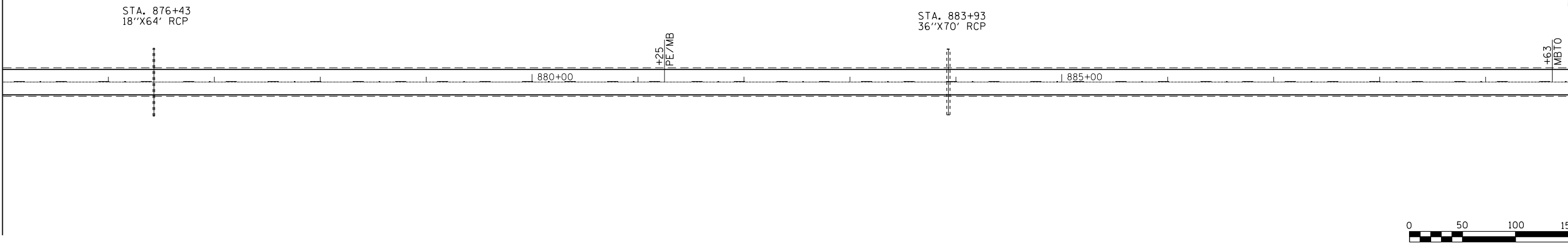

FILE NAME =	USER NAME = calderoni	DESIGNED -	REVISED -
p:\planroom\dot.illinois.gov\PIDOT\Documents\IDOT Offices\District 3\Projects\0366D54\0366D54-sht-plan.dgn		DRAWN -	REVISED -
	PLOT SCALE = 100.0000' / in.	CHECKED -	REVISED -
	PLOT DATE = 5/24/2019	DATE -	REVISED -

**STATE OF ILLINOIS
DEPARTMENT OF TRANSPORTATION**

PLAN VIEWS

SCALE: 1:50 SHEET 7 OF 8 SHEETS STA. 845+00 TO STA. 890+00

F.A.P. RTE.	SECTION	COUNTY	TOTAL SHEETS	SHEET NO.
587	(17,18)RS-2	LASALLE	22	16
CONTRACT NO. 66D54			ILLINOIS FED. AID PROJECT	

MATCH LINE STA. 890 + 00

+10
FE
PE

+09
PE
+36
MBTO

STA. 897+93
24"X62' RCP

POT Sta. 900+00.00

900+00

PC Sta. 900+86.51

+13
FE

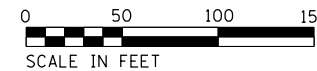

MATCH LINE STA. 905 + 00

MATCH LINE STA. 905 + 00

905+00

+89

908+40
END IMPROVEMENT

910+00

FOR INFORMATION ONLY

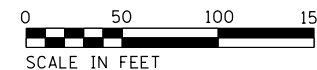

FILE NAME =	USER NAME = calderoni	DESIGNED -	REVISED -
p:\planroom.dot.illinois.gov\PIDOT\Documents\IDOT Offices\District 3\Projects\0366D54\Drawings\0366D54-sht-plan.dgn		DRAWN -	REVISED -
	PLOT SCALE = 100.0000' / in.	CHECKED -	REVISED -
	PLOT DATE = 5/24/2019	DATE -	REVISED -

STATE OF ILLINOIS
DEPARTMENT OF TRANSPORTATION

PLAN VIEWS

SCALE: 1=50 SHEET 8 OF 8 SHEETS STA. 890+00 TO STA.

F.A.P. RTE.	SECTION	COUNTY	TOTAL SHEETS	SHEET NO.
587	(17,18)RS-2	LASALLE	22	17
CONTRACT NO. 66D54				
ILLINOIS FED. AID PROJECT				

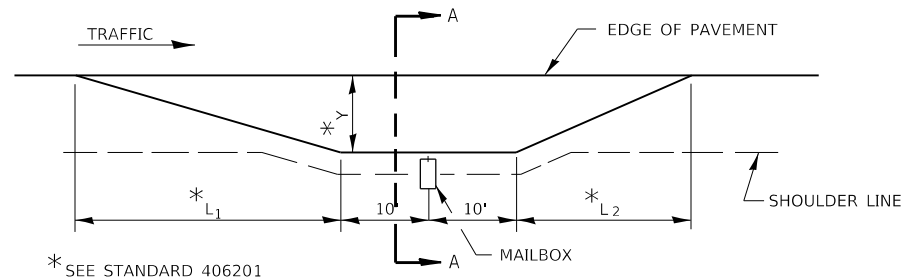

* SEE STANDARD 406201

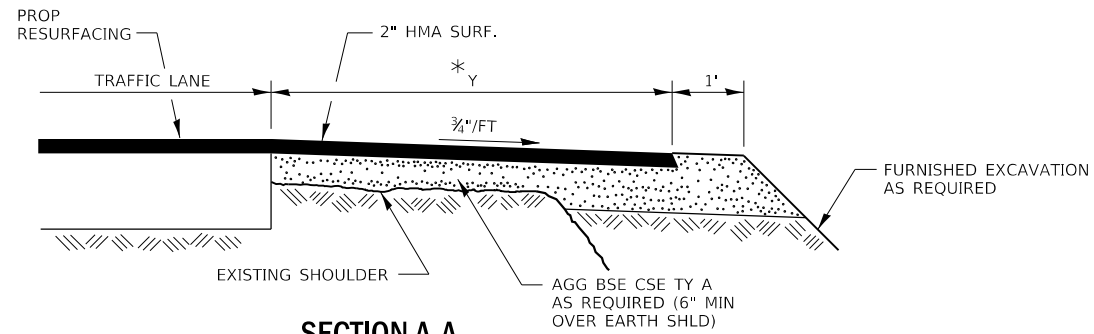

SECTION A-A

RURAL MAILBOX TURNOUT DETAILS

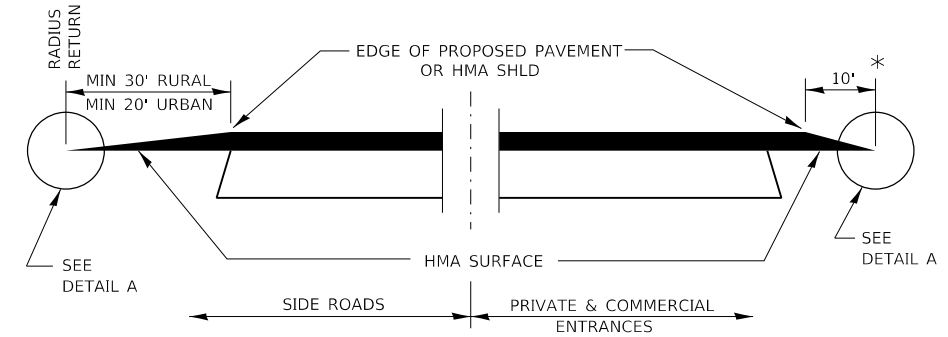

**SECTION A-A
DETAILS AT ENTRANCES & SIDE ROADS**

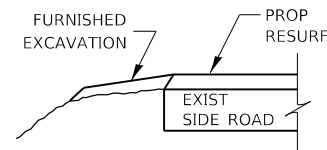

SECTION B-B

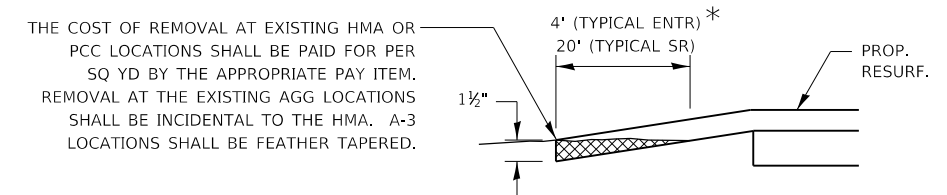

DETAIL A

THE COST OF REMOVAL AT EXISTING HMA OR PCC LOCATIONS SHALL BE PAID FOR PER SQ YD BY THE APPROPRIATE PAY ITEM. REMOVAL AT THE EXISTING AGG LOCATIONS SHALL BE INCIDENTAL TO THE HMA. A-3 LOCATIONS SHALL BE FEATHER TAPERED.

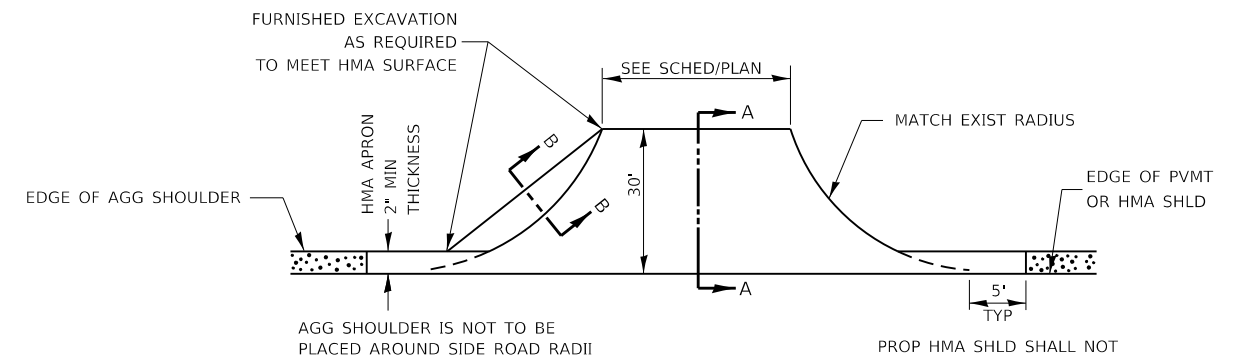

PLAN AT SIDE ROADS

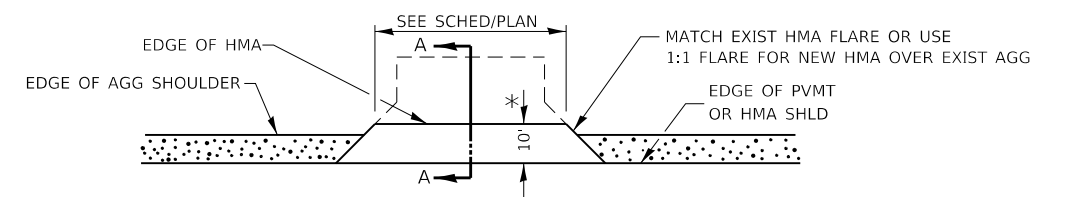

PLAN AT PRIVATE & COMMERCIAL ENTRANCES

(DO NOT RESURFACE FIELD ENTRANCES)

* PROPOSED HMA RESURFACING AT PUBLIC EDUCATIONAL FACILITY ENTRANCES SHALL BE EXTENDED TO THE RIGHT-OF-WAY LIMITS.

MODEL: Default
FILE: \\nas01c:\pub\planroom\dat\illinois.gov\PI\DOT\Documents\DOT_Offices\Director_3\Projects\1036605\ACAD\Drawings\366054-2ht-detail.dgn

USER NAME = calderoni	DESIGNED -	REVISED -
PLOT SCALE = 100,0000' / in.	DRAWN -	REVISED -
PLOT DATE = 5/24/2019	CHECKED -	REVISED -
	DATE -	REVISED -

**STATE OF ILLINOIS
DEPARTMENT OF TRANSPORTATION**

DETAILS	
SCALE:	SHEET OF SHEETS STA. TO STA.

F.A.P. RTE.	SECTION	COUNTY	TOTAL SHEETS	SHEET NO.
587	(17,18)RS-2	LASALLE	22	18
CONTRACT NO. 66D54				
ILLINOIS FED. AID PROJECT				

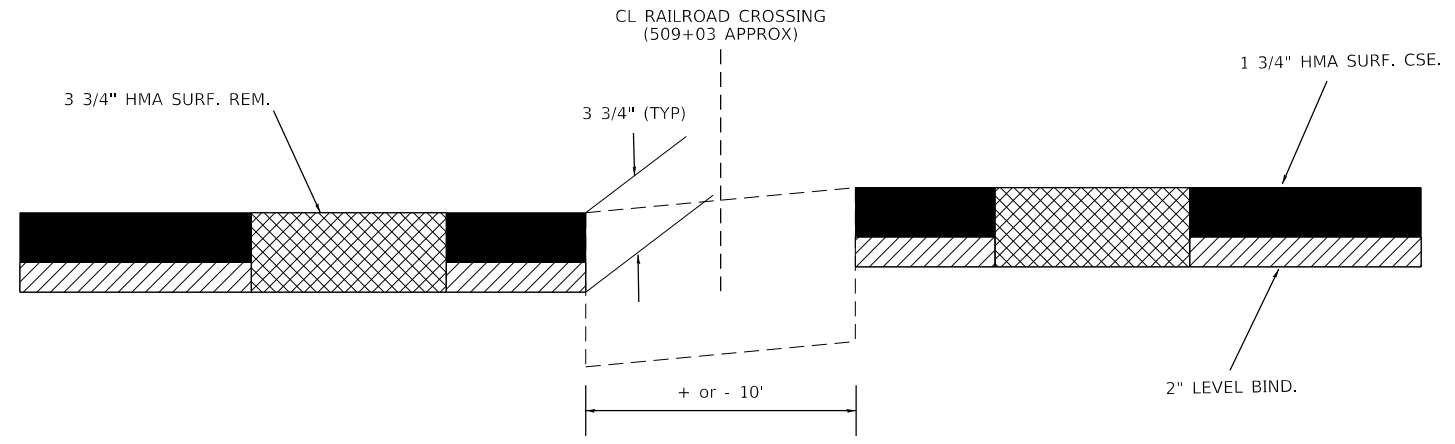

HMA SURFACE REMOVAL AT UNION PACIFIC RAILROAD CROSSING

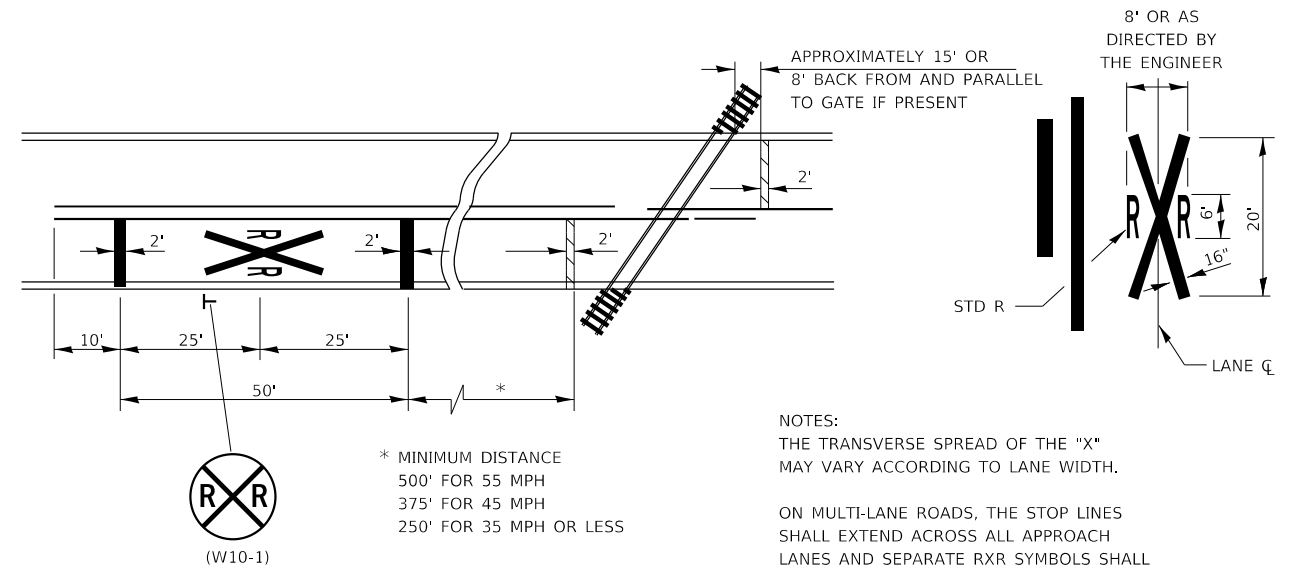

PAVEMENT MARKINGS AT RAILROAD-HIGHWAY GRADE CROSSING

NOTES:
 THE TRANSVERSE SPREAD OF THE "X" MAY VARY ACCORDING TO LANE WIDTH.
 ON MULTI-LANE ROADS, THE STOP LINES SHALL EXTEND ACROSS ALL APPROACH LANES AND SEPARATE RXR SYMBOLS SHALL BE PLACED ADJACENT TO EACH OTHER IN EACH LANE.
 WHEN THE PAVEMENT MARKING SYMBOL IS USED, A PORTION OF THE SYMBOL SHOULD BE LOCATED DIRECTLY ADJACENT TO THE ADVANCE WARNING SIGN (W10-1).

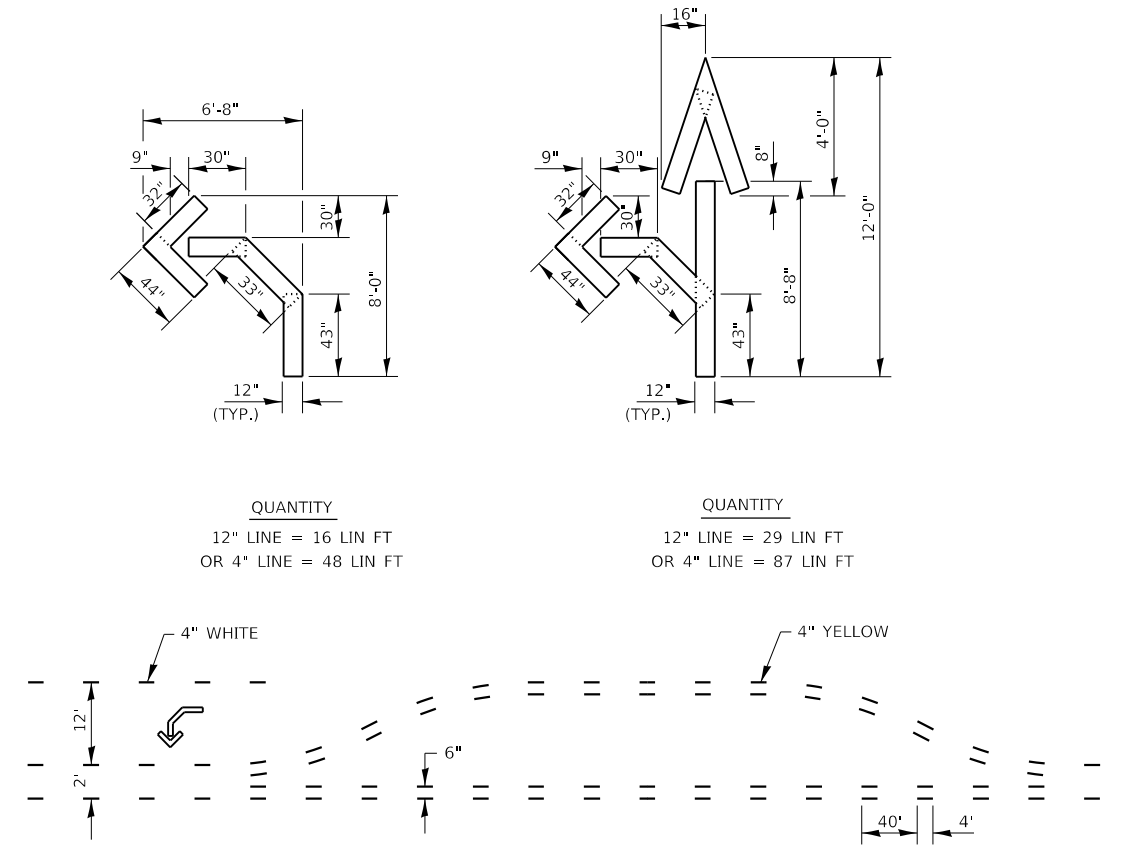

SHORT-TERM PAVEMENT MARKING FOR MEDIANS AND ARROWS

MODEL: Default
 FILE: Mainfile: p:\pub\barroom.dwg
 PROJECT: PW\DOT\Documents\DOT - Office\Drawings - 3\Projects\0366054\ACADD\0366054-2ht-deta11e.dwg

USER NAME = calderoni	DESIGNED -	REVISED -
	DRAWN -	REVISED -
PLOT SCALE = 100.0000' / in.	CHECKED -	REVISED -
PLOT DATE = 5/24/2019	DATE -	REVISED -

STATE OF ILLINOIS
 DEPARTMENT OF TRANSPORTATION

SCALE:		SHEET	OF	SHEETS	STA.	TO	STA.
--------	--	-------	----	--------	------	----	------

F.A.P. RTE.	SECTION	COUNTY	TOTAL SHEETS	SHEET NO.
587	(17,18)RS-2	LASALLE	22	19
CONTRACT NO. 66D54				
ILLINOIS FED. AID PROJECT				

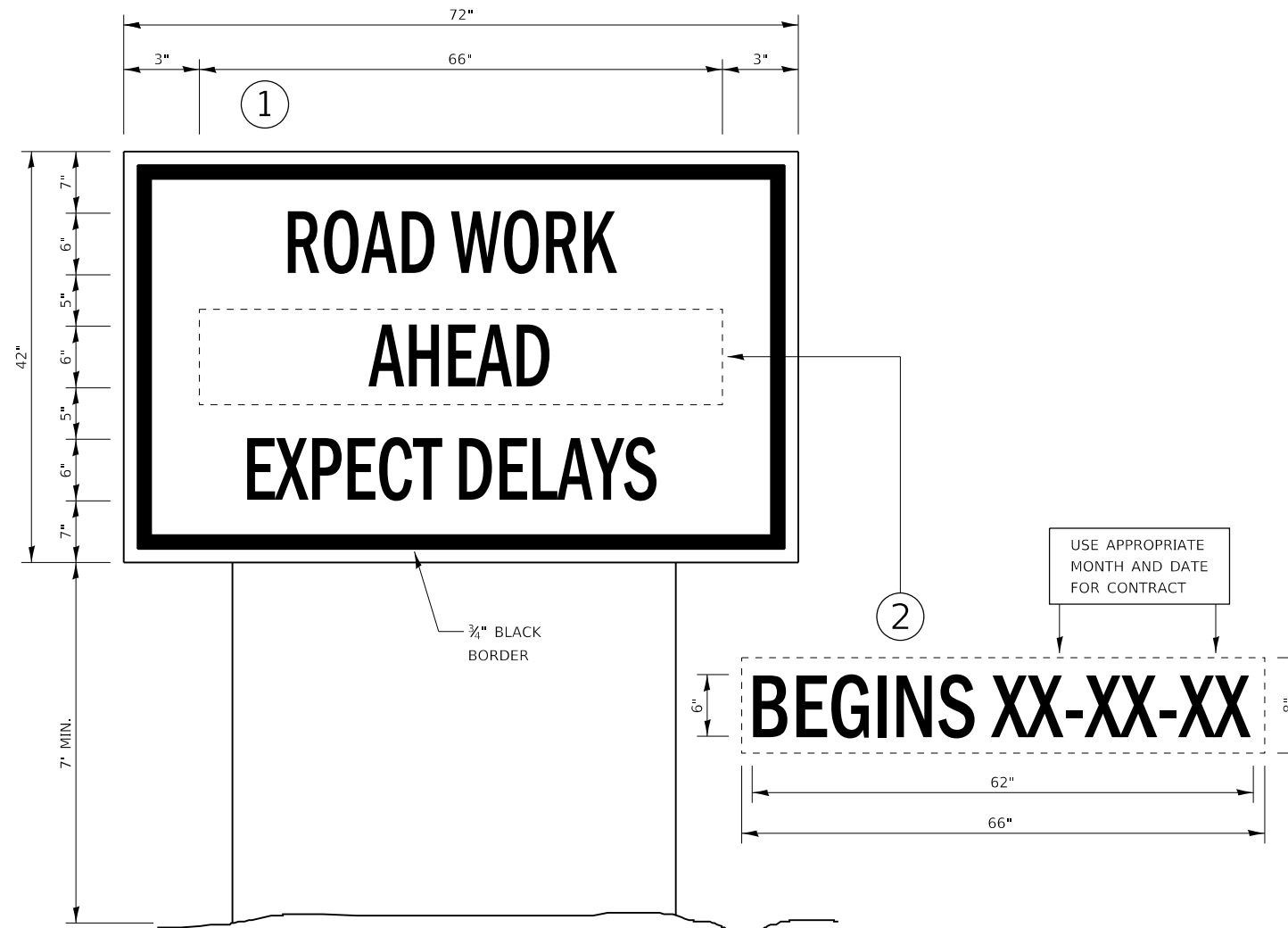

TEMPORARY INFORMATION SIGNING

NOTES:

1. USE 6" D BLACK LETTERING ON FLUORESCENT ORANGE BACKGROUND.
2. ERECT SIGNS AT LOCATIONS IN ADVANCE OF THE "ROAD CONSTRUCTION AHEAD" SIGNS AS DIRECTED BY THE ENGINEER.
3. ERECT SIGN ① WITH INSTALLED PANEL ② A MINIMUM OF ONE WEEK PRIOR TO THE START OF THE LANE CLOSURE.
4. REMOVE PANEL ② ON THAT DATE.
5. SEE SPECIAL PROVISION "TEMPORARY INFORMATION SIGNING" FOR ADDITIONAL INFORMATION.
6. WILL BE PAID FOR PER SQ FT AS "TEMPORARY INFORMATION SIGNING". EACH SIGN = 21 SQ FT AND THE DATE PANEL ② WILL NOT BE MEASURED SEPARATELY FOR PAYMENT.

MODEL: Default
 FILE: \\nas01c.pva.hq.ibm.com\data\illinois.gov\PIWDOT\Documents\DOT_Offices\District_3\Projects\10366054\CADD\366054-2ht-deta11e.dgn

	USER NAME = calderoni	DESIGNED -	REVISED -	STATE OF ILLINOIS DEPARTMENT OF TRANSPORTATION	DETAILS				F.A.P RTE.	SECTION	COUNTY	TOTAL SHEETS	SHEET NO.
		DRAWN -	REVISED -							(17,18)R5-2	LASALLE	22	20
	PLOT SCALE = 100.0000' / in.	CHECKED -	REVISED -										CONTRACT NO. 66D54
	PLOT DATE = 5/24/2019	DATE -	REVISED -			SCALE:	SHEET	OF	SHEETS	STA.	TO	STA.	ILLINOIS

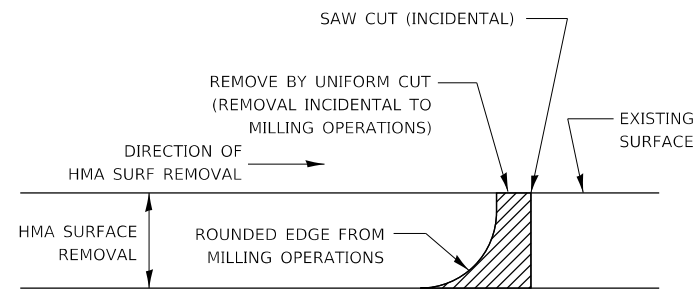

NOTE:

WHEN MILLING OPERATIONS PRODUCE A ROUNDED EDGE, THEN A SAW CUT SHALL BE USED TO MANUFACTURE A PERPENDICULAR EDGE AS SHOWN IN THE DETAIL. THE ENGINEER SHALL BE THE SOLE JUDGE CONCERNING THE USE OF THIS DETAIL

HMA DETAIL AT BUTT JOINTS

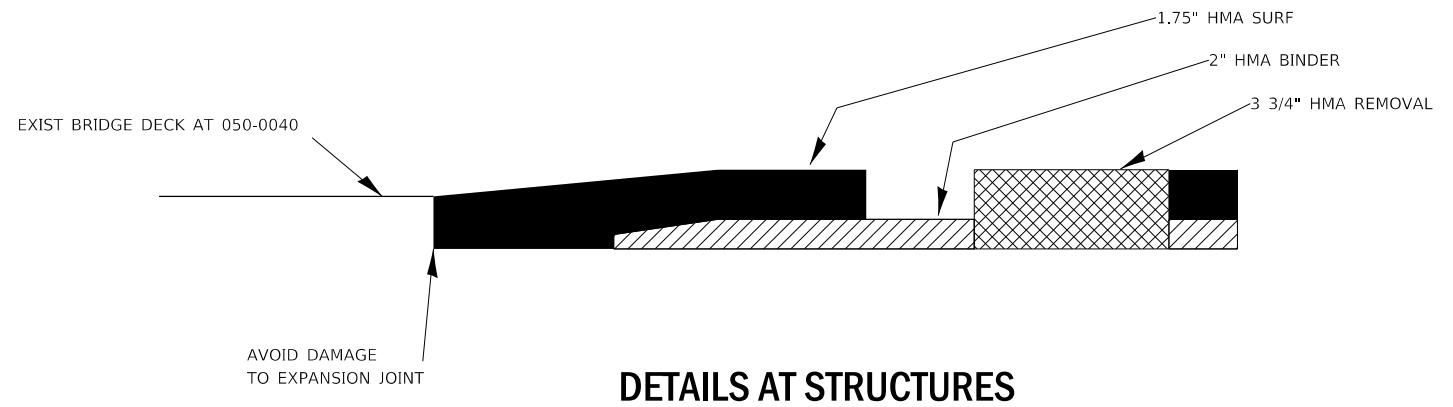

DETAILS AT STRUCTURES

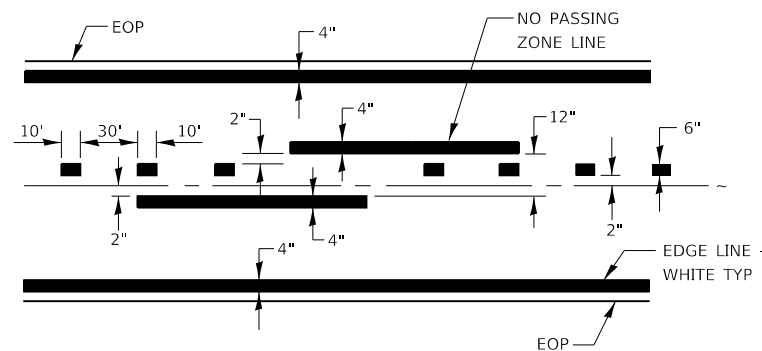

CENTERLINE & NO PASSING ZONE LINES - YELLOW

PAVEMENT MARKING

**STATE OF ILLINOIS
DEPARTMENT OF TRANSPORTATION**

DETAILS

SCALE: SHEET OF SHEETS STA. TO STA.

F.A.P. RTE.	SECTION	COUNTY	TOTAL SHEETS	SHEET NO.
587	(17,18)RS-2	LASALLE	22	21
CONTRACT NO. 66D54				
ILLINOIS FED. AID PROJECT				

FOR INFORMATION ONLY

NOT TO SCALE

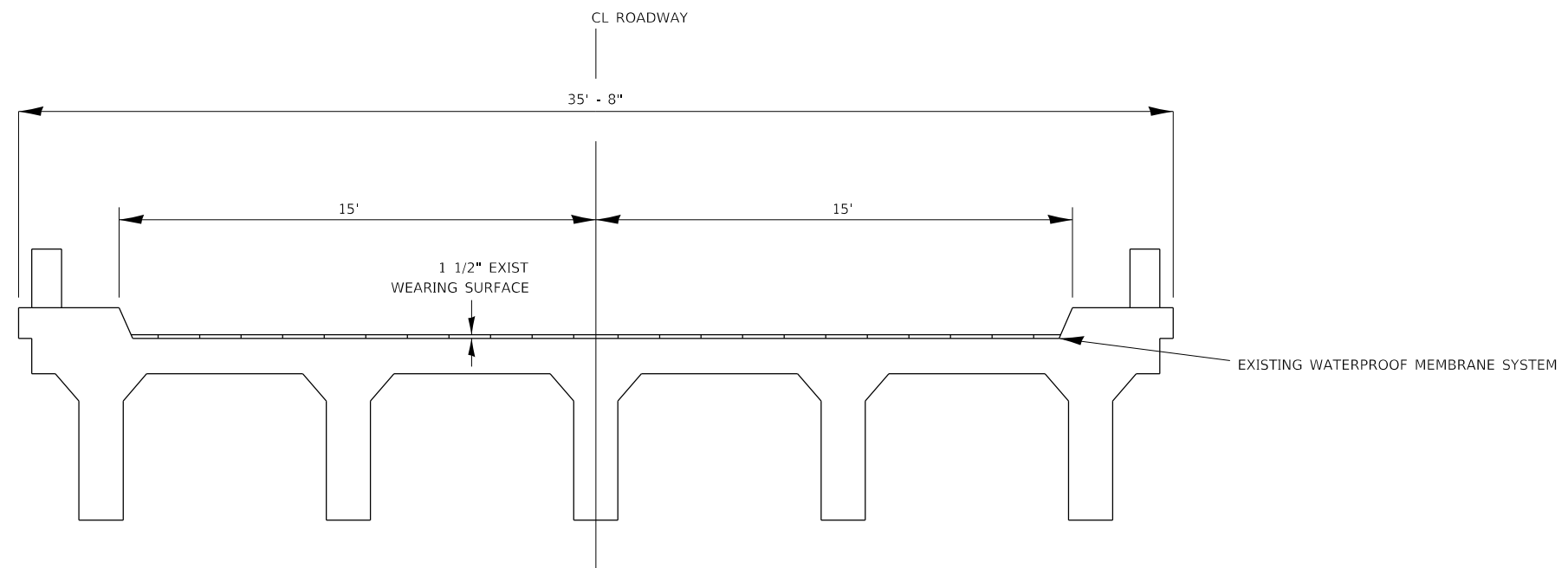

**EXIST DECK CROSS-SECTION
050-0040**

NOT TO SCALE

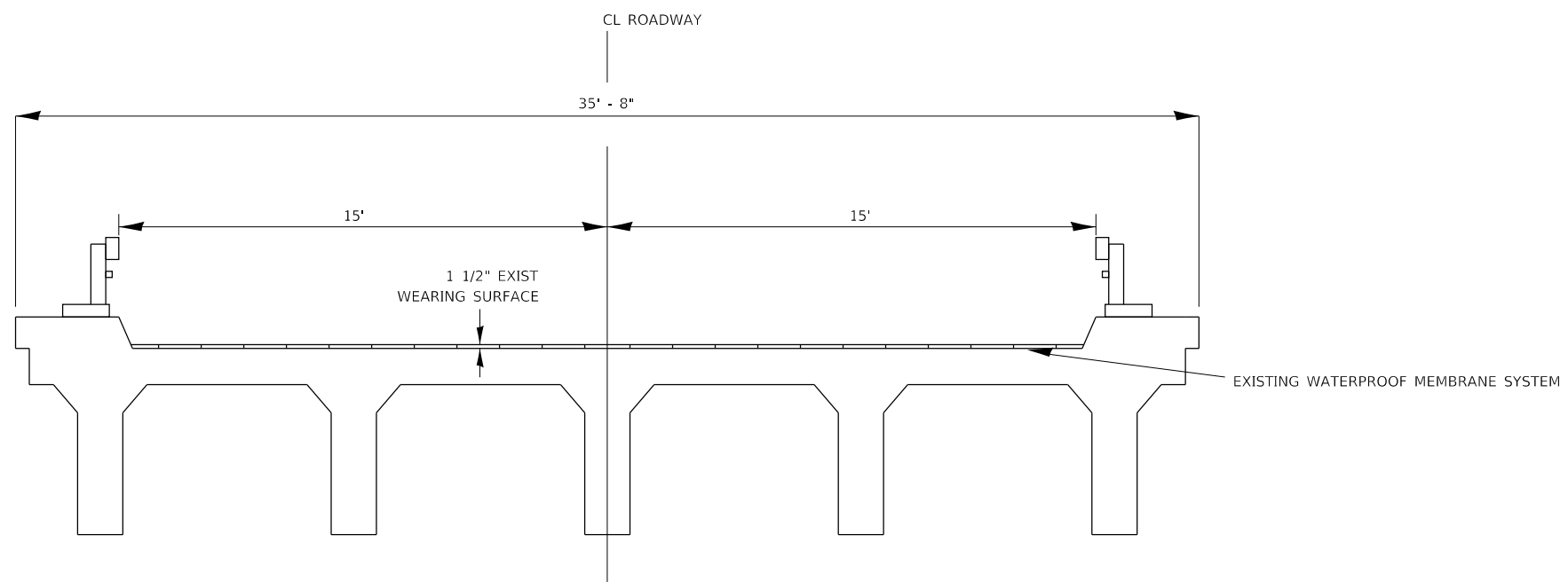

**EXIST DECK CROSS-SECTION
050-0039**

MODEL: Default
 FILE: \\nas01c.psu.edu\pub\baronm.d\at\illinois.gov\PWIDOT\Documents\DOT_Offices\District_3\Projects\0366D54\AC\0366D54-2ht-detail.dgn

USER NAME = calderoni	DESIGNED -	REVISED -
	DRAWN -	REVISED -
PLOT SCALE = 100.0000' / in.	CHECKED -	REVISED -
PLOT DATE = 5/24/2019	DATE -	REVISED -

**STATE OF ILLINOIS
DEPARTMENT OF TRANSPORTATION**

DETAILS

SCALE: SHEET OF SHEETS STA. TO STA.

F.A.P. RTE.	SECTION	COUNTY	TOTAL SHEETS	SHEET NO.
587	(17,18)R5-2	LASALLE	22	22
CONTRACT NO. 66D54			ILLINOIS FED. AID PROJECT	