

STATE OF ILLINOIS
DEPARTMENT OF TRANSPORTATION

F.A.I. RTE.	SECTION	COUNTY	TOTAL SHEETS	SHEET NO.
64	82 (1,2,3,4,5,6,7,8)CJS-1	ST. CLAIR	24	1
		ILLINOIS	CONTRACT NO. 76M66	

D-98-080-19



PROPOSED HIGHWAY PLANS

FAI ROUTE 64 (I-064)
SECTION 82-(1,2,3,4,5,6,7,8)CJS-1
PROJECT NHPP-WWJR(010)
CRACK AND JOINT SEAL
ST. CLAIR COUNTY

C-98-099-19

FOR INDEX OF SHEETS, SEE SHEET NO. 2

ADT

I-64 FROM I-55/70 TO I-255
2017 ADT = 76200 (ACTUAL)
2019 ADT = 77300 (ESTIMATED)
2039 ADT = 88300 (ESTIMATED)
SU = 22.9% MU = 8.5%

I-64 FROM I-255 TO IL 157
2015 ADT = 91400 (ACTUAL)
2019 ADT = 94000 (ESTIMATED)
2039 ADT = 99800 (ESTIMATED)
SU = 5.6% MU = 7.8%

I-64 FROM GREENMOUNT ROAD TO IL 158
2015 ADT = 56700 (ACTUAL)
2019 ADT = 57500 (ESTIMATED)
2039 ADT = 66100 (ESTIMATED)
SU = 2.9% MU = 11.6%

I-64 FROM IL 158 TO IL 4
2015 ADT = 38000 (ACTUAL)
2019 ADT = 38500 (ESTIMATED)
2039 ADT = 44300 (ESTIMATED)
SU = 3.3% MU = 11.6%

BEGIN SECTION
I-64 0.6 MI EAST OF I-55/70
LAT: 38.62499
LONG: -90.13489

BEGIN SECTION
0.2 MI WEST OF GREENMOUNT ROAD
LAT: 38.57802
LONG: -89.93282

END SECTION
0.3 MI WEST OF IL 157
LAT: 38.61652
LONG: -90.05104

END SECTION
0.4 MI WEST OF IL 4
LAT: 38.55352
LONG: -89.81445

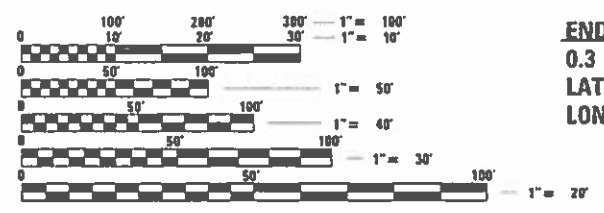
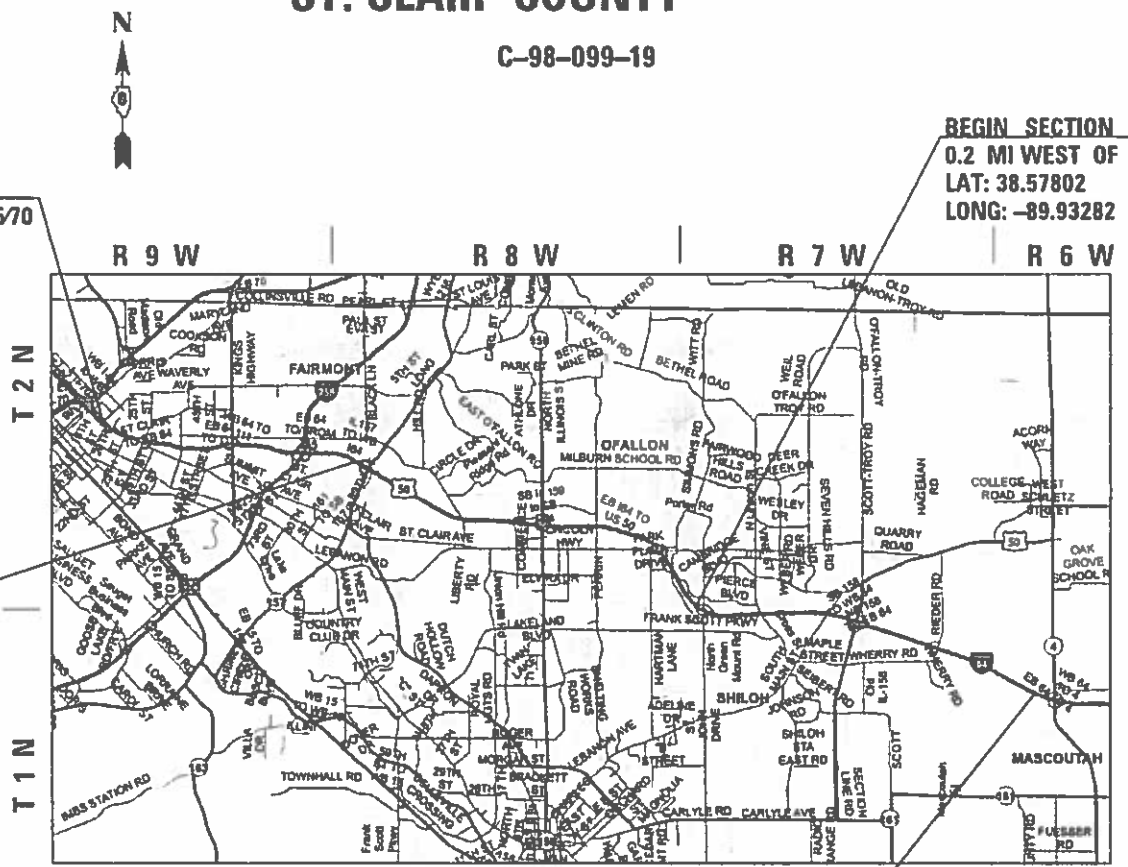

FULL SIZE PLANS HAVE BEEN PREPARED USING STANDARD ENGINEERING SCALES. REDUCED SIZED PLANS WILL NOT CONFORM TO STANDARD SCALES. IN MAKING MEASUREMENTS ON REDUCED PLANS, THE ABOVE SCALES MAY BE USED.

J.U.L.I.E.
JOINT UTILITY LOCATION INFORMATION FOR EXCAVATORS
1-800-892-0123
OR 811

PROJECT ENGINEER: HERVE GELIN (618) 346-3179
SQUAD LEADER: BILLIE OWEN (618) 346-3209

GROSS LENGTH = 11.72 MILE

CONTRACT NO. 76M66

STATE OF ILLINOIS
DEPARTMENT OF TRANSPORTATION

SUBMITTED May 31 2019
Kaith Roberts
REGIONAL ENGINEER

June 14 2019
E.A. Elk
ENGINEER OF DESIGN AND ENVIRONMENT

June 24 2019
Paul P. Chy
DIRECTOR OF HIGHWAYS PROJECT IMPLEMENTATION

PRINTED BY THE AUTHORITY
OF THE STATE OF ILLINOIS

INDEX OF SHEETS

- 1 COVER SHEET
- 2 INDEX OF SHEETS, HIGHWAY STANDARDS, GENERAL NOTES & COMMITMENTS
- 3 SUMMARY OF QUANTITIES
- 4-23 TYPICAL SECTION
- 24 CRACK & JOINT SEALING DETAIL

HIGHWAY STANDARDS

- 000001-07 STANDARD SYMBOLS, ABBREVIATIONS AND PATTERNS
- 701426-09 LANE CLOSURE, MULTILANE, INTERMITTENT OR MOVING OPER., FOR SPEEDS > 45MPH
- 701901-08 TRAFFIC CONTROL DEVICES

GENERAL NOTES

- 1. ILLINOIS STATE LAW REQUIRES A 48-HOUR NOTICE TO BE GIVEN TO UTILITIES BEFORE DIGGING. FIELD MARKING OF FACILITIES MAY BE OBTAINED BY CONTACTING J.U.L.I.E. (1-800-892-0123 OR 811) OR FOR NON-MEMBERS THE UTILITY COMPANY DIRECTLY.
- 2. RESIDENT ENGINEER SHALL DETERMINE EXACT LOCATION WHERE CRACKS ARE TO BE ROUTED AND FILLED.
- 3. ESTIMATED CRACK FILLING APPLICATION RATE : 0.33 LB/FT
- 4. THE CONTRACTOR AND THE ENGINEER SHALL BE AWARE THAT NO SURVEY WAS PERFORMED FOR THIS PROJECT. THE STATIONING, TOPOGRAPHY, AND QUANTITIES SHOWN IN THE PLANS WERE CREATED USING FIELD MEASUREMENTS. ALL SHALL BE ASSUMED TO BE APPROXIMATE. THE CONTRACTOR SHALL VERIFY DIMENSIONS AND CONDITIONS IN THE FIELD PRIOR TO CONSTRUCTION AND ORDERING OF MATERIALS.

- 5. THE ILLINOIS DEPARTMENT OF TRANSPORTATION STRONGLY ENCOURAGES THE PRIME CONTRACTOR AND THEIR APPROVED SUB-CONTRACTORS TO HIRE MINORITY, WOMEN AND DISADVANTAGED INDIVIDUALS FROM ITS FEDERALLY FUNDED HIGHWAY CONSTRUCTION CAREERS TRAINING PROGRAM (HCCTP) TO HELP MEET WORKFORCE AND TRAINEE GOALS. THIS PROGRAM IS TRAINING MINORITIES, WOMEN AND DISADVANTAGED INDIVIDUALS IN HIGHWAY CONSTRUCTION-RELATED SKILLS, E.G., MATH FOR THE TRADES, JOB READINESS, TECHNICAL SKILLS COURSEWORK (CARPENTRY, CONCRETE FLATWORK, BLUEPRINT READING, SITE PLANS, SITE WORK, TOOLS USE, ETC.) AND OSHA 10 HOUR CERTIFICATION, TO PREPARE THEM FOR A CAREER IN THE HIGHWAY CONSTRUCTION TRADES. GRADUATES ARE WELL-TRAINED AND READY TO BECOME PRODUCTIVE ENTRY-LEVEL CONSTRUCTION WORKERS. PLEASE CONTACT THE DISTRICT 8 EEO OFFICE AT 618-346-3360 AND/OR THE HCCTP COORDINATOR AT 618-874-6528 TO LEARN MORE ABOUT THE PROGRAM AND FOR ASSISTANCE IN MEETING WORKFORCE AND TRAINEE GOALS.

- 6. TWO CHANGEABLE MESSAGE BOARDS SHALL BE REQUIRED FOR THIS PROJECT. BOTH SHALL BE PLACED TWO WEEKS PRIOR TO ANY LANE CLOSURE, ONE ON EACH END OF THE PROJECT. ONE SHALL REMAIN FOR THE DURATION OF THE CONTRACT AND PLACED AT THE DIRECTION OF THE ENGINEER.
- 7. EXISTING PAVEMENT MARKING SHALL BE AVOIDED DURING ROUTING AND SEALING OPERATIONS. IF PAVEMENT MARKING IS AFFECTED, IT SHALL BE REPLACED AT THE CONTRACTOR'S EXPENSE.
- 8. THE QUANTITY SHOWN IN THE PLANS FOR CRACK ROUTING AND SEALING IS AN ESTIMATE OF LONGITUDINAL LANE LINES INCLUDING SHOULDER (SHOULDER LINES NOT INCLUDED THROUGH THE C-D LANES AT I-255). LOCATION 1 (EAST OF I-55/70 TO WEST OF IL 157) IS ESTIMATED AT 232,100 FT AND LOCATION 2 (WEST OF GREENMOUNT TO WEST OF IL 4) IS ESTIMATED AT 239,300 FT.

- 9. ALL BRIDGES ARE OMITTED. NO CRACK ROUTING OR SEALING SHOULD BE PERFORMED ON THE FOLLOWING STRUCTURES:

082-0152	082-0160	082-0168	082-0181
082-0153	082-0161	082-0169	082-0182
082-0154	082-0162	082-0170	082-0183
082-0155	082-0163	082-0241	082-0184
082-0156	082-0164	082-0242	082-0187
082-0157	082-0165	082-0261	082-0188
082-0158	082-0166	082-0344	082-0189
082-0159	082-0167		

COMMITMENTS

NONE

REV. - MS

MODEL: Default
FILE: Main1_PlanRoom.dwg
PROJECT: I:\Projects\DOT\Office\District 8\Projects\DOT\76M66\CAD\Drawings\DOT\76M66-24-GenNote.dgn

USER NAME = lewisko	DESIGNED -	REVISED -
	DRAWN -	REVISED -
PLOT SCALE = 100.0000' / 1in.	CHECKED -	REVISED -
PLOT DATE = 5/31/2019	DATE -	REVISED -

**STATE OF ILLINOIS
DEPARTMENT OF TRANSPORTATION**

**INDEX OF SHEETS, HIGHWAY STANDARDS,
GENERAL NOTES & COMMITMENTS**

SCALE: NTS SHEET NO. OF SHEETS STA. TO STA.

F.A.I. RTE.	SECTION	COUNTY	TOTAL SHEETS	SHEET NO.
64	82-(1,2,3,4,5,6,7,8)CJS-1	ST. CLAIR	24	2
CONTRACT 76M66				
FED. ROAD DIST. NO. ILLINOIS FED. AID PROJECT				

MODEL: Default
 FILE: Main1: P:\uplanroom.dat: illinois.gov:PWIDOT\Documents\DOT_Offices\District 8\Projects\ID776M66\CAD\Drawings\ID776M66-shr-500.dgn

CODE NO.	ITEM	UNIT	TOTAL QUANTITY	CONSTR. CODE	
				ST. CLAIR	90% FED 10% ST.
				ROADWAY	
				0005	
				URBAN	
45100100	CRACK ROUTING (PAVEMENT)	FOOT	471400	471400	
45100200	CRACK FILLING	POUND	155562	155562	
67100100	MOBILIZATION	L SUM	1	1	
70107025	CHANGEABLE MESSAGE SIGN	CAL DA	35	35	
70200100	NIGHTTIME WORK ZONE LIGHTING	L SUM	1	1	
X7010216	TRAFFIC CONTROL AND PROTECTION, (SPECIAL)	L SUM	1	1	

REV. - MS

USER NAME = lewiska	DESIGNED -	REVISED -
	DRAWN -	REVISED -
PLOT SCALE = 100.0000 ' / in.	CHECKED -	REVISED -
PLOT DATE = 5/31/2019	DATE -	REVISED -

**STATE OF ILLINOIS
 DEPARTMENT OF TRANSPORTATION**

SUMMARY OF QUANTITIES

SCALE: SHEET OF SHEETS STA. TO STA.

F.A.I. RTE.	SECTION	COUNTY	TOTAL SHEETS	SHEET NO.
64	82-(1,2,3,4,5,6,7,8)CJS-1	ST. CLAIR	24	3
CONTRACT NO. 76M66				
ILLINOIS FED. AID PROJECT				

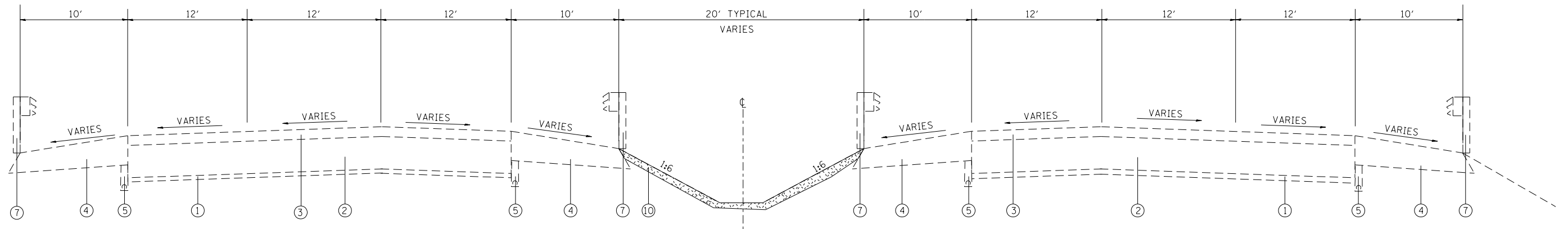

EXISTING I-64 MAINLINE
 STA. 87+58.20 TO STA. 100+62.55 (EB)
 STA. 87+46.38 TO STA. 100+72.52 (WB)

LEGEND

- ① EXISTING STABILIZED SUB-BASE 4"
- ② EXISTING CONTINUOUSLY REINFORCED PCC PAVEMENT, 8"
- ③ EXISTING HMA OVERLAY 3 1/4"
- ④ EXISTING HMA SHOULDERS +/- 12"
- ⑤ EXISTING PIPE UNDERDRAIN, 6"
- ⑥ EXISTING HMA OVERLAY 5"
- ⑦ EXISTING GUARDRAIL
- ⑧ EXISTING HIGH TENSION CABLE MEDIAN BARRIER
- ⑨ EXISTING MOW STRIP
- ⑩ EXISTING RIPRAP

MODEL: Default
 FILE NAME: \\s:\lanroom\dtd\illinois.gov\PIV\DOT\Documents\DOT_Offices\District_8\Projects\876M66\CADD\876M66-876M66-876M66-876M66.dwg

USER NAME = lewisko	DESIGNED -	REVISED -
	DRAWN -	REVISED -
PLOT SCALE = 100.0000' / 1"	CHECKED -	REVISED -
PLOT DATE = 5/31/2019	DATE -	REVISED -

**STATE OF ILLINOIS
 DEPARTMENT OF TRANSPORTATION**

TYPICAL SECTION

SCALE: NTS SHEET NO. OF SHEETS STA. TO STA.

F.A.I. RTE.	SECTION	COUNTY	TOTAL SHEETS	SHEET NO.
64	82-(1,2,3,4,5,6,7,8)CJS-1	ST. CLAIR	24	4
CONTRACT 76M66				
FED. ROAD DIST. NO.		ILLINOIS FED. AID PROJECT		

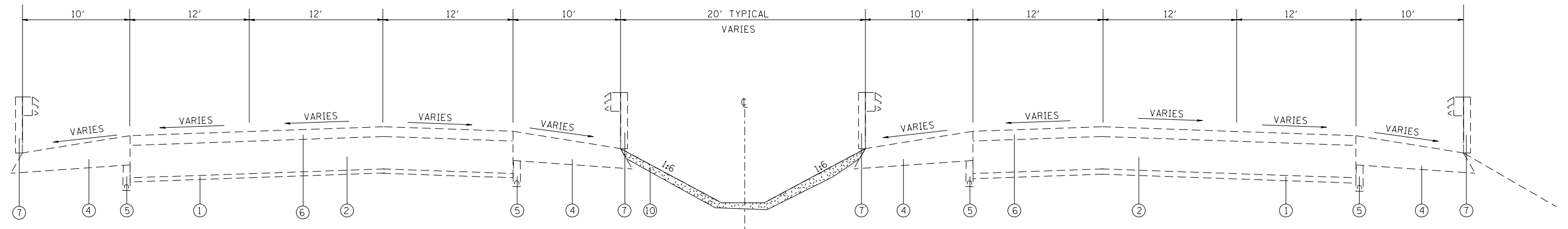

EXISTING I-64 MAINLINE
 STA. 100+62.55 TO STA. 121+69.35 (EB)
 STA. 100+72.52 TO STA. 121+82.72 (WB)

LEGEND

- ① EXISTING STABILIZED SUB-BASE 4"
- ② EXISTING CONTINUOUSLY REINFORCED PCC PAVEMENT, 8"
- ③ EXISTING HMA OVERLAY 3 1/4"
- ④ EXISTING HMA SHOULDERS +/- 12"
- ⑤ EXISTING PIPE UNDERDRAIN, 6"
- ⑥ EXISTING HMA OVERLAY 5"
- ⑦ EXISTING GUARDRAIL
- ⑧ EXISTING HIGH TENSION CABLE MEDIAN BARRIER
- ⑨ EXISTING MOW STRIP
- ⑩ EXISTING RIPRAP

MODEL: Default
 FILE NAME: \\s:\lanroom\dot\illinois.gov\PIV\DOT\Documents\DOT_Offices\District_8\Projects\876M66\CADD\876M66-876M66-876M66-876M66.dgn

USER NAME = lewisko	DESIGNED -	REVISED -
	DRAWN -	REVISED -
PLOT SCALE = 100.0000' / 1"	CHECKED -	REVISED -
PLOT DATE = 5/31/2019	DATE -	REVISED -

**STATE OF ILLINOIS
 DEPARTMENT OF TRANSPORTATION**

TYPICAL SECTION

SCALE: NTS SHEET NO. OF SHEETS STA. TO STA.

F.A.I. RTE.	SECTION	COUNTY	TOTAL SHEETS	SHEET NO.
64	82-(1,2,3,4,5,6,7,8)CJS-1	ST. CLAIR	24	5
CONTRACT 76M66				
FED. ROAD DIST. NO.		ILLINOIS FED. AID PROJECT		

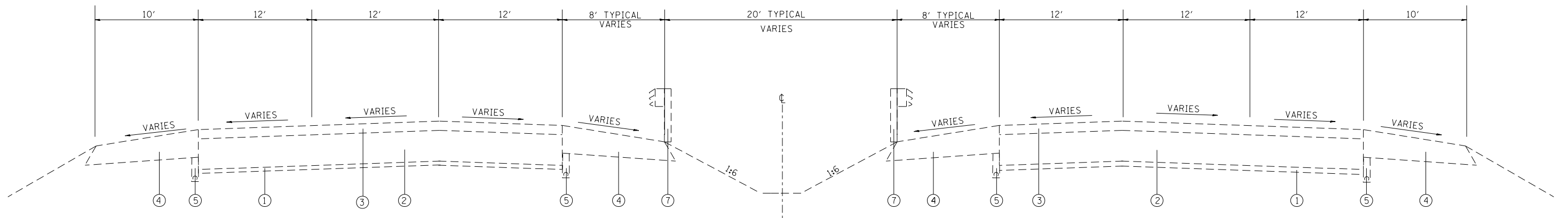

EXISTING I-64 MAINLINE
 STA. STA. 121+69.35 TO STA. 149+90 (EB)
 STA. STA. 121+82.72 TO STA. 149+90 (WB)

LEGEND

- ① EXISTING STABILIZED SUB-BASE 4"
- ② EXISTING CONTINUOUSLY REINFORCED PCC PAVEMENT, 8"
- ③ EXISTING HMA OVERLAY 3 1/4"
- ④ EXISTING HMA SHOULDERS +/- 12"
- ⑤ EXISTING PIPE UNDERDRAIN, 6"
- ⑥ EXISTING HMA OVERLAY 5"
- ⑦ EXISTING GUARDRAIL
- ⑧ EXISTING HIGH TENSION CABLE MEDIAN BARRIER
- ⑨ EXISTING MOW STRIP
- ⑩ EXISTING RIPRAP

MODEL: Default
 FILE NAME: \\s:\lanroom\dtd\illinois.dot\illinois\p\w\dot\Documents\DOT_Office\District_8\Projects\82-(1,2,3,4,5,6,7,8)CJS-1\CAD\Drawings\82-(1,2,3,4,5,6,7,8)CJS-1.dgn

USER NAME = lewisko	DESIGNED -	REVISED -
	DRAWN -	REVISED -
PLOT SCALE = 100.0000' / 1" =	CHECKED -	REVISED -
PLOT DATE = 5/31/2019	DATE -	REVISED -

**STATE OF ILLINOIS
 DEPARTMENT OF TRANSPORTATION**

TYPICAL SECTION

SCALE: NTS SHEET NO. OF SHEETS STA. TO STA.

F.A.I. RTE.	SECTION	COUNTY	TOTAL SHEETS	SHEET NO.
64	82-(1,2,3,4,5,6,7,8)CJS-1	ST. CLAIR	24	6
CONTRACT 76M66				
FED. ROAD DIST. NO.		ILLINOIS FED. AID PROJECT		

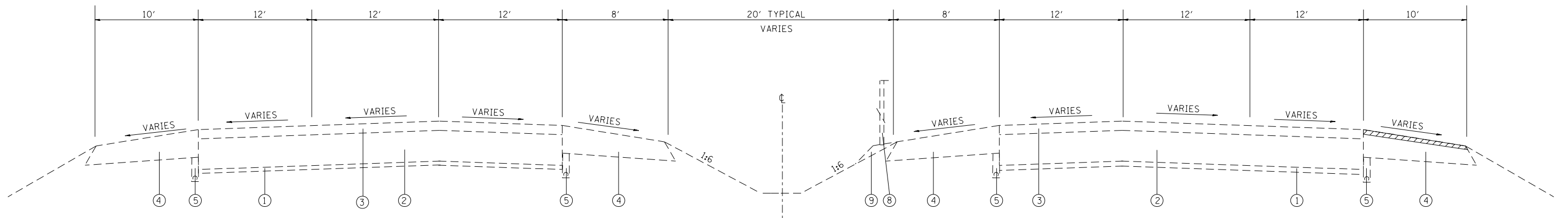

EXISTING I-64 MAINLINE
 STA. 149+90 TO STA. 163+62
 STA. 195+25 TO STA. 213+00
 STA. 232+22 TO STA. 245+32.45

LEGEND

- ① EXISTING STABILIZED SUB-BASE 4"
- ② EXISTING CONTINUOUSLY REINFORCED PCC PAVEMENT, 8"
- ③ EXISTING HMA OVERLAY 3 1/4"
- ④ EXISTING HMA SHOULDERS +/- 12"
- ⑤ EXISTING PIPE UNDERDRAIN, 6"
- ⑥ EXISTING HMA OVERLAY 5"
- ⑦ EXISTING GUARDRAIL
- ⑧ EXISTING HIGH TENSION CABLE MEDIAN BARRIER
- ⑨ EXISTING MOW STRIP
- ⑩ EXISTING RIPRAP

MODEL: Default
 FILE NAME: p:\s\planroom\dot\illinois.gov\pww\DOT\Documents\IDOT_Offices\District_8\Projects\876M66\CADData\CADSheets\876M66-sh-typical.dgn

USER NAME = lewiska	DESIGNED -	REVISED -
	DRAWN -	REVISED -
PLOT SCALE = 100.0000' / in.	CHECKED -	REVISED -
PLOT DATE = 5/31/2019	DATE -	REVISED -

**STATE OF ILLINOIS
 DEPARTMENT OF TRANSPORTATION**

TYPICAL SECTION

SCALE: NTS SHEET NO. OF SHEETS STA. TO STA.

F.A.I. RTE.	SECTION	COUNTY	TOTAL SHEETS	SHEET NO.
64	82-(1,2,3,4,5,6,7,8)CJS-1	ST. CLAIR	24	7
CONTRACT 76M66				
FED. ROAD DIST. NO.	ILLINOIS FED. AID PROJECT			

MODEL: Default
 FILE NAME: \\s:\planroom\dot\illinois\gov\FWIDOT\Documents\IDOT_Offices\District_8\Projects\B76M66\CADData\CADSheets\B76M66-sh1-yp1-cal.dgn

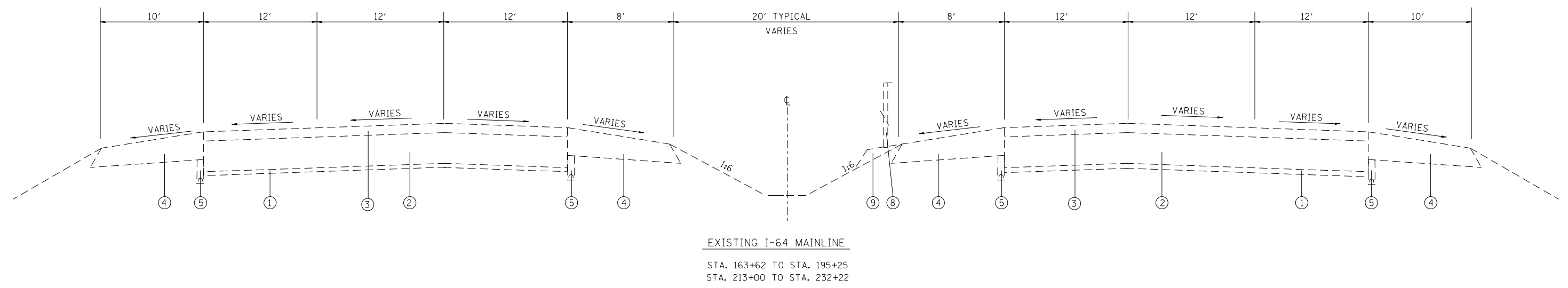

EXISTING I-64 MAINLINE
 STA. 163+62 TO STA. 195+25
 STA. 213+00 TO STA. 232+22

LEGEND

- ① EXISTING STABILIZED SUB-BASE 4"
- ② EXISTING CONTINUOUSLY REINFORCED PCC PAVEMENT, 8"
- ③ EXISTING HMA OVERLAY 3 1/4"
- ④ EXISTING HMA SHOULDERS +/- 12"
- ⑤ EXISTING PIPE UNDERDRAIN, 6"
- ⑥ EXISTING HMA OVERLAY 5"
- ⑦ EXISTING GUARDRAIL
- ⑧ EXISTING HIGH TENSION CABLE MEDIAN BARRIER
- ⑨ EXISTING MOW STRIP
- ⑩ EXISTING RIPRAP

USER NAME = lewisko	DESIGNED -	REVISED -
	DRAWN -	REVISED -
PLOT SCALE = 100.0000' / 1"	CHECKED -	REVISED -
PLOT DATE = 5/31/2019	DATE -	REVISED -

STATE OF ILLINOIS
DEPARTMENT OF TRANSPORTATION

TYPICAL SECTION

SCALE: NTS SHEET NO. OF SHEETS STA. TO STA.

F.A.I. RTE.	SECTION	COUNTY	TOTAL SHEETS	SHEET NO.
64	82-(1,2,3,4,5,6,7,8)CJS-1	ST. CLAIR	24	8
CONTRACT 76M66				
FED. ROAD DIST. NO.		ILLINOIS FED. AID PROJECT		

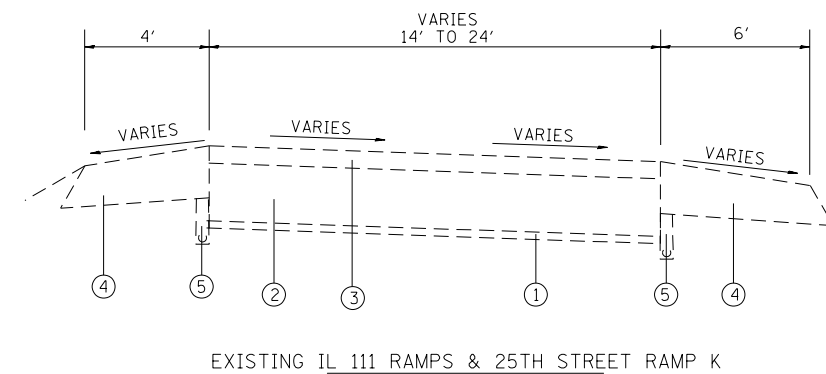
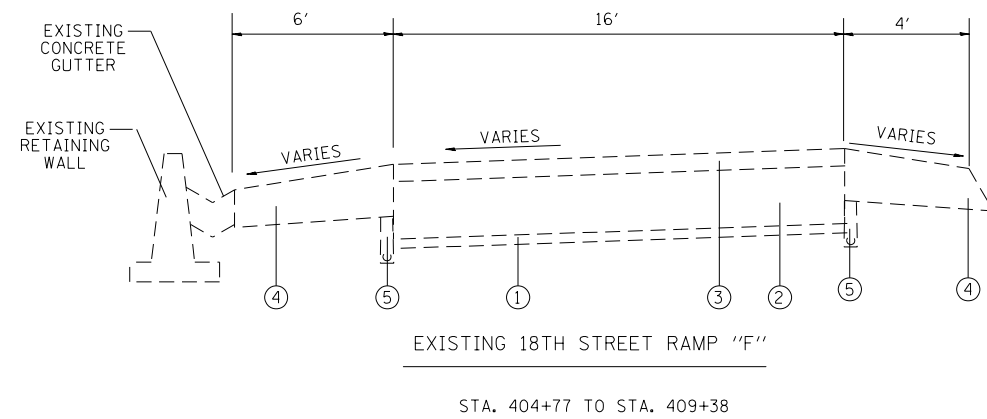

LEGEND

- ① EXISTING STABILIZED SUB-BASE 4"
- ② EXISTING CONTINUOUSLY REINFORCED PCC PAVEMENT, 8"
- ③ EXISTING HMA OVERLAY 3 1/4"
- ④ EXISTING HMA SHOULDERS +/- 12"
- ⑤ EXISTING PIPE UNDERDRAIN, 6"
- ⑥ EXISTING HMA OVERLAY 5"
- ⑦ EXISTING GUARDRAIL
- ⑧ EXISTING HIGH TENSION CABLE MEDIAN BARRIER
- ⑨ EXISTING MOW STRIP
- ⑩ EXISTING RIPRAP

MODEL: Default
 FILE NAME: \\s:\lanroom\dot\illinois.gov\PIV\DOT\Documents\DOT_Offices\District_8\Projects\1876M66\CADDData\CAD\sheet\1876M66-1876M66-1876M66.dgn

USER NAME = lewisko	DESIGNED -	REVISED -
	DRAWN -	REVISED -
PLOT SCALE = 100.0000' / 1"	CHECKED -	REVISED -
PLOT DATE = 5/31/2019	DATE -	REVISED -

**STATE OF ILLINOIS
DEPARTMENT OF TRANSPORTATION**

TYPICAL SECTION

SCALE: NTS SHEET NO. OF SHEETS STA. TO STA.

F.A.I. RTE.	SECTION	COUNTY	TOTAL SHEETS	SHEET NO.
64	82-(1,2,3,4,5,6,7,8)CJS-1	ST. CLAIR	24	9
CONTRACT 76M66				
FED. ROAD DIST. NO. ILLINOIS FED. AID PROJECT				

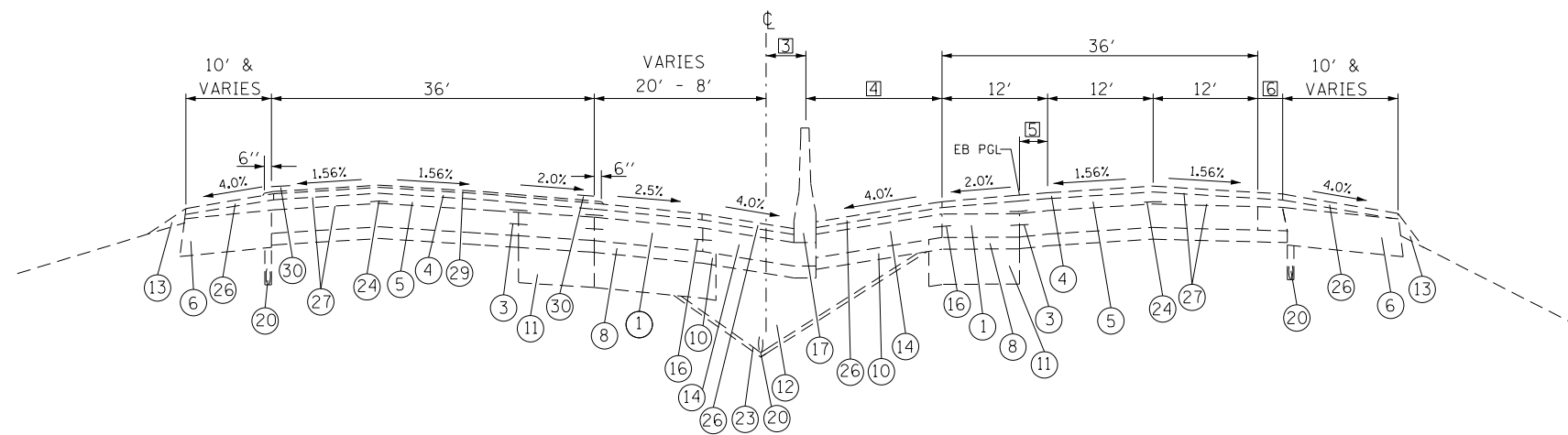

STA. 337+00 TO STA. 347+89.14 EB
 STA. 337+00 TO STA. 346+66.94 WB
 3 VARIES 0' (STA. 337+00) TO 6' (STA. 345+51.58)
 4 VARIES 8' (STA. 337+00) TO 14' (STA. 346+01.58)
 5 VARIES 12' (STA. 337+00) TO 0' (STA. 346+01.58)
 6 VARIES

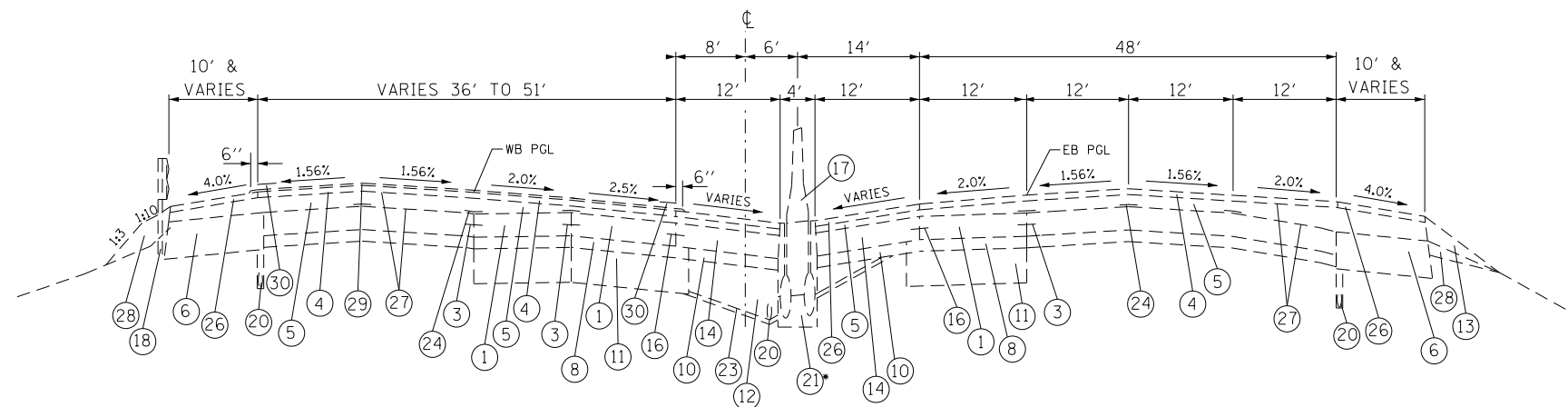

STA. 347+89.14 TO STA. 351+51.50 EB
 STA. 346+66.94 TO STA. 351+51.50 WB
 BRIDGE OMISSION WB STA. 349+15.20 TO 351+51.50

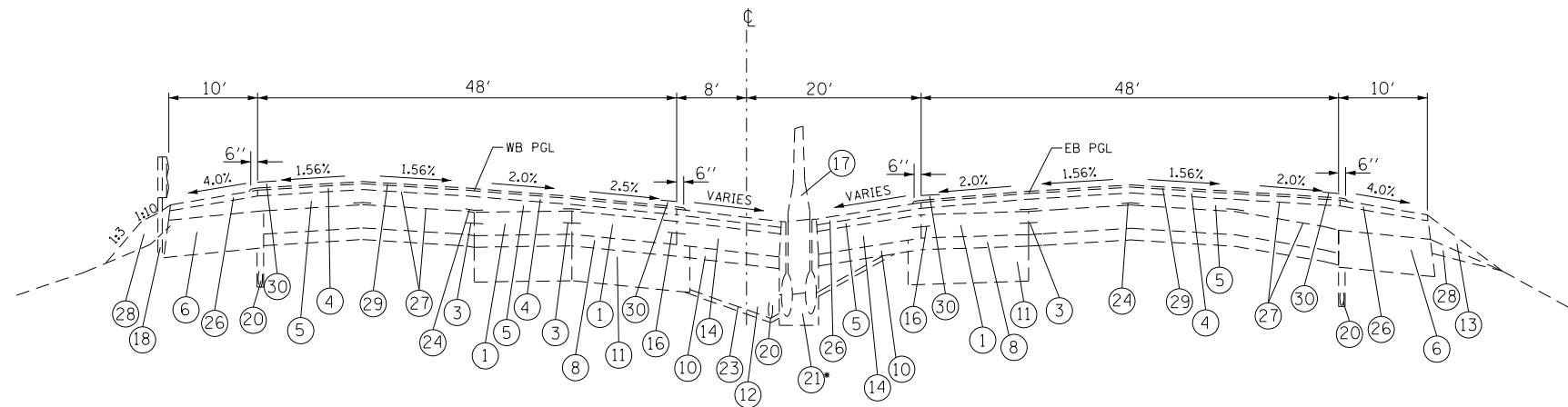

STA. 351+51.50 TO STA. 352+34

LEGEND

- ① EXISTING CONTINUOUSLY REINFORCED PORTLAND CEMENT CONCRETE PAVEMENT 8"
- ② EXISTING CONTINUOUSLY REINFORCED PORTLAND CEMENT CONCRETE PAVEMENT 9"
- ③ EXISTING LONGITUDINAL CONSTRUCTION JOINT - USE NO. 6 EPOXY COATED DEFORMED TIE BARS AT 24" C-C AND 24" LONG, DRILLED AND GROUTED
- ④ EXISTING POLYMERIZED BITUMINOUS CONCRETE SURFACE COURSE, STONE MATRIX ASPHALT, CLASS I (2")
- ⑤ EXISTING POLYMERIZED BITUMINOUS CONCRETE BINDER COURSE, SUPERPAVE, IL-19.0, N105 (2-1/4" & VARIES)
- ⑥ EXISTING 13" BITUMINOUS SHOULDER
- ⑦ EXISTING 8" BITUMINOUS SHOULDER
- ⑧ EXISTING STABILIZED SUB-BASE 4"
- ⑨ EXISTING SUB-BASE GRANULAR MATERIAL, TYPE B 12"
- ⑩ EXISTING SUB-BASE GRANULAR MATERIAL, TYPE A 4"
- ⑪ EXISTING AGGREGATE SUBGRADE 12"
- ⑫ EXISTING POROUS GRANULAR EMBANKMENT, SUBGRADE
- ⑬ EXISTING AGGREGATE SHOULDER, TYPE B
- ⑭ EXISTING PORTLAND CEMENT CONCRETE SHOULDERS 8"
- ⑮ EXISTING PORTLAND CEMENT CONCRETE SHOULDERS 9"
- ⑯ EXISTING LONGITUDINAL CONSTRUCTION JOINT - USE 3/4 INCH EPOXY COATED SMOOTH DOWEL BARS AT 24" C-C AND 24" LONG
- ⑰ EXISTING CONCRETE BARRIER, CONCRETE BARRIER (MODIFIED), CONCRETE BARRIER (SPECIAL), OR CONCRETE BARRIER TRANSITION
- ⑱ EXISTING GUARDRAIL
- ⑲ EXISTING BITUMINOUS SHOULDER CURB
- ⑳ EXISTING PIPE UNDERDRAINS 6"
- ㉑ EXISTING SLOTTED DRAIN STRUCTURE
- ㉒ EXISTING STORM SEWER
- ㉓ EXISTING FILTER FABRIC
- ㉔ EXISTING STRIP REFLECTIVE CRACK CONTROL TREATMENT
- ㉕ EXISTING NOISE ABATEMENT WALL
- ㉖ EXISTING BITUMINOUS CONCRETE SURFACE COURSE, SUPERPAVE, MIX "C", N50 (2")
- ㉗ EXISTING BITUMINOUS MATERIALS (PRIME COAT)
- ㉘ EXISTING EMBANKMENT
- ㉙ EXISTING MICRO-SURFACING SINGLE PASS, TYPE II, 1/2" (WITH RUT FILLING)
- ㉚ EXISTING THERMOPLASTIC PAVEMENT MARKING, EDGELINE

MODEL: Default
 FILE NAME: \\s:\lanroom.doe\illinois.gov\PIV\DOT\Documents\DOT_Offices\Bartlett_8\Projects\0876M66\CADD\01\CAD\Sheet\0876M66-1hts\typical.dgn

USER NAME = lewisko	DESIGNED -	REVISED -
PLOT SCALE = 100.0000' / 1"	DRAWN -	REVISED -
PLOT DATE = 5/31/2019	CHECKED -	REVISED -
	DATE -	REVISED -

STATE OF ILLINOIS
DEPARTMENT OF TRANSPORTATION

TYPICAL SECTION

SCALE: NTS SHEET NO. OF SHEETS STA. TO STA.

F.A.I. RTE.	SECTION	COUNTY	TOTAL SHEETS	SHEET NO.
64	82-(1,2,3,4,5,6,7,8)CJS-1	ST. CLAIR	24	10
CONTRACT 76M66				
FED. ROAD DIST. NO.		ILLINOIS FED. AID PROJECT		

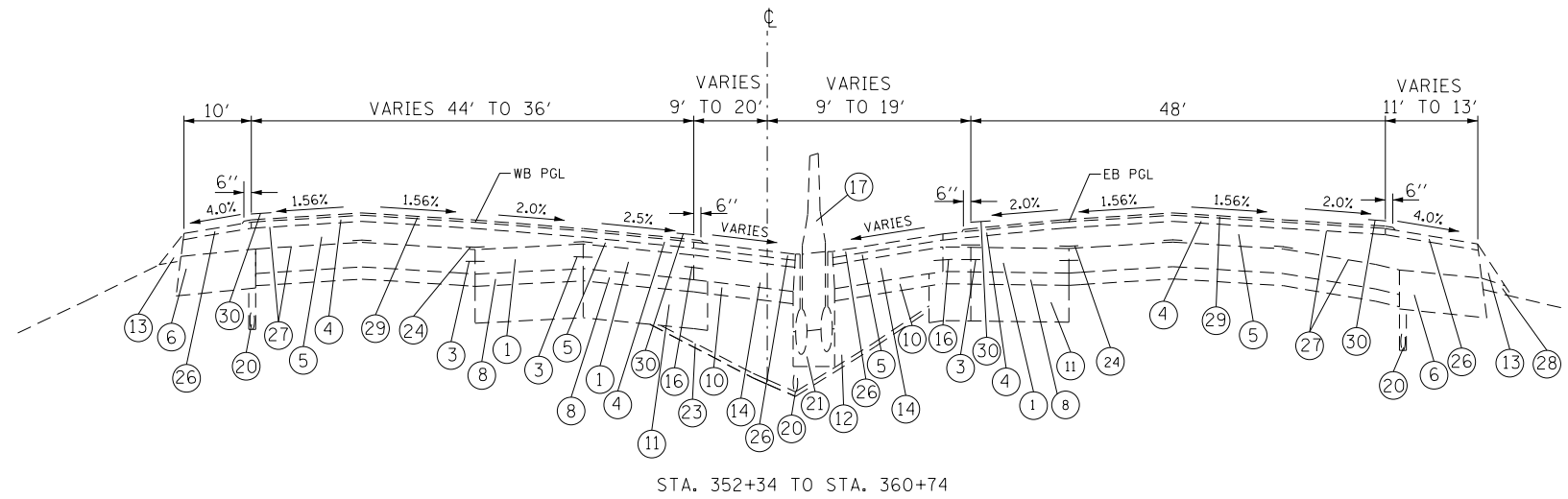

STA. 352+34 TO STA. 360+74

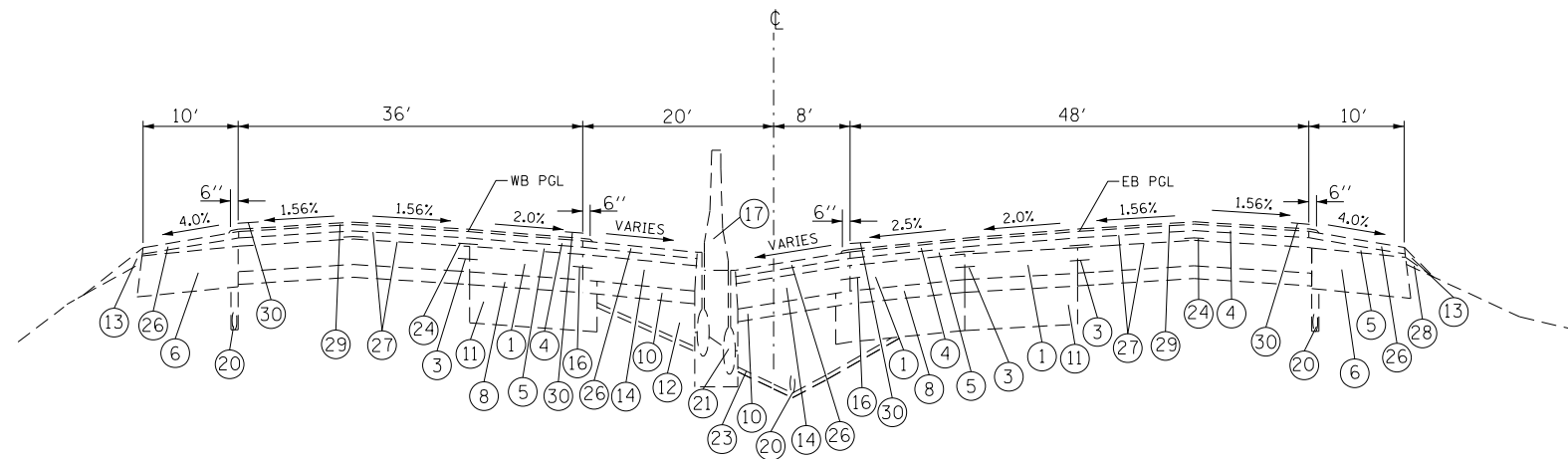

STA. 360+74 TO STA. 367+00

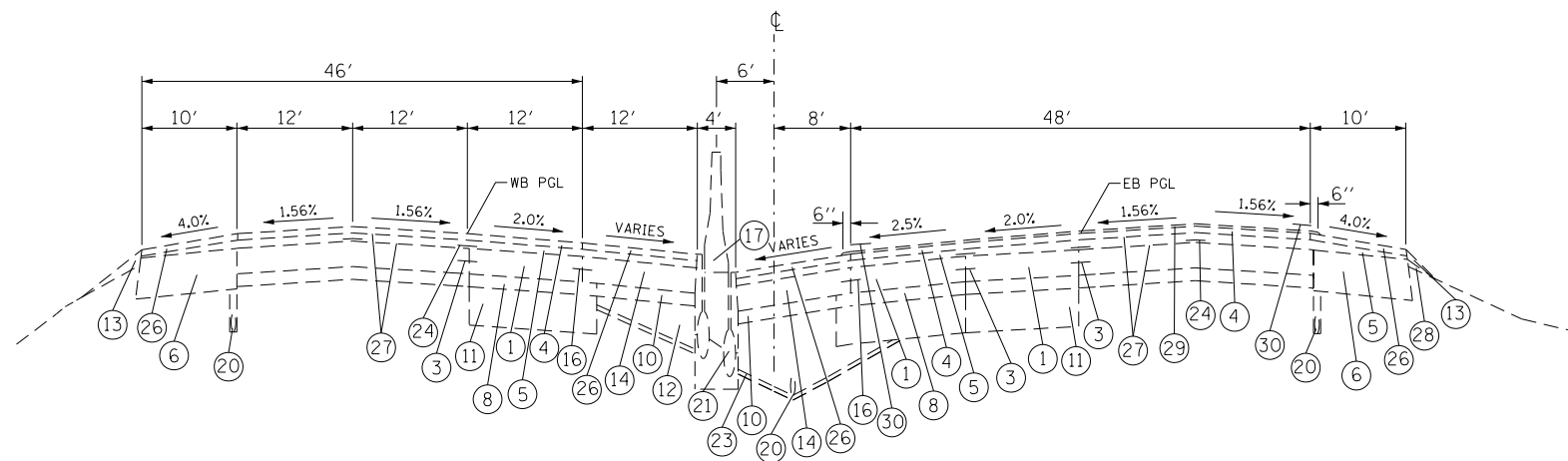

STA. 367+00 TO STA. 400+00

LEGEND

- ① EXISTING CONTINUOUSLY REINFORCED PORTLAND CEMENT CONCRETE PAVEMENT 8"
- ② EXISTING CONTINUOUSLY REINFORCED PORTLAND CEMENT CONCRETE PAVEMENT 9"
- ③ EXISTING LONGITUDINAL CONSTRUCTION JOINT - USE NO. 6 EPOXY COATED DEFORMED TIE BARS AT 24" C-C AND 24" LONG, DRILLED AND GROUDED
- ④ EXISTING POLYMERIZED BITUMINOUS CONCRETE SURFACE COURSE, STONE MATRIX ASPHALT, CLASS 1 (2")
- ⑤ EXISTING POLYMERIZED BITUMINOUS CONCRETE BINDER COURSE, SUPERPAVE, IL-19.0, N105 (2-1/4" & VARIES)
- ⑥ EXISTING 13" BITUMINOUS SHOULDER
- ⑦ EXISTING 8" BITUMINOUS SHOULDER
- ⑧ EXISTING STABILIZED SUB-BASE 4"
- ⑨ EXISTING SUB-BASE GRANULAR MATERIAL, TYPE B 12"
- ⑩ EXISTING SUB-BASE GRANULAR MATERIAL, TYPE A 4"
- ⑪ EXISTING AGGREGATE SUBGRADE 12"
- ⑫ EXISTING POROUS GRANULAR EMBANKMENT, SUBGRADE
- ⑬ EXISTING AGGREGATE SHOULDER, TYPE B
- ⑭ EXISTING PORTLAND CEMENT CONCRETE SHOULDERS 8"
- ⑮ EXISTING PORTLAND CEMENT CONCRETE SHOULDERS 9"
- ⑯ EXISTING LONGITUDINAL CONSTRUCTION JOINT - USE 3/4 INCH EPOXY COATED SMOOTH DOWEL BARS AT 24" C-C AND 24" LONG
- ⑰ EXISTING CONCRETE BARRIER, CONCRETE BARRIER (MODIFIED), CONCRETE BARRIER (SPECIAL), OR CONCRETE BARRIER TRANSITION
- ⑱ EXISTING GUARDRAIL
- ⑲ EXISTING BITUMINOUS SHOULDER CURB
- ⑳ EXISTING PIPE UNDERDRAINS 6"
- ㉑ EXISTING SLOTTED DRAIN STRUCTURE
- ㉒ EXISTING STORM SEWER
- ㉓ EXISTING FILTER FABRIC
- ㉔ EXISTING STRIP REFLECTIVE CRACK CONTROL TREATMENT
- ㉕ EXISTING NOISE ABATEMENT WALL
- ㉖ EXISTING BITUMINOUS CONCRETE SURFACE COURSE, SUPERPAVE, MIX "C", N50 (2")
- ㉗ EXISTING BITUMINOUS MATERIALS (PRIME COAT)
- ㉘ EXISTING EMBANKMENT
- ㉙ EXISTING MICRO-SURFACING SINGLE PASS, TYPE II, 1/2" (WITH RUT FILLING)
- ㉚ EXISTING THERMOPLASTIC PAVEMENT MARKING, EDGELINE

MODEL: Default
 FILE NAME: \\s:\lanroom.doe\illinois.gov\PI\DOT\Documents\DOT_Offices\Bartlett_8\Projects\0876M66\CADD\01\CAD\Sheet\0876M66-111111.dgn

USER NAME = lewisko	DESIGNED -	REVISED -
	DRAWN -	REVISED -
PLOT SCALE = 100.0000' / 1"	CHECKED -	REVISED -
PLOT DATE = 5/31/2019	DATE -	REVISED -

**STATE OF ILLINOIS
DEPARTMENT OF TRANSPORTATION**

TYPICAL SECTION

SCALE: NTS SHEET NO. OF SHEETS STA. TO STA.

F.A.I. RTE.	SECTION	COUNTY	TOTAL SHEETS	SHEET NO.
64	82-(1,2,3,4,5,6,7,8)CJS-1	ST. CLAIR	24	11
CONTRACT 76M66				
FED. ROAD DIST. NO.		ILLINOIS FED. AID PROJECT		

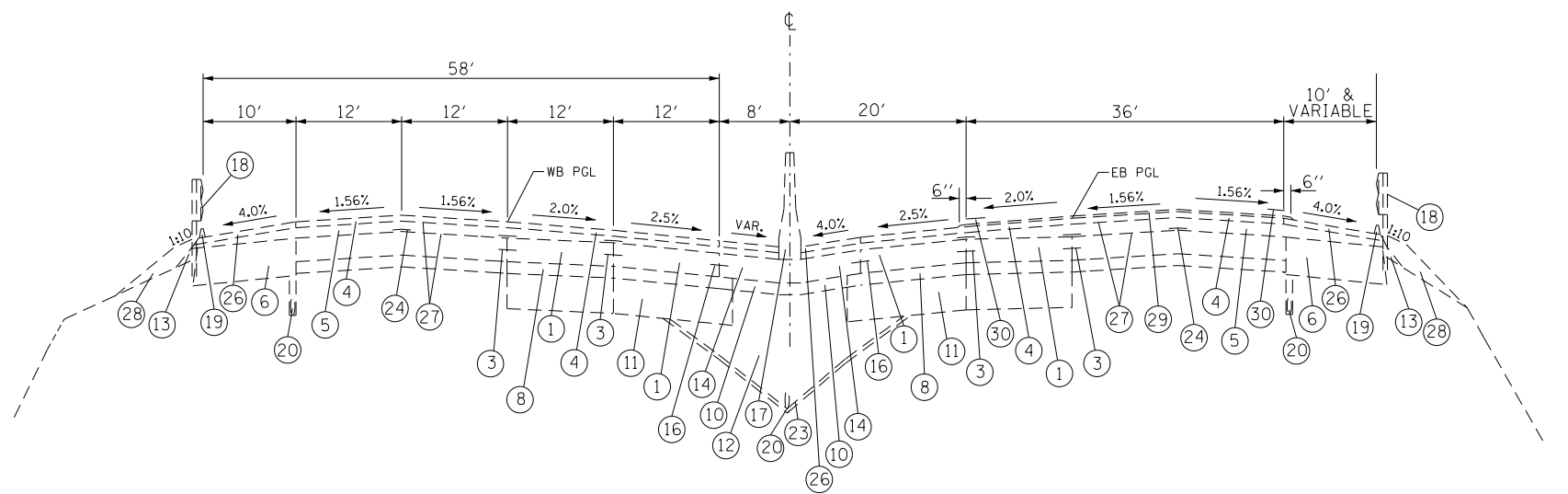

STA. 417+08.89 TO STA. 435+43.93 EB
 STA. 434+54.13 WB

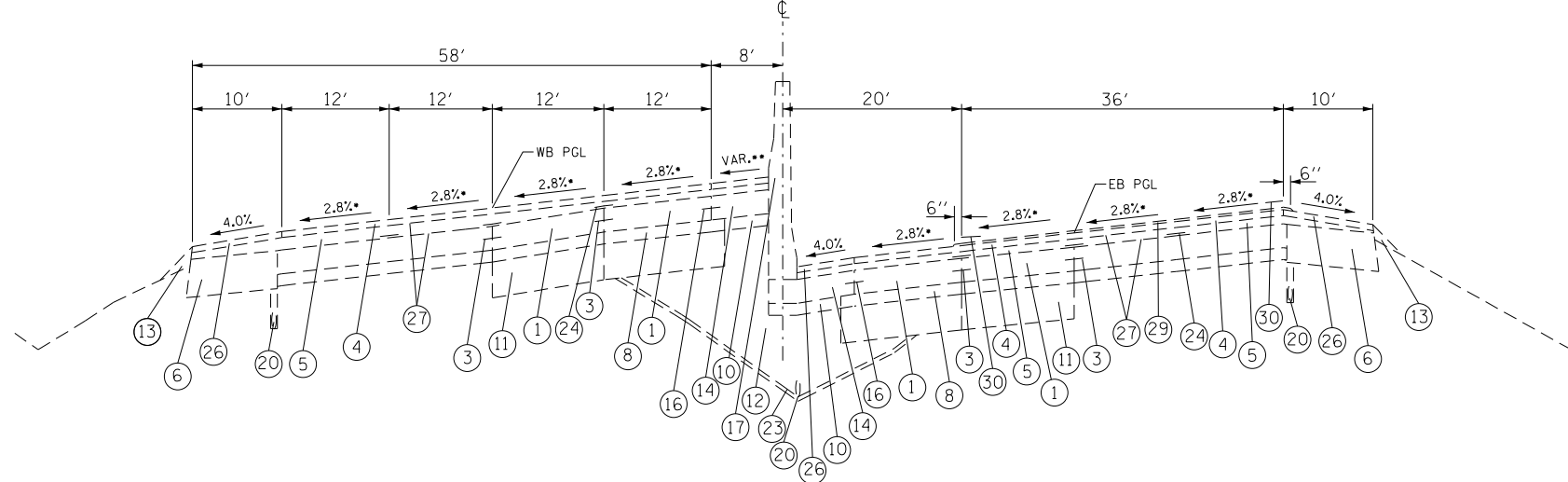

STA. 435+43.93 EB TO STA. 443+00 EB
 STA. 434+54.13 WB TO STA. 443+00 WB

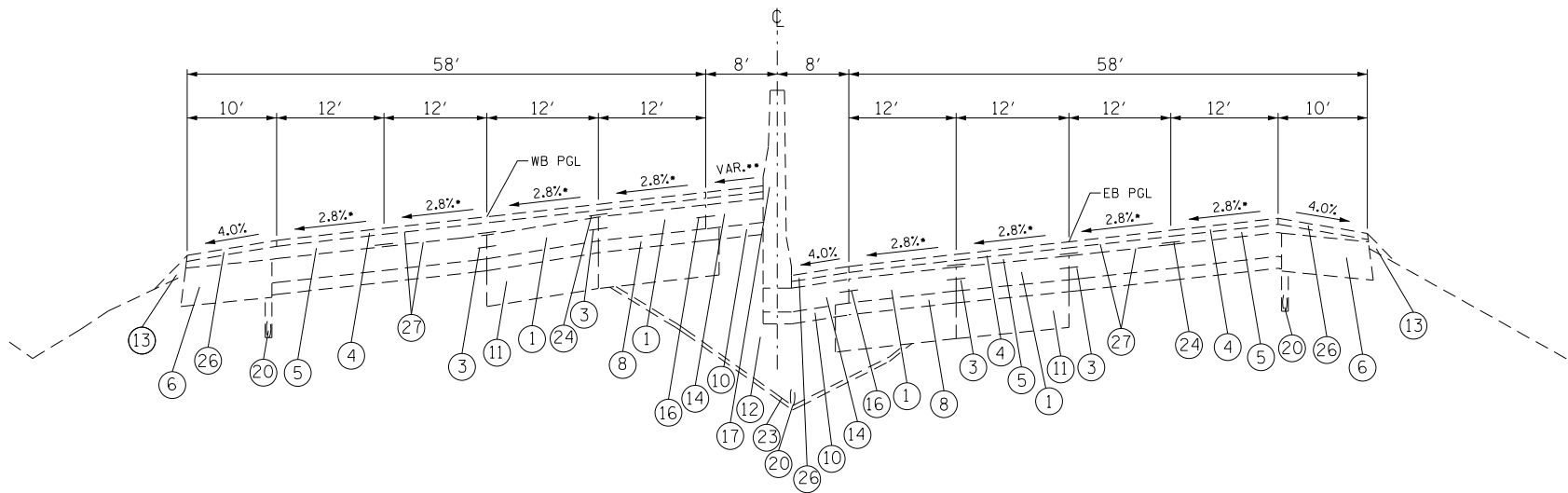

STA. 443+00 EB TO STA. 452+41.86 EB
 STA. 443+00 WB TO STA. 451+93.21 WB
 STA. 456+82.38 EB TO STA. 466+57.16 EB
 STA. 458+93.21 WB TO STA. 467+46.96 WB
 STA. 548+60.20 EB TO STA. 559+48.32 EB
 STA. 547+70.40 WB TO STA. 560+38.12 WB

- LEGEND
- ① EXISTING CONTINUOUSLY REINFORCED PORTLAND CEMENT CONCRETE PAVEMENT 8"
 - ② EXISTING CONTINUOUSLY REINFORCED PORTLAND CEMENT CONCRETE PAVEMENT 9"
 - ③ EXISTING LONGITUDINAL CONSTRUCTION JOINT - USE NO. 6 EPOXY COATED DEFORMED TIE BARS AT 24" C-C AND 24" LONG, DRILLED AND GROUTED
 - ④ EXISTING POLYMERIZED BITUMINOUS CONCRETE SURFACE COURSE, STONE MATRIX ASPHALT, CLASS I (2")
 - ⑤ EXISTING POLYMERIZED BITUMINOUS CONCRETE BINDER COURSE, SUPERPAVE, IL-19.0, N105 (2-1/4" & VARIES)
 - ⑥ EXISTING 13" BITUMINOUS SHOULDER
 - ⑦ EXISTING 8" BITUMINOUS SHOULDER
 - ⑧ EXISTING STABILIZED SUB-BASE 4"
 - ⑨ EXISTING SUB-BASE GRANULAR MATERIAL, TYPE B 12"
 - ⑩ EXISTING SUB-BASE GRANULAR MATERIAL, TYPE A 4"
 - ⑪ EXISTING AGGREGATE SUBGRADE 12"
 - ⑫ EXISTING POROUS GRANULAR EMBANKMENT, SUBGRADE
 - ⑬ EXISTING AGGREGATE SHOULDER, TYPE B
 - ⑭ EXISTING PORTLAND CEMENT CONCRETE SHOULDERS 8"
 - ⑮ EXISTING PORTLAND CEMENT CONCRETE SHOULDERS 9"
 - ⑯ EXISTING LONGITUDINAL CONSTRUCTION JOINT - USE 3/4 INCH EPOXY COATED SMOOTH DOWEL BARS AT 24" C-C AND 24" LONG
 - ⑰ EXISTING CONCRETE BARRIER, CONCRETE BARRIER (MODIFIED), CONCRETE BARRIER (SPECIAL), OR CONCRETE BARRIER TRANSITION
 - ⑱ EXISTING GUARDRAIL
 - ⑲ EXISTING BITUMINOUS SHOULDER CURB
 - ⑳ EXISTING PIPE UNDERDRAINS 6"
 - ㉑ EXISTING SLOTTED DRAIN STRUCTURE
 - ㉒ EXISTING STORM SEWER
 - ㉓ EXISTING FILTER FABRIC
 - ㉔ EXISTING STRIP REFLECTIVE CRACK CONTROL TREATMENT
 - ㉕ EXISTING NOISE ABATEMENT WALL
 - ㉖ EXISTING BITUMINOUS CONCRETE SURFACE COURSE, SUPERPAVE, MIX "C", N50 (2")
 - ㉗ EXISTING BITUMINOUS MATERIALS (PRIME COAT)
 - ㉘ EXISTING EMBANKMENT
 - ㉙ EXISTING MICRO-SURFACING SINGLE PASS, TYPE II, 1/2" (WITH RUT FILLING)
 - ㉚ EXISTING THERMOPLASTIC PAVEMENT MARKING, EDGELINE

MODEL: Default
 FILE NAME: p:\planroom\dot\illinois\dot\Office\DOT\Documents\DOT\Projects\DOT\CAD\Sheet\DOT\876M66\sh-s\typical.dgn

USER NAME = lewiska	DESIGNED -	REVISED -
PLOT SCALE = 100.0000' / in.	DRAWN -	REVISED -
PLOT DATE = 5/31/2019	CHECKED -	REVISED -
	DATE -	REVISED -

**STATE OF ILLINOIS
 DEPARTMENT OF TRANSPORTATION**

TYPICAL SECTION	
SCALE: NTS	SHEET NO. OF SHEETS STA. TO STA.

F.A.I. RTE.	SECTION	COUNTY	TOTAL SHEETS	SHEET NO.
64	82-11,2,3,4,5,6,7,8CJS-1	ST. CLAIR	24	13
CONTRACT 76M66				
FED. ROAD DIST. NO.	ILLINOIS	FED. AID PROJECT		

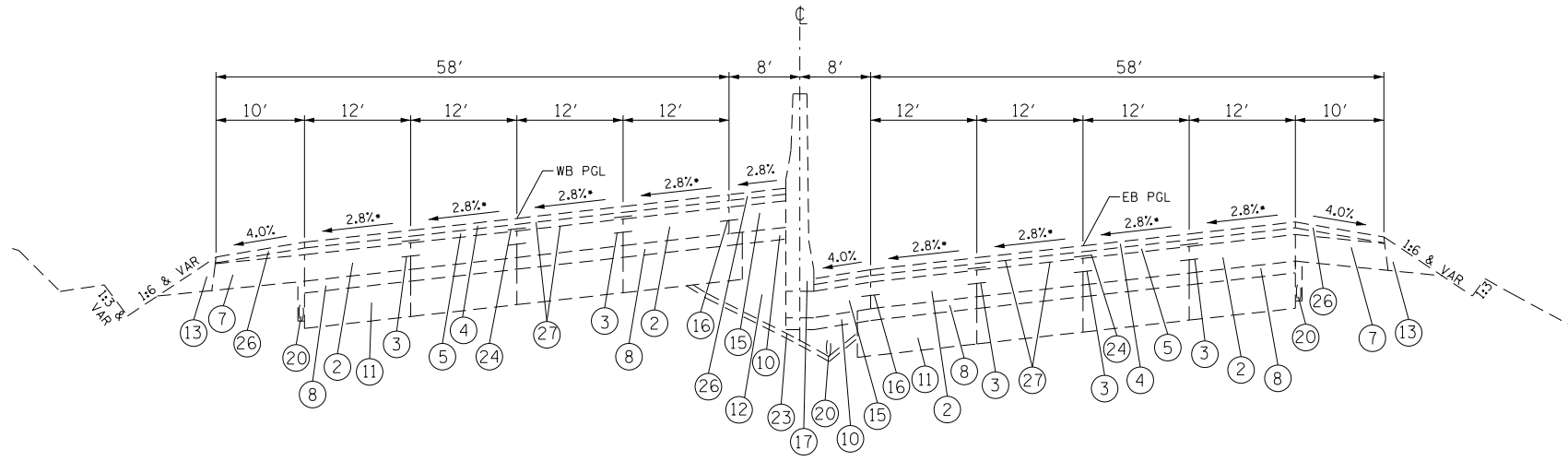

STA. 452+41.86 EB TO STA. 456+82.38 EB
 STA. 451+93.21 WB TO STA. 458+93.21 WB

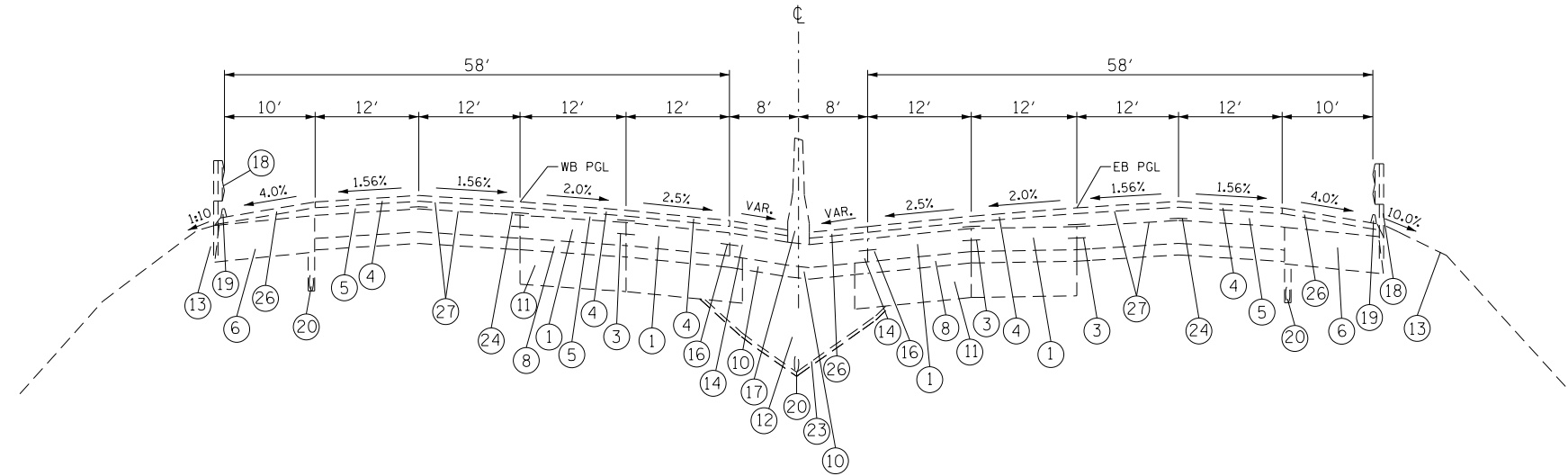

STA. 466+57.16 EB TO STA. 506+92.82 EB
 STA. 467+46.96 WB TO STA. 504+07.00 WB
 STA. 521+38.92 EB TO STA. 548+60.20 EB
 STA. 510+34.00 WB TO STA. 547+70.40 WB
 STA. 607+83.78 EB TO STA. 613+80.02
 STA. 606+93.98 WB
 STA. 693+92.51 EB TO STA. 725+00 EB
 STA. 692+18.71 WB TO STA. 705+00 WB

LEGEND

- ① EXISTING CONTINUOUSLY REINFORCED PORTLAND CEMENT CONCRETE PAVEMENT 8"
- ② EXISTING CONTINUOUSLY REINFORCED PORTLAND CEMENT CONCRETE PAVEMENT 9"
- ③ EXISTING LONGITUDINAL CONSTRUCTION JOINT - USE NO. 6 EPOXY COATED DEFORMED TIE BARS AT 24" C-C AND 24" LONG, DRILLED AND GROUTED
- ④ EXISTING POLYMERIZED BITUMINOUS CONCRETE SURFACE COURSE, STONE MATRIX ASPHALT, CLASS I (2")
- ⑤ EXISTING POLYMERIZED BITUMINOUS CONCRETE BINDER COURSE, SUPERPAVE, IL-19.0, N105 (2-1/4" & VARIES)
- ⑥ EXISTING 13" BITUMINOUS SHOULDER
- ⑦ EXISTING 8" BITUMINOUS SHOULDER
- ⑧ EXISTING STABILIZED SUB-BASE 4"
- ⑨ EXISTING SUB-BASE GRANULAR MATERIAL, TYPE B 12"
- ⑩ EXISTING SUB-BASE GRANULAR MATERIAL, TYPE A 4"
- ⑪ EXISTING AGGREGATE SUBGRADE 12"
- ⑫ EXISTING POROUS GRANULAR EMBANKMENT, SUBGRADE
- ⑬ EXISTING AGGREGATE SHOULDER, TYPE B
- ⑭ EXISTING PORTLAND CEMENT CONCRETE SHOULDERS 8"
- ⑮ EXISTING PORTLAND CEMENT CONCRETE SHOULDERS 9"
- ⑯ EXISTING LONGITUDINAL CONSTRUCTION JOINT - USE 3/4 INCH EPOXY COATED SMOOTH DOWEL BARS AT 24" C-C AND 24" LONG
- ⑰ EXISTING CONCRETE BARRIER, CONCRETE BARRIER (MODIFIED), CONCRETE BARRIER (SPECIAL), OR CONCRETE BARRIER TRANSITION
- ⑱ EXISTING GUARDRAIL
- ⑲ EXISTING BITUMINOUS SHOULDER CURB
- ⑳ EXISTING PIPE UNDERDRAINS 6"
- ㉑ EXISTING SLOTTED DRAIN STRUCTURE
- ㉒ EXISTING STORM SEWER
- ㉓ EXISTING FILTER FABRIC
- ㉔ EXISTING STRIP REFLECTIVE CRACK CONTROL TREATMENT
- ㉕ EXISTING NOISE ABATEMENT WALL
- ㉖ EXISTING BITUMINOUS CONCRETE SURFACE COURSE, SUPERPAVE, MIX "C", N50 (2")
- ㉗ EXISTING BITUMINOUS MATERIALS (PRIME COAT)
- ㉘ EXISTING EMBANKMENT
- ㉙ EXISTING MICRO-SURFACING SINGLE PASS, TYPE II, 1/2" (WITH RUT FILLING)
- ㉚ EXISTING THERMOPLASTIC PAVEMENT MARKING, EDGELINE

MODEL: Default
 FILE NAME: d:\work\lanroom.doe\illinois.gov\FWIDOT\Documents\DOT_Offices\District_8\Projects\B76M66\CADData\CADSheets\B76M66-shi-ypf-cal.dgn

USER NAME = lewisko	DESIGNED -	REVISED -
	DRAWN -	REVISED -
PLOT SCALE = 100,0000' / in.	CHECKED -	REVISED -
PLOT DATE = 5/31/2019	DATE -	REVISED -

STATE OF ILLINOIS
 DEPARTMENT OF TRANSPORTATION

TYPICAL SECTION

SCALE: NTS SHEET NO. OF SHEETS STA. TO STA.

F.A.I. RTE.	SECTION	COUNTY	TOTAL SHEETS	SHEET NO.
64	82-(1,2,3,4,5,6,7,8)CJ5-1	ST. CLAIR	24	14
CONTRACT 76M66				
FED. ROAD DIST. NO.		ILLINOIS FED. AID PROJECT		

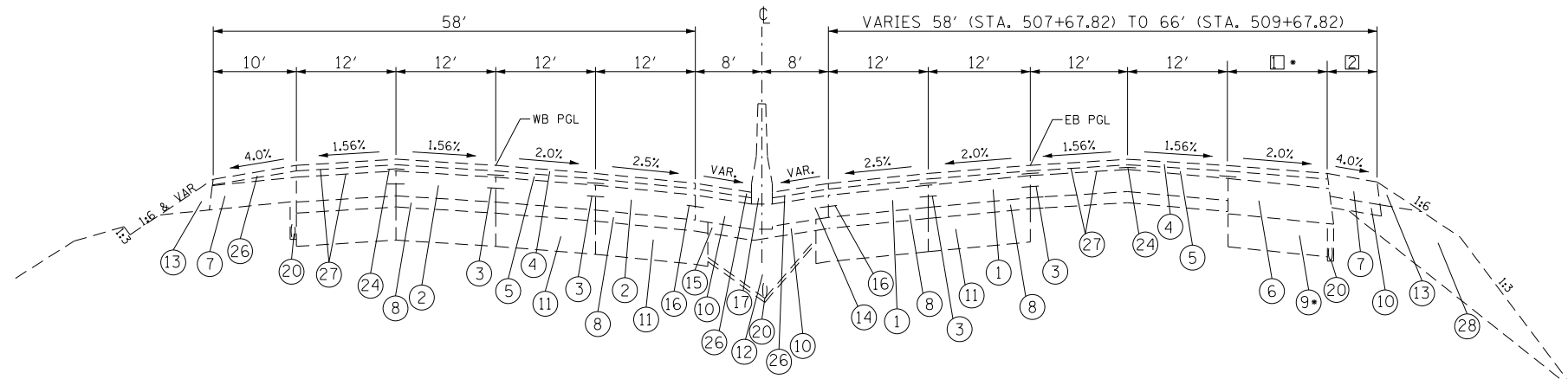

STA. 506+92.82 EB TO STA. 521+38.92 EB
 STA. 504+07.00 WB TO STA. 510+34.00 WB

* □ SHOULDER PAVEMENT & SUB-BASE WIDTH VARY
 10' (STA. 509+17.82) TO 12' (STA. 509+67.82)
 □ VARIES 0' (STA. 507+67.82) TO 6' (STA. 509+17.82)

- LEGEND
- ① EXISTING CONTINUOUSLY REINFORCED PORTLAND CEMENT CONCRETE PAVEMENT 8"
 - ② EXISTING CONTINUOUSLY REINFORCED PORTLAND CEMENT CONCRETE PAVEMENT 9"
 - ③ EXISTING LONGITUDINAL CONSTRUCTION JOINT - USE NO. 6 EPOXY COATED DEFORMED TIE BARS AT 24" C-C AND 24" LONG, DRILLED AND GROUTED
 - ④ EXISTING POLYMERIZED BITUMINOUS CONCRETE SURFACE COURSE, STONE MATRIX ASPHALT, CLASS I (2")
 - ⑤ EXISTING POLYMERIZED BITUMINOUS CONCRETE BINDER COURSE, SUPERPAVE, IL-19.0, N105 (2-1/4" & VARIES)
 - ⑥ EXISTING 13" BITUMINOUS SHOULDER
 - ⑦ EXISTING 8" BITUMINOUS SHOULDER
 - ⑧ EXISTING STABILIZED SUB-BASE 4"
 - ⑨ EXISTING SUB-BASE GRANULAR MATERIAL, TYPE B 12"
 - ⑩ EXISTING SUB-BASE GRANULAR MATERIAL, TYPE A 4"
 - ⑪ EXISTING AGGREGATE SUBGRADE 12"
 - ⑫ EXISTING POROUS GRANULAR EMBANKMENT, SUBGRADE
 - ⑬ EXISTING AGGREGATE SHOULDER, TYPE B
 - ⑭ EXISTING PORTLAND CEMENT CONCRETE SHOULDERS 8"
 - ⑮ EXISTING PORTLAND CEMENT CONCRETE SHOULDERS 9"
 - ⑯ EXISTING LONGITUDINAL CONSTRUCTION JOINT - USE 3/4 INCH EPOXY COATED SMOOTH DOWEL BARS AT 24" C-C AND 24" LONG
 - ⑰ EXISTING CONCRETE BARRIER, CONCRETE BARRIER (MODIFIED), CONCRETE BARRIER (SPECIAL), OR CONCRETE BARRIER TRANSITION
 - ⑱ EXISTING GUARDRAIL
 - ⑲ EXISTING BITUMINOUS SHOULDER CURB
 - ⑳ EXISTING PIPE UNDERDRAINS 6"
 - ㉑ EXISTING SLOTTED DRAIN STRUCTURE
 - ㉒ EXISTING STORM SEWER
 - ㉓ EXISTING FILTER FABRIC
 - ㉔ EXISTING STRIP REFLECTIVE CRACK CONTROL TREATMENT
 - ㉕ EXISTING NOISE ABATEMENT WALL
 - ㉖ EXISTING BITUMINOUS CONCRETE SURFACE COURSE, SUPERPAVE, MIX "C", N50 (2")
 - ㉗ EXISTING BITUMINOUS MATERIALS (PRIME COAT)
 - ㉘ EXISTING EMBANKMENT
 - ㉙ EXISTING MICRO-SURFACING SINGLE PASS, TYPE II, 1/2" (WITH RUT FILLING)
 - ㉚ EXISTING THERMOPLASTIC PAVEMENT MARKING, EDGELINE

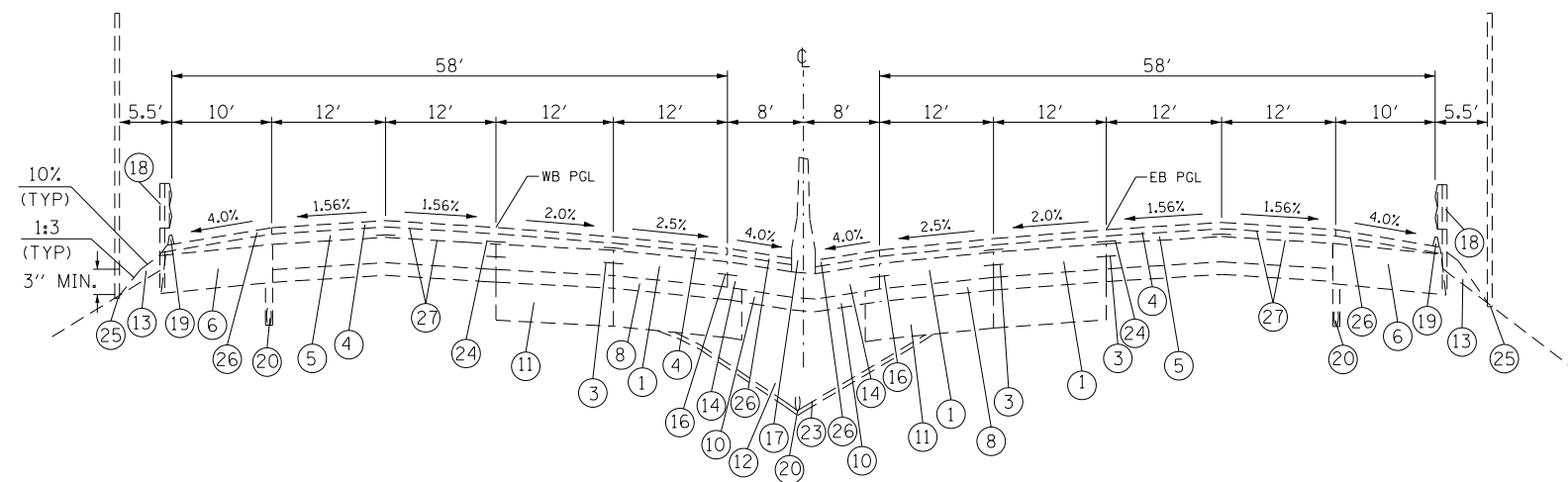

STA. 559+48.32 EB TO STA. 585+31.38 EB
 STA. 560+38.12 WB TO STA. 586+21.18 WB

MODEL: Default
 FILE NAME: \\s:\lanroom\dot\illinois\gov\pww\DOT\Documents\DOT_Offices\Birt\Birt_8\Projects\0876M66\CADD\0876M66\0876M66-shs-sys\fig\1.dgn

USER NAME = lewisko	DESIGNED -	REVISED -
	DRAWN -	REVISED -
PLOT SCALE = 100.0000' / 1"	CHECKED -	REVISED -
PLOT DATE = 5/31/2019	DATE -	REVISED -

**STATE OF ILLINOIS
 DEPARTMENT OF TRANSPORTATION**

TYPICAL SECTION

SCALE: NTS SHEET NO. OF SHEETS STA. TO STA.

F.A.I. RTE.	SECTION	COUNTY	TOTAL SHEETS	SHEET NO.
64	82-(1,2,3,4,5,6,7,8)CJS-1	ST. CLAIR	24	15
CONTRACT 76M66				
FED. ROAD DIST. NO.		ILLINOIS FED. AID PROJECT		

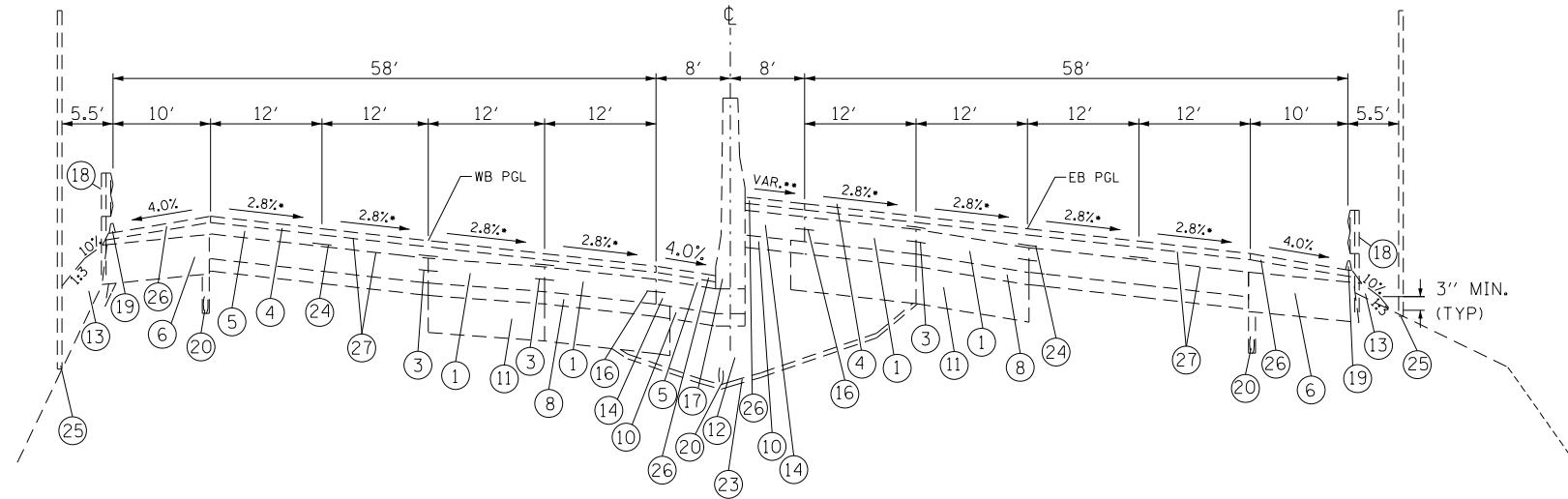

STA. 585+31.38 EB TO STA. 607+83.78 EB
 STA. 586+21.18 WB TO STA. 606+93.98 WB

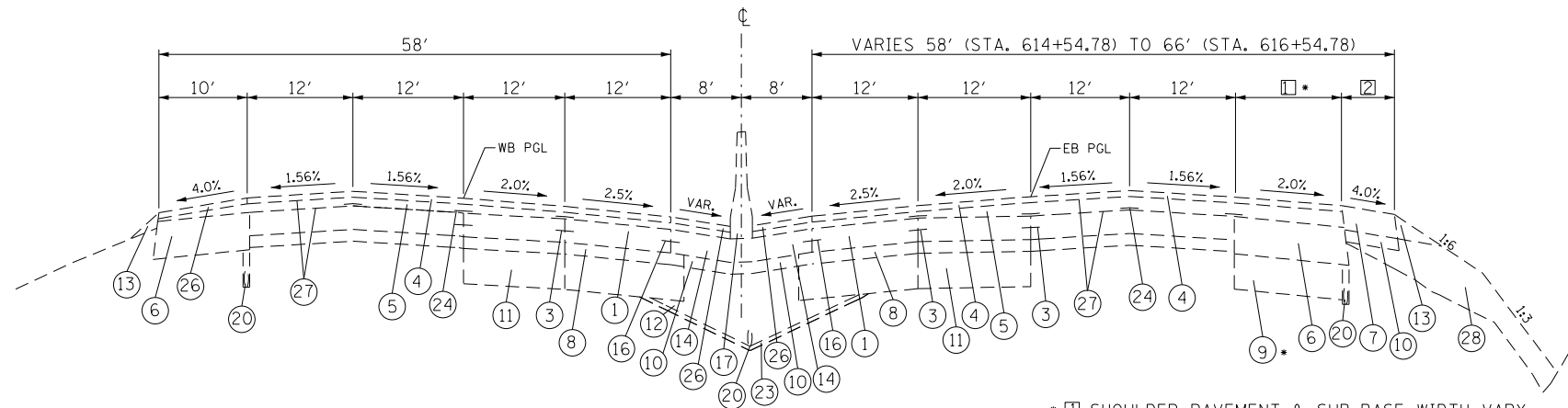

STA. 613+80.02 TO STA. 657+24.79 EB
 STA. 652+43.94 WB

* □ SHOULDER PAVEMENT & SUB-BASE WIDTH VARY
 10' (STA. 616+04.78) TO 12' (STA. 616+54.78)
 □ VARIES 0' (STA. 614+54.78) TO 6' (STA. 616+04.78)

STATION EQUATION
 STA. 618+20.65 BK =
 STA. 643+85.18 AH

LEGEND

- ① EXISTING CONTINUOUSLY REINFORCED PORTLAND CEMENT CONCRETE PAVEMENT 8"
- ② EXISTING CONTINUOUSLY REINFORCED PORTLAND CEMENT CONCRETE PAVEMENT 9"
- ③ EXISTING LONGITUDINAL CONSTRUCTION JOINT - USE NO. 6 EPOXY COATED DEFORMED TIE BARS AT 24" C-C AND 24" LONG, DRILLED AND GROUTED
- ④ EXISTING POLYMERIZED BITUMINOUS CONCRETE SURFACE COURSE, STONE MATRIX ASPHALT, CLASS I (2")
- ⑤ EXISTING POLYMERIZED BITUMINOUS CONCRETE BINDER COURSE, SUPERPAVE, IL-19.0, N105 (2-1/4" & VARIES)
- ⑥ EXISTING 13" BITUMINOUS SHOULDER
- ⑦ EXISTING 8" BITUMINOUS SHOULDER
- ⑧ EXISTING STABILIZED SUB-BASE 4"
- ⑨ EXISTING SUB-BASE GRANULAR MATERIAL, TYPE B 12"
- ⑩ EXISTING SUB-BASE GRANULAR MATERIAL, TYPE A 4"
- ⑪ EXISTING AGGREGATE SUBGRADE 12"
- ⑫ EXISTING POROUS GRANULAR EMBANKMENT, SUBGRADE
- ⑬ EXISTING AGGREGATE SHOULDER, TYPE B
- ⑭ EXISTING PORTLAND CEMENT CONCRETE SHOULDERS 8"
- ⑮ EXISTING PORTLAND CEMENT CONCRETE SHOULDERS 9"
- ⑯ EXISTING LONGITUDINAL CONSTRUCTION JOINT - USE 3/4 INCH EPOXY COATED SMOOTH DOWEL BARS AT 24" C-C AND 24" LONG
- ⑰ EXISTING CONCRETE BARRIER, CONCRETE BARRIER (MODIFIED), CONCRETE BARRIER (SPECIAL), OR CONCRETE BARRIER TRANSITION
- ⑱ EXISTING GUARDRAIL
- ⑲ EXISTING BITUMINOUS SHOULDER CURB
- ⑳ EXISTING PIPE UNDERDRAINS 6"
- ㉑ EXISTING SLOTTED DRAIN STRUCTURE
- ㉒ EXISTING STORM SEWER
- ㉓ EXISTING FILTER FABRIC
- ㉔ EXISTING STRIP REFLECTIVE CRACK CONTROL TREATMENT
- ㉕ EXISTING NOISE ABATEMENT WALL
- ㉖ EXISTING BITUMINOUS CONCRETE SURFACE COURSE, SUPERPAVE, MIX "C", N50 (2")
- ㉗ EXISTING BITUMINOUS MATERIALS (PRIME COAT)
- ㉘ EXISTING EMBANKMENT
- ㉙ EXISTING MICRO-SURFACING SINGLE PASS, TYPE II, 1/2" (WITH RUT FILLING)
- ㉚ EXISTING THERMOPLASTIC PAVEMENT MARKING, EDGELINE

MODEL: Default
 FILE NAME: p:\planroom\dot\illinois\gov\pwwdot\Documents\DOT_Offices\District_8\Projects\876M66\CADData\CADSheets\876M66-sh-typical.dgn

USER NAME = lewiska	DESIGNED -	REVISED -
PLOT SCALE = 100.0000' / in.	DRAWN -	REVISED -
PLOT DATE = 5/31/2019	CHECKED -	REVISED -
	DATE -	REVISED -

STATE OF ILLINOIS
 DEPARTMENT OF TRANSPORTATION

TYPICAL SECTION

SCALE: NTS SHEET NO. OF SHEETS STA. TO STA.

F.A.I. RTE.	SECTION	COUNTY	TOTAL SHEETS	SHEET NO.
64	82-(1,2,3,4,5,6,7,8)CJS-1	ST. CLAIR	24	16
CONTRACT 76M66				
FED. ROAD DIST. NO. [ILLINOIS] FED. AID PROJECT				

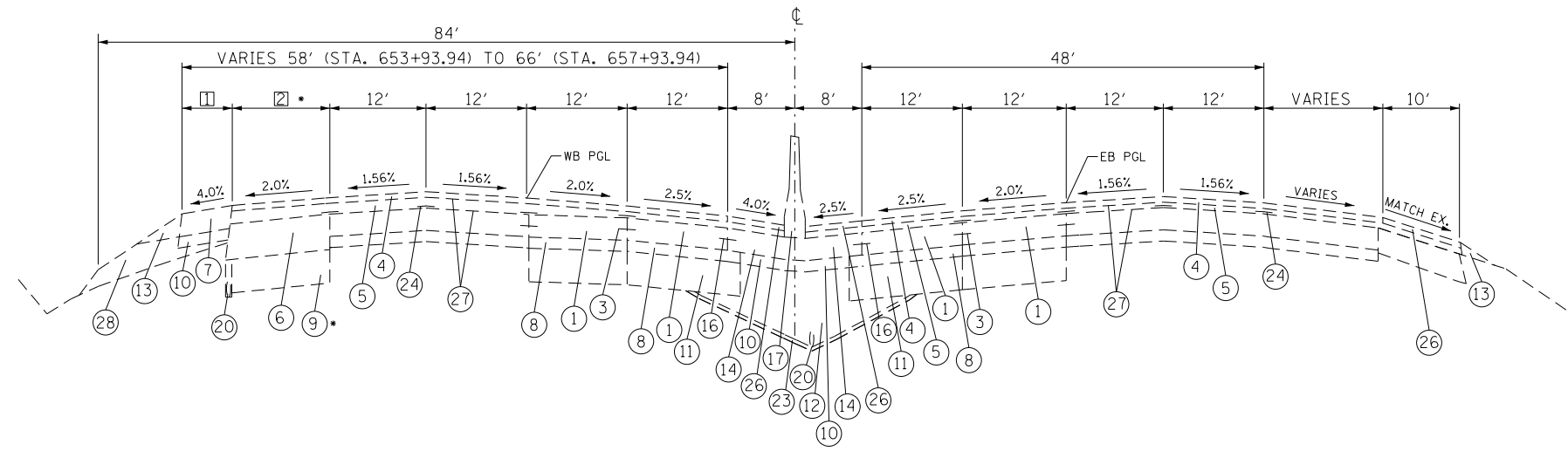

□ VARIES 0' (STA. 653+93.94) TO 6' (STA. 656+93.94)
 * ▣ SHOULDER PAVEMENT & SUB-BASE WIDTH VARY
 10' (STA. 656+93.94) TO 12' (STA. 657+93.94) STA. 657+24.79 EB TO STA. 658+69.57 EB
 STA. 652+43.94 WB TO STA. 658+54.90 WB

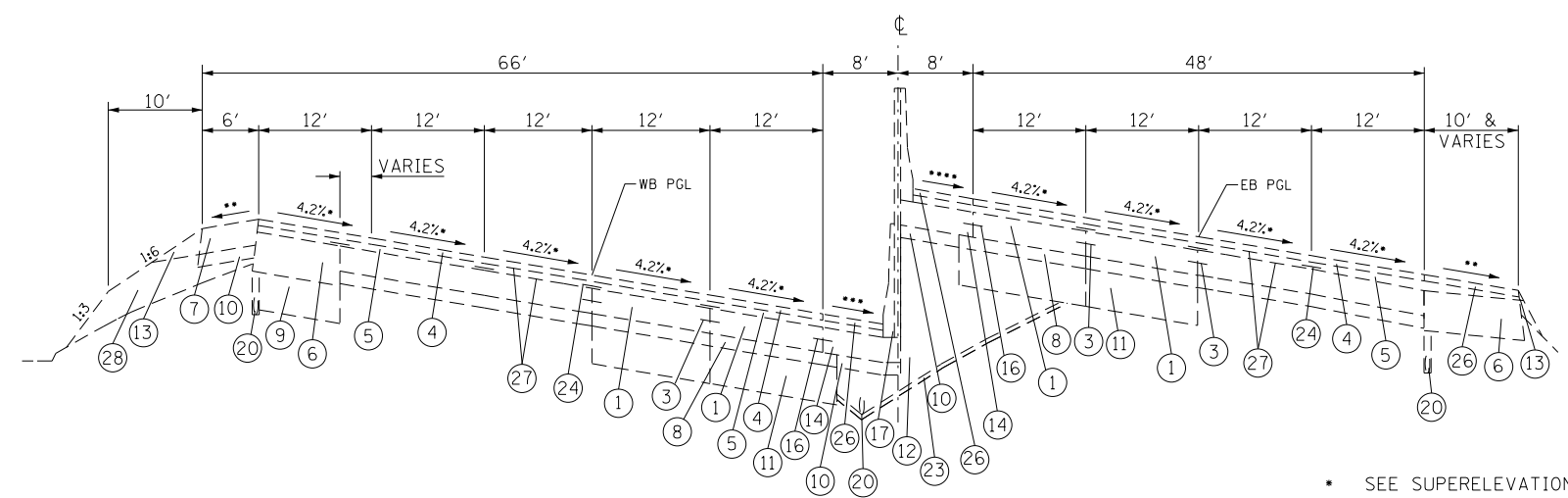

STA. 658+69.57 EB TO STA. 661+10.04
 STA. 658+54.90 WB TO STA. 662+84.20 WB
 STA. 662+84.20 TO STA. 672+93.94

- SEE SUPERELEVATION TRANSITION DETAILS FOR PAVEMENT SUPERELEVATION.
- ** WHEN THE SUPERELEVATION RATE IS 4% OR LESS, THE SHOULDER SLOPE IS 4%. WHEN PAVEMENT SUPERELEVATION RATE EXCEEDS 4%, THE MAXIMUM ALGEBRAIC DIFFERENCE IN CROSS SLOPE IS 8%.
- *** WHEN THE SUPERELEVATION RATE IS 4% OR LESS, THE SHOULDER SLOPE IS 4%. WHEN PAVEMENT SUPERELEVATION RATE EXCEEDS 4%, THE SHOULDER SLOPE SHOULD EQUAL ADJACENT PAVEMENT SUPERELEVATION RATE.
- **** SHOULDER SLOPE SHOULD EQUAL ADJACENT PAVEMENT SUPERELEVATION RATE.

LEGEND

- ① EXISTING CONTINUOUSLY REINFORCED PORTLAND CEMENT CONCRETE PAVEMENT 8"
- ② EXISTING CONTINUOUSLY REINFORCED PORTLAND CEMENT CONCRETE PAVEMENT 9"
- ③ EXISTING LONGITUDINAL CONSTRUCTION JOINT - USE NO. 6 EPOXY COATED DEFORMED TIE BARS AT 24" C-C AND 24" LONG, DRILLED AND GROUTED
- ④ EXISTING POLYMERIZED BITUMINOUS CONCRETE SURFACE COURSE, STONE MATRIX ASPHALT, CLASS I (2")
- ⑤ EXISTING POLYMERIZED BITUMINOUS CONCRETE BINDER COURSE, SUPERPAVE, IL-19.0, N105 (2-1/4" & VARIES)
- ⑥ EXISTING 13" BITUMINOUS SHOULDER
- ⑦ EXISTING 8" BITUMINOUS SHOULDER
- ⑧ EXISTING STABILIZED SUB-BASE 4"
- ⑨ EXISTING SUB-BASE GRANULAR MATERIAL, TYPE B 12"
- ⑩ EXISTING SUB-BASE GRANULAR MATERIAL, TYPE A 4"
- ⑪ EXISTING AGGREGATE SUBGRADE 12"
- ⑫ EXISTING POROUS GRANULAR EMBANKMENT, SUBGRADE
- ⑬ EXISTING AGGREGATE SHOULDER, TYPE B
- ⑭ EXISTING PORTLAND CEMENT CONCRETE SHOULDERS 8"
- ⑮ EXISTING PORTLAND CEMENT CONCRETE SHOULDERS 9"
- ⑯ EXISTING LONGITUDINAL CONSTRUCTION JOINT - USE 3/4 INCH EPOXY COATED SMOOTH DOWEL BARS AT 24" C-C AND 24" LONG
- ⑰ EXISTING CONCRETE BARRIER, CONCRETE BARRIER (MODIFIED), CONCRETE BARRIER (SPECIAL), OR CONCRETE BARRIER TRANSITION
- ⑱ EXISTING GUARDRAIL
- ⑲ EXISTING BITUMINOUS SHOULDER CURB
- ⑳ EXISTING PIPE UNDERDRAINS 6"
- ㉑ EXISTING SLOTTED DRAIN STRUCTURE
- ㉒ EXISTING STORM SEWER
- ㉓ EXISTING FILTER FABRIC
- ㉔ EXISTING STRIP REFLECTIVE CRACK CONTROL TREATMENT
- ㉕ EXISTING NOISE ABATEMENT WALL
- ㉖ EXISTING BITUMINOUS CONCRETE SURFACE COURSE, SUPERPAVE, MIX "C", N50 (2")
- ㉗ EXISTING BITUMINOUS MATERIALS (PRIME COAT)
- ㉘ EXISTING EMBANKMENT
- ㉙ EXISTING MICRO-SURFACING SINGLE PASS, TYPE II, 1/2" (WITH RUT FILLING)
- ㉚ EXISTING THERMOPLASTIC PAVEMENT MARKING, EDGELINE

MODEL: Default
 FILE NAME: d:\work\lanroom.dbo\illinois.gov\FWIDOT\Documents\DOT_Offices\Dist\CTC_B\Projects\B76M66\CADData\CADSheets\B76M66-shi-ypf-cal.dgn

USER NAME = lewis	DESIGNED -	REVISED -
	DRAWN -	REVISED -
PLOT SCALE = 100,0000' / 1"	CHECKED -	REVISED -
PLOT DATE = 5/31/2019	DATE -	REVISED -

STATE OF ILLINOIS
DEPARTMENT OF TRANSPORTATION

TYPICAL SECTION

SCALE: NTS SHEET NO. OF SHEETS STA. TO STA.

F.A.I. RTE.	SECTION	COUNTY	TOTAL SHEETS	SHEET NO.
64	82-(1,2,3,4,5,6,7,8)CJ5-1	ST. CLAIR	24	17
CONTRACT 76M66				
FED. ROAD DIST. NO.		ILLINOIS FED. AID PROJECT		

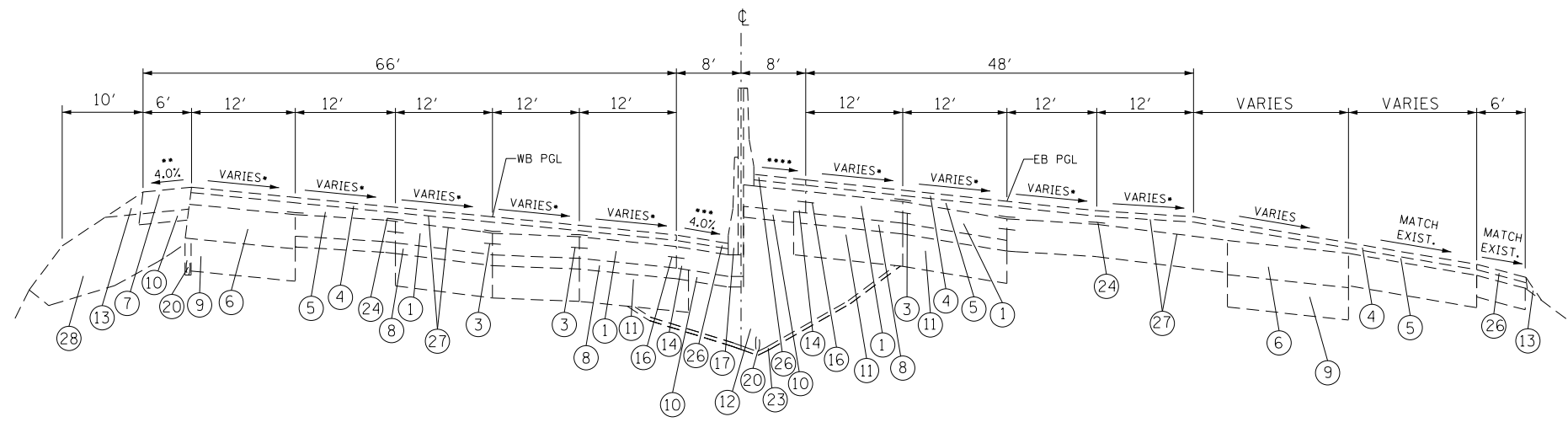

STA. 661+10.04 TO STA. 662+23.36

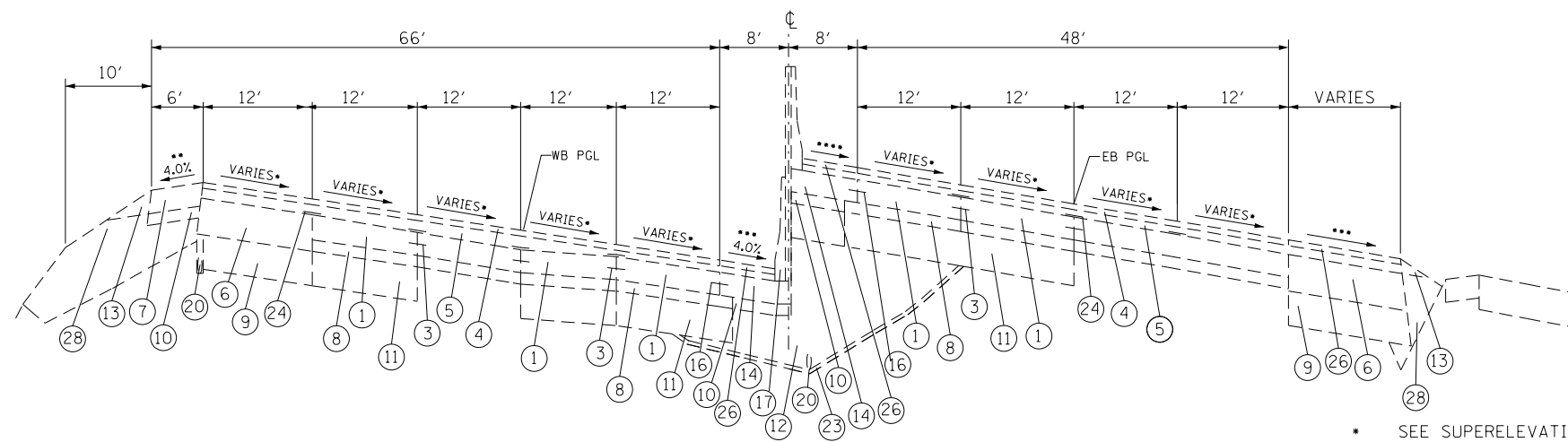

STA. 662+23.36 TO STA. 662+84.20

LEGEND

- ① EXISTING CONTINUOUSLY REINFORCED PORTLAND CEMENT CONCRETE PAVEMENT 8"
- ② EXISTING CONTINUOUSLY REINFORCED PORTLAND CEMENT CONCRETE PAVEMENT 9"
- ③ EXISTING LONGITUDINAL CONSTRUCTION JOINT - USE NO. 6 EPOXY COATED DEFORMED TIE BARS AT 24" C-C AND 24" LONG, DRILLED AND GROUTED
- ④ EXISTING POLYMERIZED BITUMINOUS CONCRETE SURFACE COURSE, STONE MATRIX ASPHALT, CLASS 1 (2")
- ⑤ EXISTING POLYMERIZED BITUMINOUS CONCRETE BINDER COURSE, SUPERPAVE, IL-19.0, N105 (2-1/4" & VARIES)
- ⑥ EXISTING 13" BITUMINOUS SHOULDER
- ⑦ EXISTING 8" BITUMINOUS SHOULDER
- ⑧ EXISTING STABILIZED SUB-BASE 4"
- ⑨ EXISTING SUB-BASE GRANULAR MATERIAL, TYPE B 12"
- ⑩ EXISTING SUB-BASE GRANULAR MATERIAL, TYPE A 4"
- ⑪ EXISTING AGGREGATE SUBGRADE 12"
- ⑫ EXISTING POROUS GRANULAR EMBANKMENT, SUBGRADE
- ⑬ EXISTING AGGREGATE SHOULDER, TYPE B
- ⑭ EXISTING PORTLAND CEMENT CONCRETE SHOULDERS 8"
- ⑮ EXISTING PORTLAND CEMENT CONCRETE SHOULDERS 9"
- ⑯ EXISTING LONGITUDINAL CONSTRUCTION JOINT - USE 3/4 INCH EPOXY COATED SMOOTH DOWEL BARS AT 24" C-C AND 24" LONG
- ⑰ EXISTING CONCRETE BARRIER, CONCRETE BARRIER (MODIFIED), CONCRETE BARRIER (SPECIAL), OR CONCRETE BARRIER TRANSITION
- ⑱ EXISTING GUARDRAIL
- ⑲ EXISTING BITUMINOUS SHOULDER CURB
- ⑳ EXISTING PIPE UNDERDRAINS 6"
- ㉑ EXISTING SLOTTED DRAIN STRUCTURE
- ㉒ EXISTING STORM SEWER
- ㉓ EXISTING FILTER FABRIC
- ㉔ EXISTING STRIP REFLECTIVE CRACK CONTROL TREATMENT
- ㉕ EXISTING NOISE ABATEMENT WALL
- ㉖ EXISTING BITUMINOUS CONCRETE SURFACE COURSE, SUPERPAVE, MIX "C", N50 (2")
- ㉗ EXISTING BITUMINOUS MATERIALS (PRIME COAT)
- ㉘ EXISTING EMBANKMENT
- ㉙ EXISTING MICRO-SURFACING SINGLE PASS, TYPE II, 1/2" (WITH RUT FILLING)
- ㉚ EXISTING THERMOPLASTIC PAVEMENT MARKING, EDGELINE

- SEE SUPERELEVATION TRANSITION DETAILS FOR PAVEMENT SUPERELEVATION.
- WHEN THE SUPERELEVATION RATE IS 4% OR LESS, THE SHOULDER SLOPE IS 4%. WHEN PAVEMENT SUPERELEVATION RATE EXCEEDS 4%, THE MAXIMUM ALGEBRAIC DIFFERENCE IN CROSS SLOPE IS 8%.
- WHEN THE SUPERELEVATION RATE IS 4% OR LESS, THE SHOULDER SLOPE IS 4%. WHEN PAVEMENT SUPERELEVATION RATE EXCEEDS 4%, THE SHOULDER SLOPE SHOULD EQUAL ADJACENT PAVEMENT SUPERELEVATION RATE.
- SHOULDER SLOPE SHOULD EQUAL ADJACENT PAVEMENT SUPERELEVATION RATE.

MODEL: Default
 FILE NAME: \\s:\planroom\dot\illinois.gov\PHW\DOT\Documents\DOT - Office\B\H\T - B\Projects\DB\76M6\CADD\DOT\CAD\Sheet\B\76M6-18r-sy\final.dgn

USER NAME = lewisko	DESIGNED -	REVISED -
	DRAWN -	REVISED -
PLOT SCALE = 100.0000' / 1"	CHECKED -	REVISED -
PLOT DATE = 5/31/2019	DATE -	REVISED -

**STATE OF ILLINOIS
DEPARTMENT OF TRANSPORTATION**

TYPICAL SECTION

SCALE: NTS SHEET NO. OF SHEETS STA. TO STA.

F.A.I. RTE.	SECTION	COUNTY	TOTAL SHEETS	SHEET NO.
64	82-(1,2,3,4,5,6,7,8)CJS-1	ST. CLAIR	24	18
CONTRACT 76M66				
FED. ROAD DIST. NO.	ILLINOIS FED. AID PROJECT			

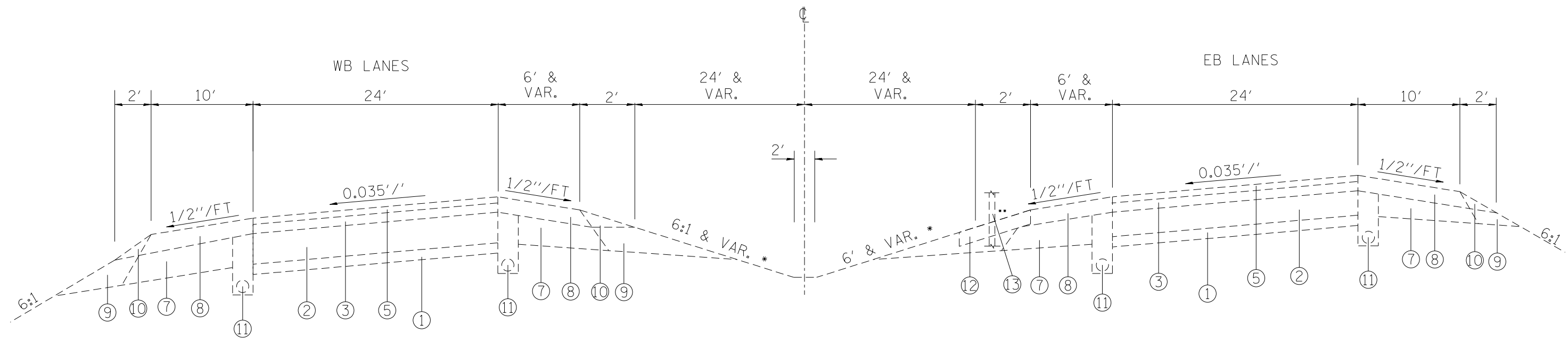

STA. 743+70 - STA. 782+93.80

* MEDIAN SLOPES VARY 6:1 AND FLATTER
 ** LOCATION OF HTC AND MOW STRIP VARIES BETWEEN EB AND WB LANES. SEE PLAN SHEETS FOR LOCATIONS.

- ① EXIST. STABILIZED SUB-BASE 4"
- ② EXIST. CRPCC PAVEMENT 8"
- ③ EXIST. HMA BINDER COURSE 2-1/4"
- ④ EXIST. HMA OVERLAY 1-3/4" TO 3-1/2"
- ⑤ EXIST. HMA SURFACE COURSE, SMA, 1-1/2"
- ⑥ EXIST. HMA SURFACE COURSE, SMA, 2"
- ⑦ EXIST. STABILIZED SHOULDERS 8"
- ⑧ EXIST. HMA SHOULDER
- ⑨ EXIST. AGGREGATE SHOULDER
- ⑩ EXIST. AGGREGATE SHOULDER WEDGE, TYPE B
- ⑪ EXIST. PIPE UNDERDRAIN 4"
- ⑫ EXIST. HOT-MIX ASPHALT SHOULDER, 4" (MOW STRIP)
- ⑬ EXIST. HIGH TENSION MEDIAN CABLE BARRIER

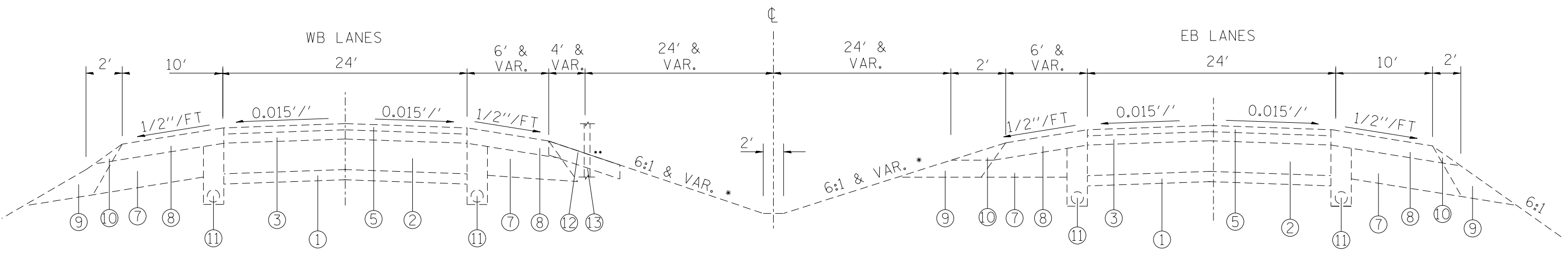

STA. 782+93.80 - STA. 859+77.63
 STA. 903+38.51 - STA. 948+05

MODEL: Default
 FILE: I:\NAME: \w\lancom.dot\illinois.dot\illinois\DOT\Documents\DOT_Office\Birt\Birt_8\Projects\0876M66\CADD\Drawings\CAD\Drawings\0876M66-htc-sy-fcl.dgn

USER NAME = lewisko	DESIGNED -	REVISED -
PLOT SCALE = 100.0000' / 1"	DRAWN -	REVISED -
PLOT DATE = 5/31/2019	CHECKED -	REVISED -
	DATE -	REVISED -

**STATE OF ILLINOIS
 DEPARTMENT OF TRANSPORTATION**

TYPICAL SECTION				
SCALE: NTS	SHEET NO.	OF SHEETS	STA.	TO STA.

F.A.I. RTE.	SECTION	COUNTY	TOTAL SHEETS	SHEET NO.
64	82-(1,2,3,4,5,6,7,8)CJS-1	ST. CLAIR	24	21
CONTRACT 76M66				
FED. ROAD DIST. NO.		ILLINOIS FED. AID PROJECT		

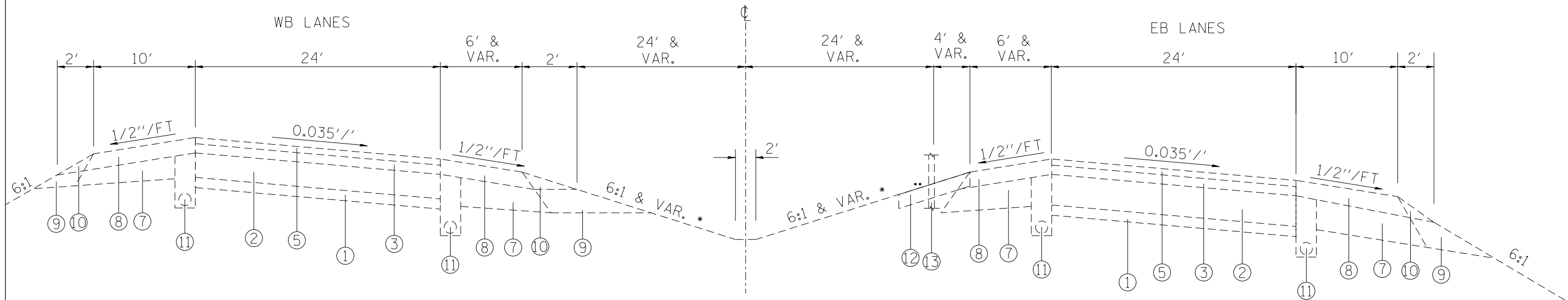

STA. 859+77.63 - STA. 903+38.51

* MEDIAN SLOPES VARY 6:1 AND FLATTER

** LOCATION OF HTC AND MOW STRIP VARIES BETWEEN EB AND WB LANES. SEE PLAN SHEETS FOR LOCATIONS.

- ① EXIST. STABILIZED SUB-BASE 4"
- ② EXIST. CRPCC PAVEMENT 8"
- ③ EXIST. HMA BINDER COURSE 2-1/4"
- ④ EXIST. HMA OVERLAY 1-3/4" TO 3-1/2"
- ⑤ EXIST. HMA SURFACE COURSE, SMA, 1-1/2"
- ⑥ EXIST. HMA SURFACE COURSE, SMA, 2"
- ⑦ EXIST. STABILIZED SHOULDERS 8"
- ⑧ EXIST. HMA SHOULDER
- ⑨ EXIST. AGGREGATE SHOULDER
- ⑩ EXIST. AGGREGATE SHOULDER WEDGE, TYPE B
- ⑪ EXIST. PIPE UNDERDRAIN 4"
- ⑫ EXIST. HOT-MIX ASPHALT SHOULDER, 4" (MOW STRIP)
- ⑬ EXIST. HIGH TENSION MEDIAN CABLE BARRIER

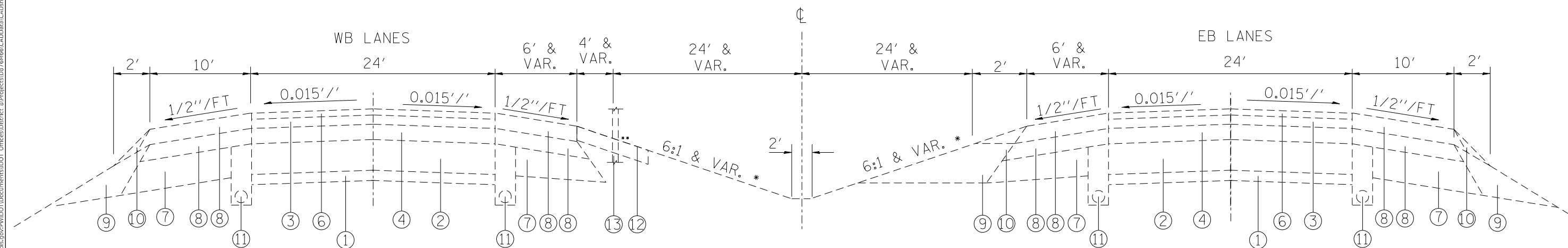

STA. 948+05 - STA. 1026+85.91

MODEL: Default
 FILE NAME: \\s:\lanroom\dot\illinois\dot\Office\DOT\Documents\DOT_Office\DOT\8\Projects\0876M66\CADD\dot\CAD\Sheet\0876M66-htc\tyfical.dgn

USER NAME = lewisko	DESIGNED -	REVISED -
	DRAWN -	REVISED -
PLOT SCALE = 100.0000' / 1"	CHECKED -	REVISED -
PLOT DATE = 5/31/2019	DATE -	REVISED -

**STATE OF ILLINOIS
DEPARTMENT OF TRANSPORTATION**

TYPICAL SECTION

SCALE: NTS SHEET NO. OF SHEETS STA. TO STA.

F.A.I. RTE.	SECTION	COUNTY	TOTAL SHEETS	SHEET NO.
64	82-(1,2,3,4,5,6,7,8)CJS-1	ST. CLAIR	24	22
CONTRACT 76M66				
FED. ROAD DIST. NO.		ILLINOIS FED. AID PROJECT		

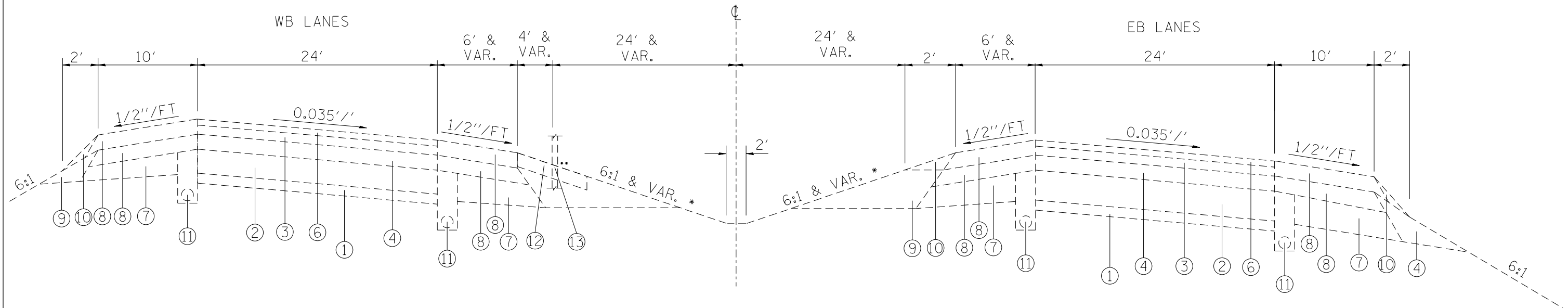

STA. 1026+85.91 - STA. 1031+00

* MEDIAN SLOPES VARY 6:1 AND FLATTER

** LOCATION OF HTC AND MOW STRIP VARIES BETWEEN EB AND WB LANES. SEE PLAN SHEETS FOR LOCATIONS.

- ① EXIST. STABILIZED SUB-BASE 4"
- ② EXIST. CRPCC PAVEMENT 8"
- ③ EXIST. HMA BINDER COURSE 2-1/4"
- ④ EXIST. HMA OVERLAY 1-3/4" TO 3-1/2"
- ⑤ EXIST. HMA SURFACE COURSE, SMA, 1-1/2"
- ⑥ EXIST. HMA SURFACE COURSE, SMA, 2"
- ⑦ EXIST. STABILIZED SHOULDERS 8"
- ⑧ EXIST. HMA SHOULDER
- ⑨ EXIST. AGGREGATE SHOULDER
- ⑩ EXIST. AGGREGATE SHOULDER WEDGE, TYPE B
- ⑪ EXIST. PIPE UNDERDRAIN 4"
- ⑫ EXIST. HOT-MIX ASPHALT SHOULDER, 4" (MOW STRIP)
- ⑬ EXIST. HIGH TENSION MEDIAN CABLE BARRIER

MODEL: Default
FILE NAME: p:\planroom\dot\illinois\gov\pww\DOT\Documents\IDOT_Offices\District_8\Projects\876M66\CAD\Drawings\876M66-sh-typlcal.dgn

USER NAME = lewiska	DESIGNED -	REVISED -
	DRAWN -	REVISED -
PLOT SCALE = 100.0000' / in.	CHECKED -	REVISED -
PLOT DATE = 5/31/2019	DATE -	REVISED -

STATE OF ILLINOIS
DEPARTMENT OF TRANSPORTATION

TYPICAL SECTION

SCALE: NTS SHEET NO. OF SHEETS STA. TO STA.

F.A.I. RTE.	SECTION	COUNTY	TOTAL SHEETS	SHEET NO.
64	82-(1,2,3,4,5,6,7,8)CJS-1	ST. CLAIR	24	23
CONTRACT 76M66				
FED. ROAD DIST. NO. ILLINOIS FED. AID PROJECT				

