

STATE OF ILLINOIS  
DEPARTMENT OF TRANSPORTATION  
DIVISION OF HIGHWAYS

PLANS FOR PROPOSED  
FEDERAL AID HIGHWAY

FAU 1588 (123rd STREET)  
MAPLE AVENUE TO GREGORY STREET  
SIDEWALK IMPROVEMENTS  
PROJECT NO.: SRTS-4009(268)  
SECTION NO.: 09-00184-00-SW  
CITY of BLUE ISLAND  
COOK COUNTY  
JOB NO.: C-91-106-14

F. A. ID. NO.	SECTION	COUNTY	TOTAL SHEETS	SHEET NO.
1588	09-00184-00-SW	COOK	6	1
STA.		TO STA.		
FED. ROAD DIST. NO. 1		ILLINOIS	FED. AID PROJECT SRTS-4009(268)	

CONTRACT #61C97

INDEX OF SHEETS  
SEE SHEET NO. 2

HIGHWAY STANDARDS  
SEE SHEET NO. 2

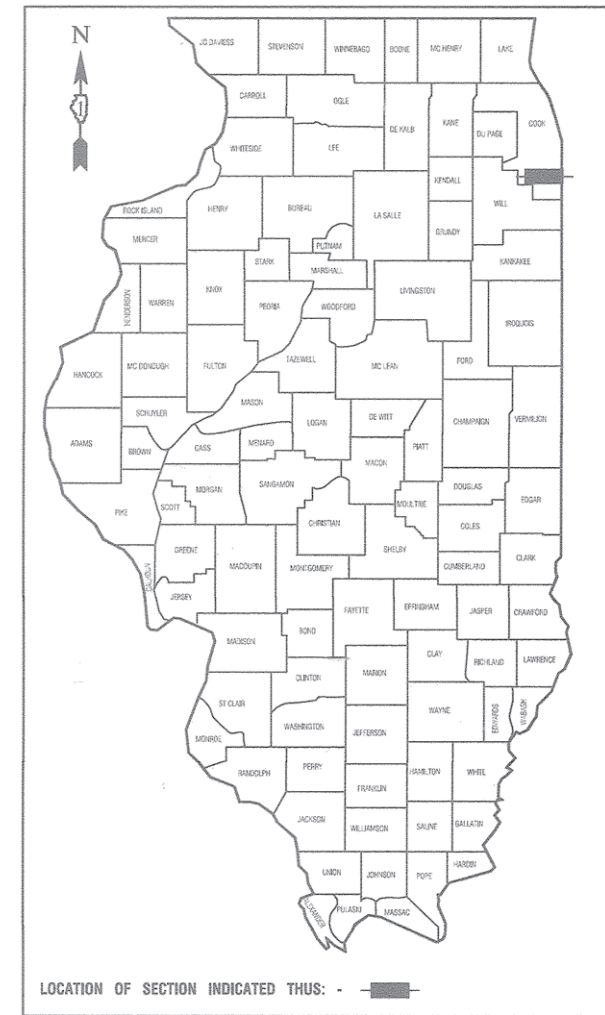

EXIST TRAFFIC DATA	
123RD STREET LOCAL ROAD (EAST OF WESTERN AVENUE AT GREGORY STREET)	2013 ADT - 2,750
123RD STREET LOCAL ROAD (MAPLE AVENUE AT ARTESIAN AVENUE)	2013 ADT - 5,150
SPEED LIMIT	20 MPH

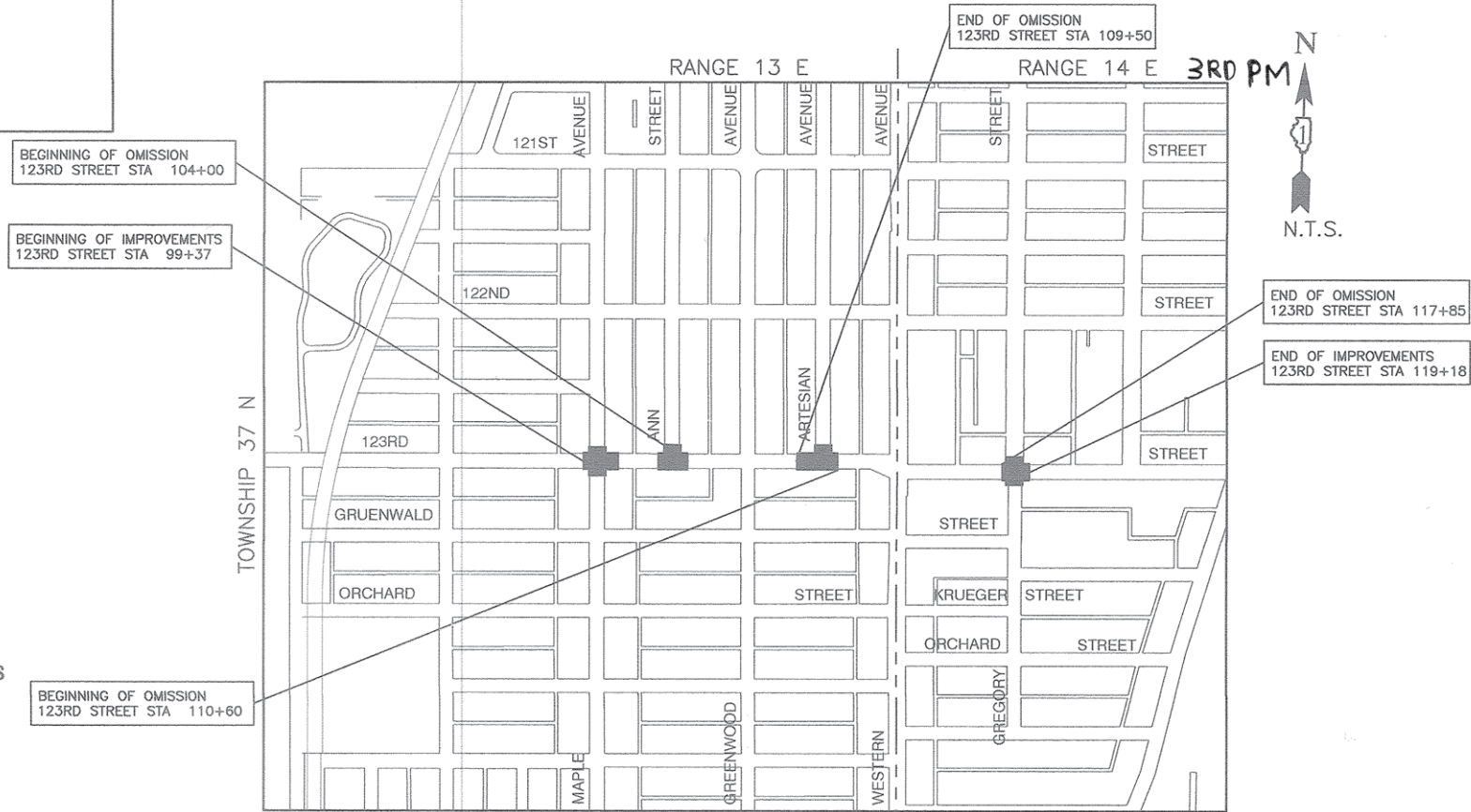
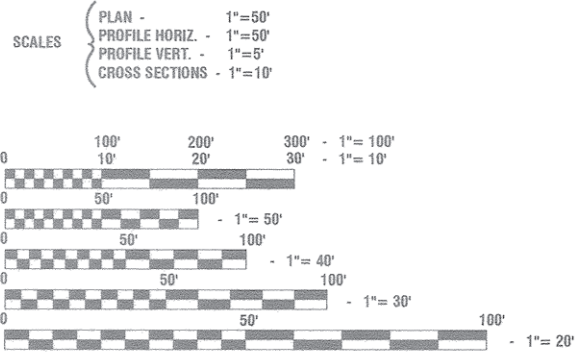

FULL SIZE PLANS HAVE BEEN PREPARED USING STANDARD ENGINEERING SCALES, REDUCED SIZED PLANS WILL NOT CONFORM TO STANDARD SCALES, IN MAKING MEASUREMENTS ON REDUCED PLANS, THE ABOVE SCALES MAY BE USED.

J. U. L. I. E.  
JOINT UTILITY LOCATION INFORMATION FOR EXCAVATION  
1-800-892-0123 or 811

CONTRACT NO. 61C97

LOCATION MAP  
INDICATES PROPOSED IMPROVEMENTS  
GROSS LENGTH=1,981 FEET=0.37 MILES  
NET LENGTH=400 FEET=0.07 MILES

STATE OF ILLINOIS DEPARTMENT OF TRANSPORTATION  
DIVISION OF HIGHWAYS

Approved: *Domingo F. Vargas* MAY 3 2016  
Mayor, City of Blue Island

Passed: *C. Felt* MAY 10 2016  
District 1 Engineer of Local Roads & Streets

Released for Bid Based on Limited Review: *John F. Peterson* May 19 2016  
Regional Engineer

PRINTED BY THE AUTHORITY OF THE STATE OF ILLINOIS

PREPARED BY OR UNDER THE DIRECT SUPERVISION OF:

*Charles F. Riddle*  
4/19/2016

PROGRAM AND OFFICE ENGINEER: CHARLES F. RIDDLE, P.E. 847-705-4406, SCHUMBERG, IL  
CONSULTANTS: ROBINSON ENGINEERING, LTD. 708-331-6700

SUMMARY OF QUANTITIES				TOTAL	CONSTRUCTION
S.I.	CODE NO.	PAY ITEM	UNIT	QUANTITY	TYPE CODE
					0021
	21101615	TOPSOIL FURNISH AND PLACE, 4"	SQ YD	62	62
	31101200	SUBBASE GRANULAR MATERIAL, TYPE B 4"	SQ YD	194	194
	42400200	PORTLAND CEMENT CONCRETE SIDEWALK 5 INCH	SQ FT	1741	1741
	42400800	DETECTABLE WARNINGS	SQ FT	280	280
	44000500	COMBINATION CURB AND GUTTER REMOVAL	FOOT	182	182
	44000600	SIDEWALK REMOVAL	SQ FT	1699	1699
	60300305	FRAMES AND LIDS TO BE ADJUSTED	EACH	2	2
	60603800	COMBINATION CONCRETE CURB AND GUTTER, TYPE B-6.12	FOOT	101	101
	60605000	COMBINATION CONCRETE CURB AND GUTTER, TYPE B-6.24	FOOT	81	81
	67100100	MOBILIZATION	LSUM	1	1
	70102620	TRAFFIC CONTROL AND PROTECTION, STANDARD 701501	LSUM	1	1
	70102635	TRAFFIC CONTROL AND PROTECTION, STANDARD 701701	LSUM	1	1
	70102640	TRAFFIC CONTROL AND PROTECTION, STANDARD 701801	LSUM	1	1
	72000200	SIGN PANEL - TYPE 2	SQ FT	44	44
	72900200	METAL POST - TYPE B	FOOT	64	64
Δ	78000600	THERMOPLASTIC PAVEMENT MARKING - LINE 12"	FOOT	960	960
Δ	78000650	THERMOPLASTIC PAVEMENT MARKING - LINE 24"	FOOT	160	160
	X0327980	PAVEMENT MARKING REMOVAL-WATER BLASTING	SQ FT	1180	1180
	X2020410	EARTH EXCAVATION (SPECIAL)	CU YD	2	2
	X2520700	SODDING, SPECIAL	SQ YD	62	62
	X7200105	SIGN PANEL - TYPE 1 (SPECIAL)	SQ FT	6.24	6.24

Δ SPECIALTY ITEMS

\* - INDICATES SPECIALTY ITEMS

- INDEX OF SHEETS**
1. COVER SHEET
  2. SUMMARY OF QUANTITIES AND GENERAL NOTES
  3. EXISTING CONDITIONS AND REMOVAL PLAN
  4. INTERSECTION IMPROVEMENT PLAN
  - 5.-6. IDOT DISTRICT 1 DETAILS

- HIGHWAY STANDARDS**
- 000001-06 STANDARD SYMBOLS, ABBREVIATIONS AND PATTERNS
  - 424001-08 PERPENDICULAR CURB RAMPS FOR SIDEWALKS
  - 424006-02 DIAGONAL CURB RAMPS FOR SIDEWALKS
  - 424011-02 CORNER PARALLEL CURB RAMPS FOR SIDEWALKS
  - 424021-03 DEPRESSED CORNER FOR SIDEWALKS
  - 424026-01 ENTRANCE / ALLEY PEDESTRIAN CROSSINGS
  - 606001-06 CONCRETE CURB TYPE B AND COMBINATION CONCRETE CURB AND GUTTER
  - 701006-05 OFF-ROAD OPERATIONS, 2L, 2W, 15' TO 24" FROM PAVEMENT EDGE
  - 701301-04 LANE CLOSURE, 2L, 2W, SHORT TIME OPERATIONS
  - 701501-06 URBAN LANE CLOSURE, 2L, 2W UNDIVIDED
  - 701701-10 URBAN LANE CLOSURE, MULTILANE INTERSECTION
  - 701801-06 SIDEWALK, CLOSURE OR CROSSWALK CLOSURE
  - 701901-05 TRAFFIC CONTROL DEVICES
  - 780001-05 TYPICAL PAVEMENT MARKINGS

**GENERAL NOTES**

1. BEFORE STARTING ANY EXCAVATION THE CONTRACTOR SHALL CALL "J.U.L.I.E." AT (800) 892-0123 OR 811 AND (312) 744-7000 FOR FIELD LOCATIONS OF BURIED ELECTRIC, TELEPHONE AND GAS UTILITIES. (48 HOUR NOTIFICATION REQUIRED)
2. UTILITIES INDICATED ON THE PLANS ARE PROVIDED FOR THE CONTRACTOR'S USE AND ARE BASED UPON INFORMATION AVAILABLE AT THE TIME OF THE ADVERTISEMENT FOR BIDS. THE OWNER AND ENGINEER DO NOT GUARANTEE THE ACCURACY OF UTILITY INFORMATION.
3. IT SHALL BE THE CONTRACTOR'S RESPONSIBILITY TO VERIFY ALL DIMENSIONS AND CONDITIONS EXISTING IN THE FIELD PRIOR TO CONSTRUCTION AND ORDERING OF MATERIALS.
4. THE REMOVAL AND/OR REPLACEMENT OF ANY DRIVEWAYS, PAVEMENT, CURB, OR SIDEWALKS. SHALL BE ACCOMPLISHED BY MEANS OF A SAW CUT JOINT, AT THE DIRECTION OF THE ENGINEER. THIS WORK WILL NOT BE PAID FOR SEPARATELY, BUT SHALL BE INCLUDED IN THE UNIT PRICE FOR THE ITEM BEING REMOVED.
5. ANY LOOSE MATERIAL DEPOSITED IN THE FLOW LINE OF DITCHES, GUTTERS OR OTHER DRAINAGE STRUCTURES SHALL BE REMOVED BY THE END OF EACH DAY BY THE CONTRACTOR AT THEIR EXPENSE.

FILE NAME = 15R0936-QUAN-01 - IDOT P01

USER NAME =	DESIGNED -- ERR	REVISED --
	CHECKED -- HLG	REVISED --
PLOT SCALE =	DRAWN -- ACAD	REVISED --
PLOT DATE = 02-03-16	CHECKED -- ACAD	REVISED --

STATE OF ILLINOIS  
DEPARTMENT OF TRANSPORTATION

123RD STREET SIDEWALK IMPROVEMENTS SUMMARY OF QUANTITIES		F.A.U. RTE. 1588	SECTION 09-00184-00-SW	COUNTY COOK	TOTAL SHEETS 6	SHEET NO. 2
SCALE: N/A	SHEET NO. 2	OF 6	SHEETS	STA.	TO STA.	CONTRACT NO. 61C97
		FED. ROAD DIST. NO. 1	ILLINOIS	FED. AID PROJECT	SRTS-4009(268)	

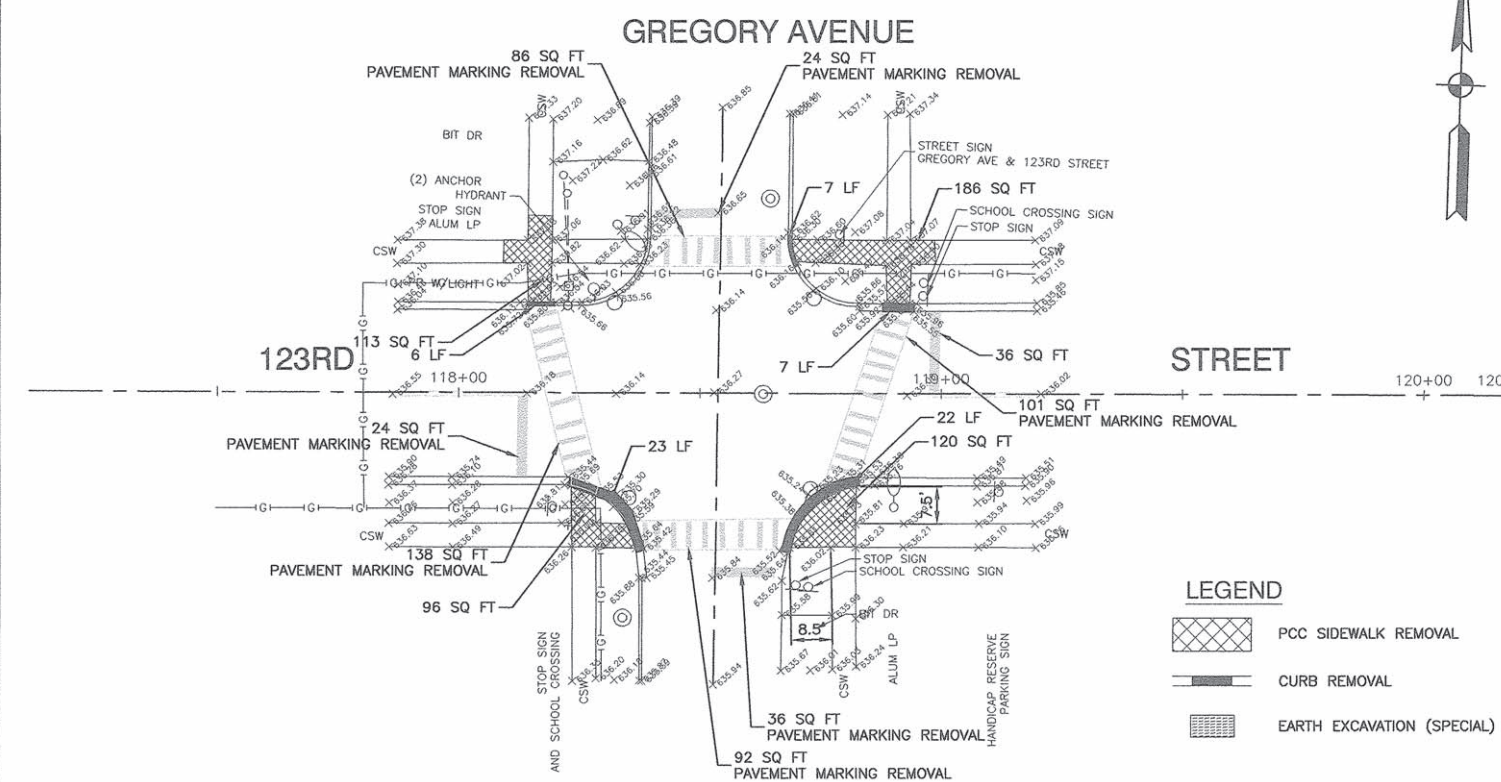
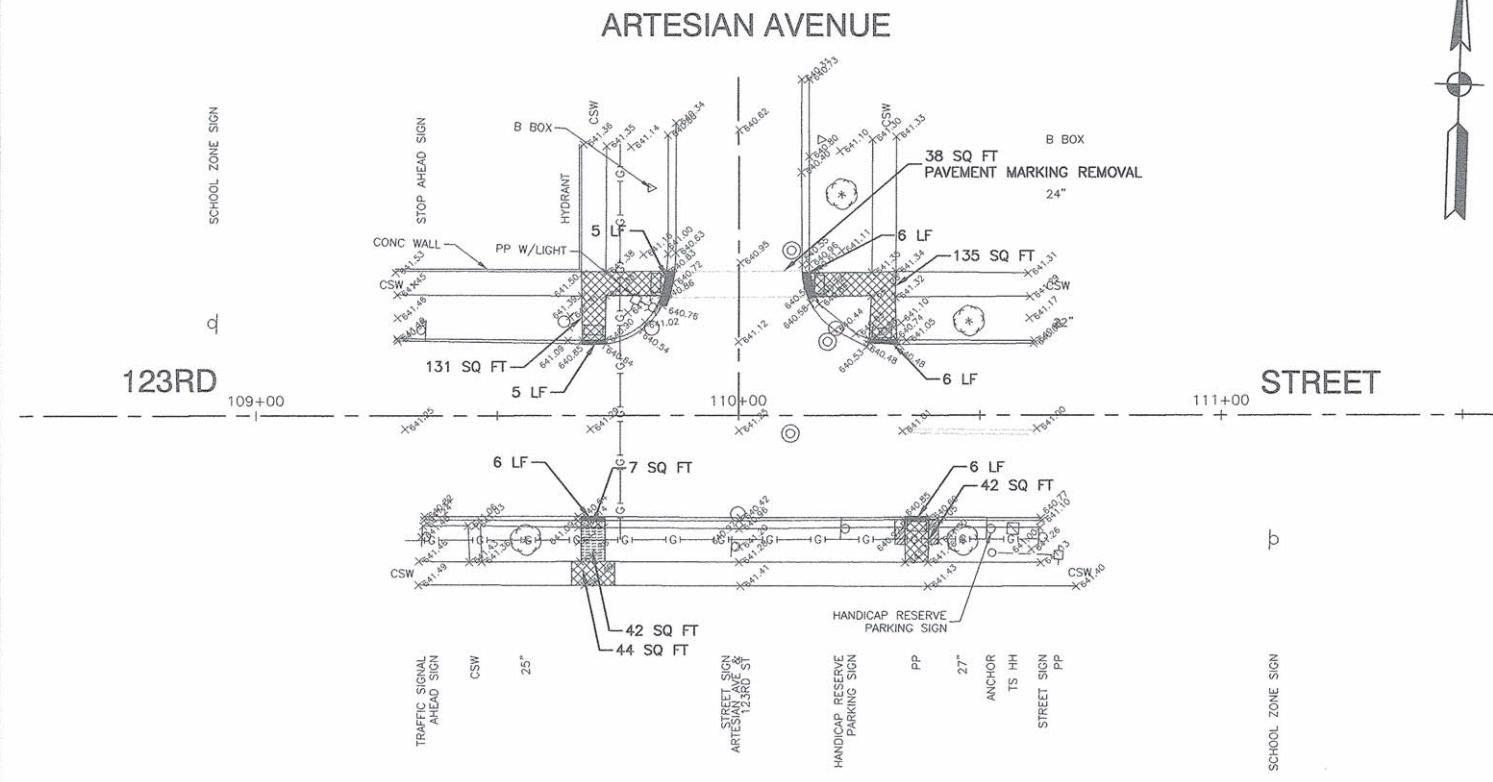
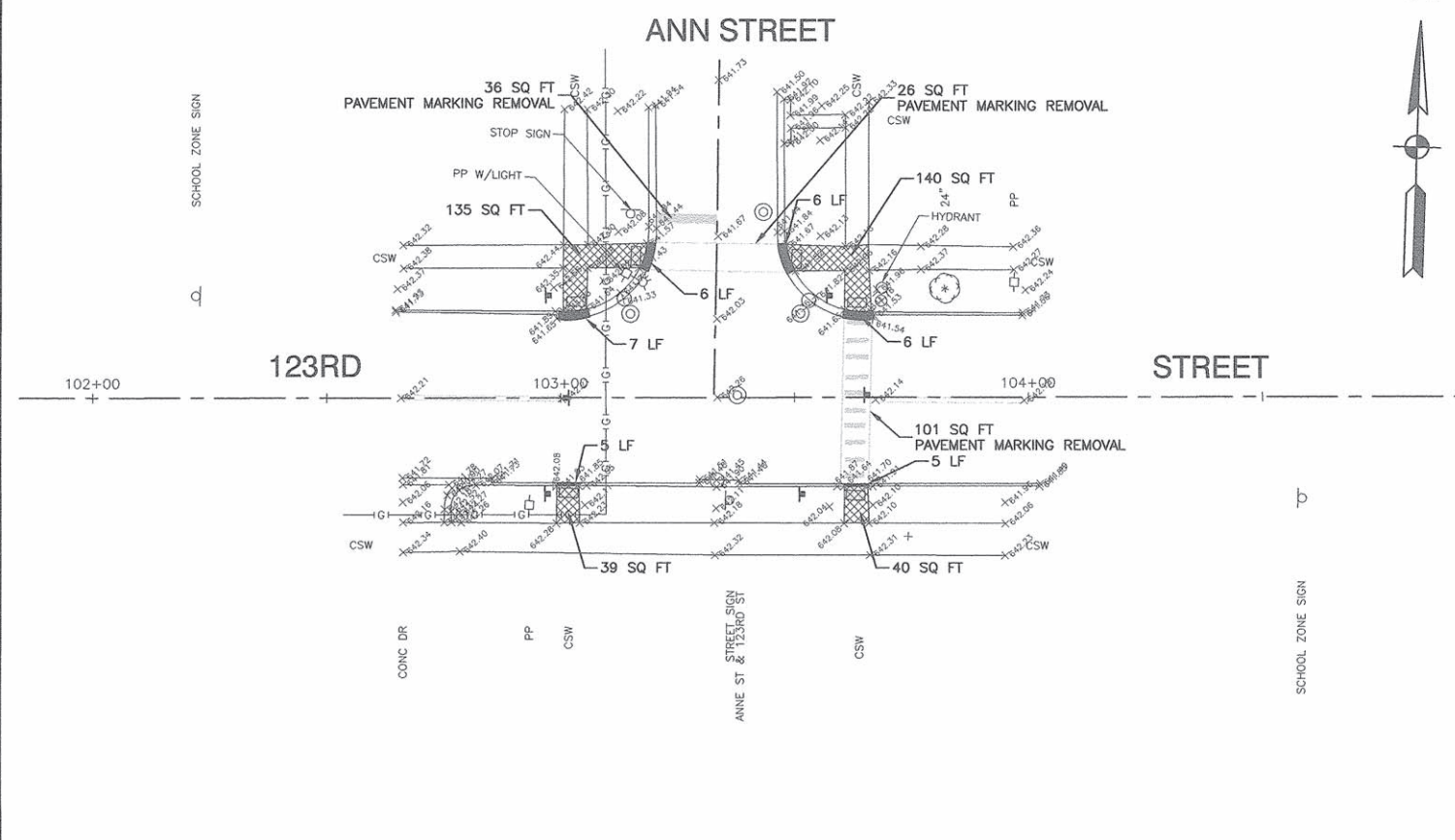
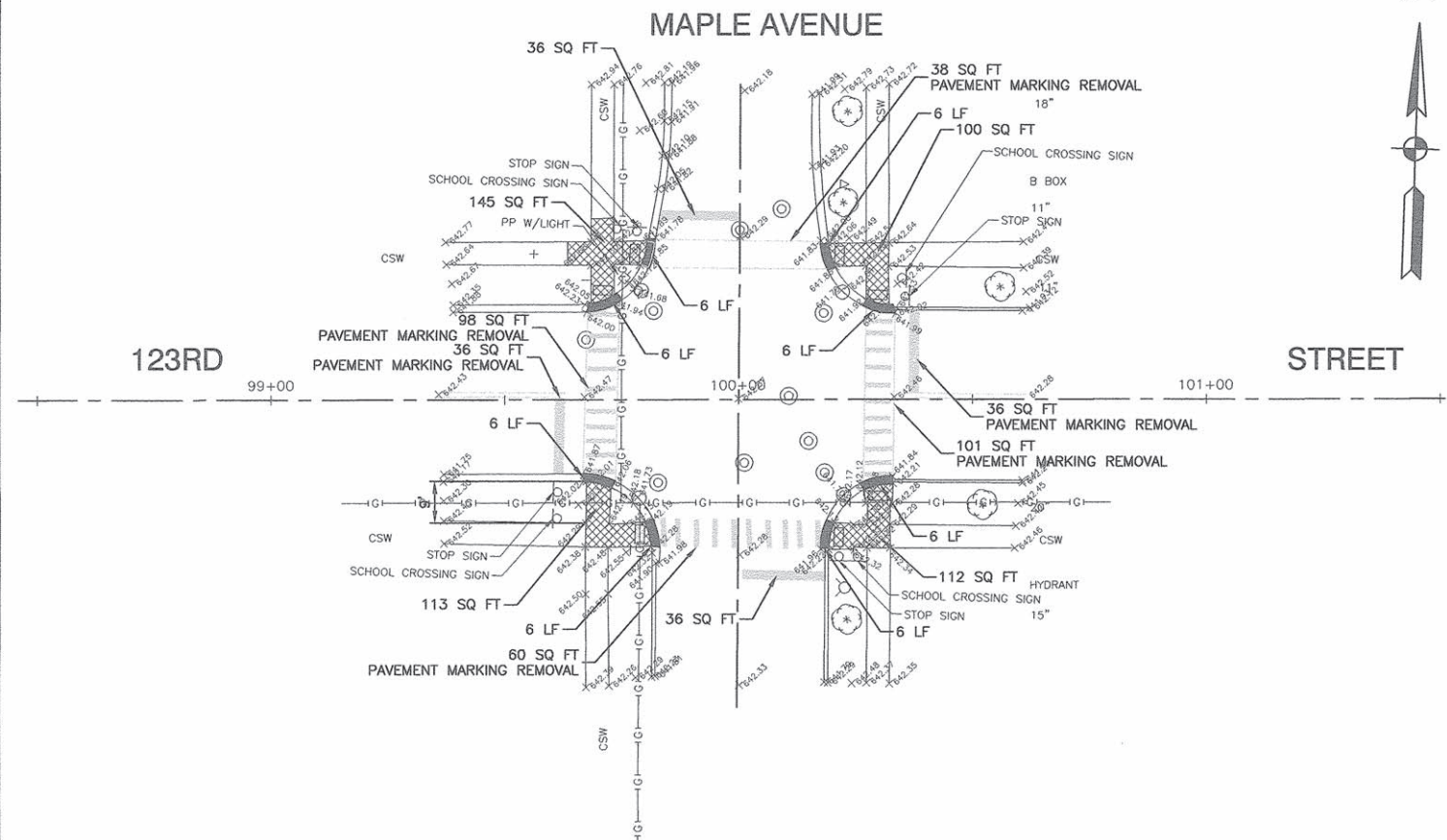

**LEGEND**

	PCC SIDEWALK REMOVAL
	CURB REMOVAL
	EARTH EXCAVATION (SPECIAL)

FILE NAME = 15R0636-ALT-01 - IDOT P01	USER NAME =	DESIGNED - ERR	REVISED -
		CHECKED - HLG	REVISED -
	PLOT SCALE =	DRAWN - MED	REVISED -
	PLOT DATE = 02-03-16	CHECKED - APG	REVISED -

STATE OF ILLINOIS  
DEPARTMENT OF TRANSPORTATION

123RD STREET SIDEWALK IMPROVEMENTS EXISTING CONDITIONS AND REMOVAL PLAN	
SCALE: 1"=20'	SHEET NO. 3 OF 6 SHEETS STA. TO STA.

F.A.U. RTE. 1588	SECTION 09-00184-00-SW	COUNTY COOK	TOTAL SHEETS 6	SHEET NO. 3
CONTRACT NO. 61C97				
FED. ROAD DIST. NO. 1 ILLINOIS FED. AID PROJECT SRTS-4009(268)				

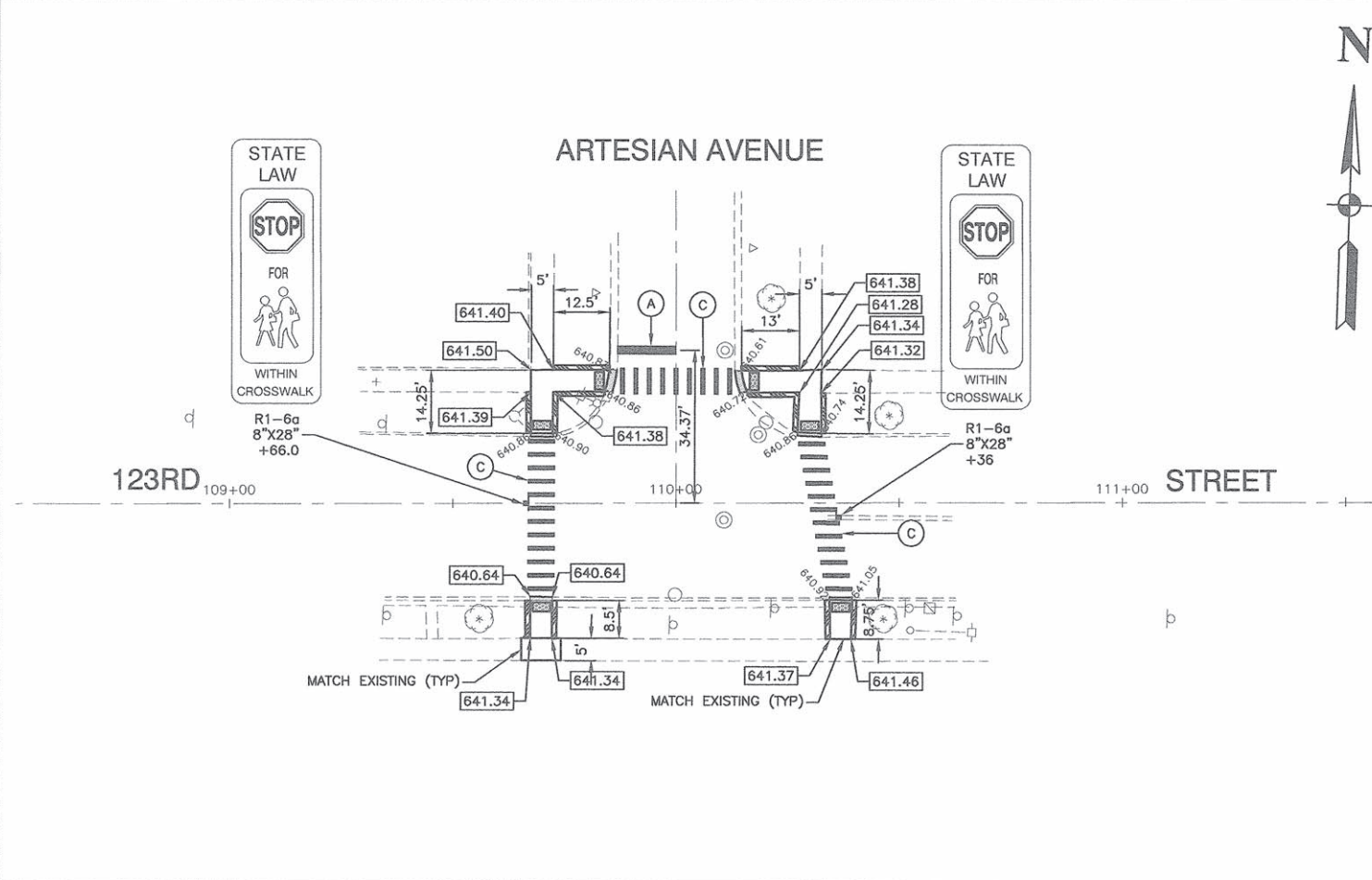
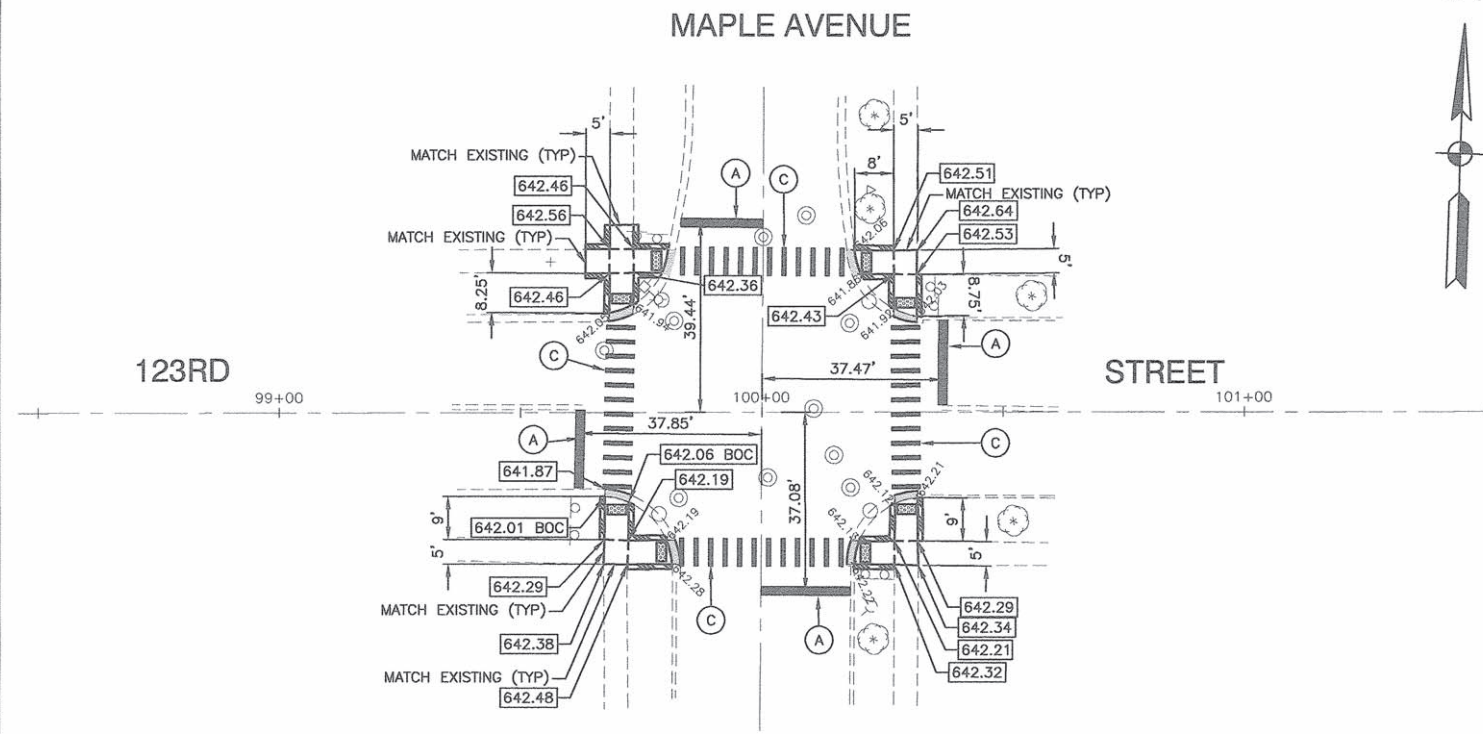

FILE NAME = 15R0636-ALT-01 - IDOT P02
USER NAME =
PLOT SCALE =
PLOT DATE = 02-03-16

DESIGNED -- ERR	REVISD --
CHECKED -- HLG	REVISD --
DRAWN -- MED	REVISD --
CHECKED -- APG	REVISD --

**STATE OF ILLINOIS  
DEPARTMENT OF TRANSPORTATION**

123RD STREET  
SIDEWALK IMPROVEMENTS  
INTERSECTION IMPROVEMENT & STRIPING PLAN

SCALE: 1"=20'      SHEET NO. 4 OF 6 SHEETS      STA. TO STA.

**LEGEND**

(A)	THERMOPLASTIC PAVEMENT MARKING LINE WHITE, 24"
(C)	THERMO PLASTIC PAVEMENT MARKING LINE WHITE, 12" (2' C-C)
[Solid Line]	PROPOSED CONCRETE SIDEWALK
[Dashed Line]	PROPOSED DEPRESSED CURB
[Stippled Area]	PROPOSED DETECTABLE WARNING
x 636.12	MATCH EXISTING GRADE (BACK OF CURB)
636.12	PROPOSED GRADE
ADJ	ADJUST RIM
[Hatched Area]	SODDING (SPECIAL)

F.A.U. RTE.	SECTION	COUNTY	TOTAL SHEETS	SHEET NO.
1588	09-00184-00-SW	COOK	6	4
CONTRACT NO. 61C97				
FED. ROAD DIST. NO. 1 ILLINOIS FED. AID PROJECT SRTS-4009(268)				

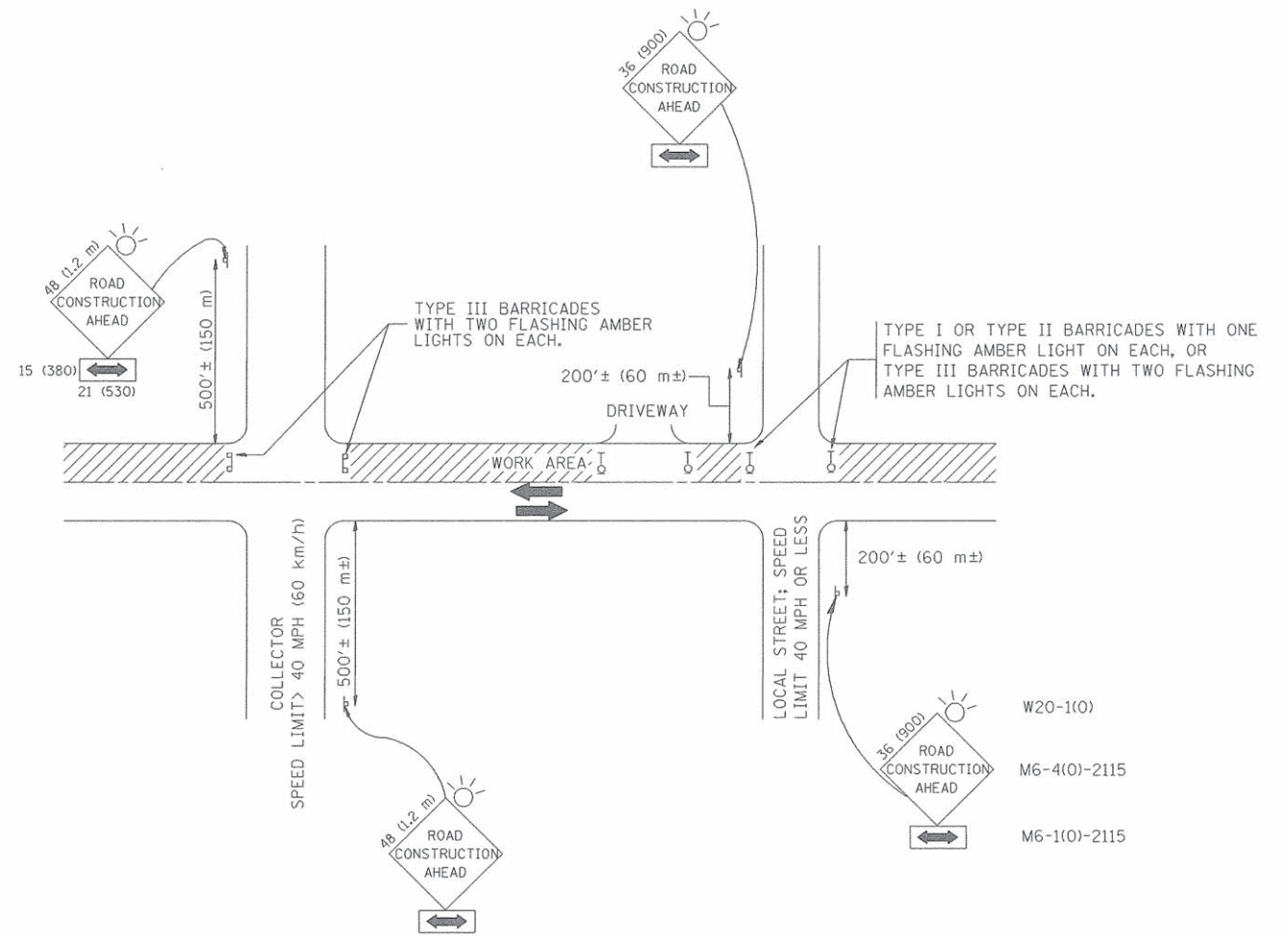

TRAFFIC CONTROL AND PROTECTION FOR SIDE ROADS, INTERSECTIONS, AND DRIVEWAYS

NOTES:

- A. FOR NO LANE RESTRICTION ON THE SIDE ROAD OR DRIVEWAYS
  1. SIDE ROAD WITH A SPEED LIMIT OF 40 MPH (60 km/h) OR LESS AS SHOWN ON THE DRAWING AND AS DIRECTED BY THE ENGINEER:
    - a) ONE **ROAD CONSTRUCTION AHEAD** SIGN 36 x 36 (900x900) WITH A FLASHER AND FLAG MOUNTED ON IT APPROXIMATELY 200' (60 m) IN ADVANCE OF THE MAIN ROUTE.
    - b) THE CLOSED PORTION OF THE MAIN ROUTE SHALL BE PROTECTED BY BLOCKING WITH TYPE I, TYPE II OR TYPE III BARRICADES, 1/3 OF THE CROSS SECTION OF THE CLOSED PORTION.
  2. SIDE ROAD WITH A SPEED LIMIT GREATER THAN 40 MPH (60 km/h) AS SHOWN ON THE DRAWING AND AS DIRECTED BY THE ENGINEER:
    - a) ONE **ROAD CONSTRUCTION AHEAD** SIGN 48 x 48 (1.2 m x 1.2 m) WITH A FLASHER MOUNTED ON IT APPROXIMATELY 500' (150 m) IN ADVANCE OF THE MAIN ROUTE.
    - b) THE CLOSED PORTION OF THE MAIN ROUTE SHALL BE PROTECTED BY BLOCKING WITH TYPE III BARRICADES, 1/2 OF THE CROSS SECTION OF THE CLOSED PORTION.
  3. WHEN THE SIDE ROAD LIES BETWEEN THE BEGINNING OF THE MAINLINE SIGNING AND THE WORK ZONE, A SINGLE HEADED ARROW (M6-1) SHALL BE USED IN LIEU OF THE DOUBLE HEADED ARROW (M6-4).
- B. FOR A LANE CLOSURE ON A SIDE ROAD OR DRIVEWAY:
 

USE APPLICABLE PORTIONS OF THE TYPICAL APPLICATION OF TRAFFIC CONTROL DEVICES (STD. 701501, STD. 701606 OR THE APPROPRIATE STANDARD). THE SPACING OF SIGNS AND BARRICADES SHALL BE ADJUSTED FOR FIELD CONDITIONS AS DIRECTED BY THE ENGINEER. THE DIRECTIONAL ARROW SHALL BE COVERED OR REMOVED WHEN NO LONGER CONSISTENT WITH THE SIDE ROAD LANE CLOSURE.

  - C. ADVANCE WARNING SIGNS ARE TO BE OMITTED ON DRIVEWAY UNLESS OTHERWISE NOTED.
  - D. THE TRAFFIC CONTROL AND PROTECTION FOR SIDE ROADS, INTERSECTIONS, AND DRIVEWAYS SHALL BE INCIDENTAL TO THE COST OF SPECIFIED TRAFFIC CONTROL STANDARDS OR ITEMS.

All dimensions are in millimeters (inches) unless otherwise shown.

FILE NAME = 15R0636-DT1S-01 - IDOT P01	USER NAME =	DESIGNED -- LHA	REVISED -- J. OBERLE 10-18-95
		CHECKED --	REVISED -- A. HOUSEH 03-06-96
	PLOT SCALE =	DRAWN --	REVISED -- A. HOUSEH 10-15-96
	PLOT DATE = 02-03-16	CHECKED -- 06-89	REVISED -- T. RAMMACHER 01-06-00

STATE OF ILLINOIS  
DEPARTMENT OF TRANSPORTATION

TRAFFIC CONTROL AND PROTECTION FOR  
SIDE ROADS, INTERSECTIONS, AND DRIVEWAYS

SCALE: SHEET NO. 5 OF 6 SHEETS STA. TO STA.

F.A.U. RTE.	SECTION	COUNTY	TOTAL SHEETS	SHEET NO.
1588	09-00184-00-SW	COOK	6	5
<b>TC-10</b>			CONTRACT NO. 61C97	
FED. ROAD DIST. NO. 1 ILLINOIS FED. AID PROJECT SPTS-4009(268)				

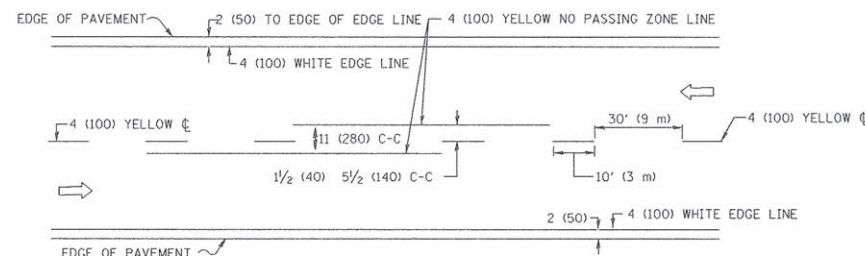

**2-LANE ROADWAY**

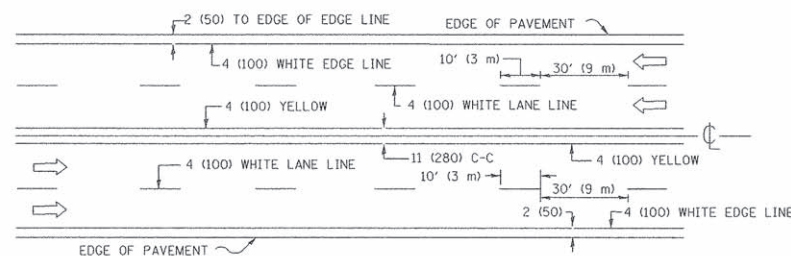

**MULTI-LANE UNDIVIDED**

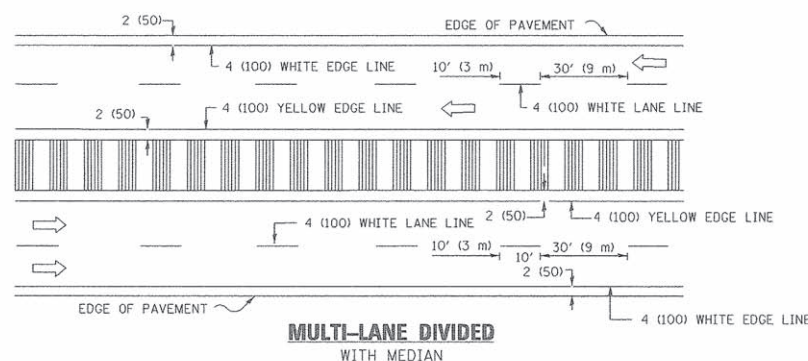

**MULTI-LANE DIVIDED WITH MEDIAN**

**TYPICAL LANE AND EDGE LINE MARKING**

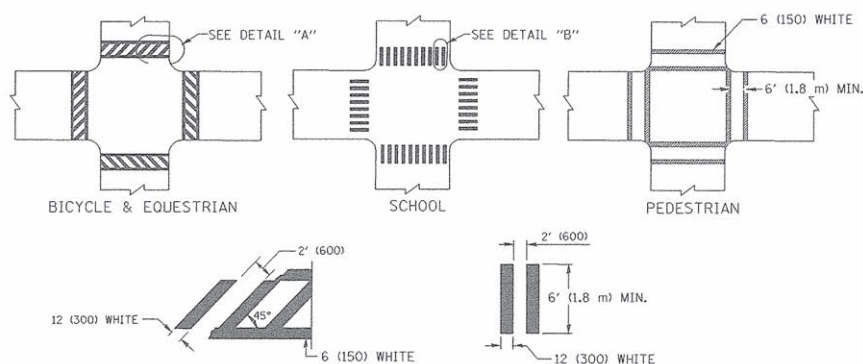

**DETAIL "A"**

**DETAIL "B"**

**TYPICAL CROSSWALK MARKING**

\* MARKINGS SHALL BE INSTALLED PARALLEL TO THE CENTERLINE OF THE ROAD WHICH IT CROSSES

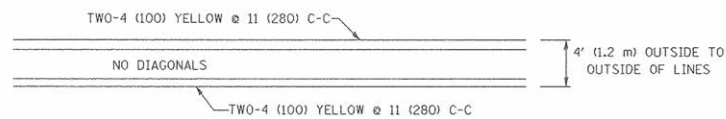

**4' (1.2 m) WIDE MEDIANS ONLY**

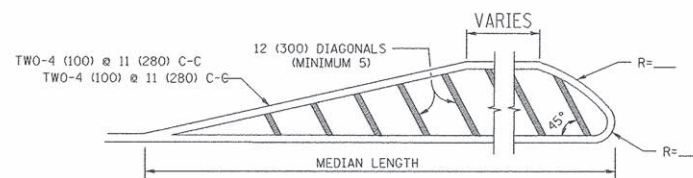

FOR MEDIAN LENGTHS WHERE DIAGONAL SPACING CANNOT BE ATTAINED, USE 5 (FIVE) EQUALLY SPACED DIAGONAL LINES.

DIAGONAL LINE SPACING: 50' (15 m) C-C (LESS THAN 30MPH (50 km/h))  
75' (25 m) C-C 30MPH (50 km/h) TO 45MPH (70 km/h)  
150' (45 m) C-C (MORE THAN 45MPH (70 km/h))

**MEDIANS OVER 4' (1.2 m) WIDE**

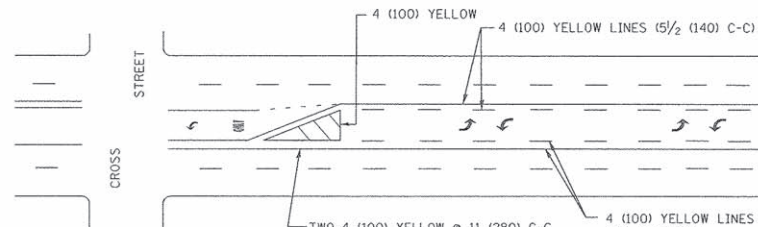

A MINIMUM OF TWO PAIRS OF TURN ARROWS SHALL BE USED, WHITE IN COLOR. ADDITIONAL PAIRS SHALL BE PLACED AT 200' (60 m) TO 300' (90 m) INTERVALS.

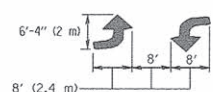

**MEDIAN WITH TWO-WAY LEFT TURN LANE**

**TYPICAL PAINTED MEDIAN MARKING**

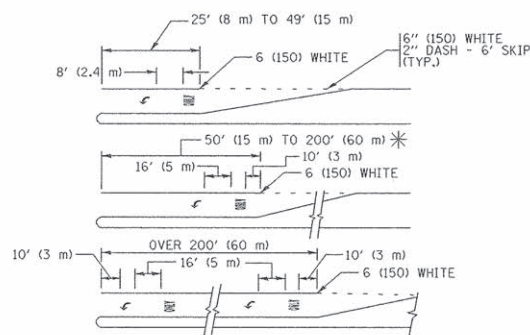

FULL SIZE LETTERS 8' (2.4 m) AND ARROWS SHALL BE USED. AREA = 15.6 SQ. FT. (1.5 m<sup>2</sup>) ONLY AREA = 20.8 SQ. FT. (1.9 m<sup>2</sup>)

\* TURN LANES IN EXCESS OF 400' (120 m) IN LENGTH MAY HAVE AN ADDITIONAL SET OF ARROW - "ONLY" INSTALLED MIDWAY BETWEEN THE OTHER TWO SETS OF ARROW - "ONLY".

**TYPICAL LEFT (OR RIGHT) TURN LANE**

**TYPICAL TURN LANE MARKING**

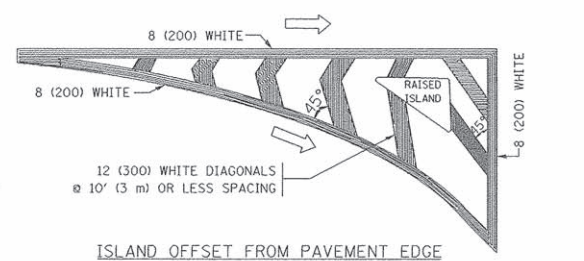

ISLAND OFFSET FROM PAVEMENT EDGE

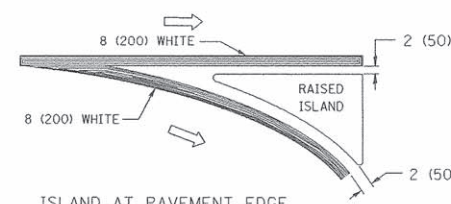

ISLAND AT PAVEMENT EDGE

**TYPICAL ISLAND MARKING**

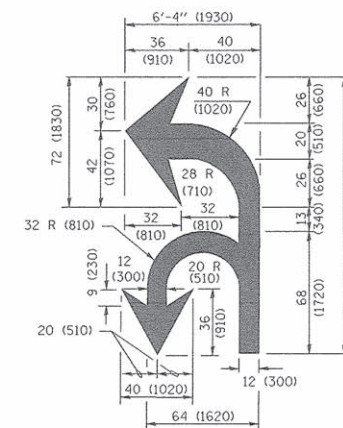

**COMBINATION LEFT AND U-TURN**

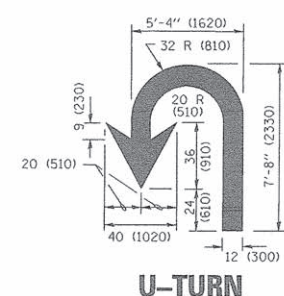

**U-TURN**

**LANE REDUCTION TRANSITION**

\* LANE REDUCTION ARROWS REQUIRED AT SPEEDS OF 45 MPH OR GREATER OR WHEN SPECIFIED IN PLANS.

D(FT)	SPEED LIMIT
345	30
425	35
500	40
580	45
665	50
750	55

TYPE OF MARKING	WIDTH OF LINE	PATTERN	COLOR	SPACING /REMARKS
CENTERLINE ON 2 LANE PAVEMENT	4 (100)	SKIP-DASH	YELLOW	10' (3 m) LINE WITH 30' (9 m) SPACE
CENTERLINE ON MULTI-LANE UNDIVIDED PAVEMENT	2 @ 4 (100)	SOLID	YELLOW	11 (280) C-C
NO PASSING ZONE LINES; FOR ONE DIRECTION FOR BOTH DIRECTIONS	4 (100) 2 @ 4 (100)	SOLID SOLID	YELLOW YELLOW	5 1/2 (140) C-C FROM SKIP-DASH CENTERLINE 11 (280) C-C OMIT SKIP-DASH CENTERLINE BETWEEN
LANE LINES	4 (100) 5 (125) ON FREEWAYS	SKIP-DASH SKIP-DASH	WHITE WHITE	10' (3 m) LINE WITH 30' (9 m) SPACE
DOTTED LINES (EXTENSIONS OF CENTER, LANE OR TURN LANE MARKINGS)	SAME AS LINE BEING EXTENDED	SKIP-DASH	SAME AS LINE BEING EXTENDED	2' (600) LINE WITH 6' (1.8 m) SPACE
EDGE LINES	4 (100)	SOLID	YELLOW-LEFT WHITE-RIGHT	OUTLINE MEDIANS IN YELLOW
TURN LANE MARKINGS	6 (150) LINE; FULL SIZE LETTERS & SYMBOLS (8' (2.4m))	SOLID	WHITE	SEE TYPICAL TURN LANE MARKING DETAIL
TWO WAY LEFT TURN MARKING	2 @ 4 (100) EACH DIRECTION 8' (2.4m) LEFT ARROW	SKIP-DASH AND SOLID IN PAIRS	YELLOW WHITE	10' (3 m) LINE WITH 30' (9 m) SPACE FOR SKIP-DASH; 5 1/2 (140) C-C BETWEEN SOLID LINE AND SKIP-DASH LINE SEE TYPICAL TWO-WAY LEFT TURN MARKING DETAIL
CROSSWALK LINES (PEDESTRIAN) A. DIAGONALS (BIKE & EQUESTRIAN) B. LONGITUDINAL BARS (SCHOOL)	2 @ 6 (150) 12 (300) @ 45° 12 (300) @ 90°	SOLID SOLID SOLID	WHITE WHITE WHITE	NOT LESS THAN 6' (1.8 m) APART 2' (600) APART SEE TYPICAL CROSSWALK MARKING DETAILS.
STOP LINES	24 (600)	SOLID	WHITE	PLACE 4' (1.2 m) IN ADVANCE OF AND PARALLEL TO CROSSWALK, IF PRESENT. OTHERWISE, PLACE AT DESIRED STOPPING POINT. PARALLEL TO CROSSROAD CENTERLINE, WHERE POSSIBLE.
PAINTED MEDIANS	2 @ 4 (100) WITH 12 (300) DIAGONALS @ 45° NO DIAGONALS USED FOR 4' (1.2 m) WIDE MEDIANS	SOLID	YELLOW; TWO WAY TRAFFIC WHITE; ONE WAY TRAFFIC	11 (280) C-C FOR THE DOUBLE LINE SEE TYPICAL PAINTED MEDIAN MARKING.
GORE MARKING AND CHANNELIZING LINES	8 (200) WITH 12 (300) DIAGONALS @ 45°	SOLID	WHITE	DIAGONALS: 15' (4.5 m) C-C (LESS THAN 30MPH (50 km/h)) 20' (6 m) C-C 30MPH (50 km/h) TO 45MPH (70 km/h) 30' (9 m) C-C (OVER 45MPH (70 km/h))
RAILROAD CROSSING	24 (600) TRANSVERSE LINES; "RR" IS 6' (1.8 m) LETTERS; 16 (400) LINE FOR "X"	SOLID	WHITE	SEE STATE STANDARD 780001 AREA OF: "R"=3.6 SQ. FT. (0.33 m <sup>2</sup> ) EACH "X"=54.0 SQ. FT. (5.0 m <sup>2</sup> )
SHOULDER DIAGONALS (REQUIRED FOR SHOULDERS ≥ 8')	12 (300) @ 45°	SOLID	WHITE - RIGHT YELLOW - LEFT	50' (15 m) C-C (LESS THAN 30MPH (50 km/h)) 75' (25 m) C-C (30 MPH (50 km/h) TO 45MPH (70 km/h)) 150' (45 m) C-C (OVER 45MPH (70 km/h))
U TURN ARROW	SEE DETAIL	SOLID	WHITE	16.3 SF
2 ARROW COMBINATION LEFT AND U TURN	SEE DETAIL	SOLID	WHITE	30.4 SF

FOR FURTHER DETAILS ON PAVEMENT MARKING REFER TO STANDARD SPECIFICATIONS FOR ROAD AND BRIDGE CONSTRUCTION AND STATE STANDARD 780001.

All dimensions are in inches (millimeters) unless otherwise shown.

FILE NAME = 15R0636-07LS-01 - IDOT P(1) 2)	USER NAME =	DESIGNED = LHA	REVISED = J. OBERLE 10-18-95
		CHECKED =	REVISED = A. HOUSEH 03-06-96
	PLOT SCALE =	DRAWN =	REVISED = A. HOUSEH 10-15-96
	PLOT DATE = 02-03-16	CHECKED = 06-89	REVISED = T. RAMMACHER 01-06-00

**STATE OF ILLINOIS  
DEPARTMENT OF TRANSPORTATION**

**DISTRICT ONE  
TYPICAL PAVEMENT MARKINGS**

F.A.U. RTE.	SECTION	COUNTY	TOTAL SHEETS	SHEET NO.
1588	09-00184-00-SW	COOK	6	6
<b>TC-13</b>		CONTRACT NO. 61C97		
FED. ROAD DIST. NO. 1	ILLINOIS	FED. AID PROJECT SRTS-4009(268)		

SCALE: SHEET NO. 6 OF 6 SHEETS STA. TO STA.