

STATE OF ILLINOIS  
DEPARTMENT OF TRANSPORTATION

F.A.P. RTE.	SECTION	COUNTY	TOTAL SHEETS	SHEET NO.
853	D9 CM SAFETY SHLDRS 2017-1	FRANKLIN	7	1
		ILLINOIS	CONTRACT NO. 78533	

FOR INDEX OF SHEETS, SEE SHEET NO. 2

# PROPOSED HIGHWAY PLANS

F.A.P. ROUTE 853 (IL RTE. 14)  
D9 CM SAFETY SHLDRS 2017-1

TRAFFIC DATA	ADT(2015)	%TRUCKS
IL RTE 14	2450	11.5%

POSTED SPEED LIMIT: 55 MPH

SAFETY SHOULDERS  
FRANKLIN COUNTY

C-99-035-16

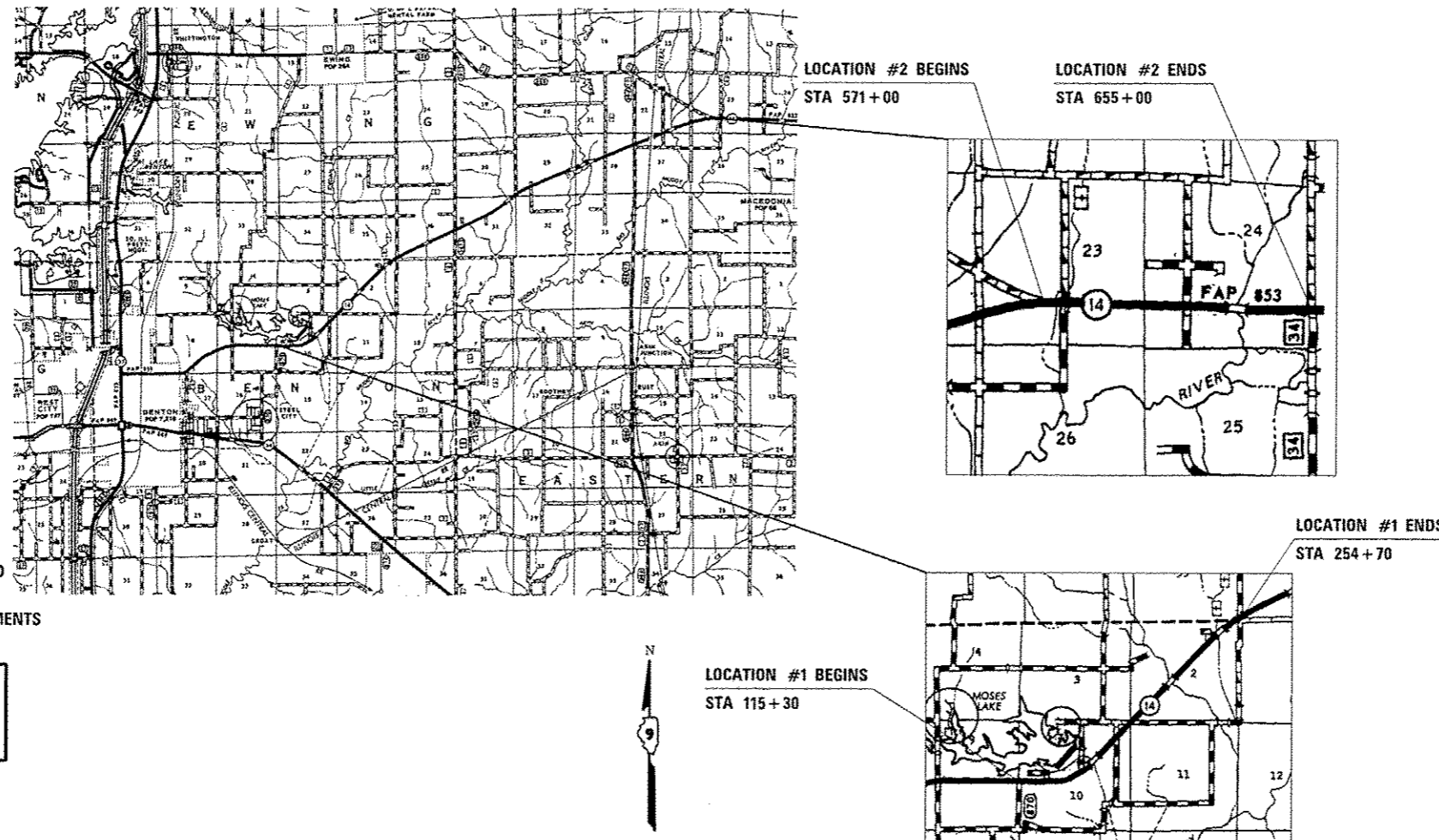

FULL SIZE PLANS HAVE BEEN PREPARED USING STANDARD ENGINEERING SCALES. REDUCED SIZED PLANS WILL NOT CONFORM TO STANDARD SCALES. IN MAKING MEASUREMENTS ON REDUCED PLANS, THE ABOVE SCALES MAY BE USED.

J.U.L.I.E.  
JOINT UTILITY LOCATION INFORMATION FOR EXCAVATION  
1-800-892-0123  
OR 811

PROJECT ENGINEER: KYLE MARKEL  
PROJECT MANAGER: SUSAN POE

CONTRACT NO. 78533

GROSS LENGTH = 22,340 FT. = 4.23 MILES  
NET LENGTH = 21,773 FT. = 4.12 MILES

STATE OF ILLINOIS  
DEPARTMENT OF TRANSPORTATION

SUBMITTED May 13 2016  
Jeffrey R. Kuen  
REGIONAL FIVE ENGINEER

July 1 2016  
Matthew M. Addis PE  
ENGINEER OF DESIGN AND ENVIRONMENT

July 1 2016  
Tracie A. [Signature]  
DIRECTOR OF PROGRAM DEVELOPMENT

PRINTED BY THE AUTHORITY  
OF THE STATE OF ILLINOIS

# INDEX OF SHEETS

SHEET NO.	DESCRIPTION
1	COVER SHEET
2	INDEX OF SHEETS, STANDARDS, SIGNATURE BLOCK
3	GENERAL NOTES, MIXTURE REQUIREMENTS
4	SUMMARY OF QUANTITIES
5	TYPICAL SECTIONS
6	SCHEDULE OF QUANTITIES
7	DETAILS

## STANDARDS

000001-06	STANDARD SYMBOLS, ABBREVIATIONS AND PATTERNS
001006	DECIMAL OF AN INCH AND OF A FOOT
701001-02	OFF-RD OPERATIONS, 2L, 2W, MORE THAN 15' AWAY
701006-05	OFF-RD OPERATIONS, 2L, 2W, 15' TO 24" FROM PAVEMENT EDGE
701326-04	LANE CLOSURE, 2L, 2W, PAVEMENT WIDENING, FOR SPEEDS > 45 MPH
701901-06	TRAFFIC CONTROL DEVICES

Prepared By:	<i>[Signature]</i> DISTRICT STUDIES & PLANS ENGINEER
Examined By:	<i>[Signature]</i> DISTRICT LAND ACQUISITION ENGINEER
Examined By:	<i>[Signature]</i> DISTRICT PROGRAM DEVELOPMENT ENGINEER
Examined By:	<i>[Signature]</i> DISTRICT OPERATIONS ENGINEER
Examined By:	<i>[Signature]</i> DISTRICT PROJECT IMPLEMENTATION ENGINEER
Examined By:	<i>[Signature]</i> DISTRICT CONSTRUCTION ENGINEER
Examined By:	<i>[Signature]</i> DISTRICT MATERIALS ENGINEER

FILE NAME	USER NAME	DESIGNED	REVISED	STATE OF ILLINOIS DEPARTMENT OF TRANSPORTATION	INDEX OF SHEETS, STANDARDS, SIGNATURE BLOCK	F.A.P. RTE.	SECTION	COUNTY	TOTAL SHEETS	SHEET NO.	
PROJECT	PROJECT	PROJECT	PROJECT			853	D9 CM SAFETY SHOULDERS 2017-1	FRANKLIN	7	2	
SCALE	PLOT SCALE	CHECKED	REVISED			CONTRACT NO. 78533					
PLOT DATE	DATE	DATE	DATE			ILLINOIS FED. AID PROJECT					

## GENERAL NOTES

1) FACTORS USED FOR ESTIMATING PLAN QUANTITIES ARE AS FOLLOWS AND SHALL NOT BE USED FOR THE BASIS OF FINAL QUANTITIES:

ALL HOT MIX ASPHALT	2.016 TONS/CU. YD.
ALL AGGREGATE	2.05 TONS/CU. YD.
BITUMINOUS MATERIALS:	
( TACK COAT)	
ON PAVEMENT	0.05 LBS./SQ. FT.
HMA LIFTS	0.025 LBS./SQ. FT.
( PRIME COAT)	
AGGREGATE BASES	0.25 LBS./SQ. FT.
RIPRAP	1.50 TONS/CU. YD.
EARTH	110 LBS / CU. FT.
LIME	4, 5, OR 6% WEIGHT OF EARTH.

- 2) WHEN PLACING HOT-MIX ASPHALT SHOULDERS, 8" THE CONTRACTOR SHALL TRIM EXISTING SURFACE AND BASE TO A FIRM, NEAR VERTICAL PLANE BEFORE CONSTRUCTING THE HOT-MIX ASPHALT SHOULDERS, 8". THE COST OF THIS REQUIREMENT IS INCLUDED IN THE UNIT PRICE FOR HOT-MIX ASPHALT SHOULDERS, 8".
- 3) THE EXCAVATED AGGREGATE/EARTH FOR THE PROPOSED SHOULDER SHALL NOT BE WASTED ON THE CONSTRUCTION SITE UNLESS APPROVAL IS FIRST GIVEN BY THE ENGINEER.
- 4) THERE ARE NO AVAILABLE WASTE SITES ON THE EXISTING RIGHT OF WAY WITHIN THE PROJECT LIMITS. DISPOSAL WILL BE THE RESPONSIBILITY OF THE CONTRACTOR AND WASTE MUST BE DISPOSED OF IN ACCORDANCE WITH ARTICLE 202.03 OF THE STANDARD SPECIFICATIONS.

## MIXTURE REQUIREMENTS

LOCATION(S):	HOT-MIX ASPHALT SHOULDERS
MIXTURE USES(S):	HOT-MIX ASPHALT BINDER COURSE, N70, IL-19.0 FINE GRADED
AC/PG:	PG64-22
ABR % (MAX):	SEE SPECIAL PROVISION
DESIGN AIR VOIDS:	4.0%, 70 GYRATION DESIGN
MIXTURE COMPOSITION:	IL-19.0 MM FINE GRADED
FRICITION AGGREGATE:	NONE
QUALITY MANAGEMENT PROGRAM	QCQA

# SUMMARY OF QUANTITIES

COUNTY:	Franklin			
ROUTE:	IL 14, FAP 853			
FUNDING:	100% STATE			
LOCATION:	RURAL			
TOTAL QUANTITY	ROADWAY 0021			
20200600	EXCAVATING AND GRADING EXISTING SHOULDER	UNIT	435	435
40600290	BITUMINOUS MATERIALS (TACK COAT)	POUND	2,177	2,177
48203029	HOT-MIX ASPHALT SHOULDERS, 8"	SQ YD	9,677	9,677
67100100	MOBILIZATION	L SUM	1	1
70100500	TRAFFIC CONTROL AND PROTECTION, STANDARD 701326	L SUM	1	1

5

# TYPICAL SECTION (IL 14)

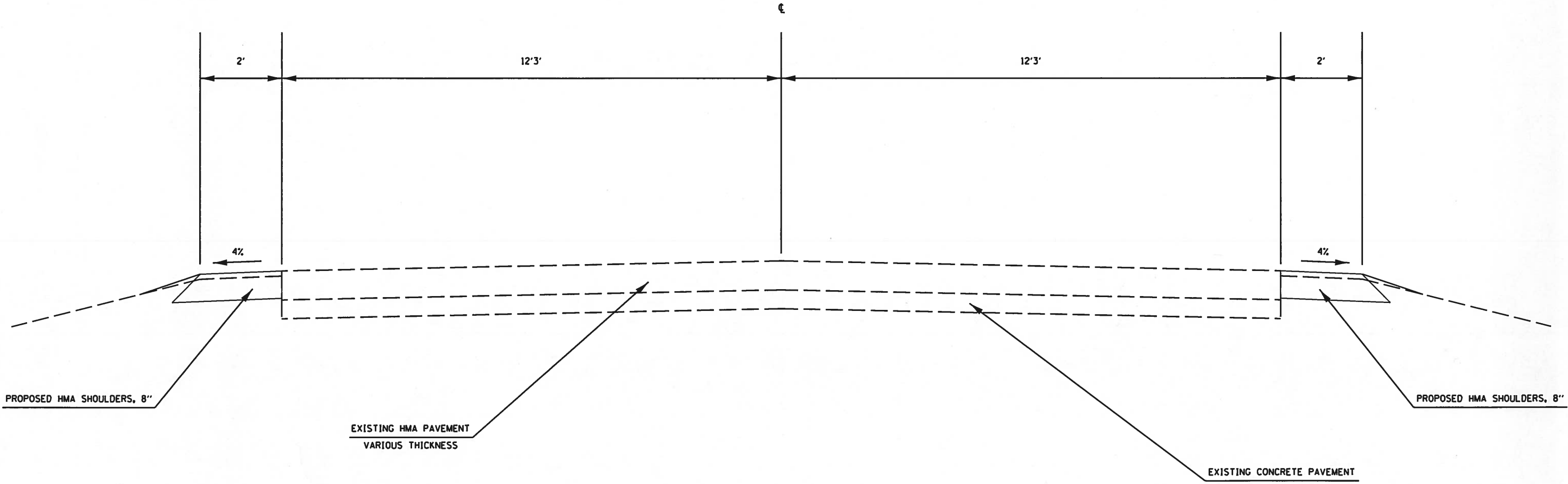

FILE NAME =	USER NAME = markakp	DESIGNED -	REVISED -	<b>STATE OF ILLINOIS DEPARTMENT OF TRANSPORTATION</b>	<b>TYPICAL SECTION</b>			F.A.P. RTE.	SECTION	COUNTY	TOTAL SHEETS	SHEET NO.
pw:\IL084EBIDINTEG.illinois.gov\PI00T\Documents\DOT Offices\District 9\Projects\78533\Drawings\CA\Sheets\78533-sht.dgn	DRAWN to\CA\Sheets\78533-sht.dgn	REVISOR -	REVISOR -		853	D9 CM SAFETY SHLDRS 2017-1	FRANKLIN	7	5			
PLOT SCALE = 100.0000 ' / in.	CHECKED -	REVISOR -	REVISOR -		CONTRACT NO. 78533			ILLINOIS FED. AID PROJECT				
PLOT DATE = 4/28/2016	DATE -	REVISOR -	REVISOR -		SCALE:	SHEET	OF	SHEETS	STA.	TO STA.		

## SHOULDER SCHEDULE

LOCATION STATION TO STATION						GROSS LENGTH	ENTRANCES TO GAP	SIDEROADS TO OMIT	NET LENGTH	EXCAVATING AND GRADING EXISTING SHOULDER	HOT-MIX ASPHALT SHOULDERS, 8"	BITUMINOUS MATERIALS (TACK COAT)	REMARKS
						FOOT			FOOT	UNIT	SQ YD	POUND	
<b>IL 14 (FAP 853)</b>													
<b>LOCATION #1</b>													
STA	115+30	TO	STA	149+11	LT	3381		1 @ 60' WIDTH 1 @ 65' WIDTH	3256	33	724	163	
STA	115+30	TO	STA	149+11	RT	3381			3381	34	751	169	
STA	150+31	TO	STA	208+29	LT	5798		1 @ 80' WIDTH 1 @ 45' WIDTH	5673	57	1261	284	
STA	150+31	TO	STA	208+29	RT	5798		1 @ 70" WIDTH 1 @ 50' WIDTH	5678	57	1262	284	
STA	208+71	TO	STA	237+94	LT	2923	1 @ 35' WIDTH		2888	29	642	144	
STA	208+71	TO	STA	237+64	RT	2893			2893	29	643	145	
STA	238+24	TO	STA	254+70	LT	1646			1646	16	366	82	
STA	237+94	TO	STA	254+70	RT	1676			1676	17	372	84	
<b>LOCATION #2</b>													
STA	571+00	TO	STA	630+67	LT	5967		1 @ 45' WIDTH 1 @ 50' WIDTH	5872	59	1305	294	
STA	571+00	TO	STA	630+59	RT	5959		1 @ 45' WIDTH 1 @ 50' WIDTH	5864	59	1303	293	
STA	631+45	TO	STA	655+00	LT	2355			2355	24	523	118	
STA	631+37	TO	STA	655+00	RT	2363			2363	24	525	118	
<b>TOTAL</b>						<b>44140</b>			<b>43545</b>	<b>435</b>	<b>9677</b>	<b>2177</b>	

# DETAIL OF AGGREGATE FIELD AND PRIVATE ENTRANCES

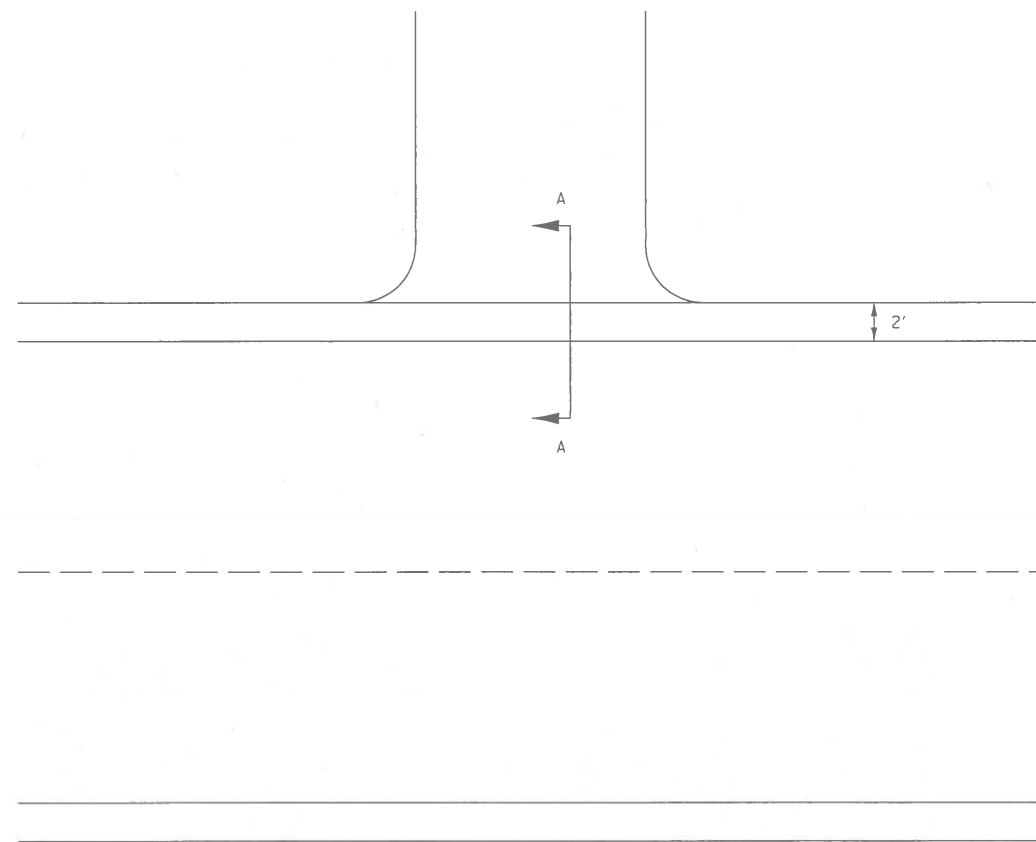

## SECTION A-A

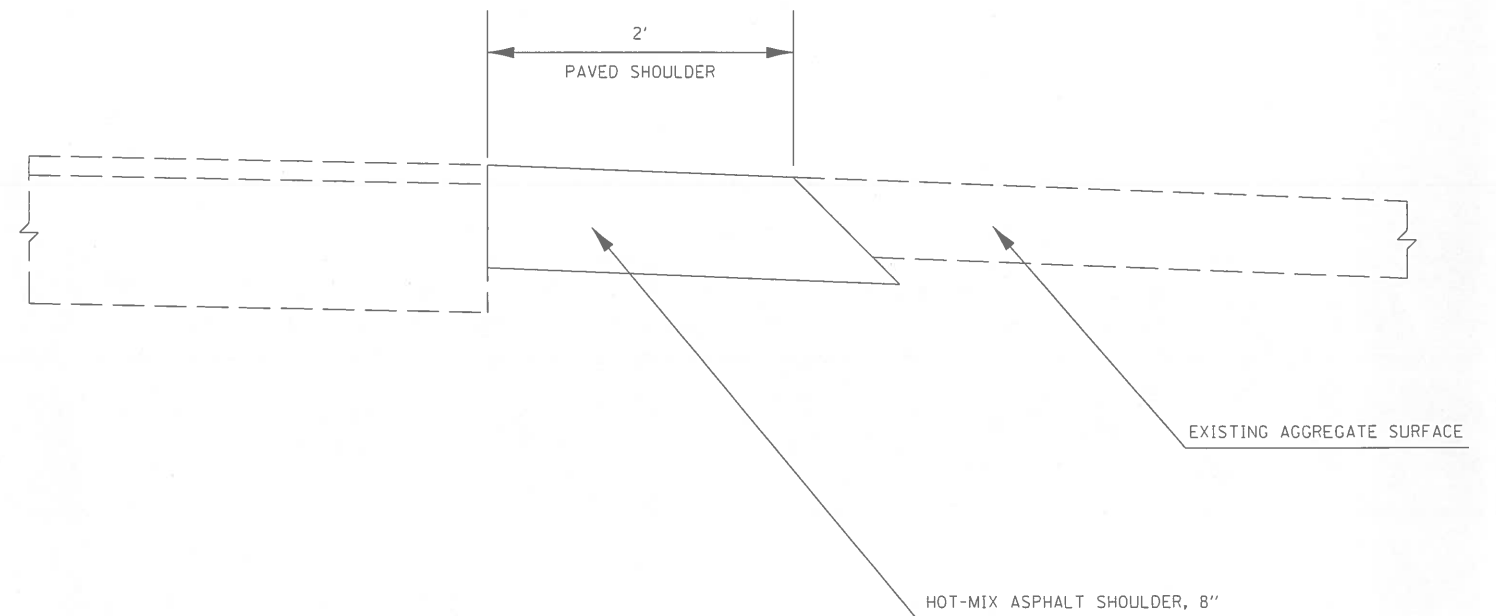

FILE NAME =	USER NAME = markelp	DESIGNED -	REVISED -	<b>STATE OF ILLINOIS DEPARTMENT OF TRANSPORTATION</b>	<b>DETAIL AGGREGATE ENTRANCES</b>	F.A.P. RTE.	SECTION	COUNTY	TOTAL SHEETS	SHEET NO.	
pw\l\l084E8IDINTEG.illinois.gov\PWIDOT\Documents\DOT Offices\District 9\Projects\78533\Drawings\78533-sht.dgn	Documents\DOT Offices\District 9\Projects\78533\Drawings\78533-sht.dgn	DRAWN -	REVISED -			853	09 CM SAFETY SHLDRS 2017-1	FRANKLIN	7	7	
		CHECKED -	REVISED -			CONTRACT NO. 78533					
#MODELNAME*	PLOT DATE = 4/28/2016	DATE -	REVISED -			ILLINOIS FED. AID PROJECT					
					SCALE:	SHEET OF SHEETS		STA. TO STA.			