

F.A.P. RTE.	SECTION	COUNTY	TOTAL SHEETS	SHEET NO.
866	4N-1	LAKE	165	27
STA. 0+687		TO STA. 0+950		
FED. ROAD DIST. NO. 1		ILLINOIS FED. AID PROJECT		

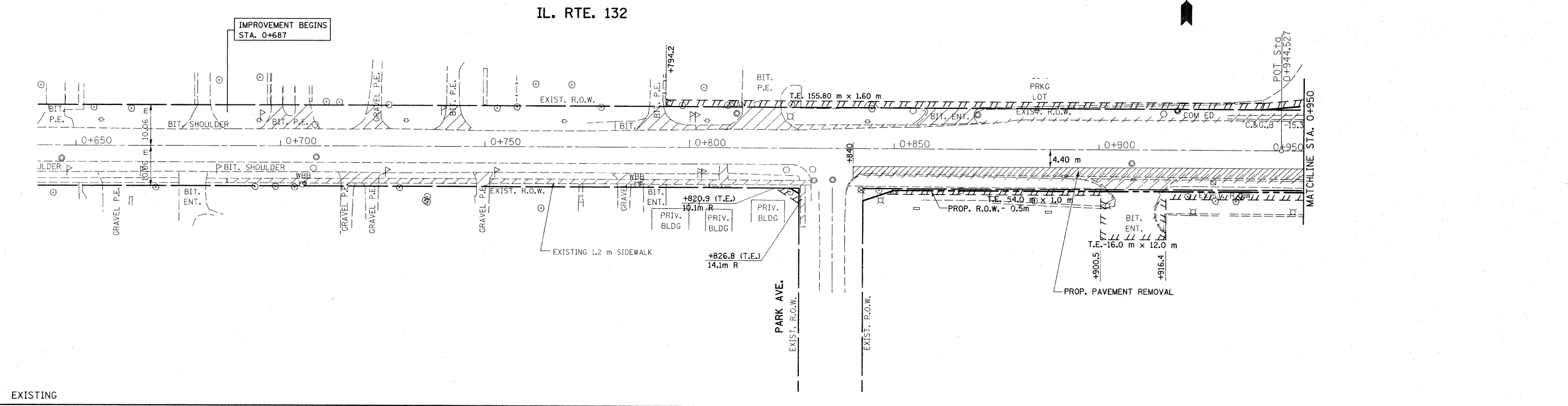

EXISTING

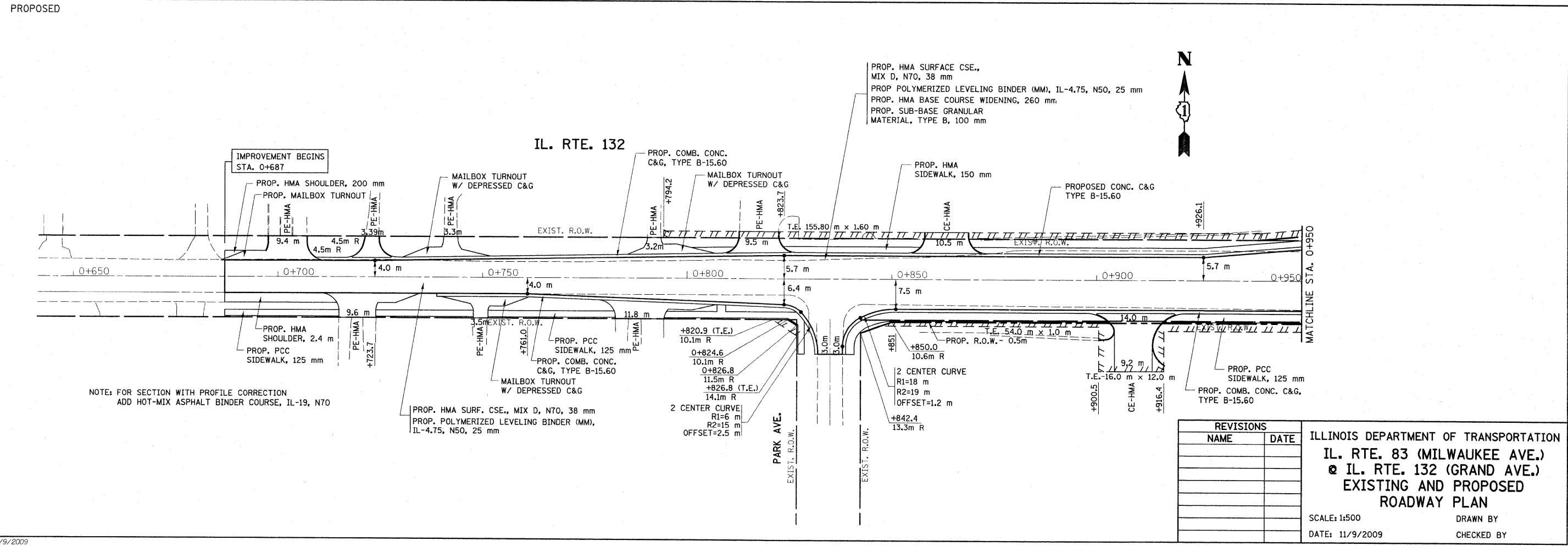

PROPOSED

NOTE: FOR SECTION WITH PROFILE CORRECTION
ADD HOT-MIX ASPHALT BINDER COURSE, IL-19, N70



REVISIONS	
NAME	DATE

ILLINOIS DEPARTMENT OF TRANSPORTATION
IL. RTE. 83 (MILWAUKEE AVE.)
@ IL. RTE. 132 (GRAND AVE.)
EXISTING AND PROPOSED
ROADWAY PLAN
 SCALE: 1:500
 DATE: 11/9/2009
 DRAWN BY
 CHECKED BY