



F.A.P. RTE.	SECTION	COUNTY	TOTAL SHEETS	SHEET NO.
866	4N-1	LAKE	165	99
STA. 3+318.69		TO STA. 3+324.15		
FED. ROAD DIST. NO.		ILLINOIS FED. AID PROJECT		

CONTRACT: 60931

SCOPE OF WORK:

1. DRILL SHAFTS FOR SOLDIER PILES.
2. INSTALL AND ENCASE SOLDIER PILES IN CONCRETE AND CLSM.
3. INSTALL TEMPORARY SOIL RETENTION SYSTEM AS REQUIRED.
4. INSTALL TIMBER LAGGING.
5. REMOVE EXISTING STEEL PIPE GRATING.
6. CUT ALL THE THREE PIPES TO MATCH WITH NEW HEADWALL.
7. INSTALL SHEAR CONNECTORS ON SOLDIER PILES.
8. INSTALL TIMBER LAGGING.
9. INSTALL GEOFABRIC AND FRENCH DRAIN.
10. INSTALL CONCRETE FACING.
11. INSTALL THE PREVIOUSLY REMOVED STEEL PIPE GRATING.
12. REMOVE TEMPORARY SOIL RETENTION SYSTEM.
13. CLEAN CONSTRUCTION SITE.
14. RESTORE SITE TO ITS ORIGINAL CONDITION, AS CLOSE AS POSSIBLE.

GENERAL NOTES:

1. ALL ELEVATIONS ARE IN METERS.
2. ALL DIMENSIONS ARE IN MM EXCEPT AS NOTED.
3. (E) INDICATES REINFORCEMENT BARS EPOXY COATED.
4. USE CLASS S1 CONCRETE IN HEADWALL.
5. MINIMUM CLEAR COVER 50 mm. EXCEPT AS NOTED.
6. ALL EXPOSED CONCRETE EDGES SHALL BE CHAMFERED 20 mm EXCEPT AS NOTED.
7. REINFORCEMENT BARS SHALL CONFORM TO THE REQUIREMENTS OF AASHTO M31M OR M332M GRADE 400 DEFORMED BARS.
8. FOR SOIL BORING LOG SEE SHEET S4 OF S4.
9. PIPE OPENINGS AS SHOWN ARE APPROXIMATE.
10. PLAN DIMENSIONS AND DETAILS RELATIVE TO EXISTING STRUCTURE HAVE BEEN TAKEN FROM EXISTING PLANS AND ARE SUBJECT TO NOMINAL CONSTRUCTION VARIATIONS. IT SHALL BE THE CONTRACTOR'S RESPONSIBILITY TO VERIFY SUCH DIMENSIONS AND DETAILS IN THE FIELD AND MAKE NECESSARY APPROVED ADJUSTMENTS PRIOR TO CONSTRUCTION OR ORDERING OF MATERIALS. SUCH VARIATIONS SHALL NOT BE CAUSE FOR ADDITIONAL COMPENSATION FOR A CHANGE IN THE SCOPE OF THE WORK, HOWEVER, THE CONTRACTOR WILL BE PAID FOR THE QUANTITY ACTUALLY FURNISHED AT THE UNIT PRICE FOR THE WORK.
11. ATTACH GRATE TO PIPE AS REQUIRED AND AS APPROVED BY THE ENGINEER.
12. BACK FILLING WILL BE PERFORMED IN ACCORDANCE WITH ARTICLE 502.10 OF STANDARD SPECIFICATIONS FOR ROAD AND BRIDGE CONSTRUCTION, ADOPTED JANUARY 1, 2002. OR ITS LATEST EDITION.

LEGEND:

CLSM = CONTROLLED LOW STRENGTH MATERIAL.

DESIGN STRESSES:

f'c = 24 MPa
 fy = 400 MPa (Reinf.)
 fy = 345 MPa (Piles)

TOTAL BILL OF MATERIAL

ITEM	UNIT	QUANTITY
REINFORCEMENT BARS, EPOXY COATED	KG	604
CONCRETE STRUCTURES	CU. M.	13.5
CONCRETE REMOVAL	CU. M.	3.0
FURNISHING SOLDIER PILES HP 360 x 152	M.	31.2
DRILLING AND SETTING SOLDIER PILES (IN SOIL)	CU. M.	8.2
STRUCTURE EXCAVATION	CU. M.	39.8
STUD SHEAR CONNECTORS	EACH	48
PIPE UNDERDRAINS FOR STRUCTURES	M.	9.1
TEMPORARY SOIL RETENTION SYSTEM	SQ. M.	27
UNTREATED TIMBER LAGGING	SQ. M.	22.7

REVISIONS	
NAME	DATE

ILLINOIS DEPARTMENT OF TRANSPORTATION
 IL 83 (MILWAUKEE AVENUE)
 AT IL 132 (GRAND AVENUE)
 EXISTING CULVERT HEADWALL
 PLAN AND ELEVATION
 SCALE : NONE
 DATE : 02/26/04
 DRAWN BY: MVT
 CHECKED BY: RSS

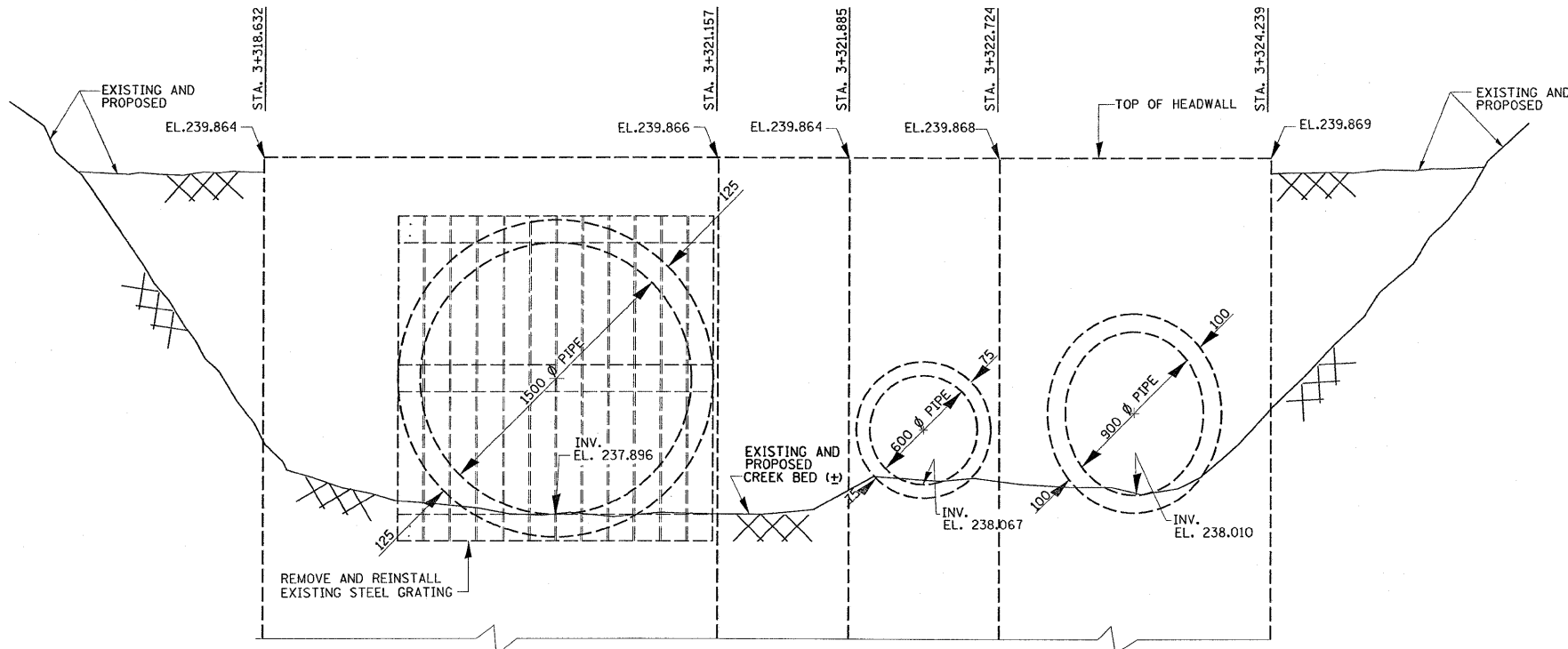

ELEVATION
 (EXISTING HEADWALL TO BE REMOVED)

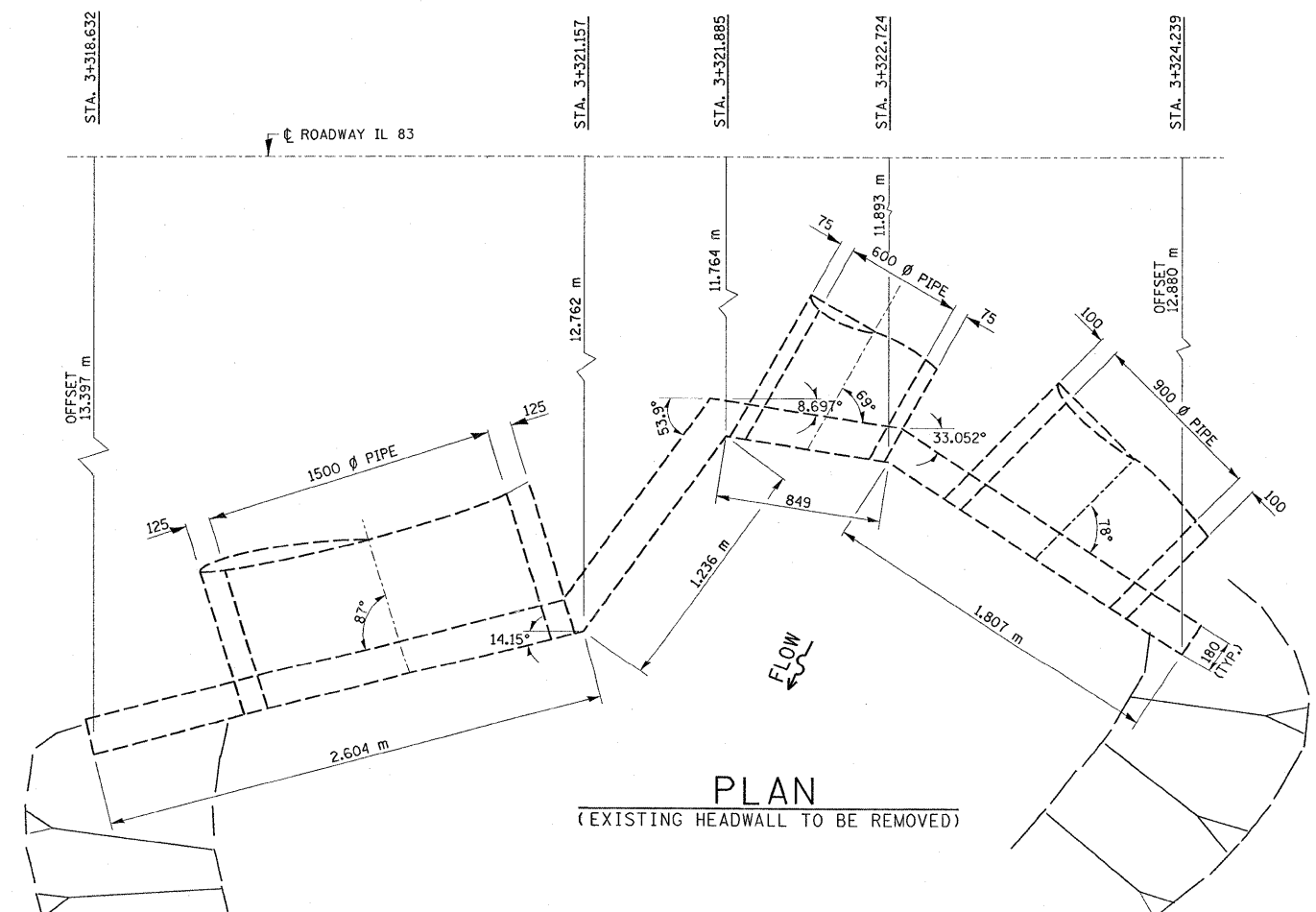

PLAN
 (EXISTING HEADWALL TO BE REMOVED)

10/21/2009
 c:\paw_wor\kdpwido\10101671\1183\1132.dgn
 DISTRICT ONE - DESIGN
 PLAN PREPARATION ENGINEER JOHN FORTMANN / RUSS SINHA (847) 705-4209 / ATTENTION MARK V. TINIAKOS (847) 705-4266