

**INDEX OF SHEETS**

- 1 COVER SHEET
- 2 INDEX OF SHEETS AND GENERAL NOTES
- 3-4 SUMMARY OF QUANTITIES
- 5 TYPICAL SECTIONS
- 6 EXISTING & PROPOSED PLAN AND PROFILE
- 7 LIGHTING AND ELECTRICAL PLANS
- 8 PAVEMENT MARKING, LANDSCAPING AND EROSION CONTROL PLAN
- 9 MOT GENERAL NOTES & SUGGESTED CONSTRUCTION SEQUENCING
- 10 SUGGESTED STAGE OF CONSTRUCTION & TRAFFIC CONTROL - STAGE 1
- 11 SUGGESTED STAGE OF CONSTRUCTION & TRAFFIC CONTROL - STAGE 2
- 12 SUGGESTED STAGE OF CONSTRUCTION & TRAFFIC CONTROL - STAGE 3
- 13 GENERAL PLAN AND ELEVATION
- 14 INDEX OF SHEET, GENERAL NOTES & BILL OF MATERIAL
- 15 STAGE CONSTRUCTION DETAILS
- 16 TEMPORARY CONCRETE BARRIER
- 17 TOP OF DECK PLAN, DEAD LOAD DEFLECTION DIAGRAM DETAIL AND ELEVATIONS
- 18 TOP OF DECK SLAB ELEVATIONS 1
- 19 TOP OF DECK SLAB ELEVATIONS 2
- 20 TOP OF DECK SLAB ELEVATIONS 3
- 21 TOP OF DECK SLAB ELEVATIONS 4
- 22 WEST APPROACH TOP OF SLAB ELEVATIONS
- 23 EAST APPROACH TOP OF SLAB ELEVATIONS
- 24 SUPERSTRUCTURE PLAN, CROSS SECTION & BILL OF MATERIALS
- 25 SUPERSTRUCTURE DETAILS
- 26 SUPERSTRUCTURE PARAPET ELEVATIONS AND DETAILS
- 27 EAST & WEST APPROACH SLAB PLAN & DETAILS
- 28 BRIDGE APPROACH SLAB DETAILS
- 29 ALUMINUM RAILING TYPE I
- 30 PREFORMED JOINT STRIP SEAL
- 31 FRAMING PLAN & DETAILS
- 32 FRAMING DETAILS 1
- 33 FRAMING DETAILS 2
- 34 ELASTOMERIC BEARING TYPE II DETAILS
- 35 ELASTOMERIC BEARING TYPE III DETAILS
- 36 WEST ABUTMENT DETAILS
- 37 EAST ABUTMENT DETAILS
- 38 PIERS 1 REPAIR DETAILS
- 39 PIERS 2 REPAIR DETAILS
- 40 PIERS 3 REPAIR DETAILS
- 41 PIERS 4 REPAIR DETAILS
- 42 SLOPEWALL REPAIR DETAILS
- 43 SEGMENTAL BLOCK RETAINING WALL REPAIR DETAILS & CONCRETE HEADWALL FOR PIPE DRAIN DETAILS
- 44 BAR SPLICER ASSEMBLY & MECHANICAL SPLICER
- 45 DRAINAGE SYSTEM DETAILS
- 46 DRAINAGE SCUPPER DS-12M10
- 47 TC-10 DISTRICT ONE TRAFFIC CONTROL AND PROTECTION FOR SIDE ROADS, INTERSECTIONS AND DRIVEWAYS
- 48 TC-11 DISTRICT ONE TYPICAL APPLICATIONS RAISED REFLECTIVE PAVEMENT MARKERS
- 49 TC-13 DISTRICT ONE TYPICAL PAVEMENT MARKINGS
- 50 TC-22 DISTRICT ONE ARTERIAL ROAD INFORMATION SIGN
- 51 BD-24 DISTRICT ONE CURB AND GUTTER REMOVAL AND REPLACEMENT
- 52 BD-32 BUTT JOINT AND HMA TAPER DETAILS

**STATE STANDARDS**

- 000001-05 STANDARD SYMBOLS, ABBREVIATIONS AND PATTERNS
- 001001-02 AREAS OF REINFORCEMENT BARS
- 001006 DECIMAL OF AN INCH AND OF A FOOT
- 420401-08 BRIDGE APPROACH PAVEMENT CONNECTOR
- 515001-03 NAME PLATE FOR BRIDGES
- 601101-01 CONCRETE HEADWALL FOR PIPE DRAIN
- 606001-04 CONCRETE CURB TYPE B AND COMBINATION CONCRETE CURB AND GUTTER
- 606301-04 PC CONCRETE ISLANDS AND MEDIANS
- 631026-05 TRAFFIC BARRIER TERMINAL, TYPE 5
- 631031-08 TRAFFIC BARRIER TERMINAL, TYPE 6
- 701311-03 LANE CLOSURE, 2L, 2W, MOVING OPERATIONS-DAY ONLY
- 701501-05 URBAN LANE CLOSURE, 2L, 2W UNDIVIDED
- 701606-06 LANE CLOSURE, MULTILANE, 1W OR 2W WITH MOUNTABLE MEDIAN
- 701801-04 LANE CLOSURE, MULTILANE, 1W OR 2W CROSSWALK OR SIDEWALK CLOSURE
- 701901-01 TRAFFIC CONTROL DEVICES
- 704001-06 TEMPORARY CONCRETE BARRIER
- 814001-02 HANDHOLES

**GENERAL NOTES:**

1. THESE PLANS HAVE BEEN PREPARED FROM INFORMATION ACQUIRED FROM EXISTING PLANS AND NOTES RECEIVED FROM IDOT FIELD MAINTENANCE ENGINEERS.
2. PLAN DIMENSIONS AND DETAILS RELATIVE TO EXISTING PLANS ARE SUBJECT TO VARIATIONS FOUND IN THE FIELD. THE CONTRACTOR SHALL FIELD VERIFY EXISTING DIMENSIONS AND DETAILS AFFECTING NEW CONSTRUCTION AND MAKE NECESSARY ADJUSTMENTS PRIOR TO CONSTRUCTION OR ORDERING MATERIALS. ANY ADJUSTMENTS PROPOSED BY THE CONTRACTOR MUST BE APPROVED BY THE ENGINEER. SUCH VARIATIONS SHALL NOT BE CAUSE FOR ADDITIONAL COMPENSATION FOR A CHANGE IN THE SCOPE OF THE WORK, HOWEVER, THE CONTRACTOR WILL BE PAID FOR THE QUANTITY ACTUALLY FURNISHED BASED UPON THE UNIT PRICE.
3. FORTY- EIGHT HOURS BEFORE STARTING EXCAVATION, THE CONTRACTOR WILL CALL J.U.L.I.E. (1-800-892-0123) OR 811 FOR LOCATIONS OF THE EXISTING UTILITIES.
4. THE CONTRACTOR WILL NOT BE ALLOWED TO SET UP A YARD OR FIELD OFFICE ON STATE PROPERTY WITHOUT WRITTEN PERMISSION FROM THE DEPARTMENT.
5. SAW CUTTING PRIOR TO ANY REMOVAL ITEMS NOTED ON THE PLANS OR DIRECTED BY THE ENGINEER SHALL BE CONSIDERED INCLUDED IN THE COST OF THE ITEMS BEING REMOVED.
6. DO NOT SCALE PLANS FOR CONSTRUCTION DIMENSIONS.
7. THE CONTRACTOR SHALL USE CARE IN REMOVING OR EXCAVATING NEAR ALL EXISTING ITEMS WHICH WILL REMAIN. ANY DAMAGE DONE TO EXISTING ITEMS BY THE CONTRACTOR SHALL BE REPAIRED AT THE CONTRACTOR'S EXPENSE.
8. WHEN ARTIFICIAL LIGHTING IS UTILIZED IN NIGHT OPERATIONS, THE CONTRACTOR SHALL EXERCISE THE UTMOST PRECAUTIONS IN PREVENTING ADVERSE VISIBILITY TO THE MOTORING PUBLIC AS WELL AS ADJOINING RESIDENTIAL AREAS.
9. THE CONTRACTOR SHALL OBTAIN ALL NECESSARY PERMITS, AS REQUIRED, PRIOR TO COMMENCING WITH CONSTRUCTION.
10. THE CONTRACTOR SHALL TAKE ALL NECESSARY MEASURES TO ASSURE THAT NO DEBRIS FALLS ONTO THE RAILROAD FACILITY. THE COST OF THIS WORK SHALL BE INCLUDED IN THE VARIOUS PAY ITEMS.
11. THE CONTRACTOR SHALL CONTACT THE TRAFFIC CONTROL SUPERVISOR AT (847) 705-4470 A MINIMUM OF 72 HOURS PRIOR TO THE PLACEMENT OF ANY TEMPORARY TRAFFIC CONTROL DEVICES.
12. THE CONTRACTOR SHALL CONTACT PATRICE HARRIS, THE AREA TRAFFIC FIELD ENGINEER, AT (708) 597-9800 TWO (2) WEEKS PRIOR TO THE PLACEMENT OF PERMANENT PAVEMENT MARKINGS.
13. ALL DAMAGE TO EXISTING PAVEMENT MARKINGS OUTSIDE THE PROPOSED IMPROVEMENTS SHOWN ON THE PLANS SHALL BE REPLACED AT THE CONTRACTOR'S EXPENSE.
14. ALL RAISED REFLECTIVE PAVEMENT MARKERS (BRIDGE) SHALL BE LOW PROFILE.
15. ACCESS SHALL BE PROVIDED AT ALL TIMES TO PROPERTIES ABUTTING THE PROPOSED IMPROVEMENT.
16. BEFORE BEGINNING ANY WORK, THE CONTRACTOR SHALL RETAIN AND RECORD FOR FUTURE REFERENCE, ALL EXISTING PAVEMENT MARKING LINES (AND RAISED REFLECTIVE MARKERS) IN ORDER THAT THESE LOCATIONS CAN BE RE-ESTABLISHED FOR STRIPING. EXACT LOCATIONS OF ALL PAVEMENT MARKINGS SHALL BE AS DIRECTED BY THE ENGINEER.

**COMMITMENTS**

NONE

| HOT-MIX ASPHALT MIXTURE REQUIREMENTS                     |              |
|--|--------------|
| MIXTURE TYPE   | AIR VOIDS    |
| <b>SURFACE COURSE</b>                                    |              |
| POLYMERIZED HOT-MIX ASPHALT SURFACE COURSE, MIX "F", N90 | 4% @ 90 Gyr. |
| <b>TEMPORARY PAVEMENT</b>                                |              |
| HOT-MIX ASPHALT BINDER IL-19MM                           | 4% @ 50 Gyr. |
| HOT-MIX ASPHALT SURFACE COURSE, MIX "D", N50 (IL-9.5MM)  | 4% @ 50 Gyr. |
| <b>BINDER COURSE</b>                                     |              |
| LEVELING BINDER (MACHINE METHOD), N70                    | 4% @ 70 Gyr. |

THE UNIT WEIGHT USED TO CALCULATE ALL HMA SURFACE MIXTURE QUANTITIES IS 112 LBS/SQ YD/IN.

The "AC Type" for Polymerized HMA Mixes SHALL BE "SBS/SBR PG 70 -22" AND FOR NON POLYMERIZED HMA THE "AC TYPE" shall be "PG 64 22" UNLESS modified by District ONE Special Provisions. FOR "PERCENT OF RAP" SEE DISTRICT ONE SPECIAL PROVISIONS.

Note: For proposed section see sheet number 5 and 13.

**PROJECT CONTROL POINTS**

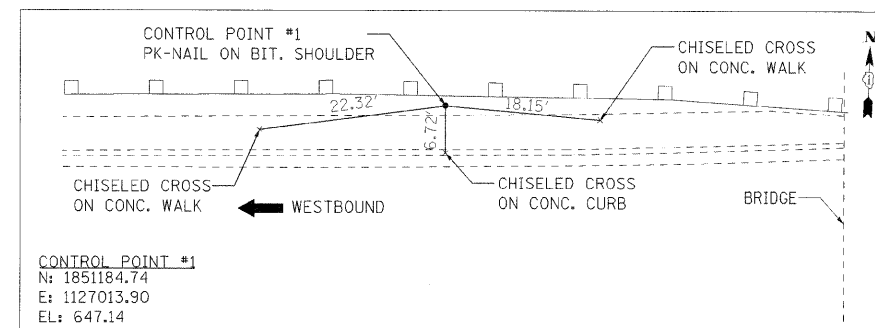

BENCH MARK: B.M. "A" - SQUARE CUT ON LIGHT POLE CONCRETE BASE, STA. 88+91.50 39.76' LEFT, ELEV. 645.29' NAVD88

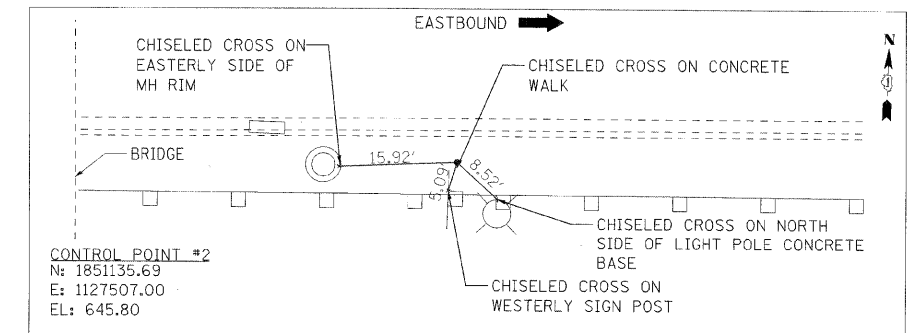

FILE NAME \*  
#FILEL#S



|          |            |         |   |
|----------|------------|---------|---|
| DESIGNED | VEA        | REVISED | - |
| DRAWN    | VEA        | REVISED | - |
| CHECKED  | TWL        | REVISED | - |
| DATE     | 06/14/2010 | REVISED | - |

**STATE OF ILLINOIS  
DEPARTMENT OF TRANSPORTATION**

**INDEX OF SHEET, STATE STANDARDS,  
GENERAL NOTES AND COMMITMENTS**

SCALE: SHEET NO. OF SHEETS STA. TO STA.

| F.A.U. RTE.               | SECTION         | COUNTY | TOTAL SHEETS | SHEET NO. |
|---------------------------|-----------------|--------|--------------|-----------|
| 1548                      | 461 (VB & VF) I | COOK   | 52           | 2         |
| CONTRACT NO. 60H65        |                 |        |              |           |
| ILLINOIS FED. AID PROJECT |                 |        |              |           |