

F.A.P. RTE.	SECTION	COUNTY	TOTAL SHEETS	SHEET NO.
577	DY-T-1	WILL	7	1
		ILLINOIS	CONTRACT NO. 60K74	

STATE OF ILLINOIS
DEPARTMENT OF TRANSPORTATION

DIVISION OF HIGHWAYS

**PROPOSED
HIGHWAY PLANS**

FAP ROUTE 577 (IL 171)
SECTION DY-T-1
AT THORNTON STREET
DRAINAGE IMPROVEMENT
WILL COUNTY
C-91-587-10

FOR INDEX OF SHEETS, SEE SHEET NO. 2

TRAFFIC DATA

EXISTING ADT = 14,600 TO 16,800 (2007)
SPEED LIMIT = 35 MPH

THE IMPROVEMENT IS LOCATED WITHIN
THE CITY OF LOCKPORT

D-91-587-10

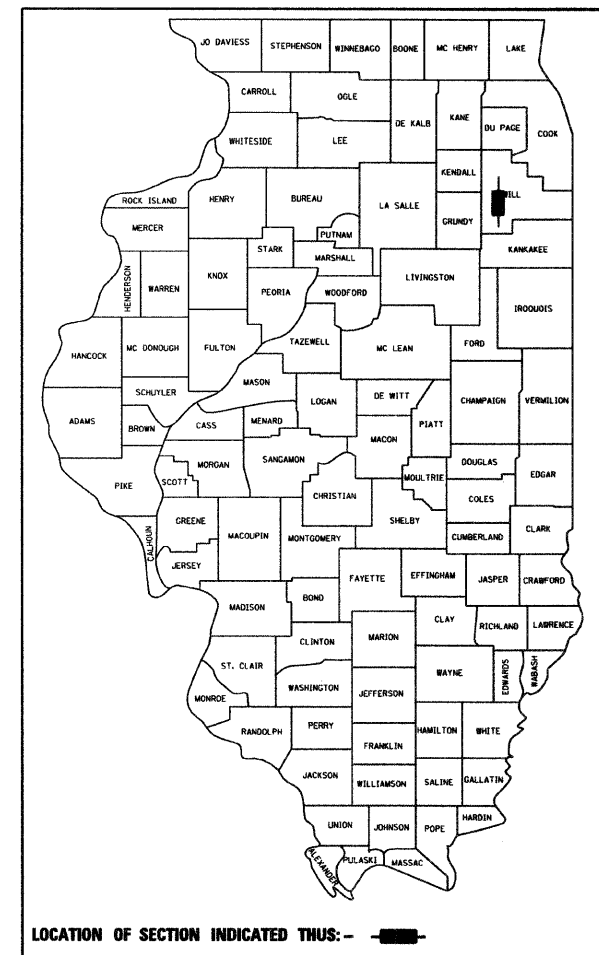

LOCATION OF SECTION INDICATED THUS: - [black rectangle] -

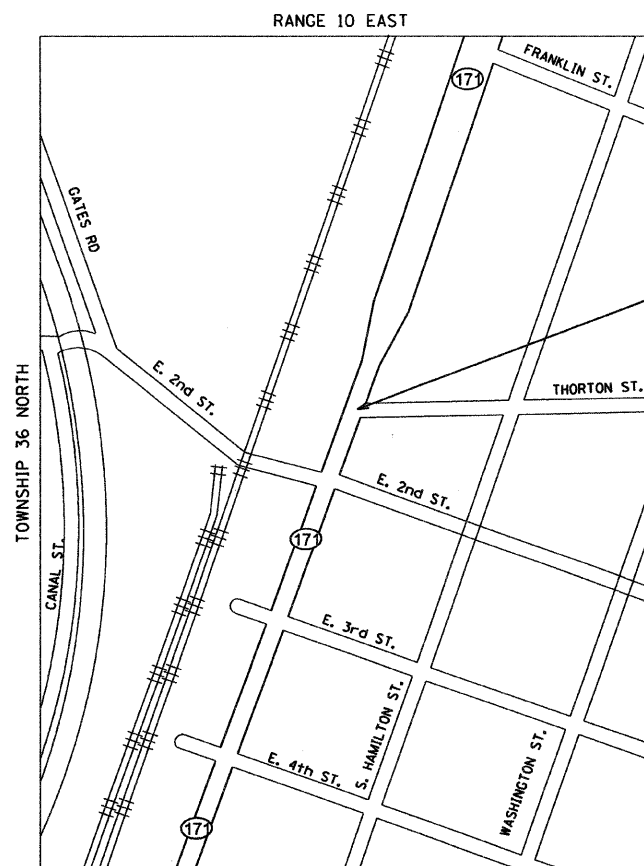

PROJECT LOCATION
STA. 106+54.85 IL 171=
STA. 50+00 THORNTON ST.

Peter M. Johnston
4-26-10
REGISTERED PROFESSIONAL ENGINEER OF ILLINOIS
662-047647
11-30-11

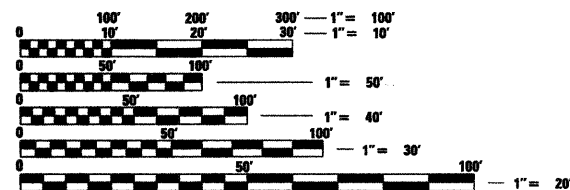

FULL SIZE PLANS HAVE BEEN PREPARED USING STANDARD ENGINEERING SCALES. REDUCED SIZED PLANS WILL NOT CONFORM TO STANDARD SCALES. IN MAKING MEASUREMENTS ON REDUCED PLANS, THE ABOVE SCALES MAY BE USED.

J.U.L.I.E.
JOINT UTILITY LOCATION INFORMATION FOR EXCAVATION
1-800-892-0123
OR 814

PROJECT ENGINEER: PETER JOHNSTON (GRAEF) 773-399-0112
PROJECT MANAGER: KEN ENG (IDOT) 847-705-4247

CONTRACT NO. 60K74

GRAEF 8501 W. Higgins Road, Suite 280
Chicago, Illinois 60631
(773) 399-0112

STATE OF ILLINOIS
DEPARTMENT OF TRANSPORTATION
DIVISION OF HIGHWAYS
SUBMITTED APRIL 28, 2010
Deanna M. O'Keefe
DEPUTY DIRECTOR OF HIGHWAYS, REGION ENGINEER
June 25 2010
Scott E. Stitt P.E.
acting ENGINEER OF DESIGN AND ENVIRONMENT
June 25 2010
Christine M. Reed
DIRECTOR OF HIGHWAYS, CHIEF ENGINEER

PRINTED BY THE AUTHORITY
OF THE STATE OF ILLINOIS

INDEX OF SHEETS	
SHEET NO.	DESCRIPTION
1	COVER SHEET
2	INDEX, GENERAL NOTES AND HIGHWAY STANDARDS
3	SUMMARY OF QUANTITIES
4	TYPICAL SECTION
5	DRAINAGE IMPROVEMENTS PLAN
6	CURB OR CURB AND GUTTER REMOVAL AND REPLACEMENT (BD24)
7	ARTERIAL ROAD INFORMATION SIGN (TC22)

HIGHWAY STANDARDS	
STD. NO.	TITLE
602011-01	CATCH BASIN, TYPE C
602401-02	MANHOLE, TYPE A
604001-03	FRAME AND LIDS, TYPE 1
604091-02	FRAME AND GRATE, TYPE 24
606001-04	CONCRETE CURB TYPE B AND COMBINATION CONCRETE CURB AND GUTTER
701606-06	URBAN LANE CLOSURE, MULTILANE, 2W WITH MOUNTABLE MEDIAN
701701-06	URBAN LANE CLOSURE, MULTILANE INTERSECTION
701801-04	LANE CLOSURE, MULTILANE 1W OR 2W CROSSWALK OR SIDEWALK CLOSURE
701901-01	TRAFFIC CONTROL DEVICES

- GENERAL NOTES**
- BEFORE STARTING ANY EXCAVATION, THE CONTRACTOR SHALL CALL "J.U.L.I.E." AT 800-892-0123 FOR FIELD LOCATIONS OF BURIED ELECTRIC, TELEPHONE AND GAS FACILITIES AND THE CITY OF LOCKPORT AT 815-838-0549 FOR FIELD LOCATIONS OF SANITARY SEWER AND WATER MAIN. (48 HOUR NOTIFICATION IS REQUIRED).
 - THE CONTRACTOR SHALL COORDINATE CONSTRUCTION ACTIVITIES WITH UTILITY COMPANIES.
 - THE CONTRACTOR WILL NOT BE ALLOWED TO SET UP A YARD OR FIELD OFFICE ON STATE PROPERTY WITHOUT WRITTEN PERMISSION FROM THE DEPARTMENT.
 - WHEN ARTIFICIAL LIGHTING IS USED IN NIGHT OPERATIONS THE CONTRACTOR SHALL EXERCISE THE UTMOST PRECAUTIONS IN PREVENTING ADVERSE VISIBILITY TO THE MOTORING PUBLIC AND ADJOINING RESIDENTIAL AREAS.
 - THE RESIDENT ENGINEER SHALL CONTACT THE TRAFFIC CONTROL SUPERVISOR AT (847) 705-4470 A MINIMUM 72 HOURS PRIOR TO THE PLACEMENT OF ANY TEMPORARY TRAFFIC CONTROL DEVICES.
 - FOR PAVEMENT MARKING AND RAISED REFLECTIVE PAVEMENT MARKERS, REFER TO DISTRICT ONE TYPICAL MARKINGS FOR DETAILS NOT SHOWN.
 - MATCH EXISTING PAVEMENT MARKINGS AT PROJECT LIMITS.
 - EXCAVATED MATERIAL FROM THE JOB SITE WILL BE DISPOSED OF AT THE JOLIET MAINTENANCE YARD, LOCKPORT, ILLINOIS.

HOT-MIX ASPHALT MIXTURE REQUIREMENTS	
MIXTURE TYPE	AIR VOIDS
CLASS D PATCHES	
HOT-MIX ASPHALT SURFACE COURSE, MIX "D", N70, 1 1/2"	4% @ 70 GYR
HOT-MIX ASPHALT BINDER COURSE, 19.0mm, N70, 12 1/2 INCH	4% @ 70 GYR

THE UNIT WEIGHT USED TO CALCULATE ALL HOT-MIX ASPHALT SURFACE MIXTURE A IS 112 LBS/SQ YD/IN.

THE "AC TYPE" FOR POLYMERIZED HMA MIXES SHALL BE "SBS/SBR PG 70-22" AND FOR NON-POLYMERIZED HMA THE "AC TYPE" SHALL BE "PG 64-22" UNLESS MODIFIED BY DISTRICT ONE SPECIAL PROVISIONS.

FILE NAME =	USER NAME = .USER.	DESIGNED - EF	REVISED -	STATE OF ILLINOIS DEPARTMENT OF TRANSPORTATION	IL 171 (STATE STREET) INDEX OF SHEETS, HIGHWAY STANDARDS AND GENERAL NOTES			F.A.P. RTE. 577	SECTION DY-T-1	COUNTY WILL	TOTAL SHEETS 7	SHEET NO. 2
#FILE#	PLOT SCALE = 20.0000' / IN.	DRAWN - EF	REVISED -		SCALE: 20	SHEET NO. 1 OF 1 SHEETS	STA.	TO STA.	CONTRACT NO. 60K74			
	PLOT DATE = 5/3/2010	CHECKED - RS	REVISED -		ILLINOIS FED. AID PROJECT							
		DATE - 04-26-2010	REVISED -									

SUMMARY OF QUANTITIES

ITEM NO.	DESCRIPTION	UNIT	100% STATE URBAN TOTAL QUANTITY	Y007 DRAINAGE QUANTITY
20800150	TRENCH BACKFILL AND	CU YD	17	17
21101615	TOPSOIL FURNISH PLACE, 4"	SQ YD	132	132
25200110	SODDING, SALT TOLERANT	SQ YD	132	132
42001300	PROTECTIVE COAT AND AND	SQ YD	11	11
44001700	COMBINATION CONCRETE CURB GUTTER REMOVAL REPLACEMENT	FOOT	32	32
44201821	CLASS D PATCHES, TYPE IV, 14 INCH	SQ YD	28	28
44300200	STRIP REFLECTIVE CRACK CONTROL TREATMENT	FOOT	100	100
550A0050	STORM SEWERS, CLASS A, TYPE 1 12"	FOOT	73	73
55039700	STORM SEWERS TO BE CLEANED	FOOT	395	395
60208240	CATCH BASINS, TYPE C, TYPE 24 FRAME AND GRATE	EACH	1	1
60221100	MANHOLES, TYPE A, 5'-DIAMETER, TYPE 1 FRAME, CLOSED LID	EACH	1	1
60255410	CATCH BASINS TO BE CLEANED	EACH	1	1
60500060	REMOVING INLETS	EACH	1	1
67000400	ENGINEER'S FIELD OFFICE, TYPE A	CAL MO	6	6
67100100	MOBILIZATION	L SUM	1	1
70102625	TRAFFIC CONTROL AND PROTECTION, STANDARD 701606	L SUM	1	1
* 78000400	THERMOPLASTIC PAVEMENT MARKING - LINE 6"	FOOT	81	81
* 78000650	THERMOPLASTIC PAVEMENT MARKING - LINE 24"	FOOT	21	21
X0322256	TEMPORARY INFORMATION SIGNING	SQ FT	76	76
Z0018500	DRAINAGE STRUCTURES TO BE CLEANED	EACH	4	4

* DENOTES SPECIALTY ITEM

FILE NAME =	USER NAME = .USER.	DESIGNED - EF	REVISED -	STATE OF ILLINOIS DEPARTMENT OF TRANSPORTATION	IL 171 (STATE STREET) SUMMARY OF QUANTITIES			F.A.P. RTE. 577	SECTION DY-T-1	COUNTY WILL	TOTAL SHEETS 7	SHEET NO. 3
#FILEL*	PLOT SCALE = 20.0000' / IN.	DRAWN - EF	REVISED -		SCALE: 20	SHEET NO. 1 OF 1 SHEETS	STA.	TO STA.	CONTRACT NO. 60K74			
	PLOT DATE = 5/3/2010	CHECKED - RS	REVISED -		ILLINOIS FED. AID PROJECT							
		DATE - 04-26-2010	REVISED -									

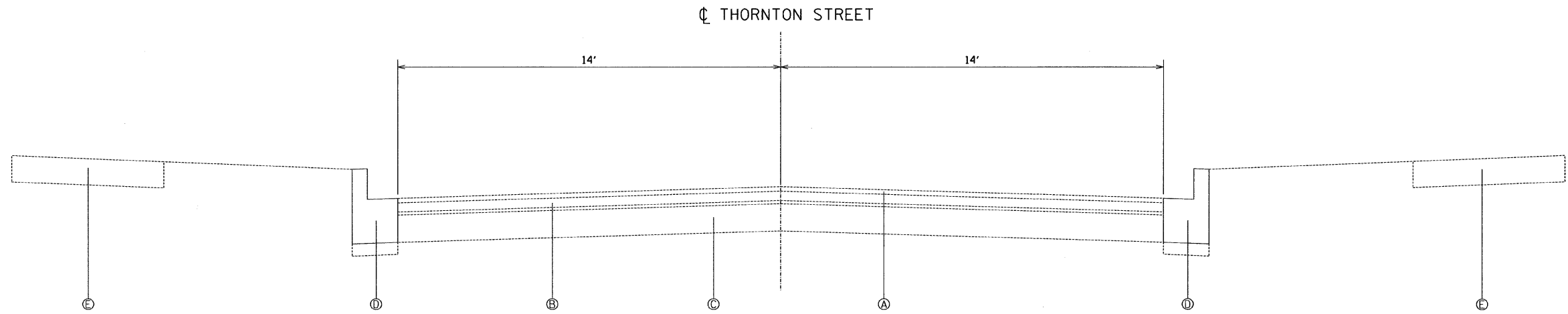

EXISTING TYPICAL SECTION

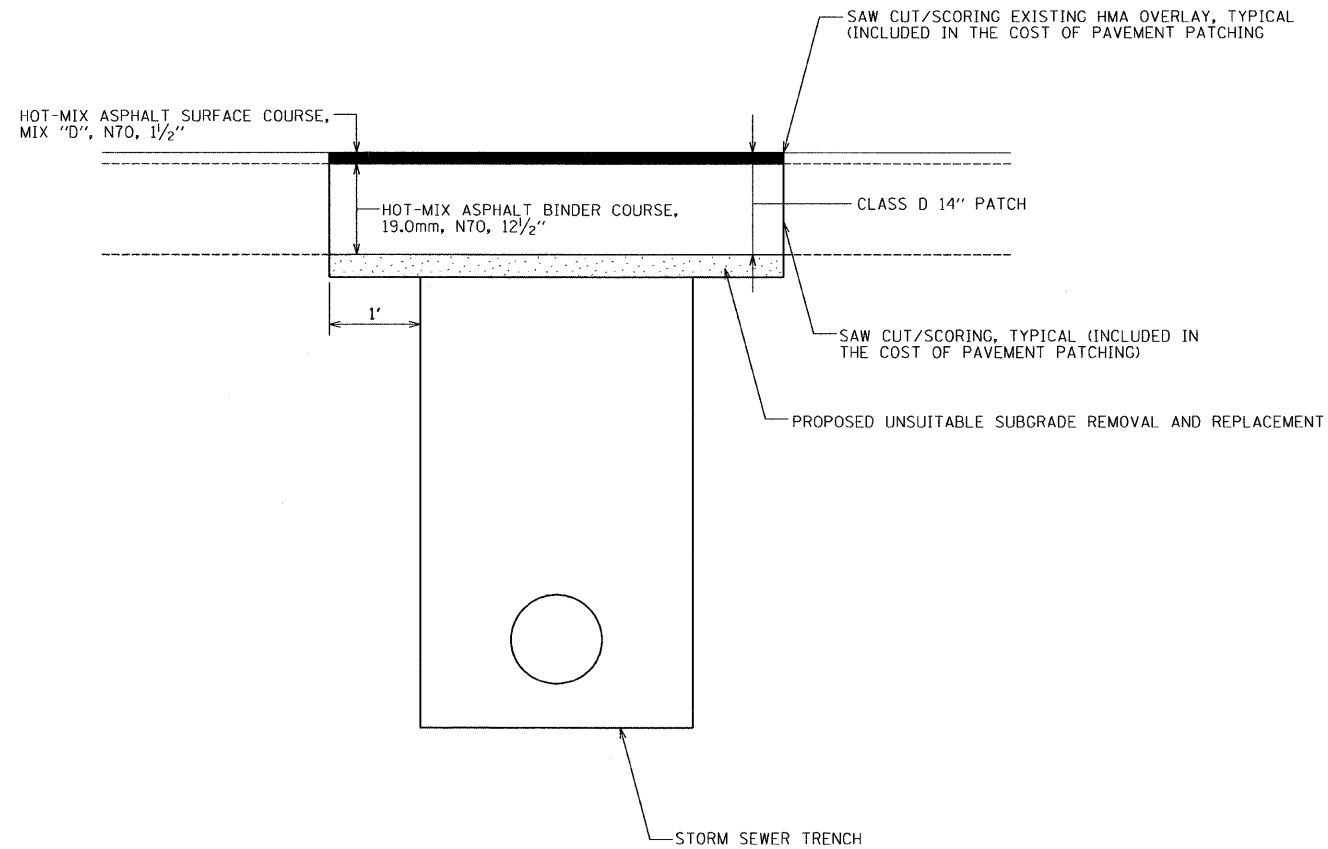

EXISTING CONDITIONS:

- Ⓐ BITUM. CONCRETE SURFACE COURSE, MIX D, CL. I, TYPE 2, AC 10, 1 1/2"
- Ⓑ BITUM. CONCRETE BINDER COURSE, TYPE 2, MIX B, 3"
- Ⓒ P.C.C. PAVEMENT, 9"
- Ⓓ COMBINATION CONCRETE CURB AND GUTTER, B6.24
- Ⓔ P.C.C. SIDEWALK

NOTE:

TO INSTALL THE STORM SEWER THE PATCH SHALL BE FULL DEPTH.
 THE TOP 1 1/2 OF THE PATCH SHOULD BE HOT-MIX ASPHALT SURFACE COURSE, MIX "D", N70.

FILE NAME = *FILEL*	USER NAME = .USER.	DESIGNED - EF	REVISED -	STATE OF ILLINOIS DEPARTMENT OF TRANSPORTATION	IL 171 (STATE STREET) TYPICAL SECTIONS			F.A.P. RTE.	SECTION	COUNTY	TOTAL SHEETS	SHEET NO.
	PLOT SCALE = 20.0018' / IN.	DRAWN - EF	REVISED -		577	DY-T-1	WILL	7	4			
	PLOT DATE = 4/26/2010	CHECKED - RS	REVISED -		SCALE: 20 SHEET NO. 1 OF 1 SHEETS STA. TO STA.			CONTRACT NO. 60K74				
	DATE - 04-26-2010	REVISED -		ILLINOIS FED. AID PROJECT								

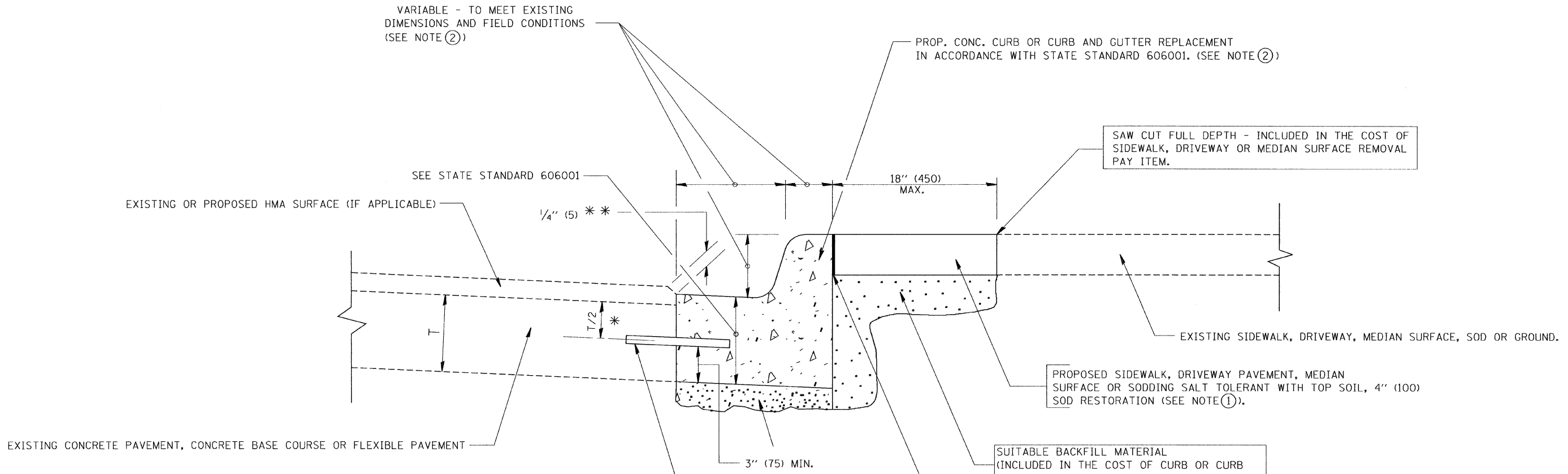

- * 3" (75) MINIMUM FROM TOP AND BOTTOM OF THE CONCRETE PAVEMENT OR BASE COURSE.
 - * * IF THE FINAL SURFACE OF THE PAVEMENT IS CONCRETE, THE GUTTER IS TO BE FLUSH WITH THE PAVEMENT.
- NOTE: ① SIDEWALK, DRIVEWAY PAVEMENT OR MEDIAN SURFACE SHALL BE SIMILAR TO THE MATERIAL BEING REMOVED AND WILL BE PAID FOR SEPARATELY.
SODDING, SALT TOLERANT AND TOP SOIL, FURNISH AND PLACE 4" WILL BE PAID FOR SEPARATELY.
- ② FERTILIZER FOR THE PLACEMENT OF THE SOD IS NOT REQUIRED
- ③ CURB OR CURB AND GUTTER REPLACEMENT SHALL MATCH THE SHAPE OF THE EXISTING CURB OR CURB AND GUTTER UNLESS OTHERWISE SPECIFIED.
- ④ FOR CURB OR CURB AND GUTTER REMOVAL AND REPLACEMENT ADJACENT TO FLEXIBLE PAVEMENT DELETE EPOXY COATED TIE BARS.
- ⑤ LONGITUDINAL BARS, IF ENCOUNTERED IN THE EXISTING CURB OR CURB AND GUTTER, ARE NOT TO BE REPLACED. CUTTING AND REMOVING LONGITUDINAL BARS SHALL BE INCLUDED IN THE COST OF CURB OR CURB AND GUTTER REMOVAL AND REPLACEMENT.
- ⑥ THE COST OF HMA SURFACE REMOVAL IN THE EXISTING GUTTER FLAG SHALL BE INCLUDED IN THE COST OF THE CURB AND GUTTER REMOVAL AND REPLACEMENT.
- ⑦ THE REMOVAL AND REPLACEMENT OF THE EXISTING CURB OR CURB AND GUTTER SHALL BE DONE IN ACCORDANCE WITH THE APPLICABLE PORTIONS OF SECTION 440 AND 606 OF THE STANDARD SPECIFICATIONS.
- ⑧ THE LOCATIONS OF REMOVAL AND REPLACEMENT OF EXISTING CURB OR CURB AND GUTTER SHALL BE DETERMINED BY THE RESIDENT ENGINEER AT THE TIME OF CONSTRUCTION.

- PROPOSED 3/4" (20) PREFORMED EXPANSION JOINT AT CONCRETE SIDEWALKS, DRIVEWAYS, AND MEDIANS. (INCLUDED IN THE COST OF CURB OR CURB AND GUTTER REMOVAL AND REPLACEMENT.)
- UNSUITABLE SUB-BASE MATERIAL TO BE REMOVED, IF DIRECTED BY THE ENGINEER, SHALL BE REPLACED WITH EITHER SUB-BASE GRANULAR MATERIAL, TYPE B OR ADDITIONAL THICKNESS OF CONCRETE.
- REMOVAL AND REPLACEMENT 4" (100) OR LESS IS INCLUDED IN THE COST OF CURB OR CURB AND GUTTER REMOVAL AND REPLACEMENT.
- REMOVAL AND REPLACEMENT IN EXCESS OF 4" (100) WILL BE PAID FOR IN ACCORDANCE WITH ARTICLE 109.04 OF THE STANDARD SPECIFICATIONS.
- PROPOSED #6 (20) EPOXY COATED TIE BARS 24" (600) LONG AT 24" (600) CENTERS WILL NOT BE PAID FOR SEPARATELY. DELETE EPOXY COATED TIE BARS IF EXISTING TIE BARS ARE USUABLE AS DETERMINED BY THE ENGINEER. (SEE NOTE ③).

BASIS OF PAYMENT:
THIS WORK WILL BE PAID FOR AT THE CONTRACT UNIT PRICE PER FOOT (METER) FOR "CURB REMOVAL AND REPLACEMENT" OR "COMBINATION CONCRETE CURB AND GUTTER REMOVAL AND REPLACEMENT".

CURB OR CURB AND GUTTER REMOVAL AND REPLACEMENT

ALL DIMENSIONS ARE IN INCHES (MILLIMETERS)
UNLESS OTHERWISE SHOWN.

FILE NAME =	USER NAME = drivakosgn	DESIGNED - A. HOUSEH	REVISED - R. SHAH 10-03-96	STATE OF ILLINOIS DEPARTMENT OF TRANSPORTATION	CURB OR CURB AND GUTTER REMOVAL AND REPLACEMENT	F.A.B. RTE.	SECTION	COUNTY	TOTAL SHEETS	SHEET NO.	
es:\pw\work\p\dot\drivakosgn\d0108315\bd24.dgn		DRAWN -	REVISED - A. ABBAS 03-21-97			557	DY-T-01	WILL	7	6	
PLOT SCALE = 50.000' / IN.		CHECKED -	REVISED - M. GOMEZ 01-22-01			BD600-06 (BD-24)		CONTRACT NO. 60R74			
PLOT DATE = 12/15/2009		DATE - 03-11-94	REVISED - R. BORO 12-15-09			FED. ROAD DIST. NO. 1 ILLINOIS FED. AID PROJECT					
					SCALE: NONE	SHEET NO. 1 OF 1 SHEETS		STA. TO STA.			

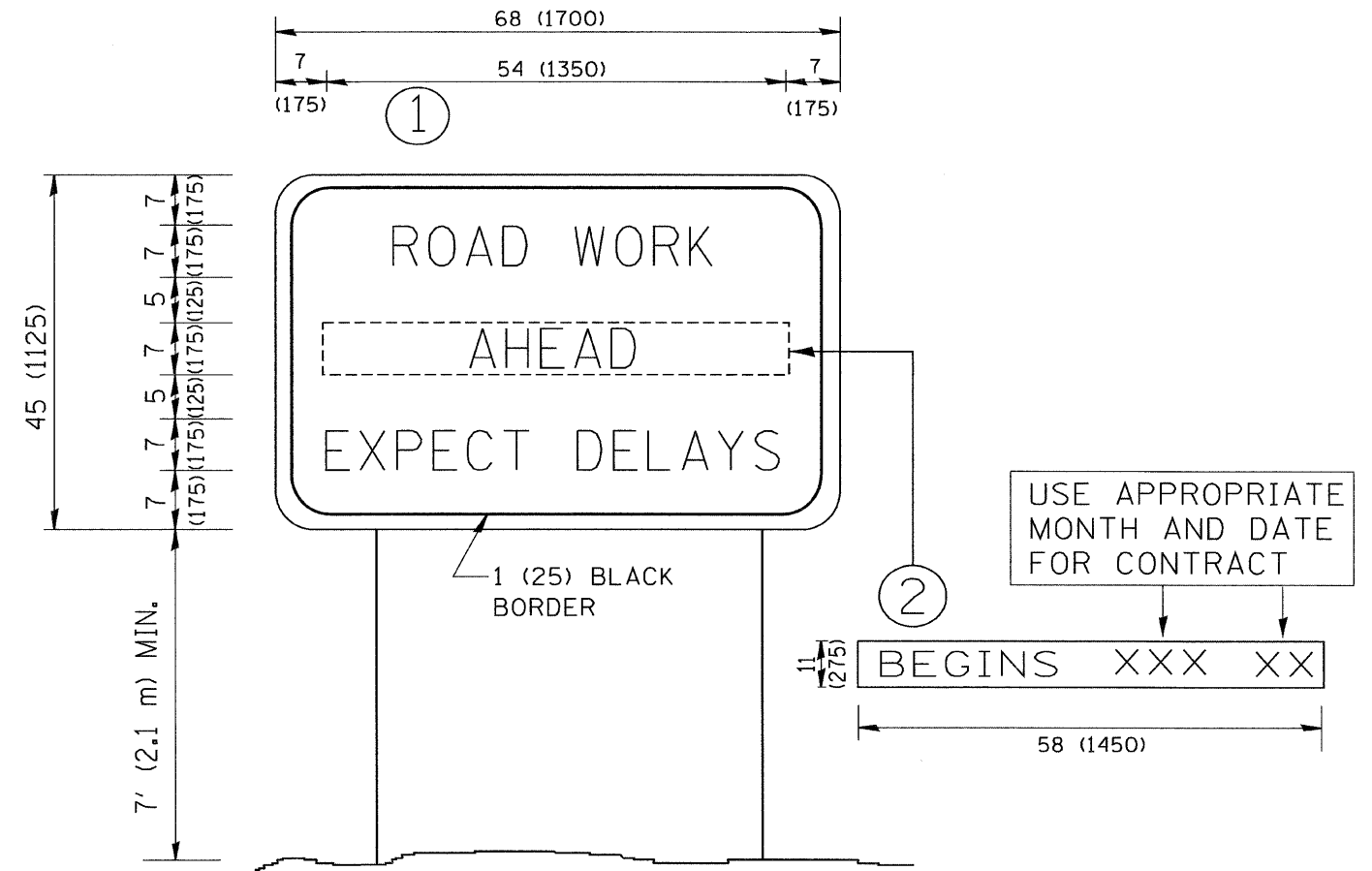

NOTES:

1. USE BLACK LETTERING ON ORANGE BACKGROUND.
2. ERECT SIGNS IN ADVANCE OF THE LOCATION FOR THE "ROAD CONSTRUCTION AHEAD" SIGN AT LOCATIONS AS DIRECTED BY THE ENGINEER.
3. ERECT SIGN ① WITH INSTALLED PANEL ② ONE WEEK PRIOR TO THE START OF CONSTRUCTION.
4. REMOVE PANEL ② SOON AFTER THE START OF CONSTRUCTION.
5. SEE SPECIAL PROVISION FOR "TEMPORARY INFORMATION SIGNING" FOR ADDITIONAL INFORMATION.
6. ONE SIGN ASSEMBLY EQUALS 25.70 SQ. FT. (2.3 SQ. M.)
7. SHALL BE PAID FOR AS TEMPORARY INFORMATION SIGNING.

ALL DIMENSIONS ARE IN INCHES (MILLIMETERS) UNLESS OTHERWISE SHOWN.

FILE NAME = W:\diststd\22x34\to22.dgn	USER NAME = gegltonobt	DESIGNED -	REVISED - R. MIRS 09-15-97	STATE OF ILLINOIS DEPARTMENT OF TRANSPORTATION	ARTERIAL ROAD INFORMATION SIGN			F.A.P. RTE. 557	SECTION DV-T-1	COUNTY WILL	TOTAL SHEETS 7	SHEET NO. 7
	PLOT SCALE = 50.000' / IN.	DRAWN -	REVISED - R. MIRS 12-11-97		SCALE: NONE	SHEET NO. 1	OF 1	SHEETS	STA.	TO STA.	FED. ROAD DIST. NO. 1 ILLINOIS FED. AID PROJECT	
	PLOT DATE = 1/4/2008	CHECKED -	REVISED - T. RAMMACHER 02-02-99		CONTRACT NO. 60K74							
		DATE -	REVISED - C. JUCIUS 01-31-07									