

**LEGEND:**

- PROPOSED MANHOLE
- PROPOSED CATCH BASIN
- PROPOSED STORM SEWER
- ▶ PROPOSED FLARED END SECTION
- EXISTING MANHOLE
- EXISTING CATCH BASIN
- EXISTING INLET
- ▶ EXISTING FLARED END SECTION
- EXISTING STORM SEWER
- - - EXISTING PIPE CULVERT

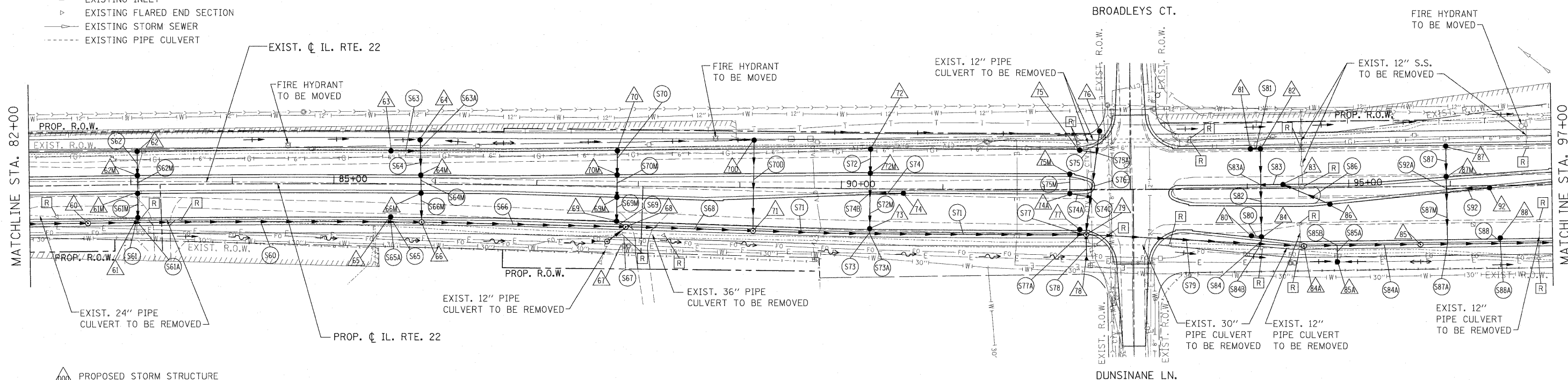

- △ PROPOSED STORM STRUCTURE
- PROPOSED STORM SEWER
- EXISTING STRUCTURE TO BE REMOVED
- EXISTING STORM SEWER TO BE ABANDONED
- EXISTING STRUCTURE TO BE ADJUSTED
- EXISTING STRUCTURE TO BE CLEANED

**FOR UTILITY INFORMATION ONLY**

**NOTE:**

STORM WATER STRUCTURE OFFSET LOCATIONS GIVEN ON THE DETAILED PLANS ARE TO THE FOLLOWING POINTS: A) FOR STRUCTURES FALLING IN THE CURB LINE - TO THE EDGE OF PAVEMENT; B) FOR ALL OTHER STRUCTURE LOCATIONS - TO THE CENTER OF THE STRUCTURE.

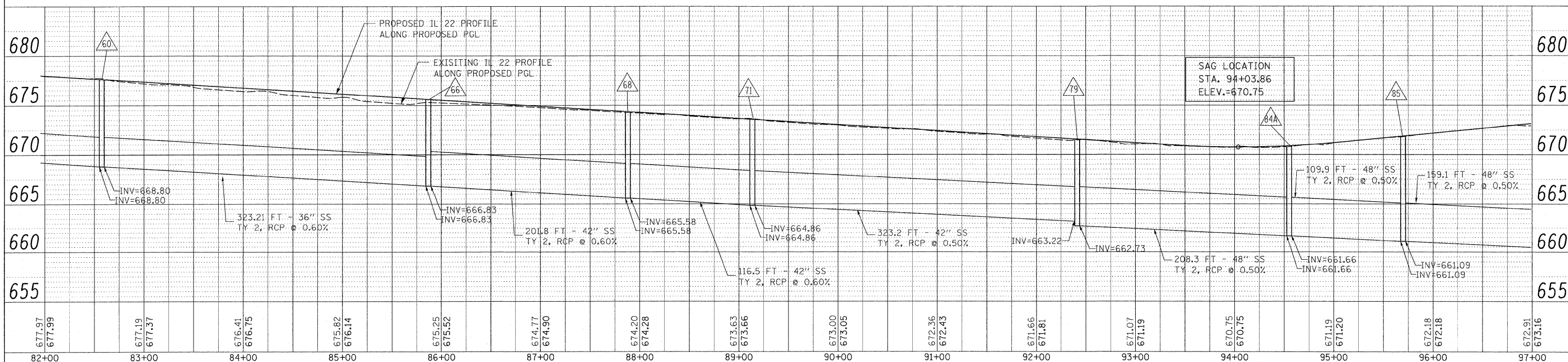

DATE	
BY	
REVISION	
NO.	
DESCRIPTION	
DATE	
BY	
REVISION	
NO.	
DESCRIPTION	
DATE	
BY	
REVISION	
NO.	
DESCRIPTION	

DATE	
BY	
REVISION	
NO.	
DESCRIPTION	
DATE	
BY	
REVISION	
NO.	
DESCRIPTION	
DATE	
BY	
REVISION	
NO.	
DESCRIPTION	

FILE NAME =	USER NAME = #USER#	DESIGNED - LP	REVISED -	<b>STATE OF ILLINOIS DEPARTMENT OF TRANSPORTATION</b>	<b>IL. ROUTE 22 DRAINAGE PLAN AND PROFILE</b>			F.A.P. RTE. 337	SECTION 2010-062-DTR	COUNTY LAKE	TOTAL SHEETS 56	SHEET NO. 26
W:\11\RT22\2009 REVISIONS\Tree Removal Contract\CADD Sheets\0160L41-zht-drain.dgn	PLOT SCALE = #SCALE#	DRAWN - MC	REVISED -		SCALE: 1"=50'	SHEET NO. 26 OF 56 SHEETS	STA. 82+00 TO STA. 97+00	CONTRACT NO. 60L41				
PLOT DATE = 5/13/2010	DATE - 05/14/2010	CHECKED - JP	REVISED -		ILLINOIS FED. AID PROJECT							
		REVISION	REVISED -									