

- LEGEND:**
- PROPOSED MANHOLE
  - PROPOSED CATCH BASIN
  - PROPOSED STORM SEWER
  - ▶ PROPOSED FLARED END SECTION
  - EXISTING MANHOLE
  - EXISTING CATCH BASIN
  - EXISTING INLET
  - ▶ EXISTING FLARED END SECTION
  - EXISTING STORM SEWER
  - EXISTING PIPE CULVERT

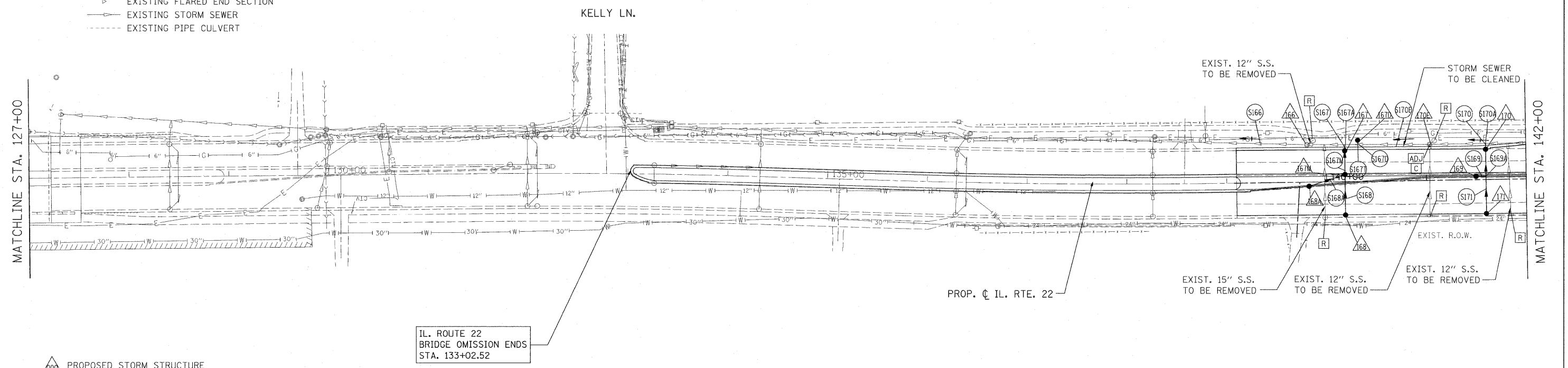

DATE	
BY	
REVIEWED	
APPROVED	
NOTE BOOK	
ALIGNED	
CHECKED	
NO. OF SHEETS	
FILE NAME	

DATE	
BY	
REVIEWED	
APPROVED	
NOTE BOOK	
ALIGNED	
CHECKED	
NO. OF SHEETS	
FILE NAME	



**FOR UTILITY INFORMATION ONLY**

**NOTE:**  
STORM WATER STRUCTURE OFFSET LOCATIONS GIVEN ON THE DETAILED PLANS ARE TO THE FOLLOWING POINTS: A) FOR STRUCTURES FALLING IN THE CURB LINE - TO THE EDGE OF PAVEMENT; B) FOR ALL OTHER STRUCTURE LOCATIONS - TO THE CENTER OF THE STRUCTURE.

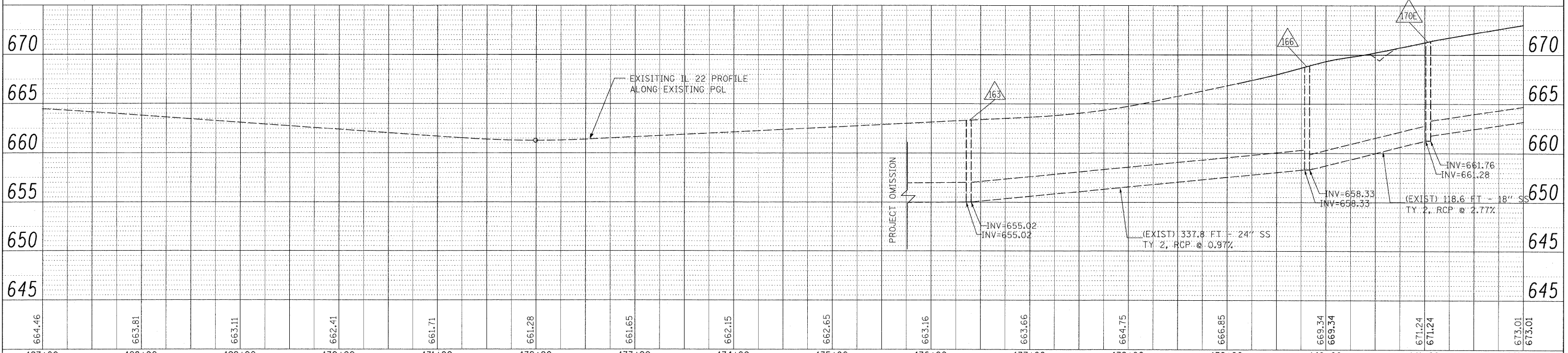

664.46	663.81	663.11	662.41	661.71	661.28	661.65	662.15	662.65	663.16	663.66	664.75	666.85	669.34	669.34	671.24	671.24	673.01	673.01			
127+00	128+00	129+00	130+00	131+00	132+00	133+00	134+00	135+00	136+00	137+00	138+00	139+00	140+00	141+00	142+00						
FILE NAME =		USER NAME = #USER#		DESIGNED - LP		REVISED -		<b>STATE OF ILLINOIS</b> <b>DEPARTMENT OF TRANSPORTATION</b>		<b>IL ROUTE 22</b> <b>DRAINAGE PLAN AND PROFILE</b>		F.A.P. RTE.		SECTION		COUNTY		TOTAL SHEETS		SHEET NO.	
W:\ILROUTE22\2009 REVISIONS\Tree Removal Contract\CADD Sheets\DI60_41-shr-drain.dgn		DRAWN - MC		REVISED -		337						2010-062-DTR		LAKE		56		29			
PLOT SCALE = #SCALE#		CHECKED - JP		REVISED -																	
PLOT DATE = 5/13/2010		DATE - 05/14/2010		REVISED -																	
								SCALE: 1"=50'		SHEET NO. 29 OF 56 SHEETS		STA. 127+00 TO STA. 142+00		CONTRACT NO. 60L41		ILLINOIS FED. AID PROJECT					