

DATE \_\_\_\_\_  
 BY \_\_\_\_\_  
 SURVEYED \_\_\_\_\_  
 ALIGNED \_\_\_\_\_  
 RT. OF WAY CHECKED \_\_\_\_\_  
 PLAN NO. \_\_\_\_\_  
 NOTE BOOK \_\_\_\_\_  
 NO. \_\_\_\_\_  
 DATE FILED \_\_\_\_\_

**CHRISTOPHER B. BURKE ENGINEERING LTD.**  
 9575 West Higgins Road, Suite 600  
 Rosemont, Illinois 60018  
 (847) 823-0500

DATE \_\_\_\_\_  
 BY \_\_\_\_\_  
 SURVEYED \_\_\_\_\_  
 PROPOSED CHECKED \_\_\_\_\_  
 B.M. NOTED \_\_\_\_\_  
 PROFILE NO. \_\_\_\_\_  
 STRUCTURE NOTATION CH'RD \_\_\_\_\_

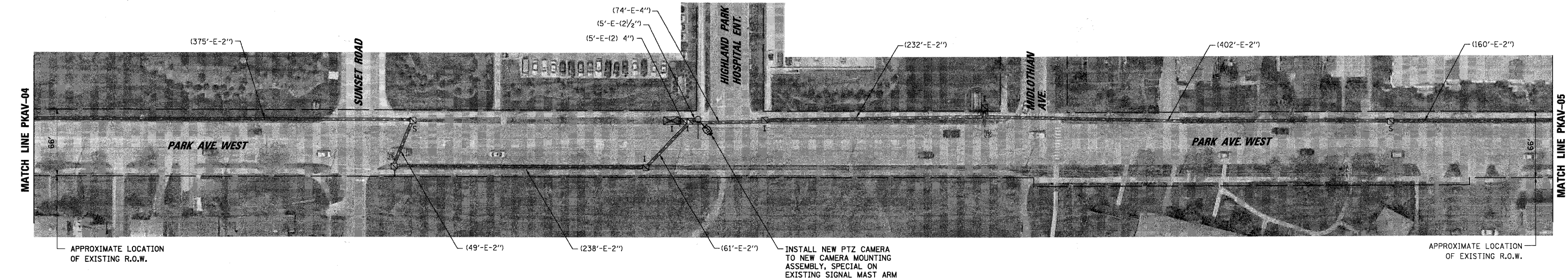
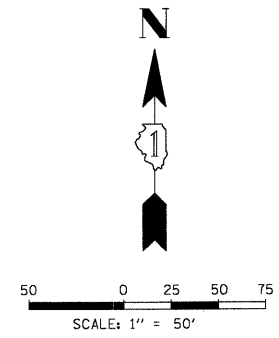
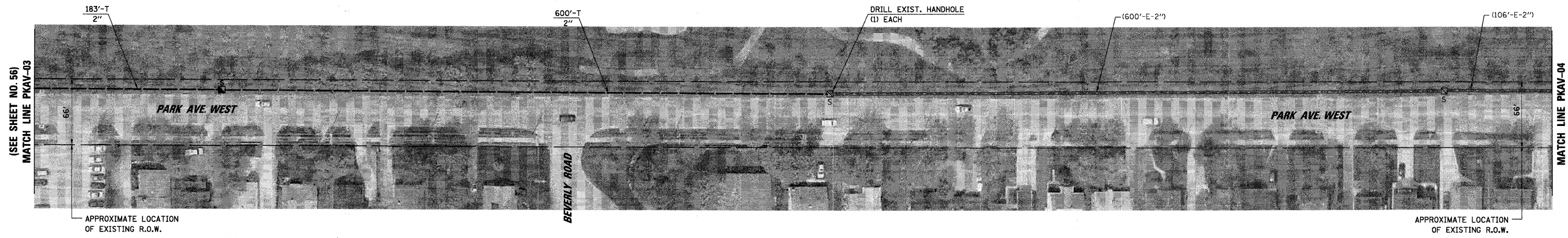

FILE NAME = N:\LCD01\090407\T-r\offic\INT-14_ParkAve.dgn	USER NAME = FBARISO	DESIGNED - ABR	REVISED -	<b>STATE OF ILLINOIS DEPARTMENT OF TRANSPORTATION</b>	<b>INTERCONNECT PLAN PARK AVENUE WEST FROM U.S. ROUTE 41 (SKOKIE HWY) TO GREEN BAY ROAD</b>				F.A.P. RTE.	SECTION	COUNTY	TOTAL SHEETS	SHEET NO.
	PLOT SCALE = 50'	DRAWN - FPB / FCP	REVISED -		SCALE: 1" = 50'	SHEET NO. 2 OF 2 SHEETS	STA. --	TO STA. --	06-00924-00-TL	LAKE	76	57	
	PLOT DATE = 5/3/2010	CHECKED - MJT	REVISED -						CONTRACT NO. 63485				
		DATE - APRIL 30, 2010	REVISED -						ILLINOIS FED. AID PROJECT				