

PROPOSED HORIZONTAL CONTROL

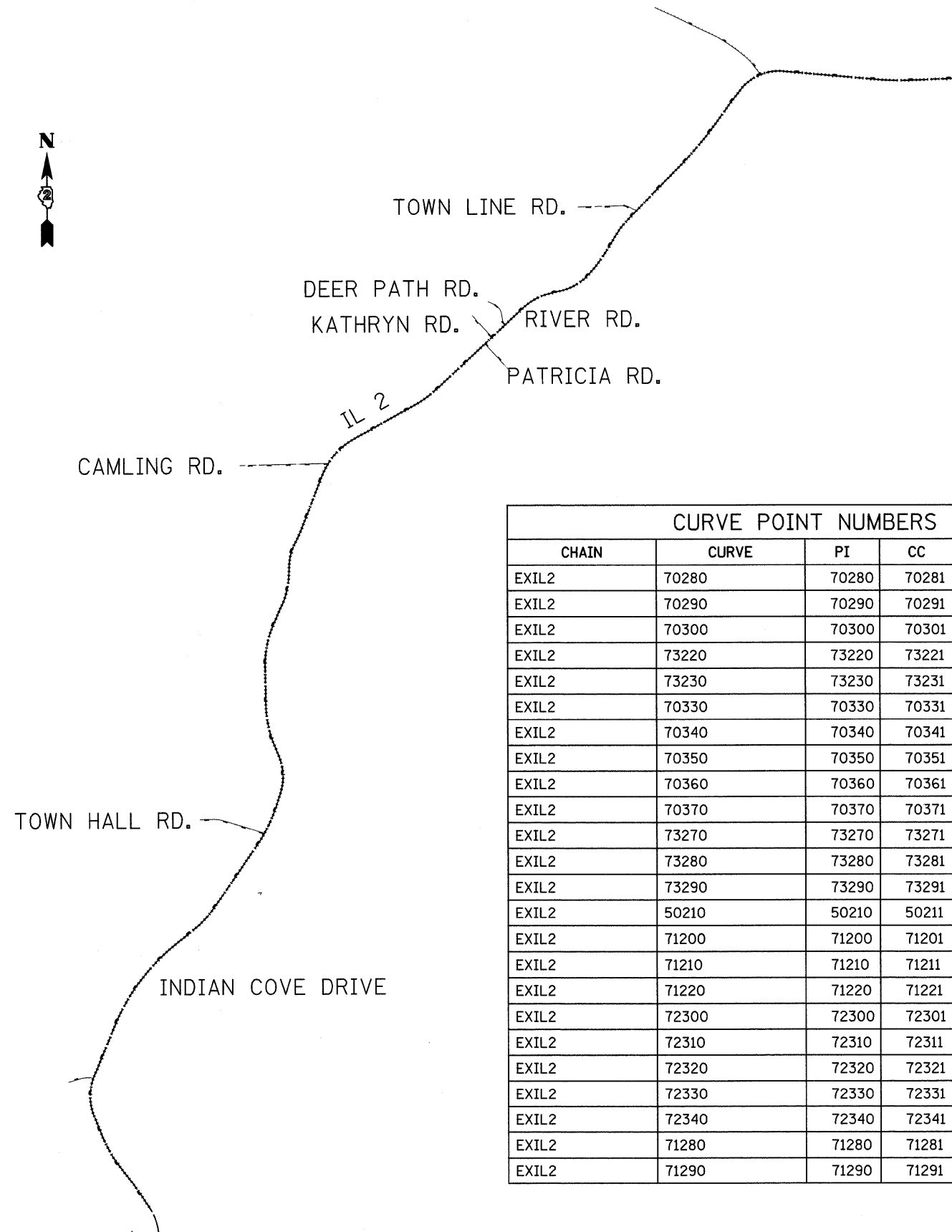

CURVE POINT NUMBERS					
CHAIN	CURVE	PI	CC	PC	PT
EXIL2	70280	70280	70281	70282	70283
EXIL2	70290	70290	70291	70292	70293
EXIL2	70300	70300	70301	70302	70303
EXIL2	73220	73220	73221	73222	73223
EXIL2	73230	73230	73231	73232	73233
EXIL2	70330	70330	70331	70332	70333
EXIL2	70340	70340	70341	70342	70343
EXIL2	70350	70350	70351	70352	70353
EXIL2	70360	70360	70361	70362	70363
EXIL2	70370	70370	70371	70372	70373
EXIL2	73270	73270	73271	73272	73273
EXIL2	73280	73280	73281	73282	73283
EXIL2	73290	73290	73291	73292	73293
EXIL2	50210	50210	50211	50212	50213
EXIL2	71200	71200	71201	71202	71203
EXIL2	71210	71210	71211	71212	71213
EXIL2	71220	71220	71221	71222	71223
EXIL2	72300	72300	72301	72302	72303
EXIL2	72310	72310	72311	72312	72313
EXIL2	72320	72320	72321	72322	72323
EXIL2	72330	72330	72331	72332	72333
EXIL2	72340	72340	72341	72342	72343
EXIL2	71280	71280	71281	71282	71283
EXIL2	71290	71290	71291	71292	71293

Chain PRIL2E contains:
 70000 CUR 70200 CUR 70210 CUR 60210 CUR 60220 100001 CUR 70240 CUR 70250 CUR 7-
 0260 CUR 70270 CUR 70280 CUR 70290 CUR 70300 CUR 73220 CUR 73230 CUR 70330 CUR -
 70340 CUR 70350 CUR 70360 CUR 70370 CUR 73270 CUR 73280 CUR 73290 CUR 50210 CUR-
 71200 CUR 71210 CUR 71220 CUR 72300 CUR 72310 CUR 72320 CUR 72330 CUR 72340 CU-
 R 71280 CUR 71290 70005

Beginning chain PRIL2E description
 =====

Point 70000 N 1,945,719.6790 E 726,654,5670 Sta 538+74.25

Course from 70000 to PC 70200 0° 53' 05.40" Dist 5,814.6147'

Curve Data

Curve 70200
 P.I. Station 598+16.73 N 1,951,661.4500 E 726,746.3346
 Delta = 17° 45' 27.34" (LT)
 Degree = 7° 00' 00.03"
 Tangent = 127.8649'
 Length = 253.6796'
 Radius = 818.5100'
 External = 9.9271'
 Long Chord = 252.6655'
 Mid. Ord. = 9.8082'
 P.C. Station 596+88.86 N 1,951,533.6003 E 726,744.3600
 P.T. Station 599+42.54 N 1,951,783.8106 E 726,709.2221
 C.C. N 1,951,546.2403 E 725,925.9476

Course from PT 70200 to PC 70210 343° 07' 38.06" Dist 359.0976'

Curve Data

Curve 70210
 P.I. Station 604+39.30 N 1,952,259.1850 E 726,565.0392
 Delta = 6° 52' 29.31" (LT)
 Degree = 2° 30' 00.00"
 Tangent = 137.6614'
 Length = 274.9925'
 Radius = 2,291.8320'
 External = 4.1307'
 Long Chord = 274.8275'
 Mid. Ord. = 4.1232'
 P.C. Station 603+01.64 N 1,952,127.4496 E 726,604.9950
 P.T. Station 605+76.63 N 1,952,385.1904 E 726,509.6018
 C.C. N 1,951,462.2516 E 724,411.8225

Course from PT 70210 to PC 60210 336° 15' 08.75" Dist 207.2060'

Curve Data

Curve 60210
 P.I. Station 609+61.74 N 1,952,737.6886 E 726,354.5167
 Delta = 6° 47' 14.35" (RT)
 Degree = 1° 54' 35.49"
 Tangent = 177.8997'
 Length = 355.3832'
 Radius = 3,000.0000'
 External = 5.2701'
 Long Chord = 355.1754'
 Mid. Ord. = 5.2608'
 P.C. Station 607+83.84 N 1,952,574.8520 E 726,426.1583
 P.T. Station 611+39.22 N 1,952,907.8510 E 726,302.6219
 C.C. N 1,953,782.9756 E 729,172.1440

Course from PT 60210 to PC 60220 343° 02' 23.09" Dist 409.7110'

FILE NAME = c:\pwork\pwidot\GRANTPM\dms31213\086628hvc.dgn	USER NAME = grantpm	DESIGNED -	REVISED -	STATE OF ILLINOIS DEPARTMENT OF TRANSPORTATION	HORIZONTAL & VERTICAL CONTROL	F.A.P. RTE.	SECTION	COUNTY	TOTAL SHEETS	SHEET NO.
PLOT SCALE = 50.0000' / IN.	CHECKED -	REVISED -	742			37R-4	OGLE	867	80	
PLOT DATE = Tue Mar 30 11:44:27 2010	DATE -	REVISED -	CONTRACT NO. 64E17							
			SCALE:			SHEET NO. OF SHEETS	STA. TO STA.	FED. ROAD DIST. NO.	ILLINOIS FED. AID PROJECT	