

STAGE 2

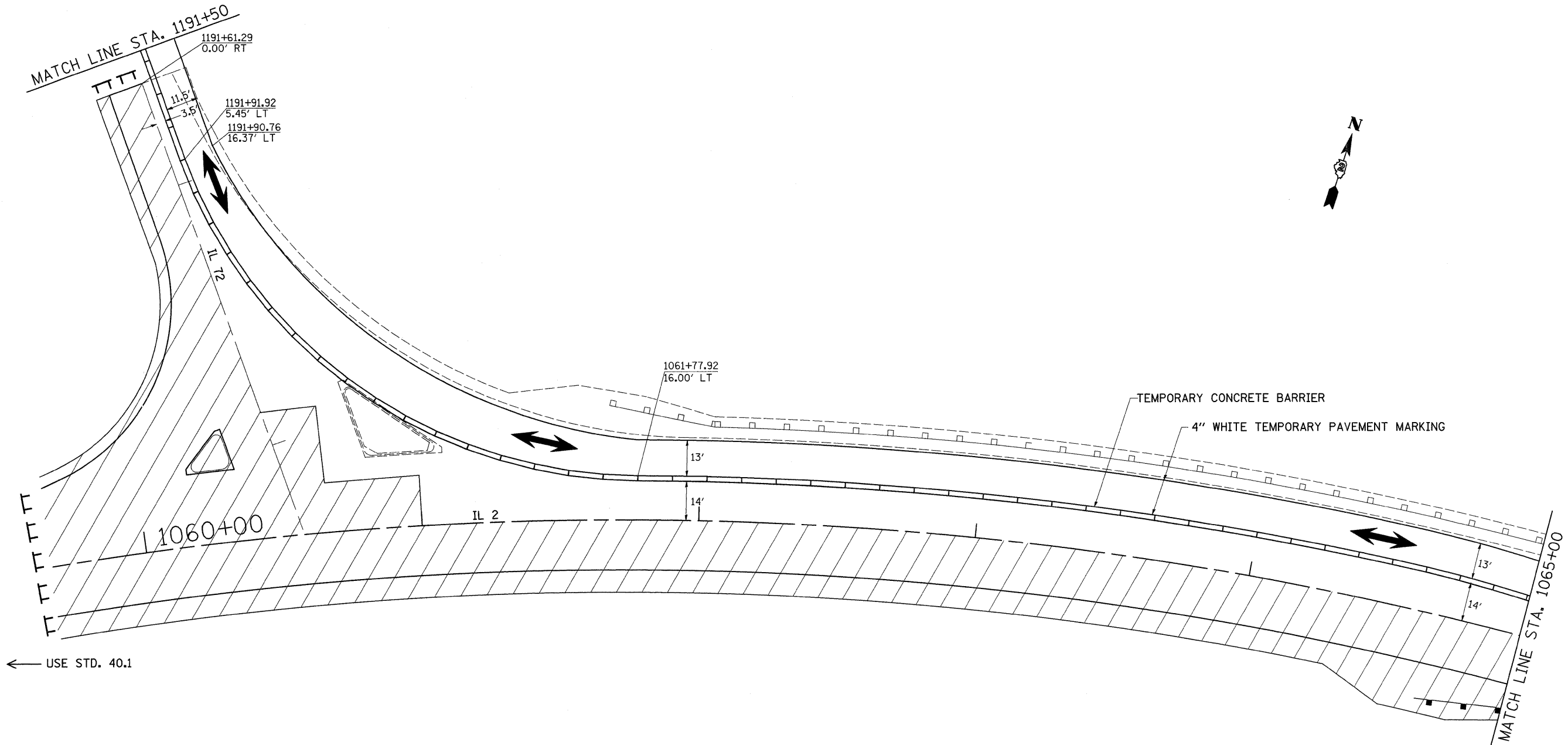

← USE STD. 40.1

STAGE 2 NOTES

1. USE STANDARD 701321. SEE STANDARDS FOR ADDITIONAL SIGNING AND DEVICES NOT SHOWN IN DETAILS.
 2. REMOVAL OF GUARDRAIL @ RT STA. 1065+20 TO STA. 1068+20.
 3. REMOVAL OF EXISTING PAVEMENT FROM NW QUAD IL 72 TO MILL CREEK BRIDGE.
 4. CONSTRUCT SUB-BASE GRANULAR MATERIAL, TYPE "A"
 5. CONSTRUCT PCC PAVEMENT (JOINTED) & PCC SHOULDERS
 6. INSTALL STEEL PLATE BEAM GUARDRAIL, TYPE A RT STA. 1064+68 - 1068+13.
- * ACCESS FOR RESIDENTS ON IL 2 SOUTH TOWARD OREGON WILL BE CLOSED FOR THIS STAGE.

STAGE 3 NOTES

1. REMOVAL OF ALL TEMPORARY PAINT PAVEMENT MARKINGS PLACED IN STAGE 2 (WORKZONE PAVEMENT MARKING REMOVAL)
2. PLACEMENT OF FINAL PAVEMENT MARKINGS IN THE RECONSTRUCTION AREA (URETHANE PAVEMENT MARKINGS) AND PREVIOUS CONFLICTING PAVEMENT MARKINGS REMOVED IN STAGE 1.

	= WORK AREA
	= TYPE III BARRICADE WITH FLASHING LIGHTS
	= SIGN
	= BARRICADE, OR DRUM WITH STEADY BURNING LIGHTS
	= INDUCTION LOOP DETECTOR
	= TRAFFIC SIGNAL
	= TEMPORARY RUMBLE STRIPS

FILE NAME =	USER NAME = grantpm	DESIGNED -	REVISED -	STATE OF ILLINOIS DEPARTMENT OF TRANSPORTATION	STAGE 2			F.A. RTE.	SECTION	COUNTY	TOTAL SHEETS	SHEET NO.
os:\pwork\VPWIDOT\GRANTPM\dms31213\d06628etg.dgn	PLOT SCALE = 20,0000' / IN.	DRAWN -	REVISED -					742	37R-4	OGLE	867	157
PLOT DATE = Tue Mar 30 11:22:29 2010	DATE -	CHECKED -	REVISED -					CONTRACT NO. 64E17				
								ILLINOIS FED. AID PROJECT				
				SCALE:	SHEET NO.	OF SHEETS	STA.	TO STA.				