

Benchmark: Telephone Pole, Existing Sta. 712+80.09, 21.37' LT.
Proposed Sta. 712+78.03, 24.74' LT. Elev. 682.39

STATE OF ILLINOIS
DEPARTMENT OF TRANSPORTATION

Existing Structure: None

* For top of wall elevation, pile section, spacing and tip elevation see sheets 6-8 of 13. Bottom of wall panels shall be a minimum of 2'-0" below top of curb.

SHEET INDEX

NO.	DESCRIPTION
1-3	GENERAL PLAN
4	GENERAL NOTES & TOTAL BILL OF MATERIALS
5	WALL SECTION
6-8	WALL PLAN
9	PANEL DETAILS
10	WALL DETAILS
11-13	BORING LOGS

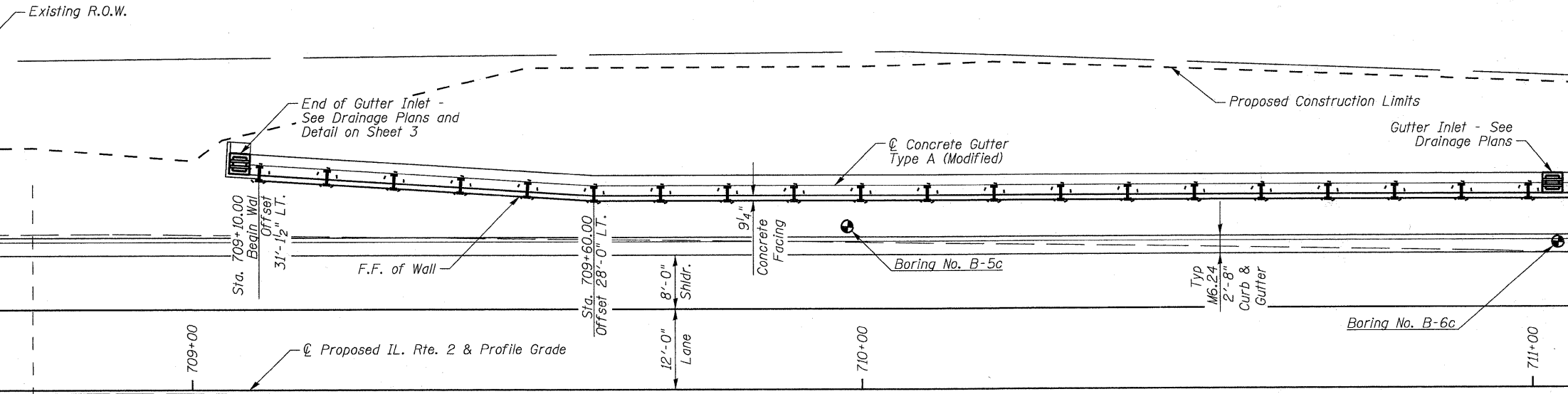
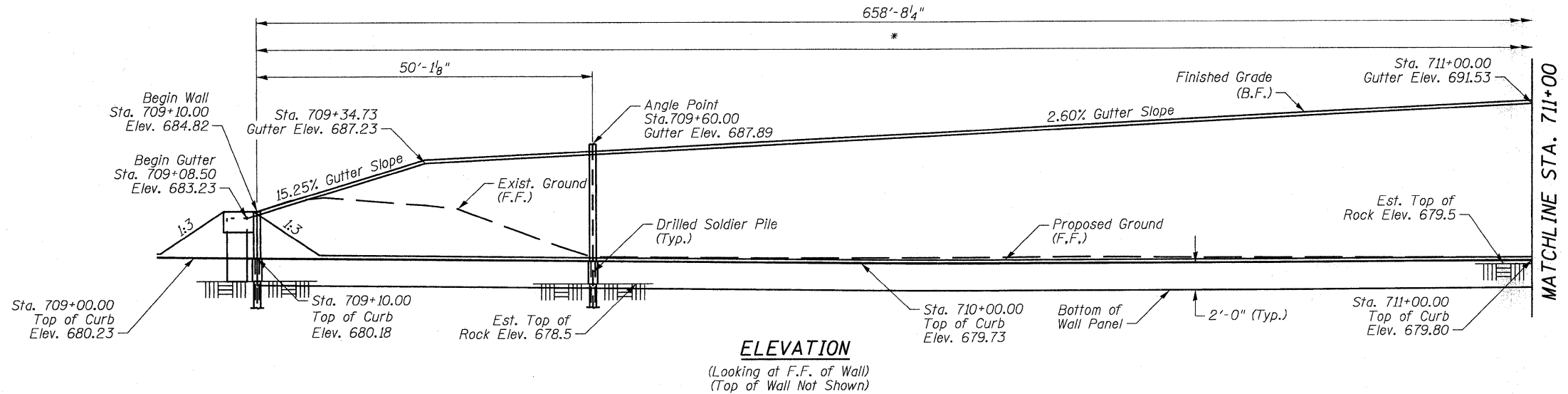

CURVE DATA
(IL. Rte. 2)

P.I. STA = 719+72.11
Δ = 43° 40' 36" (RT.)
D = 4° 00' 00"
R = 1,432.40'
T = 574.03'
L = 1,091.92'
E = 110.74'
P.C. STA = 713+98.08
P.T. STA = 724+90.00

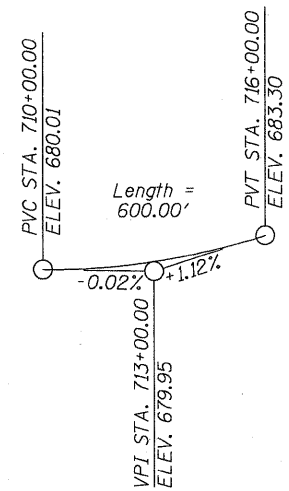

PROFILE GRADE
(Along Centerline of Proposed IL. Rte. 2)

NOTES

Stations and Offsets are given from the Centerline of Proposed IL. Rte. 2 at the front face of wall unless otherwise noted.

See Sheet 4 of 13 for Bill of Materials.

F.F. = Front Face
B.F. = Back Face

Howard R. Green Company

PLAN

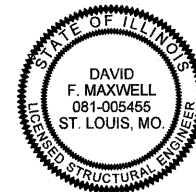

David F. Maxwell, S.E. Reg. No. 081-005455
Date: 3/17/10
My registration expires November 30, 2010.

APPROVED
FOR STRUCTURAL ADEQUACY ONLY

Ralph E. Anderson (TJD)
ENGINEER OF BRIDGES AND STRUCTURES

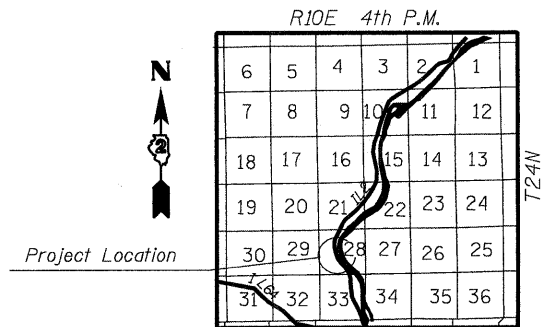

LOCATION SKETCH

GENERAL PLAN & ELEVATION
IL. RTE. 2
FAP 742 SECTION 37R-4
OGLE COUNTY
RETAINING WALL D
STA. 709+10.00 TO STA. 715+65.00
STRUCTURE NO. 071-7003

DESIGNED	JMW
CHECKED	DFM
DRAWN	CTH
CHECKED	DFM

SHEET NO. 1	F.A.P. RTE.	SECTION	COUNTY	TOTAL SHEETS	SHEET NO.
13 SHEETS	742	37R-4	OGLE	867	200
CONTRACT NO. 64E17					
FED. ROAD DIST. NO. 7 ILLINOIS FED. AID PROJECT					