

STATE OF ILLINOIS
DEPARTMENT OF TRANSPORTATION

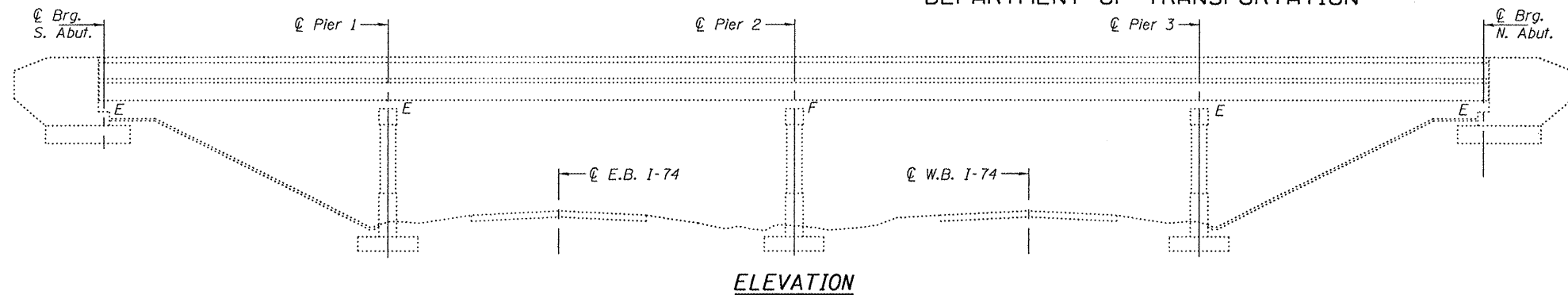

GENERAL NOTES

All structural steel shall conform to AASHTO Classification M-270 Gr. 36, unless otherwise noted.

Fasteners shall be high strength bolts. Bolts $7/8"$ ϕ , open holes $15/16"$ ϕ , unless otherwise noted.

After the new beam is in its final position and/or beam straightening operations have been completed, the Engineer in the field shall check to see that the top flange is tight against the slab. If not, the Contractor shall inject epoxy between the existing concrete deck and the top flange of the beam. See Special Provision "Epoxy Injection".

Plan dimensions and details relative to existing plans are subject to nominal construction variations. The Contractor shall field verify existing dimensions and details affecting new construction and make necessary approved adjustments prior to construction or ordering of materials. Such variations shall not be cause for additional compensation for a change in scope of the work, however, the Contractor will be paid for the quantity actually furnished at the unit bid price for the work.

The existing structural steel coating contains lead. The Contractor shall take appropriate precautions to deal with the presence of lead on this project.

Existing structural steel that will be in contact with new structural steel shall be cleaned and painted prior to erection as required by the Special Provision "Cleaning and Painting Contact Surface Areas of Existing Steel Structures".

All structural steel shall be shop painted with the inorganic zinc rich primer per AASHTO M300, Type 1. Cost included with Structural Steel Repair.

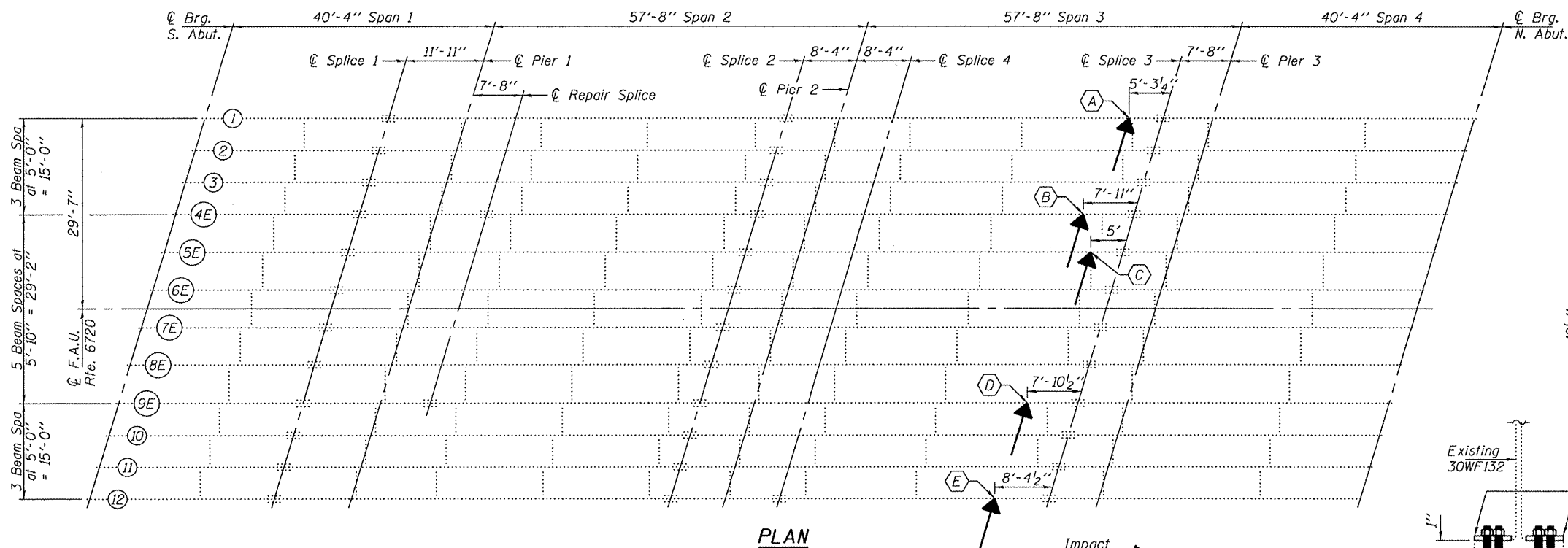

- (A) - Beam 1, Span 3 to be Straightened.
- (B) - Beam 4E, Span 3 to be Straightened & Strengthened.
- (C) - Beam 5E, Span 3 to be Straightened & Strengthened.
- (D) - Beam 9E, Span 3 to be Straightened & Strengthened.
- (E) - Beam 12, Span 3 to be Straightened & Strengthened.

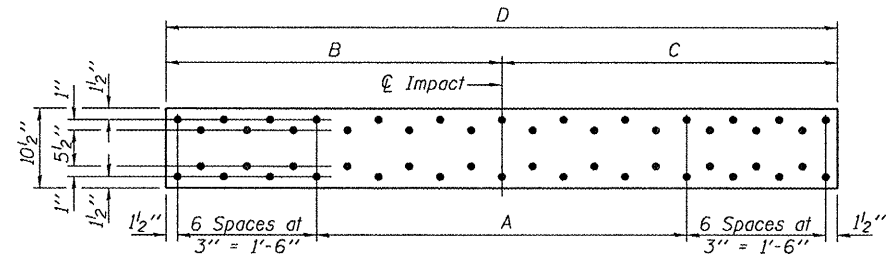
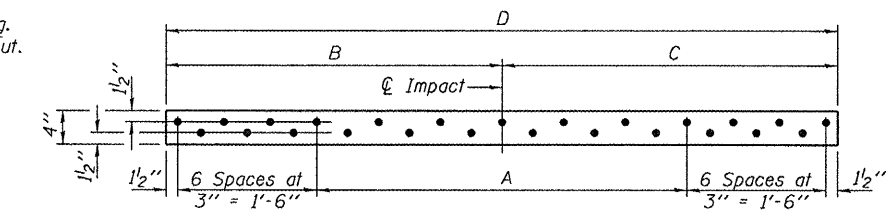
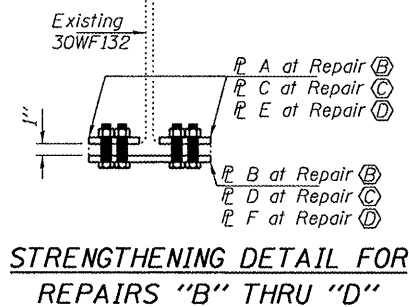

TABLE OF DIMENSIONS

	A	B	C	D	# Req'd
R A	24 spa. at $4 1/2" = 9'-0"$	$6'-7 1/2"$	$5'-7 1/2"$	$12'-3"$	2
R B	24 spa. at $4 1/2" = 9'-0"$	$6'-7 1/2"$	$5'-7 1/2"$	$12'-3"$	1
R C	8 spa. at $4 1/2" = 3'-0"$	$3'-6 1/2"$	$2'-8 1/2"$	$6'-3"$	2
R D	8 spa. at $4 1/2" = 3'-0"$	$3'-6 1/2"$	$2'-8 1/2"$	$6'-3"$	1
R E	12 spa. at $4" = 4'-0"$	$3'-7 1/2"$	$3'-7 1/2"$	$7'-3"$	2
R F	12 spa. at $4" = 4'-0"$	$3'-7 1/2"$	$3'-7 1/2"$	$7'-3"$	1



TOTAL BILL OF MATERIAL

ITEM	UNIT	QUANTITY
Structural Steel Repair	Pound	1500
Beam Straightening	L.S.	0.5

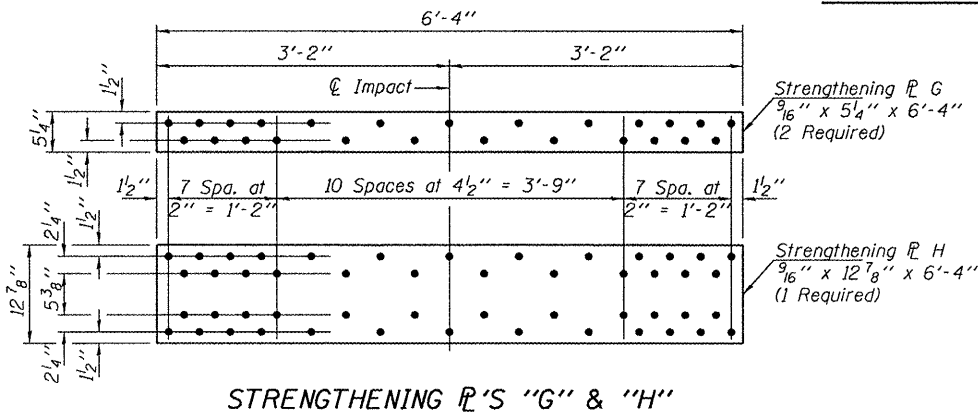
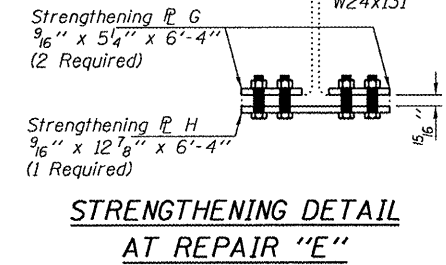

PLAN & ELEVATION
PINECREST DRIVE OVER F.A.I. RTE. 74
SN 090-0091

DESIGNED: [Signature]
CHECKED: [Signature]
DRAWN: Kyle M. Steffen
CHECKED: [Signature]

JUNE 15, 2010
EXAMINED: [Signature]
PASSED: [Signature]



Expires: November 30, 2010

SHEET NO. 1	F.A.I. RTE. 74	SECTION [90-14HB-1(BR)II]	COUNTY TAZEWELL	TOTAL SHEETS 17	SHEET NO. 14
2 SHEETS	CONTRACT NO. 68976		FED. ROAD DIST. NO. ILLINOIS FED. AID PROJECT		