

SEQUENCE OF CONSTRUCTION

1. REMOVE EXISTING PAVED SHOULDERS AND REPLACE WITH HMA BASE COURSE 12"
2. INSTALL TRAFFIC CONTROL AS SHOWN IN THIS DETAIL AND ACCORDING TO STANDARDS 701400 & 701402.
3. CONSTRUCT THE STAGE 1 PORTION OF THE STRUCTURE REPAIRS.

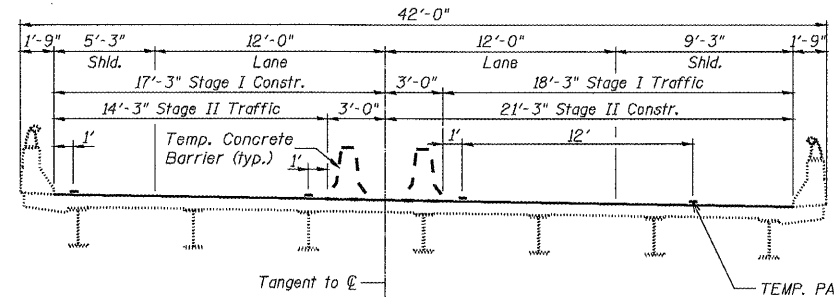
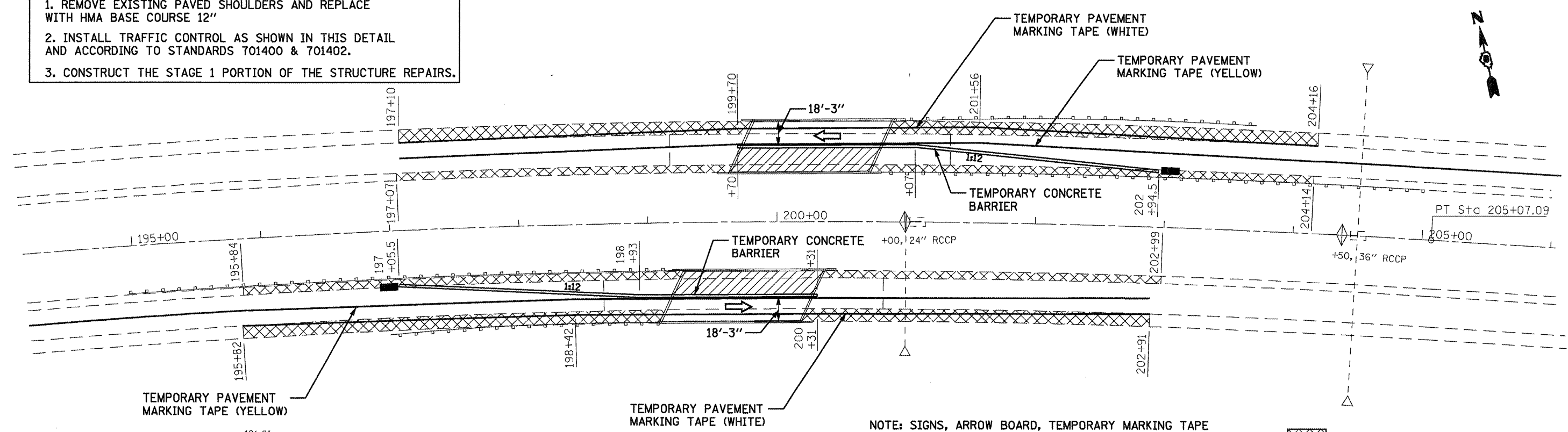

CROSS SECTION
(Looking East, EB bridge shown, WB bridge similar)

NOTE: SIGNS, ARROW BOARD, TEMPORARY MARKING TAPE AND BARRICADES WITH STEADY BURNING MONODIRECTIONAL LIGHTS AS SHOWN IN STANDARD 701402 & 701400.
REMOVE EXISTING STRIPING CONFLICTING WITH THE STAGING PLAN. PAID FOR AS PAVEMENT MARKING REMOVAL.

- PAVED SHOULDER REMOVAL REPLACE WITH HMA BASE COURSE 12"
- WORK AREA
- IMPACT ATTENUATOR

STAGE I

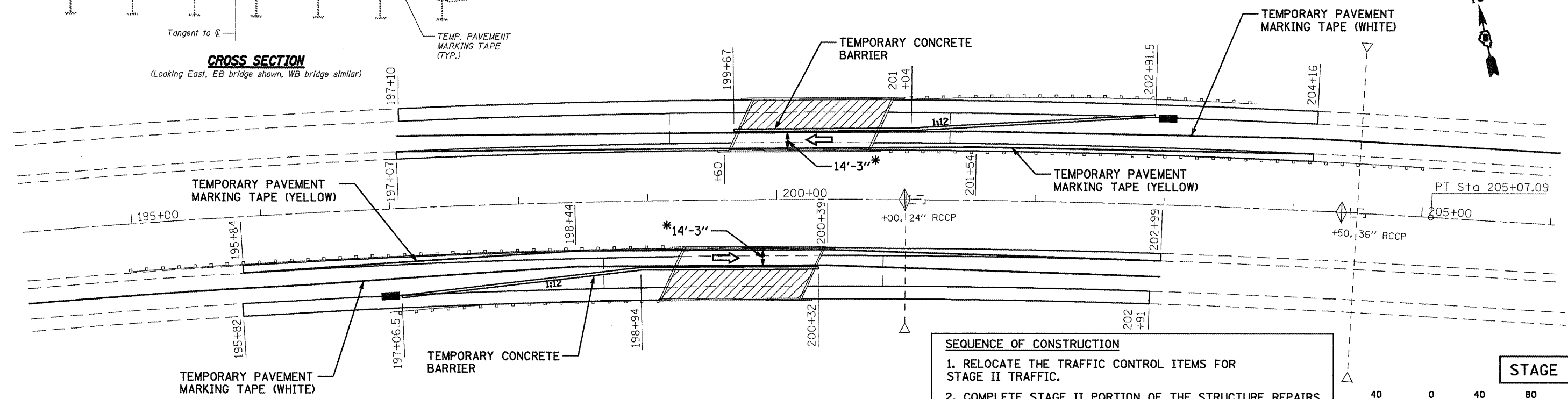

SEQUENCE OF CONSTRUCTION

1. RELOCATE THE TRAFFIC CONTROL ITEMS FOR STAGE II TRAFFIC.
2. COMPLETE STAGE II PORTION OF THE STRUCTURE REPAIRS.
3. REMOVE TRAFFIC CONTROL ITEMS AND COMPLETE ALL REMAINING WORK.

* SEE WIDTH RESTRICTION SIGNING DETAIL

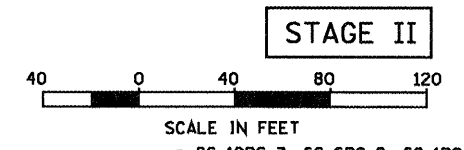

STAGE II

FILE NAME =
e:\pwwork\pwwid07\LAUGHLIN\LD0196700\0722A16-Sht-staging.dgn

USER NAME = laughtinr1
DESIGNED -
DRAWN -
CHECKED -
DATE -

DESIGNED -
DRAWN -
CHECKED -
DATE -

REVISED -
REVISED -
REVISED -
REVISED -

**STATE OF ILLINOIS
DEPARTMENT OF TRANSPORTATION**

STAGING PLAN
SN 086-0023(EB) & 0024(WB)

F.A.I. RTE.	SECTION	COUNTY	TOTAL SHEETS	SHEET NO.
72	*	**	48	34
CONTRACT NO. 72A16				
ILLINOIS FED. AID PROJECT				